

SIDE BURNER CART MOUNT KIT AGBPK



INSTALLATION OF DOUBLE SIDE BURNER ONTO GRILL CART (MODEL AGB122 ONLY)

IMPORTANT - READ ALL INSTRUCTIONS BEFORE YOU BEGIN

THE INSTRUCTIONS HEREIN SHOULD BE PERFORMED BY A QUALIFIED SERVICE TECHNICIAN. THE APPLIANCE MUST BE COMPLETELY COOL AND THE PREVIOUS GAS SOURCE MUST BE SHUT OFF OR REMOVED BEFORE ATTEMPTING INSTALLATION.

Some parts inside your grill or side burner have sharp edges. Care must be taken when handling the various components to avoid personal injury. Wear gloves when handling.

TOOLS REQUIRED:

- Work gloves
- Safety glasses
- Phillips screwdriver
- Pipe wrench or large slip-joint pliers
- Adjustable Wrenches (2)
- Thread sealant

STEP 1

Remove the grate cover, grate, drip pan, and the electrical cord strain relief from the rear of the unit. You will need a flat-blade screwdriver to remove the strain relief, then push the cord through the opening.

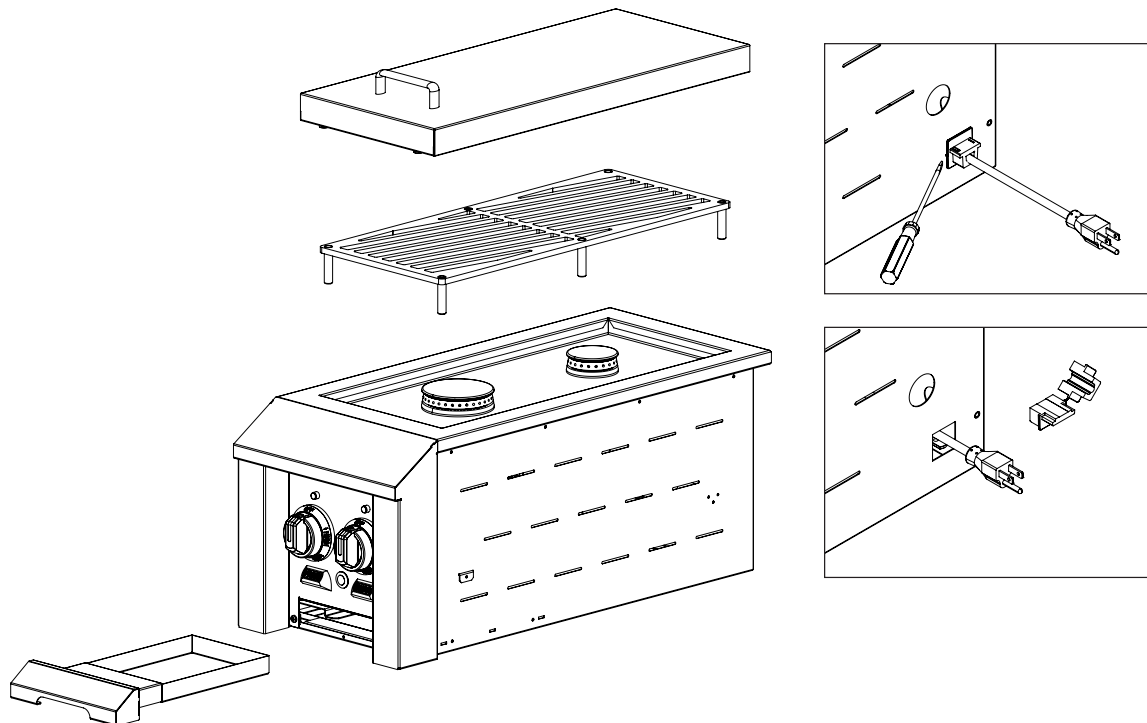



CART INSTALLATION *(continued)*

STEP 2

Locate the panels included with your kit. Mount all panels to the side burner using the provided Phillips screws. Install the sides first, then the rear panel.

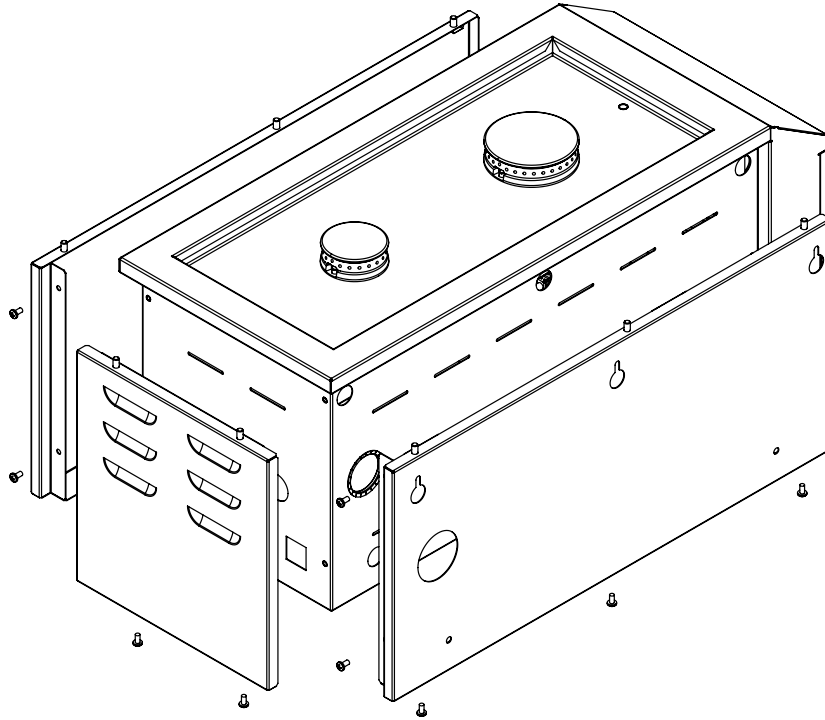

STEP 3

Remove the side shelf by removing the bolt at the rear bracket, and then removing the shelf. Now you can remove both side shelf brackets from the cart. Replace the large plug with the grommet as shown.

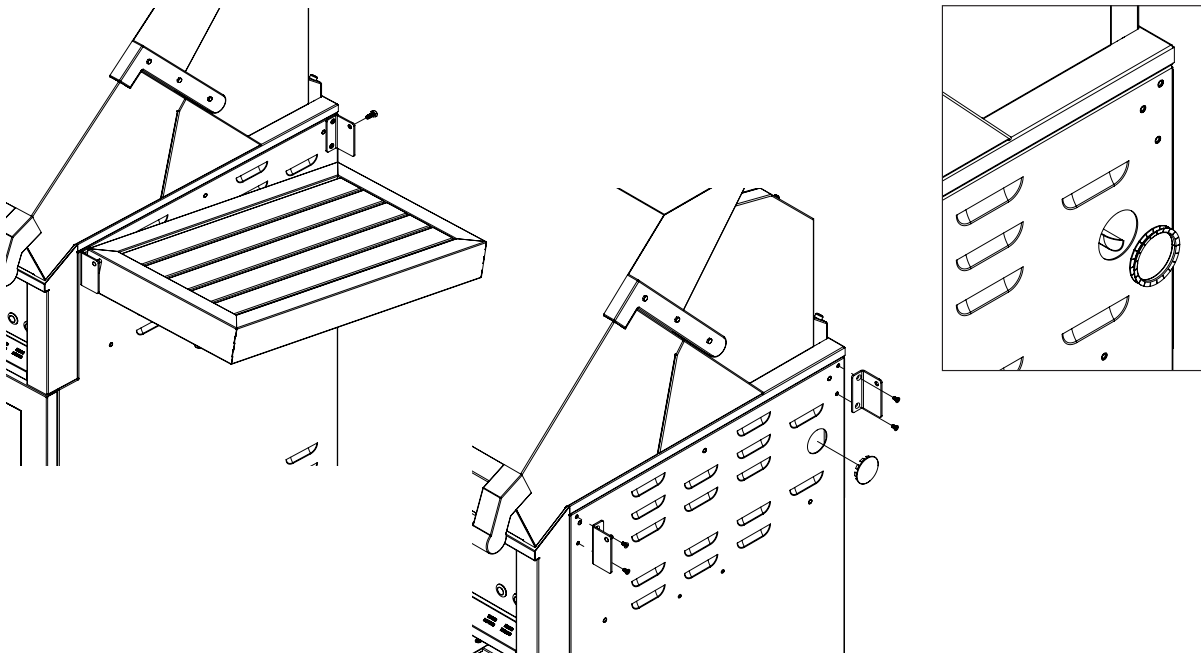

CART INSTALLATION *(continued)*



STEP 4

Remove the rear panel on the cart to access the grill's gas manifold inlet. Disconnect the regulator and all fittings from the inlet (LP shown).

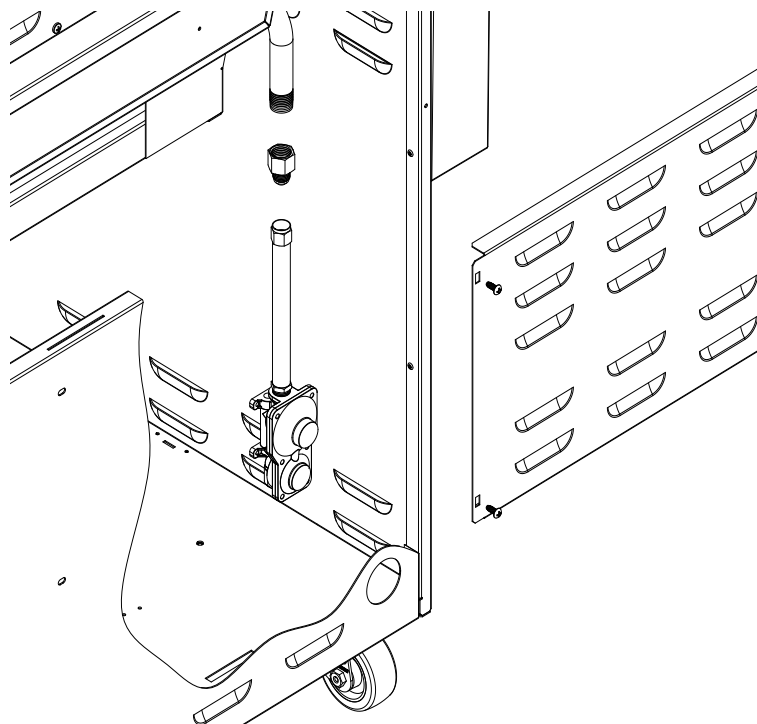

STEP 5

Install the interplumbing fittings as shown below (LP shown). Use appropriate thread sealant on all threaded pipe fittings. Compression fittings do not require thread sealant. Route the stainless steel flex hose as shown. You will notice the Side Burner regulator has been removed.

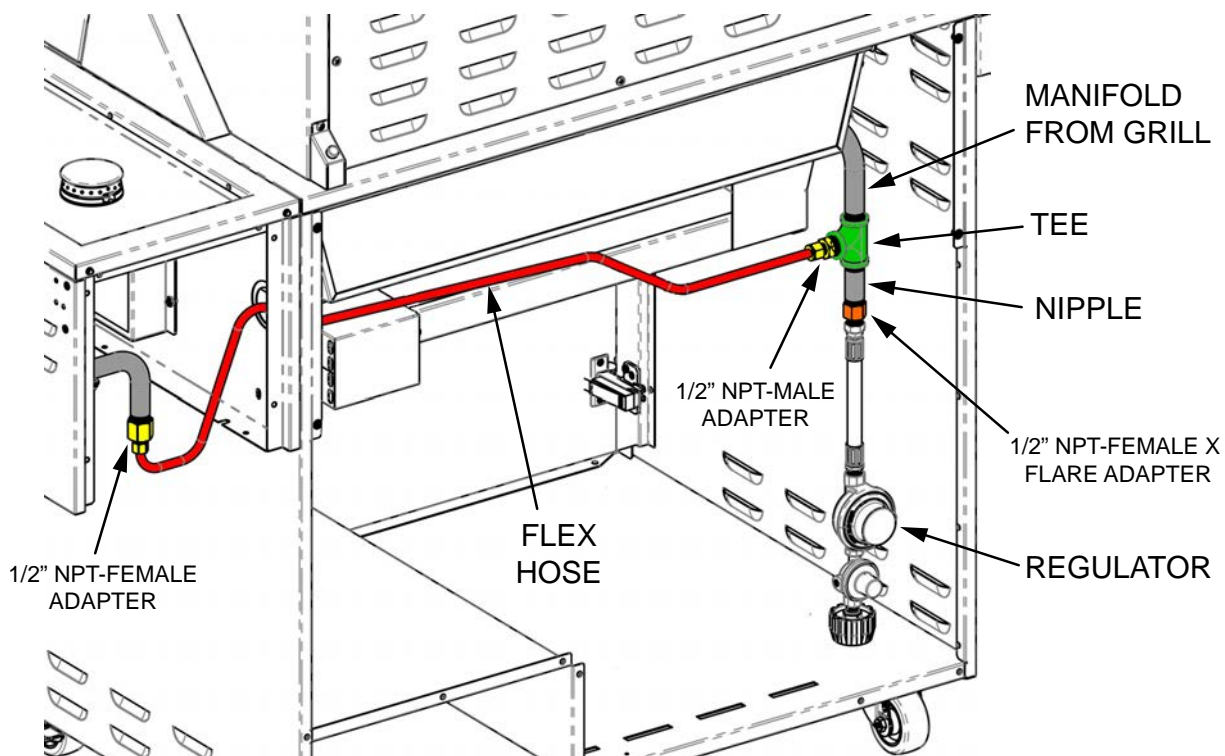



CART INSTALLATION *(continued)*

STEP 6

Mount the side burner to the right side of the cart using the 5 provided 1/4-20 hex bolts. Route the 3/8" diameter stainless-steel flex hose through the grommet hole to the side burner manifold inlet. Route the power cable from the side burner's electrical box, through the grommet hole, and plug into to the grill's electrical box (located on inside rear wall of cart).

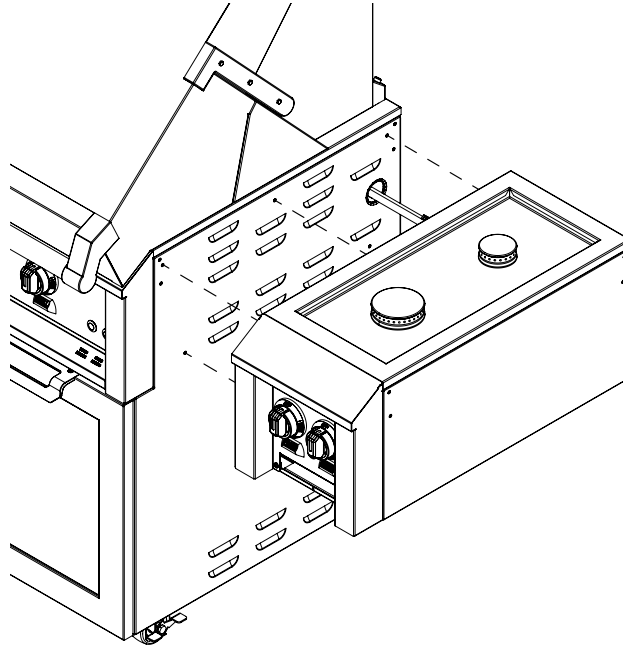

STEP 7

Reinstall the grate cover, grate, and drip pan onto the side burner. Mount the side shelf brackets and side shelf onto the side burner (if desired). Continue with other gas connections as necessary and be sure to check for gas leaks as per instructions in the manuals supplied with those appliances. Reinstall the rear cover onto the grill cart when done.

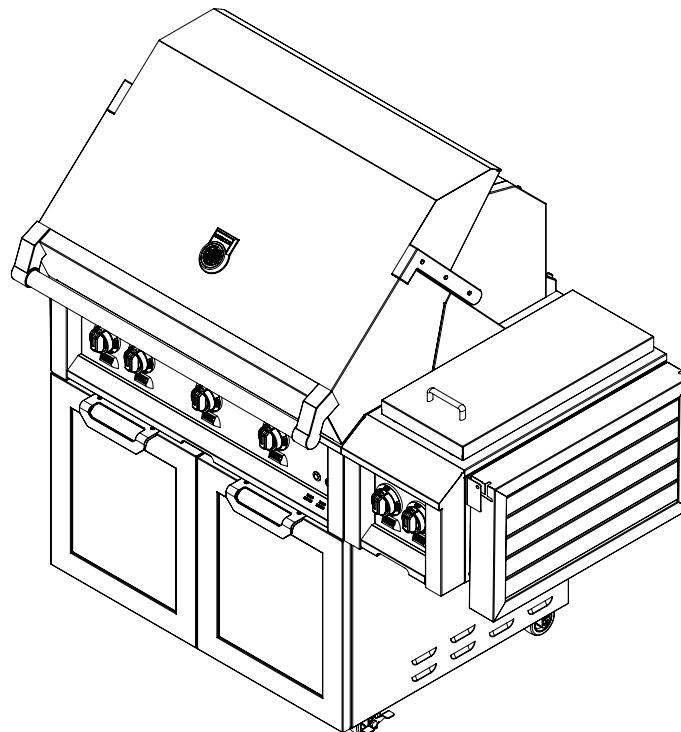

RETAIN THIS MANUAL FOR FUTURE REFERENCE



Hestan Commercial Corporation

3375 E. La Palma Ave.
Anaheim, CA 92806
(888) 905-7463