

HESTAN

F qwdrg'Y cm'Qxgp
MF Q52'('MF Q52/ZZ
Rct vu'Nku

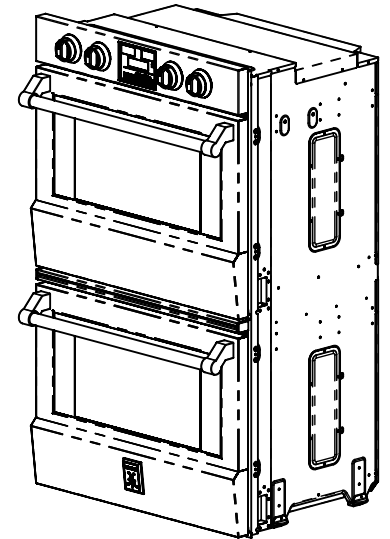

J gucp'Ego o gteknEqtrqtcvkqp
5597'G0Nc'Rem c'Cxg0
Cpcj glo .'EC"; 4: 28
*** :: † 27/9685**

TGVCKP'VJ KUHQ'T'HWWTG'TGHGTGPEG

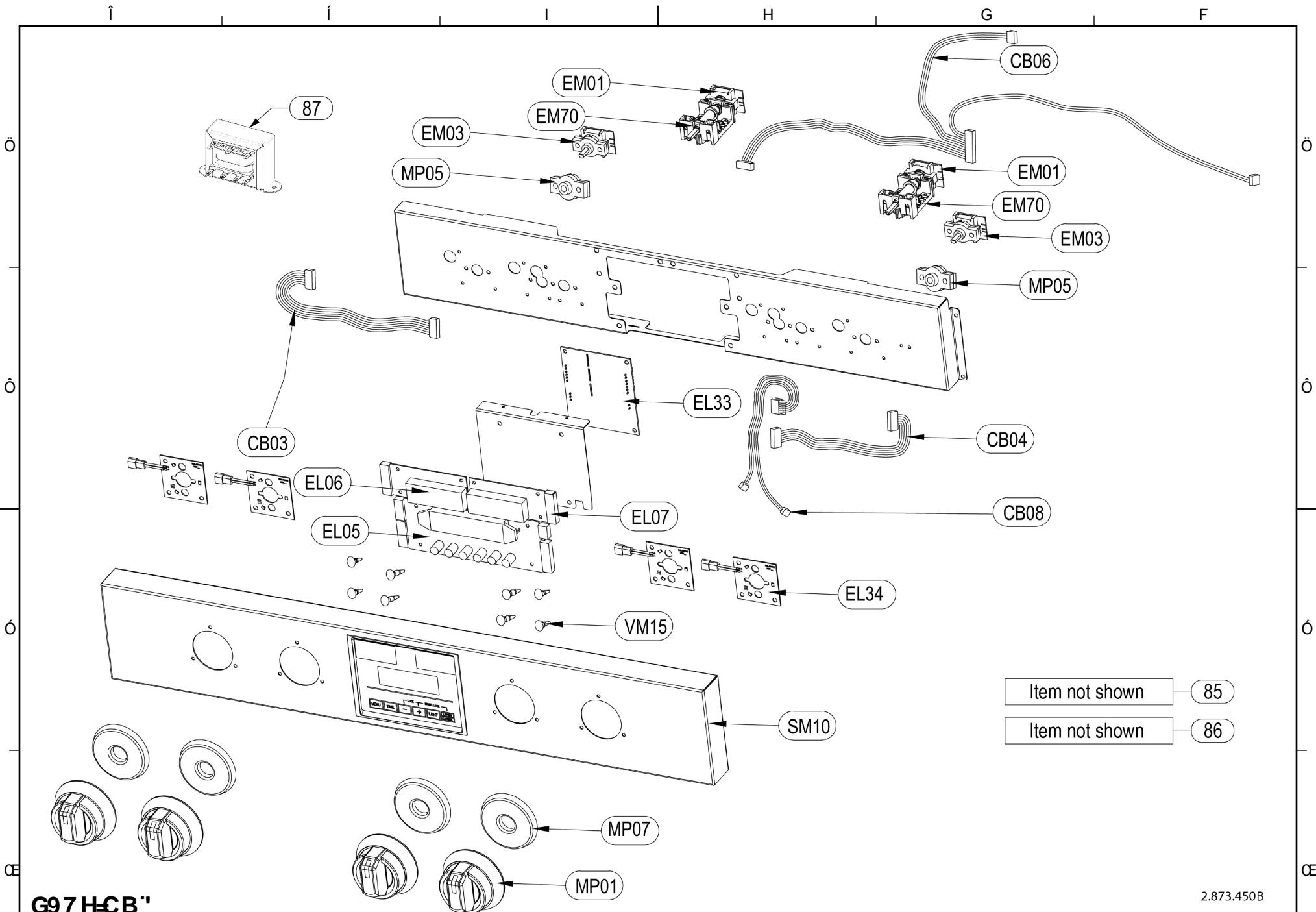

G97HCB'

2.873.450B

HESTAN

DFCDF-9H5FM
 PUAJEUVAUAPQAUOMTCEVITCEADOUUOMCOOAB
 UNVUOOCABUOUJGDESEYVOTBUUUAUUBUTQVCOCA
 CEYAUUTBYQPUIWAPQAYUQVCEAJOUTQUBPABUA
 P+@AQI(1.3.8880111)BVPQOUOMTCEVUUAABY
 OUBUAPOSSCOUOVUUPCOUWUUPYUQVCEAJOUVUUE

G9FJ79ZK5@@CJ9BZ8CI6@
 fP8C'\$/?'8C' \$!LL

?8C' \$!LL!G9FJ79

8
 HAUQA

DOUBLE OVEN PARTS LIST

KDO30 / KDO30-XX

20-Mar-2023

SECT. #	BALLOON #	HESTAN P/N	DESCRIPTION	NOTES
2	EM11	025507	BOTTOM HEATING ELEMENT, 3000W 240V	
2	EM12	025508	RING HEATING ELEMENT, 1300W 240V	
2	EM14	025509	THERMOSTAT, MANUAL RESET, NC155°C-16A BIPOLAR Ty62-R	
2	EM16	025510	THERMOSTAT, FIXED TEMP., 16A 70°C	
2	EM19	025511	MOTOR, FAN, 80K, RIGHT, 120V	
2	EM20	025512	FAN BLADE, SS, LEFT, 30"	
2	EM21	025513	FAN BLADE, SS, 30"	
2	GU03	025514	RING ELEMENT SEAL, FIBER, 27/30"	
2	GU06	025515	GASKET, FIBER, CEILING, 80K	
2	LM01	025516	THERMOSTAT BRACKET	
2	LM04	025517	UPPER COVER, BACK, 80K	
2	VM03	025518	SPACER, ELECTRONIC CONTROL	
2	VM04	025519	SCREW, FAN MOTOR, 80K	
2	VM08	025520	SPACER, CERAMIC, MAIN POWER CONNECTOR	
3	CB03	025521	WIRING, OVEN, 30" 80K, DISPLAY BOARD-DISPLAY	
3	CB04	025522	WIRING, OVEN, 30" 80K, DISPLAY BOARD-DISPLAY	
3	CB06	025523	WIRING, OVEN, 30" D80K, DISPLAY BOARD-PB LG.	
3	CB08	025524	WIRING, OVEN, 30" D80K, DISPLAY BOARD-SELECTOR	
3	EL05	025525	DISPLAY BOARD, CLOCK, WHITE, UL	
3	EL06	025526	DISPLAY BOARD, FUNCTION, WHITE	
3	EL07	025527	DISPLAY BOARD, TEMP., WHITE	
3	EL33	019678	LED DRIVER, HESTAN	
3	EL34	017612	LED MODULE, KNOB LIGHTING, HESTAN	
3	EM01	025530	SELECTOR, 0+8 POSITION, MULTIFUNCTION MODEL	
3	EM03	025531	SELECTOR, TEMPERATURE	
3	EM70	025532	COMMUTATOR, 8F+0 L20 7LA-8902XX, KNOB LIGHTING	
3	MP01	020663	KNOB, HESTAN	
3	MP05	025534	GUIDE, SELECTOR	
3	MP07	019744	LENS, DIFFUSER, HESTAN	
3	SM10	025536	CONTROL PANEL, FRONT, D80K, HESTAN	
3	VM15	025537	SPACER, DISPLAY	
3	85	025542	WIRING, OVEN, 30" D80K	
3	86	025543	WIRING, KNOB LIGHTING, D80K HESTAN	
3	87	016512	TRANSFORMER, 40VA, 120VAC TO 12/24V	
4	AS04	025538	OVEN DOOR BASE ASSEMBLY 80K, HESTAN	
4,5	CR01	025539	DOOR HINGE ASSEMBLY, 80K GAS/DF/IND.	END - Mar. 17, 2019
4,5		037650	DOOR HINGE ASSEMBLY, 80K GAS/DF/IND.	BEGIN - Mar. 18, 2019
4,5	MN01	020670	HANDLE, WALL OVEN/WARMING DRAWER	
4,5	MN03	000463	ENDCAP, HANDLE, LH, SM	
4,5	MN04	000704	ENDCAP, HANDLE, RH, SM	
4	SM11	025540	PANEL, OVEN DOOR & GLASS w/ BADGE (STAINLESS STEEL)	
4	SM11	022925-XX	KIT, OVEN DOOR, LOWER, WALL OVEN (COLOR)	SPECIFY COLOR
4	AC31	024252	SERVICE, LARGE HESTAN LOGO w/ RETAINING RINGS & TAPE	
5	SM12	025541	PANEL, OVEN DOOR & GLASS w/o BADGE (STAINLESS STEEL)	
5	SM12	022937-XX	KIT, OVEN DOOR, UPPER, WALL OVEN (COLOR)	SPECIFY COLOR

Color Extension (-XX)	Description
	Stainless Steel
-BK	Stealth - Black
-WH	Froth - White
-RD	Matador - Red
-YW	Sol - Yellow
-OR	Citra - Orange
-BG	Tin Roof - Burgundy
-PP	Lush - Purple
-BU	Prince - Blue
-GR	Grove - Green
-GG	Pacific Fog - Graphite Gray
-TQ	Bora Bora - Turquoise



HESTAN
HESTAN CORPORATION
 10000 W. 10TH AVENUE
 DENVER, CO 80231
 TEL: 303.440.1111
 FAX: 303.440.1112
 WWW.HESTAN.COM

G9FJ=79ŽK5@@CJ9Bž8CI6@
 fP8C'\$/ '8C' \$!LL

?8C' \$!LL!G9FJ=79

8
 IAUQ