

## NOTICE:



EYE PROTECTION  
REQUIRED



GLOVES  
RECOMMENDED

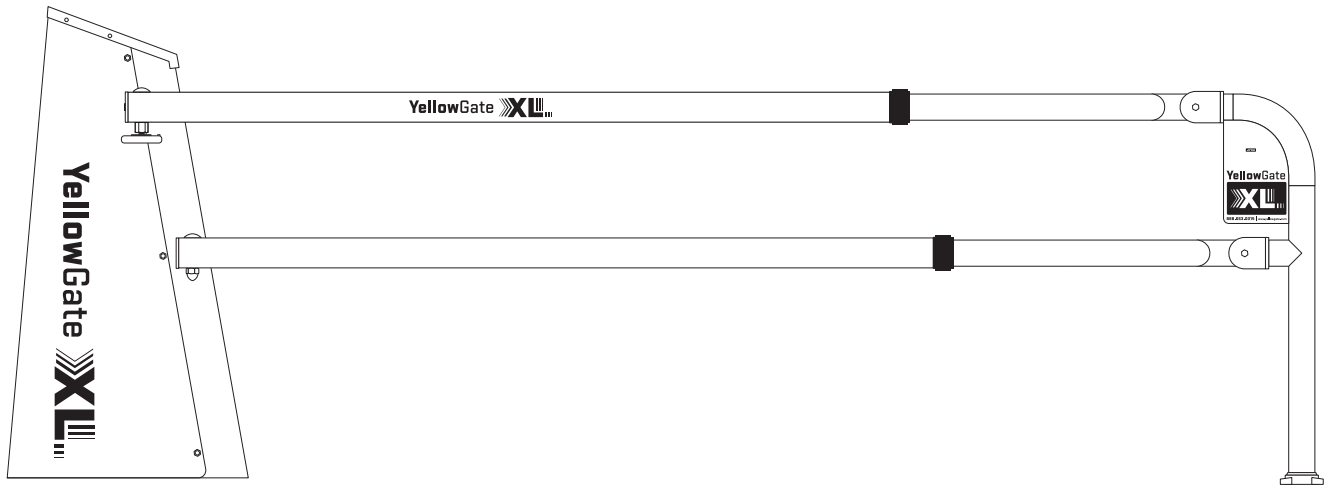

Part No. 108490-XL

## IMPORTANT NOTES AND SPECIFICATIONS



Read carefully and understand all instructions before starting installation. Adhere to all instructions in manual.

**FAILURE TO FOLLOW ALL INSTRUCTIONS MAY RESULT IN SERIOUS PERSONAL INJURY OR DEATH**

Prior to installation, ensure that mounting surface is adequate to support equipment and opening size is appropriate.

Equipment should not be altered or modified from its original design without consultation with the manufacturer.

Equipment which is damaged or becomes damaged during use, handling, or shipping should be set aside and not used.

Do not use impact wrenches to tighten fasteners. Doing so may cause damage to the equipment and its safe operation.



**WARNING!:** Keep hands away from potential pinch points and moving parts during operation.

This product and/or its components may be covered by one or more patents. For more information, go to [www.saferack.com/patents](http://www.saferack.com/patents)



**WARNING!:** This product can expose you to chemicals including cadmium, which is known to the State of California to cause cancer, and/or birth defect or other reproductive harm.

For more information, go to [www.p65warnings.ca.gov](http://www.p65warnings.ca.gov)



Contact our Customer Service team for help.

Call: **888-663-0015** (toll free)

Visit: **[www.yellowgate.com](http://www.yellowgate.com)**

**Scan QR** code to view a video of YellowGateXL assembly

# INTRODUCTION

YellowGateXL is the most adjustable barrier gate available. This gate, at 42 inches high, easily adjusts in the field from 6ft to 12ft with 90 degrees of easy action movement.

The patent pending system provides field adjustable tension and maintenance free closure.

## SYSTEM DESIGN

### OSHA Regulation:

- OSHA Compliant 1910.29 (b) (1)
- Aluminum extruded. Laser precision manufactured 1910.29 (b) (3) and (4)
- Maintenance free ergonomic design 1910.144 (a) (3)

## TOOLS NEEDED FOR INSTALLATION

### REQUIRED FOR INSTALLATION



2 People Required for Assembly (min.)

Open End Wrench (15/16")



Socket and Ratchet (7/16", 1/2", 9/16")

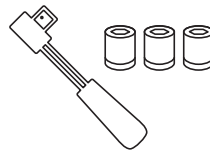

Rubber Mallet

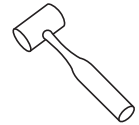

Anti-seize or Bolt Lubricate



(3/16") Allen Wrench



Tape



Electric Drill with 5/16" Hex Driver



(x6) 1/2" Concrete Anchors

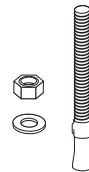

Thread Lock Compound



## PARTS LIST

(x1) Mounting Base Cover

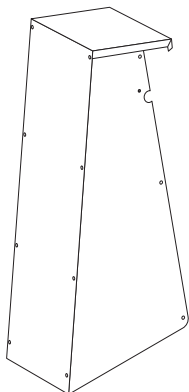

(x1) Mounting Base

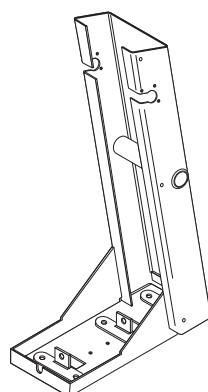

(x1) Support Post

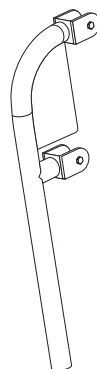

(x4) Short Receiver Arm

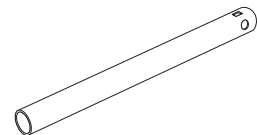

(x4) Long Receiver Arm

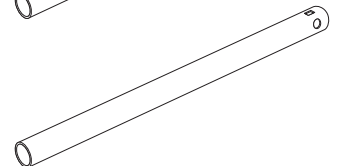

(x2) Extension Arm Assembly

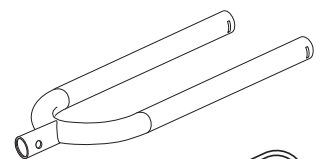

(x1) 5/16" Extra Long Allen Wrench



# PARTS LIST

(NOT ACTUAL SIZE)

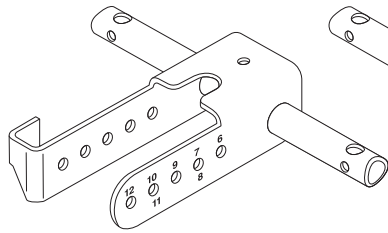

(x1) Lever Arm

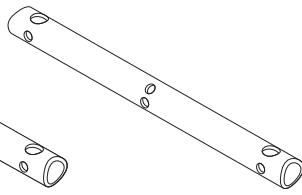

(x1) Lower Pivot arm



(x2) 5/8" Zinc Nut



(x2) 1/2" Nylock Nut



(x2) Shackles



(x4) Bronze Bushing



(x2) 1/2" Bolt

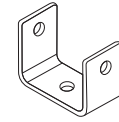

(x1) Lever Arm Spring Yoke

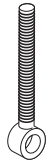

(x1) Galvanized Rod Eye



(x2) Lower Pivot Bushing



(x2) Upper Pivot Collar



(x2) 3/4" Acorn Nut



(x12) 5/16" Zinc Bolt



(x4) 3/4" S/S Carriage Bolt



(x2) Stop Pad



(x4) Receiver Arm Sleeve



(x2) 3/8" SS Nyloc Nut



(x2) 3/8" SS Washer



(x4) Gripper Washer



(x4) Rubber Gripper



(x4) Extension Rail Bushing



(x4) 3/8" Black Oxide Bolt



(x2) 3/8" x 3 3/4" SS Hex Head Bolt



(x4) Extension Rail Nut Plate

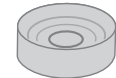

(x4) Tool Alignment Guide



(x2) 3/8" Split Lock Washer



(x2) 3/8" Nut



(x2) 3/8" Bolt



(x4) 3/4" Clamping Collar

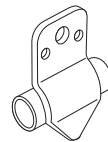

(x1) Lower Adjustment Collar

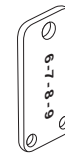

(x1) Lower Spring Extension

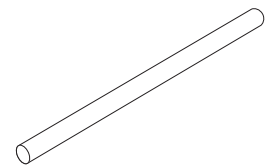

(x1) Spring Adjustment Rod



(x4) Receiver Tube Cap



(x1) Rubber Grommet



(x1) Plastic Hole Plug



(x2) Extension Arm Cap



(x2) Extension Rail Spanner Bushing



(x1) Lock Pin with Lanyard

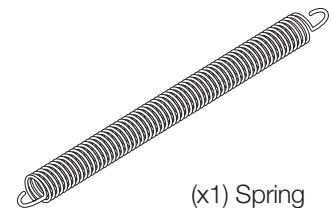

(x1) Spring Assembly



(x1) Support Post Bumper Cover



(x1) Support Post Insert

# STEP 1 YELLOWGATE XL ASSEMBLY

- Assess the location the gate is to be installed. Estimate the gate length & ensure there are no obstructions, including over head.

**Warning:** Gate material is conductive to electricity.

- Unpack YellowGateXL components, verify you have all the parts required for this product before beginning.
- Next locate YGXL base.
- Remove the (x6) 5/16" bolts (3 each side) and remove the cover from the mounting base and set it aside
- Remove the two upper right and left pivot collars.
- Position post in desired location & bolt in place using 1/2" concrete anchors or similar. The post may need to be moved for Step 9 if there is interference, such as a wall behind the post.
- Be sure to verify final gate length before anchoring, by measuring from the center of the pivot point of the top receiver, to the support post.

Reference Illustration 1 in Step 8.

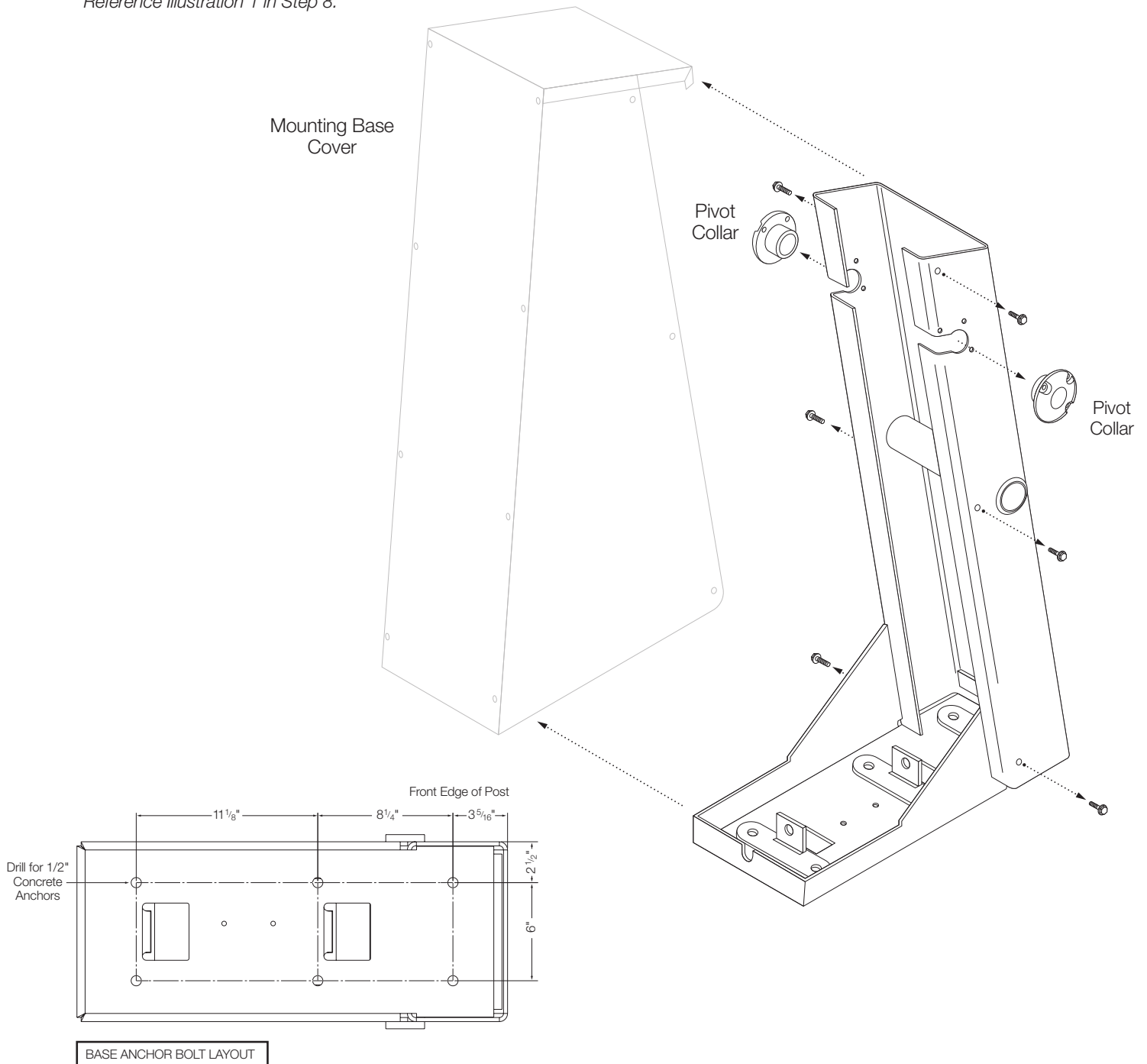

## STEP 2 ASSEMBLING THE LEVER ARM BRACKET

- Locate lever arm bracket.
- Position the spring yoke in the adjustment hole for the desired gate opening. When tightening the nuts make sure the yoke continues to rotate but minimize any side play.

**Note:** the numbers in the illustration below. Each number represents the length of the desired gate. The gate length can be measured from the pivot point of the top rail to the support post.

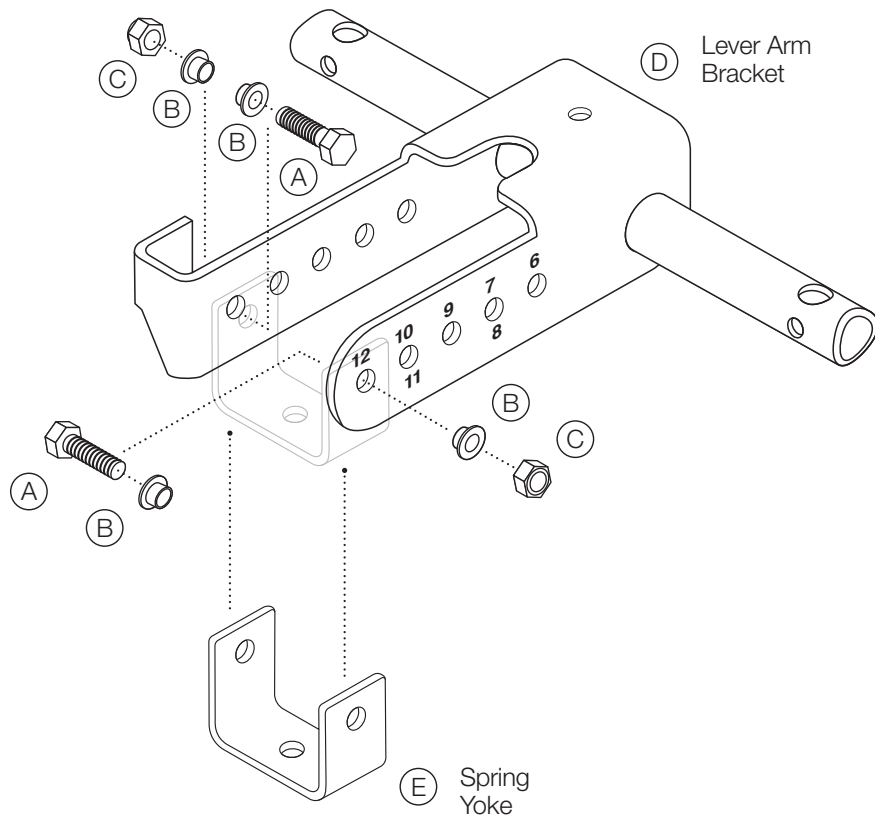

### Hardware needed:

- A** (2) 1/2" x 1 3/4" Bolt
- B** (4) Bronze Bushing
- C** (2) 1/2" Nylock Nut
- D** (1) Lever Arm Bracket
- E** (1) Spring Yoke

## STEP 3 INSTALLING LEVER ARM BRACKET AND LOWER PIVOT TUBE

- Place the lever arm bracket in the top section slots of the mounting base.  
**Note:** Orientation in illustration below.
- Slide a pivot collar onto each end of the lever arm pivot tube as shown, and reinstall the mounting bolts. Do not over tighten bolts.
- Next add both the right and left lower pivot bushings into the holes below the lever arm assembly, then insert lower pivot tube.

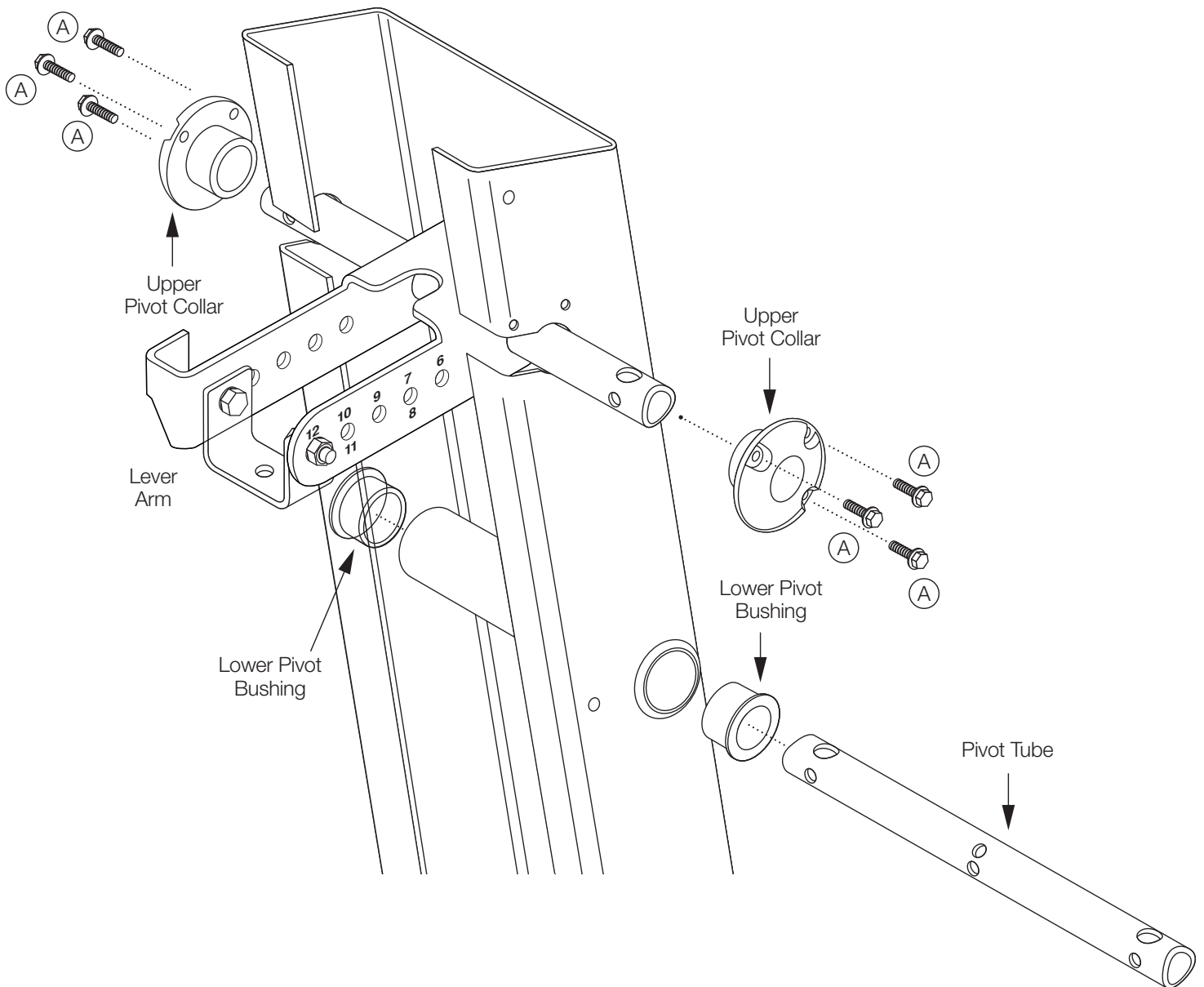

**Hardware needed:**

**A** (6) 5/16" Zinc Bolt

## STEP 4 LOWER SPRING ADJUSTMENT INSTALLATION

- There are two initial adjustment points for the lower spring adjustment yoke. **NOTE:** The two holes in the bottom of the post base. The hole closest to the back of the post is used for gates 6-11ft, while the hole to the front is for 12ft gates (see Illustration 1). This is a starting point & additional adjustment may be needed.
- Begin by sliding the spring adjustment rod into the first hole, followed by adding a clamping collar, lower spring adjustment yoke and an additional clamping collar. Slide the adjustment rod through the next mounting bracket hole. Ending by adding clamping collars to both ends of the spring adjustment rod, on the outer portion of the support brackets as shown below.
- Tighten clamping collars once spring adjustment yoke is placed in the correct and final position.

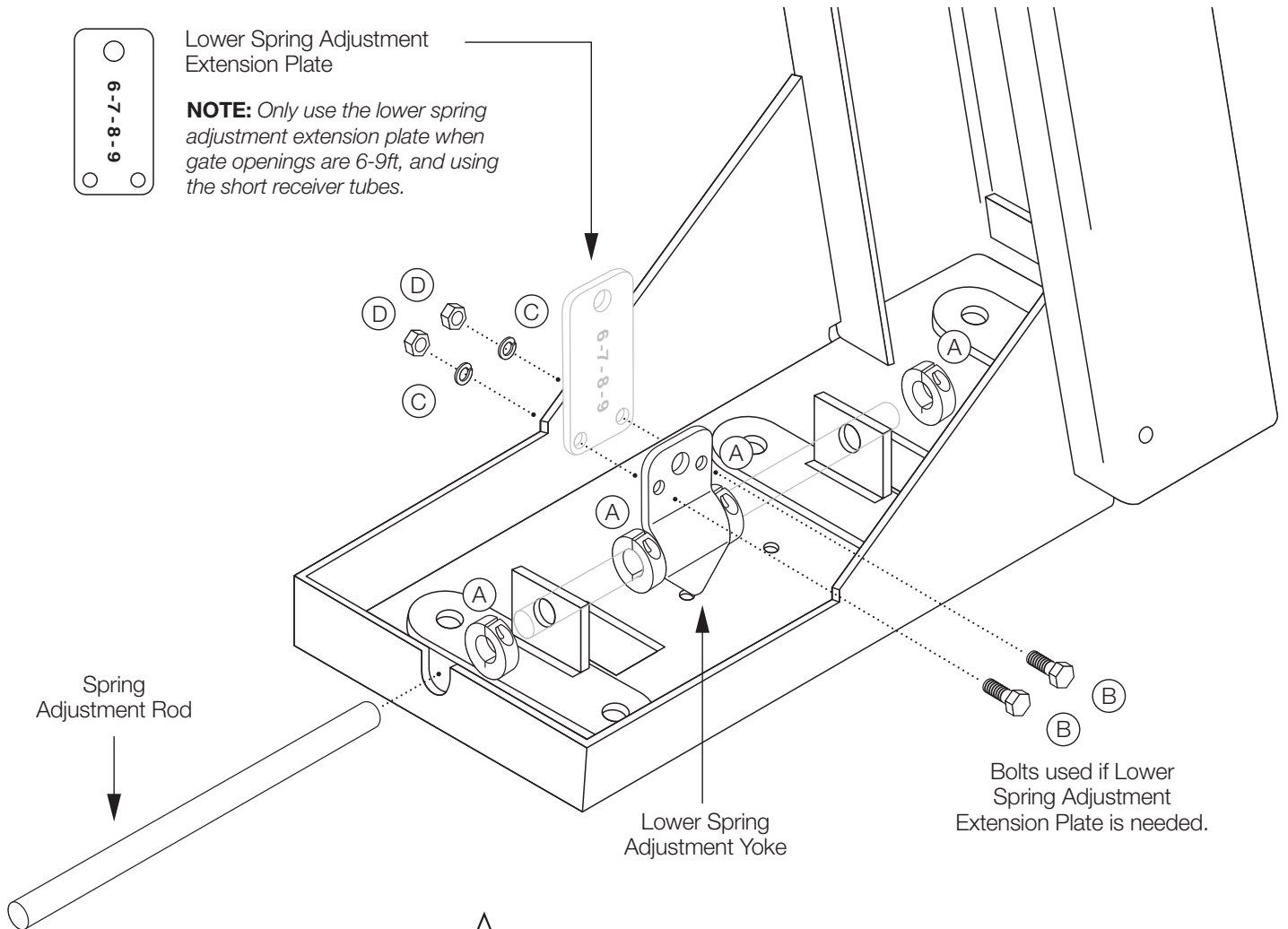
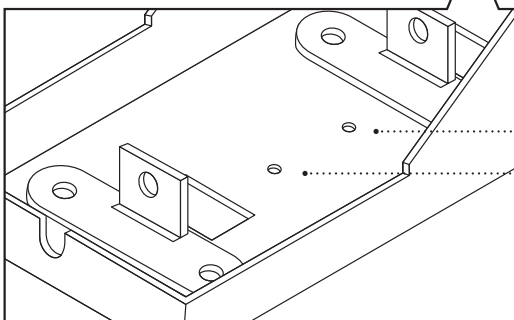

Illustration 1



**NOTE:**  
 ..... 12ft expansion  
 ..... 6-11ft expansion

**Hardware needed:**

- A** (4) 3/4" Clamping Collar
- B** (2) 3/8" Bolt
- C** (2) 3/8" Split Lock Washer
- D** (2) 3/8" Nut

## STEP 5 INSTALLATION OF RECEIVING ARMS

- Select the appropriate receiver arms. Use the long receiver for 9ft & over. Short receivers for under 9 ft.
- Install the receiver end caps using a rubber mallet.
- Next install the four receiver tubes, starting with the lower one on each side of the pivot tube & lever arm, using the labeled tubes for the top rail. Secure each receiver arm in place using the 3/4" carriage bolts supplied. Use the acorn nuts for the lower arms & the stop pads for the upper. Apply a small amount of thread lock to each bolt.
- Align the square hole of the receiver tube with the larger hole in the pivot tubes. Also align the hole in the carriage bolt with the smaller hole of the pivot tube.

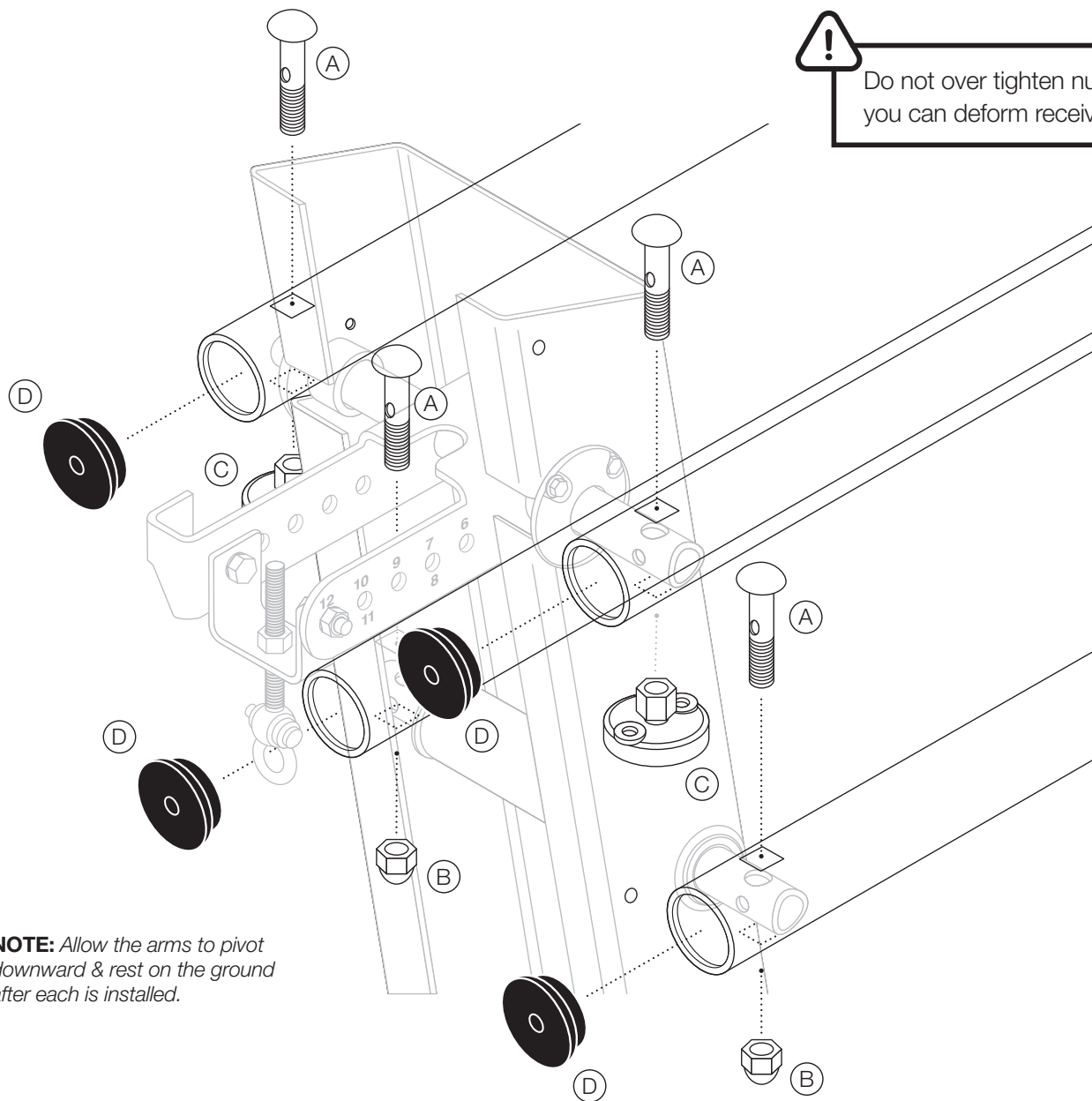

**NOTE:** Allow the arms to pivot downward & rest on the ground after each is installed.

### Hardware needed:

- A** (4) 3/4" S/S Carriage Bolt
- B** (2) 3/4" Acorn Nut
- C** (2) Stop Pad
- D** (4) Receiver End Caps



## STEP 6 EXTENSION ARMS

---

- Locate the extension arms, and **proceed to Step 7** to install parts needed to connect rails together.

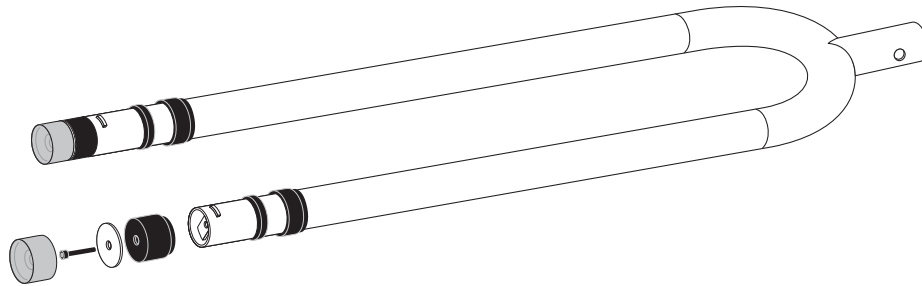

**Proceed to Step 7  
before connecting rails**

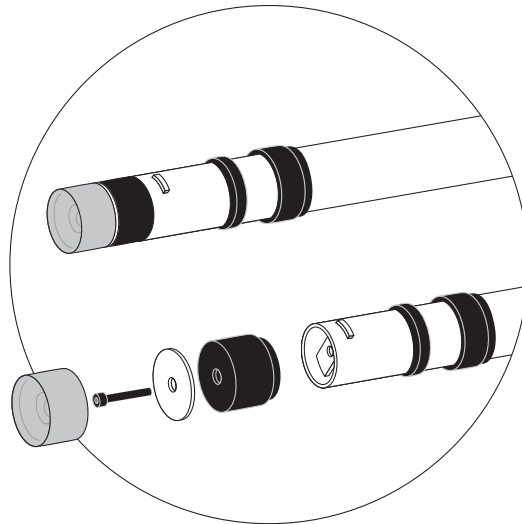

**Hardware needed:**  
A (2) Extension Arms

## STEP 7 INSTALLING PARTS TO CONNECT EXTENSION ARMS

- Next assemble the extension rails.
- Place the receiving arm sleeve and rail bushing onto the extension arms first.
- Place the insert nut into the extension arm slots. Next screw the rubber gripper, gripper washer, and 3/8" black oxide bolt into the insert nut.
- Place the tool guide over the head of the bolt, and wrap tape around it, joining it to the gripper and washer, to hold it in place during final assembly.
- Repeat this for each extension arm.

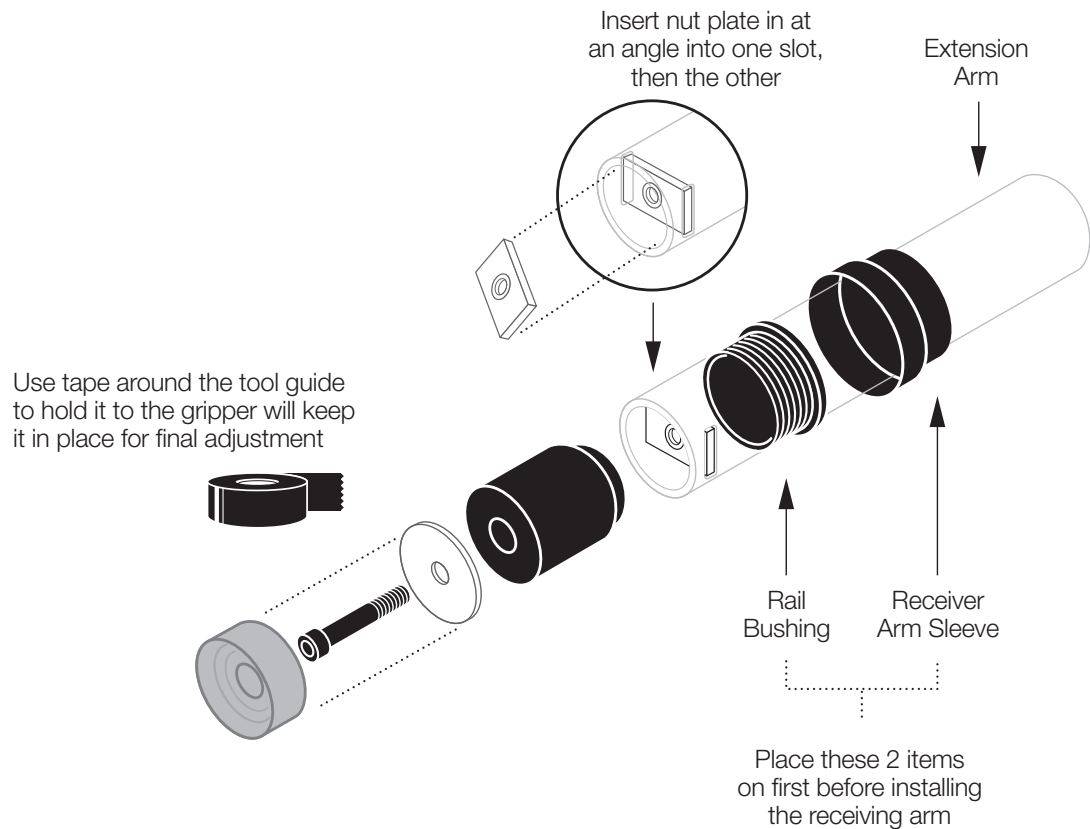

Order of parts assembly

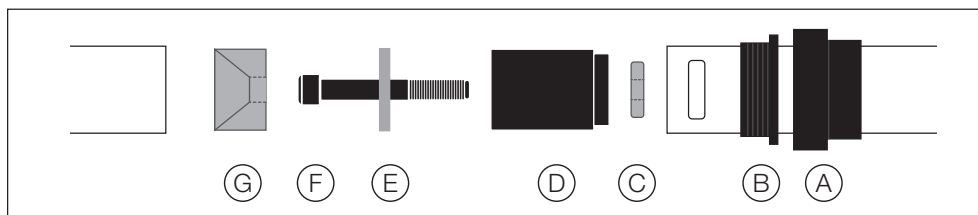

Side View

Parts fully assembled

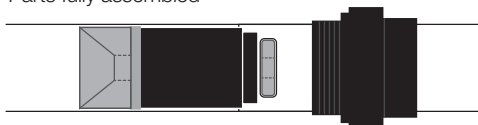

### Hardware needed:

- A** (4) Receiver arm sleeve
- B** (4) Rail bushing
- C** (4) Insert Nut
- D** (4) Rubber gripper
- E** (4) Gripper washer
- F** (4) 3/8" x 3" Black oxide allen head bolt
- G** (4) Tool alignment guide

## STEP 8 INSTALLING SUPPORT POST

- Slide an extension arm into each of the upper & lower receiver tubes and leave loose.
- Locate the support post for your YGXL, and assemble as shown below.
- Once the support post is installed, adjust the gate opening size by sliding the extension arms in the receivers, taking a measurement from the pivot point of the top receiver to the support post.
- Adjust the support post so that it is perpendicular to the ground.

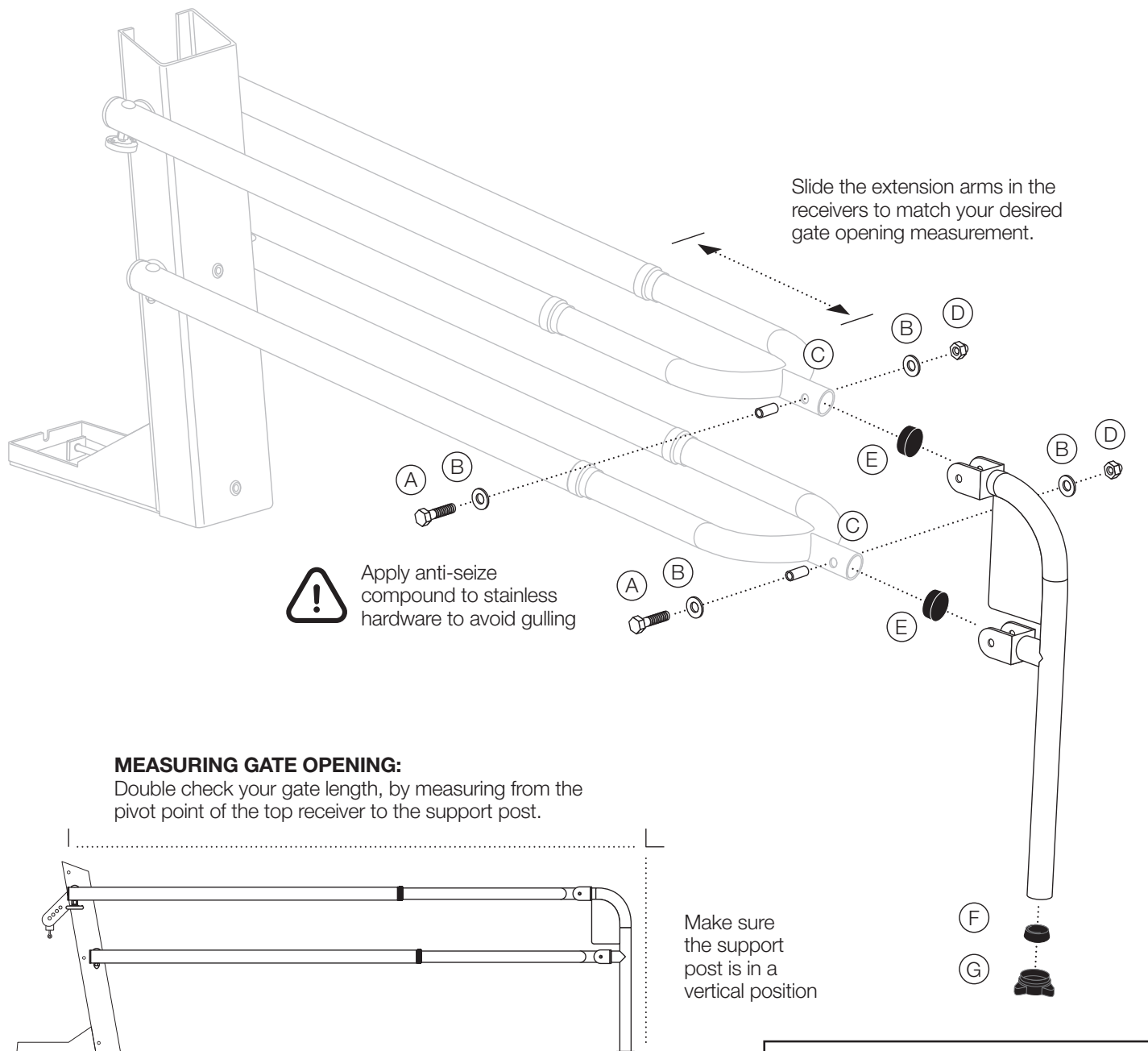

Illustration 1

### Hardware needed:

- A** (2) 3/8" S/S Bolt
- B** (4) 3/8" S/S Flat washer
- C** (2) Spanner bushing
- D** (2) 3/8" S/S Nylock nut
- E** (2) Extension arm caps
- F** (1) Support Post Insert
- G** (1) Support Post Bumper Cover

## STEP 9 SECURING EXTENSION ARMS

---

- Using the supplied allen wrench, tighten the expansion bolt on the ends of each extension arm to lock the rails in place to the desired gate length.

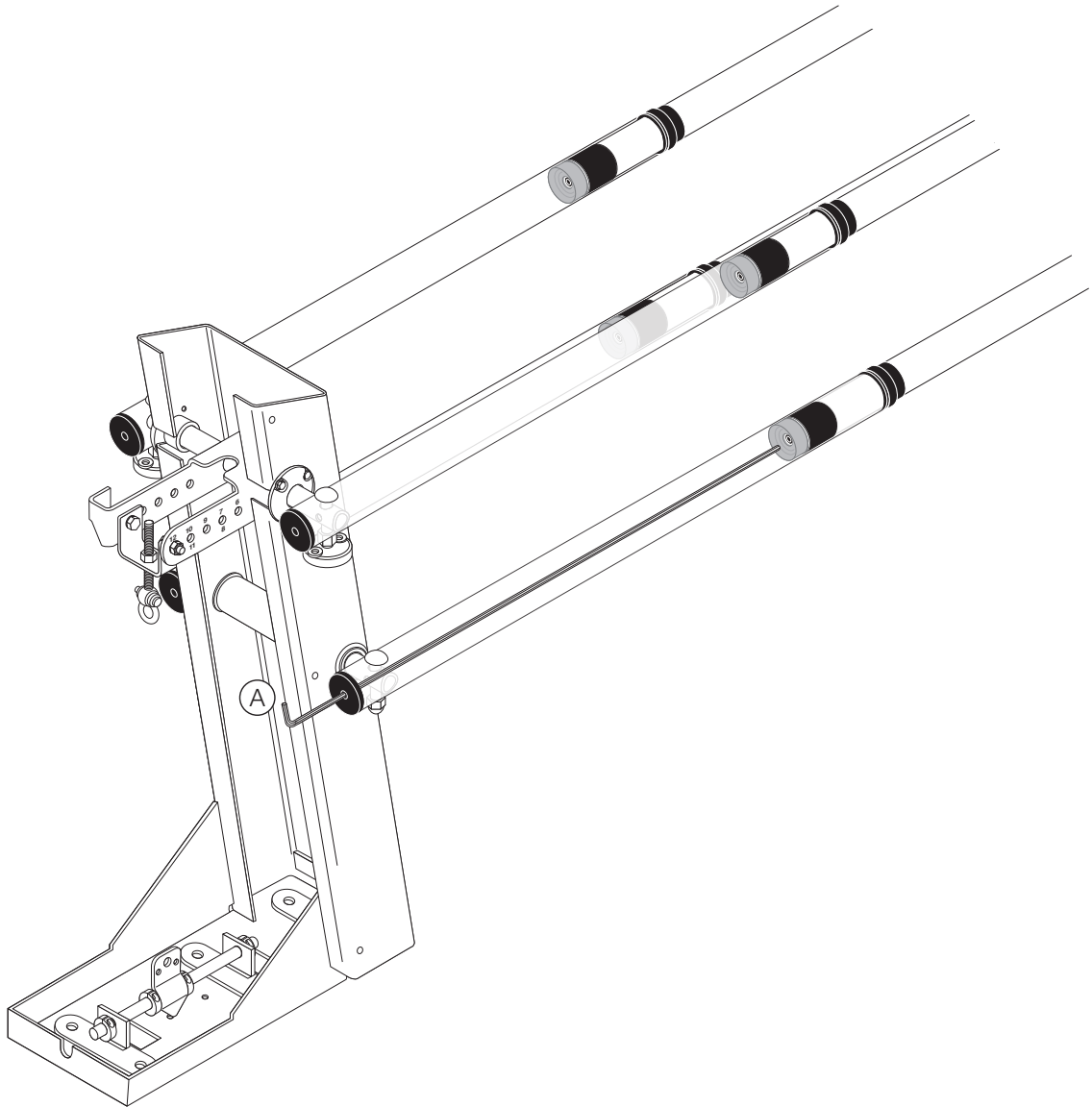

**Hardware needed:**

**A** (1) Allen Wrench

## STEP 10 RAISING THE GATE & INSTALLING THE SAFETY PIN

- Install rubber grommet in pin lock hole. Install plastic hole plug in the bottom hole in the front of post.
- Raise the gate to the vertical open position. This step may require two people.
- While in the raised position, insert the locking pin to safely store the gate in position.
- Once unit is securely pinned, install lanyard using the supplied self tapping screw. Placing the screw approx. 1" - 2" above locking hole using an electric drill & 5/16" hex driver.

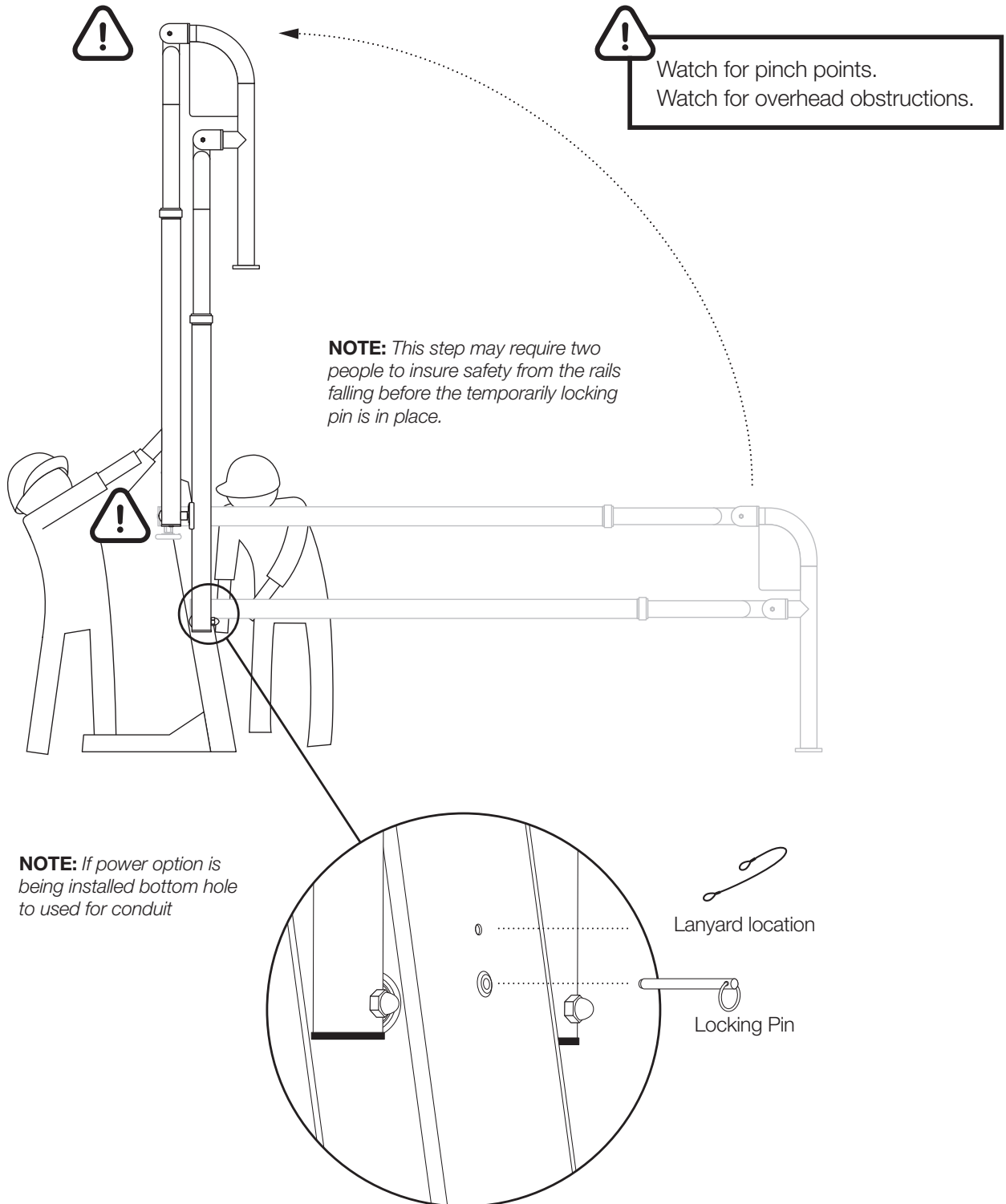

## STEP 11 ATTACHING THE SPRING ASSEMBLY

- Install the lift spring assembly by first connecting it to the lower spring adjustment yoke at the bottom of the post base.  
**Note:** For gates 6-9 ft., the extension plate will be required and connected to the lower spring adjustment yoke with the two 3/8" diameter bolts.
- Next, connect the spring assembly at the top to the rod bolt, which is connected to the upper spring yoke.
- Lift the rod bolt up and into the spring yoke as shown.
- Thread on the 5/8" nuts down 2"- 3".

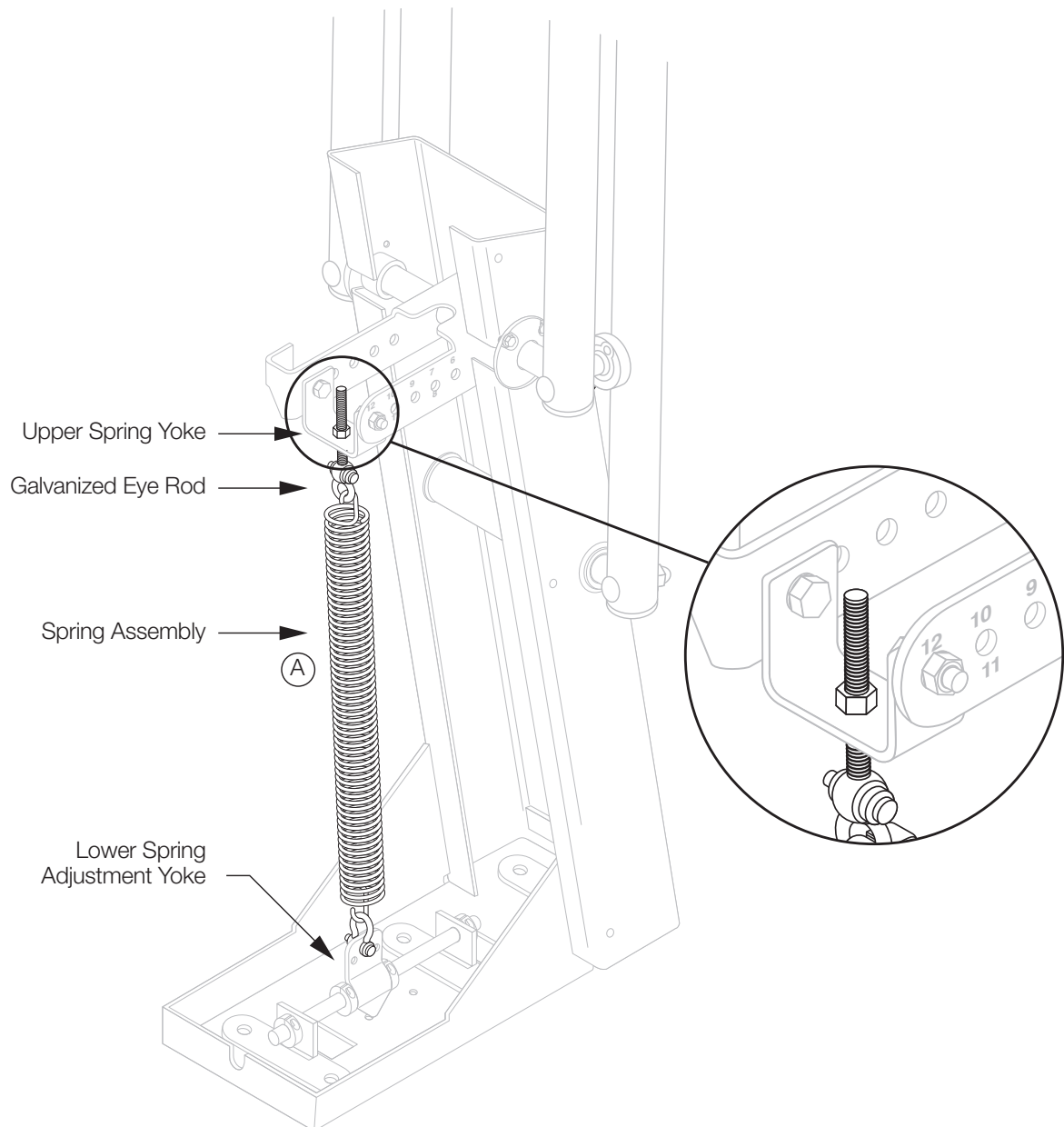

### Hardware needed:

- A** (1) Spring Assembly
- B** (2) 5/8" Nut
- C** (1) Galvanized Eye Rod

## STEP 12 ADJUSTING SPRING TENSION

- Remove the lock pin & lower the gate supporting as it descends.  
Note, the gate should easily remain on the ground yet not fall swiftly during lowering.
- Once proper tensioning has been achieved, run the second 5/8" nut down as a jam nut to lock the adjustment in place.
- Check to ensure all fasteners are properly tightened before proceeding to the next step.

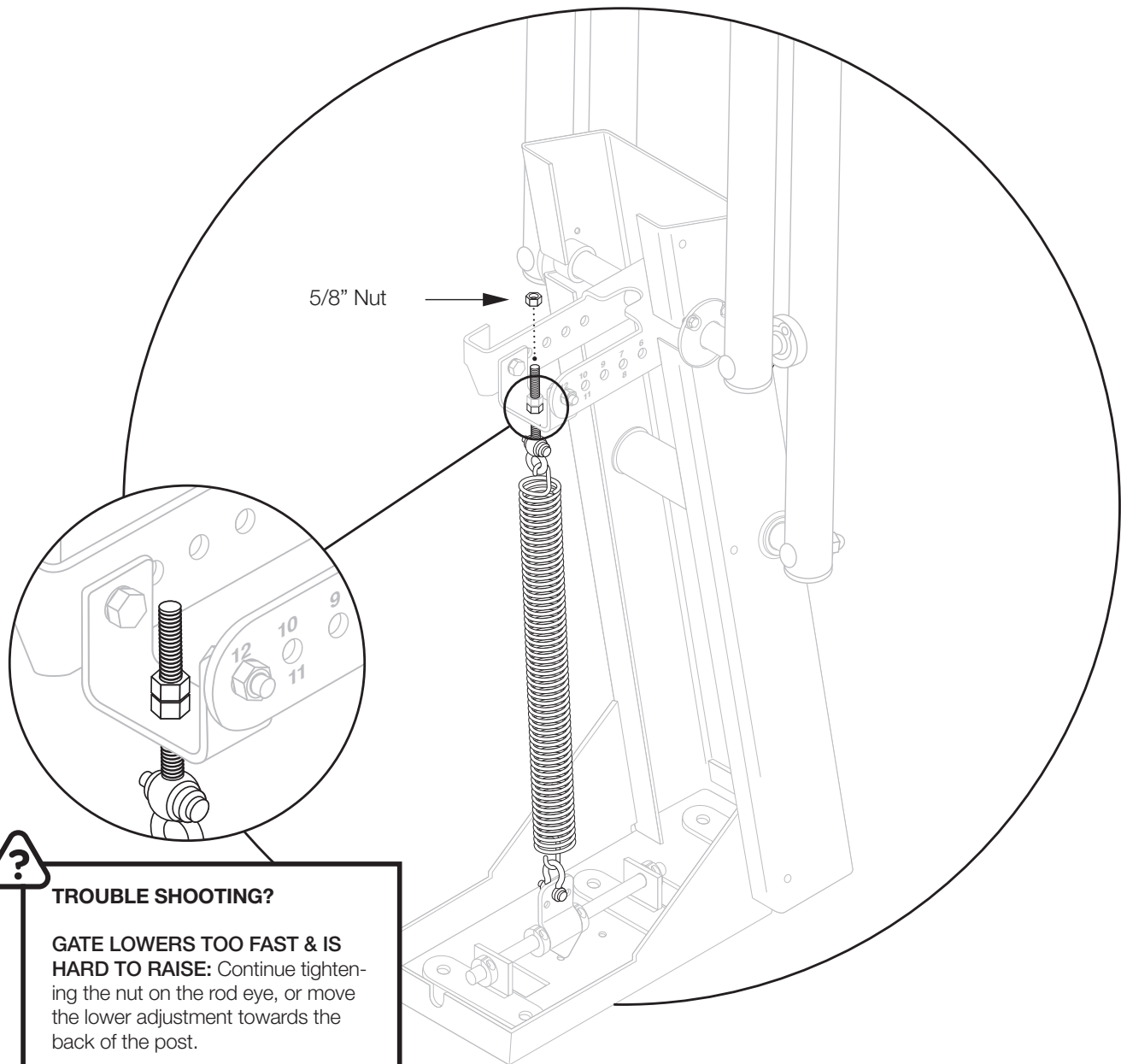

### TROUBLE SHOOTING?

**GATE LOWERS TOO FAST & IS HARD TO RAISE:** Continue tightening the nut on the rod eye, or move the lower adjustment towards the back of the post.

**GATE DOESN'T STAY ON THE GROUND WHEN LOWERED:** Loosen the nut on the rod eye, or move the spring yoke one hole towards the pivot tube.

**GATE DOESN'T STAY IN THE FULL OPEN POSITION:** Move the lower adjustment clevis forward to remove any slack in the spring, or move the spring yoke towards the pivot tube.

**NOTE:** On a 12 ft gate opening the spring may be slightly slack at full open position but will not fall.

## STEP 13 REPLACING THE BASE COVER

- Tilt the back of the cover upward & drop the front lip down over the post.
- Now rotate the cover downward
- Secure using the supplied fasteners.

