

HINGE CONFIGURATION FOR PERPENDICULAR GATE MOUNTING
SCALE: 1:1

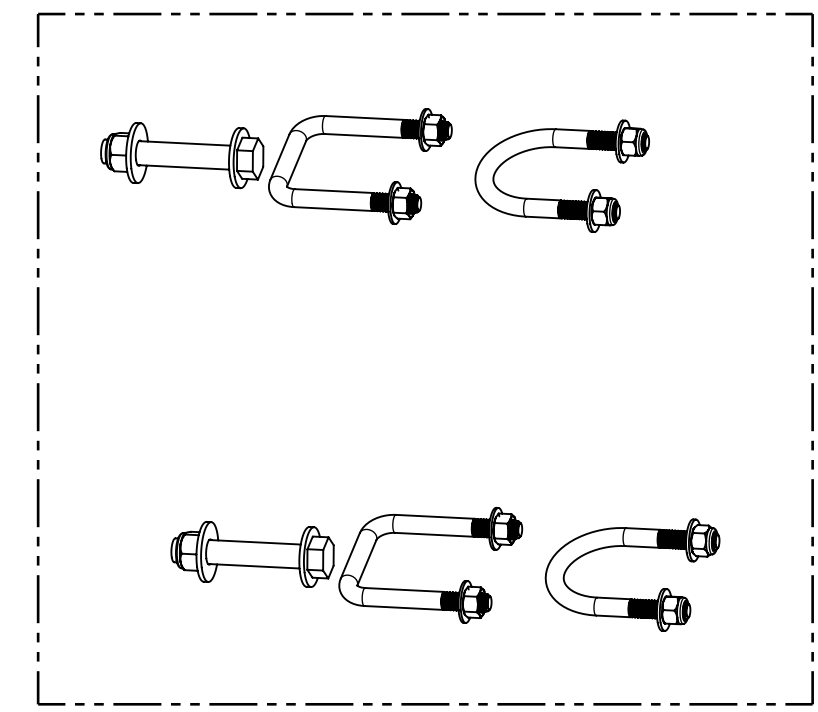

ITEMS CONTAINED IN MOUNTING HARDWARE KIT

NOTE: SELECT APPROPRIATE STYLE OF FASTENER TO FIT STRUCTURE FOR MOUNTING OF GATE

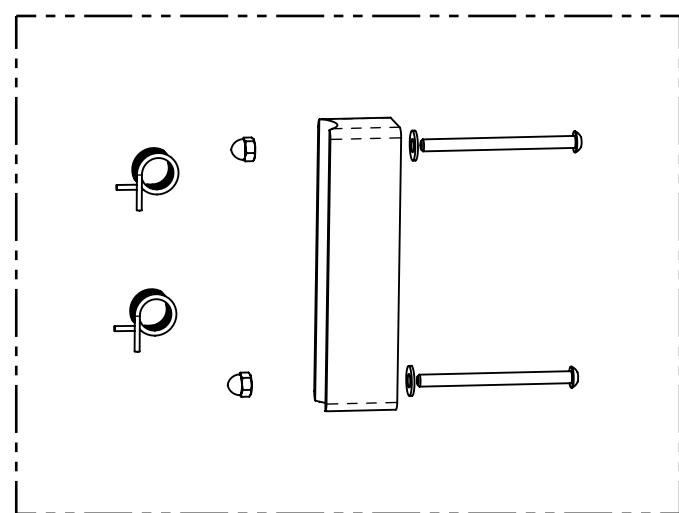

ITEMS CONTAINED IN PERPENDICULAR MOUNTING KIT

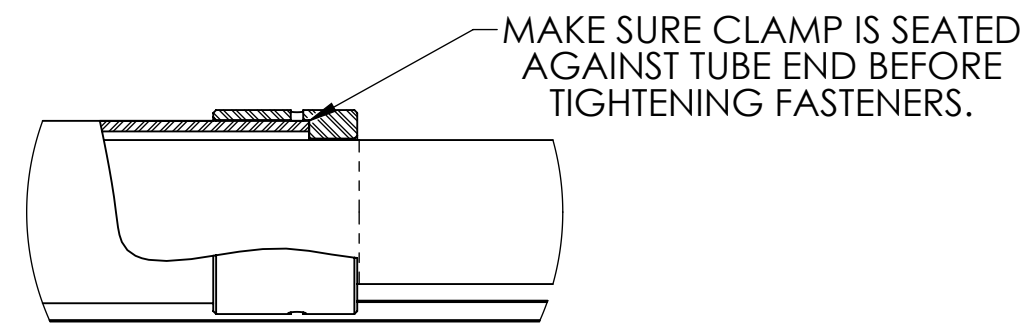

DETAIL A
SCALE: 1:2

MAKE SURE CLAMP IS SEATED AGAINST TUBE END BEFORE TIGHTENING FASTENERS.

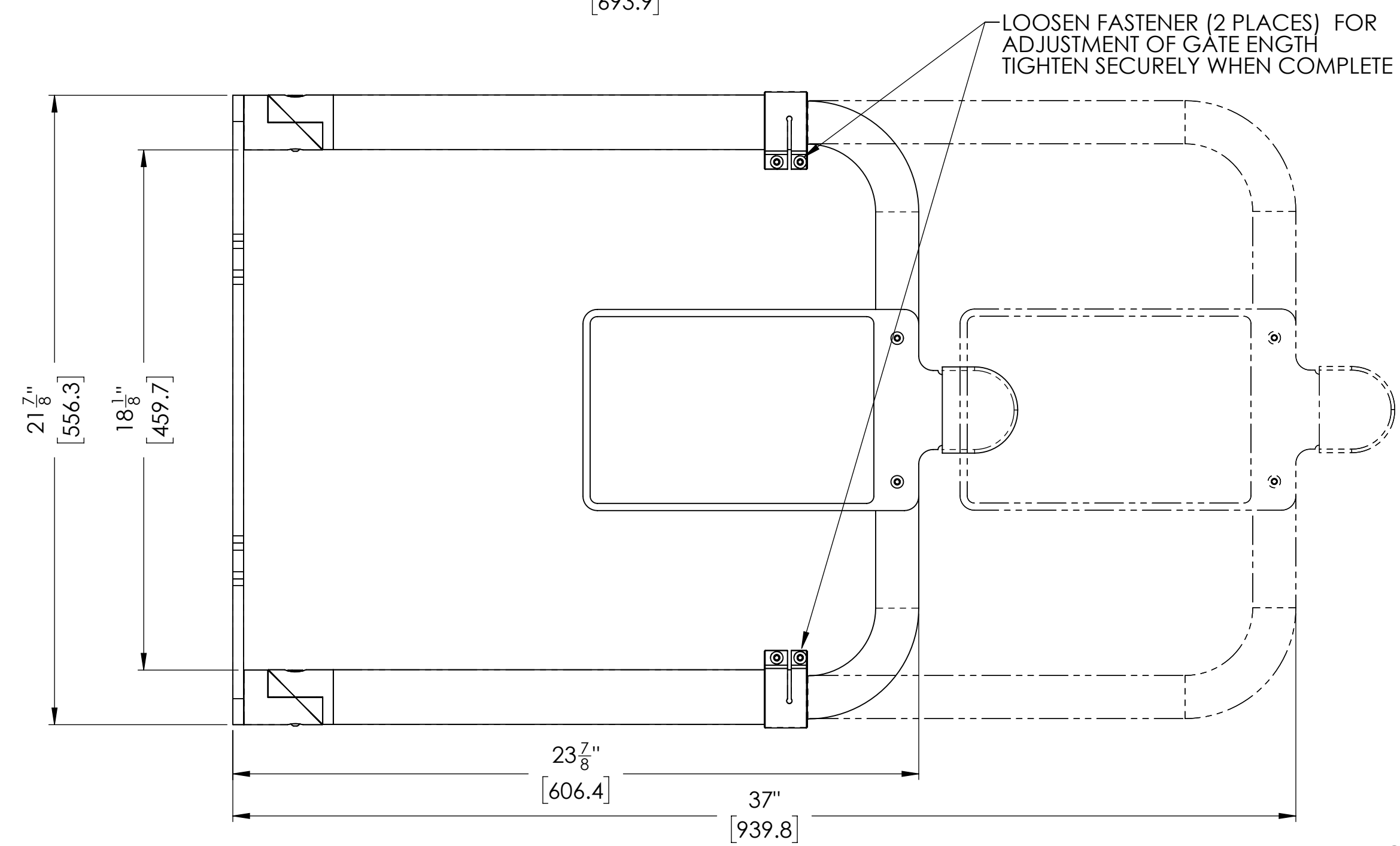
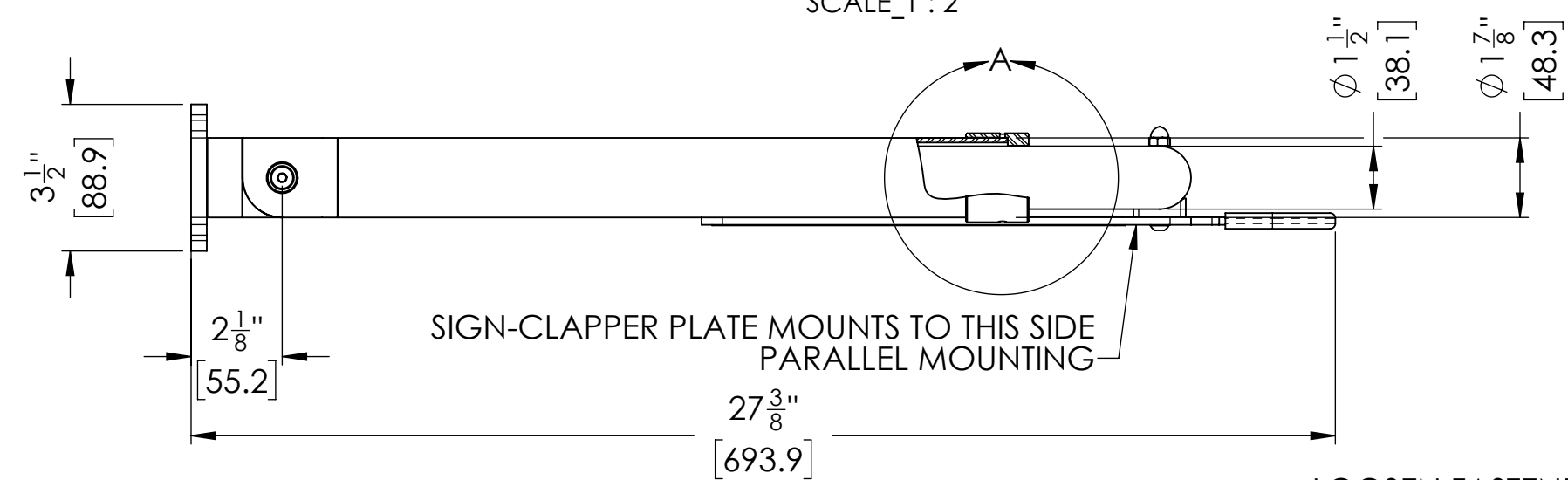

PARALLEL MOUNTING CONFIGURATION
FACTORY SETTING / CONFIGURATION

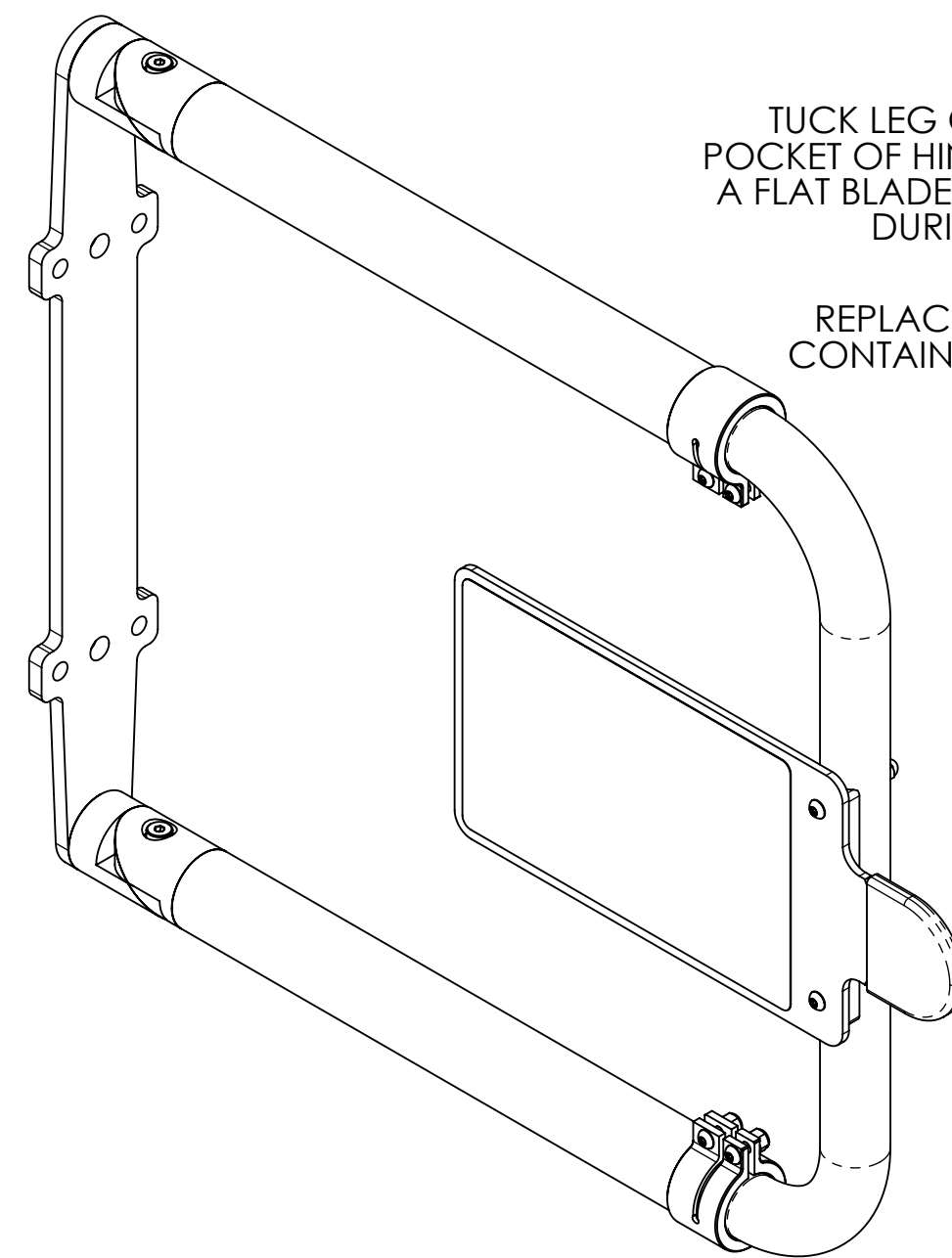

TUCK LEG OF SPRING INTO POCKET OF HINGE BODY WITH A FLAT BLADED SCREWDRIVER DURING REASSEMBLY

REPLACE SPRING WITH SPRING CONTAINED IN PERPENDICULAR MOUNTING KIT 2 PLACES

REMOVE SPRING FOR PARALLEL MOUNTING

ASSEMBLE WITH HINGE BASE POSITIONED AS SHOWN FOR PERPENDICULAR MOUNTING (SQUARE CORNER TO SQUARE CORNER)

SIGN-CLAPPER PLATE MOUNTS TO THIS SIDE PERPENDICULAR MOUNTING

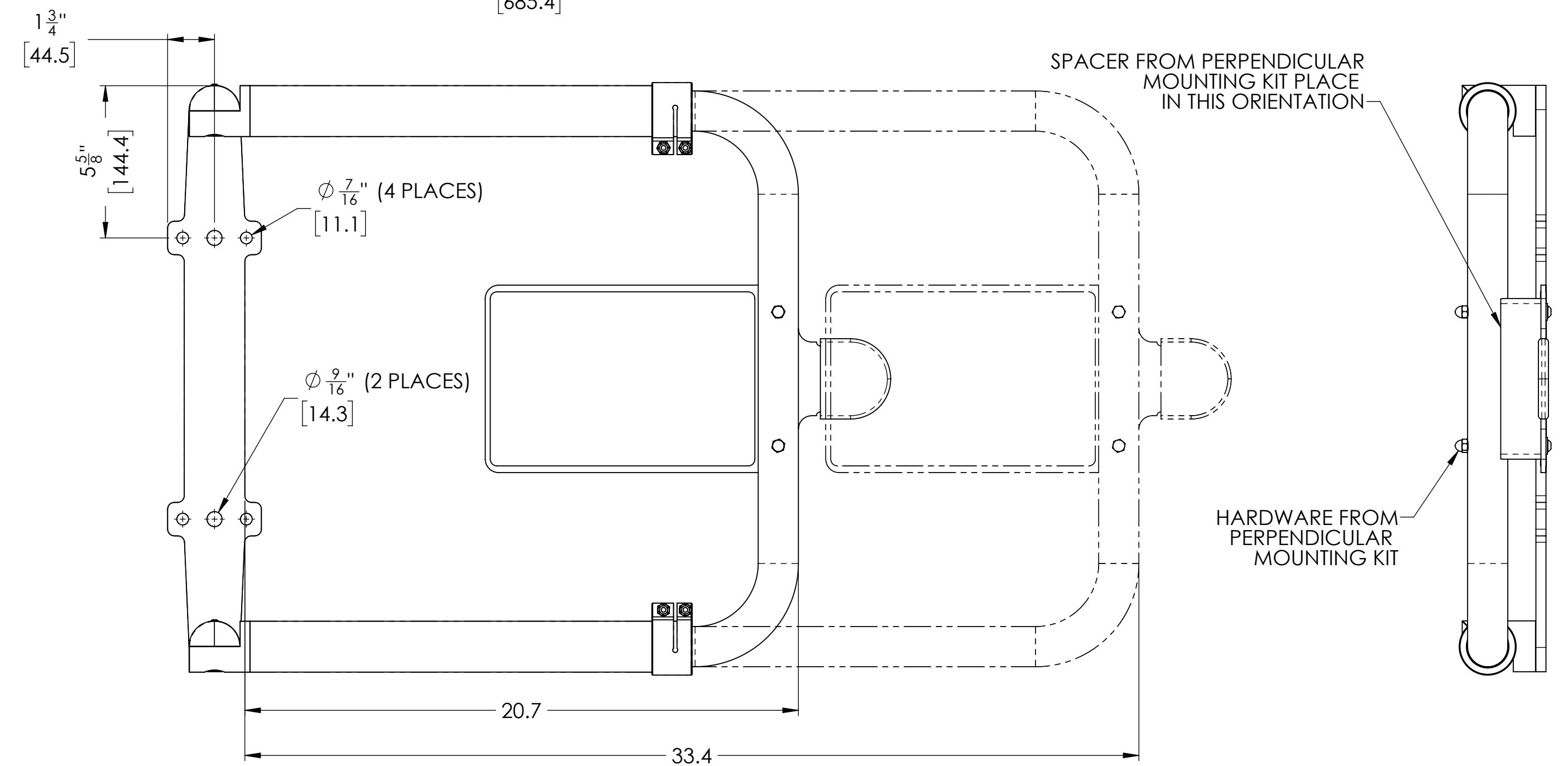
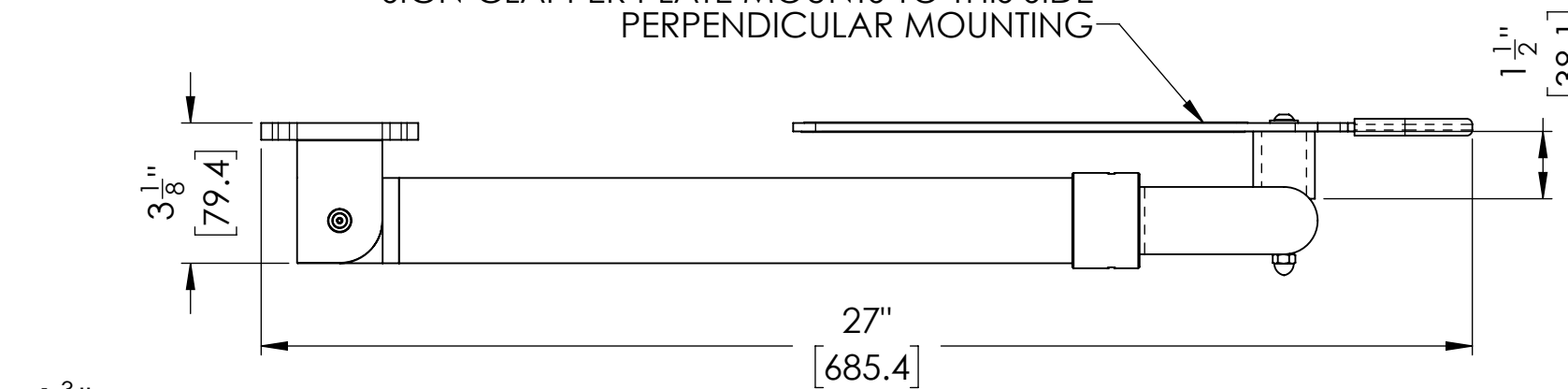

PERPENDICULAR MOUNTING CONFIGURATION
CUSTOMER / FIELD OPTIONAL CONFIGURATION

GENERAL NOTES:

- YELLOWGATE IS RATED TO WITHSTAND A 200 LB. LIVE LOAD (890 N.) HORIZONTALLY AND VERTICALLY ACCORDING TO OSHA 1926.1052(C)(5)
- YELLOWGATE WEIGHS 8 LBS. (3.6 KG.)AND HAS A PACKAGED WEIGHT OF 10 LBS. (4.5KG.)

- RELEASED FOR PRODUCTION		02/28/2024	SK	DO NOT SCALE		TOLERANCES: UNLESS OTHERWISE SPECIFIED		YELLOWGATE WELDING STANDARDS SEAL WELD UNLESS OTHERWISE NOTED USE FILLETS LISTED BELOW UNLESS OTHERWISE NOTED		ALL INFORMATION CONTAINED HEREIN IS CONFIDENTIAL AND PROPRIETARY AND MAY NOT BE DISCLOSED IN ANY FORM WITHOUT PRIOR WRITTEN CONSENT OF YELLOWGATE		CUSTOMER INFORMATION: SIXAXIS		DRAWN: SK 02/22/2024 YELLOW GATE 2.0	
# DESCRIPTION		DATE	BY	PROJECTION: THIRD ANGLE		LINEAR: X"-Y" = +1/16" X" = ±.01 .X = ±.1 .XX = ±.03 .XXX = ±.010		Material Thickness of Thinner Part Joined (inch) Minimum Fillet Size - S (inch) To 1/4" 1/8" Over 1/4" to 1/2" 3/16" Over 1/2" to 3/4" 1/4" Over 3/4" 5/16"		WWW.YELLOWGATE.COM 888-878-1839		DESCRIPTION: GENERAL ARRANGEMENT YELLOW GATE 2.0 - CUSTOMER INFORMATION		CHECK: JL 02/24/2024 ABAS #: 173499 SHEET: 1 OF 1	
						ANGULAR: +/- 1/2°						ENG: SK 12/20/2023 FINISH: NONE		SCALE: 1:4 SIZE: D	
												APVL: YG 02/28/2024		DWG#: YG2.0-X1 REV: -	
												P.O.#			