

### Product Overview

Palisades Grid gives designers all the tools they need to create flexible space division that can form a cornerstone design element or become the centrepiece. It provides the needed levels of acoustic and visual privacy between different working zones and allows for the curation of spaces within spaces, without building walls. Palisades' huge range of accessories enables you to curate a look that suits your workspace and is completely unique to your brand. TV alcoves, shelving and storage cater to the essentials, whilst the planters, Prism glass panels, and Mycelium accessories add a contemporary touch of biophilic design to complete the perfect zone divider.

### Dimensions

#### Shelves

16" w × 16" d

#### Alcoves

16" w × 16 1/8" d × 16" h

#### Front Panel

16" w × 16" h

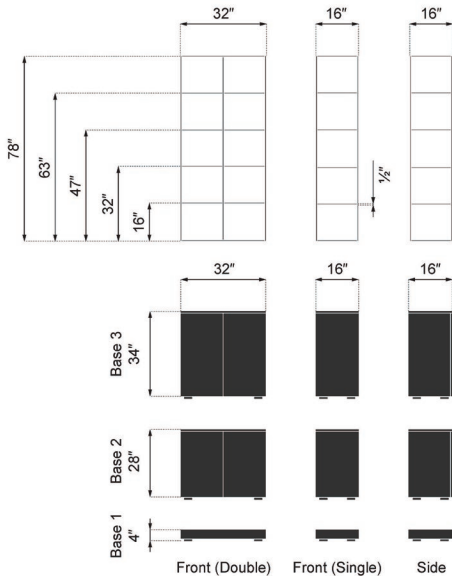

#### Accessories

##### Whiteboard:

Panel is 1 1/4" × 1 1/4"

##### Light:

Bulb is 5" wide

##### Light cord:

15ft

### Environmental Summary

During the development journey we always kept our environmental impact in mind. This is demonstrated in the following key features of the design when the product is purchased with the recommended finishes:

- All materials used are LBC 3.1 Red List Compliant, an extremely stringent standard

- Product lifecycle – the products are designed to be modular and reconfigurable to cater for future needs without wastage and using more resources.

#### Mycelium Panel

- 2 Ingredients; local agricultural waste + mycelium
- Composting: simply break into small pieces and return to mother nature
- Home-compostable, approx 45 days
- Marine-compostable, approx 180 days
- Optimum humidity and temperature - 45% RH and 18 °C

### Environmental Document & Declare Label



### Sustainability Compliance

Spacestor products support leading sustainability standards including WELL, LEED, BREEAM, LBC (Living Building Challenge), and SKA. By aligning with these frameworks, we help you create environmentally responsible spaces that enhance employee wellbeing.

We simplify the complexity of certification by providing clear, tailored guidance and product-specific compliance breakdowns for your project.

Scan above for more information or contact your dedicated rep for detailed documentation.

### Electrics

#### Lighting & Power

Sockets - 1 per 4 lights (need to send extra junction box and power lead)

Switching - each light switched individually

Cable run - clipped to tubes with cable ties

Socket position - ideally on a nearby wall / floorbox. If floorbox must be hidden, can do an access flap in the base units (cupboards only)

#### Light Feature Spec:

Adjustable: 15ft woven fabric cord lets you hang the pendant anywhere you like

Includes one LED Spiral Filament light bulb

Standard E26 base size

Uses only 4 watts and gives off a soft glow

Unique spiral curved filament

Long-life 50,000 hour LED bulb

### Safety

#### Fire Ratings

- Mycelium panels have good fire-resistant properties because of their low density, high porosity, and low thermal conductivity. The network of interwoven filaments in the mycelium creates a matrix of air pockets, which can act as an insulator and slow down the spread of heat and flames.
- Prism Glass Panel has fire resistance rating M1.

## Palisades Grid

---

### Lifting

Product must be handled by 2 operatives.

### General safety

- All maintenance and repair tasks must be performed by appropriately qualified and authorized technicians.
- Only use tools that are appropriate for these tasks.
- For longer periods of absence or if there is a thunderstorm, unplug the power supply cable from the power outlet to avoid damage due to grid-related over-voltage.

### Structural

Adjustable levellers on the product have up to 13/16" / 20mm tolerance.

### Seismic

To address the need for any required seismic regulations, this product can be fitted with brackets, managed per project with the Project Manager.

### Weights

Whiteboard panel: Approx. 16.5lbs

Max weight loading per shelf (glass or ply) - 22lbs

Castors have a weight limit of 37.5lbs

### Acoustics

---

Mycelium panels can provide good sound absorption across a wide range of frequencies due to their porous structure and low density. The mycelium grows into a network of interwoven filaments, creating a matrix of air pockets that can effectively trap and dissipate sound energy. Additionally, mycelium is a sustainable and biodegradable material, making it an attractive alternative to traditional soundproofing materials like foam or fiberglass, which can have a significant environmental impact.

### Shipping

---

Shipping dims/weight/packaging are dependant per project - please enquire.