

140.97

374.90

187.45

187.45

Coffeehouse taste  
in your own home.

FIND YOUR PERFECT POD

With over 70 brands and hundreds  
of varieties, find your match at  
[keurig.com/new](http://keurig.com/new)

**Have questions?** We're here to help. Visit  
[support.keurig.com](http://support.keurig.com) for troubleshooting videos,  
maintenance recommendations, and the full Use & Care Guide.

**Still need help?** Give us a call at 1-866-901-BREW (2739).

AW0000001183 REV A

KEURIG®  
Let's get  
brewing.

K•Crema™  
SINGLE SERVE COFFEE MAKER

Quick Start Guide

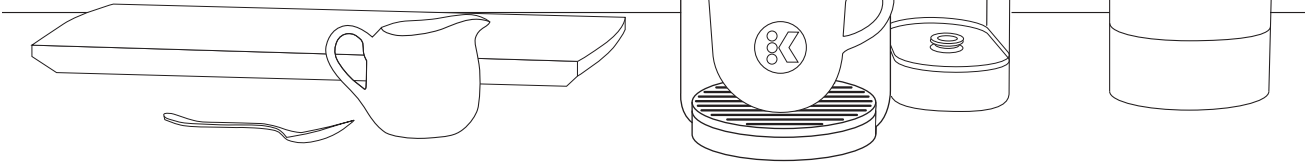

GET TO KNOW YOUR K-CREMA™

Scan here to watch step-by-step instructions for how to set up your brewer or continue reading.



1620 Tech Avenue, Mississauga, ON  
L4W 5P4 Canada  
[www.sgkinc.com](http://www.sgkinc.com)  
905.218.1600

SGK is a Matthews International Corporation

Please check carefully before using. Although every effort is made to produce the finest possible product, errors do occur.  
We do not assume any liability beyond the replacement of our product.

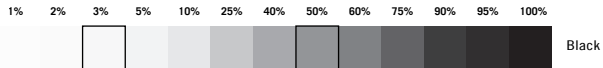

Client Name: Keurig Green Mountain  
Sales Order: 121435670  
Service Order: 404050473  
Date: 03-12-2025  
Description: K-Crema QSG-QSG

KGM Job #: 25-5743  
Item Part #: AW0000001183 REV A  
Buyer: LingZhang  
Vendor:  
Designer:  
CC:  
Operator: SB  
Project:

Barcode:  
Mag:  
Bar Width Adj.:  
Dieline #:  
Line Screen: 200  
Print Method:  
Printer: Printpack (M) Sdn Bhd - Senai  
Printer PO #: -  
Special Print -  
Processes:

KGM Approval:	Designer Approval:	Buyer Approval:	Proofreader Approval:	Changes:
Date	Date	Date	Date	Date

140.97

## IMPORTANT SAFEGUARDS

When using electrical appliances, basic safety precautions should always be followed, including the following:

1. READ ALL INSTRUCTIONS.
2. For household use only.
3. Do not use distilled water.
4. Scalding may occur if the handle is opened during the brewing process.
5. Do not touch hot surfaces. Use handles or knobs.
6. To protect against fire, electric shock, and injury to persons, do not immerse appliance, cord, or plugs in water or other liquid.
7. This appliance is not intended for use by persons (including children) with reduced physical, sensory, or mental capabilities or lack of experience and knowledge unless they have been given supervision or instruction concerning use of the appliance by a person responsible for their safety. Children should be supervised to ensure that they do not play with the appliance.
8. Close supervision is necessary when any appliance is used by or near children.
9. Unplug from outlet when not in use and before cleaning. Allow to cool before putting on or taking off parts and before cleaning the appliance.
10. Do not operate any appliance with a damaged cord or plug or after the appliance malfunctions or has been damaged in any manner. Return appliance to the nearest authorized service facility for examination, repair, or adjustment or contact Keurig customer service.
11. The use of accessory attachments not recommended by the appliance manufacturer may result in fire, electric shock, or injury to persons.
12. Do not use outdoors.
13. Do not let cord hang over edge of table or counter or touch hot surfaces.
14. Do not place on or near a hot gas or electric burner or in a heated oven.
15. Never add to container while appliance is operating.
16. Container must be properly in place before operating appliance.
17. Always attach plug to appliance first (if not permanently attached), then plug cord into the wall outlet. To disconnect, turn any control to "off," then remove plug from wall outlet.
18. Do not use appliance for other than intended use.
19. Use brewer in upright position only.
20. Only use K-Cup® pods intended for this appliance. If the pod does not fit, do not force it into the appliance.
21. Avoid spilling any liquid substances on powered connectors.
22. Do not remove the water reservoir or lift the handle once the **BREW** button has been pressed until the brew has completed.
23. **PRESSURE LOCK:** Lower the handle completely to close the lid. Once **PRESSURE** mode is selected, the brew chamber lock will automatically engage. The **BREW** button will no longer illuminate and the lock will disengage once the brew has completed.

**For detailed brewer cleaning and maintenance instructions, videos, and the full Use & Care Guide, visit [support.keurig.com](https://support.keurig.com).**



374.90

187.45

187.45

1. **WARNING:** Keep all plastic bags away from children.
2. **CAUTION:** Keurig recommends using only Keurig® My K-Cup® Universal Reusable Filters and Keurig® approved K-Cup® pods in this appliance. If the pod does not fit, do not force the pod into the appliance. The use of non-Keurig® pods or accessories may cause brewer malfunction or injury.
3. **WARNING:** Used K-Cup® pods should be removed from the pod holder, and the drip tray and water reservoir (if applicable) should be rinsed clean regularly or as part of the daily cleaning routine.
4. **WARNING:** There is extremely hot water under pressure in the K-Cup® pod holder during the brew process. To avoid risk of injury, do not lift the handle or otherwise open the handle during the brew process.
5. **CAUTION:** There are sharp needles that puncture the K-Cup® pod above the K-Cup® pod holder and in the bottom of the K-Cup® pod holder. To avoid risk of injury, be aware of the needle locations.
6. **WARNING:** The appliance has a polarized plug (one blade is wider than the other); to reduce the risk of electric shock, this plug is intended to fit into a polarized outlet only one way. If the plug does not fit fully into the outlet, reverse the plug. If it still does not fit, contact a qualified electrician. Do not attempt to modify the plug in any way.
7. **POWER CORD INSTRUCTIONS:**
  - a. A short power-supply cord is provided to reduce risks resulting from becoming entangled in or tripping over a longer cord.
  - b. Longer detachable power-supply cords or extension cords are available and may be used if

care is exercised in their use.

c. If a long detachable power-supply cord or extension cord is used:

- i. The marked electrical rating of the detachable power-supply cord or extension cord should be at least as great as the electrical rating of the appliance.
- ii. If the appliance is of the grounded type, the extension cord should be a grounding type 3-wire cord.
- iii. The longer cord should be arranged so that it will not drape over the countertop or tabletop, where it can be pulled on by children or tripped over.

**8. CAUTION: HOT COCOA/OTHER NON-COFFEE PODS:** Immediately after using a hot cocoa/ other non-coffee pod, run a hot water brew cycle without a pod to avoid the possibility of clogging the exit needle. DO NOT assume the next user will do this.

**WARNING**  
RISK OF FIRE OR ELECTRIC SHOCK DO NOT OPEN

**WARNING: TO REDUCE THE RISK OF FIRE OR ELECTRIC SHOCK, DO NOT REMOVE COVER. NO USER SERVICEABLE PARTS INSIDE. REPAIR SHOULD BE DONE BY AUTHORIZED SERVICE PERSONNEL ONLY.**

## SAVE THESE INSTRUCTIONS



1620 Tech Avenue, Mississauga, ON  
L4W 5P4 Canada  
[www.sgkinc.com](https://www.sgkinc.com)  
905.218.1600  
SGK is a Matthews International Corporation

Please check carefully before using. Although every effort is made to produce the finest possible product, errors do occur.  
We do not assume any liability beyond the replacement of our product.

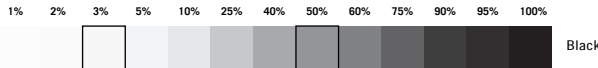

Client Name: Keurig Green Mountain  
Sales Order: 121435670  
Service Order: 404050473  
Date: 03-12-2025  
Description: K-Crema QSG-QSG

KGm Job #: 25-5743  
Item Part #: AW0000001183 REV A  
Buyer: LingZhang  
Vendor:  
Designer:  
CC:  
Operator: SB  
Project:

Barcode:  
Mag:  
Bar Width Adj.:  
Dieline #:  
Line Screen: 200  
Print Method:  
Printer: Printpack (M) Sdn Bhd - Senai  
Printer PO #: -  
Special Print Processes:

KGm Approval:	Designer Approval:	Buyer Approval:	Proofreader Approval:	Changes:
Date	Date	Date	Date	Date

140.97

374.90

187.45

187.45

**K•Crema™**  
SINGLE SERVE COFFEE MAKER

- A. Control Panel**  
**B. Brewer Handle**  
**C. Removable Water Reservoir & Lid**  
**D. Removable Drip Tray**  
**E. K-Cup® Pod Holder**  
**F. Adjustable Drip Tray Levels**

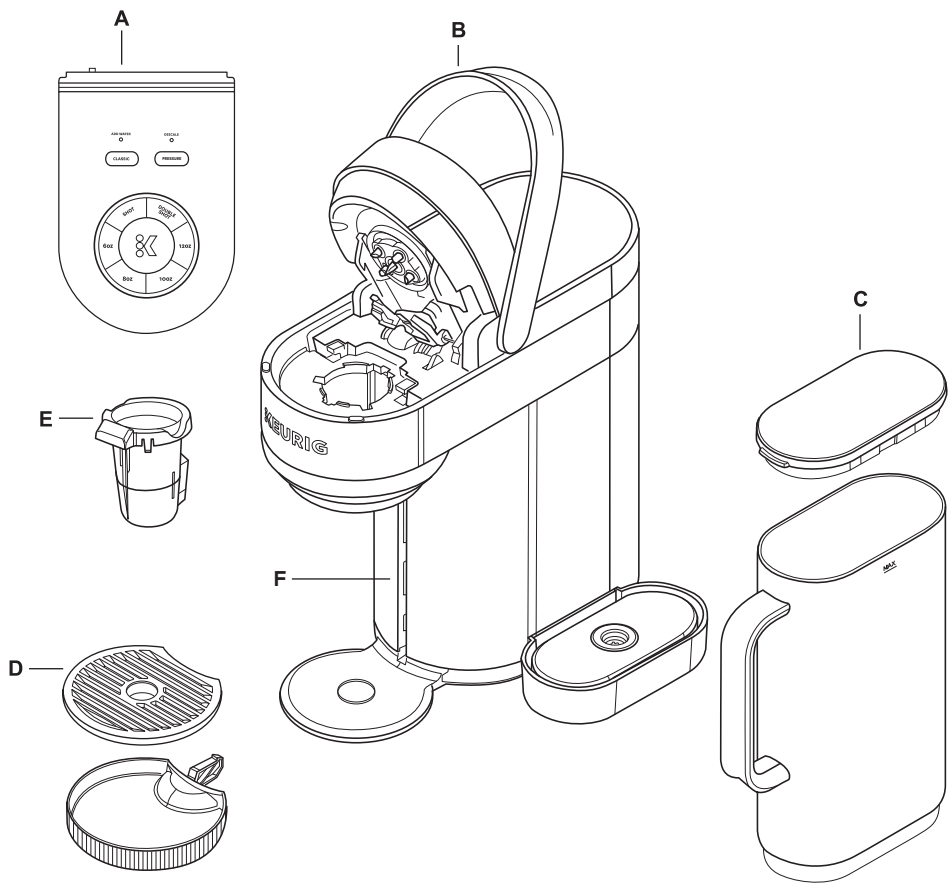

**NOTE:** Before first use, wash all removable parts with hot, soapy water.  
Rinse and dry.

**CONTROL PANEL OVERVIEW**

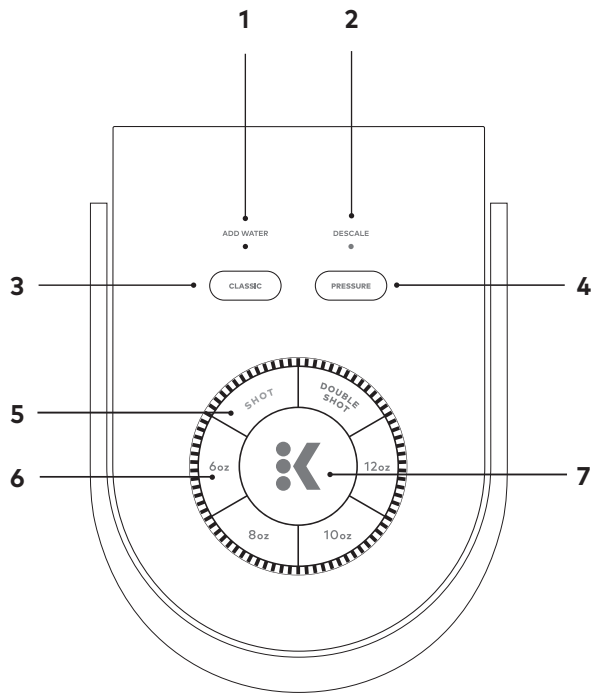

- 1. Add Water**  
**2. Descale**  
**3. Classic**  
**4. Pressure**  
**5. Shot & Double Shot**  
**6. Brew Sizes**  
**7. Brew Button**  
Starts your brew and remains illuminated during brew; brew is complete when button is no longer illuminated.  
**Power On**  
Lift the brewer handle or press any button.  
**Power Off**  
Press and hold either **CLASSIC** or **PRESSURE** for 3 seconds.



Please check carefully before using. Although every effort is made to produce the finest possible product, errors do occur.  
We do not assume any liability beyond the replacement of our product.

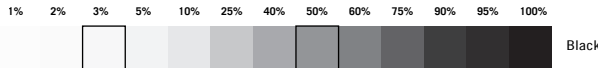

**Client Name:** Keurig Green Mountain  
**Sales Order:** 121435670  
**Service Order:** 404050473  
**Date:** 03-12-2025  
**Description:** K-Crema QSG-QSG

**KGM Job #:** 25-5743  
**Item Part #:** AW0000001183 REV A  
**Buyer:** LingZhang  
**Vendor:**  
**Designer:**  
**CC:**  
**Operator:** SB  
**Project:**

**Barcode:**  
**Mag:**  
**Bar Width Adj.:**  
**Dieline #:**  
**Line Screen:** 200  
**Print Method:**  
**Printer:** Printpack (M) Sdn Bhd - Senai  
**Printer PO #:** -  
**Special Print Processes:** -

<b>KGM Approval:</b>	<b>Designer Approval:</b>	<b>Buyer Approval:</b>	<b>Proofreader Approval:</b>	<b>Changes:</b>
Date	Date	Date	Date	Date

140.97

374.90

187.45

187.45

### BEFORE YOU BREW

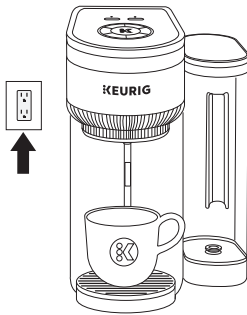

#### 1 Plug & Place

Remove packing tape from brewer and plug into an outlet. Place a 12 oz mug on the drip tray.

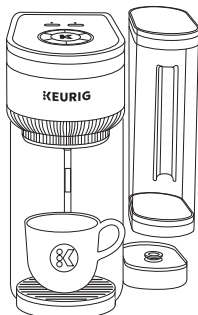

#### 2 Rinse & Fill

If you have a Keurig® Water Filter (sold separately), install it now. Refer to your Water Filter Starter Kit for instructions. Rinse water reservoir before filling with fresh water to the **MAX FILL** line. Replace water reservoir, making sure it is secure on the brewer. **NOTE:** Do not use distilled water.

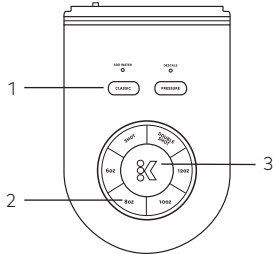

#### 3 Cleansing Brew

Lift and lower the handle. Do not insert a K-Cup® pod. Press the **CLASSIC** button, select **8 oz.**, and press the blinking **BREW** button to begin the cycle. The cycle is complete when the **BREW** button is no longer illuminated. Empty the mug and place it back on the drip tray.

### BREW YOUR FIRST CUP

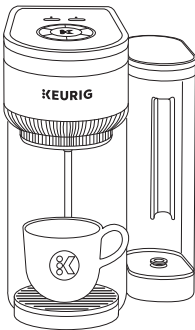

#### 4 Place Mug & Pod

Adjust the drip tray to best fit your mug size or remove drip tray to accommodate travel mugs. Place your mug. Lift the handle and place a K-Cup® pod in the K-Cup® pod holder. Lower the handle completely to close the lid. Do not remove the foil lid on the K-Cup® pod.

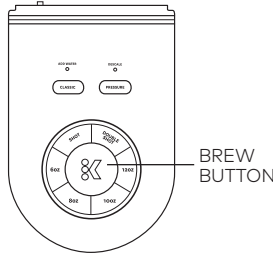

#### 5 Brew & Enjoy!

Select your brew pressure, **CLASSIC** or **PRESSURE**. Choose your brew size and press the **BREW** button to start the brew.

**Do not open the handle** until the brew is complete and the **BREW** button is no longer illuminated.

#### HOW TO RECYCLE K-CUP® PODS IN THREE STEPS

⚠ CAUTION: POD IS HOT. ALLOW TO COOL AFTER USE.

**PEEL**  
Starting at puncture, peel lid and dispose.

**EMPTY**  
Compost or dispose of grounds. (Filter can remain).

**RECYCLE**  
Check locally\* to recycle empty cup.

\*Not recycled in many communities. Visit Keurig.com/recyclable to learn more.



1620 Tech Avenue, Mississauga, ON  
L4W 5P4 Canada  
www.sgkinc.com  
905.218.1600  
SGK is a Matthews International Corporation

Please check carefully before using. Although every effort is made to produce the finest possible product, errors do occur.  
We do not assume any liability beyond the replacement of our product.

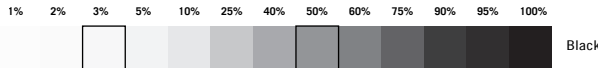



Client Name: Keurig Green Mountain  
Sales Order: 121435670  
Service Order: 404050473  
Date: 03-12-2025  
Description: K-Crema QSG-QSG

KGM Job #: 25-5743  
Item Part #: AW0000001183 REV A  
Buyer: LingZhang  
Vendor:  
Designer:  
CC:  
Operator: SB  
Project:

Barcode:  
Mag:  
Bar Width Adj.:  
Dieline #:  
Line Screen: 200  
Print Method:  
Printer: Printpack (M) Sdn Bhd - Senai  
Printer PO #: -  
Special Print Processes:

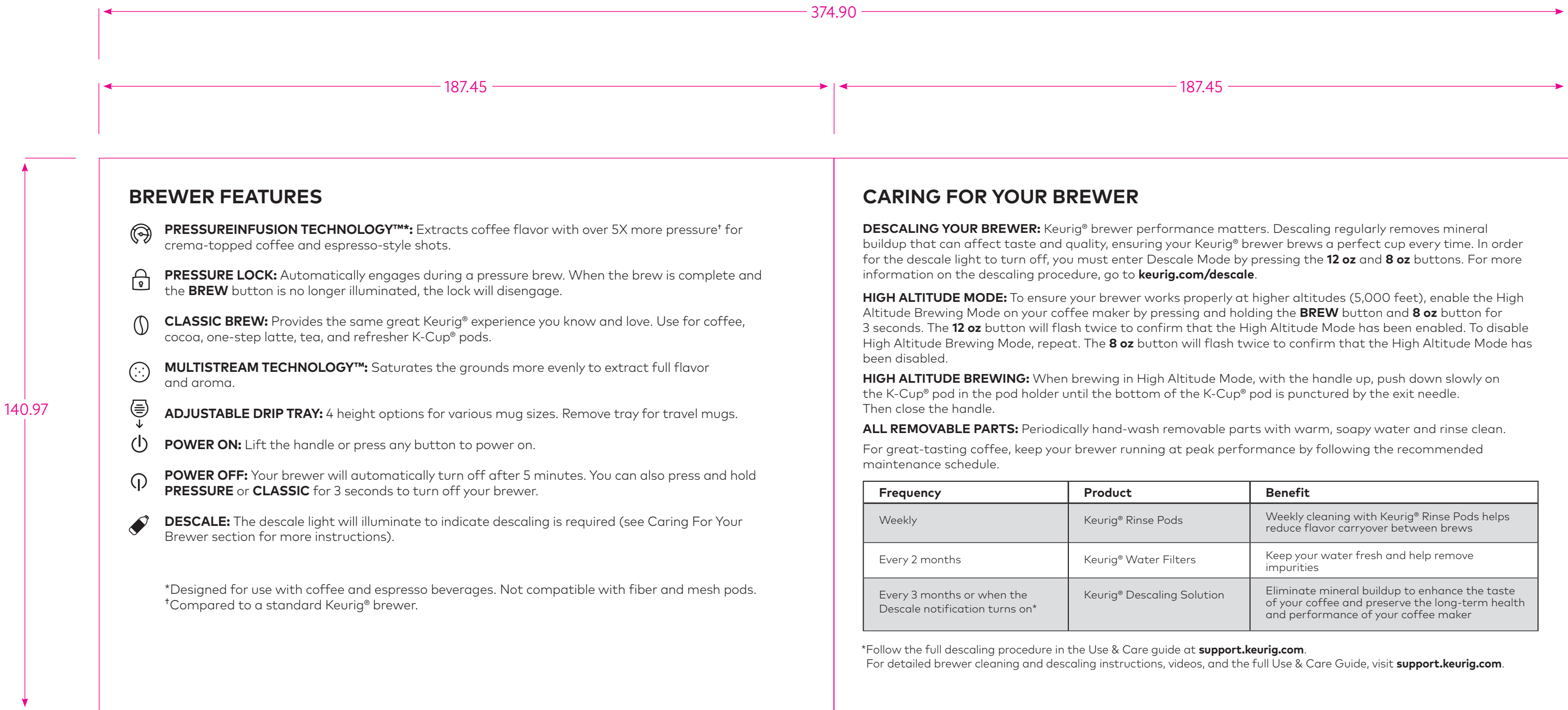
KGM Approval:	Designer Approval:	Buyer Approval:	Proofreader Approval:	Changes:
Date	Date	Date	Date	Date





1630 Tech Avenue, Mississauga, ON  
L4W 5P4 Canada  
www.sgkinc.com  
905.218.1600  
SGK is a Matthews International Corporation

Please check carefully before using. Although every effort is made to produce the finest possible product, errors do occur.  
We do not assume any liability beyond the replacement of our product.

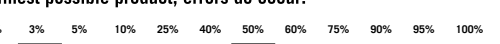

1% 2% 3% 5% 10% 25% 40% 50% 60% 75% 90% 95% 100% Black

<b>Client Name:</b> Keurig Green Mountain <b>Sales Order:</b> 121435670 <b>Service Order:</b> 404050473 <b>Date:</b> 03-12-2025 <b>Description:</b> K-Crema QSG-QSG	<b>KGM Job #:</b> 25-5743 <b>Item Part #:</b> AW0000001183 REV A <b>Buyer:</b> LingZhang <b>Vendor:</b> <b>Designer:</b> <b>CC:</b> <b>Operator:</b> SB <b>Project:</b>	<b>Barcode:</b> <b>Mag:</b> <b>Bar Width Adj.:</b> <b>Dieline #:</b> <b>Line Screen:</b> 200 <b>Print Method:</b> <b>Printer:</b> Printpack (M) Sdn Bhd - Senai <b>Printer PO #:</b> - <b>Special Print Processes:</b> -	
---	--	--	--

<b>KGM Approval:</b>	<b>Designer Approval:</b>	<b>Buyer Approval:</b>	<b>Proofreader Approval:</b>	<b>Changes:</b>
<b>Date</b>	<b>Date</b>	<b>Date</b>	<b>Date</b>	<b>Date</b>



140.97

## CARING FOR YOUR BREWER

If you experience changes in your coffee quality or crema, and if you frequently use flavored K-Cup® pods, cocoas, or one-step lattes, it might be time to clean your K-Cup® pod holder.

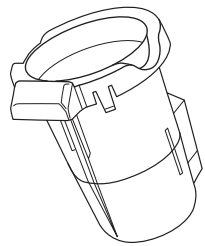

### K-Cup® Pod Holder

To remove the K-Cup® pod holder, lift the handle and grasp the top of the K-Cup® pod holder with one hand while pushing up on the bottom of the K-Cup® pod holder from underneath with the other hand.

To remove the bottom funnel, pinch the textured ridges together while pulling in the direction of the arrows.

### Rinse

Rinse the two pieces of the pod holder under a faucet.

### Reassemble Pod Holder

After cleaning, align the bottom funnel with the K-Cup® pod holder, using the snaps as a guide, and push into place.

For more detailed pod holder cleaning instructions, see the Use & Care Guide at support.keurig.com.

**CAUTION:** There are sharp needles that puncture the K-Cup® pod above the K-Cup® pod holder and in the bottom of the K-Cup® pod holder. To avoid risk of injury, do not put your fingers in the K-Cup® pod holder.

**NOTE:** Always remove and dispose of the used K-Cup® pod after brewing or as part of the daily cleaning routine.

## KEURIG® COFFEE MAKER MAINTENANCE

For great-tasting coffee, keep your coffee maker running at peak performance.



### 3-Month Brewer Care Kit

**THIS THREE-MONTH BUNDLE** has all the essentials needed to keep your Keurig® coffee maker running at peak performance.



### Descaling Solution

**USE EVERY THREE MONTHS**, or when descale indicator turns on\*, to eliminate mineral buildup and preserve the long-term health of your Keurig® coffee maker.

\*See Use & Care Guide or visit keurig.com/descale for brewer-specific instructions, including the use of Descal Mode to reset the indicator.



Please check carefully before using. Although every effort is made to produce the finest possible product, errors do occur. We do not assume any liability beyond the replacement of our product.

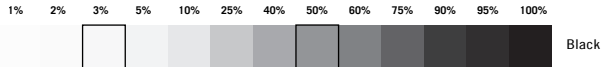

Client Name: Keurig Green Mountain  
Sales Order: 121435670  
Service Order: 404050473  
Date: 03-12-2025  
Description: K-Crema QSG-QSG

KGM Job #: 25-5743  
Item Part #: AW0000001183 REV A  
Buyer: LingZhang  
Vendor:  
Designer:  
CC:  
Operator: SB  
Project:

Barcode:  
Mag:  
Bar Width Adj.:  
Dieline #:  
Line Screen: 200  
Print Method:  
Printer: Printpack (M) Sdn Bhd - Senai  
Printer PO #: -  
Special Print Processes:

KGM Approval:	Designer Approval:	Buyer Approval:	Proofreader Approval:	Changes:
Date	Date	Date	Date	Date