

# Side By Side Refrigerator

## PRODUCT DIMENSIONS

# MORA

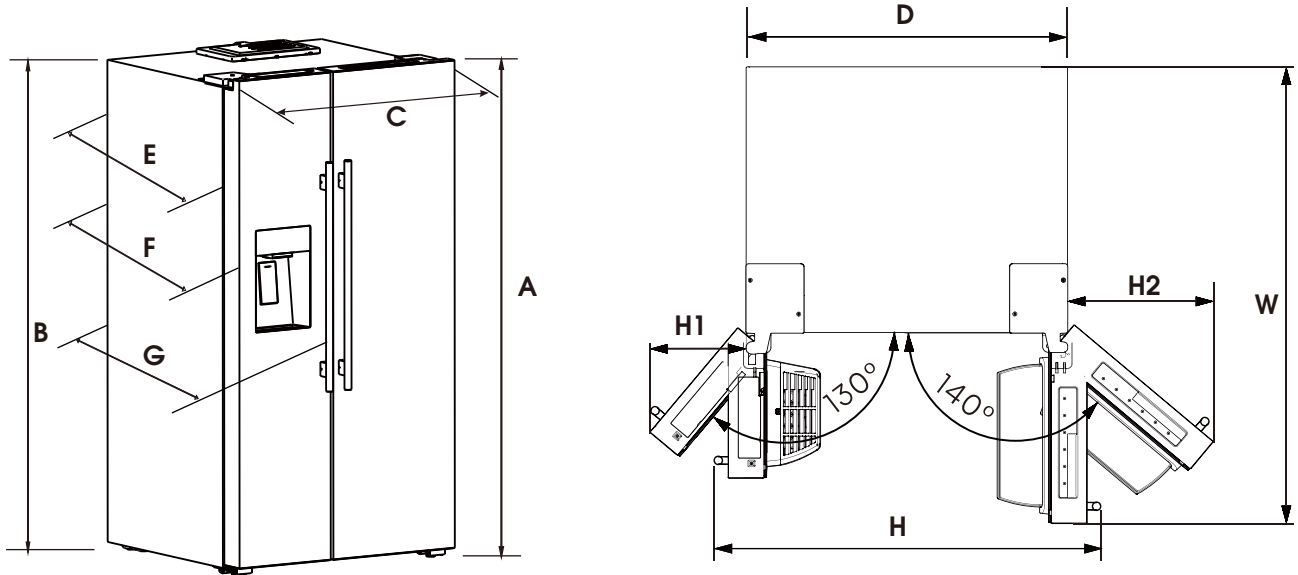

Model	Capacity	Height-with Overall "A"	Height-with Cabinet "B"	Width-with Door "C"	Width-with Cabinet "D"	Depth-less Door "E"	Depth-without Handle "F"	Depth-with Handle "G"	Width-Door Open 90° "H"	Width-Door Open 130° "H1"	Width-Door Open 140° "H2"	Depth-Door Open 90° "W"
MRS290T5FSD	29.1 cu.ft	70.3" (1785mm)	70.0" (1778mm)	35.9" (912mm)	35.8" (908mm)	29.5" (750mm)	34.0" (864mm)	36.3" (923mm)	45.1" (1145mm)	10.1" (257mm)	15.6" (395mm)	57.8" (1290mm)

## LOCATION REQUIREMENTS

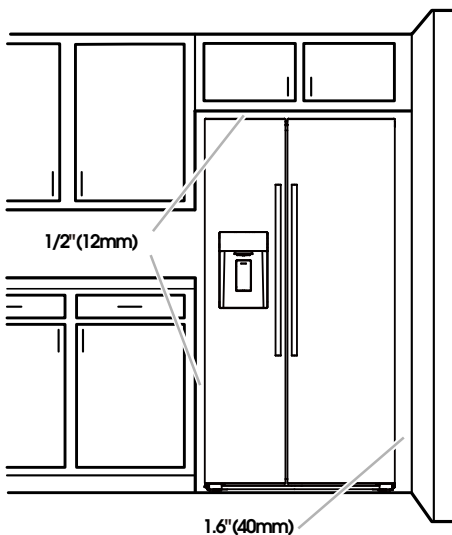

To ensure proper ventilation for your refrigerator, allow for a 1/2"(12mm) space on each side and at the top. Allow at least 2.0"(51mm) between back of cabinet and the wall. If your refrigerator has an ice maker, allow extra space at the back for the water line connections.

If you are installing your refrigerator next to a fixed wall, leave 1.6"(40mm) minimum on the hinge side (some models require more) to allow for the door to swing open.

**NOTE:** This refrigerator is intended for use in a location where the temperature ranges from a minimum of 55F(13°C) to a maximum of 110°F(43°C).