

transform

ALL-IN-ONE
TOUT-EN-UN

UTILITY CABINET WITH STAINLESS-STEEL SINK AND FAUCET
ARMOIRE DE RANGEMENT AVEC ÉVIER EN ACIER INOXYDABLE ET ROBINET



OWNER'S MANUAL
MANUEL DE L'UTILISATEUR

ITM. / ART. 2233579
QL014

Table of Contents

Safety Information	2	Installing the Strainer	9
Warranty		Placement	10
One Year Limited Warranty	3	Drainage	10
Warranty Claim Procedure	3	Supply Lines	10
Pre-Installation		Maintenance	
Tools/Materials Required	4	Cartridge Replacement	10
Parts Required	4	Care and Cleaning	
Package Contents	5	Sink	11
Installation		Cabinet	11
Installing the Leveling Legs	6	Service Parts	12
Installing the Handles	7	MANUEL DE L'UTILISATEUR	13
Installing the Faucet	8		

Safety Information

READ AND SAVE THESE INSTRUCTIONS

1. Unpack and inspect this product for chips, scratches, cracks, dents, and scuff marks. Do not install this product if any damages or defects are identified.
2. Use this product only in the manner intended by the manufacturer. If you have any questions, contact the manufacturer.
3. Installation work and plumbing must be done by qualified person(s) in accordance with all applicable codes and standards.
4. Protect the entire surface during installation.



DANGER: Always wear safety goggles and gloves in order to avoid personal injury.

ONE YEAR LIMITED WARRANTY

A thorough inspection must be made before installation and any damage must be promptly reported. We will not be liable for failures or damage that could have been discovered or avoided by proper inspection and testing prior to installation.

Conglom Kitchen & Bath warrants this product to be free from defects in materials or workmanship for one (1) year from the date of purchase. Proof of purchase (original sales receipt) from the original consumer purchaser must be made available to Conglom Kitchen & Bath for all warranty claims.

This warranty is non-transferable and shall be voided if the unit is removed from its initial installation or if it is not installed following the manufacturer's instructions. It does not apply in the event of product damage due to the use of other than genuine Conglom Kitchen & Bath replacement parts, (Replacement parts may be obtained by e-mail at cs@conglomkb.com or by calling 1-877-333-0098 between 8:30 am - 5:00 pm EST) installation error, abuse, misuse or improper care and maintenance (whether performed by a plumber, contractor, service provider or member of the purchaser's household). The warranty excludes damage due to aggressive air or water conditions, harsh or abrasive cleaners and/or materials.

Under no circumstance shall we be held liable for personal injury or property damage resulting from improper installation or use of this product. We will not be held liable for inconvenience caused by loss of use of this product, costs incurred for labour or materials, removal and installation of replacement units, or any other incidental or consequential damages. Costs relating to obtaining access for repair or replacement are the responsibility of the user.

Our obligation shall be limited to the repair or replacement of a unit (at our discretion) that may prove, by our sole examination, to be defective under normal use and service during the warranty period.

Any failure of this product that is not traceable to a defect in material or workmanship is not covered by this warranty. These non-warrantable items include, but are not limited to:

- Improper installation not in accordance with manufacturer's instructions.
- Dents and/or scratches incurred during shipping, handling, or installation.
- Change in colour or finish due to chemical usage.
- Damage caused by failure to follow care and cleaning guidelines, including damage caused by the use of abrasive cleaners.
- Alterations made to the unit by the purchaser or installer.
- Damage caused by accidental impact, fire, flood, freezing, and normal wear.
- Bends and warping caused by forced connections, over-tightened fittings, and inadequate support during installation.
- Damage caused by use of chlorine-based cleaners.

This warranty does not extend to commercial and institutional installation or use.

WARRANTY CLAIM PROCEDURE

If a claimable defect occurs or replacement parts are needed, please contact our customer service team at cs@conglomkb.com or 1-877-333-0098 (Service available in English and French, Monday - Friday from 8:30 am - 5:00 pm EST).

Before you make your call, please ensure that you have:

- Model number or description.
- Proof of sale.
- Details regarding the defect and/or part number.
- Name(s) and address(es) of the owner and/or installer.

Pre-Installation

ENGLISH

TOOLS/MATERIALS REQUIRED (NOT SUPPLIED)

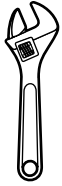

Adjustable wrench



Needle nose pliers

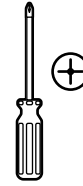

Phillips screwdriver



Utility knife



Pipe wrench

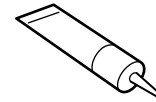

Sealant

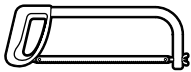

Hacksaw



Carpenter's level



Hex key



Safety gloves



Safety goggles

PARTS REQUIRED (NOT SUPPLIED)

NOTE:

Parts not shown to actual size.



Tailpipe



P-Trap

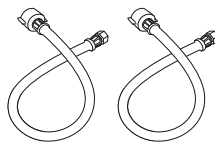

Supply lines

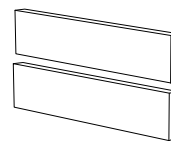

Shims

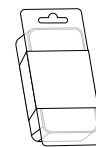

Wall Fastening Hardware

Pre-Installation (continued)

PACKAGE CONTENTS

Carefully check the utility cabinet for damage and/or missing parts prior to installation. If there is any damage or if you are missing parts, do not proceed with the installation. Report damage and/or missing parts immediately to our customer service team at cs@conglomkb.com or 1-877-333-0098 (Service available in English and French, Monday - Friday from 8:30 am - 5:00 pm EST). Please do not dispose of packaging before you are satisfied with your new utility cabinet.

ENGLISH

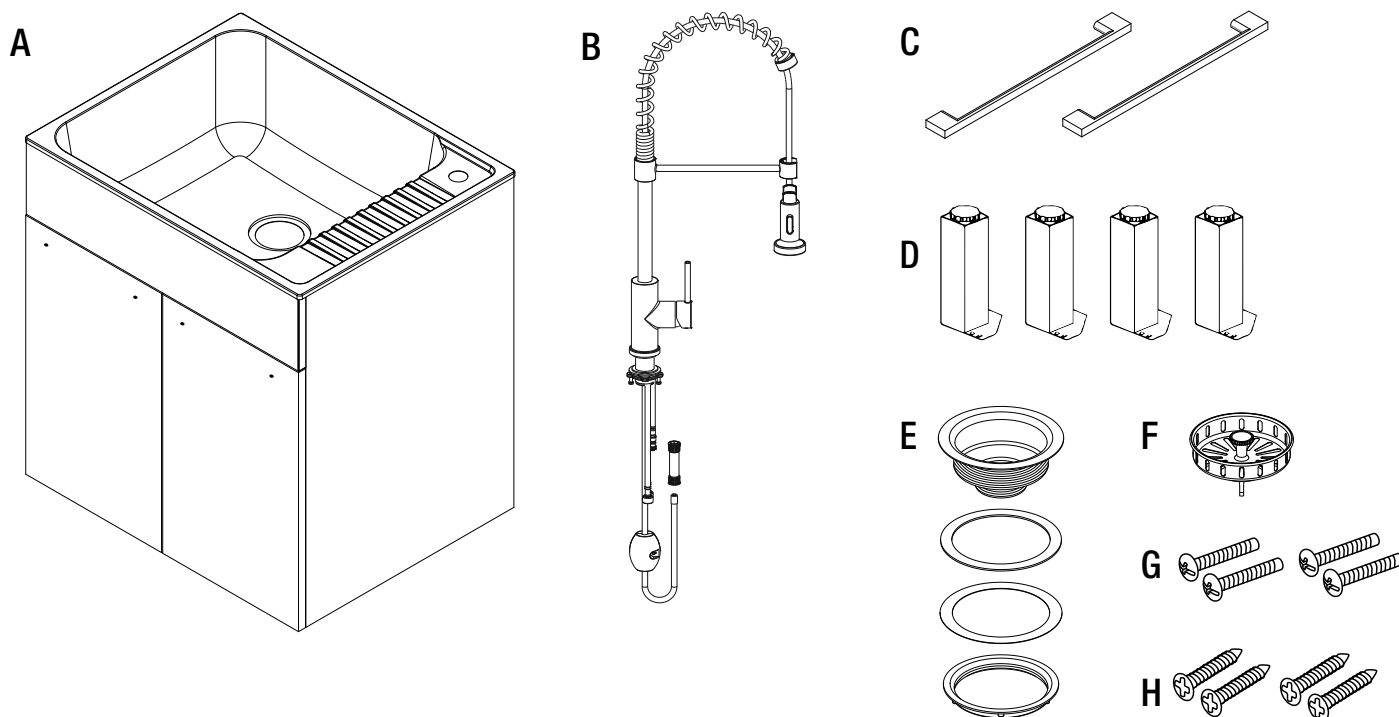

Part	Description	Quantity
A	Cabinet	1
B	Faucet	1
C	Door Handles	2
D	Leveling Legs	4
E	Strainer Assembly	1
F	Strainer Basket	1
G	Handle Screws	4
H	Leveling Leg Screws	16

Installation

INSTALLING THE LEVELING LEGS

- Remove the cabinet (A) and place it on a soft, protective surface.
- Attach each leveling leg (D) to the bottom of the cabinet (A) using four of the provided screws (H).
- Gently rotate the cabinet (A) right side up.



WARNING: Always wear safety goggles and gloves during installation.



CAUTION: Do not rest or bump the leveling legs on the side as this may cause them to detach or break.

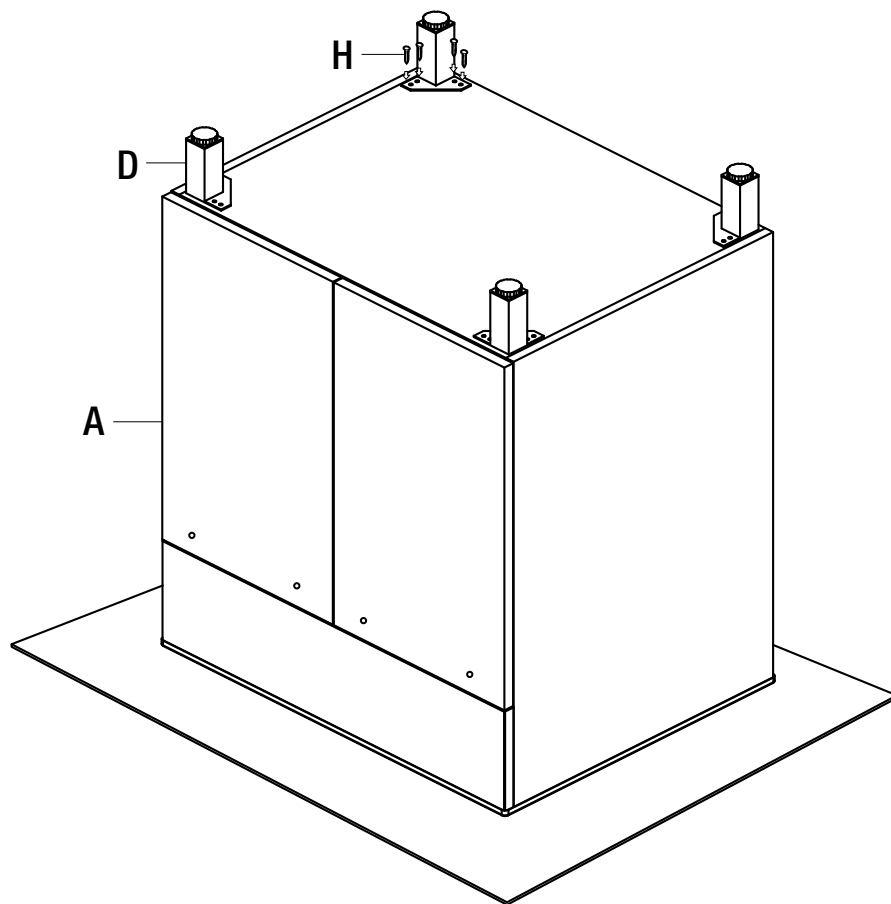

Installation (continued)

INSTALLING THE HANDLES

- Attach door handles (C) to the cabinet doors using supplied door handle screws (G) and a screw driver. Do not overtighten.

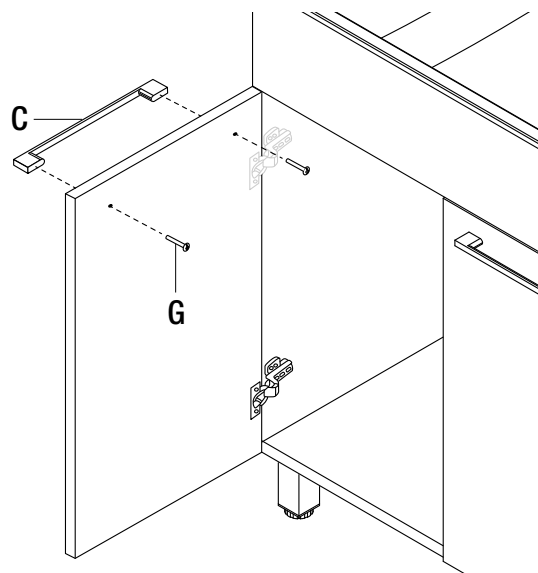

ADJUSTING THE DOOR POSITION

If the doors need to be repositioned, the hinges can be adjusted to ensure a precise fit with the cabinet.

1. The lateral adjustment screw adjusts the door orientation from left to right.

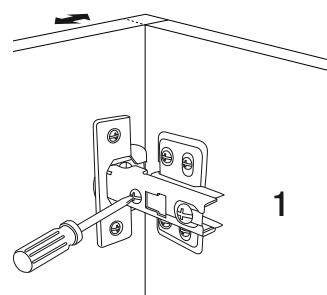

2. The horizontal adjustment screw adjusts the door orientation from front to back.

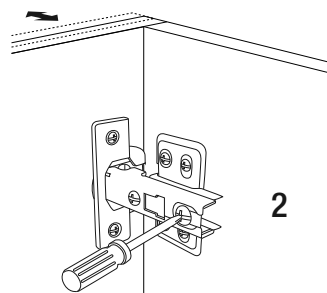

3. The vertical adjustment screw adjusts the orientation up or down.

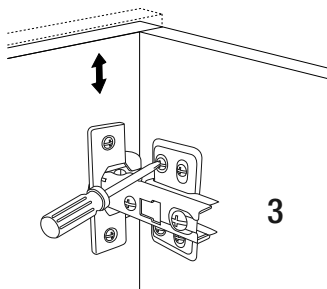

Installation (continued)

INSTALLING THE FAUCET

- Remove the retaining nut, metal washer, and rubber gasket from the mounting shank of the faucet.
- Insert the faucet hose and the mounting shank through the faucet hole in the sink and rest the faucet on the sink.
- Install the rubber gasket, metal washer, and retaining nut onto the mounting shank to secure the faucet to the sink. Hand-tighten the retaining nut until it is snug. Tighten the screws of the retaining nut using a screw driver. Do not overtighten.
- Connect the main water supply outlet to the sprayer hose using the quick connector as shown. Connect the end of the quick connector marked with an "S" to the sprayer hose and the other end to the main water supply hose of the faucet. Lightly tug on the quick connect fittings to ensure they are fully engaged.
- Fully retract the sprayer hose. Install the counterweight about 2 in. (50 mm) from the bottom on the side closest to the sprayer head.
- Attach and hand tighten the supply lines (not supplied) onto the faucet inlet fittings. Use two wrenches to tighten the two ends together. Please note, tightening the fittings with a single wrench may damage the faucet and void the warranty.

NOTE:

It is helpful to have a second person hold the faucet in place while tightening the mounting nuts. Please ensure that none of the supply lines are kinked during installation.

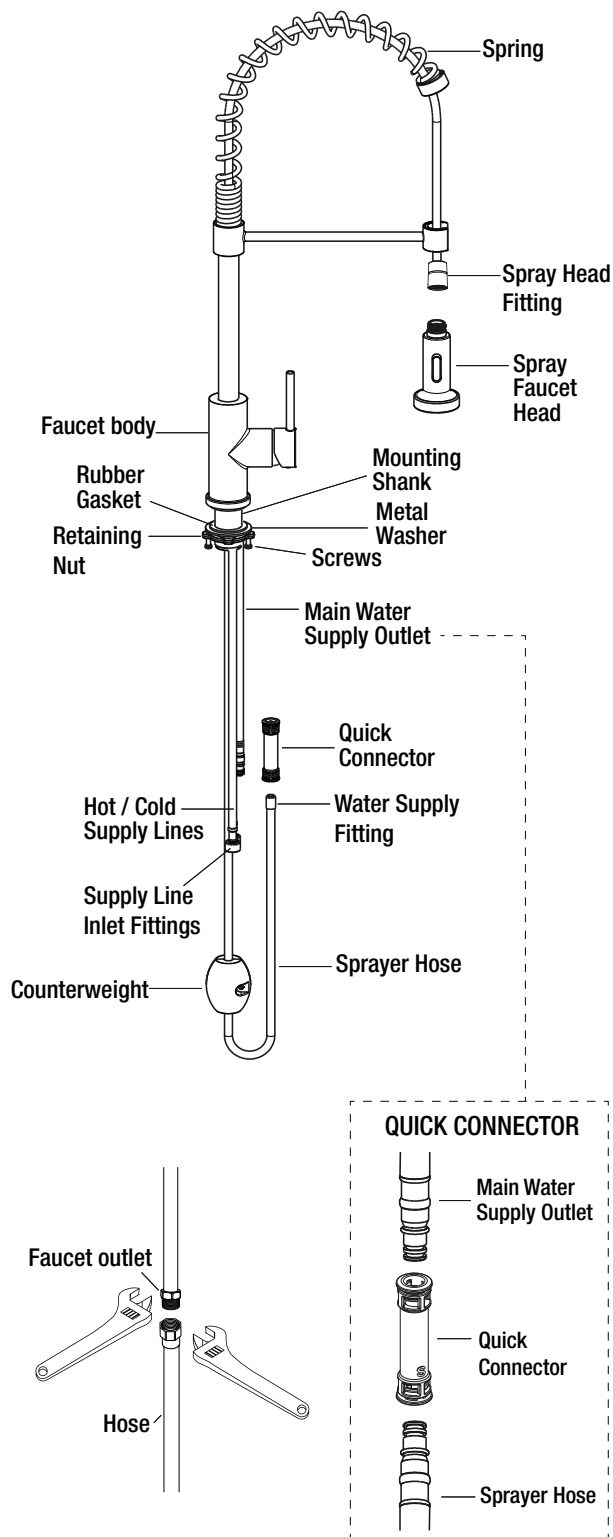

Installation (continued)

INSTALLING THE STRAINER

- Apply plumbing putty or silicone sealant to the top side of the drain opening.
- Insert the strainer body into the drain opening and press it down until it is evenly seated.
- Assemble the rubber gasket, friction washer and strainer locknut onto the strainer body from underneath the sink. Hand tighten the strainer locknut until it is snug. Do not overtighten.
- Insert the plastic flange into the flange-end of the tailpipe (not supplied) then secure the tailpipe to the strainer body using the connecting nut. Tighten the connecting nut until it is snug. Do not overtighten.
- Remove excess sealant from around the drain opening.

NOTE:

The tail pipe is not supplied.

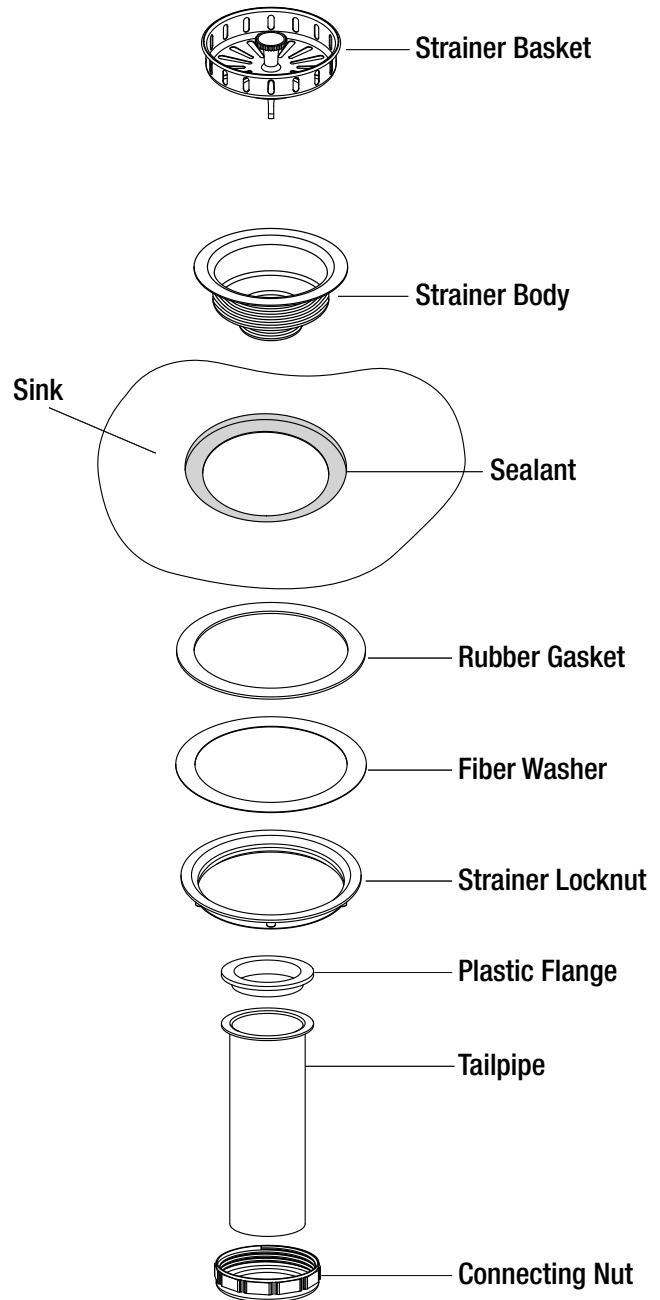

Installation (continued)

PLACEMENT

Push the cabinet against the wall. Level the unit by adjusting the four leveling legs and checking the alignment of the sink using a carpenter's level.

Please note, leveling feet are intended for leveling the cabinet, not height adjustments. It is not recommended to extend leveling feet by more than 0.4" (10mm). Overextending the leveling feet may render the sink cabinet unstable.

IMPORTANT: Due to the size and weight of this product, it must be firmly attached to the wall using fastening hardware that is appropriate for your wall type. For drywall or plaster walls, it must be attached to a wooden wall stud. Please consult a qualified installation professional if necessary.

DRAINAGE

The tailpipe (not supplied) previously installed to the drain can now be connected to your household plumbing. In some cases, your household plumbing will have to be modified to ensure proper drainage. If so, please consult a licensed plumber to complete needed modifications.

SUPPLY LINES

Connect the supply lines to your home's water supply as per manufacturer's instructions.

Open the hot and cold water supply valves and check to make sure they have been installed to appropriate inlet ports. Check for leaks. Run hot and cold water uninterrupted for about one minute to remove any residue from the lines.

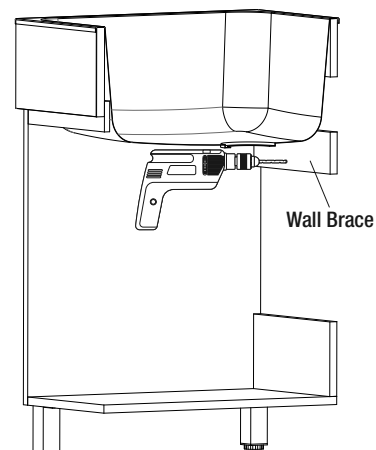

Cabinet Cross Section
Some Components Removed For Clarity

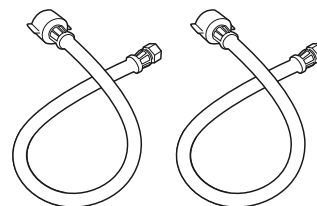

Maintenance

CARTRIDGE REPLACEMENT

- Turn off the water supply to the faucet.
- Remove the setscrew cap. Loosen the setscrew with the hex key provided and remove the handle.
- Gently unscrew the decorative cap by hand. Use a wrench to unscrew the retaining nut.
- Pull the cartridge out of the faucet body and replace it with a new ceramic cartridge. Ensure new cartridge is seated properly with the locating pins in appropriate place.
- Secure the cartridge in place using the retaining nut.
- Gently tighten the retaining nut using a wrench. Do not overtighten.
- Reinstall the decorative cap. Slide the handle back onto the lever arm and make sure it rotates freely. Secure the handle in place using the setscrew and cover it with the setscrew cap.
- Turn the water supply to the faucet back on.
- Operate the faucet to make sure everything works correctly.

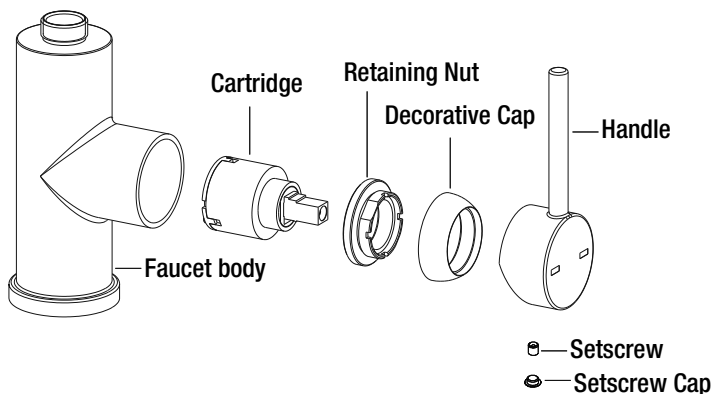

Care and Cleaning

Your sink is manufactured with the highest grade stainless steel and will provide you many years of enjoyment with the proper care.

SINK

Do
<ul style="list-style-type: none">- After use, always rinse your sink with tap water to dilute and remove deposits.- Towel dry after use whenever possible to prevent water spots. Should water spots occur, clean with a mild solution of vinegar and water followed by a thorough rinse.- Use liquid soap, a general household cleaner, or a weak solution of vinegar and water for regular cleaning.- Only use plastic scouring pads recommended for use in stainless-steel sinks, and only use them in the bowl of the sink. Scrub in the direction of the satin finish lines.
Do not
<ul style="list-style-type: none">- Do not allow any food, detergent, soap or grease to dry or sit for extended periods of time on the surface of the sink.- Never use abrasive cleaning products, as they will dull and scratch the finish.- Do not use scouring pads on the deck, as they will dull the mirror finish.- Never use steel wool pads, as they will leave iron particles on the sink, which will cause corrosion.- Never leave steel or cast iron pans in your sink for extended periods of time, as this can cause corrosion.- Never use chlorine-based cleaners in your new sink, they could lead to rust spots and discolouration. If you must use them, rinse sink thoroughly with fresh water immediately after use. If any chemicals or glue make contact with the sink during installation, wipe clean and rinse thoroughly with fresh water.

CABINET

Do
<ul style="list-style-type: none">- Remove dust and dry dirt with a soft, damp cloth.- Clean grease, oil, paint and ink stains with isopropyl (rubbing alcohol). Immediately rinse with water after stain removal.
Do not
<ul style="list-style-type: none">- Do not allow your cabinet surface to come into contact with products such as acetone (nail polish remover), nail polish, dry cleaning solution, lacquer thinners, gasoline, pine oil, etc.- Use caution when using sharp instruments that may fall and scratch the surface.

SCRATCH, SPOT, AND BLEMISH REMOVAL AND SURFACE RESTORATION:

Little rust spots and blemishes that periodically appear in the sink are typically the result of the steel interacting with the chemicals found in the vast spectrum of substances that sinks are commonly exposed to. They may also get transferred from other objects placed or left in the sink. Scratches are the result of regular wear and tear.

To remove scratches, spots, and blemishes from the sink, rub them with a non-metallic scouring pad (e.g. Scotch-Brite®) combined with a mild abrasive cleaner (e.g. Vim® or Barkeeper's Friend®). Always rub the surfaces in the direction of the grain of the steel. When finished, rinse the sink with water and dry it with a towel to allow the sink to form a protective outer layer. This procedure can also be used to renew all of the surfaces of the sink.

Service Parts

ENGLISH

If you are missing parts or if you require replacement parts, please contact our customer service team at cs@conglomkb.com or 1-877-333-0098 (Service available in English and French, Monday - Friday from 8:30 am - 5:00 pm EST). Identify the required part(s) and have the part number(s) ready.

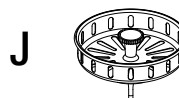
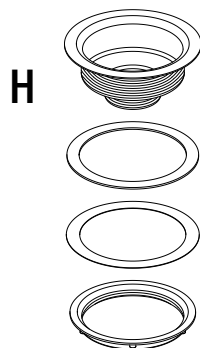
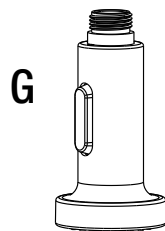
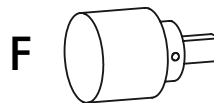
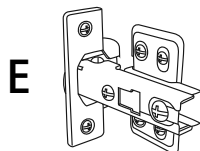
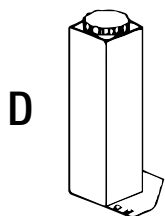
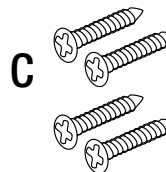
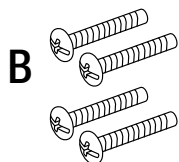
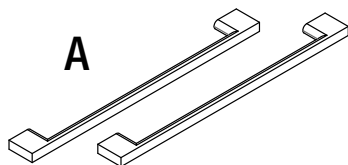

Part	Description	Code	Quantity
A	Door Handles	QHL182	2
B	Door Handle Screws	QHL104	4
C	Leveling Leg Screws	QHL106	16
D	Leveling Legs	QHL179	4
E	Cabinet Hinges	QHL102	4
F	Ceramic Cartridge	QHL166	1
G	Sprayer Head	QHL181	1
H	Strainer Assembly	QHL176	1
J	Strainer Basket	QHL177	1

Imported by / Importé par :

Conglom
KITCHEN & BATH

St-Laurent, Québec, H4S 2C3

1-877-333-0098 | cs@conglomkb.com

(service available in English and French, Monday - Friday from 8:30 am - 5 pm EST)

(service disponible en anglais et français, du lundi au vendredi, 8h30 à 17h, H.N.E.)

Made in China / Fabriqué en Chine

