

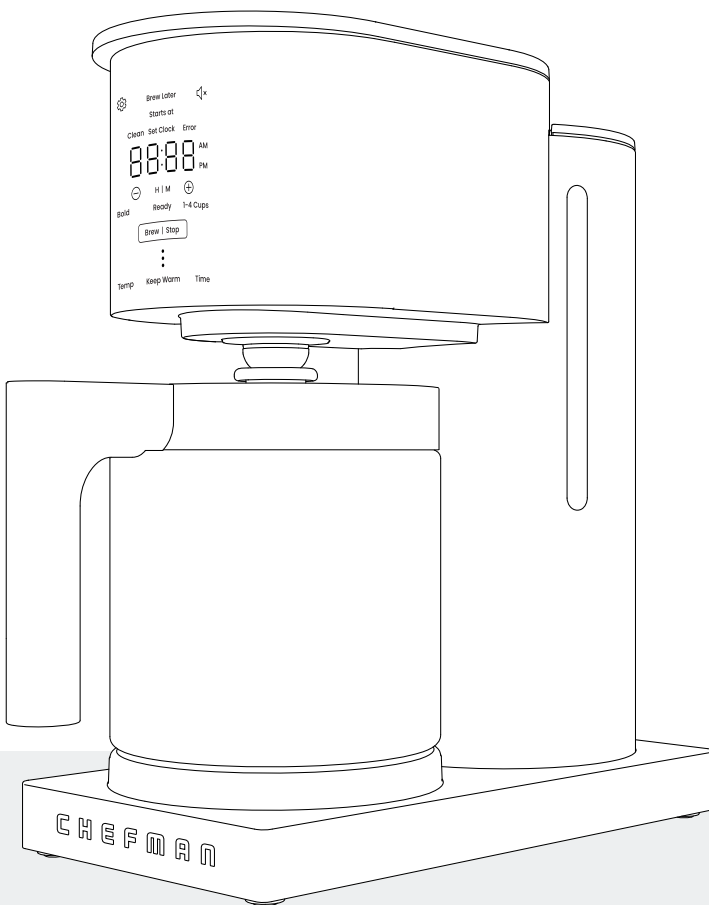

C H E F M A N

Caffeinator Drip™



C14-DR14-1-US-SERIES







Table of Contents

4	Get to Know Your Coffee Maker
6	Control Panel
7	Safety Instructions & Important Safeguards
10	Before First Use
11	Quick Start: How to Make Coffee
15	Special Functions and Features
17	Having Trouble?
18	Keep It Clean
20	Terms & Conditions
23	Warranty Registration





Get to Know Your Coffee Maker

1. Control panel
2. Extra-wide brewing showerhead
3. Brew chamber lid
4. Water reservoir lid
5. Water reservoir
6. Water level viewing window
7. Removable water filter assembly
8. Coffee scoop
9. Heating plate
10. 14-cup tempered glass carafe
11. BalancedBrew™ funnel
12. Carafe lid with locking knob
13. Removable filter holder
14. Reusable GoldTone® filter



READ ALL INSTRUCTIONS BEFORE USE

For your safety and continued enjoyment of this product, always read the instruction manual before using.



Get to Know Your Coffee Maker

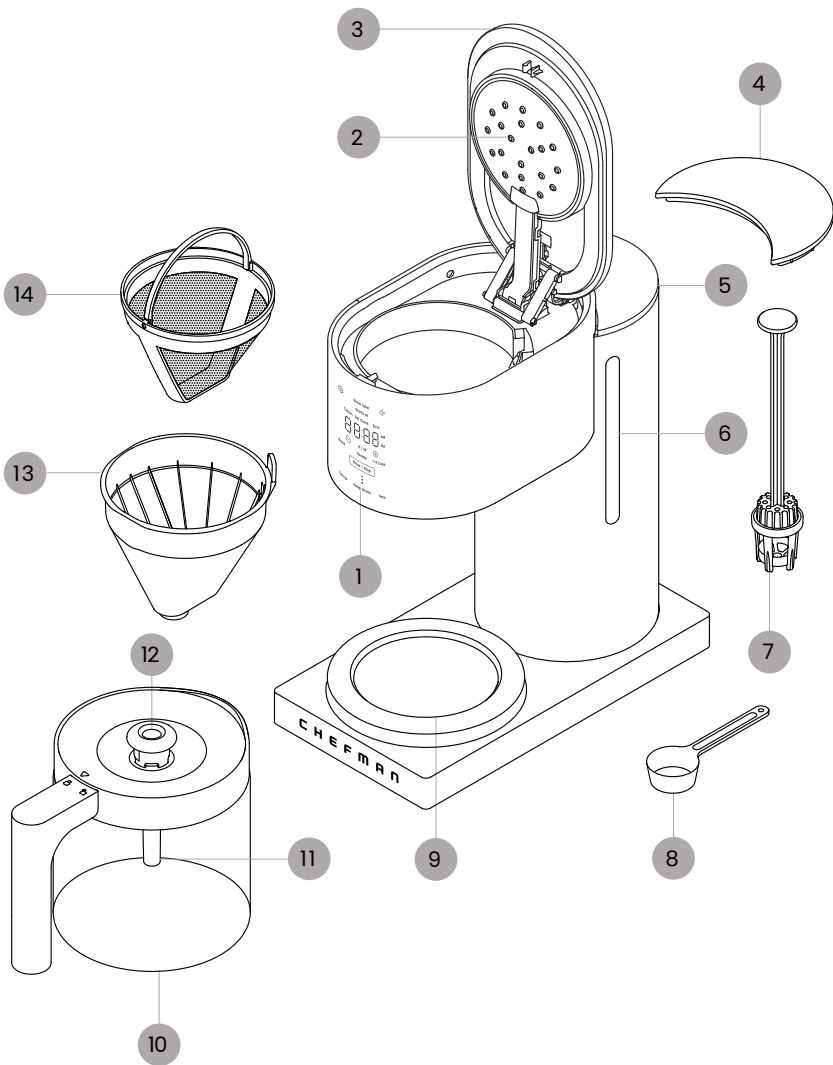



Control Panel

1. Settings button
2. Brew Later indicator/button
3. Set Clock button
4. Mute On | Off button
5. Error warning light
6. Digital time display
7. Time + | - buttons
8. Small batch selector button
9. Brew | Stop button
10. Progress lights
11. Keep Warm Time adjustment button
12. Keep Warm button
13. Keep Warm Temperature adjustment button
14. Ready light
15. Bold selector button
16. Clean button
17. Brew time indicator light (Starts at)

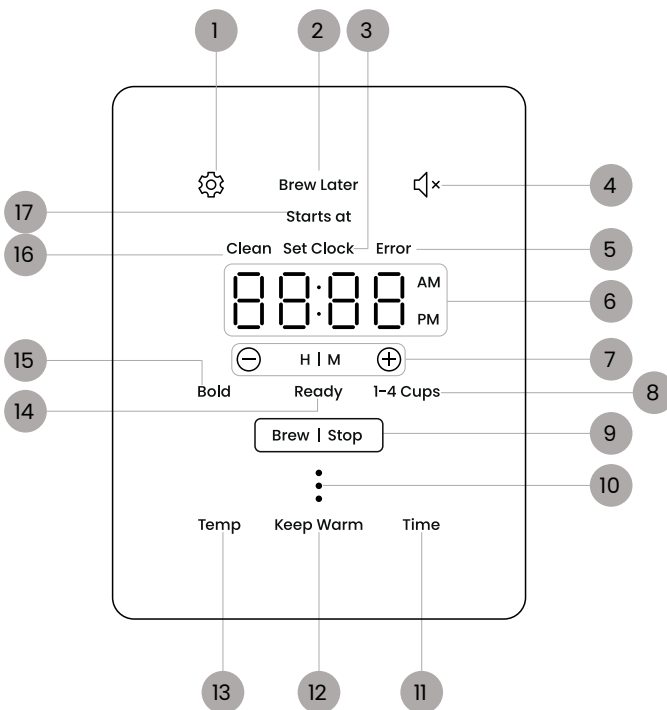



SAFETY INSTRUCTIONS & IMPORTANT SAFEGUARDS

WARNING: When using electrical appliances, basic safety precautions should always be followed, including:

1. Read all instructions.
2. **Do NOT** touch hot surfaces. Use handle or knobs.
3. To protect against fire, electric shock and injuries to persons, **do NOT** immerse cord, plug charging base, or unit in water or other liquid.
4. Close supervision is necessary when any appliance is used by or near children.
5. Unplug from outlet when not in use and before cleaning. Allow to cool before putting on or taking off parts, and before cleaning the appliance.
6. **Do NOT** operate any appliance with a damaged cord or plug or after the appliance malfunctions, or has been damaged in any manner. If this should occur, contact Chefman Customer Service.
7. The use of accessory attachments not recommended by Chefman may result in fire, electric shock, or injury to persons.
8. **Do NOT** use outdoors.
9. **Do NOT** let cord hang over edge of table or counter, or touch hot surfaces.
10. **Do NOT** place on or near a hot gas or electric burner, or in a heated oven.
11. To disconnect, turn any control to off, then remove plug from wall outlet.
12. **Do NOT** use appliance for other than intended use.
13. Scalding may occur if lid is opened during heating cycle.

SAVE THESE INSTRUCTIONS FOR HOUSEHOLD USE ONLY





SAFETY INSTRUCTIONS & IMPORTANT SAFEGUARDS

WARNING: This appliance has a polarized plug (one blade is wider than the other). This plug is intended to fit into a polarized outlet only one way. If the plug does not fit fully into the outlet, reverse the plug. If it still does not fit, contact a qualified electrician. Do not attempt to modify the plug in any way or force it into the outlet. This could result in injury or electric shock.

Short Cord Instructions

A short power-supply cord is provided to reduce the hazards of entanglement or tripping over a longer cord. Longer detachable power-supply cords or extension cords are available and may be used if care is exercised in their use. If a longer detachable power-supply extension cord is used:

1. The marked electrical rating of the extension cord should be at least as great as the electrical rating of the appliance;
2. The longer cord should be arranged so that it will not drape over the countertop or tabletop where it can be pulled on by children or tripped over.



SAFETY INSTRUCTIONS & IMPORTANT SAFEGUARDS

Power Cord Safety Tips

1. Never pull or yank on cord or the appliance.
2. To insert plug, grasp it firmly and guide it into outlet.
3. To disconnect appliance, grasp plug and remove it from outlet.
4. Never use the product if the power cord shows signs of excessive wear. Contact Chefman Customer Support for additional guidance and support.
5. Never wrap the cord tightly around the appliance, as this could place undue stress on the cord where it enters the appliance and cause it to fray and break.

**DO NOT OPERATE APPLIANCE IF THE POWER CORD SHOWS ANY DAMAGE
OR IF APPLIANCE WORKS INTERMITTENTLY OR STOPS WORKING ENTIRELY**

California Proposition 65:

(Applicable for California Residents only)
WARNING: Cancer and Reproductive Harm
www.P65Warnings.ca.gov

Do not place the appliance on a
stovetop or any other heatable
surface, even if stovetop is not on.
Doing so is a fire hazard.



Before First Use

1. Remove all packing materials and stickers from the inside and outside of the unit. Be sure that all parts are included before throwing out packaging.
2. Gently wipe down the exterior with a damp cloth or paper towel. Never immerse the coffee maker, its base, cord, or plug in water or any other liquid. The electrical connections and the brew buttons must never come into contact with water or any other liquid.
3. Remove and hand wash the carafe, carafe lid and funnel, coffee filter holder, reusable coffee filter, and water filter assembly with warm, soapy water. Rinse and dry well before returning them to the unit.
4. Set the clock: To set the clock for the current time, press the **Settings** button (gear icon), then press **Set Clock**. Use the + and - buttons to set clock to the current time, using the **H | M** button to toggle between adjusting hours and adjusting minutes. **NOTE:** The unit uses a 12-hour clock so be sure the AM or PM setting is correct. Press **Set Clock** again to confirm the time, then the **Settings** button to exit the Settings menu.
5. Install the water filter: Soak the charcoal water filter cartridge in water for about 5 minutes, then rinse for about 60–90 seconds.
6. Pull the cap of the water filter assembly off the basket and place the cartridge in the basket. Snap the cap back into place.
7. Lower the filter assembly, basket-side down, into the water reservoir and insert it into the port at the bottom of the reservoir to lock it in place. Fill the reservoir to the 4-cup mark. The filter cartridge will bubble until it's fully saturated.
8. Clean the brewer's internal parts of any manufacturing residue: with the reservoir still filled to the 4-cup mark, place the filter holder and (empty) reusable filter in the brew chamber, and place the carafe on the heating plate.
9. Set the coffee maker to brew 1–4 cups using the Small Batch Setting (see p. 16). The unit will "brew" a pot of plain water.
10. When the brewing cycle finishes, empty the carafe. Your coffee maker is now ready to enjoy.



Quick Start: How to Make Coffee

1. Remove the lid from the carafe: Turn the locking knob counter-clockwise to unlock, then lift off the lid.

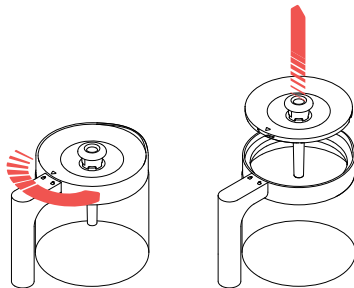

2. Fill the carafe with your desired amount of water, then remove the reservoir lid and pour it into the reservoir. Replace the reservoir lid.
NOTE: If you are brewing 4 cups or less, or want to use other settings such as Bold or Brew Later, see pages 15–16 on how to customize.

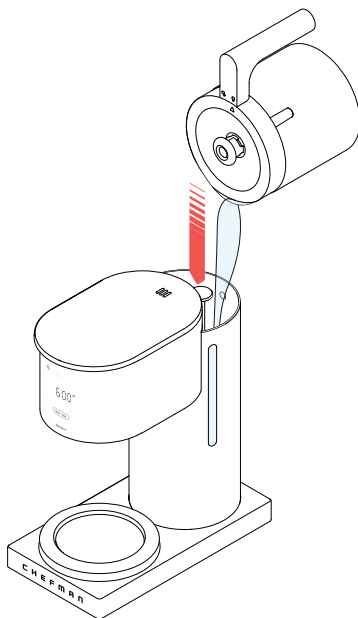



Quick Start: How to Make Coffee

3. Slide the carafe under the brew head, making sure it is properly seated on the heating plate.

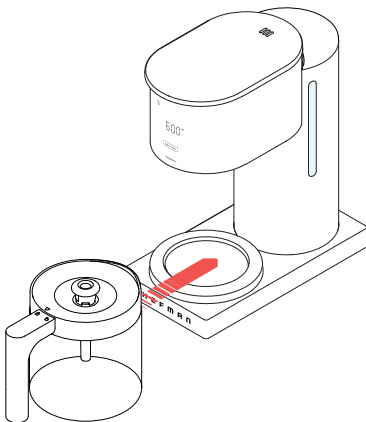

4. Place the filter holder in the brew chamber. Put **EITHER** the reusable GoldTone® filter or a disposable paper in the filter holder (do **NOT** use both). Add your desired amount of ground coffee to the filter; we recommend one scoop of grounds per cup of brewed coffee.

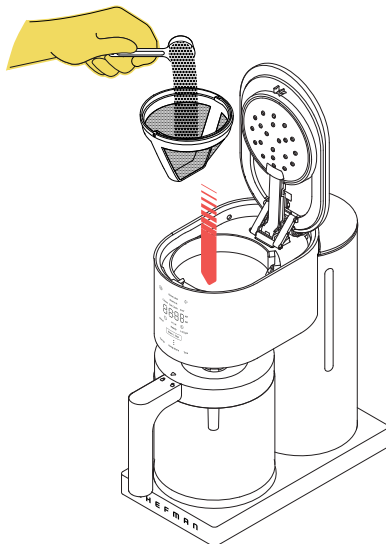



Quick Start: How to Make Coffee

5. Push the brew chamber lid down, making sure it locks closed.

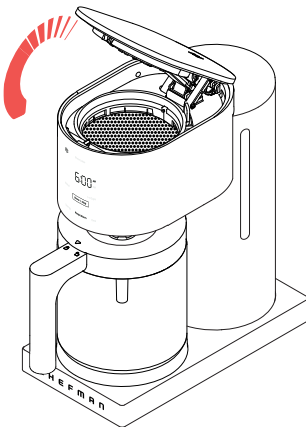

6. For simple brewing (full-pot, classic-strength), press the **Brew | Stop** button. See pages 15–16 for details on how to customize settings for strength, volume, Keep Warm function, and to program a delayed brew.

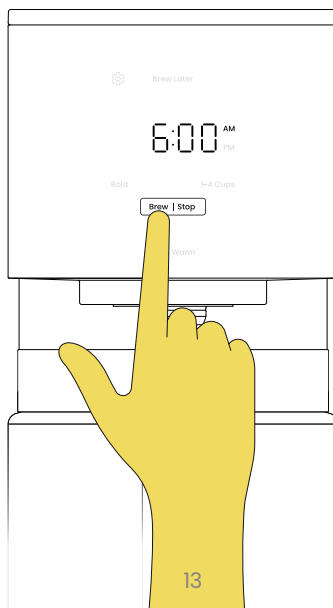



Quick Start: How to Make Coffee

- During brewing, the progress lights will illuminate one at a time. If you want to pour a cup during the brewing, you can remove the carafe and the unit will pause for 20 seconds without any coffee dripping onto the heating plate. Keep in mind, though, that the strength of coffee poured mid-cycle will differ from the finished brew and will affect the strength and flavor of the remaining coffee.

CAUTION: During brewing, steam escapes from vents on the top of the unit. Keep hands away from the vents to prevent burns.

- When the brew cycle is complete, the unit will beep, **Ready** will illuminate on the control panel, and **Keep Warm** mode will automatically begin. The clock will begin counting up the time in Keep Warm mode. (The default time is 1 hour but you can set it for up to 4 hours or turn off Keep Warm; see p. 15.)

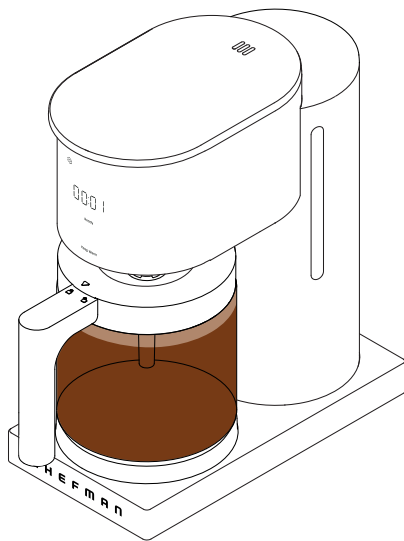



Special Functions and Features

Brew Later

If you like to wake up to a pot of freshly brewed coffee, use the Brew Later function.

NOTE: To use the Brew Later function, you must have the clock set to the current time (see p. 10, step 4). To program: press the **Brew Later** button; the words “Starts at” will illuminate on the control panel. Use the + and - buttons to set the time at which you'd like the coffee to begin brewing (be sure to select AM or PM).

To confirm the time, press the **Brew Later** button again; the unit will return to Standby mode with **Brew Later** fully illuminated.

When the programmed time occurs, the unit will begin brewing automatically. After brewing, the function turns off and the clock returns to displaying the current time. To use Brew Later daily, you'll need to activate it each day, but it will default to the previous settings (start time and other settings such as Bold) so you don't need to program them again. To check what time it is programmed to start, press the Brew Later button; the start time will illuminate for about 3 seconds then return to displaying the current time.

To cancel a scheduled Brew Later time, press and hold the **Brew Later** button for 3 seconds. Once canceled, the Brew Later LED will go from fully illuminated to dimly lit.

Keep Warm Settings – Time and Temperature

Keep Warm mode turns on the heating plate to keep your pot of coffee fresh and hot while you enjoy it. The coffee maker defaults to automatically go into Keep Warm mode for 1 hour after brewing finishes. However, you can customize the duration and temperature to your preference. To do so, Press the **Settings** button, then press either **Time** or **Temp**. Use the + and - buttons to adjust to your liking; you can set the time anywhere from 1 to 4 hours, and the temperature at level 1, 2, or 3 (3 being the hottest). When you've finished, press the **Settings** button again to confirm your selections and exit the Settings menu.

If you finish the pot of coffee before the set Keep Warm time is up, turn it off by pressing **Keep Warm**. You can also deactivate the function completely by pressing **Keep Warm** while the unit is actively brewing (it cannot be turned off while in Standby mode). In this case, it will remain off until turned back on during an active brewing cycle. When the light is brightly lit, it means Keep Warm is turned on.



Special Functions and Features

Bold Setting

For a stronger brew, the Bold setting slows the drip of water through the brew chamber, increasing the amount of time it spends infusing with coffee. To use it, press the **Bold** button, then press **Brew | Stop**. To return to regular-strength brew, press **Bold** again. **NOTE:** You can use the Bold and Small Batch settings at the same time.

Small Batch Setting

If you want to brew a smaller pot of coffee, the Small Batch setting (1-4 Cups on the control panel) adjusts how quickly water is pushed through the brew chamber, creating the optimal brew strength for a smaller pot. To use it, press the **1-4 Cups** button, then press **Brew | Stop** to begin brewing. You can also use the Bold setting for a smaller pot; simply press **Bold** while setting up the brew (otherwise, it will default to Classic strength). To return to a full pot, press the **1-4 Cups** button again.

Mute Function

To mute the coffee maker's beep at the end of brewing, press **Settings**, then press the **Mute On | Off** button. The icon will illuminate brightly, indicating that sounds are muted. Press **Settings** again to exit the menu. To turn sound back on, press the same **Mute On | Off** button again while in the Settings menu (the icon will be dimly lit, indicating it's off).

BalancedBrew™ Funnel

The BalancedBrew™ funnel on the underside of the carafe lid directs brewed coffee to the bottom of the carafe rather than dripping it to the top. This distributes and mixes the coffee more evenly so that you have the same strength and flavor throughout.

Wide Showerhead

The Caffeinator Drip boasts an extra-wide showerhead, which saturates the coffee grounds evenly, for uniform flavor extraction.

Blooming Cycle

The Caffeinator Drip features an automatic blooming function: At the start of the brewing cycle, it releases just enough water to dampen the grounds, then pauses for several seconds before continuing to brew. This maximizes the water's contact time with the grounds for a fuller flavor.



Having Trouble?

Problem	Likely Cause	Solution
Filter basket overflows	<ol style="list-style-type: none">1. Too much ground coffee in the basket.2. Using the mesh filter together with a paper filter.	<ol style="list-style-type: none">1. Reduce the amount of ground coffee when setting up a brew.2. Use the mesh filter OR a paper filter, but not both together.
Coffee isn't hot enough or takes too long to brew.	Calcium deposits have built up in the unit's internal parts, inhibiting the flow of water.	Descale the unit, following the instructions on p. 19.
After setting up Brew Later, coffee doesn't brew at selected time.	<ol style="list-style-type: none">1. Brew time is set to PM instead of AM.2. Brew Later isn't reset after first day's use.3. Water reservoir wasn't refilled.	<ol style="list-style-type: none">1. Be sure to select AM or PM properly when setting up Brew Later.2. Though you don't need to reset the brew time every day if you want your coffee at the same time, you do need to re-activate it each day (simply press Brew Later twice from the main screen).3. When setting up Brew Later, be sure to also fill the reservoir with enough water.



Keep It Clean

Regular cleaning after each use is minimal and will keep your coffee maker in top shape. Additionally, your coffee maker has a self-cleaning program that makes descaling the unit a breeze.

For Daily Cleaning

1. Make sure the unit is completely cool before cleaning.
2. Remove the carafe lid and empty any leftover coffee. Wash the carafe and lid with warm, soapy water. Rinse and dry thoroughly and return to the unit. The carafe and lid are also top-rack dishwasher safe.
3. Open the brew chamber and lift out the filter holder. If the reusable filter was used, tip and knock it gently into a sink or trash bin to empty the grounds. If a paper filter was used, discard it along with the grounds.
4. Wash the filter holder and reusable filter (if used) with warm, soapy water. Rinse and dry thoroughly. Return them to the unit and close the brew chamber lid. The filter holder and filter are NOT dishwasher safe.
5. Wipe down the heating plate and base of the unit with a damp cloth or sponge, if needed. Never immerse the coffee maker or its plug in water.
6. Replace the charcoal water filter cartridge at least every 30 to 60 days, following the instructions on page 19.



Keep It Clean

To Descale the Caffeinator Drip™

Calcium buildup (or “scale”), caused over time by minerals commonly found in water, can adversely affect brewing. We recommend descaling the unit after 100 brew cycles. To run the cleaning cycle:

1. Prepare a commercial descaler according to the package directions OR a 50/50 mix of water and distilled vinegar. Fill the water reservoir completely with the mixture.
2. Place the carafe under the brew head.
3. Press the **Settings** button to enter the Settings menu. From there, press the **Clean** button. The unit will cycle the cleaning solution through its internal parts and dispense into the carafe.
4. When the cycle has finished, discard the liquid in the carafe. Repeat the cycle with another tank full of descaling solution.
5. Refill the water reservoir with fresh water.
6. Repeat the cleaning cycle, again emptying the carafe after it finishes brewing. Refill the water reservoir with fresh water and run the cycle a second time to thoroughly rinse out the system.
7. Press **Clean** button to return to Standby mode.

Replacing the Filter

If the optional charcoal water filter cartridge is used, we recommend changing it at least every 30 to 60 days. To order replacement cartridges, scan the QR code below.

To replace the filter:

1. Remove the filter assembly from the water reservoir.
2. Pull off the cap (attached to the stalk) and discard the old charcoal filter cartridge.
3. Place a new cartridge in the basket and replace the cap.
4. Re-install the filter assembly in the water reservoir (see p. 10, steps 5–7).



Scan here to order replacement water filter cartridges for your Caffeinator Drip™.



Terms & Conditions

Limited Warranty

RJ Brands, LLC d/b/a Chefman® offers a limited 5-year Warranty (the “Warranty”) available on sales through authorized distributors and retailers only. Please note that this Warranty becomes valid from the date of initial retail purchase and that the Warranty is nontransferable and applies only to the original purchaser.

This Warranty is void without proof of purchase within the United States and Canada. Please be aware that this Warranty supersedes all other warranties and constitutes the entire agreement between the consumer and Chefman®. Any changes to the Terms and Conditions of this Warranty must be in writing, signed by a representative of Chefman®. No other party has the right or ability to alter or change the Terms and Conditions of this Warranty.

We may ask you to please submit, via email, photos and/or video of the issue you are experiencing. This is to help us better assess the matter and possibly offer a quick fix. Photos and/or video may also be required to determine Warranty eligibility.

We encourage you to register your product. Registering can make the Warranty process easier and can keep you informed of any updates or recalls on your product. To register, follow the directions on the Chefman® Warranty Registration page in the Chefman® User Guide. Please retain your proof of purchase even after registering. In the event that you do not have proof of your purchase date, we may declare your Warranty void or we may, at our sole discretion, apply the date of manufacture as the purchase date for purposes of this Warranty.



What the Warranty Covers

- **Manufacturer Defects**

Chefman® products are warranted against defects in material and workmanship, under normal household use, for a period of 5 years from the date of purchase when used in accordance with the directions listed in the Chefman® User Guide. If your product does not work as it should, please contact Customer Support at support@chefman.com so that we may assist you;

This Warranty Does Not Cover

- **Misuse**

Damage that occurs from neglectful or improper use of products, including, but not limited to, damage that occurs as a result of usage with incompatible voltage, regardless of whether the product was used with a converter or adapter. See Safety Instructions in the Chefman® User Guide for information on proper use of product;

- **Poor Maintenance**

General lack of proper care. We encourage you to take care of your Chefman® products so that you may continue to enjoy them. Please see Keep It Clean directions in this Chefman® User Guide for information on proper maintenance;

- **Commercial Use**

Damage that occurs from commercial use;

- **Normal Wear and Tear**

Damage or degradation expected to occur due to normal use over time;

- **Altered Products**

Damage that occurs from alterations or modifications by any entity other than Chefman® such as the removal of the rating label affixed to the product;

- **Catastrophic Events**

Damage that occurs from fire, floods, or natural disasters; or

- **Loss of Interest**

Claims of loss of interest or enjoyment.



Terms & Conditions

For product information, please visit us at Chefman.com.

EXCEPT WHERE SUCH LIABILITY IS REQUIRED BY LAW, THIS WARRANTY DOES NOT COVER, AND CHEFMAN® SHALL NOT BE LIABLE FOR, INCIDENTAL, INDIRECT, SPECIAL, OR CONSEQUENTIAL DAMAGES, INCLUDING WITHOUT LIMITATION, DAMAGE TO, OR LOSS OF USE OF THE PRODUCT, OR LOST SALES OR PROFITS OR DELAY OR FAILURE TO PERFORM THIS WARRANTY OBLIGATION. THE REMEDIES PROVIDED HEREIN ARE THE EXCLUSIVE REMEDIES UNDER THIS WARRANTY, WHETHER BASED ON CONTRACT, TORT OR OTHERWISE.



Warranty Registration

What do I need to register my product?

- Contact Information
- Model Number (see example below)
- Proof of Purchase (online confirmation, receipt, gift receipt)
- Date Code (see example below)
- Access Code (see example below)

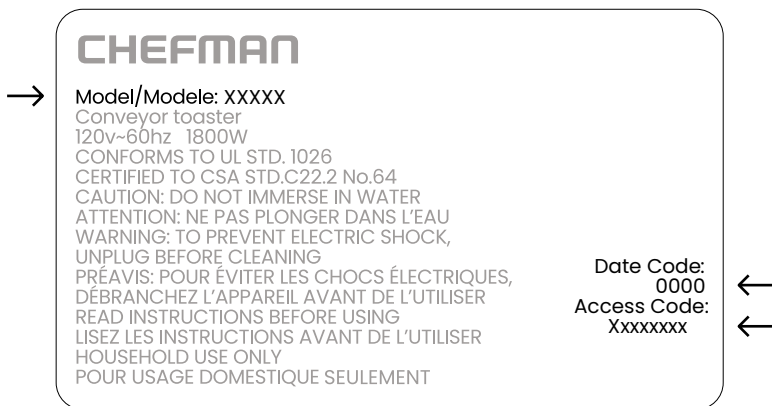

NOTE: Label depicted here is an example.

Please see label on your product for actual model/date code/access code.

How do I register my product?

All you need to do is fill out a simple Chefman® registration form. You can easily access the form in one of the two ways listed below:

- Visit Chefman.com/register.
- Scan the QR code to the right to access site.





C14DR141US-SERIESUG061825

Chefman® is a registered trademark of RJ Brands, LLC.

Caffeinator Drip™ is a trademark of RJ Brands, LLC.

BalancedBrew™ is a trademark of RJ Brands, LLC.

GoldTone® is a registered trademark of Manufacturers Components, Inc.

