

ICE MAKER

USER MANUAL

MERI26B1AGY

MERI26B1AGN

Warning notices: Before using this product, please read this manual carefully and keep it for future reference. The design and specifications are subject to change without prior notice for product improvement. Consult with your dealer or manufacturer for details. The diagram above is just for reference. Please take the appearance of the actual product as the standard.

THANK YOU LETTER

Thank you for choosing Midea! Before using your new Midea product, please read this manual thoroughly to ensure that you know how to operate the features and functions that your new appliance offers in a safe way.

CONTENTS

SAFETY INSTRUCTIONS	1
SPECIFICATIONS	4
PRODUCT OVERVIEW	5
OPERATION INSTRUCTIONS	6
CLEANING AND MAINTENANCE	9
TROUBLESHOOTING	11

SAFETY INSTRUCTIONS





Intended use

Before switching on the appliance for the first time read the following safety information!

This appliance is intended to be used in household and similar applications such as staff kitchen areas in shops, offices and other working environments; farm houses and by clients in hotels, motels and other residential type environments; bed and breakfast type environments; catering and similar non-retail applications.

If the appliance is used commercially please note that the manufacturer cannot accept any liability for any damage.

Explanation of symbols

	DANGER This symbol indicates that there are dangers to the life and health of persons due to extremely flammable gas.
	WARNING OF ELECTRICAL VOLTAGE This symbol indicates that there is a danger to life and health of persons due to voltage.
	WARNING The signal word indicates a hazard with a medium level of risk which, if not avoided, may result in death or serious injury.
	CAUTION The signal word indicates a hazard with a low degree of risk which, if not avoided, may result in minor or moderate injury.
	ATTENTION The signal word indicates important information (e.g. damage to property), but not danger.



WARNING

Risk of fire/Flammable materials

- **DANGER** Risk of fire or explosion. Flammable refrigerant used. Do not use mechanical devices to defrost refrigerator. Do not puncture refrigerant tubing.
- **DANGER** Risk of fire or explosion. Flammable refrigerant used. To be repaired only by trained service personnel. Use only manufacturer authorized service parts. Any repair equipment used must be designed for flammable refrigerants. Follow all manufacturer repair instructions. Do not puncture refrigerant tubing.



WARNING General safety

- Install in accordance with the manufacturer's instructions. The unit is for indoor house-hold use only.
- This product should not be recessed or built-in an enclosed cabinet. It is designed for freestanding installation only. Ensure a minimum of three inches of clearance around the side and back walls of the unit for proper air circulation.
- Keep ventilation openings, in the product, clear of obstruction.
- Do not install or operate the machine in a sealed space, such as a closed room.
- Use the machine in a well-ventilated area with a temperature, between 50°F and 90°F.
- Do not install near any heat sources, such as radiators, heat registers, stoves, other cooking appliances or in direct sunlight.
- Do not store or use gasoline or any flammable liquids inside or in the vicinity of this appliance.
- Do not clean the ice machine with flammable liquid. Failure to do so may result in fire or explosion.
- Do not use mechanical devices or other means to accelerate the defrosting process, other than those recommended by the manufacturer.
- Do not damage the refrigerant circuit.
- Do not use if the service life is exceeded.
- Only dispose of the unit according to Federal and Local Regulations. Used device must be returned to official collection point for recycling of electrical electronic devices. To find these collection systems please contact to your local authorities or retailer where the product was purchased.



WARNING Electrical safety

- Voltage power from outlet must match specifications on appliance nameplate.
- This appliance must be grounded.
- Do not squeeze or twist the power cord of the ice machine.
- If the power cord is damaged, it must be replaced by a manufacturer, service agent or similar qualified person to avoid danger.
- Using an extension cord may cause overheating and increase the risk of fire.
- If an extension cord **MUST** be used:
Only use an extension cord with grounding plug.
The marked rating of an extension cord or greater than the rating of this appliance.

- Do not operate if any component, including the cord or plug is damaged.
- Unplug the unit before cleaning by hand.
- Do not touch the evaporator with your hands while the ice maker is operating.
- Do not plug in or unplug the unit with wet hands.
- Do not immerse any part of the unit in water.



WARNING Child safety

- This appliance is not intended for use by persons (including children) with reduced physical, sensory or mental capabilities, or lack of experience and knowledge, unless they have been given supervision or instruction concerning use of the appliance by a person responsible for their safety.
- Do not place the power cord where it could be pulled by children or pose a tripping hazard.
- Children should not be left unattended near the ice maker during operation.
- Children should be supervised to ensure that they do not play with the appliance.
- Destroy carton, plastic bags, and any exterior wrapping material immediately after the product is unpacked.



WARNING

State of California Proposition 65 Warnings:

- This product can expose you to chemicals including lead, which is known to the State of California to cause cancer, and bisphenol A (BPA) and lead which are known to the state of California to cause birth defects or other reproductive harm. For more information go to **www.P65Warnings.ca.gov**.

SPECIFICATIONS

Product model	MER126B1AGY/MER126B1AGN
Voltage/Frequency	AC115V /60Hz
Working Power	140W
Electric Current	1.6A
Water Reservoir	0.34 gal(1.3L)
Ice Basket Capacity	1 lbs(0.45kg)
Ice-Making Rate	26 lbs per Day
Ice Shape	Bullet
Ice Size	Small or Large
Material	GPPS, ABS, PP, HIPS
Net Weight	14.55 lbs(6.6kg)
Unit Size	11.6 x 8.4 x 11.6 in (295.7 x 213 x 295mm)

PRODUCT OVERVIEW

Names of components

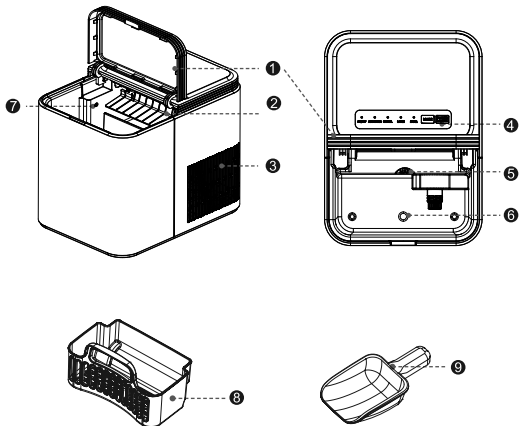

- | | | | |
|---|-------------------------|---|---------------|
| 1 | Large Viewing Window | 2 | Ice Shovel |
| 3 | Air Exhaust Fan | 4 | Control Panel |
| 5 | Maximum Water Fill Line | 6 | Drain Plug |
| 7 | Ice Full Sensor | 8 | Ice Basket |
| 9 | Ice Scoop | | |

ATTENTION

- The picture above is only for reference. The actual configuration will depend on the physical product or statement by the distributor

OPERATION INSTRUCTIONS

Control panel operation

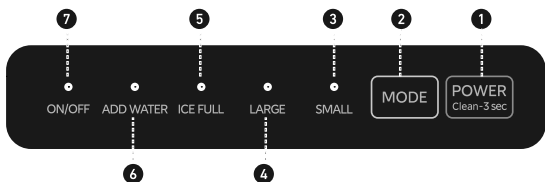

	Key (with indicator)	Function
1	POWER Clean-3 sec	Short press the POWER/Clean-3 sec button to turn the ice maker on.
		Short press the POWER/Clean-3 sec button to turn the ice maker off.
		In standby mode, press and hold the POWER/Clean-3 sec button for 3 seconds and the ice maker will switch to self-cleaning mode.
2	MODE	Confirms large ice mode or small ice mode.
3	SMALL	The indicator light turns white when small ice mode is selected.
4	LARGE	The indicator light turns white when large ice mode is selected.
5	ICE FULL	The indicator light turns white when the ice basket is full.
6	ADD WATER	The indicator light turns white when the water reservoir low.
7	ON/OFF	The indicator light turns white when the power button is on.
		The indicator light turns off when the power button is off.

ATTENTION

- The actual control panel may differ from model to model.

Before first use

1. Stand upright for 24hrs.

Check for accessories.

Missing parts?
Contact us.

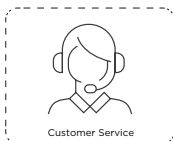
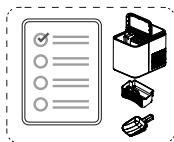
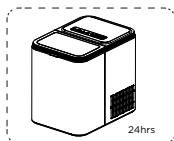

2. Clean the ice maker thoroughly before first use.

Discard first 4 cycles of ice.

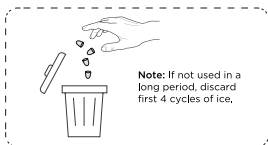
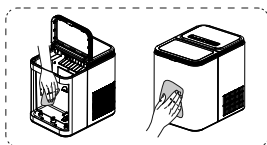

Use in locations 50°F - 90°F.

Perfect ice shape.

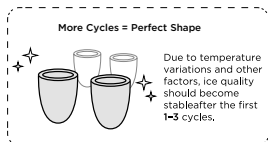
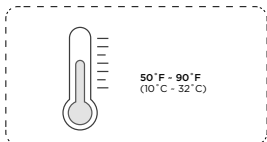

3. **What Not To Do!**
Unstable base.

No other liquids
(Drinking water only).

Do not use in high or low temps.

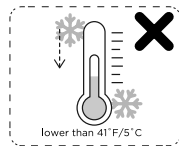
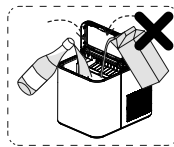
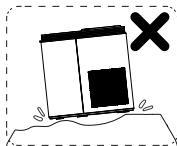

How to use your ice maker

Open cover and remove basket.

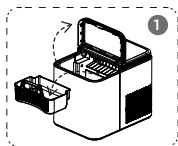

Pour water, do not exceed the "MAX" water mark.

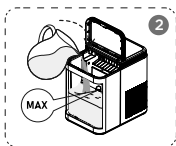

Press the **POWER** button.

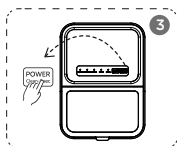

Press **MODE** button to choose ice cube size. Wait for 6mins-8mins.

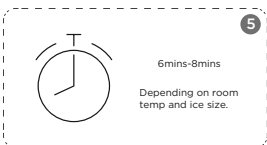
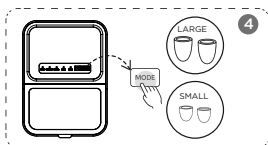

Ice full and ready when "ICE FULL" indicator turns white.

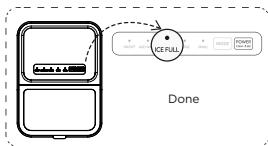

When "ADD WATER" indicator turns white, add water and press **POWER** button.
(The Power button operation interval should be greater than 3s)

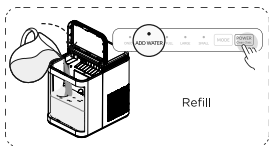

Take ice cubes out in time to avoid melting.

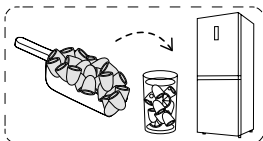

CLEANING AND MAINTENANCE

To keep your ice tasting fresh and the unit looking great, we recommend cleaning the unit once per week.

Self-cleaning

1. Remove the basket and add water.
2. Hold for 3 sec to start self-cleaning. (Complete flushing after 5 minutes)

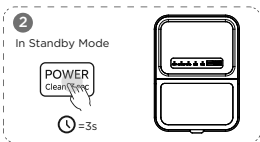
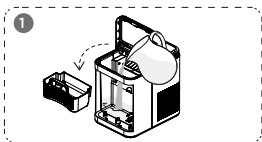

3. Drain water reservoir.

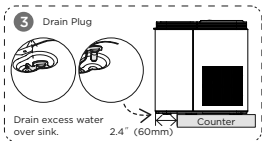

4. Clean exterior with cloth and mild dishwashing soap.

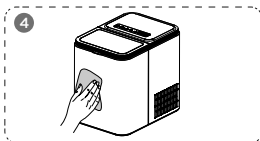

Manual cleaning

Turn off the unit and disconnect from power outlet before cleaning.

1. Remove the basket.
2. Clean using a soft cloth with warm water and vinegar. Clean the water filter, ice shovel and the evaporator to avoid dirt buildup.

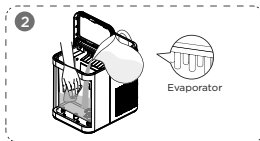
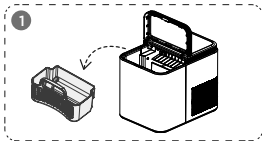

3. Drain water reservoir.

4. Clean exterior with cloth and mild dishwashing soap.

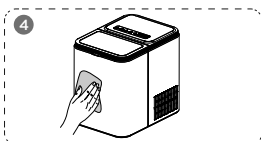
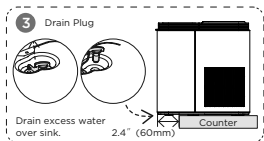

CAUTION

DO's & DON'Ts while cleaning and maintaining

- Do not use organic solvent, boiled water, detergent, strong acid and strong alkali etc. for cleaning.
- When the unit is not to be used for a long duration, drain the water completely & dry the interior.
- Store in a well-ventilated area.

TROUBLESHOOTING

The following simple issues can be handled by the user. Please call the after-sale service department if the issues are not solved.

Problem	Possible Causes	Solution
Poor ice shape or quality.	Poor heat dissipation.	Leave a 3-inch clearance on all sides of the ice maker for ventilation.
	The water temperature is too high.	Fill with water temperature between 46°F and 77°F.
	The water temperature is too high.	Use the ice maker in room temperatures between 50°F and 90°F.
	Evaporator deformation.	Please contact customer service.
Ice maker creating loud noise.	Ice maker has not been cleaned for a long time, which will form a sticky substance around the inlet of the water pump.	Clean every 1 to 2 weeks, using some neutral cleaning agents (such as mild vinegar solution and soapy water).
	Lack of water to pump will create noise when pumping water.	Add more water.
	Fan or ice maker is damaged.	Please contact customer service.
	Water pump is damaged.	
"ICE FULL" indicator light is on.	Ice is blocking the infrared sensor.	Empty the ice basket. (After the full ice warning is cleared, the compressor will restart and ice making will resume within 2 minutes.)
	Infrared sensors do not work.	1. Wipe the infrared sensors clean. 2. Contact customer service if the infrared sensors still don't work.
Ice sticks together.	Making ice takes too long.	Stop making ice. After the ice melts, restart and try again. Check the ice-making mode is set to "large ice" mode, switch to "small ice" mode."
	The water temperature or ambient temperature is too low.	Fill with water temperatures between 46°F and 77°F.
	Evaporator deformation.	Please contact customer service.

Problem	Possible Causes	Solution
Not making ice.	Ambient or water temperature is too high.	Please contact customer service.
	Water pump is damaged.	
	Refrigerating system leaking.	
	Refrigerating system blocked.	
	The fan stopped working.	
	The wires are loose.	
The gears in the motor are broken.		
"ADD WATER" indicator light is on.	Water tank water level is too low, cannot start ice making.	Add water, press the POWER button to restart the machine, and once the water shortage prompt is resolved, the ice-making will begin.

TRADEMARKS, COPYRIGHTS AND LEGAL STATEMENT

 Mideaogo, word marks, trade name, trade dress and all versions thereof are valuable assets of Midea Group and/or its affiliates ("Midea"), to which Midea owns trademarks, copyrights and other intellectual property rights, and all goodwill derived from using any part of an Midea trademark. Use of Midea trademark for commercial purposes without the prior written consent of Midea may constitute trademark infringement or unfair competition in violation of relevant laws.

This manual is created by Midea and Midea reserves all copyrights thereof. No entity or individual may use, duplicate, modify, distribute in whole or in part this manual, or bundle or sell with other products without the prior written consent of Midea.

All the described functions and instructions were up to date at the time of printing this manual. However, the actual product may vary due to improved functions and designs.

DISPOSAL AND RECYCLING

Important instructions for environment

This symbol indicates that this product shall not be disposed with other household wastes at the end of its service life. Used device must be returned to official collection point for recycling of electrical electronic devices. To find these collection systems please contact to your local authorities or retailer where the product was purchased. Each household performs important role in recovering and recycling of old appliance. Appropriate disposal of used appliance helps prevent potential negative consequences for the environment and human health.



Compliance with RoHS Directive

The product you have purchased complies with EU RoHS Directive (2011/65/EU). It does not contain harmful and prohibited materials specified in the Directive.

Package information

Packaging materials of the product are manufactured from recyclable materials in accordance with our National Environment Regulations. Do not dispose of the packaging materials together with the domestic or other wastes. Take them to the packaging material collection points designated by the local authorities.



DATA PROTECTION NOTICE

For the provision of the services agreed with the customer, we agree to comply without restriction with all stipulations of applicable data protection law, in line with agreed countries within which services to the customer will be delivered, as well as, where applicable, the EU General Data Protection Regulation (GDPR).

Generally, our data processing is to fulfil our obligation under contract with you and for product safety reasons, to safeguard your rights in connection with warranty and product registration questions. In some cases, but only if appropriate data protection is ensured, personal data might be transferred to recipients located outside of the European Economic Area.

Further information are provided on request. You can contact our Data Protection Officer via MideaDPO@midea.com. To exercise your rights such as right to object your personal data being processed for direct marketing purposes, please contact us via MideaDPO@midea.com. To find further information, please follow the QR Code.



make yourself at home



www.midea.com

© Midea 2022 all rights reserved