

## PEDALS AND CRANKS

**!** Attachment of an incorrect pedal into a crank arm can strip pedal threads and cause irreparable damage. Before your first ride, please check to ensure your pedals are attached securely and correctly.

1. Look for the letters **(1)** "R" for right, and "L" for left, stamped on each pedal spindle. Start each pedal spindle **(4)** by hand to avoid stripping the threads. (note that the right hand pedal attached to the chainwheel side crank arm with a right-hand (clockwise) **(2)** thread. The left pedal attached to the other crank arm and has a left-hand (counter-clockwise thread)**(3)**). Tighten with the 15mm pedal wrench provided. It is very important that you check the crank set for correct adjustment and tightness before riding your bicycle.

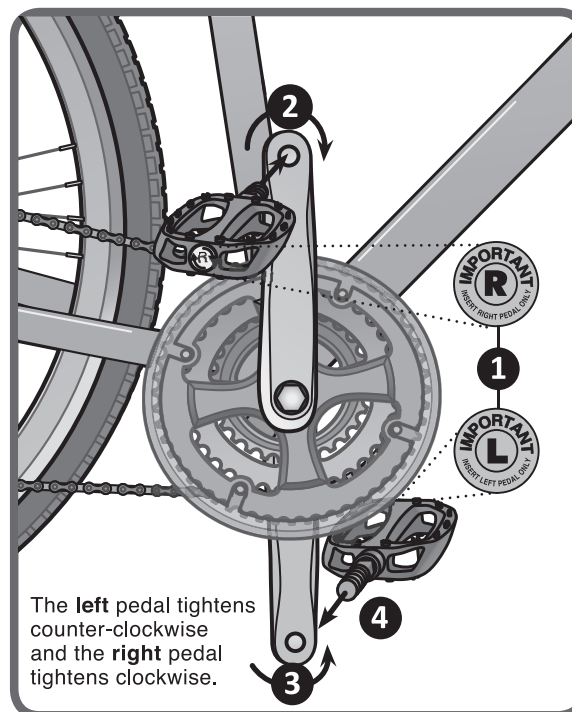

## TOOLS SUPPLIED

- 3 Way Allen Tool, 4mm, 5mm, 6mm
- 15mm Open End Pedal Wrench/15mm Closed Box Wrench

## SERVICE AND TECHNICAL SUPPORT

<http://www.infinitycycleworks.com/video>

**TOLL FREE 1-855-521-1127**

Monday - Friday 8:00 a.m. To 4:00 p.m. Pacific Time  
Closed on Canadian Statutory Holidays

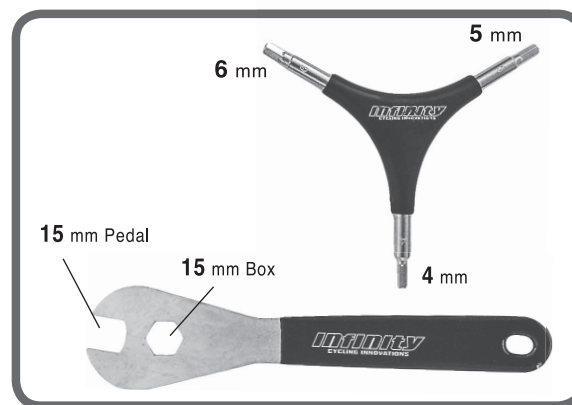

## FINAL CHECK

- !** Never inflate a tire beyond the maximum pressure marked on the tire's sidewall. Exceeding the recommended pressure may blow the tire off the rim, which could damage to the bicycle and injury to the rider and bystanders.
- !** Tighten both front/rear wheel axle nuts or the quick release mechanism securely. Failure to do this, may cause the front/rear wheel to dislodge from the frame dropouts resulting in serious damage or injury.
- !** Be sure to double check that all quick release and bolts are secure before riding.
- !** Always wear a helmet.
- !** Check that the stem is tight by holding the front wheel between your legs, then try to move the handlebar assembly side to side. If the handlebar assembly moves remove the dust cap, and tighten the stem bolt.
- After all adjustments have been made, shift through every gear several times at varying speeds. This will ensure all your adjustments are correct and will allow you to pinpoint any trouble areas. If you encounter any problems, refer to the appropriate section and make any necessary adjustments.
- Check the tire pressure and inflate each tube to the recommended psi as stated on the sidewall of the tire.
- Check the kickstand operates smoothly and the kickstand bolt is secured tightly.
- Finally, examine the bicycle. Make sure all accessories are attached and all quick releases, nuts and bolts have been tightened securely.
- Correct maintenance of your bicycle will ensure many years of happy riding. Service your bicycle regularly by referring to the relevant sections of this manual, OR take it to a professional bicycle shop.
- Remember: Always wear a helmet and obey all traffic laws.

## TOOLS FOR ASSEMBLY ARE INCLUDED

Your new bicycle was assembled and tuned in the factory and then partially disassembled for shipping. The following instructions will enable you to prepare your bicycle for years of enjoyable cycling. For more details on inspection, lubrication, maintenance and adjustment of any area, please refer to the relevant sections in your owner's manual. Should you require replacement parts or have any questions pertaining to the assembly of your bicycle, email ([info@infinitycycleworks.com](mailto:info@infinitycycleworks.com)) or call our toll free service line (1-855-521-1127).

## Infinity HT 29 inch Mountain Bike

Here is a picture of your assembled bicycle.

Be sure to double check that all quick release and bolts are secure before riding.

Always wear a helmet.

## GETTING STARTED: CARTON

1. Open the carton from the top and carefully remove the bicycle.
2. Remove all ties and packaging included.
3. Remove rear axle/derailleur black PVC protector.
4. Remove stem black PVC protectors.



ASSEMBLY  
VIDEO LINK

## FORK DIRECTION

1. Confirm the fork is facing the right way, so that the red arrow is facing forward. (A)
2. Your model comes equipped with gears and handbrakes, you will need to be sure that the brake and shifter cables are properly routed.

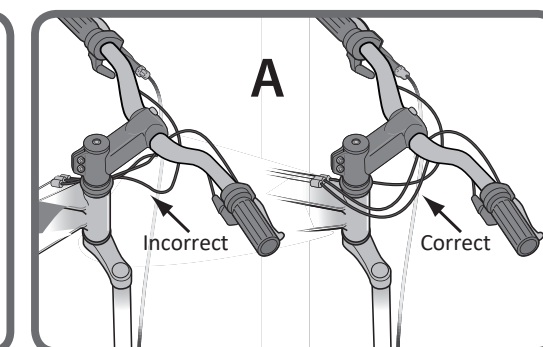
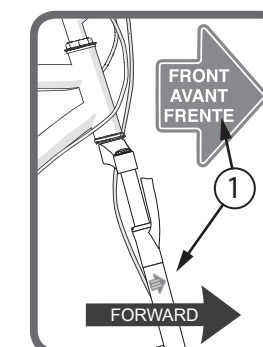

## HANDLEBAR AND STEM ASSEMBLY

1. Using Allen tool, remove the four screws holding the stem clamp in place (B). Place and center handlebars within the stem (some have centerline marks), and replace screws (C). Double check that the brake cables and shift cables are properly routed. Position the handlebar assembly as if you were going to install it, and take a look at the cables. They should run in a smooth arc from the shifter or brake lever to the front brake or cable stop on the frame. If they are twisted or kinked, the shifting and braking will not work. Rotate the handlebars around until the cables are taking the smoothest route.
2. Tighten screws with Allen tool (D). Make sure that the gap between the stem is roughly the same on the top and bottom (Fig. D, i), and the handlebars are at a comfortable riding angle (Fig. D, ii).
3. Check handlebar stem clamp bolts to be sure they are properly tightened, and handlebar can not move. The angle of the handlebar can be adjusted. To adjust; loosen all of the handlebar stem clamping bolts, and rotate the handlebar to the desired angle. Be sure that the handlebar stays centered in the stem. Retighten the bolts a LITTLE at a time being sure that the gap between the stem cap and stem stays even. Repeat tightening each bolt a little bit until handlebar is secure.

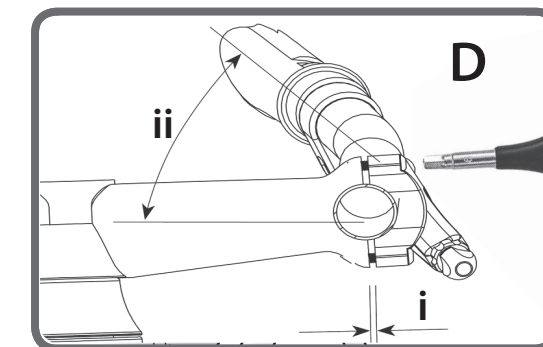
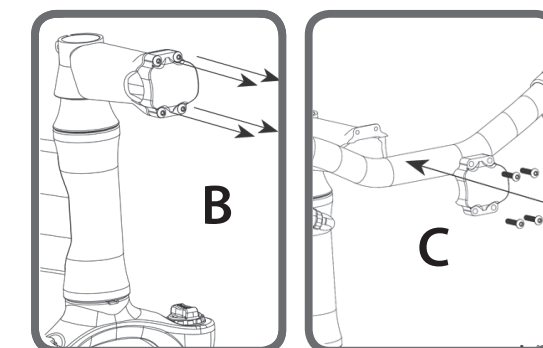

**!** Check steering tightness prior to riding by straddling the front wheel. Try turning the handlebar. If you can move it without turning the front wheel, the stem is too loose. Re-align the handlebar with the front wheel and re-tighten the stem bolt

## SADDLE ASSEMBLY

- A. The saddle assembly should be adjusted with the saddle centered on the rails and level. Insert the saddle assembly into the frame.
- B. Adjust seat to desired height (O) and tighten the quick release clam (N) so that the saddle may not turn left or right, or move up or down. If it moves after locking the quick release lever, open it and tighten the adjusting nut further, then close the quick release lever again.
- C. Be sure that the seat post is inserted far enough into the frame so that the "minimum insertion" mark on the seat post is no longer visible. Riding the bicycle with the seat post above this line is dangerous and can cause serious injury, damage to the bicycle and/or create a unstable riding position causing an accident.

**!** Before each ride check to be sure the seat post is inserted so that the minimum insertion mark cannot be seen. The quick release mechanism is tightened securely to prevent accidental slippage.

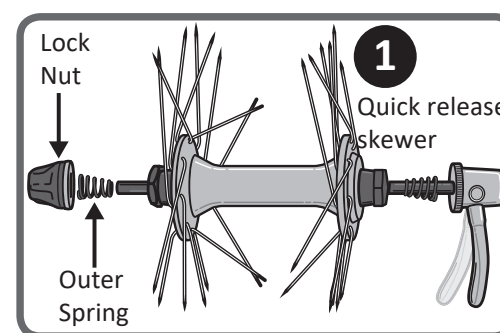
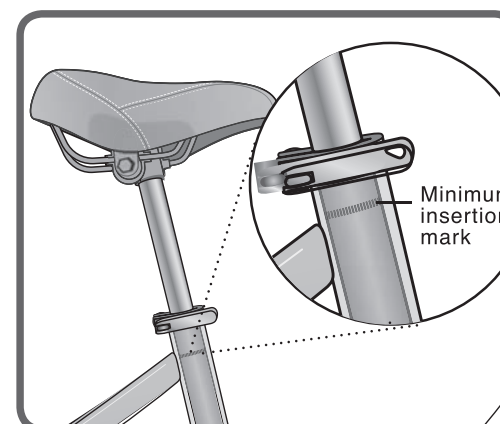
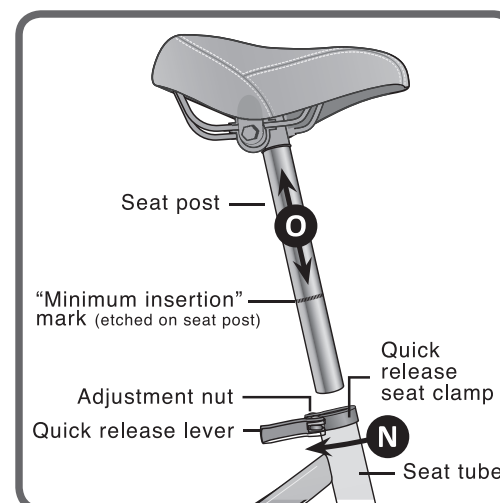

## FRONT WHEEL

VIDEO: <http://www.infinitycycleworks.com/video/>

1. Locate the quick release skewer from the small parts carton of your bicycle.
2. Unscrew the lock nut from the quick release skewer, remove outer spring and slide the skewer through the front wheel axle.
3. Install spring and then start to thread the lock nut back onto the skewer, but do not tighten too far.

4. Slide the wheel into the fork wheel slots and be sure that the wheel is centered. Your front wheel has a disc brake, insert the disc rotor into the slot on the caliper body as you insert the wheel axle into the fork drop out.
5. The handle on the quick release has an "open" and a "closed" position. Move the handle so it is in the "open" position. With one hand on the handle and one hand on the lock nut, start to hand tighten the lock nut until you start to feel some resistance with the fork.
6. Try to close the handle. If it closes easily, open it up, and tighten the lock nut further. If it is too difficult to close, open the handle, and loosen the lock nut try again.
7. The quick release handle should be difficult to push closed with your palm, but should be possible. Practice opening and closing the wheel until you feel comfortable. DO NOT attempt to tighten the wheel by turning the handle to tighten; the handle is for securing the wheel, use the lock nut for adjusting tension.

**!** All quick release levers should be inspected before every ride to be sure they are fully closed and secure. Failure to properly close a quick release lever can cause loss of control of the bicycle resulting injury or death.

**!** Make sure the wheel is properly seated and the quick release is properly closed.

## DISC BRAKES

Your bike is fitted with a front disc brake, and the components should already be attached. However, please check all connections before attempting to ride the bicycle. Secure tightly the 6 bolts that hold the disc to the front wheel hub and the 2 bolts that hold the brake mechanism to the fork. Double check that the front hub is inserted into the fork drop outs correctly and that the quick release is closed and secure.

**!** DISC GETS HOT! Severe injury could result from contact with the hot disc! Mind your legs, as well as your hands.

**!** If your bike is equipped with a front disc brake, be careful not to damage the disc, caliper or brake pads when re-inserting the disc into the caliper. Never activate a disc brake's control lever unless the disc is correctly inserted in the caliper.

**!** These brakes require breaking in! Ride and use the brakes gently for a few miles before using the brakes in downhill conditions, for sudden stops, or any other serious braking. Please be aware that your brake system will change in performance throughout the wear-in process. The disc brake should be cleaned before the first ride using rubbing alcohol. NEVER use oil or similar products to clean your disc brake system.

