

The Brondell Swash fits most residential toilets, including many contoured one-piece fixtures. Unless you have a toilet with a square bowl or unusual shape, the Swash should fit your toilet. To confirm, please double check all measurements prior to ordering. To insure proper fit, simply follow the instructions below:

- 1) Using the diagram below, measure to determine if you have a round or elongated fixture.
- 2) Measure the distance between your mounting bolt holes to determine proper fit (between 5 ¼" and 8")
- 3) Lastly, measure the distance from the center of the bolt holes to the toilet tank to determine proper clearance (must be at least 1 ½")

Please note: if the distance measured from the center of the bolt holes to the toilet tank is less than 2", the front end of the Swash may slightly extend over the front edge of your toilet bowl as there may not be enough room to slide the seat all the way back.

If you have any questions regarding compatibility or fit, please give Brondell a call toll free at 1-888-542-3355 or send us an email: support@brondell.com

Swash Fit Diagram: S300, S900 & S1000 Series

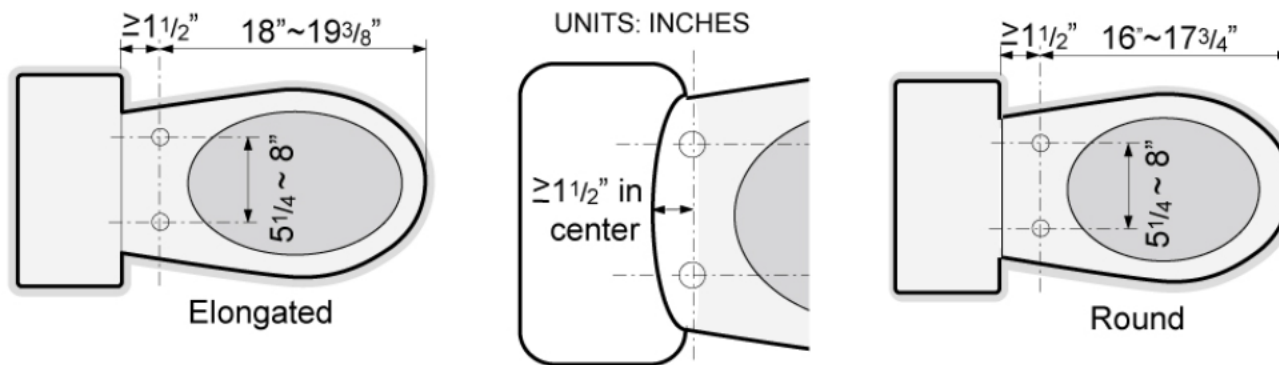

The Brondell Swash fits most one and two-piece toilets, even many with French curved tanks (note: these models will not fit the Kohler San Raphael)

Swash Fit Diagram: Ecoseat 100 Series

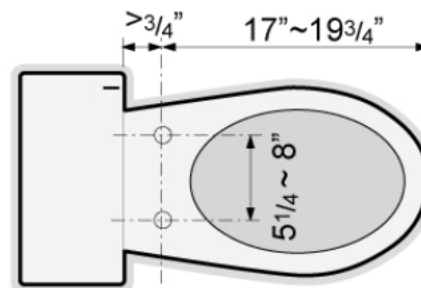

Note: the Swash Ecoseat 100 is designed to fit elongated toilets only, however this model will in fact fit select round fixtures. Please reference the fit diagram for size verification. The Swash Ecoseat 100 will not fit French curve fixtures.