

4PK Stackable Shoe Box Organizer

Assembly Instructions & User's Manual

Before Assembly

Remove components from the box, no tools necessary. Open and separate each clear panel. To report information regarding damaged or missing parts, please email info@standby.net.cn. Please read all instructions carefully before assembling this product. **THIS ASSEMBLY MANUAL CONTAINS SAFETY INFORMATION. PLEASE READ AND KEEP FOR FUTURE REFERENCE.**

SPANISH components from the box, no tools necessary. Open and separate each side of the clear panels. To report information missing parts, please email info@standby.net.cn. Please read all instructions carefully before assembling this product. **THIS ASSEMBLY MANUAL CONTAINS SAFETY INFORMATION. PLEASE READ AND KEEP FOR FUTURE REFERENCE.**

FRENCH components from the box, no tools necessary. Open and separate each side of the clear panels. To report information missing parts, please email info@standby.net.cn. Please read all instructions carefully before assembling this product. **THIS ASSEMBLY MANUAL CONTAINS SAFETY INFORMATION. PLEASE READ AND KEEP FOR FUTURE REFERENCE.**



ART Number: #1000190

How to Assemble

Step 1

Take out Part C and one Part B panel. Insert one end of Part C into Part B and push firmly until you hear a "click" sound. **SPANISH TRANSLATION DUMMY COPY** For placement only Take out Part C and Insert one end of Part C into Part B and **FRENCH TRANSLATION DUMMY COPY** For placement only Take out Part C and Insert one end of Part C into Part B and

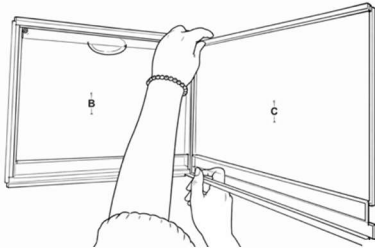

Step 2

Take the second Part B panel and attach it to the other end of Part C the same way as in Step 3. Push firmly until you hear a "click" sound. **SPANISH TRANSLATION DUMMY COPY** For placement only Take out Part C and Insert one end of Part C into Part B and **FRENCH TRANSLATION DUMMY COPY** For placement only Take out Part C and Insert one end of Part C into Part B and

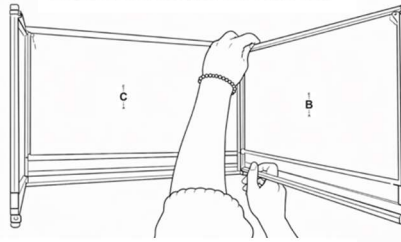

Step 3

Take out Part A. Following the arrows on Part A, align the assembled Part C and two-Part B panels with the three inner slots on Part A. **SPANISH TRANSLATION DUMMY COPY** For placement only Take out Part C and Insert one end of Part C into Part B and **FRENCH TRANSLATION DUMMY COPY** For placement only Take out Part C and Insert one end of Part C into Part B and

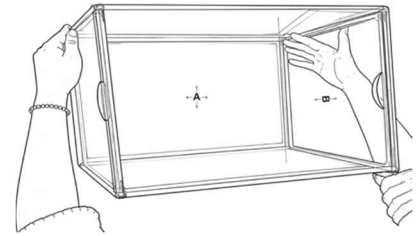

Step 4

Open both Part B doors. Press down firmly on the bottom edges of Part B and Part C until you hear a "click" sound. **SPANISH TRANSLATION DUMMY COPY** For placement Insert one end of Part C into **FRENCH TRANSLATION DUMMY COPY** For placement only Take out Part C and For placement only Take

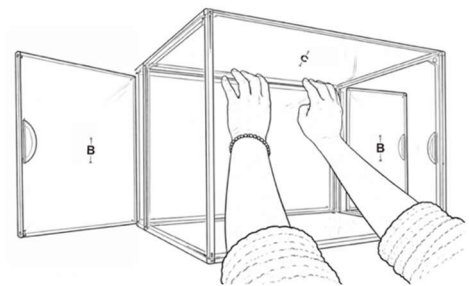
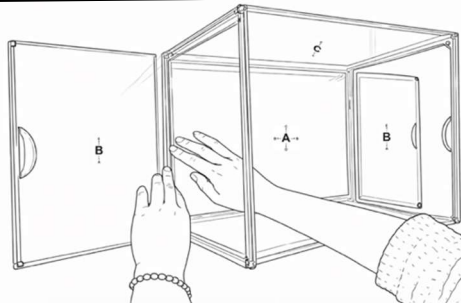

Step 5

Insert both ends of Part D into the inner slots of the two-Part B panels. **SPANISH TRANSLATION DUMMY COPY** For placement Insert one end of Part C into **FRENCH TRANSLATION DUMMY COPY** For placement only Take out Part C and For placement only Take

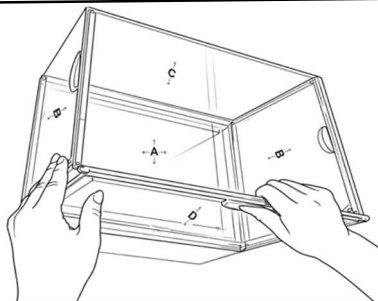

Step 6

Open the Part D door. Hold the bottom frame, align it with the slot on Part A, and press down firmly until you hear a "click" sound. **SPANISH TRANSLATION DUMMY COPY** For placement Insert one end of Part C into **FRENCH TRANSLATION DUMMY COPY** For placement only Take out Part C and For placement only Take

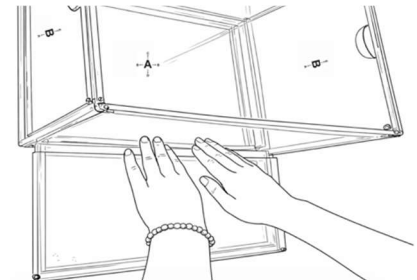

Step 7

Align Part E with the top of the unit following the arrow directions. Insert one corner first, then press down on the remaining corners until each side clicks into place. Press along the edges of Part A and Part E to ensure everything is securely locked. Remove the labels and assembly is complete. **SPANISH TRANSLATION DUMMY COPY** For placement in this space in this Insert one end of Part C into dummy copy this space **FRENCH TRANSLATION DUMMY COPY** For placement in this space only Take out Part C and Dummy Copy this space is For placement only Take Dummy Copy here in this

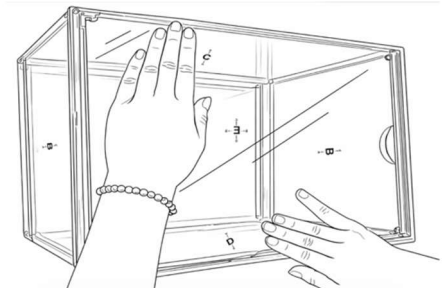
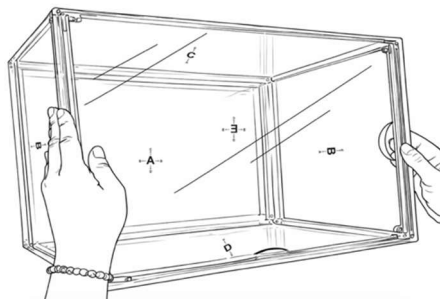

4PK Stackable Shoe Box Organizer

Assembly Instructions & User's Manual

Parts List

Contains 6 pieces for each Stackable Show Box, 24 Pieces total. After removing from the box, remove the plastic wrapped around each piece.

Spanish Translation Remove all 6 pieces from the box and remove the plastic wrapped around each piece.

French Translation Remove all 6 pieces from the box and remove the plastic wrapped around each piece.

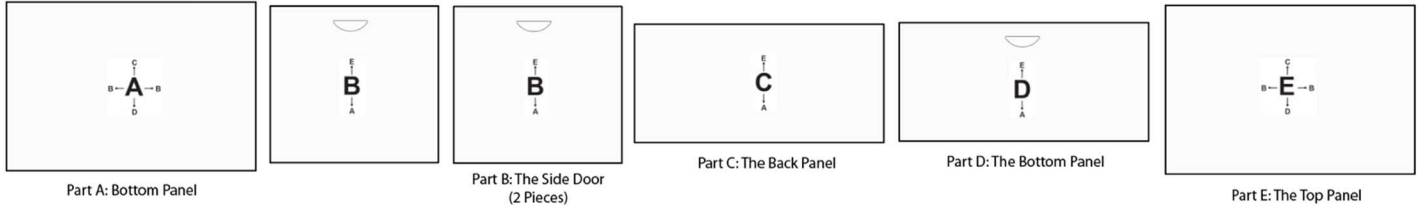

How to Disassemble

Step 1

Open the Part D door. Hold Part B with one hand and remove Part E by releasing the four corners one-by-one. Lift off Part E.

SPANISH TRANSLATION Part D door. Hold Part B with one hand and remove Part E by releasing our corners one-by-one.

FRENCH TRANSLATION Part D door. Hold Part B with one hand and remove Part E by releasing four corners one-by-one.

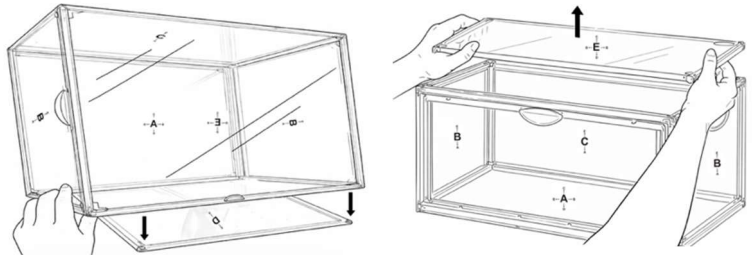

Step 2

Open the Part B door. Press down firmly on the bottom edges of Part B and Part C until you hear a "click" sound.

SPANISH TRANSLATION Part D door. Hold Part B with one hand and remove Part E by releasing the four

FRENCH TRANSLATION Part D door. Hold Part B with one hand and remove Part E by releasing the four

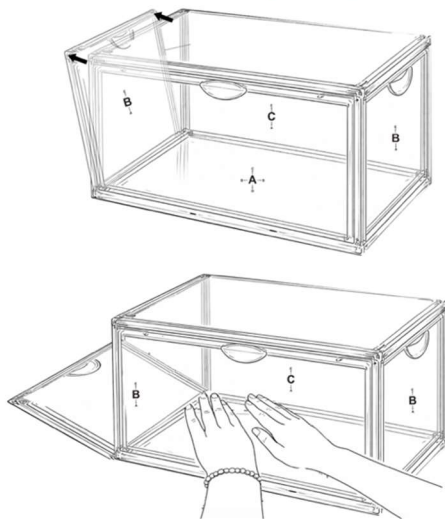

Step 3

Firmly pull-apart Part C first, then remove Part D.

SPANISH TRANSLATION Part D door. Hold Part B

FRENCH TRANSLATION Part D door. Hold Part B

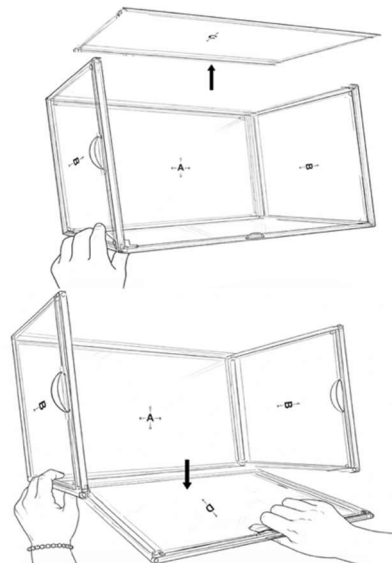

Step 4

Remove the two Part B panels from Part A. Disassemble complete.

SPANISH TRANSLATION Part D door. Hold Part B

FRENCH TRANSLATION Part D door. Hold Part B

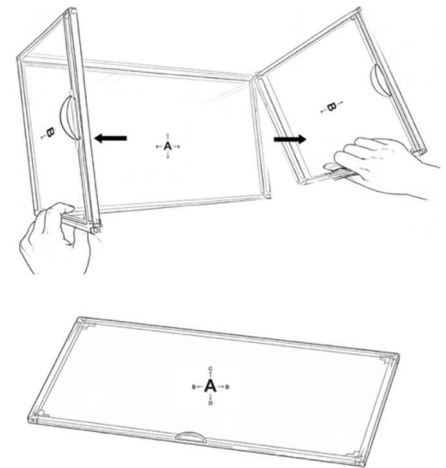

Care Instructions

Use soft, clean, non-abrasive microfiber cloths. These trap dust and prevent scratching. Use a cleaner made for acrylic or plastic. Lukewarm water with mild dish soap can be used for basic cleaning. Also, avoid paper towels or regular cloths they can leave micro-scratches on surfaces.

SPANISH TRANSLATION non-abrasive microfiber cloths. These trap dust scratching. Use a cleaner made for acrylic or plastic. Lukewarm water with mild dish soap can be used for basic cleaning. Also, avoid paper towels or **FRENCH TRANSLATION** non-abrasive microfiber cloths. These trap dust scratching. Use a cleaner made for acrylic or plastic. Lukewarm water with mild dish soap can be used for basic cleaning. Also, avoid paper towels

Warning:

Avoid extreme heat or humidity, especially in attics or garages — The box can warp over time under environmental stress. No Tools required for assembly or dissembled, will cause damage to the PET Panels

SPANISH TRANSLATION Avoid extreme heat or humidity, especially in The box can warp over time under environmental stress. No Tools required for assembly or dissembled, will cause damage to the PET Panels

FRENCH TRANSLATION Avoid extreme heat or humidity, especially in The box can warp over time under environmental stress. No Tools required for assembly or dissembled, will cause damage to the PET Panels