

OmniHeat™

OWNER'S MANUAL
ITM. / ART. 1914943

CERAMIC PERSONAL HEATER

MODEL (DQ2509R)



IMPORTANT, RETAIN FOR FUTURE REFERENCE: READ CAREFULLY
This product is only suitable for well-insulated spaces or occasional use.

The first part of the paper discusses the importance of understanding the local context in which a project is implemented. This includes a thorough analysis of the social, economic, and cultural factors that may influence the project's success or failure. It is essential to engage with the local community from the outset, as their input and feedback are crucial for tailoring the project to their needs and expectations.

The second part of the paper explores the challenges faced by project managers in cross-cultural environments. These challenges can range from communication barriers and language differences to varying attitudes towards authority and decision-making. Effective project management requires a deep understanding of these cultural nuances and the ability to adapt strategies accordingly.

The third part of the paper focuses on the role of leadership in project management. Leaders must be able to inspire and motivate their teams, especially in the face of uncertainty and resistance. This involves clear communication, active listening, and the ability to make difficult decisions when necessary.

The fourth part of the paper discusses the importance of monitoring and evaluation in project management. Regular assessment of progress and performance is essential to ensure that the project remains on track and that any deviations are identified and addressed promptly.

The fifth part of the paper concludes by emphasizing the need for a holistic approach to project management. This means considering all aspects of the project, from the initial planning and design to the final implementation and evaluation, in a way that is consistent and integrated.

NOTICE**IMPORTANT INSTRUCTIONS:****PLEASE READ AND SAVE THESE IMPORTANT INSTRUCTIONS**

WHEN USING ELECTRICAL APPLIANCES, BASIC PRECAUTIONS SHOULD ALWAYS BE FOLLOWED TO REDUCE THE RISK OF FIRE, ELECTRIC SHOCK, INJURY TO PERSONS, AND HYPERTHERMIA, INCLUDING THE FOLLOWING:

- Read all instructions before using this heater.
- This heater is hot when in use. To avoid burns, do not let bare skin touch hot surfaces. If provided, use handles when moving this heater.
- Keep combustible materials such as drapes, furniture, pillows, bedding, papers, clothes, and curtains at least three (3) feet (0.9 m) from the front of heater and keep them at least one (1) foot (0.3m) from the sides and rear of the heater.
- Extreme caution is necessary when heater is used by or near children or invalids and whenever the heater is left operating and unattended.
- Always unplug heater when not in use.
- Do not use any heater with a damaged cord or plug or after heater malfunctions or has been dropped or damaged in any manner. Discard heater, or return to authorized service facility for examination, electrical or mechanical adjustment, or repair. (See Warranty for information)
- Do not use outdoors.
- This heater is not to be used in wet or damp locations such as bathrooms, laundry areas or other similar indoor locations. Never locate heater where it may fall into a bathtub or other water container.
- Do not run cord under carpeting. Do not cover cord with throw rugs, runners, or similar coverings. Do not route cord under furniture or appliance. Arrange cord away from traffic area where it will not be tripped over.
- To disconnect heater, turn control to OFF then remove plug from outlet.
- Do not insert or allow foreign objects to enter any ventilation or exhaust opening as this may cause electric shock or fire or damage the heater.
- To prevent possible fire, do not block air intakes or exhaust in any manner. Do not use on soft surfaces, like a bed, where openings may become blocked.
- A heater has hot and arcing or sparking parts inside. Do not use it in areas where gasoline, paint or flammable liquids are used or stored.
- Use this heater only as directed in this manual. Any other use not recommended by the manufacturer may cause fire, electric shock or injury to persons.
- Always plug heaters directly into a wall outlet/receptacle. Never use with an extension cord or relocatable power tap (outlet/power strip).
- When unplugging, be sure to pull by the plug and not the cord.
- Keep this heater clean. DO NOT allow foreign objects to enter any vent or exhaust opening. This may cause shock, fire, or damage to heater.

- Hyperthermia can result in death. Symptoms of hyperthermia include high body temperature, headache, nausea, vomiting, tiredness, dizziness, fainting, and rapid pulse. If you begin to experience symptoms related to hyperthermia, turn off the heater and seek medical attention. To avoid excessive room temperatures which can cause hyperthermia: DO NOT leave product running unattended in a confined space around infants, or individuals with reduced physical, sensory, or mental capabilities.
- This appliance is not intended for use by persons (including children) with reduced physical sensory or mental capabilities, or lack of experience and knowledge, unless they have been given supervision or instruction concerning use of the appliance by a person responsible for their safety .
- Children should be supervised to ensure that they do not play with the appliance.
- If the heater will not operate, see specific instructions in Troubleshooting in this manual.
- DO NOT attempt to repair or adjust any electrical or mechanical function on this unit. Doing so will void your warranty. The inside of the unit contains no user serviceable parts. All service should be performed by qualified personnel only.
- Discontinue use if plug or outlet is hot. It is recommended that the outlet be replaced if outlet is hot to touch.
- The heater must not be located immediately below a socket-outlet. Do not use this heater around a bath, a shower or a swimming pool.
- Do not use with a wireless plug adapter or outlet that allows control remotely.
- WARNING: In order to avoid overheating, do not cover the heater.
- CAUTION: TO PREVENT ELECTRIC SHOCK, MATCH WIDE BLADE OF PLUG TO WIDE SLOT AND FULLY INSERT.

CAUTION:

- In order to avoid a hazard due to inadvertent resetting of the THERMAL CUT-OUT, this appliance must not be supplied through an external switching device, such as a timer, or connected to a circuit that is regularly switched on and off by the utility.
- If the SUPPLY CORD is damaged, it must be replaced by the manufacturer, a service agent or similarly qualified persons in order to avoid a hazard.
- Do not use this heater if it has been dropped.
- Do not use if there are visible signs of damage to the heater.
- Use this heater on a horizontal and stable surface.

WARNING:

- Do not use this heater in small rooms when they are occupied by persons not capable of leaving the room on their own, unless constant supervision is provided.

WARNING:

- To reduce the risk of fire, keep textiles, curtains, or any other flammable material a minimum distance of 1 meter (3.28ft) from the air outlet.

SAVE THESE INSTRUCTIONS

SPECIFICATION

Model	DQ2509R
Electric specifications	120 V ~ 60 Hz
Rated power	1500W(High) / 900W(Med) / 700W(Low)

SAFETY FEATURES

Tip-Over Protection

If the heater tips over, it will automatically shut off. The display will show "E3" and beep for 3 seconds. To restart the heater, place it upright on a flat, level surface and then turn it on again.

Overheat Protection

The heater is equipped with an overheat protection feature. If the internal temperature exceeds the safe limit, the heater will automatically shut down to prevent overheating.

Child Lock Protection

The child lock function helps ensure safety by preventing children from accidentally touching the device or triggering potentially hazardous actions.

OPERATION





PRE-OPERATING INSTRUCTIONS:

- Carefully remove your heater from the carton and bag. Please save the carton for off-season storage.
- Before using the heater, make sure it is placed on a flat and stable surface.
- This heater is not suitable for use in agricultural facilities including areas where livestock, poultry or other animals are confined.
- This Heater is not suitable for use in hazardous locations.
- **WARNING:** REDUCE THE RISK OF FIRE OR ELECTRIC SHOCK- DO NOT USE THIS HEATER WITH ANY SOLID-STATE SPEED CONTROL DEVICES.
- Plug the cord into a 120 Volt outlet. The Heater cannot be plugged into a 220 Volt outlet.
- Be sure that the plug fits tightly into outlet. When plugs fit loosely into receptacles, they may slip partially or completely out of the receptacle with only the slight movement of the attached cord. Receptacles in this condition may overheat and pose a serious fire hazard. If receptacle and plug are covered by a curtain or drape, the fire hazard is even greater in this situation.
- When the heater is not in use, turn all the controls to OFF, and remove plug from the socket-outlet.

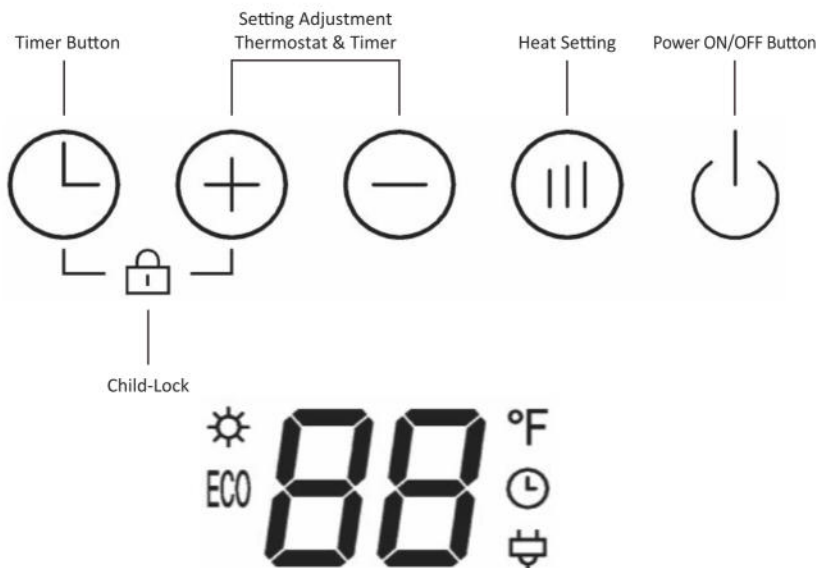
OPERATING INSTRUCTION:

This appliance is operated by the manual controls located on the top of the heater.



	Press power button to turn on the heater. The heater turns on in high mode. Press power button to turn off the heater. The heater counts down 15 seconds, then turns off.
	Press heat mode button to choose the heat mode to ECO, H1 (Low), H2 (Med) or H3 (High). In ECO mode, the heater will automatically adjust the heat setting according to the room temperature for the most optimized settings and energy savings.
	Press "Timer" and "+" and hold for 3 seconds to activate or deactivate the Child Lock setting. Setting confirmed after 3-second countdown on display.
	<u>Turn OFF Timer</u> When the heater is ON, press Timer button to automatically turn the heater off (0-12 hours). Continue pressing the Timer button to reach the desired time setting.
	<u>Turn On Timer</u> When the heater is OFF, press the Timer button to automatically turn the heater on (0-12 hours). Continue pressing the timer button to reach the desired time setting.
	Increase "+" / Decrease "-" the desired temperature setting or timer. Temperature setting range is 65-85°F. Timer setting range is 0-12 hours.

FCC STATEMENT OF COMPLIANCE

Note: This device complies with Part 15 of the FCC Rules. Operation is subject to the following two conditions: (1) This device may not cause harmful interference, and (2) This device must accept any interference received, including interference that may cause undesired operation.

CAN ICES-3 (B)/NMB-3(B). This Class B digital apparatus complies with Canadian ICES-003.

Note: This device has been tested and found to comply with the limits for a Class B digital device, pursuant to Part 15 of the FCC Rules. These limits are designed to provide reasonable protection against harmful interference in a residential installation.

This equipment generates, uses and can radiate radio frequency energy and, if not installed and used in accordance with the instructions, may cause harmful interference to radio communications. However, there is no guarantee that interference will not occur in a particular installation. If this equipment does cause harmful interference to radio or television reception, which can be determined by turning the equipment off and on the user is encouraged to try to correct the interference by one or more of the following measure:

- Reorient or relocate the receiving antenna.
- Increase the separation between the equipment and receiver.
- Connect the equipment into an outlet on a circuit different from that to which the receiver is connected.
- Consult the dealer or an experienced radio/TV technician for help.

Guidelines for Using the Hidden Cord Warp

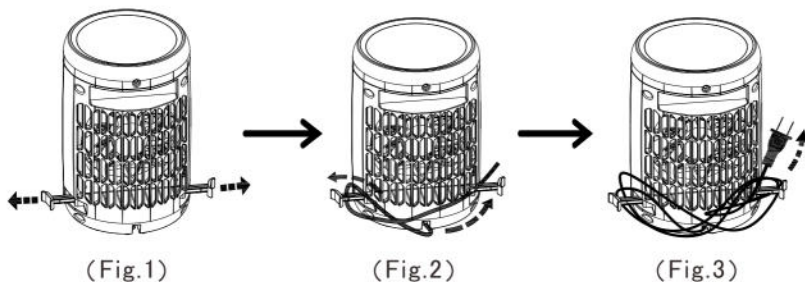

Sept 1: Gently pull out the hidden cord wrap from both sides to expand it into an open structure.(Fig.1)

Sept 2: Start wrapping the power cord in a figure-eight pattern around both sides of the cord wrap. Ensure the cord is evenly distributed and tightly wound to avoid slack.(Fig.2)

Sept 3: After completing the wrapping, feed the plug through the loop formed by the wound cord. Adjust the tightness to firmly fasten the plug in place.(Fig.3)

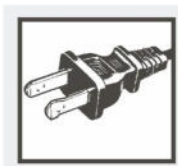

THIS APPLIANCE HAS A POLARIZED PLUG (one blade is wider than the other). To reduce the risk of electric shock, this plug is intended to fit in a polarized outlet only one way. If the plug does not fit fully in the outlet, reverse the plug. If it still does not fit, contact a qualified electrician to install the proper outlet. DO NOT ATTEMPT TO MODIFY THIS PLUG OR DEFEAT THIS SAFETY FEATURE IN ANY WAY.

CLEANING AND STORAGE

Any cleaning, servicing or maintenance of the appliance must be performed with the electrical plug disconnected and the appliance cooled down. Clean the appliance regularly with a soft non-abrasive dust cloth microfiber type. If stains are visible, lightly dampen your cloth with water.

WARNING:

- Do not insert any object or tools inside the appliance.
- Do not attempt to disassemble the heater.
- Do not put the appliance in contact with water and do not wash it.
- Never use abrasive or corrosive detergent, chemical agents or solvents as they could damage the materials and coatings, especially plastic parts.
- Do not use a steam cleaner when cleaning the appliance.
- Never immerse the appliance in water or other liquids and never hold it under running water.

TROUBLESHOOTING

Operation of your appliance can lead to errors and malfunctions. The following tables contain possible causes and tips to resolve them. Please consult this table before contacting after sales service.

Trouble	Possible causes	Solution
The appliance is not powered on.	The appliance is not plugged in correctly.	Plug in the appliance into a grounded electric socket outlet.
		Check the power plug is firmly inserted.
		Check the power cord is not trapped, bent, crushed, pinched or damaged.
	Overheat protection has been triggered.	An overheat safety mechanism is included inside the appliance. Ensure there are no objects or textiles on or near the appliance, then unplug the appliance and let it cool down at least half an hour before plugging it back in.
	The heater is defective.	Contact customer service at service@singfun.com.cn or call 1-866-505-1001(English/Spanish), 1-866-598-0688 (French) for assistance.
The appliance suddenly stops during heating.	The appliance stops heating once it has reached the temperature setting.	This is normal. If the heating stops too frequently according to your heating needs, set the temperature thermostat higher.
	The appliance cannot be turned on or turned off.	A tip over switch safety device is included inside the appliance. Ensure the appliance is on a flat and stable surface, then unplug and re-plug in the appliance.
The appliance cannot be turned on or turned off.	Child-Lock is on.	Press and hold the Child-Lock buttons for 3 seconds to turn off the panel lock.

CUSTOMER SERVICE

HAVE A PROBLEM? MAYBE WE CAN HELP! PLEASE CONTACT CUSTOMER SERVICE.

Customer Service number is for North America only.

1-866-505-1001(English/Spanish), 1-866-598-0688(French)

8 am to 4 pm, EST

If you have any questions, please email us.

service@singfun.com.cn

WARRANTY: This heater includes a one (1) year warranty, which covers manufacturer defects and workmanship under normal use. Warranty is offered only to the original purchaser. Proof of purchase is required. Proof of purchase constitutes a dated sales receipt. This warranty is void if the heater(s) have been subject to abuse such as: being dropped which could result in damage to the heater cabinets, motors, heater controls, etc., immersion in or exposure to water, exposure to excessive heat, outdoor usage, any use other than household use, disassembly, repair or alteration by anyone other than an authorized service provider, use on improper voltage or current, or any use contrary to the user instructions.

No other warranties are expressed or implied. To receive coverage under this warranty, contact customer service for consultation and/or replacement. DO NOT attempt to repair any electrical or mechanical functions of this product; doing so will void this warranty and could lead to injury.

The first part of the paper discusses the importance of understanding the local context in which a project is implemented. This includes a thorough analysis of the social, economic, and cultural factors that may influence the success or failure of the intervention. It is essential to engage with the community from the outset, ensuring that their voices are heard and their needs are addressed. This participatory approach not only fosters a sense of ownership and commitment among the community members but also allows for the identification of potential challenges and the development of strategies to mitigate them.

In addition, the paper highlights the need for a clear and realistic assessment of the resources available, both human and financial. This involves a detailed budgeting process that takes into account the costs of materials, personnel, and other logistical considerations. It is also important to establish a timeline for the project, with regular check-ins and progress reports to ensure that the project remains on track. Flexibility is key, as unexpected circumstances may arise that require adjustments to the original plan.

The second part of the paper focuses on the implementation phase, where the theoretical framework is put into practice. This stage requires a high level of coordination and communication among all stakeholders involved, including the project team, community members, and external partners. Regular meetings and open lines of communication are essential for addressing any issues that arise and for celebrating the progress made. It is also important to maintain a transparent and accountable system of reporting, ensuring that all activities are documented and that the results are shared with the community.

Finally, the paper discusses the evaluation and sustainability of the project. This involves a systematic assessment of the project's impact, both in terms of the immediate outcomes and the long-term sustainability of the changes. This can be achieved through a combination of quantitative and qualitative methods, such as surveys, interviews, and focus groups. The findings of the evaluation should be used to inform future projects and to ensure that the benefits of the intervention are maintained and built upon.

AUSTRALIAN CONSUMER LAW – WARRANTIES AGAINST DEFECTS

Our goods come with guarantees that cannot be excluded under the Australian Consumer Law. You are entitled to a replacement or refund for a major failure and for compensation for any other reasonably foreseeable loss or damage. You are also entitled to have the goods repaired or replaced if the goods fail to be of acceptable quality and the failure does not amount to a major failure.

DISTRIBUTED BY:
COSTCO WHOLESALE CORPORATION
P.O. BOX 34535
SEATTLE, WA 98124-1535
USA
1-800-774-2678
WWW.COSTCO.COM

COSTCO WHOLESALE CANADA LTD.*
415 W. HUNT CLUB ROAD
OTTAWA, ONTARIO
K2E 1C5, CANADA
1-800-463-3783
WWW.COSTCO.CA
* FAISANT AFFAIRE AU QUÉBEC SOUS
LE NOM LES ENTREPÔTS COSTCO

IMPORTADO POR:
IMPORTADORA PRIMEX S.A. DE C.V.
BLVD. MAGNOCENTRO NO. 4
SAN FERNANDO LA HERRADURA
HUIXQUILUCAN, ESTADO DE MEXICO
C.P. 52765
RFC: IPR-930907-S70
(55)-5246-5500
WWW.COSTCO.COM.MX

COSTCO WHOLESALE UK LTD /
COSTCO ONLINE UK LTD
HARTSPRING LANE
WATFORD, HERTS
WD25 8JS
UNITED KINGDOM
01923 213113
WWW.COSTCO.CO.UK

COSTCO WHOLESALE SPAIN S.L.U.
POLIGONO EMPRESARIAL LOS GAVILANES
C/ AGUSTIN DE BETANCOURT, 17
28906 GETAFE (MADRID) ESPAÑA
NIF: B86509460
900 111 155
WWW.COSTCO.ES

COSTCO FRANCE
1 AVENUE DE BRÉHAT
91140 VILLEBON-SUR-YVETTE
FRANCE
01 80 45 01 10
WWW.COSTCO.FR

COSTCO WHOLESALE ICELAND EHF.
KAUPTUN 3-7, 210 GARDABAER
ICELAND
WWW.COSTCO.IS

COSTCO WHOLESALE AUSTRALIA PTY LTD
17-21 PARRAMATTA ROAD
LIDCOMBE NSW 2141
AUSTRALIA
WWW.COSTCO.COM.AU

COSTCO WHOLESALE KOREA, LTD.
40, ILJIK-RO
GWANGMYEONG-SI
GYEONGGI-DO, 14347, KOREA
1899-9900
WWW.COSTCO.CO.KR

COSTCO WHOLESALE JAPAN LTD.
2 KAKUCHI, 2 GAIKU
KANEDA-NISHI
361 URIKURA, KISARAZU SHI
CHIBA, 292-0007 JAPAN
0570-200-800
WWW.COSTCO.CO.JP

COSTCO (CHINA) INVESTMENT CO.,LTD.
ROOM 01 MEZZANINE
NO.5178, KANG XIN HIGHWAY
PUDONG NEW DISTRICT
SHANGHAI
CHINA 201315
+86-21-6257-7065

COSTCO WHOLESALE NEW ZEALAND LIMITED
2 GUNTON DRIVE
WESTGATE
AUCKLAND 0814
NEW ZEALAND
WWW.COSTCO.CO.NZ

COSTCO WHOLESALE SWEDEN AB
BOX 614
114 11 STOCKHOLM
SWEDEN
WWW.COSTCO.SE

MADE IN CAMBODIA/FABRIQUÉ AU CAMBODGE/ HECHO EN CAMBOYA

TONG CHUANG LI ELECTRICAL APPLIANCES (CAMBODIA) CO., LTD.

400 S EL Camino Real, San Mateo, California 94402

service@singfun.com.cn