



Alere™ PBP2a

A cost-effective, targeted approach to identifying methicillin-resistant *Staphylococcus aureus* (MRSA).

- The MRSA death rate is now higher than the AIDS death rate.¹
- Invasive, serious MRSA infections occur in nearly 94,360 persons each year and are associated with approximately 18,650 deaths.²
- Of these infections, about 86% are healthcare-associated and 14% are community-associated.²

Cost-Effective & Reduces Use of Antibiotics

- Rapid MRSA testing aids in reducing empiric use of vancomycin and permits cost-effective decisions for optimal patient management.³
- People infected with antibiotic-resistant organisms like MRSA are more likely to have longer and more expensive hospital stays, and may be more likely to die as a result of the infection.¹

Targeted

- Provide targeted identification of MRSA in addition to using chromogenic agar plates for MRSA screening – a comprehensive and compliant MRSA surveillance program for testing.

Easy Procedure

- A rapid lateral flow assay procedure that's simpler than latex agglutination and takes subjectivity out of reading the result.

Simple Procedure... Objective Results

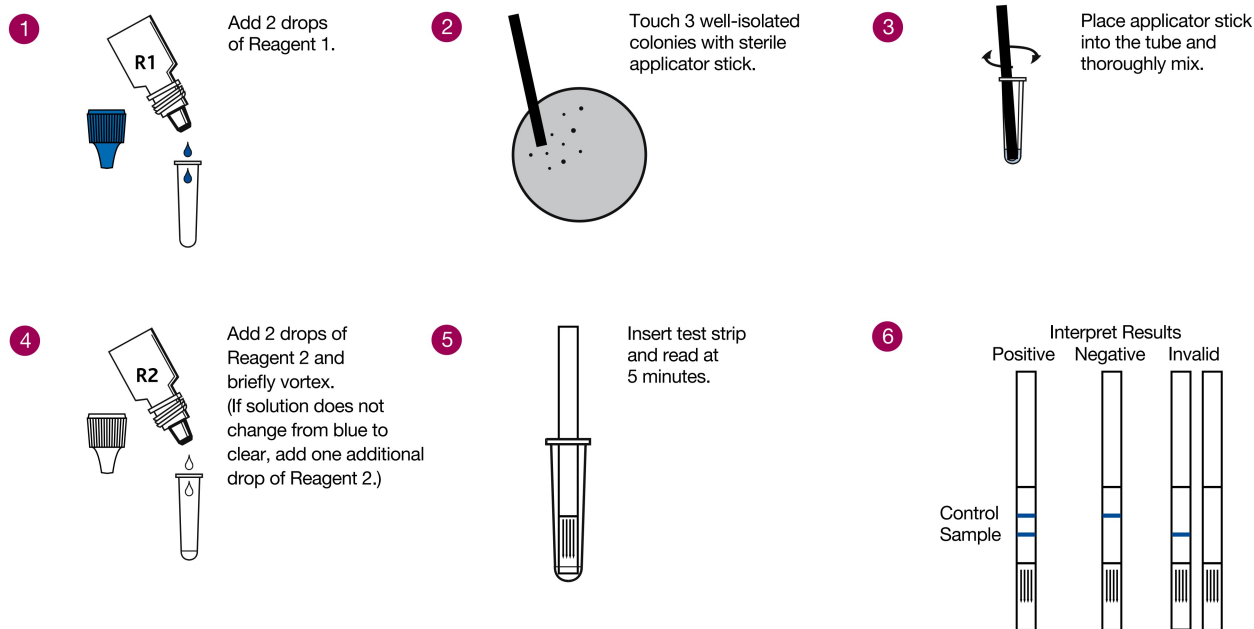

Alere™ PBP2a

- Results in 5 minutes
- Sample from culture (wound, skin, urine, etc.)
- Easy to handle test strip
- Built-in quality controls on every test strip



Each kit includes:
 25 Test Strips
 25 Assay Tubes
 25 Workstations
 1 Vial Reagent 1
 1 Vial Reagent 2
Order No. 892-000

Excellent Performance⁴

Plate Type	Sensitivity	Specificity	NPV	PPV
TSA with 5% Sheep Blood	98.1%	99.8%	98.4%	98.6%
Columbia Agar with 5% Sheep Blood	99.0%	98.8%	99.2%	98.6%
Mueller Hinton with 1 µg oxacillin induction	99.5%	98.8%	98.6%	98.6%

References

1. CDC 2. Klevens et al. *Journal of the American Medical Association* 2007;298(15):1763-1771. 3. Lodise et al. *Clinical and Economic Impact of Methicillin Resistance in Patients with Staphylococcus aureus Bacteremia. Diagn Microbiol Infect Dis.* 2005 June; 52(2): 113-22. 4. Product Insert ©2010 Alere. All rights reserved. Alere and the Alere Logo are trademarks of the Alere group of companies. 09-LF-0261vA



Headquarters

1430 West McCoy Lane
 Santa Maria, CA 93455
 800.266.2222 : phone
 805.346.2760 : fax
 Sales@HardyDiagnostics.com
 www.HardyDiagnostics.com

Distribution Centers

Santa Maria, California
 Centralia, Washington
 Salt Lake City, Utah
 Phoenix, Arizona
 Dallas, Texas
 Springboro, Ohio
 Lake City, Florida