

## 5 simple steps!

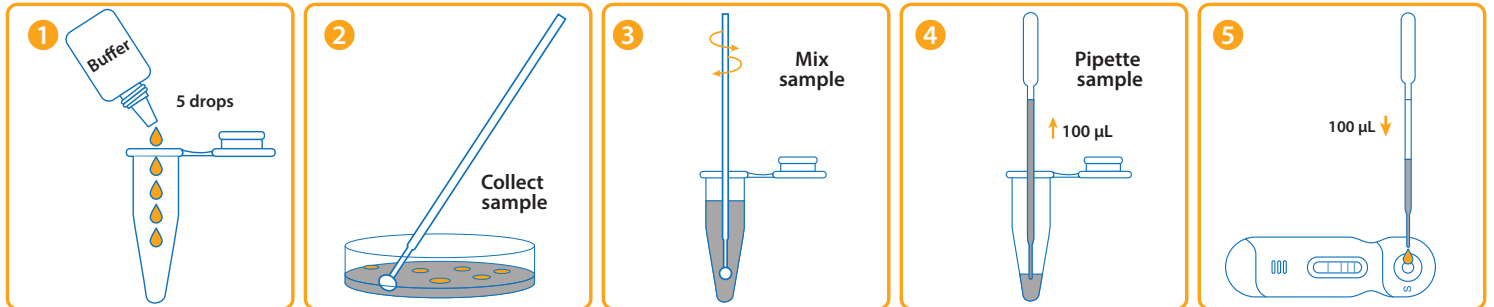

## Example of interpretation

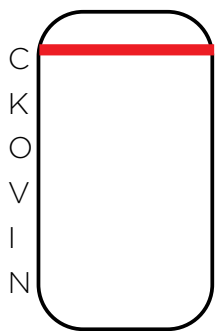

**Negative**

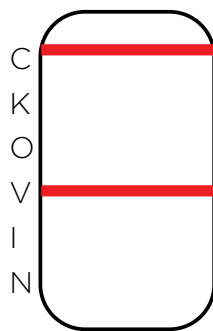

**VIM Positive**

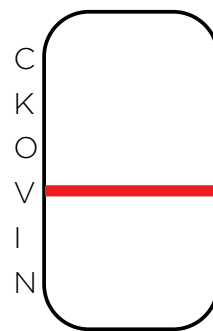

**INVALID**  
No control line

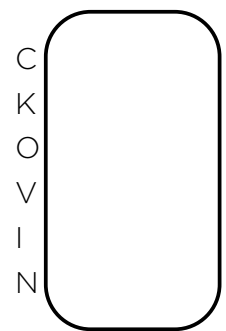

**INVALID**  
No control line

## Identification process from bacterial culture

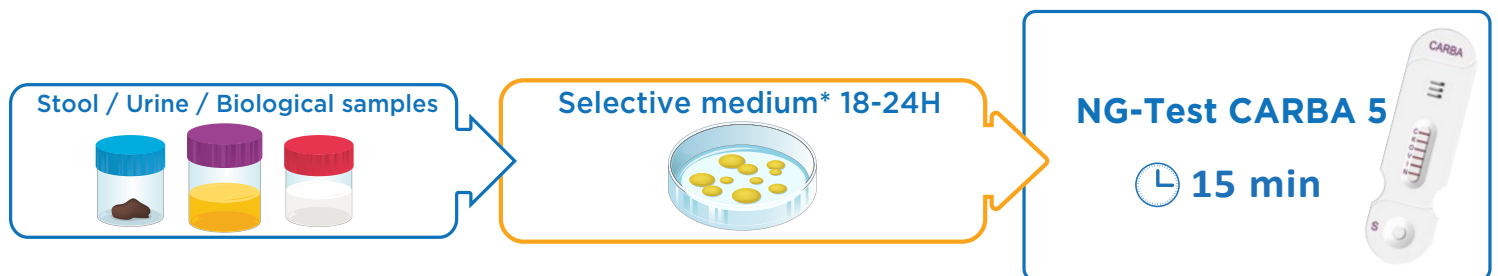

The validated media is Blood, MacConkey, and/or HardyCHROM™ CRE Agar

Description	UOM	Cat no.
<b>CARBA 5</b> , the only rapid, multiplex, phenotypic test capable of detecting KPC, OXA-48-like, VIM, IMP, and NDM carbapenemases produced by <i>Enterobacterales</i> and <i>Pseudomonas aeruginosa</i> .	20 tests per pack	CARBA5
<b>HardyCHROM™ CRE Agar</b> , a chromogenic medium for detection of carbapenemase in <i>Enterobacteriaceae</i> . 15x100mm plate.	10 pack	G323