

**SOUND RETARDANT DOORS 42 DB AND 45 MIN
FIRE RESISTANT, FOR INTENSIVE USE**

Our doors are certified and tested by
Architectural Testing up to 36" X 84".

- A STILES:** 1" (25.4 mm) non combustible material with 1/16" (1.6 mm) intumescent and 7/16" (11 mm) hardwood matched with faces, for a total width of 1 1/2" (38 mm) .
- B TOP RAIL:** 3" (76mm) non combustible material with 1/16" (1.6 mm) intumescent and 7/16" (11 mm) hardwood at top and bottom, for a total width of 3 1/2" (89 mm).
- C BOTTOM RAIL:** 3" (76mm) non combustible material.
- D CORE:** Sound dampening core
- E FACES:** Wood veneer (choice of face veneers; 2 ply plywood), fiber board panel or plastic laminate glued to composite crossband.

LOCK BLOCK (1): For lock, card reader, panic bar, material at manufacturer's choice.

GLUE: Type 1 PVA Cross-link.

INTERIOR use

SEAL COMPONENT KIT no. 10

WARRANTY: 3 years.

NOTE

- Dimensions are nominal before trimming.

WARNING

- Use of gaskets other than those tested may affect STC rating. Walls components, frame installation and joints can also impact STC ratings.

IMPORTANT

- Gaskets and automatic door bottom mortise included.
- Limited dimensions.

LEED CONTRIBUTION OPTIONS

- EPD
- LEED V4.1
- Recycled content
- FSC
- ULEF

PERFORMANCE MEASUREMENT

- ANSI/WDMA 1.S.1A
- ASTM E 90-02, 413-87, E 1332-90, E 2235-03
- AWS
- AWMAC
- Intertek WH-ETL
- NFPA 80

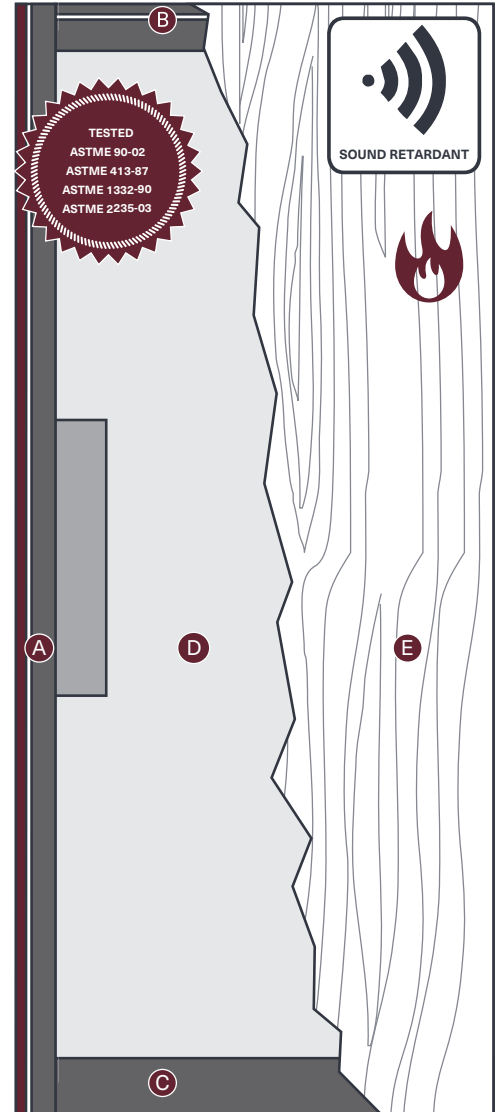

A STILES ME

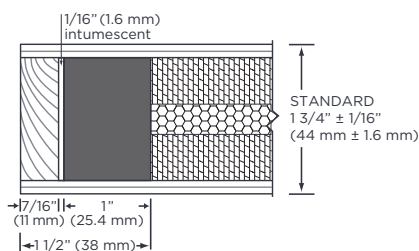

B TOP RAIL

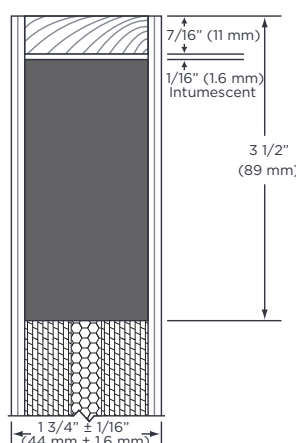

C BOTTOM RAIL

