

DATA SHEET

2700 Kerf Reveal Linear

Real Wood Veneer



2700 | KERF REVEAL LINEAR | REAL WOOD VENEER

The 2700 Kerf Reveal Linear wood ceiling offers a design where the individual wood members abut with a thin reveal between each plank. Members are installed randomly to create a planked look. Due to required fabrication tolerances for the kerf reveal

joinery, only engineered veneered wood composites are used. Member lengths are 8' to maximize yield of veneered sheet goods.

Attachment for the Kerf Reveal Linear is via progressive install, utilizing the 9Wood Z-Clip.

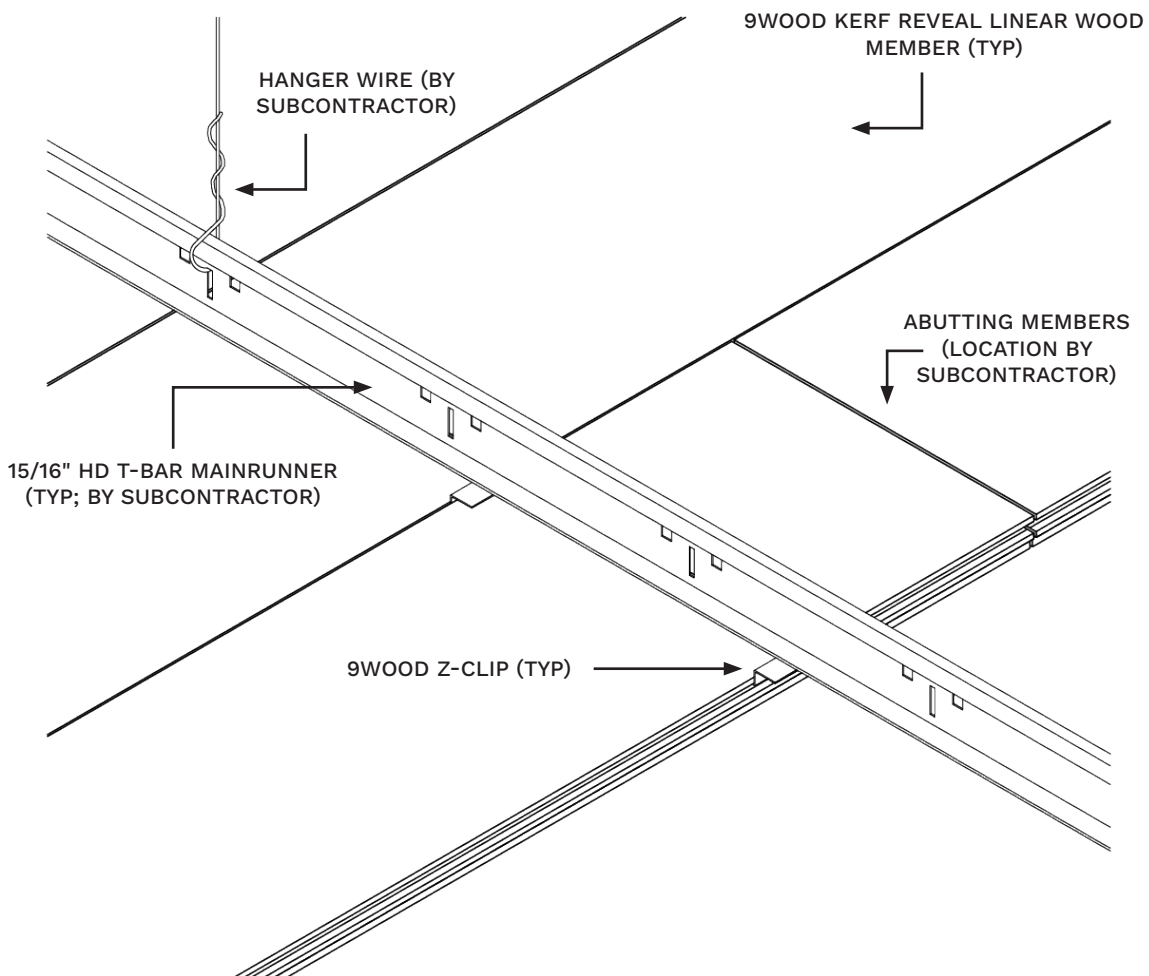



Application

The Kerf Reveal Linear provides a planked look and creates a “wood floor-on-the-ceiling” appearance with clear delineations at board edges. Access can be through strategically located access panels or from ceiling perimeters. Members are secured to T-Bar main runners progressively with the 9Wood Z-Clip.

Performance

Acclimatization

Kerf Reveal Linears must be cared for in a controlled interior environment (RH 25%-55% max; temp. 60°-80°) and installed only after reaching equilibrium moisture content. Should the building fall outside these limits, consult 9Wood for our 3 Tests/3 Tracks Acclimatization Advisory

Acoustics

The Kerf Reveal Linear is considered acoustically reflective.

Fire Rating

Individual members use Fire Rated Patrical board core and meet Class A per ASTM E84 & ASTM E2768

LEED

Kerf Reveal Linears may help contribute to LEED credits for: Material sourcing, Material ingredients, Low Emitting Materials, and Environmental Product Declarations. Credit support based on design choices, please contact 9Wood for more information.

Suspension

Kerf Reveal Linears are directly attached to 15/16” heavy duty T-Bar main runners. Main runners are installed 2’ on center, depending on system weight.

MEP

The Kerf Reveal Linear permits MEP penetrations in the ceiling’s surface. Supplemental suspension may be required at penetrations. Fixtures and diffusers must be independently supported

Seismic

Clips are typically mechanically screwed to T-Bar for seismic compliance. Please consult local code or a licensed engineer for any additional requirements.

Species & Finishes

For veneer options, 9Wood custom fast offers Plain Sliced (PS) Cherry, Walnut, White Maple, and Rift Sliced (RS) White Oak. Cherry and Maple can be easily stained to match standard or custom colors and typically Walnut and White Oak are coated with a simple clear matte finish. Opaque finishes can be requested but may take more time to dial in custom colors.

System Weight

Kerf Reveal Linears typically weigh 3 pounds per square foot

KERF REVEAL LINEAR | REAL WOOD VENEER



Typical Specifications

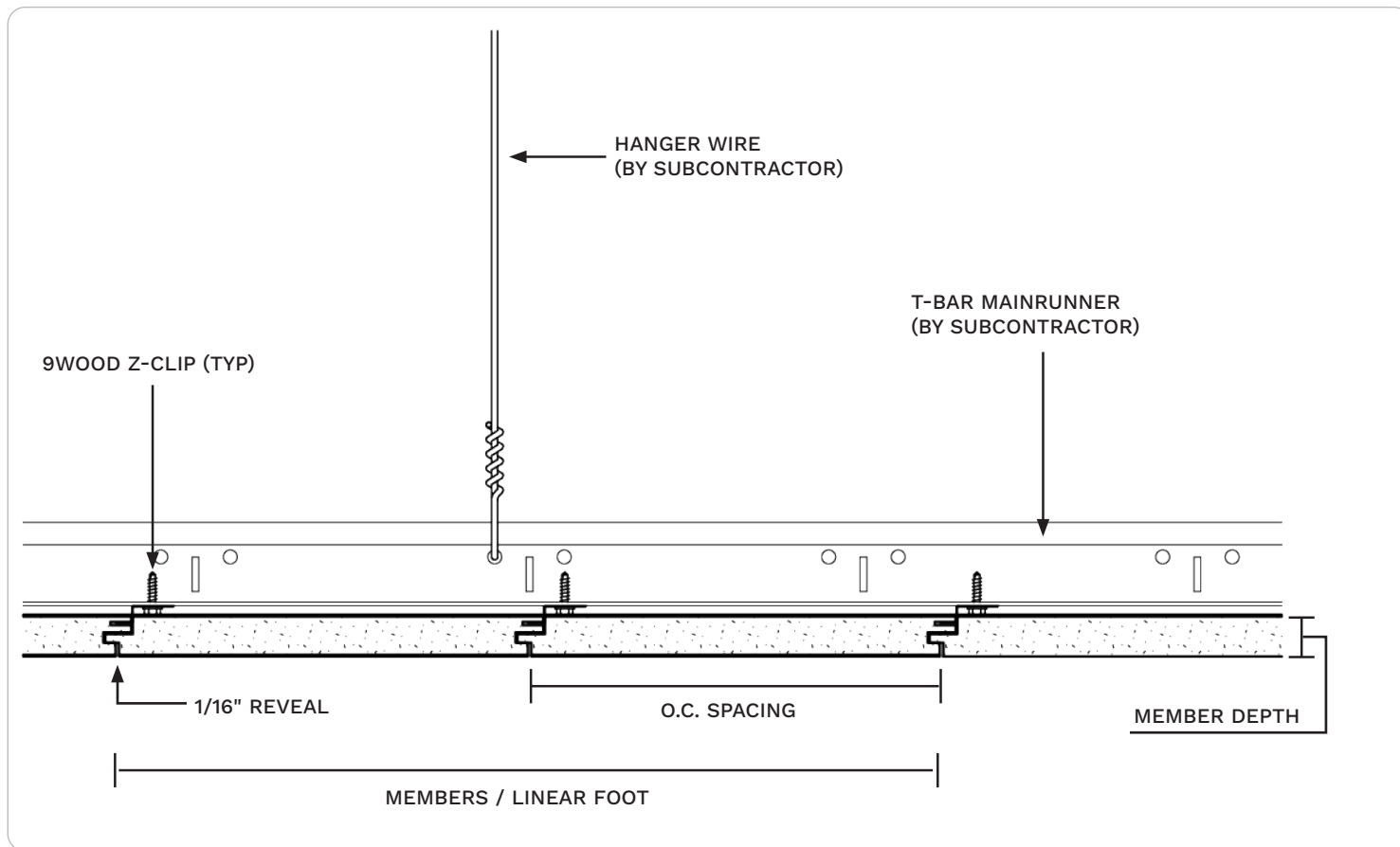

SKU Table

Depth	Width	Members per Linear Foot	
		2	3
3/4"	4 1/2"	2715-3	
3/4"	6 1/2"	2717-2	

Additional width, depth, and M/LF options may be available.
Please check with 9Wood if you don't see the combination that you have in mind.



Perimeter Conditions and Suspension

