

REV#	DATE	DESCRIPTION
10		
9		
8		
7		
6		
5		
4		
3		
2		
1		
0	10.14.25	RELEASE FOR APPROVALS

- 1 FACTORY ATTACHED AIRCRAFT CABLE BRACKET (TYP)
- 2 AIRCRAFT CABLE WITH FACTORY ATTACHED BALL ENDING (TYP; SHIPPED LOOSE AND INSTALLED IN FIELD BY SUBCONTRACTOR)
- 3 PERIMETER CONDITION (TYP; BY OTHERS)

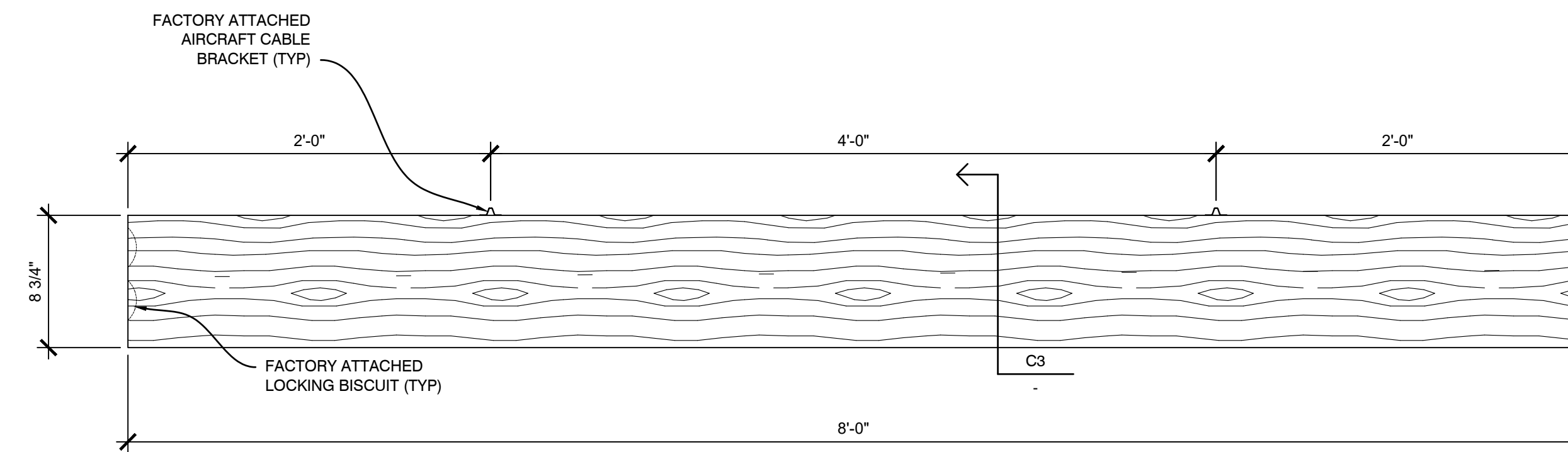

**D3** SIDE VIEW - WOOD BAFFLE "1.8"  
SCALE: 1 1/2" = 1'

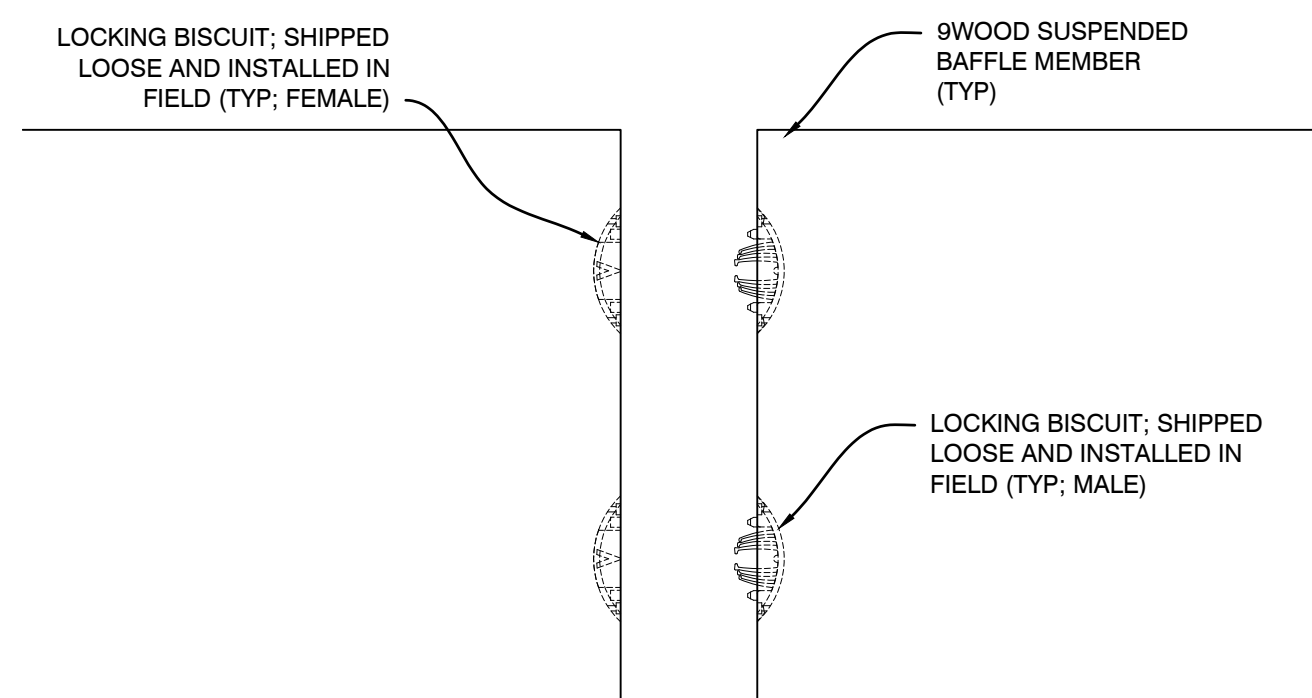

**C1** DETAIL - LOCKING BISCUIT JOINT  
SCALE: 1/2" = 1'

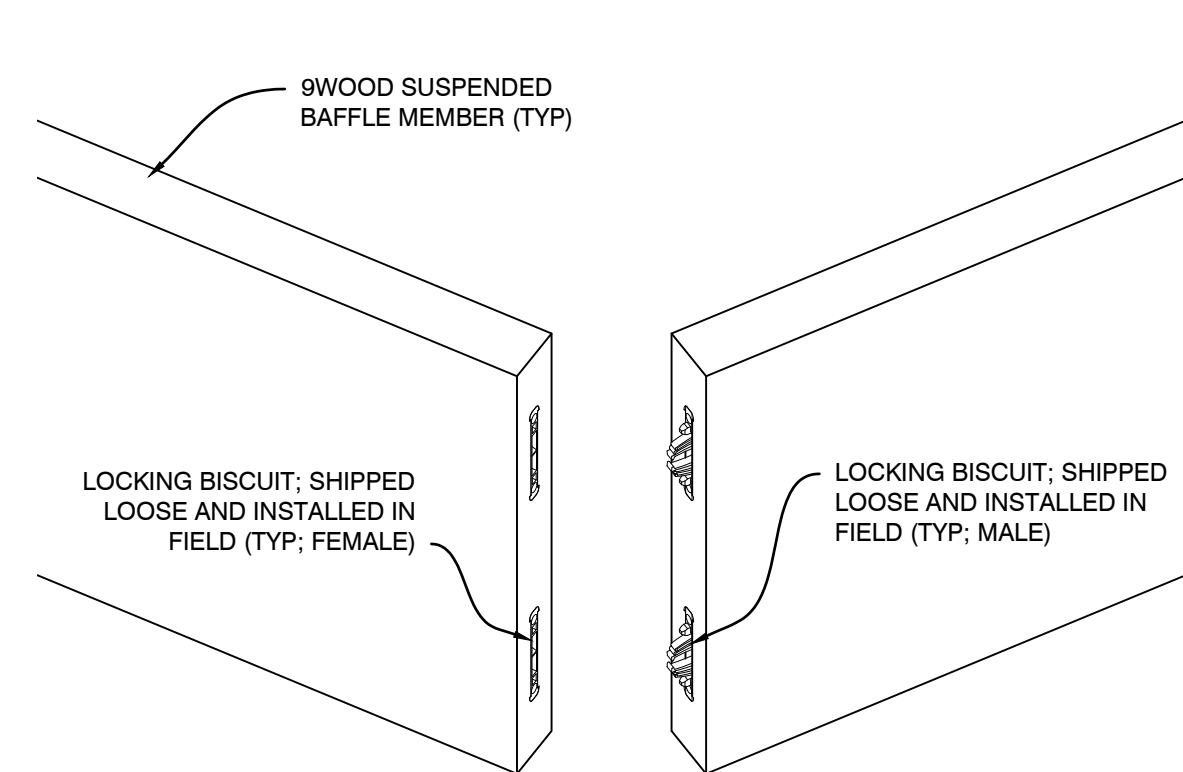

**C2** DETAIL - LOCKING BISCUIT JOINT  
SCALE: 1/2" = 1'

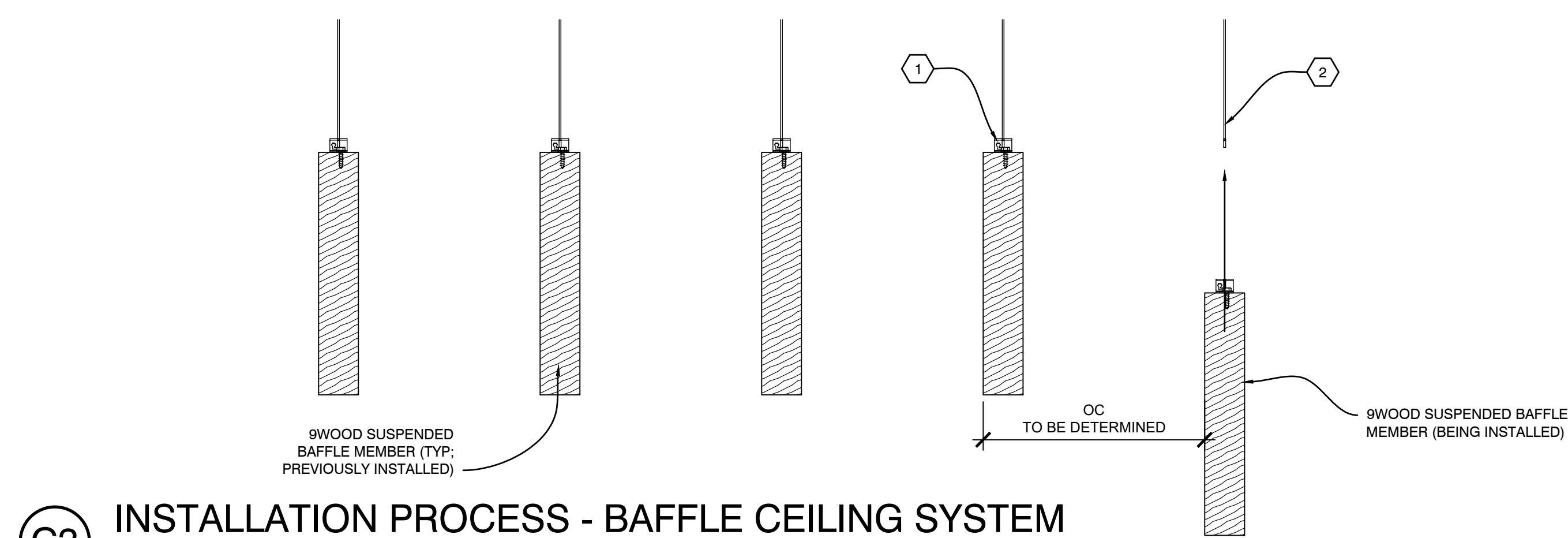

**C3** INSTALLATION PROCESS - BAFFLE CEILING SYSTEM  
SCALE: 1/4" = 1'

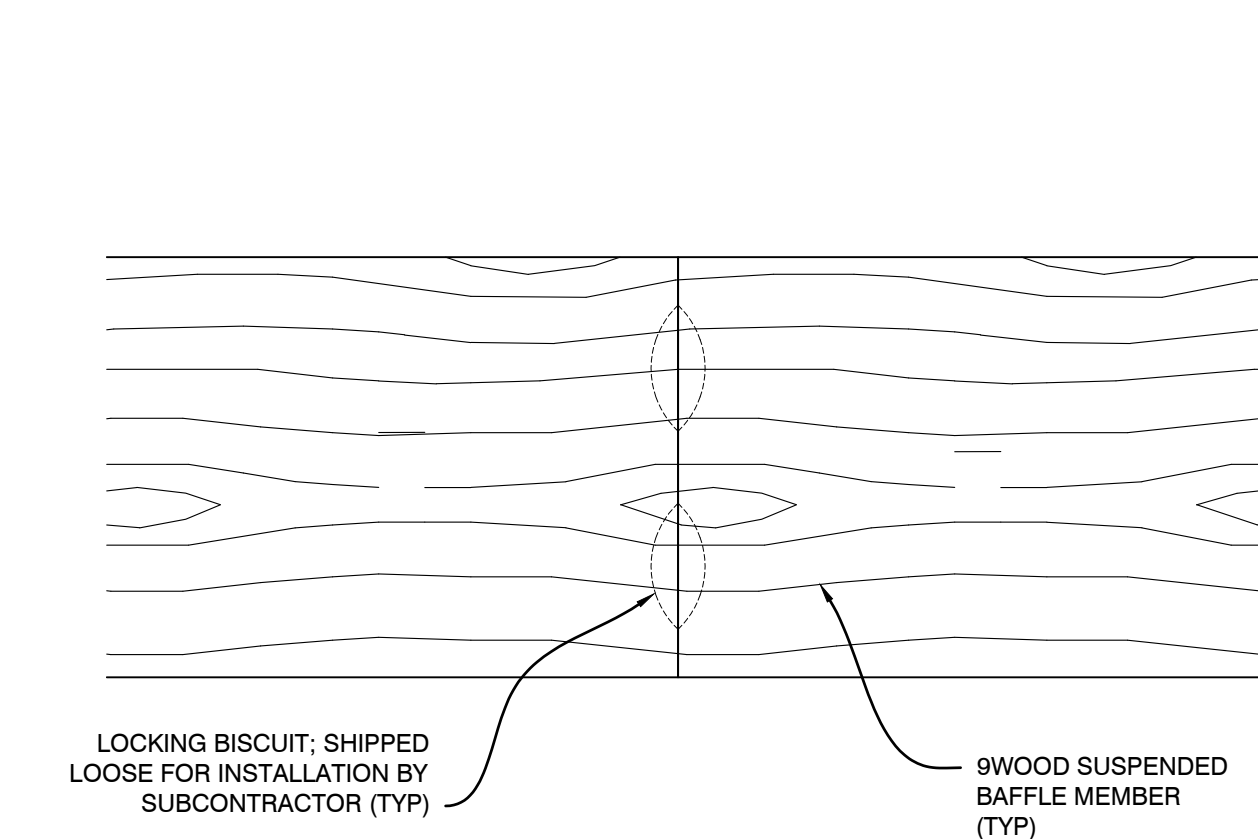

**B1** SECTION - ABUTTING MEMBERS  
SCALE: 1/4" = 1'

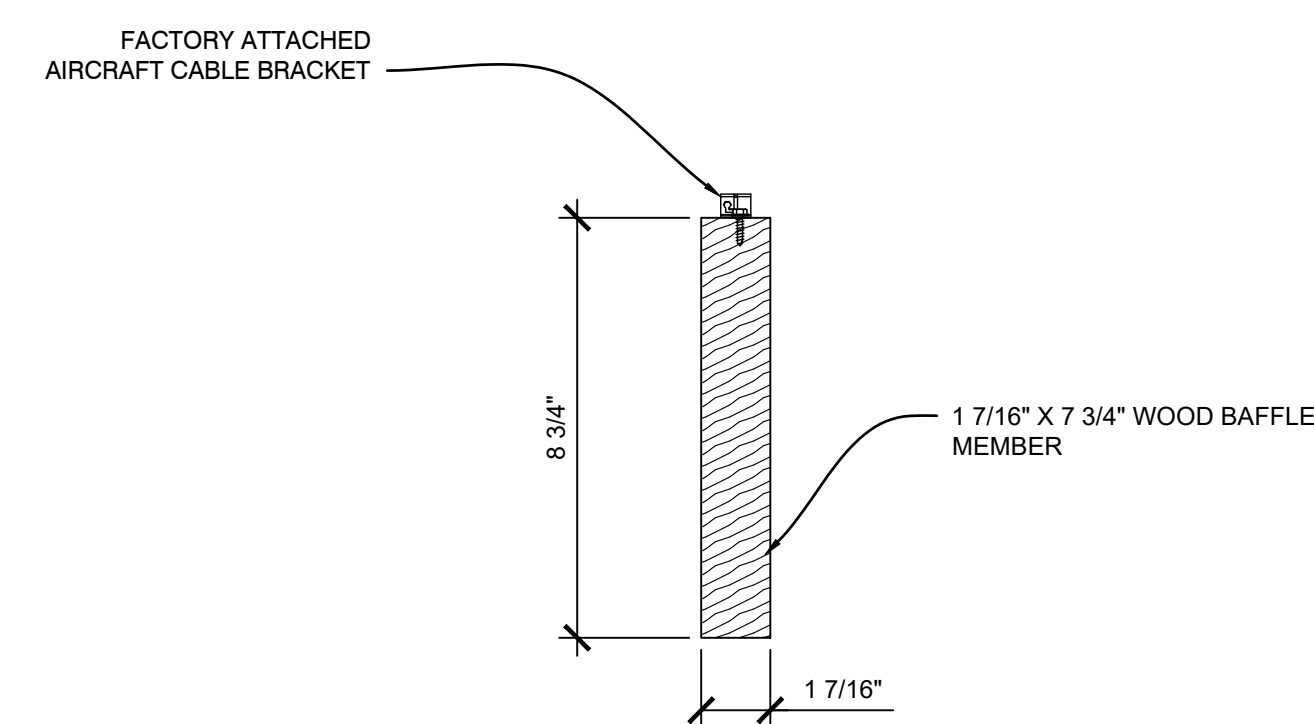

**B2** SECTION - WOOD BAFFLE  
SCALE: 1/4" = 1'

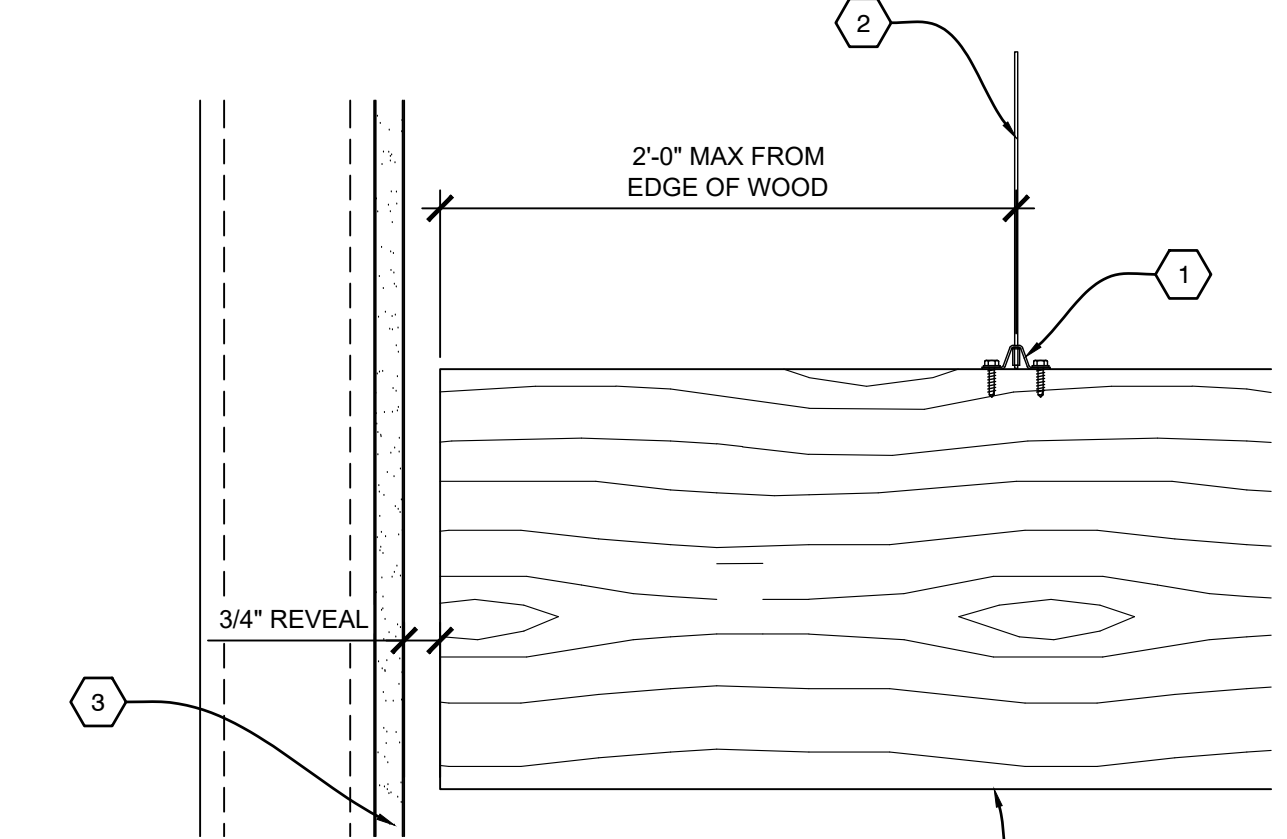

**B3** SECTION - PERIMETER  
SCALE: 1/4" = 1'

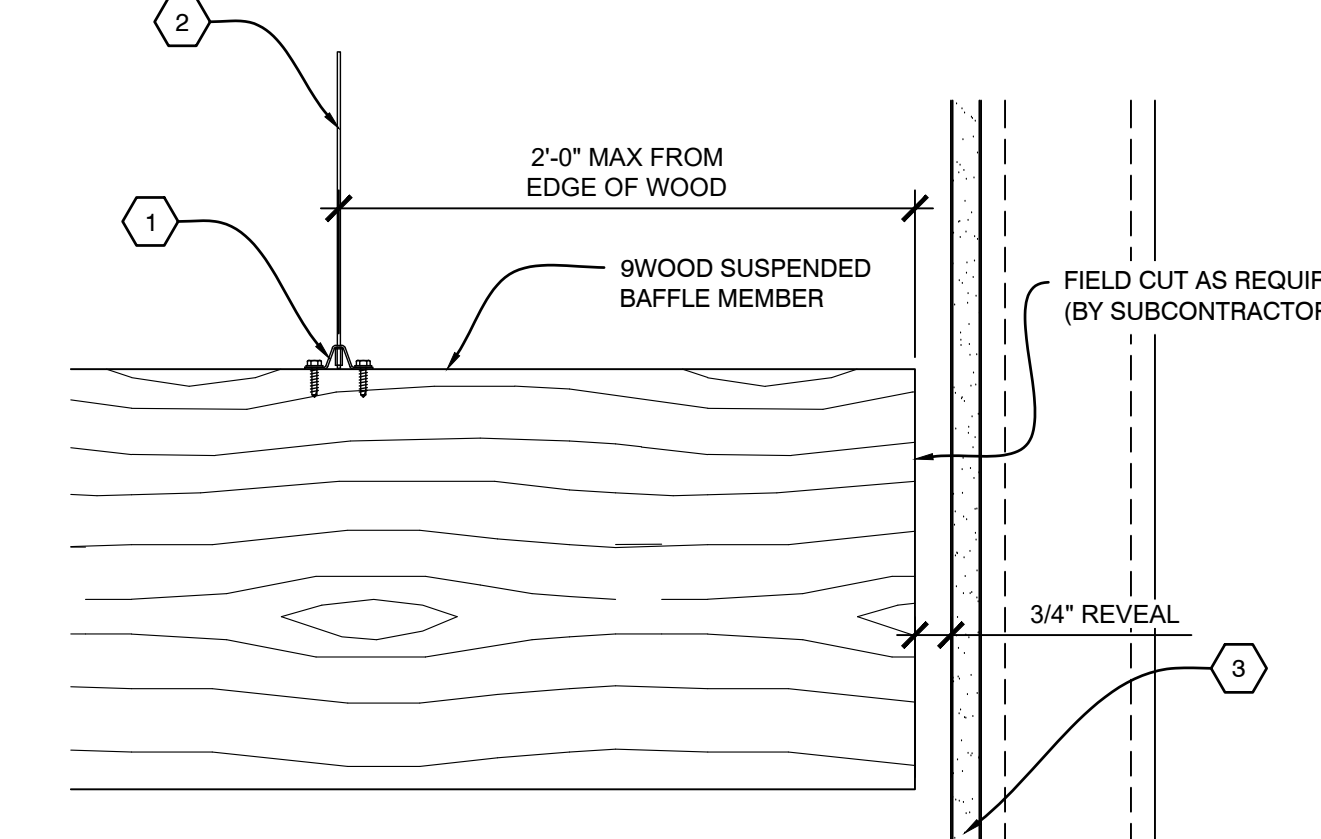

**B4** SECTION - PERIMETER  
SCALE: 1/4" = 1'

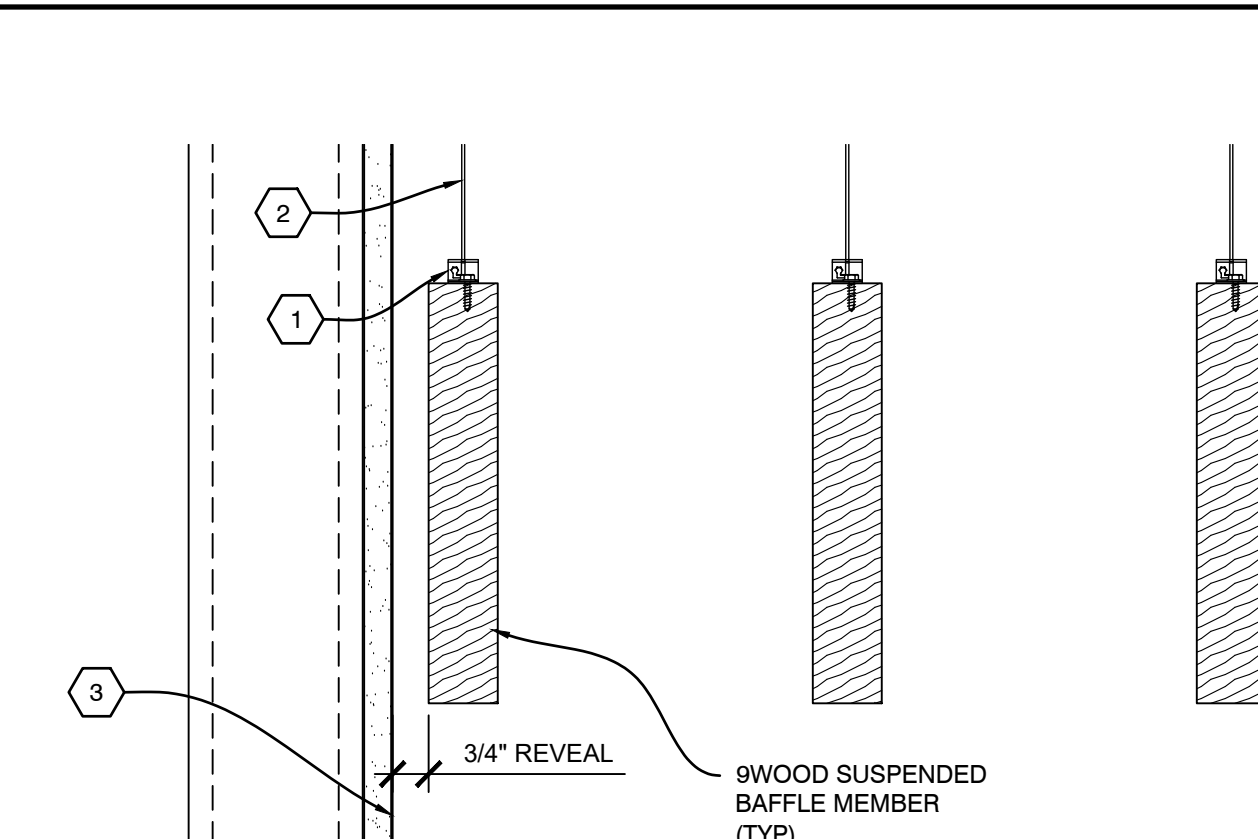

**A1** SECTION - PERIMETER  
SCALE: 1/4" = 1'

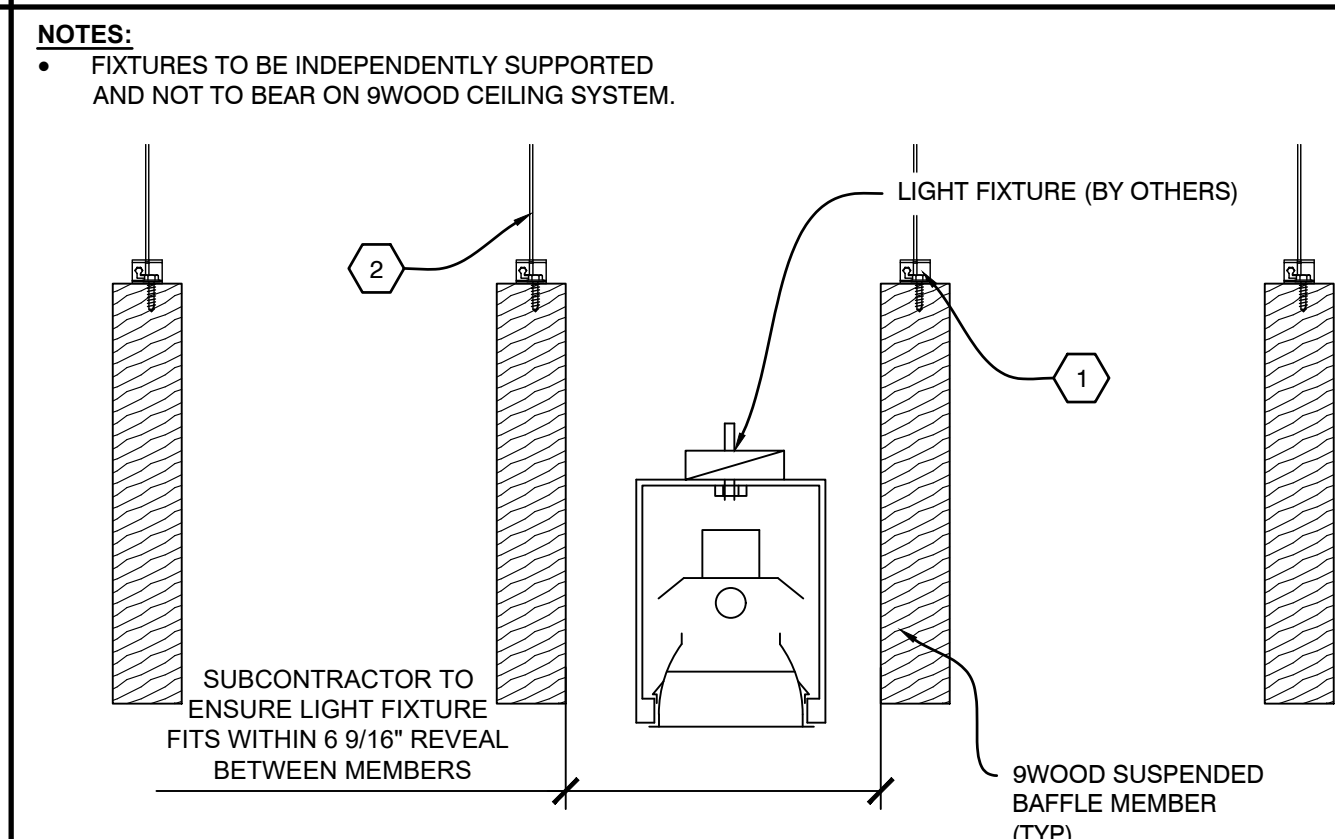

**A2** SECTION - LIGHT FIXTURE  
SCALE: 1/4" = 1'

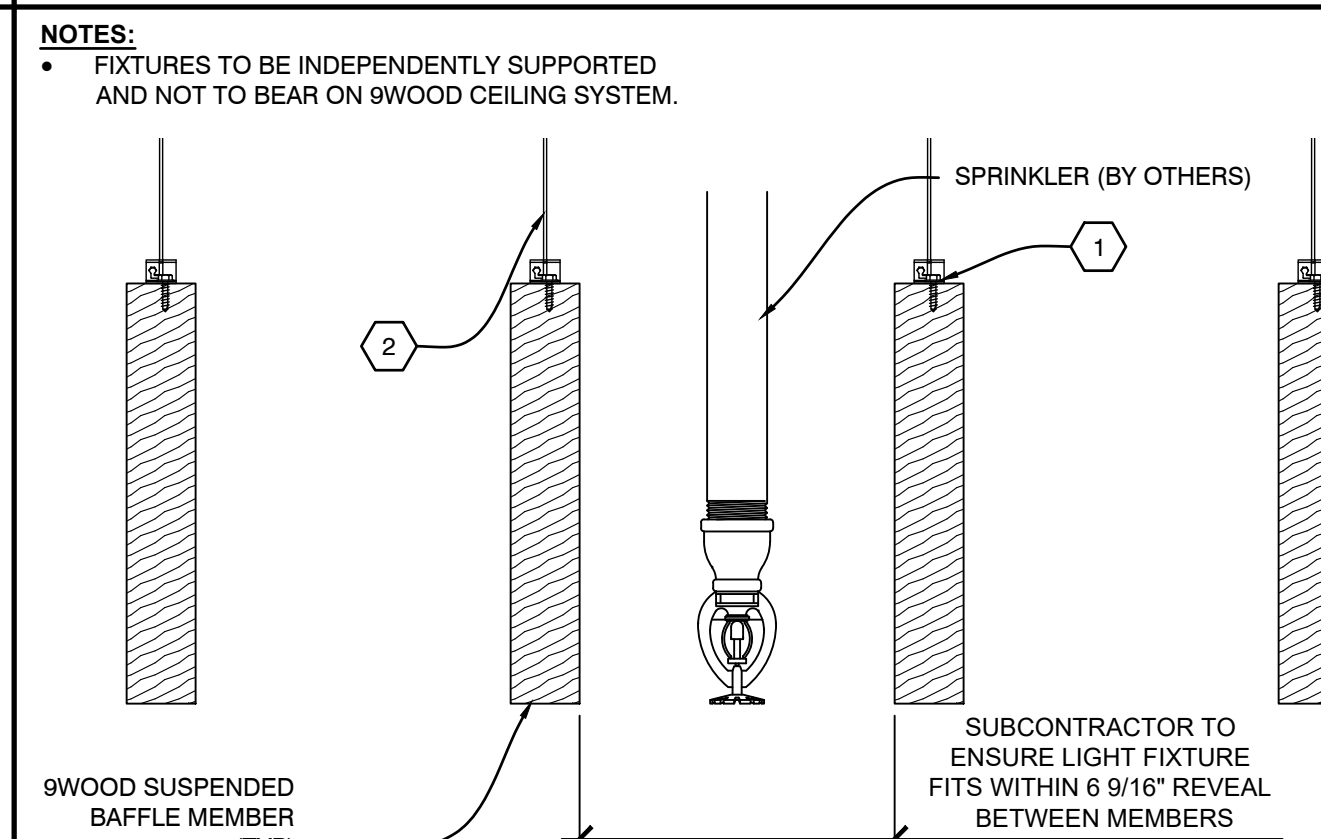

**A3** SECTION - SPRINKLER  
SCALE: 1/4" = 1'

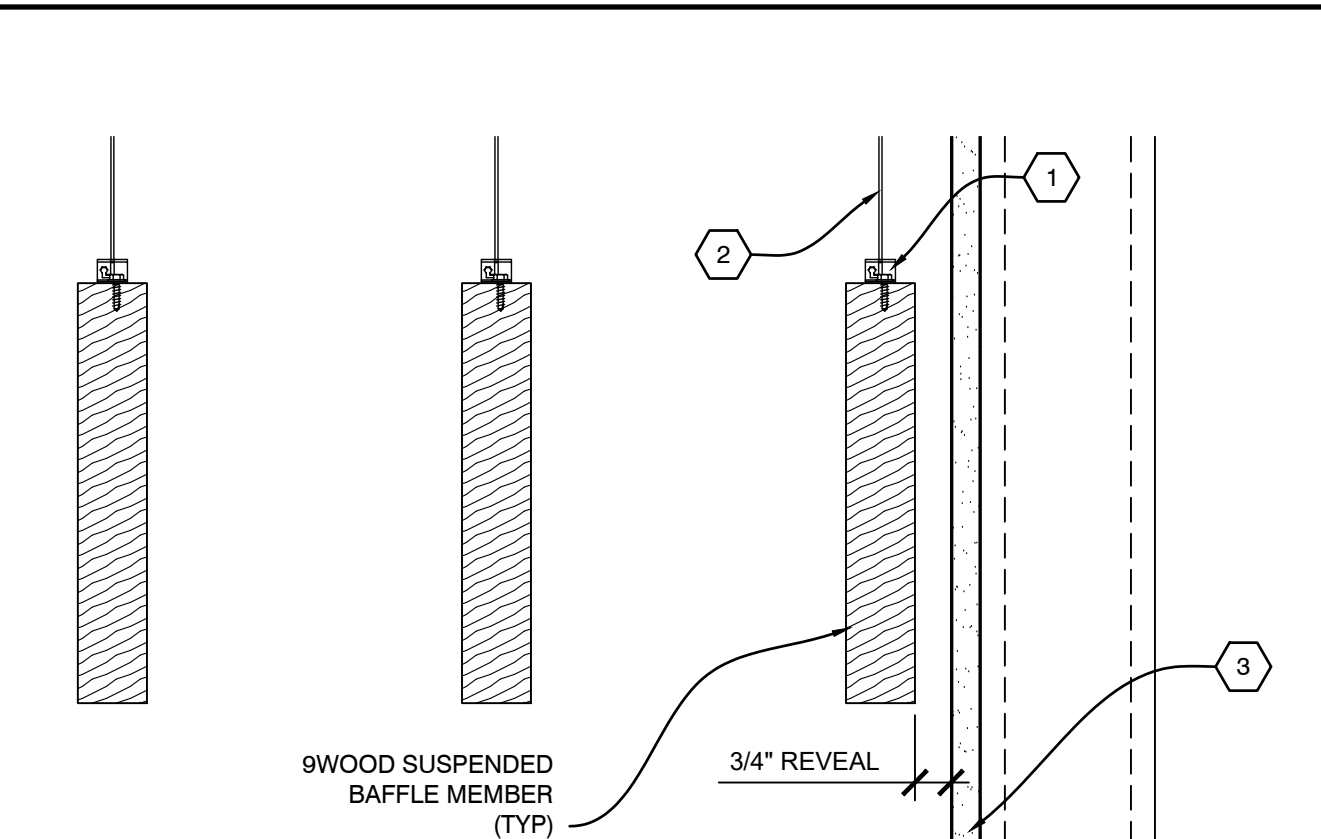

**A4** SECTION - PERIMETER  
SCALE: 1/4" = 1'

9WOOD LOCAL REPRESENTATIVE PRODUCTS CUSTOMER SERVICE: 888.767.9990 (TOLL FREE) 888.767.9998 (TOLL FREE)  
 9WOOD LOCAL REPRESENTATIVE PRODUCTS: 888.767.9990 (TOLL FREE) 888.767.9998 (TOLL FREE)  
 9WOOD LOCAL REPRESENTATIVE PRODUCTS: 888.767.9990 (TOLL FREE) 888.767.9998 (TOLL FREE)