

14-27

DATA SHEET

# 4900 Wall Tile

Real Wood Veneer



# 4900 | WALL TILE | REAL WOOD VENEER

The 4900 Wall Tile wood wall system offers a tiled appearance. The 4900 Wall Tile mounts to the wall using factory-attached Monarch Clips and field-installed Monarch Rails. Standard 3/8" reveals between panels create a clean panelized look.

Matching edgebanding is applied to all four edges of the tiles and Wall Tiles are available in a variety of sizes.

Attachment for the Wall Tile is via a clip-and-rail installation, supported by 9Wood's Monarch Clip and Monarch Rail.

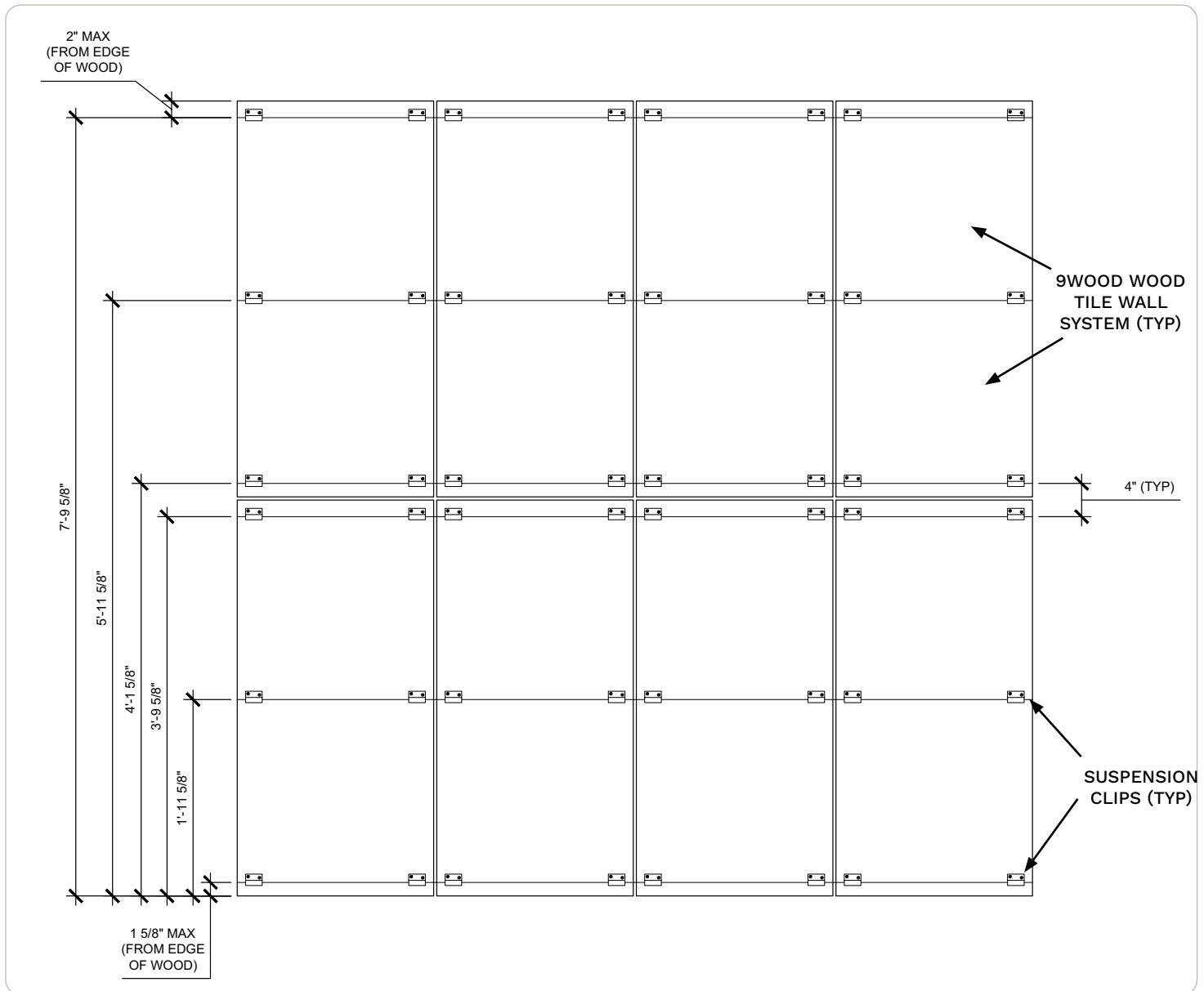

# WALL TILE | Typical Specifications



## Typical Specifications

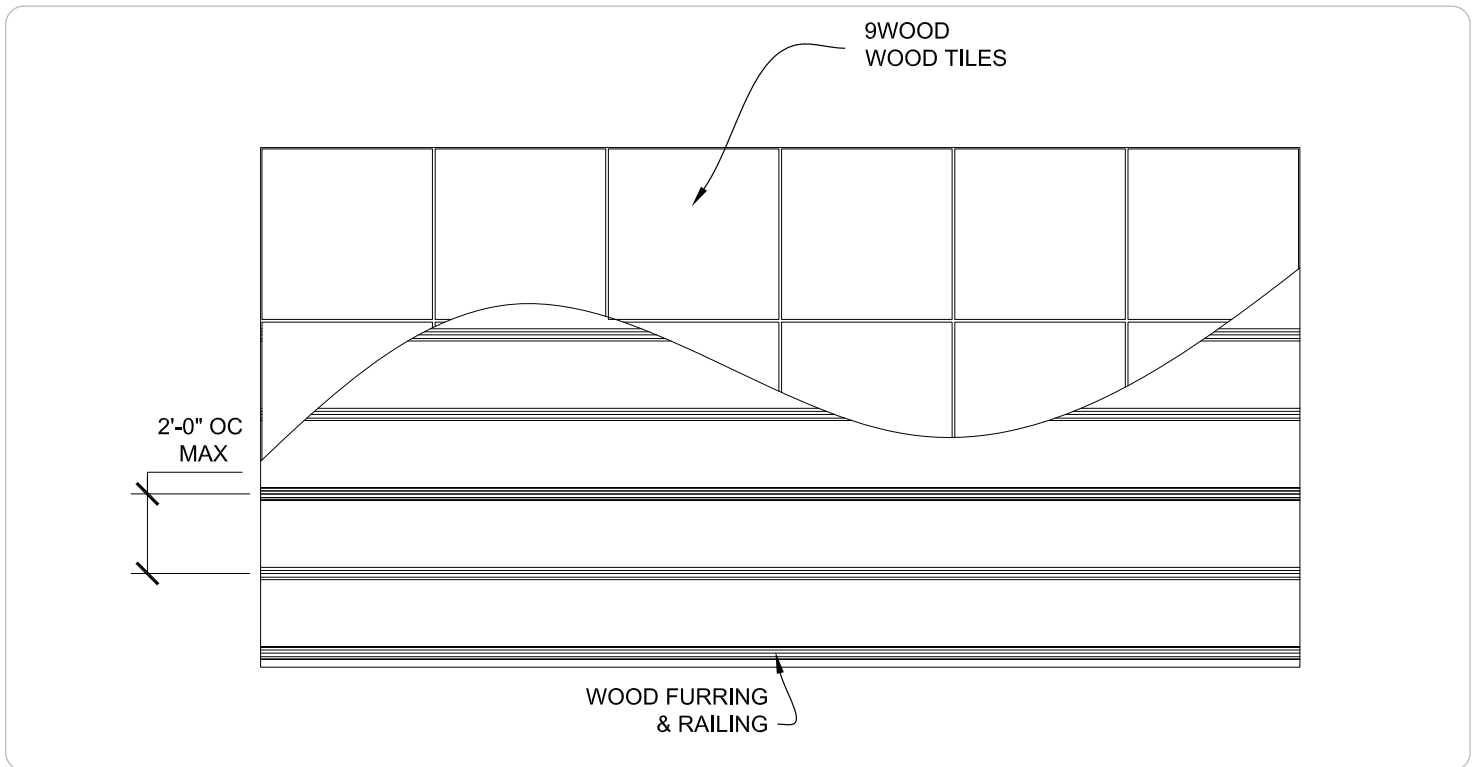

## Attachment & Perimeter Conditions

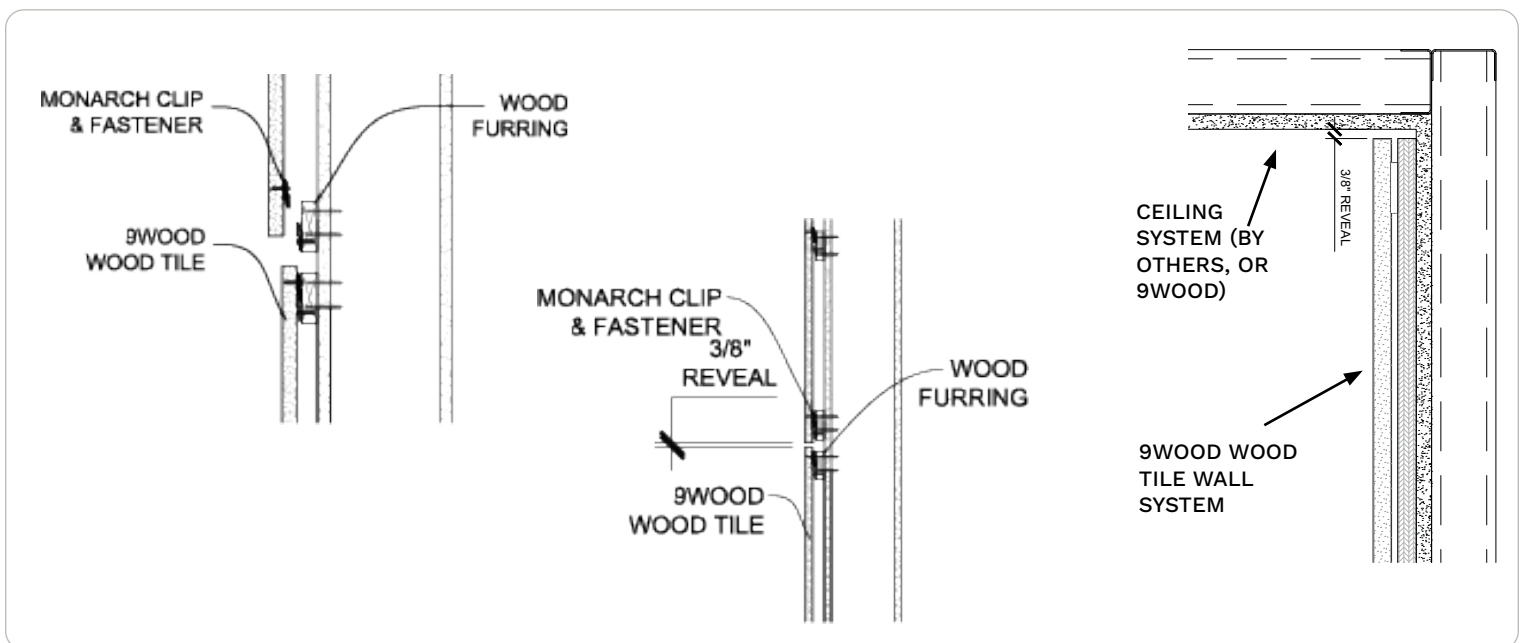



## How to build your SKU

- 1. Confirm your style.** You are specifying the 4900 Wall Tile system.
- 2. Define your nominal width.** (Rows). Choose the tile width that fits your wall layout (e.g. 24")
- 3. Define your nominal length.** (Columns) Select how long you want each individual tile to be.
- 4. Finalize the SKU.** Add the nominal length after the SKU. A 2' x 2' Wall Tile becomes 4924-24.

## SKU Decoder

- "Style" 4900 Wall Tile
- "Nominal Width" 24" Tile Width
- "Nominal Length" 24" Tile Length

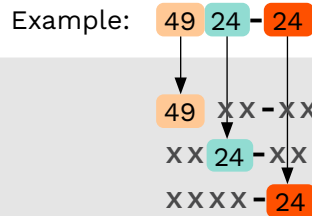

## SKU Table

Width	Nominal Width	Nominal Length (Parallel to Grain Direction)						
		24	36	48	60	72	84	96
11 5/8"	12	4912-24	4912-36	4912-48	4912-60	4912-72	4912-84	4912-96
23 5/8"	24	4924-24	4924-36	4924-48	4924-60	4924-72	4924-84	4924-96
35 5/8"	36	4924-24	4936-36	4936-48	4936-60	4936-72	4936-84	4936-96
47 5/8"	48	4948-24	4948-36	4948-48	4948-60	4948-72	4948-84	4948-96

Additional panel dimensions and tile options may be available. Please check with 9Wood if you don't see the combination that you have in mind.

# WALL TILE | Species & Finish Options



## Species Options

For veneer options, 9Wood Wall Tile can be produced in a range of real wood veneer species and finishes. Tiles are finished per the 9Wood proposal and approved control sample. Matching edgebanding is applied to all four edges, and field cut edges may require matching finish in the field. Please contact 9Wood for current species lead times and availability.

## Finish & Color Options

All products are finished with a clear matte topcoat, regardless of color. Standard Colors are available on Cherry and White Oak veneers. Custom Color Matching is always available with no required minimums and at the same cost as Standard options. Send 9Wood a control sample to get started.



**Cherry**  
Plain Sliced



**Douglas Fir**  
Quarter Sliced

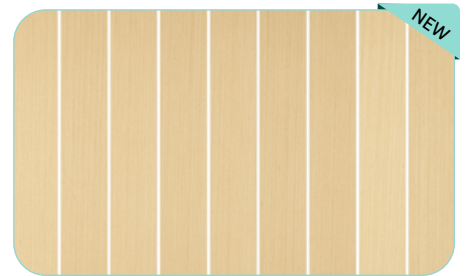

**Engineered Elm**  
Quarter Sliced

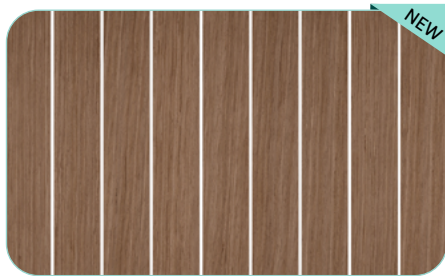

**Engineered Walnut**  
Quarter Sliced



**Khaya Mahogany**  
Quarter Sliced

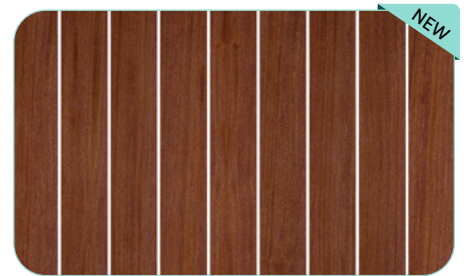

**Sapele**  
Quarter Sliced



**Walnut**  
Plain Sliced



**Walnut**  
Quarter Sliced



**White Ash**  
Plain Sliced



**White Maple**  
Plain Sliced



**White Oak**  
Plain Sliced



**White Oak**  
Rift Sliced



## Application

The 4900 Wall Tile is available in a variety of sizes. Matching edgebanding is applied to all four edges of the tiles. Wall Tiles are supported by Monarch Rails fastened to the wall structure, with wood furring used where required. Rail spacing and support conditions vary by tile size and project conditions. Field cut perimeter conditions may require relocated hardware or direct attachment to supplemental framing.

### Acclimatization

Wall Tiles must be cared for in a controlled interior environment and installed only after reaching equilibrium moisture content (RH 25%-55% max; temp. 60°-80°). A minimum of 72 hours of acclimatization is recommended before first testing for moisture equilibrium.

### Acoustics

The Wall Tile is considered acoustically reflective unless perforated. Black acoustically transparent reveal scrim may be provided when applicable.

### Fire Rating

Individual members use Fire Rated Patricalboard core and meet Class A per ASTM E84.

### LEED

Wall Tiles may help contribute to LEED credits for material sourcing, material ingredients, low emitting materials, and environmental product declarations. Credit support depends on design choices, please contact 9Wood for more information.

### Suspension

Wall Tiles are supported by Monarch Rails fastened to the wall structure or to wood furring where required. Rails and support members must align with the layout of the factory-attached Monarch Clips.

### MEP

The Wall Tile permits penetrations in the wall surface. Cut tiles may require supplemental framing, relocated hardware, or direct attachment. Fixtures, signage, and other wall-mounted elements must be independently supported

### Seismic

Wall Tiles may require supplemental framing, furring, or other attachment modifications to meet local code and seismic requirements. Please consult local code or a licensed engineer for additional requirements.

### System Weight

Wall Tiles typically weigh 3.5 pounds per square foot.



Custom  
made fast

9wood.com

999 South A Street  
Springfield, OR 97477  
Tel: 888-767-9990  
sales@9wood.com

This information is for illustrative purposes only. The featured products and processes are specific to the project and should not be duplicated without consulting 9Wood. © 2025 9Wood