



# Lightguide Stand (PN 41325)

## Assembly Instructions

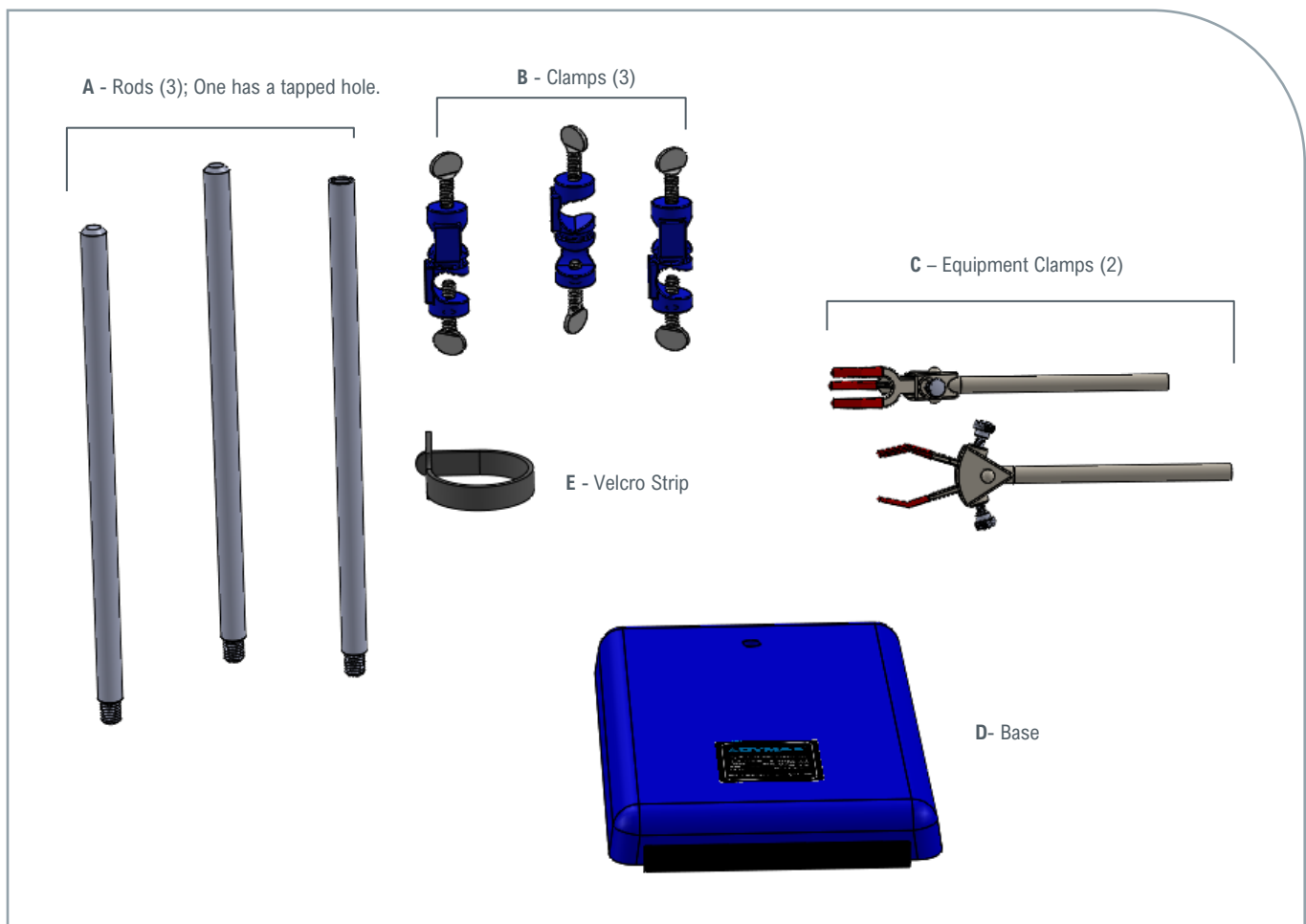
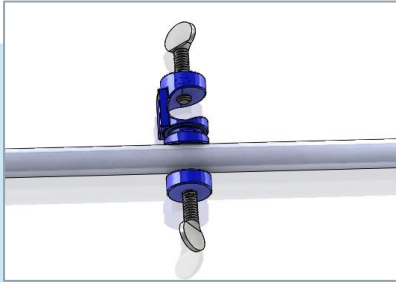


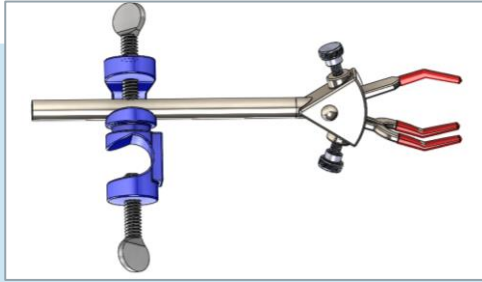
Figure 1. Lightguide Stand (PN 41325) Disassembled

1. Find a Rod (A) that does not have a threaded hole on one end. Place it into a Clamp (B) and tighten the Thumbscrew to secure the Rod in place (Figure 2).
2. Locate the two Equipment Clamps (C) and install a Clamp (B) on each Rod (Figure 3). Tighten the Thumbscrew.

NOTE: If a single-pole lightguide is being used, only one Equipment Clamp (C) is required.

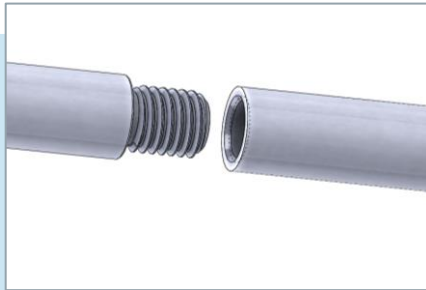


**Figure 2.** Install a Clamp on a Rod



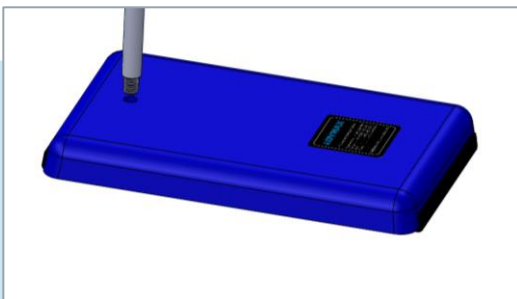
**Figure 3.** Install a Clamp on Each of the two Equipment Clamps

3. Take the two remaining Rods (A) and tighten them together (Figure 4).

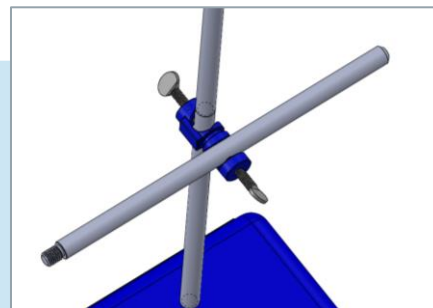


**Figure 4.** Connect the Two Remaining Rods

4. Place the Rod from Step 3 into the hole in the Base (D) and tighten (Figure 6).
5. At the desired height, install the Rod/Clamp Assembly from Step 1 onto the vertical Rod (Figure 7).



**Figure 6.** Install the Rod and Tighten



**Figure 7.** Install the Cross Rod and Tighten the Thumbscrew

6. Install the Equipment Clamps from Step 2 onto the Rod at the desired positions (Figure 8).

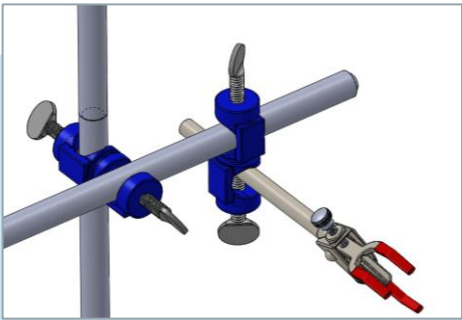


Figure 8. Install the Equipment Clamps

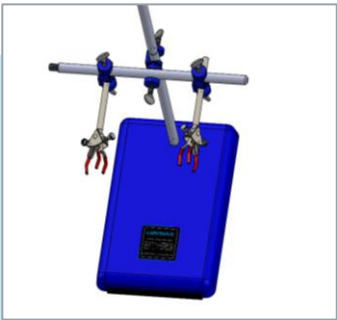


Figure 9. Assembled Stand

7. Attach the Lightguide to the Stand by clamping the metal part of the Lightguide in the Equipment Clamp (Figure 10). Note the Lightguide placement. Do not overtighten the Thumbscrews holding the Lightguide.



Figure 10. Attach the Lightguide to the Stand

Table 1. Minimum Bend Radius

Active Core Diameter (mm)	Minimum Bend Radius (mm)	
	Liquid	Fiber
3	40	60
5	60	70
8	100	100

8. If necessary, secure the Lightguides to the Rod using a Velcro Strap (E) (Figure 11).

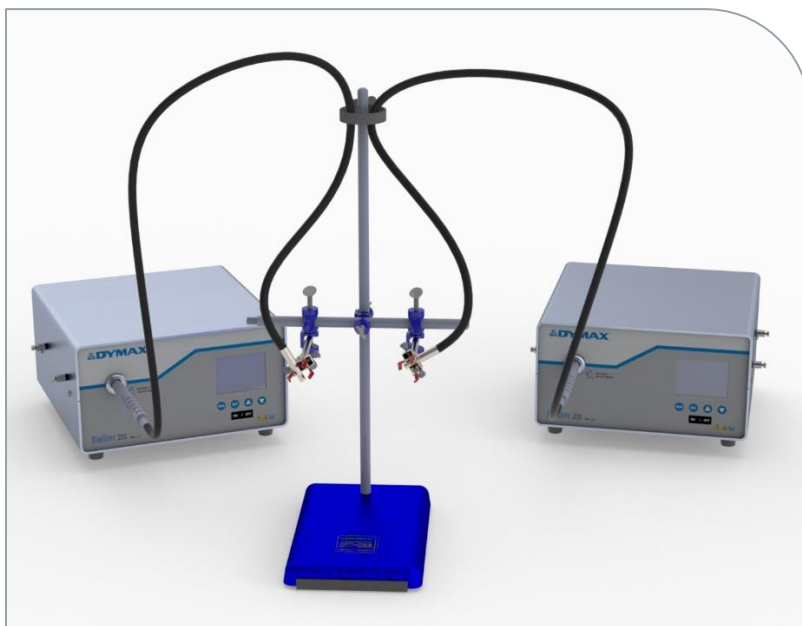


Figure 11. Assembled Stand Used with Two Spot Lamps