

index	2
veneer selections	3-4
edge selections	4
collection overview	5-6
wire management	7
trash/storage/audio visual/accessories	8
three door credenza	9
four door credenza	10
five door credenza	11
mediatrac 1™ grommets	12
accessories	13
terms and conditions	14-16
guaranteed freight	17
guaranteed freight - canada	18

SCS Indoor Advantage™ Gold and LEVEL® 1 certified. See terms and conditions for additional environmental information.

Veneer Selections

A three character sku identifies each species as well as the standard finish offered. Individual components are priced with standard finish. Special finishes on veneers made to customer specifications are subject to factory approval and a 10% net upcharge with a \$500 net minimum.

Transparent stains and sealers are applied in multiple steps to enhance the beauty of the natural wood. A durable, baked-on, top-coat of conversion varnish

or UV topcoat is applied to protect the product. It is recommended that felt, cork or fabric backed desk pads and accessories are used on worksurfaces to minimize wear.

When specifying light finishes the natural characteristics of the wood will be visible and color will vary. Paint finishes are available as custom orders. See terms and conditions for additional finish information.

MPL Maple
Flat Cut

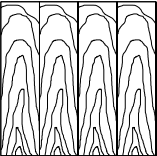

Standard Finish
871 860 861
837 836 823
865 805 866
872 839 845
870

OAK Oak
Rift Cut

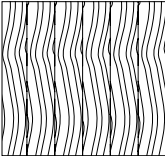

Standard Finish
871 870 839
837 860 861
865 836 866
872 805 845

OAK Select Finishes
M73 M72 M75
M74 M76 M77
M71

WLT Walnut
Flat Cut

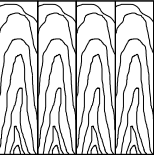

Standard Finish
872 861
870 823
860 866
839

MPL Maple



OAK Oak



OAK Select Finishes

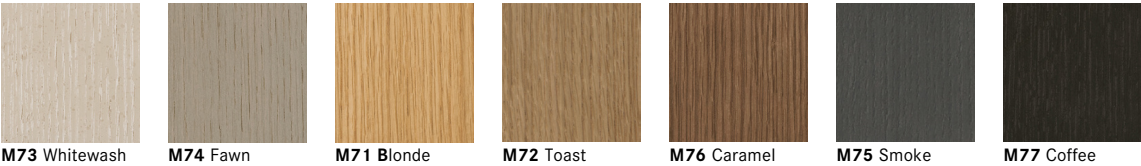

Veneer Selections

WLT Walnut



Design Selections

Veneer Edge Selection



FL 1'' Flat Edge

Profile Credenzas

Profile Credenzas are designed to accommodate trash/recycling, storage and audio visual equipment. The credenza offering includes skus as stand alone credenzas as well as ones with integral short and tall pillars. Each credenza has an integrated spacer that provides $1\frac{1}{4}$ " gap off of the wall as well as $1\frac{1}{8}$ " off the floor for proper air flow. Each credenza has a 1" top and an overall height of 30".

Three Door Credenza

Profile three door credenzas are available in (5) configurations:

- storage - av - storage
- trash - av - storage
- trash - av - recycle
- trash - av - av
- storage - av - av

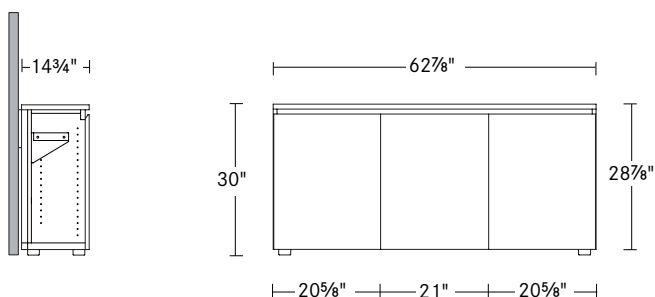

End View

Shown on wall without pillar and with AV rack

Front View

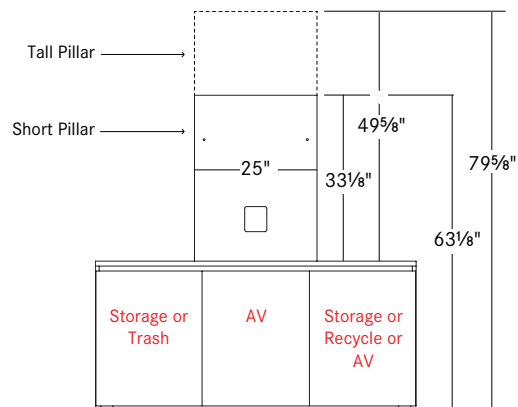

Three Door Credenza

Showing Short Pillar and Tall Pillar

Four Door Credenza

Profile four door credenzas are available in (3) configurations:

- storage - av - av - storage
- trash - av - av - storage
- trash - av - av - recycle

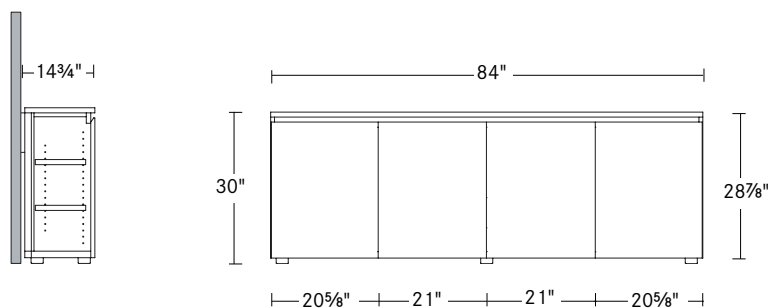

End View

Shown on wall without pillar and with shelves

Front View

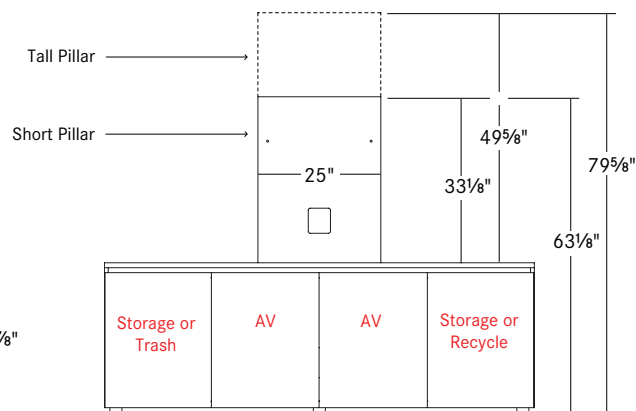

Four Door Credenza

Showing Short Pillar and Tall Pillar

Profile Credenzas

Five Door Credenza

Profile five door credenzas are available in (3) configurations:

- trash - storage - av - av - recycle
- trash - storage - av - av - storage
- storage - storage - av - av - storage

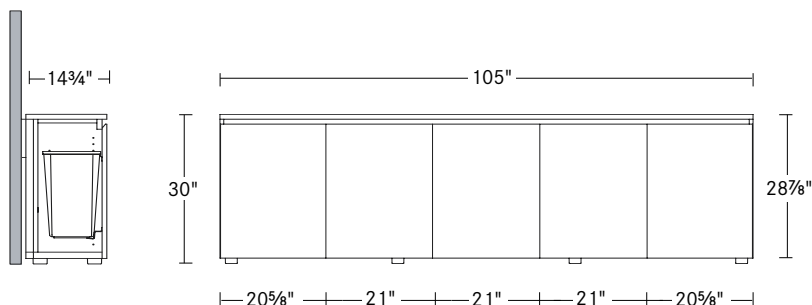

End View

Shown on wall without pillar and with trash

Front View

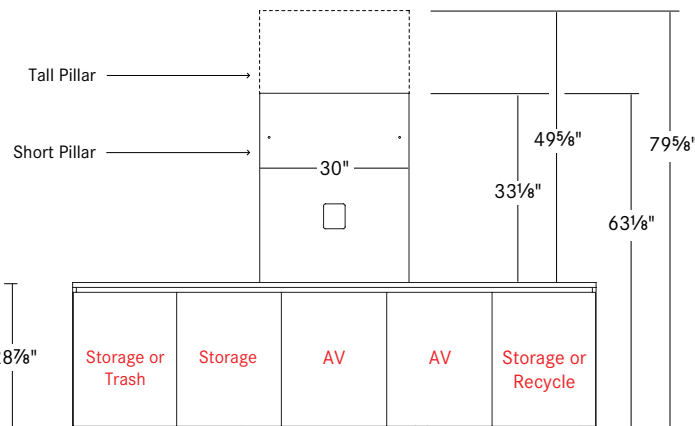

Five Door Credenza

Showing Short Pillar and Tall Pillar

Wire Management and Air Flow

Profile credenzas feature concealed wire management for TV displays and AV units, with concealed grommets in the back panel to allow cord pass through.

Profile pillars are designed for a TV to be mounted at any height on the pillar via a TV display mount. Each credenza is designed to accommodate different sized TV's:

3 Door Credenza - TV up to 65"w class

4 Door Credenza - TV up to 75"w class

5 Door Credenza - TV up to 98"w class with customer supplied display mount

The Profile credenza assembly will require the installation of the pillar and case. Bernhardt design recommends the use of 1/4" - 20 Toggler® Snaptoggle wall anchors (provides 356 lbs of security in 5/8" drywall) in both the pillar and case. Case is mounted 2" from wall for wire management and air flow.

Secure television mount per included instructions with included hardware.

Please see Bernhardtdesign.com for profile credenza installation instructions.

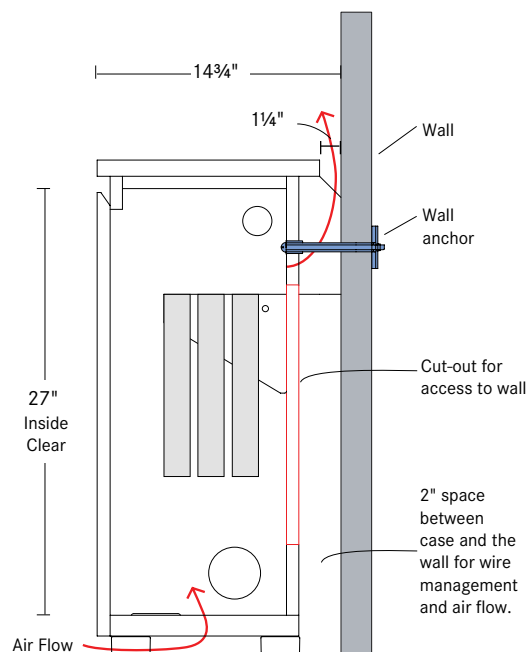

Section view showing relationship of credenza to wall.

Wire Management

Short Pillar - Showing AV Credenza and Wire Management

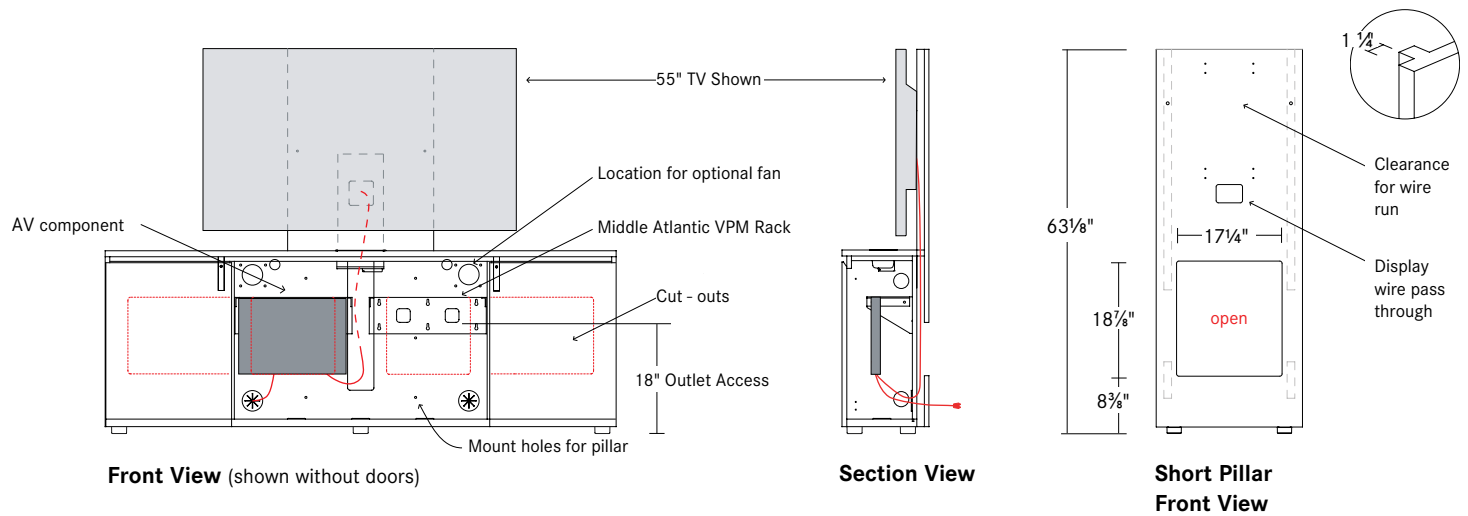

Tall Pillar - Showing AV Credenza and Wire Management

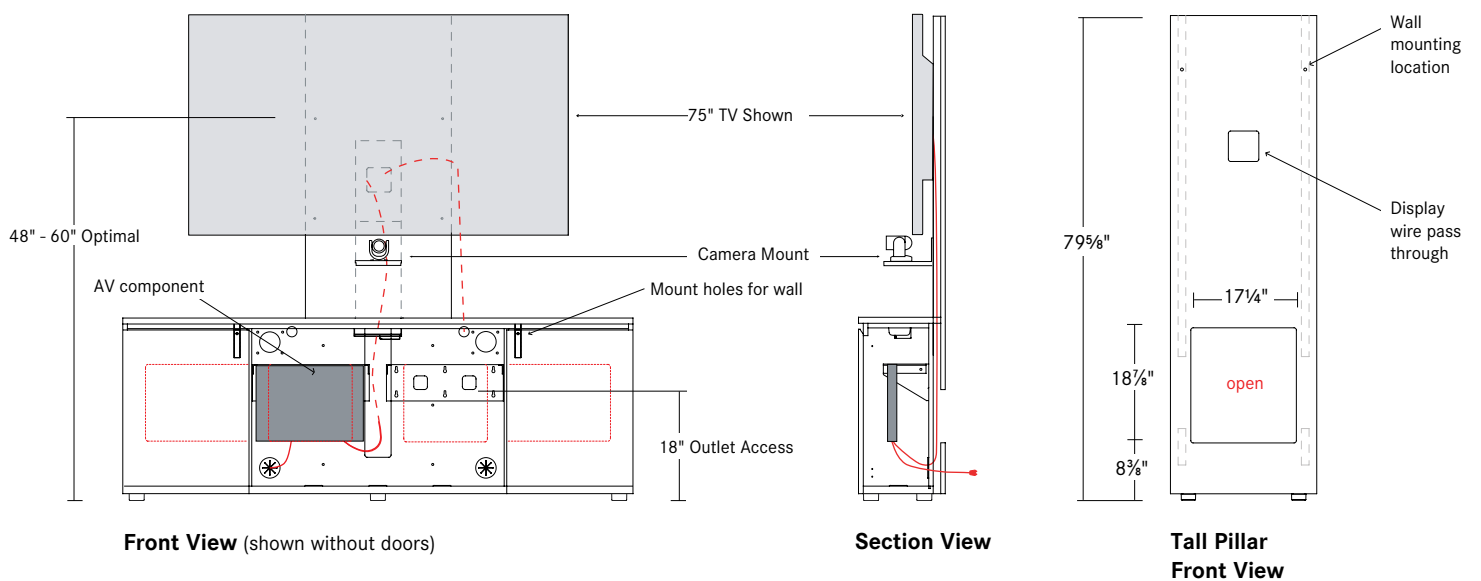

Trash/Storage/Audio Visual

Profile credenzas are designed to accommodate trash/recycling, storage and audio visual equipment.

Trash/Recycling Credenza

Tilt trash, 9¼"w x 17½"h. Gray

Includes: 1 Rubbermaid open top 35 quart trash can
1" square adhesive backed trash and recycled icons
included for optional on-site installation.

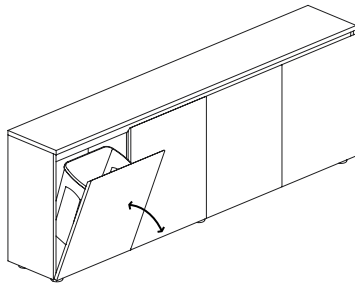

Storage

All storage units include (2) adjustable shelves.

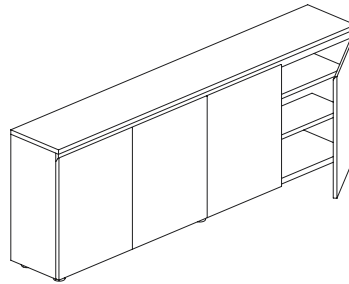

Audio Visual

Each credenza comes standard with a back panel that provides easy access to the wall receptacles. VPM-4 racks are available for installation, allowing for more flexibility and usage of space. Cord exit through gland grommet. Optional fan allows for 50 CFM air circulation. Vents in bottom panel allow for cool air to be pulled through.

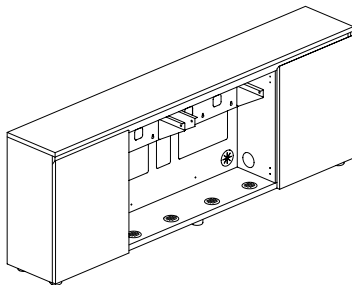

Front View (Shown without doors)

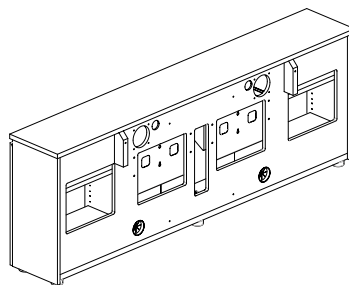

Back View

Audio Visual Rack

VPM-4, Shelf max weight capacity: 200 lbs
Rack Shelf: 6" usable depth, 19¼" usable width
Mounting horizontal/vertical,
Able to mount (4) vertical shelves

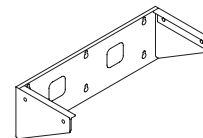

Accessories

Display Mount

Sanus Monitor Mount
Black Finish, Max Weight: 150lbs
TV Size Range: 32" - 85" class
Slim, fixed position mounted
Available range for most displays

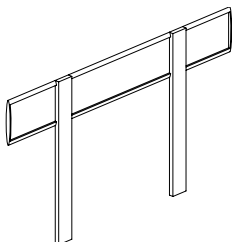

Vertical Shelf

UTR1

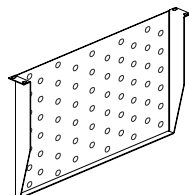

Fan

QFAN
Fan output: 50 CFM
115V, < 30dBA
Continuously running fan, no
thermostatic switch

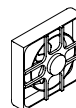

Camera Mount

mounts to monitor
black powder coat
12"w x 6¼"d x 1¼"h

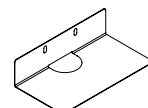

**three door credenza**

av comes standard with mounting hardware, specify rack separately
 storage units come standard with two adjustable shelves
 35 qt. gray tilt trash/recycle can, 9¼"w x 17½"h
 vented back panel
 for power, specify grommet type separately, see page 12
 all units are intended to be attached to the wall

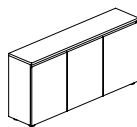
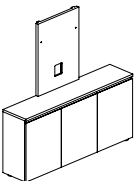
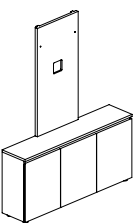
description		sku	w	d	h	specifications	MPL maple OAK oak WLT walnut
	credenza	CAW	62⅞	14¾	30	storage - av - storage	\$ 8750
		CBW	62⅞	14¾	30	trash - av - storage	8904
		CCW	62⅞	14¾	30	trash - av - recycle	8904
		CDW	62⅞	14¾	30	trash - av - av	8904
		CEW	62⅞	14¾	30	storage - av - av	8750
	short pillar + credenza	TAW	62⅞	14¾	30/63⅞	storage - av - storage	9060
		TBW	62⅞	14¾	30/63⅞	trash - av - storage	9216
		TCW	62⅞	14¾	30/63⅞	trash - av - recycle	9216
		TDW	62⅞	14¾	30/63⅞	trash - av - av	9216
		TEW	68⅞	14¾	30/63⅞	storage - av - av	9060
	tall pillar + credenza	SAW	62⅞	14¾	30/79⅞	storage - av - storage	9060
		SBW	62⅞	14¾	30/79⅞	trash - av - storage	9216
		SCW	62⅞	14¾	30/79⅞	trash - av - recycle	9216
		SDW	62⅞	14¾	30/79⅞	trash - av - av	9216
		SEW	62⅞	14¾	30/79⅞	storage - av - av	9060

specification codes example: PRS-SKU-MP4

series	sku	grommet	
profile		MP4	grommet
		000	none
P R S -	-		

material/finish code example:

WLT

material	finish
MPL maple	see pages 7-8
WLT walnut	
OAK oak	

**four door credenza**

av comes standard with mounting hardware, specify rack separately
 storage units come standard with two adjustable shelves
 35 qt. gray tilt trash/recycle can, 9¼"w x 17½"h
 vented back panel
 for power, specify grommet type separately, see page 12
 all units are intended to be attached to the wall

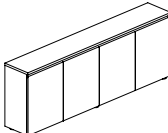
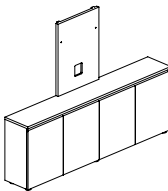
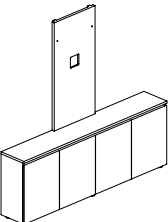
description						MPL maple OAK oak WLT walnut	
	credenza	sku	w	d	h	specifications	
		CAL	84	14¾	30	storage - av - av - storage	\$ 9843
		CBL	84	14¾	30	trash - av - av - storage	9997
		CCL	84	14¾	30	trash - av - av - recycle	9997
	short pillar + credenza	TAL	84	14¾	30/63⅞	storage - av - av - storage	10153
		TBL	84	14¾	30/63⅞	trash - av - av - storage	10310
		TCL	84	14¾	30/63⅞	trash - av - av - recycle	10310
		appropriate for tv's ranging up to 75"w class					
	tall pillar + credenza	SAL	84	14¾	30/79⅞	storage - av - av - storage	10153
		SBL	84	14¾	30/79⅞	trash - av - av - storage	10310
		SCL	84	14¾	30/79⅞	trash - av - av - recycle	10310
		appropriate for tv's ranging up to 75"w class					

specification codes example: PRS-SKU-MP4

series	sku	grommet	
profile		MP4	grommet
		000	none
P R S -	-		

material/finish code example:

WLT

material	finish
MPL maple	see pages 7-8
WLT walnut	
OAK oak	

**five door credenza**

av comes standard with mounting hardware, specify rack separately
 storage units come standard with two adjustable shelves
 35 qt. gray tilt trash/recycle can, 9¼"w x 17½"h
 vented back panel
 for power, specify grommet type separately, see page 12
 all units are intended to be attached to the wall

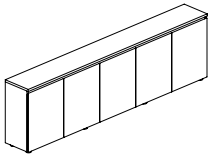
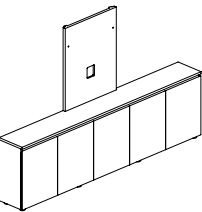
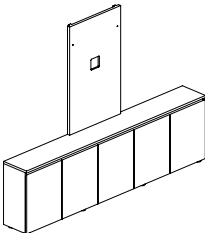
description		sku	w	d	h	specifications	MPL maple OAK oak WLT walnut
	credenza	CEI	105¼	14¾	30	storage - storage - av - av - storage	\$ 11090
		CDI	105¼	14¾	30	trash - storage - av - av - storage	11245
		CCI	105¼	14¾	30	trash - storage - av - av - recycle	11402
	short pillar + credenza	TEI	105¼	14¾	30/63½	storage - storage - av - av - storage	11402
		TDI	105¼	14¾	30/63½	trash - storage - av - av - storage	11560
		TCI	105¼	14¾	30/63½	trash - storage - av - av - recycle	11716
	appropriate for tv's ranging up to 98"w class						
	tall pillar + credenza	SEI	105¼	14¾	30/79½	storage - storage - av - av - storage	11402
		SDI	105¼	14¾	30/79½	trash - storage - av - av - storage	11560
		SCI	105¼	14¾	30/79½	trash - storage - av - av - recycle	11716
	appropriate for tv's ranging up to 98"w class						





specification codes example: PRS-SKU-MP4

series	sku	grommet	
profile		MP4	grommet
		000	none
P R S -			

material/finish code example:

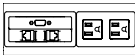
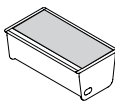
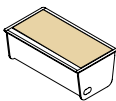
WLT

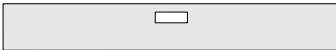
material	finish
MPL maple	see pages 7-8
WLT walnut	
OAK oak	



description	sku	w	d	h	specifications	price
8" single door mediatrac1™ grommet						
AAP module specified separately						
						
	aluminum	VAZ	8	4	3½	120" corded
	2 grounded outlets, 1 exit plug	VAT	8	4	3½	72" hardwired
	accepts 2 Extron single space AAP's	VA1	8	4	3½	18" 4-trac modular end
	brushed aluminum frame and lid					
specify grommet when ordering top						
	laminate/veneer	VWZ	8	4	3½	120" corded
	2 grounded outlets, 1 exit plug	VWT	8	4	3½	72" hardwired
	accepts 2 Extron single space AAP's	VW1	8	4	3½	18" 4-trac modular end
	brushed aluminum frame with laminate or veneer lid					
specify grommet when ordering top						
specify laminate or veneer lid material code and finish code						
						
3 Doors						
						
4 Doors						
						
5 Doors						

specification codes example: MGS-SKU

series	sku
M G S -	

material + finish code example: WLT 839

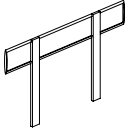
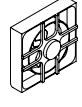
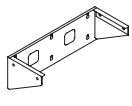
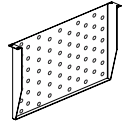
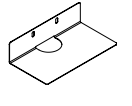
grommet lid	finish
MPL maple WLT walnut OAK oak	see pages 7-8

description		sku	w	d	h	specifications	price
	display mount sanus monitor mount black finish, max weight: 150 lbs. slim, fixed position mounted available range for most displays	TVS	18 3/4	5/8	17 1/2	up to 32"w-50"w class tv	\$ 758
		TVL	30 1/2	5/8	17 1/2	up to 40"w-85"w class tv	894
	fan QFAN fan output: 50 CFM 115V <30dBA constantly running no thermostatic switch	FN1	4 1/2	1 1/2	4 1/2		208
	av rack VPM - 4, shelf max weight capacity: 200 lbs rack shelf: 6" usable depth, 19" usable width mounting: horizontal/vertical able to mount (4) vertical racks mounts into threaded inserts	VSV	19 1/4	6	7		669
	vertical shelf UTR1 weight capacity: 25 lbs. holds small components, wireless units and other gear	VSH	19	10	1 3/4		302
	camera shelf mounts to monitor mount panel top or bottom panel mount holds any polycam camera wire pass through in back black powder coat steel	WCS	12	6 1/4	1 1/4		225
	wire clip kit (5) 1/2" cable clamps (5) 1/2" large cable holders hardware included	WMP	1 5/8	7/8	1 1/2		130

specification codes example: ACS SKU

series	sku
A C S -	

Prices and Specifications

Prices and specifications are subject to change without notice. All prices quoted will be FOB our factories. If applicable, sales tax will be based on ship-to destination.

Bernhardt Design reserves the right to make changes in dimensions, construction, price lists, or product literature without prior notice.

All measurements and weights are approximate and subject to change without notice.

Order Entry

All orders are subject to final acceptance by Bernhardt Design in Lenoir, NC. Receipt of our acknowledgment indicates acceptance of your order subject to the terms set forth on the acknowledgment.

Bernhardt Design attempts to clarify all purchase orders. However, in the event the price list number and description on the purchase order differ, the price list number will prevail.

Changes/Cancellation

All orders in production are considered firm orders and are not subject to changes or cancellation.

Shipping

Bernhardt Design will ship in accordance with customer instructions whenever possible. For convenience, Bernhardt Design offers a guaranteed freight program (GFP). Bernhardt Design will exercise our best judgment in selecting a carrier under our GFP. When selecting a carrier, Bernhardt Design will make our best effort to meet requested delivery dates.

Transportation lead-times and delays including equipment problems, weather, general traffic, traffic accidents, customer warehouse space, labor disputes, customer changes, etc., that occur on a carrier will not be the responsibility of Bernhardt Design. Furthermore, Bernhardt Design will not be responsible for additional costs incurred due to aforementioned delays.

For customers who decline our GFP, Bernhardt Design will stage orders for pick up at 1% of the list price, or \$75 minimum.

Customer orders in production will be shipped as scheduled and will not be held. Bernhardt Design reserves the right to make partial shipments on any order, unless notified otherwise by the customer.

High quality cartoning meeting trucking and railroad specifications is standard at no extra charge. Some items may be blanket wrapped for shipment.

Freight Damage and Claims

Bernhardt Design is not liable for any damages to products that occur during transit or storage. The carrier assumes all responsibility upon acceptance of product. It is the customer's responsibility to inspect products upon receipt and file any claims with the carrier. No product should be refused. If products are received damaged, a written exception should be made on the bill of lading and an immediate inspection be requested of the carrier.

Concealed damage must be reported to the carrier within 10 business days from date of delivery. Failure to make claims shall constitute acceptance of the products and waiver any claims of defects, errors or shortages.

In the event delivery is made on a Bernhardt Design truck, the products should be carefully inspected for transit damage. If contents are damaged, the driver should be notified to call his dispatcher for immediate disposition.

Concealed damage must be reported within 10 business days from date of delivery and product/package held for inspection by a Bernhardt Design representative. Replacements for product damaged in shipment or storage will be manufactured upon receipt of a purchase order.

Returns

No merchandise may be returned to Bernhardt Design without written consent in the form of a Return Authorization from our Quality Assurance Department stating why item is being returned and how item will be shipped.

Unauthorized returns will be automatically refused by our receiving department as well as returns not in accordance with Bernhardt Design shipping instructions. Liability for defective merchandise shall be limited to the replacement or repair of that merchandise, and Bernhardt Design shall not be liable for other damages or losses.

Terms and Credit

Pricing and terms of sale apply to orders accepted by Bernhardt Design, and no terms, stipulations, or conditions contained in the dealer's submitted purchase orders shall have any force or effect. Bernhardt Design requires a completed and signed credit application from every dealer. Bernhardt Design also requires dealers to provide a Blanket Certificate of Resale/Use containing valid sales tax exemption number(s) for their respective state(s).

If credit has been approved, the standard terms for all Bernhardt Design products are Net 30 from the invoice date. In certain instances, as an additional condition of order acceptance, buyer may be required to provide a deposit at time of order and/or remit the balance before shipment is released. If credit has not been approved, a 100% prepayment, including any freight charges, is required prior to production.

Acceptable forms of payment include a certified check or electronic bank transfer. For information on where to send check/electronic bank information contact our Financial Services Department. If a dealer or company check is submitted, three (3) weeks should be allowed for the clearance of the check. If electronic bank transfer is submitted, one (1) week should be allowed for the clearance of the electronic bank transfer. The order is subject to cancellation if payment in full is not received within three (3) weeks from the acknowledgment date.

The dealer may not make deductions for advertising, promotions, quality problems, freight, or any other reason without prior authorization by Bernhardt Design. Such a deduction could result in the curtailment or suspension of further shipments until the matter is resolved. Delinquency notices are generated and mailed periodically. Service charges of 18% per annum will be added to each past-due transaction. Unpaid service charges

will be accrued and invoiced on a periodic basis. Past-due notices may result in orders being held until the situation is resolved. This credit hold could prevent orders from being placed into production or shipped. Orders not in production that are placed on credit hold for three (3) weeks will be subject to cancellation.

Severe past-due situations may result in the employment of a collection agency or other collection litigation. If any collection activity is necessary regarding a dealer account, the dealer will be responsible for the payment of any and all attorney and collection agency fees.

A slow payment history may result in reducing or eliminating an open line of credit. At the discretion of Bernhardt Design, amounts owed by a dealer to Bernhardt Design arising from any transaction or dealings between the dealer and Bernhardt Design may be offset against any amounts owed to the dealer by Bernhardt Design.

Warranty

Bernhardt Design will repair or replace, at its discretion, any product or part thereof which fails as the result of defects in material and workmanship, under single shift use and normal care for five years from date of shipment. This warranty shall apply only to the original purchaser.

This warranty does not cover normal wear and tear, misuse or abuse of product, dramatic temperature changes, exposure to unusual conditions or damages incurred by contact with seating products, tables, desks or other surfaces. Natural color changes, variations or movements in lumber or veneer products, exposure to extreme temperature changes and direct sunlight may cause color changes and/or surface damage. These are circumstances beyond the control of Bernhardt Design and are not warranty issues. Repair or replacement of discontinued product will be at the discretion of Bernhardt Design.

This warranty is the customer's exclusive remedy for product defect and does not apply to damage caused by a freight carrier, dealer, installer, user modification, attachments to a product, or any third party. Bernhardt Design has the exclusive right to make the final determination of product misuse or abuse. Except as stated above, Bernhardt Design makes no express or implied warranties as to any product, and in particular, makes no warranty of merchantability or of fitness for any particular purpose. Bernhardt Design shall not be liable for any consequential or incidental damages or for commercial loss arising from any product defect.

Operational Parts Warranty

Drawer glides, drawer boxes, drawer pulls, and lock mechanisms have a Life-Time Warranty for original purchaser. Power and communication components are warranted for one year.

Parts Order

Bernhardt Design parts have a \$25 net minimum per order. This does not include freight costs.

Custom Design

Bernhardt Design may alter products to meet specific needs. Contact your local sales representative when a custom design is needed. Custom designs,

if approved, require minimum quantities, additional leadtime and upcharges.

A custom job number, available from your Bernhardt Design sales representative, must be submitted with purchase orders.

Orders combining custom design with standard product cannot be scheduled for production until custom items are approved. Custom design orders are not subject to revision or cancellation after acknowledgment.

Wood Finishes

Bernhardt Design tables are available in finishes that are compatible with credenzas and seating finishes. However, finishes on tables may vary slightly from those on seating due to the natural characteristics of the wood. No absolute match is implied or guaranteed.

Light Finishes

Bernhardt Design offers lighter finishes on certain veneers and solid woods. When specifying light finishes the natural characteristics of the wood will be visible and color will vary.

Natural characteristics include the natural discolorations of the wood substance and color variations in glued up stock. These natural characteristics are not considered defects by Bernhardt Design, and therefore merchandise will not be replaced.

Special Finishes

Special finishes, made to customer specifications and subject to factory approval, may be available at a **10% net upcharge with a \$500 net minimum**.

Additional leadtime may be required for special finish items. Special finish orders will not be acknowledged until the special finish sample is approved in writing and received by Bernhardt Design Customer Service. Special finish orders are not subject to revision or cancellation after acknowledgment.

Installation and Maintenance

All freestanding tables and credenzas are equipped with leveling devices. Local floor conditions vary, and it is always necessary to properly adjust leveling devices. Proper leveling is essential to the alignment and function of doors and drawers.

Improperly leveled units result in misaligned doors and drawers and may impair locking mechanisms or other functional hardware.

After the initial installation of credenzas, it may be necessary to readjust and align the units to compensate for settling. This should be expected as a matter of routine maintenance and follow-up to assure proper case function.

Proper installation of Bernhardt Design tables and credenzas is the responsibility of the dealer. Improperly installed units can result in permanent damage to case components. Damage due to improperly installed furniture not covered under product warranty.

Orders combining custom design with standard product cannot be scheduled for production until custom items are approved. Custom design orders are not subject to revision or cancellation after acknowledgment.

Care and Cleaning

Finished wood surfaces should be cleaned with a soft damp cloth, wiping in the direction of the grain. Furniture should be buffed dry immediately with a soft cloth.

Design and Patent Rights

All of the products shown in Bernhardt Design catalogs and described in Bernhardt Design price lists are, and remain, the property of Bernhardt Design, with the sole right reserved to manufacture and to distribute.

Some of the product designs shown are patented in the United States and will remain the property of Bernhardt Design. Any reproduction of the products constitutes an infringement of patented copyright laws and will be subject to prosecution.

Environmental

Some tables and credenzas are LEVEL® for ANSI/BIFMA e3-2019 – Furniture Sustainability Standard and SCS Indoor Advantage™ Gold certified. Visit the product page at bernhardtdesign.com for certifications.

Freight charges will be applied to orders as a separate line item based on the zones listed. Rates are based on zones with a minimum for each zone. All zones are located within the Continental United States.

All orders are shipped by Bernhardt Design company trucks or preferred carriers specified by Bernhardt Design. **If a purchase order does not specify that the product must ship complete, Bernhardt Design reserves the right to select the most effective shipping method necessary, including split shipments.** Dealer warehouse information, including phone number and contact name, must be specified on the purchase order.

- Minimum of half truckload
- Delivery site accessible by a 53' trailer
- Complete delivery site address with contact name and on-site phone number
- Labor available for unloading

Bernhardt Design has a no touch freight policy. Drivers are not allowed to unload freight.

Customers who decline GFP should refer to the shipping section of the Terms and Conditions page.

Zone	Percent	Minimum
Zone 1	3%	\$150
Zone 2	4%	\$150
Zone 3	5%	\$150
Zone 4	5.5%	\$150
Zone 5	6%	\$150

Percent bases on List Price.

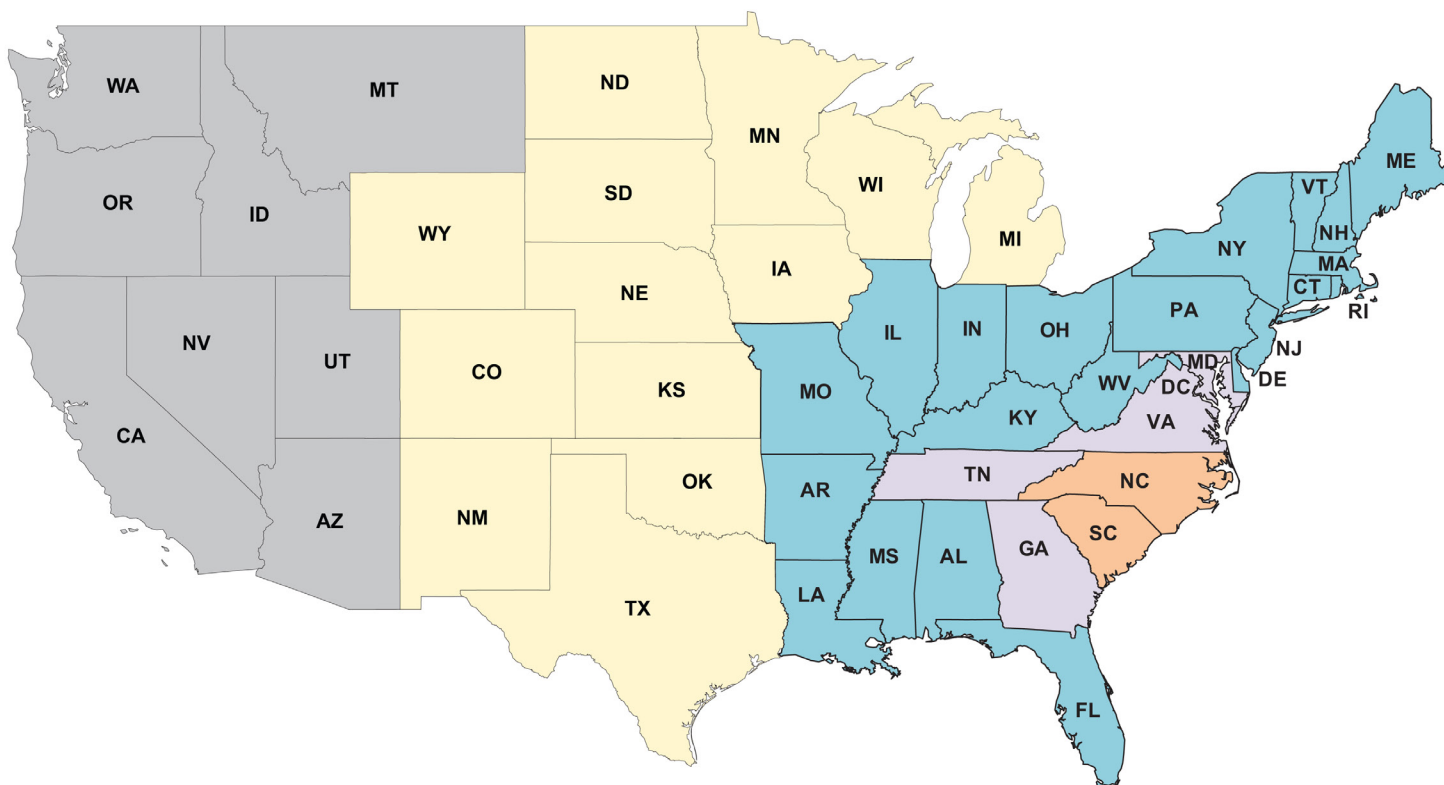

Preferred Carrier Guaranteed Freight Rates - Canada

Freight charges will be applied to orders as a separate line item based on the zones listed. Rates are based on zones with a minimum for each zone.

The freight amount is calculated on the total merchandise list COM price. Additional freight fuel surcharges may apply. Rates are based on deliveries made Monday through Friday, 8 am until 5 pm.

All orders are shipped by Bernhardt Design company trucks or preferred carriers specified by Bernhardt Design. **If a purchase order does not specify that the product must ship complete, Bernhardt Design reserves the right to select the most effective shipping method necessary, including split shipments.** Dealer warehouse information, including phone number and contact name, must be specified on the purchase order.

Direct site deliveries may be requested with an additional freight cost. Requests for direct site deliveries must be made 2 weeks prior to the scheduled ship week and meet the following criteria:

- Minimum of half truckload
- Delivery site accessible by a 53' trailer
- Complete delivery site address with contact name and on-site phone number
- Labor available for unloading

Deliveries that do not meet the criteria must be directed to a receiver warehouse. If a receiver warehouse is not available, the dealer may make arrangements with their own 3rd party carrier. If a 3rd party carrier is elected, a contact name, phone number and e-mail address is required.

Bernhardt Design has a no touch freight policy. Drivers are not allowed to unload freight.

Weekend direct site deliveries will incur a \$500 per trailer weekend delivery fee. Weekend is defined as between 5 pm Friday and 8 am Monday.

Customers who decline GFP should refer to the shipping section of the Terms and Conditions page.

Zone	Minimums	Freight	Avg. Bus. Days
Zone 1	\$200	5%	10 - 15
Zone 2	\$200	9%	10 - 15
Zone 3	\$200	8%	10 - 15
Zone 4	\$200	11%	10 - 15
Zone 5	Quote	Quote	

The attached rates are strictly freight and do not include brokerage fees.

