

## vendome price list

september 2024



complete  
overview  
product

---

|                                  |       |
|----------------------------------|-------|
| index                            | 2     |
| overview                         | 3     |
| powder coat + fabric selections  | 4     |
| overview                         | 5     |
| privacy screens                  |       |
| straight                         | 6     |
| tall straight                    | 7     |
| corner                           | 8     |
| angled                           | 9     |
| tall angled                      | 10    |
| preapproval procedure for fabric | 11    |
| terms and conditions             | 12-14 |
| guaranteed freight               | 15    |
| guaranteed freight - canada      | 15    |

## Powder Coat Selections

A two-character sku identifies each powder coat finish offered. Individual skus are priced with standard metal finish. Non-standard finishes may incur an additional charge. The powder coat option is available on skus where noted as an option in the material specification code.

### Powder Coat Finishes

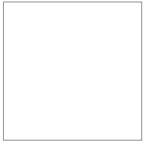

WH Satin White



AL Matte Aluminum



GR Graphite

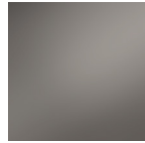

BZ Bronze



IG Iron Grey



RD Black Red



BK Matte Black

### Optional Powder Coat Colors - RAL

- Lead Time - Three weeks additional lead-time after color approval
- Net Up-charge - \$1000 for colors shown in Bernhardt Design RAL Powder Coat Selector
- Minimum Order Quantity - None
- Approval Sample Cost - None
- Combining Products - One up-charge is applicable for multiple products on a single purchase order when they are in the same color

### Custom Powder Coat Colors

- Lead Time - Eight weeks additional lead-time after color approval
- Net Upcharge - \$3000 for solid custom colors
- Net Upcharge - To be quoted upon request for metallic custom colors
- Minimum Order Quantity - None
- Approval Sample Cost - None
- Combining Products - One up-charge is applicable for multiple products on a single purchase order when they are in the same color

### Fabric Selections

Panels were tested and pass ASTM-E84/UL 723 Class B flame spread test with ASTM-E84 rated fabric. **Bernhardt Textiles offers fabrics that comply to ASTM-E84 rating. View available Bernhardt fabrics in the graded-in textiles listing shown on the Vendome product page. Pricing shown within the price list includes the graded-in textiles pricing.**

### COM

**All COM fabrics must pass ASTM-E84 with documentation in order to be applied to Vendome screens.**

**Bernhardt Textiles** - For more information, please visit [BernhardtTextiles.com](https://www.bernhardttextiles.com).

**Vendome Privacy Screen**



Vendome Screens are a collection of five different sculptural screens that provide flexibility and privacy in open spaces. The collection features acoustical screens in five different lengths and two heights. Vendome screens are available in distinctive shapes that present an opportunity for unique configurations. The screens are fully upholstered with a 1/4" powder coated steel base, available with non-marring glides. SCS Indoor Advantage™ Gold certified.

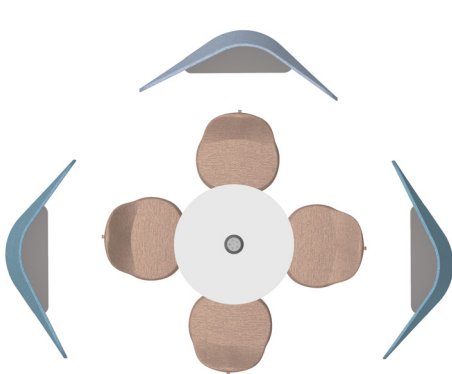

**Create a private conference/cafe space**

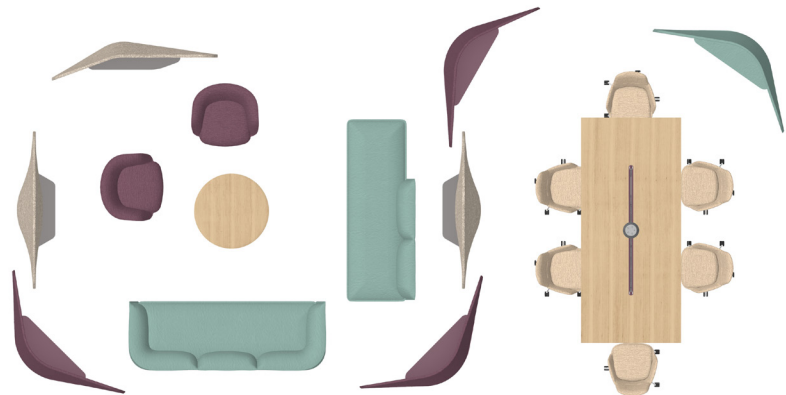

**Divide a conference room and lounge area.**

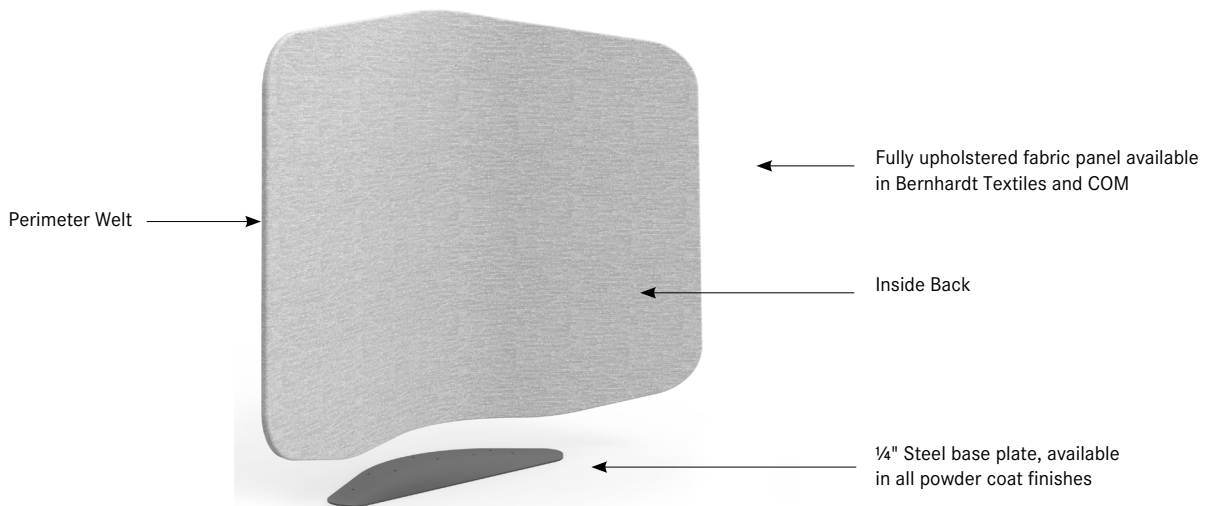

Vendome Privacy Screens

1720 Straight Privacy Screen - 77"w

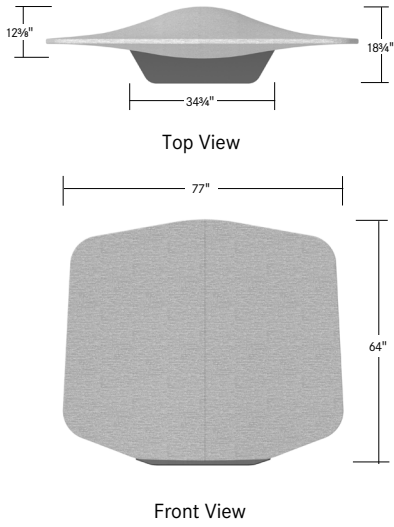

1721 Tall Straight Privacy Screen - 51 1/2"w

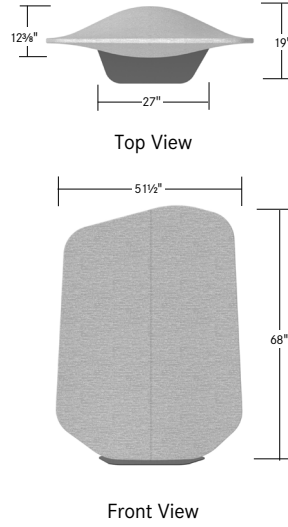

1722 Corner Privacy Screen - 83"w

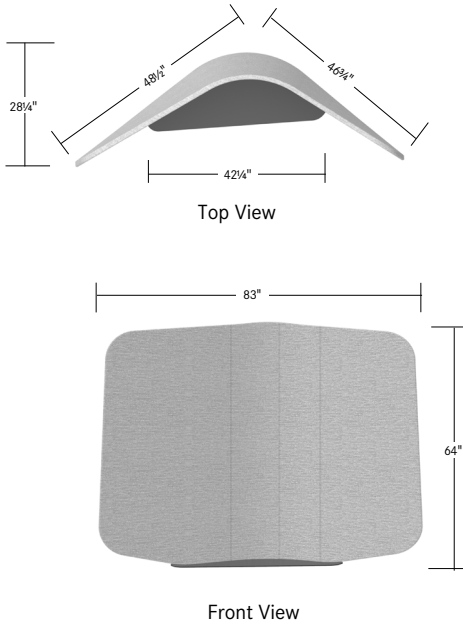

1723 Angled Privacy Screen - 82"w

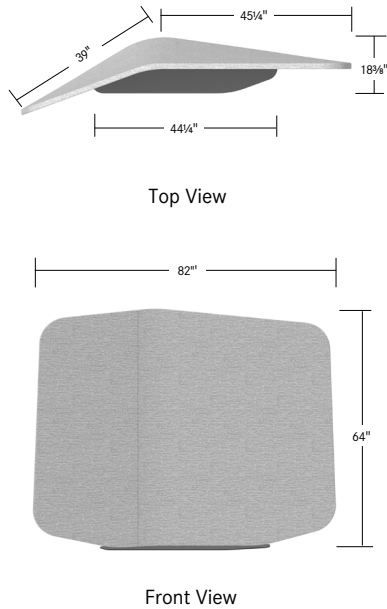

1724 Tall Angled Privacy Screen - 87"w

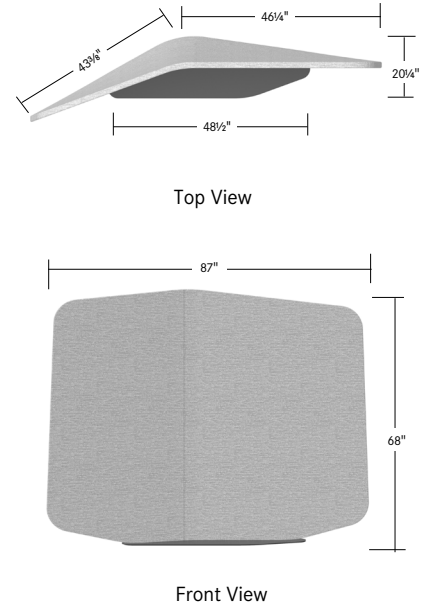

**vendome 1720**



Powder coated metal base. Nylon glides. All **COM** fabric must be preapproved by Bernhardt Design prior to application - see terms and conditions for COM/COL approval procedures. **Fabric will be railroaded for seamless application.** Standard with welt around perimeter of surround. Leather is not approved for use on Vendome.

Shipped assembled and **cannot be laid flat**; verify assembled sku is within size requirements for delivery (elevators, hall intersections, stairwells, etc).

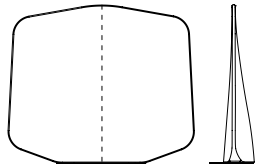

**Straight privacy screen  
Upholstered**

Powder coated metal base  
Nylon glides

When using a combination of fabrics or leathers, specify the application by designating the appropriate letter, shown below, on the purchase order. Yardage shown must be used.

See terms and conditions for contrasting upholstery upcharges.

- A) One fabric for inside back  
yardage: 4.5 yds.
- B) One fabric for outback  
yardage: 4.5 yds.
- C) One fabric for welt  
yardage: 1.0 yds.

SCS Indoor Advantage™ Gold and LEVEL® 1 certified. See terms and conditions for additional environmental information.

| Seat Height | Arm Height | W       | D     | H       | Fabric  | Leather | Weight  | Cubes/Qty |
|-------------|------------|---------|-------|---------|---------|---------|---------|-----------|
| -           | -          | 77"     | 18¾"  | 64"     | 9.3 yds | -       | 142 lbs | -         |
| -           | -          | 1956 mm | 476mm | 1626 mm | 8.5 m   | -       | 64.4 kg | -         |

| COM  | COL | 1    | 2    | 3    | 4    | 5    | 6    | 7    | 8    | 9    | 10   | 11 |
|------|-----|------|------|------|------|------|------|------|------|------|------|----|
| 3893 | -   | 4761 | 4906 | 4989 | 5154 | 5299 | 5361 | 5464 | 5609 | 5733 | 5877 | -  |

**sku**

1 | 7 | 2 | 0 |

**powder coat finish**

|           |                |           |             |
|-----------|----------------|-----------|-------------|
| <b>WH</b> | satin white    | <b>IG</b> | iron grey   |
| <b>AL</b> | matte aluminum | <b>RD</b> | black red   |
| <b>GR</b> | graphite       | <b>BK</b> | matte black |
| <b>BZ</b> | bronze         |           |             |

**vendome 1721**



Powder coated metal base. Nylon glides. All **COM** fabric must be preapproved by Bernhardt Design prior to application - see terms and conditions for COM/COL approval procedures. **Fabric will be railroaded for seamless application.** Standard with welt around perimeter of surround. Leather is not approved for use on Vendome.

Shipped assembled and **cannot be laid flat**; verify assembled sku is within size requirements for delivery (elevators, hall intersections, stairwells, etc).

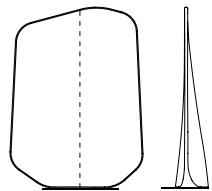

**Tall straight privacy screen  
Upholstered**

Powder coated metal base  
Nylon glides

When using a combination of fabrics or leathers, specify the application by designating the appropriate letter, shown below, on the purchase order. Yardage shown must be used.

See terms and conditions for contrasting upholstery upcharges.

- A) One fabric for inside back  
yardage: 5.25 yds.
- B) One fabric for outback  
yardage: 5.25 yds.
- C) One fabric for welt  
yardage: 1.0 yds.

SCS Indoor Advantage™ Gold and LEVEL® 1 certified. See terms and conditions for additional environmental information.

| Seat Height | Arm Height | W       | D      | H       | Fabric   | Leather | Weight  | Cubes/Qty |
|-------------|------------|---------|--------|---------|----------|---------|---------|-----------|
| -           | -          | 51½"    | 19"    | 68"     | 10.5 yds | -       | 87 lbs  | -         |
| -           | -          | 1308 mm | 483 mm | 1727 mm | 9.6 m    | -       | 39.5 kg | -         |

| COM  | COL | 1    | 2    | 3    | 4    | 5    | 6    | 7    | 8    | 9    | 10   | 11 |
|------|-----|------|------|------|------|------|------|------|------|------|------|----|
| 3477 | -   | 4457 | 4621 | 4714 | 4901 | 5064 | 6134 | 5251 | 5414 | 5554 | 5717 | -  |

**sku**

|   |   |   |   |
|---|---|---|---|
| 1 | 7 | 2 | 1 |
|---|---|---|---|

**powder coat finish**

|           |                |           |             |
|-----------|----------------|-----------|-------------|
| <b>WH</b> | satin white    | <b>IG</b> | iron grey   |
| <b>AL</b> | matte aluminum | <b>RD</b> | black red   |
| <b>GR</b> | graphite       | <b>BK</b> | matte black |
| <b>BZ</b> | bronze         |           |             |

**vendome 1722**

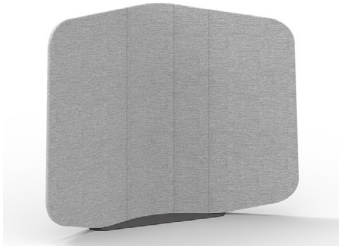

Powder coated metal base. Nylon glides. All **COM** fabric must be preapproved by Bernhardt Design prior to application - see terms and conditions for COM/COL approval procedures. **Fabric will be railroaded for seamless application.** Standard with welt around perimeter of surround. Leather is not approved for use on Vendome.

Shipped assembled and **cannot be laid flat**; verify assembled sku is within size requirements for delivery (elevators, hall intersections, stairwells, etc).

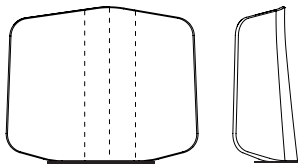

**Corner privacy screen  
Upholstered**

Powder coated metal base  
Nylon glides

When using a combination of fabrics or leathers, specify the application by designating the appropriate letter, shown below, on the purchase order. Yardage shown must be used.

See terms and conditions for contrasting upholstery upcharges.

- A) One fabric for inside back  
yardage: 4.5 yds.
- B) One fabric for outback  
yardage: 4.5 yds.
- C) One fabric for welt  
yardage: 1.0 yds.

SCS Indoor Advantage™ Gold and LEVEL® 1 certified. See terms and conditions for additional environmental information.

| Seat Height | Arm Height | W       | D      | H       | Fabric  | Leather | Weight  | Cubes/Qty |
|-------------|------------|---------|--------|---------|---------|---------|---------|-----------|
| -           | -          | 83"     | 28¼"   | 64"     | 9.4 yds | -       | 143 lbs | -         |
| -           | -          | 2108 mm | 718 mm | 1626 mm | 8.6 m   | -       | 64.9 kg | -         |

| COM  | COL | 1    | 2    | 3    | 4    | 5    | 6    | 7    | 8    | 9    | 10   | 11 |
|------|-----|------|------|------|------|------|------|------|------|------|------|----|
| 4311 | -   | 5189 | 5335 | 5419 | 5586 | 5732 | 5795 | 5899 | 6045 | 6171 | 6317 | -  |

**sku**

|   |   |   |   |  |  |  |  |  |  |  |  |  |
|---|---|---|---|--|--|--|--|--|--|--|--|--|
|   |   |   |   |  |  |  |  |  |  |  |  |  |
| 1 | 7 | 2 | 2 |  |  |  |  |  |  |  |  |  |

**powder coat finish**

|           |                |           |             |  |  |  |  |  |  |  |  |  |
|-----------|----------------|-----------|-------------|--|--|--|--|--|--|--|--|--|
|           |                |           |             |  |  |  |  |  |  |  |  |  |
| <b>WH</b> | satin white    | <b>IG</b> | iron grey   |  |  |  |  |  |  |  |  |  |
| <b>AL</b> | matte aluminum | <b>RD</b> | black red   |  |  |  |  |  |  |  |  |  |
| <b>GR</b> | graphite       | <b>BK</b> | matte black |  |  |  |  |  |  |  |  |  |
| <b>BZ</b> | bronze         |           |             |  |  |  |  |  |  |  |  |  |



**vendome 1723**



Powder coated metal base. Nylon glides. All **COM** fabric must be preapproved by Bernhardt Design prior to application - see terms and conditions for COM/COL approval procedures. **Fabric will be railroaded for seamless application.** Standard with welt around perimeter of surround. Leather is not approved for use on Vendome.

Shipped assembled and **cannot be laid flat**; verify assembled sku is within size requirements for delivery (elevators, hall intersections, stairwells, etc).

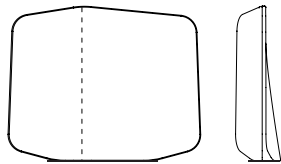

**Angled privacy screen  
Upholstered**

Powder coated metal base  
Nylon glides

When using a combination of fabrics or leathers, specify the application by designating the appropriate letter, shown below, on the purchase order. Yardage shown must be used.

See terms and conditions for contrasting upholstery upcharges.

- A) One fabric for inside back  
yardage: 4.5 yds.
- B) One fabric for outback  
yardage: 5.25 yds.
- C) One fabric for welt  
yardage: 1.0 yds.

SCS Indoor Advantage™ Gold and LEVEL® 1 certified. See terms and conditions for additional environmental information.

| Seat Height | Arm Height | W       | D                  | H       | Fabric  | Leather | Weight  | Cubes/Qty |
|-------------|------------|---------|--------------------|---------|---------|---------|---------|-----------|
| -           | -          | 82"     | 18 $\frac{3}{4}$ " | 64"     | 9.4 yds | -       | 112 lbs | -         |
| -           | -          | 2083 mm | 467 mm             | 1626 mm | 8.6 m   | -       | 50.8 kg | -         |

| COM  | COL | 1    | 2    | 3    | 4    | 5    | 6    | 7    | 8    | 9    | 10   | 11 |
|------|-----|------|------|------|------|------|------|------|------|------|------|----|
| 4172 | -   | 5050 | 5196 | 5280 | 5447 | 5593 | 5656 | 5760 | 5906 | 6032 | 6178 | -  |

**sku**

|   |   |   |   |
|---|---|---|---|
|   |   |   |   |
| 1 | 7 | 2 | 3 |

**powder coat finish**

|           |                |           |             |
|-----------|----------------|-----------|-------------|
|           |                |           |             |
| <b>WH</b> | satin white    | <b>IG</b> | iron grey   |
| <b>AL</b> | matte aluminum | <b>RD</b> | black red   |
| <b>GR</b> | graphite       | <b>BK</b> | matte black |
| <b>BZ</b> | bronze         |           |             |

**vendome 1724**



Powder coated metal base. Nylon glides. All **COM** fabric must be preapproved by Bernhardt Design prior to application - see terms and conditions for COM/COL approval procedures. **Fabric will be railroaded for seamless application.** Standard with welt around perimeter of surround. Leather is not approved for use on Vendome.

Shipped assembled and **cannot be laid flat**; verify assembled sku is within size requirements for delivery (elevators, hall intersections, stairwells, etc).

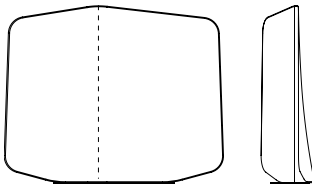

**Tall angled privacy screen  
Upholstered**

Powder coated metal base  
Nylon glides

When using a combination of fabrics or leathers, specify the application by designating the appropriate letter, shown below, on the purchase order. Yardage shown must be used.

See terms and conditions for contrasting upholstery upcharges.

- A) One fabric for inside back  
yardage: 5.75 yds.
- B) One fabric for outback  
yardage: 5.75 yds.
- C) One fabric for welt  
yardage: 1.0 yds.

SCS Indoor Advantage™ Gold and LEVEL® 1 certified. See terms and conditions for additional environmental information.

| Seat Height | Arm Height | W       | D      | H       | Fabric   | Leather | Weight  | Cubes/Qty |
|-------------|------------|---------|--------|---------|----------|---------|---------|-----------|
| -           | -          | 87"     | 20¼"   | 68"     | 11.9 yds | -       | 122 lbs | -         |
| -           | -          | 2210 mm | 514 mm | 1727 mm | 10.9 m   | -       | 55.3 kg | -         |

| COM  | COL | 1    | 2    | 3    | 4    | 5    | 6    | 7    | 8    | 9    | 10   | 11 |
|------|-----|------|------|------|------|------|------|------|------|------|------|----|
| 4588 | -   | 5699 | 5884 | 5990 | 6202 | 6387 | 6466 | 6598 | 6783 | 6942 | 7127 | -  |

**sku**

|   |   |   |   |  |
|---|---|---|---|--|
|   |   |   |   |  |
| 1 | 7 | 2 | 4 |  |

**powder coat finish**

|           |                |           |             |           |           |
|-----------|----------------|-----------|-------------|-----------|-----------|
|           |                |           |             |           |           |
| <b>WH</b> | satin white    | <b>IG</b> | iron grey   | <b>RD</b> | black red |
| <b>AL</b> | matte aluminum | <b>BK</b> | matte black |           |           |
| <b>GR</b> | graphite       |           |             |           |           |
| <b>BZ</b> | bronze         |           |             |           |           |

**Preapproval Procedure for Fabric**

**Customer's Own Material (COM)**

Due to aesthetic reasons or application restraints, Bernhardt Design must preapprove COM fabrics for application on the Bernhardt Design. **All COM fabrics must pass ASTM-E84 with documentation in order to be applied to Vendome screens.**

**PREAPPROVAL PROCEDURE**

**Please submit a 12" X 12" sample for testing prior to the actual shipment of COM to Bernhardt Design.**

**SHIPPING ADDRESS FOR SAMPLES:**

**Bernhardt Design  
1839 Morganton Blvd. SW  
Lenoir, NC 28645  
Attn: Customer Service**

**Along with the COM sample, the product number, quantity of products, and contact information must be specified.**

Bernhardt Design reserves the right to reject any covering which in our opinion is unsuitable for upholstery purposes. However, Bernhardt Design shall in no instance be held responsible for tailoring variances that result from the application of a particular textile or leather to a specific frame.

**COM Yardage Specifications**

All yardage requirements shown in the price list are based on 54" plain material. Fabrics with a vertical repeat that must be matched, or that are less than 54" wide, require more yardage. The chart below should be used for determining additional COM yardage requirements.

Please add the indicated percentage to the yardage shown beside the style number in the price list. This guide will accurately cover most COM orders, but there will be instances due to unusual repeats or designs that additional yardages may be required. Bernhardt Design will not be held responsible for the purchase of any additional COM that may be required.

When ordering multi-item modular configurations, the total COM yardage must be provided from the same dye lot in a continuous roll(s).

**All COM's will be cut and applied at the discretion of Bernhardt Design unless special cutting instructions are included in writing with the purchase order.**

**Bernhardt Design will not be held responsible for defective fabrics, as all COM's are accepted as first quality goods.**

**Fabric Yardage Vertical Repeat**

| <b>Fabric Width</b> | <b>Plain Fabric</b> | <b>2"-10" Repeat</b> | <b>11"-20" Repeat</b> | <b>21"-25" Repeat</b> | <b>26"-30" Repeat</b> |
|---------------------|---------------------|----------------------|-----------------------|-----------------------|-----------------------|
| 54"                 | 0%                  | 10%                  | 15%                   | 20%                   | 25%                   |
| 51-53"              | 15%                 | 20%                  | 25%                   | 30%                   | 35%                   |
| 48-50"              | 30%                 | 35%                  | 40%                   | 45%                   | 50%                   |
| 45-47"              | 45%                 | 50%                  | 55%                   | 60%                   | 65%                   |
| 36-44"              | 60%                 | 65%                  | 70%                   | 75%                   | 80%                   |

### Prices and Specifications

Prices and specifications are subject to change without notice. All prices quoted will be FOB our factories. If applicable, sales tax will be based on ship-to destination. Bernhardt Design reserves the right to make changes in dimensions, construction, price lists, or product literature without prior notice.

### Order Entry

All orders are subject to final acceptance by Bernhardt Design in Lenoir, NC. Receipt of our acknowledgment indicates acceptance of your order subject to the terms set forth on the acknowledgment. Bernhardt Design attempts to clarify all purchase orders. However, in the event the price list number and description on the purchase order differ, the price list number will prevail.

### Changes/Cancellation

All orders in production are considered firm orders and are not subject to changes or cancellation.

### Custom Design

Bernhardt Design may alter products to meet specific needs. Contact your local sales representative when a custom design is needed. Custom designs, **if approved**, require minimum quantities, additional leadtime and upcharges.

A custom job number, available from your local sales representative, must be submitted with purchase orders. Orders combining custom design with standard product cannot be scheduled for production until custom items are approved. Custom design orders are not subject to revision or cancellation after acknowledgment.

### Shipping

Bernhardt Design will ship in accordance with customer instructions whenever possible. If not specified, Bernhardt Design will exercise its best judgment in selecting a carrier. When selecting a carrier, Bernhardt Design will make our best effort to meet requested delivery dates.

Transportation lead-times and delays including equipment problems, weather, general traffic, traffic accidents, customer warehouse space, labor disputes, customer changes etc., that occur on a carrier will not be the responsibility of Bernhardt Design. Furthermore, Bernhardt Design will not be responsible for additional costs incurred due to aforementioned delays.

Customer orders in production will be shipped as scheduled and will not be held. Bernhardt Design reserves the right to make partial shipments on any order, unless notified otherwise by the customer.

High quality cartoning meeting trucking and railroad specifications is standard at no extra charge. Some items may be blanket wrapped for shipment.

### Freight Damage and Claims

Bernhardt Design is not liable for damages that occur during transit or storage. The carrier assumes all responsibility upon acceptance of product. It is the customer's responsibility to inspect all products upon receipt and file any claims with the carrier. No product should be refused. If products are received damaged, a written exception should be made on the bill of lading and an immediate inspection be requested of the carrier.

Concealed damage must be reported to the carrier within 10 business days from date of delivery. Failure to make claims shall constitute acceptance of the products and waiver any claims of defects, errors or shortages.

In the event delivery is made on a Bernhardt Design truck, the products should be carefully inspected for transit damage. If contents are damaged, the driver should be notified to call his dispatcher for immediate disposition. Concealed damage must be reported within 10 business days from date of delivery and product/packaging held for inspection by a Bernhardt Design representative.

Replacements for product damaged in shipment or storage will be manufactured upon receipt of a purchase order.

### Returns

No merchandise may be returned to Bernhardt Design without written consent in the form of a Return Authorization from our Quality Assurance Department stating why the item is being returned and how the item will be shipped.

Unauthorized returns will be automatically refused by our receiving department as well as returns not in accordance with Bernhardt Design shipping instructions. Liability for defective merchandise shall be limited to the replacement or repair of that merchandise, and Bernhardt Design shall not be liable for other damages or losses.

### Measurements and Weights

All measurements and weights are approximate and subject to change without notice.

### Care and Cleaning

Finished wood surfaces should be cleaned with a soft damp cloth, wiping in the direction of the grain. Furniture should be buffed dry immediately with a soft cloth.

### Wood Finishes

Bernhardt Design tables are available in finishes that are compatible with credenzas and seating finishes. However, finishes on tables may vary slightly from those on seating due to the natural characteristics of the wood. No absolute match is implied or guaranteed.

### Light Finishes

Bernhardt Design offers lighter finishes on certain veneers. When specifying light finishes the natural characteristics of the wood will be visible and color will vary.

Natural characteristics include the natural discolorations of the wood substance and color variations in glued up stock. These natural characteristics are not considered defects by Bernhardt Design, and therefore merchandise will not be replaced.

### Special Finishes

Special finishes, made to customer specifications and subject to factory approval, may be available at a **10% net upcharge with a \$500 net minimum**.

Additional leadtime may be required for special finish items. Special finish orders will not be acknowledged until the special finish sample is approved in writing and received by Bernhardt Design Customer Service. Special finish orders are not subject to revision or cancellation after acknowledgment.

#### **Installation and Maintenance**

All freestanding tables and credenzas are equipped with leveling devices. Local floor conditions vary, and it is always necessary to properly adjust leveling devices. Proper leveling is essential to the alignment and function of doors and drawers. Improperly leveled units result in misaligned doors and drawers and may impair locking mechanisms or other functional hardware.

After the initial installation of credenzas, it may be necessary to readjust and align the units to compensate for settling. This should be expected as a matter of routine maintenance and follow-up to assure proper case function.

Proper installation of Bernhardt Design tables and credenzas is the responsibility of the dealer. Improperly installed units can result in permanent damage to case components. Damage due to improperly installed furniture not covered under product warranty.

#### **Warranty**

Bernhardt Design will repair or replace, at its discretion, any product or part thereof which fails as the result of defects in material and workmanship, under single shift use and normal care for five years. This warranty shall apply only to the original purchaser. This warranty does not cover normal wear and tear, misuse or abuse of product, dramatic temperature changes, exposure to unusual conditions or damages incurred by contact with seating products, tables, desks or other surfaces.

Natural color changes, variations or movements in lumber or veneer products, exposure to extreme temperature changes and direct sunlight may cause color changes and/or surface damage. These are circumstances beyond the control of Bernhardt Design and are not warranty issues. Repair or replacement of discontinued product will be at the discretion of Bernhardt Design.

This warranty is the customer's exclusive remedy for product defect and does not apply to damage caused by a freight carrier, dealer, installer, user modification, attachments to a product, or any third party. Bernhardt Design has the exclusive right to make the final determination of product misuse or abuse.

Except as stated above, Bernhardt Design makes no express or implied warranties as to any product, and in particular, makes no warranty of merchant

ability or of fitness for any particular purpose. Bernhardt Design shall not be liable for any consequential or incidental damages or for commercial loss arising from any product defect.

#### **Operational Parts Warranty**

Drawer glides, drawer boxes, drawer pulls, and lock mechanisms have a Life-Time Warranty for original purchaser. Power and communication components are warranted for one year.

#### **Design and Patent Rights**

All of the products shown in Bernhardt Design catalogs and described in Bernhardt Design price lists are, and remain, the property of Bernhardt Design, with the sole right reserved to manufacture and to distribute.

Some of the product designs shown are patented in the United States and will remain the property of Bernhardt Design. Any reproduction of the products constitutes an infringement of patented copyright laws and will be subject to prosecution.

Bernhardt Design reserves the right to make changes in dimensions, design and/or construction, price lists, or product literature without prior notice.

#### **Environmental**

Vendome is SCS Indoor Advantage™ Gold certified. Visit the product page at [Bernhardtdesign.com](http://Bernhardtdesign.com) for certifications. For complete information regarding the SCS Indoor Advantage™ Gold certifications, please contact [bgreen@bernhardt.com](mailto:bgreen@bernhardt.com).

**Preferred Carrier Guaranteed Freight Rates**

Freight charges will be applied to orders as a separate line item based on the zones listed. Rates are based on zones with a minimum for each zone. All zones are located within the Continental United States.

The freight amount is calculated on the total merchandise list COM price. Additional freight fuel surcharges may apply. Rates are based on deliveries made Monday through Friday, 8 am until 5 pm.

All orders are shipped by Bernhardt Design company trucks or preferred carriers specified by Bernhardt Design. **If a purchase order does not specify that the product must ship complete, Bernhardt Design reserves the right to select the most effective shipping method necessary, including split shipments.** Dealer warehouse information, including phone number and contact name, must be specified on the purchase order.

Direct site deliveries may be requested with an additional freight cost. Requests for direct site deliveries must be made 2 weeks prior to the scheduled ship week and meet the following criteria:

- Minimum of half truckload
- Delivery site accessible by a 53' trailer
- Complete delivery site address with contact name and on-site phone number
- Labor available for unloading

Deliveries that do not meet the criteria must be directed to a receiver warehouse. If a receiver warehouse is not available, the dealer may make arrangements with their own 3rd party carrier. If a 3rd party carrier is elected, a contact name, phone number and e-mail address is required.

Bernhardt Design has a no touch freight policy. Drivers are not allowed to unload freight.

Weekend direct site deliveries will incur a \$500 per trailer weekend delivery fee. Weekend is defined as between 5 pm Friday and 8 am Monday.

Customers who decline GFP should refer to the shipping section of the Terms and Conditions page.

| Zone   | Percent | Minimum |
|--------|---------|---------|
| Zone 1 | 3%      | \$150   |
| Zone 2 | 4%      | \$150   |
| Zone 3 | 5%      | \$150   |
| Zone 4 | 5.5%    | \$150   |
| Zone 5 | 6%      | \$150   |

Percent bases on List Price.

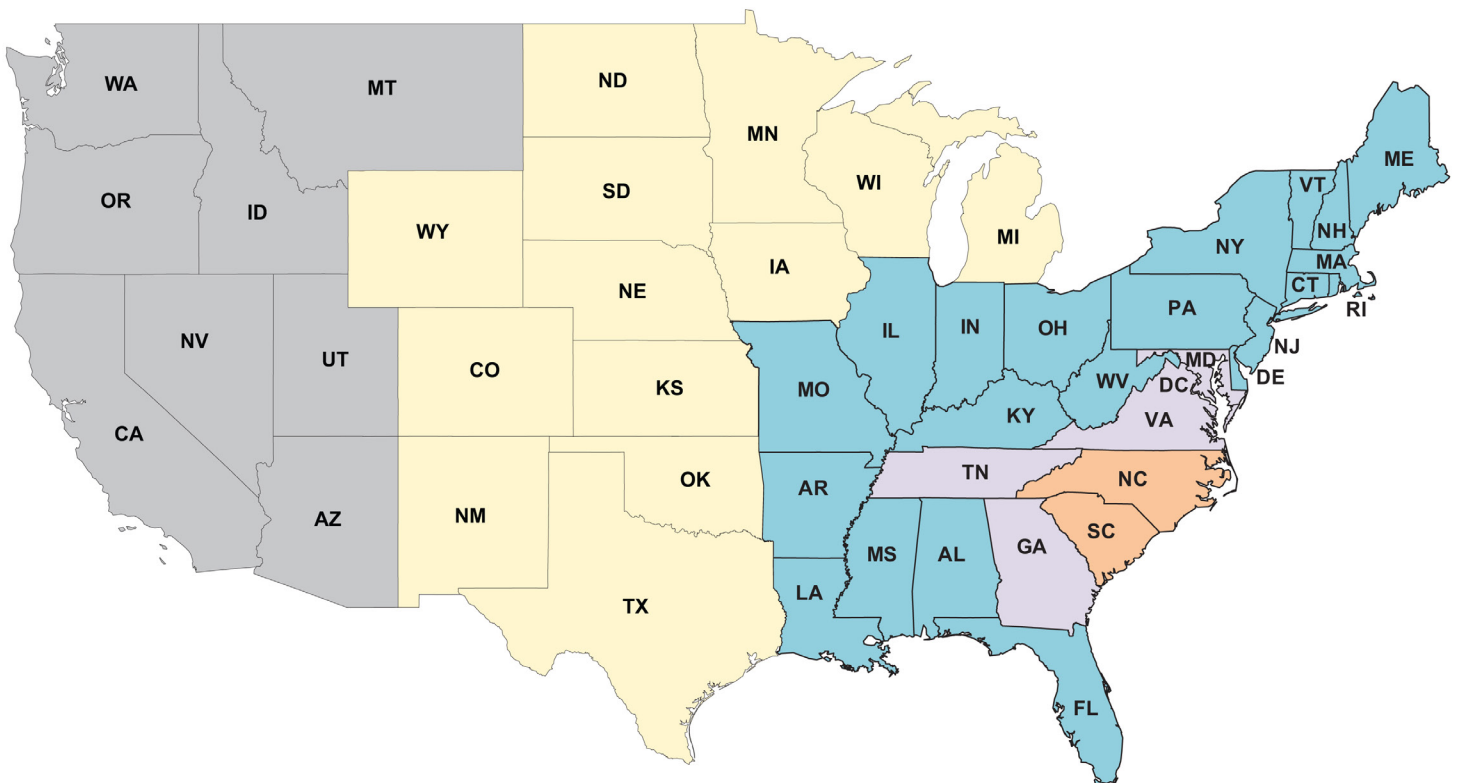

## Preferred Carrier Guaranteed Freight Rates - Canada

Freight charges will be applied to orders as a separate line item based on the zones listed. Rates are based on zones with a minimum for each zone.

The freight amount is calculated on the total merchandise list COM price. Additional freight fuel surcharges may apply. Rates are based on deliveries made Monday through Friday, 8 am until 5 pm.

All orders are shipped by Bernhardt Design company trucks or preferred carriers specified by Bernhardt Design. If a purchase order does not specify that the product must ship complete, Bernhardt Design reserves the right to select the most effective shipping method necessary, including split shipments. Dealer warehouse information, including phone number and contact name, must be specified on the purchase order.

Direct site deliveries may be requested with an additional freight cost. Requests for direct site deliveries must be made 2 weeks prior to the scheduled ship week and meet the following criteria:

- Minimum of half truckload
- Delivery site accessible by a 53' trailer
- Complete delivery site address with contact name and on-site phone number
- Labor available for unloading

Deliveries that do not meet the criteria must be directed to a receiver warehouse. If a receiver warehouse is not available, the dealer may make arrangements with their own 3rd party carrier. If a 3rd party carrier is elected, a contact name, phone number and e-mail address is required.

Bernhardt Design has a no touch freight policy. Drivers are not allowed to unload freight.

Weekend direct site deliveries will incur a \$500 per trailer weekend delivery fee. Weekend is defined as between 5 pm Friday and 8 am Monday.

Customers who decline GFP should refer to the shipping section of the Terms and Conditions page.

| Zone   | Minimums | Freight | Avg. Bus. Days |
|--------|----------|---------|----------------|
| Zone 1 | \$200    | 5%      | 10-15          |
| Zone 2 | \$200    | 9%      | 10-15          |
| Zone 3 | \$200    | 8%      | 10-15          |
| Zone 4 | \$200    | 11%     | 10-15          |
| Zone 5 | Quote    | Quote   |                |

The attached rates are strictly freight and do not include brokerage fees.

