

# LIVE Locks/ Technical Specifications

## SPECIFICATIONS

LIVE Slider Lock Body (LL101-B/W):

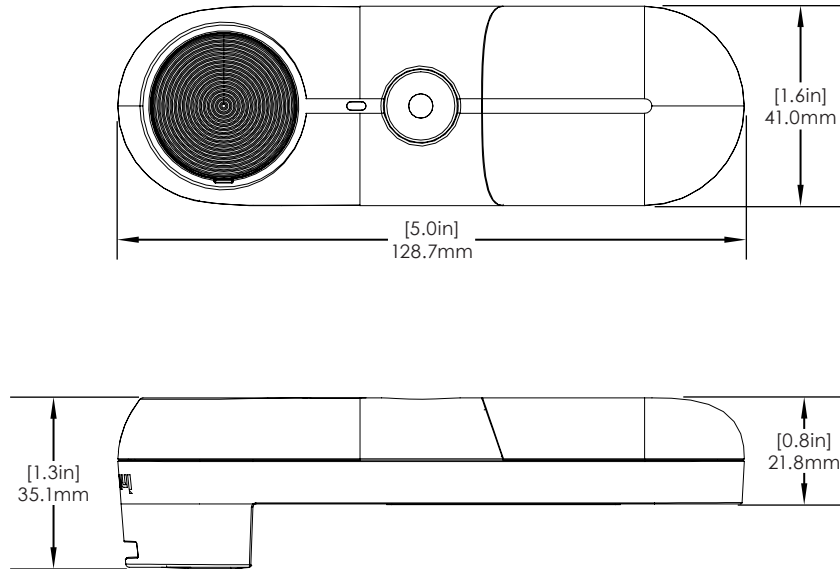

## SPECIFICATIONS

LIVE Plunger Lock Body (LL201-B/W):

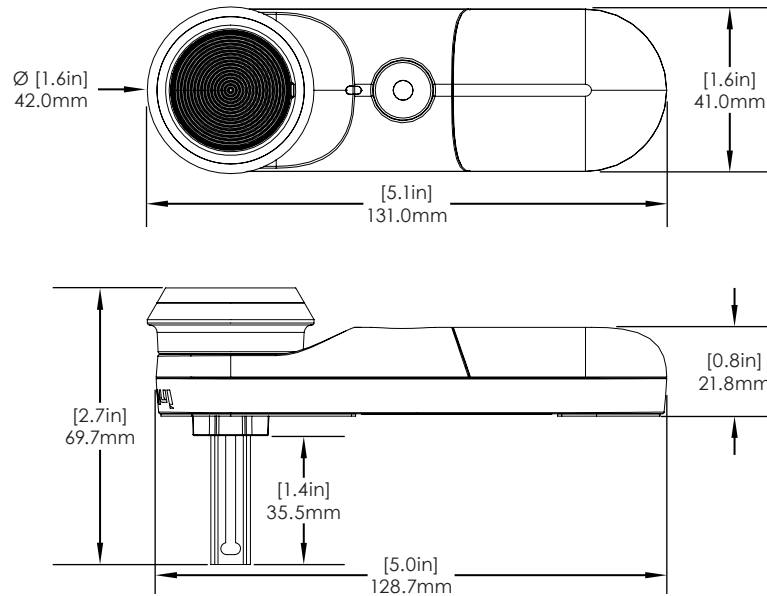

# LIVE Locks/ Technical Specifications

## SPECIFICATIONS

LIVE Plunger Lock Body - Long Pin (LL202-B/W):

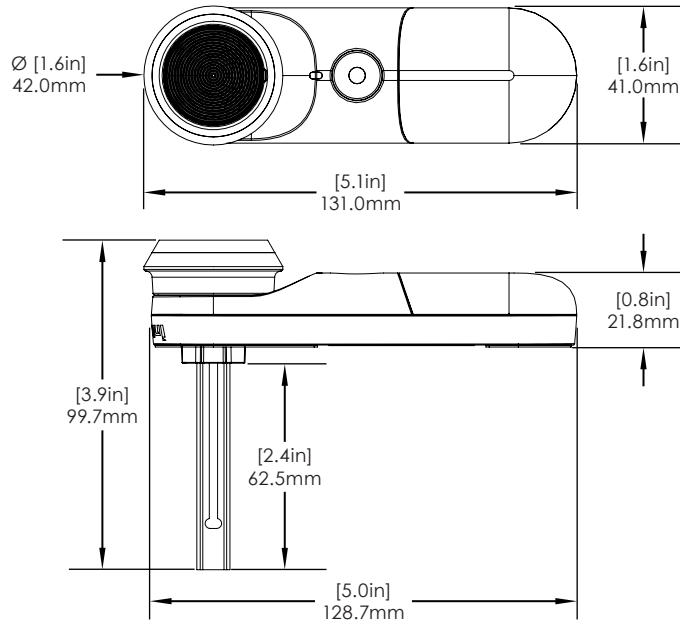

## SPECIFICATIONS

LIVE Cam Lock Body (LL301-B/W):

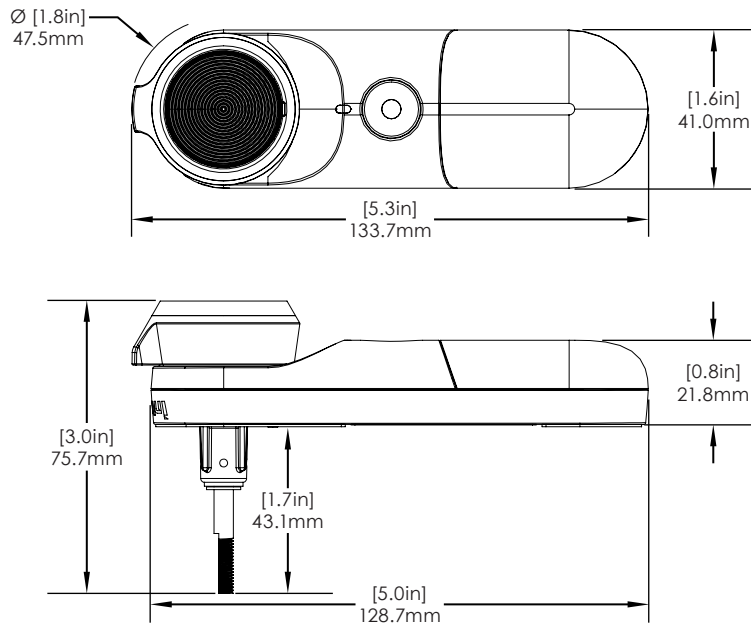

# LIVE Locks/ Technical Specifications

## SPECIFICATIONS

LIVE Cam Lock Body - Long Pin (LL302-B/W):

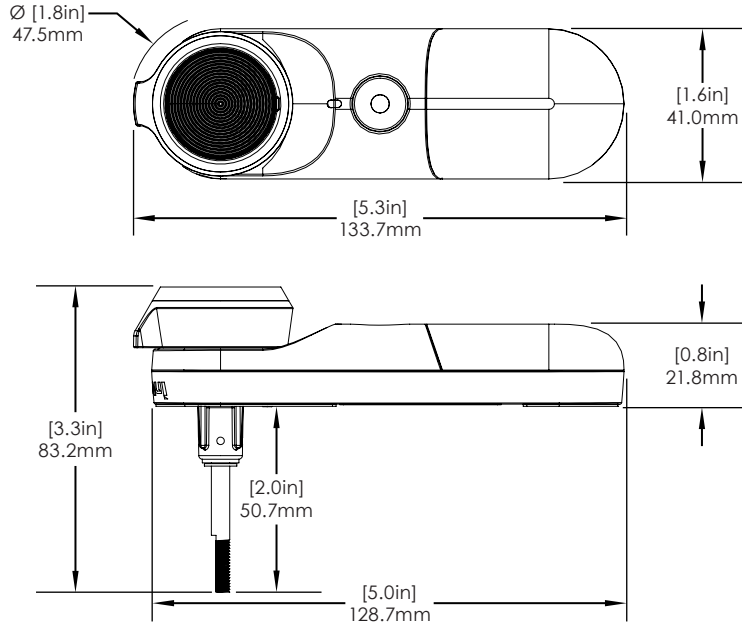

## SPECIFICATIONS

LIVE U-Lock Body (LL401-B/W):

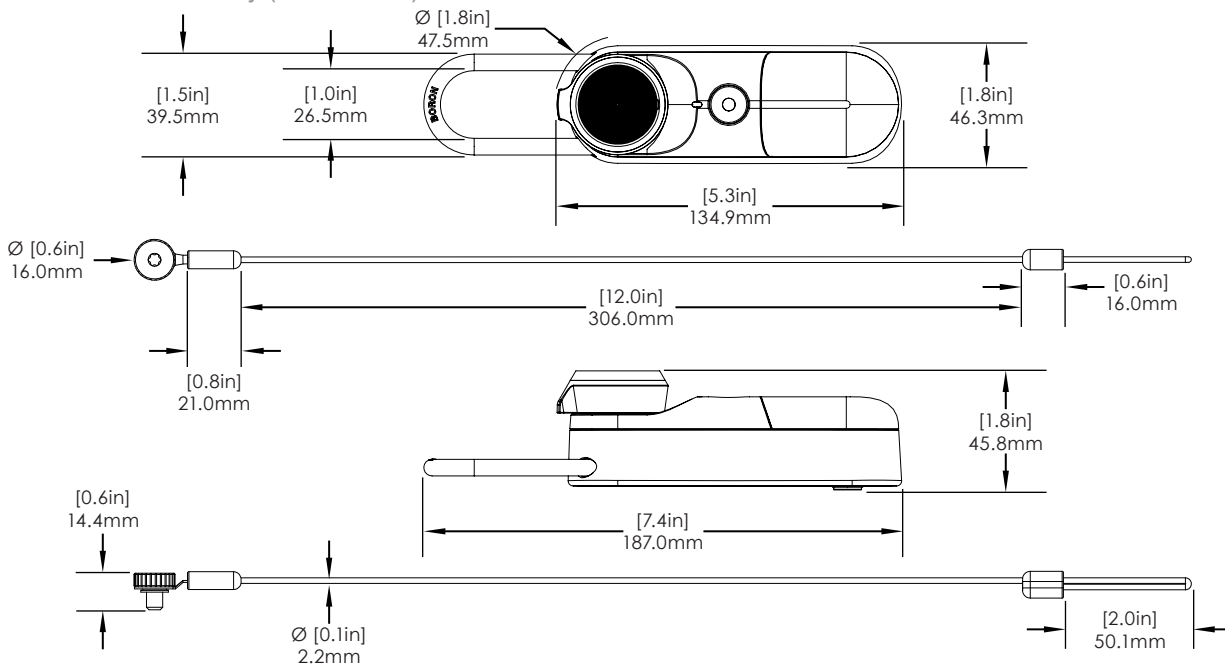

# LIVE Locks/ Technical Specifications

## SPECIFICATIONS

Slider Lock - Short Strike Plate (LL110):

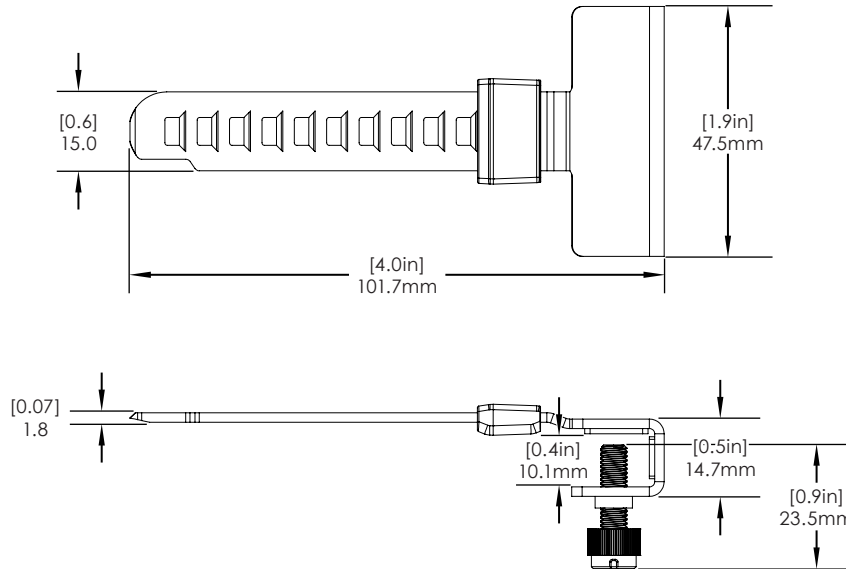

## SPECIFICATIONS

Slider Lock - Long Strike Plate (LL111):

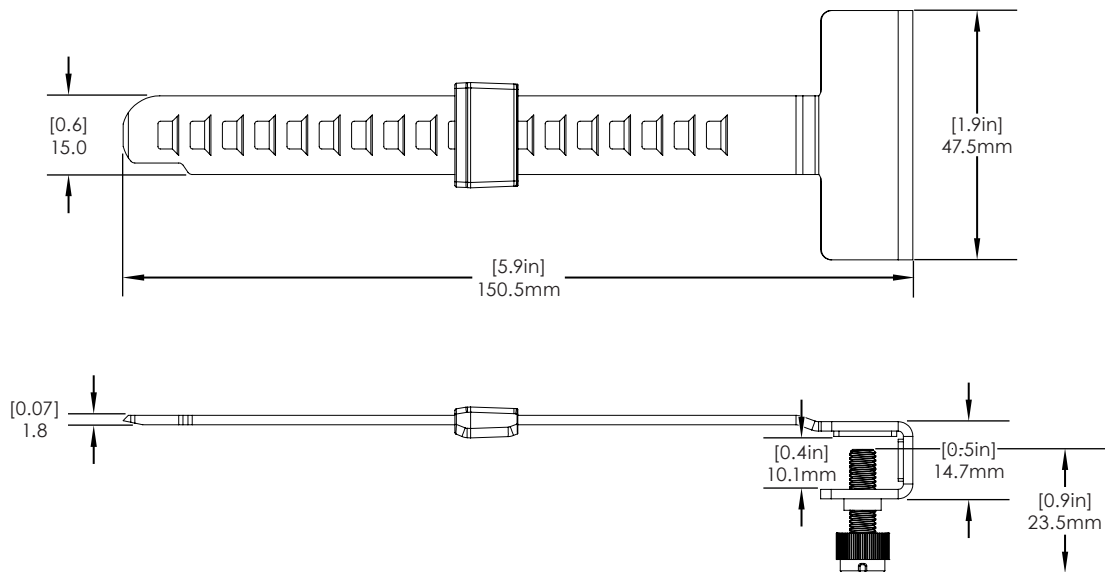

# LIVE Locks/ Technical Specifications

## SPECIFICATIONS

Plunger Lock - 22-35mm Diameter Hole Kit (LL220)

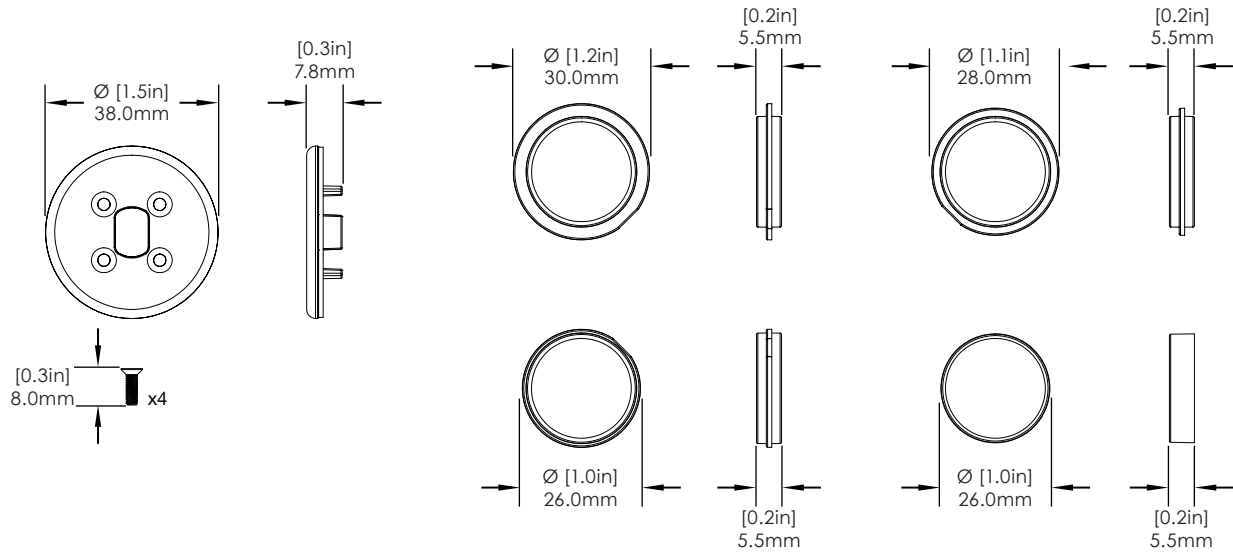

## SPECIFICATIONS

Plunger Lock - Oval Recess Kit (LL221)

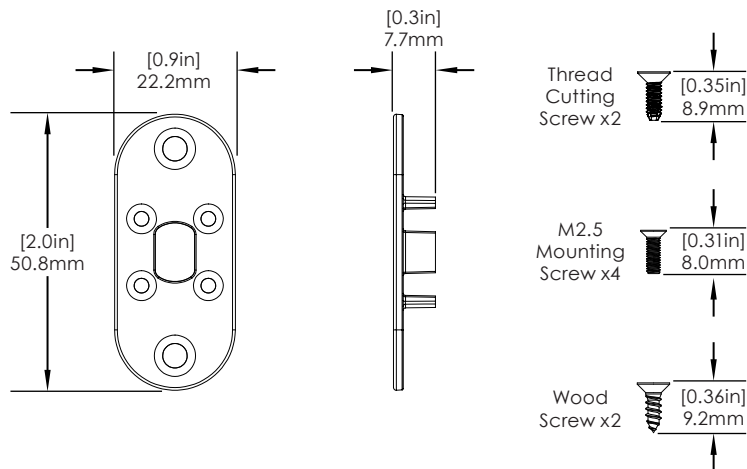

# LIVE Locks/ Technical Specifications

## SPECIFICATIONS

Plunger Lock - 13-16mm Panel Adapter Kit (LL222)

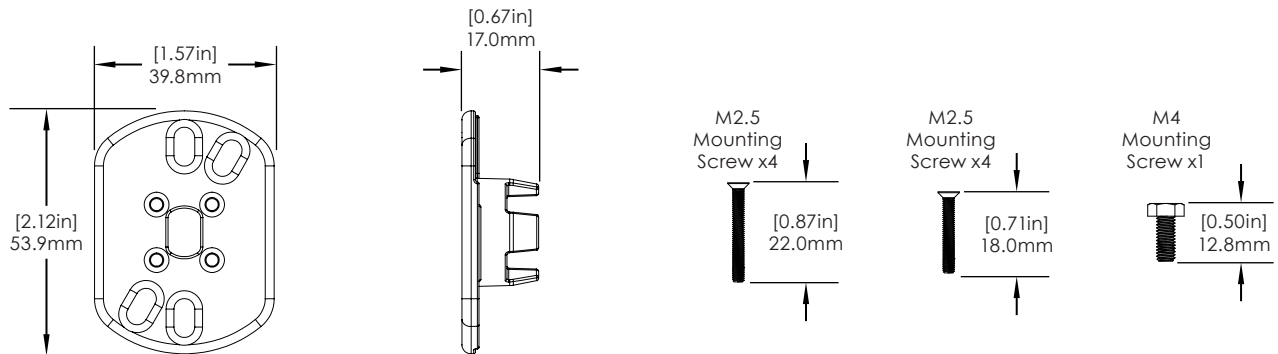

## SPECIFICATIONS

Plunger Lock - 16-20mm Panel Adapter Kit (LL223)

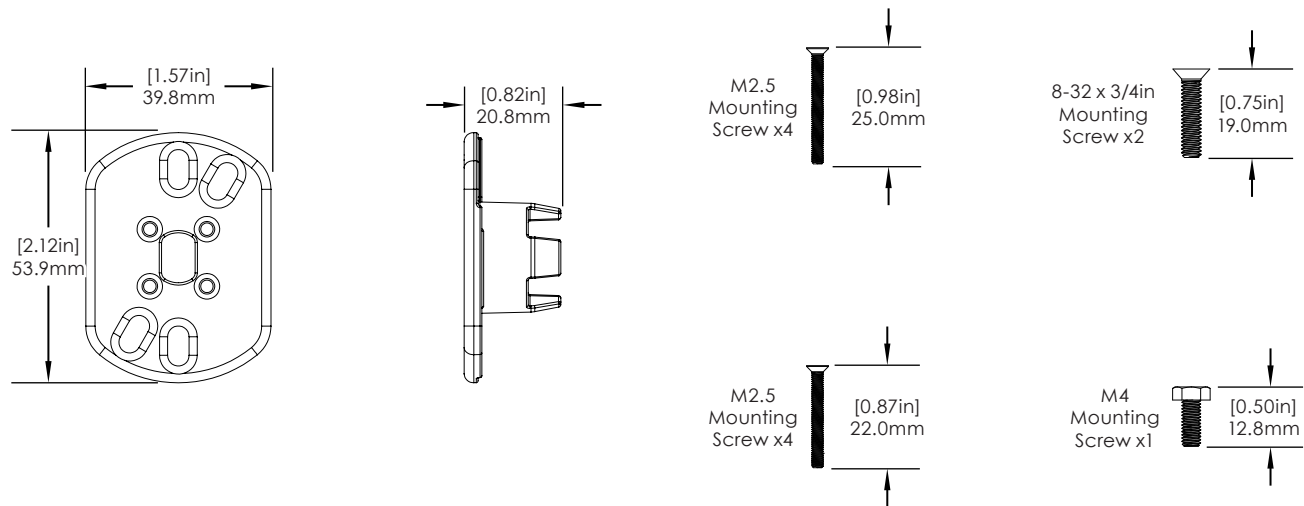

# LIVE Locks/ Technical Specifications

## SPECIFICATIONS

Cam Lock 19mm Diameter, 16mm Flat Width Kit (LL320):

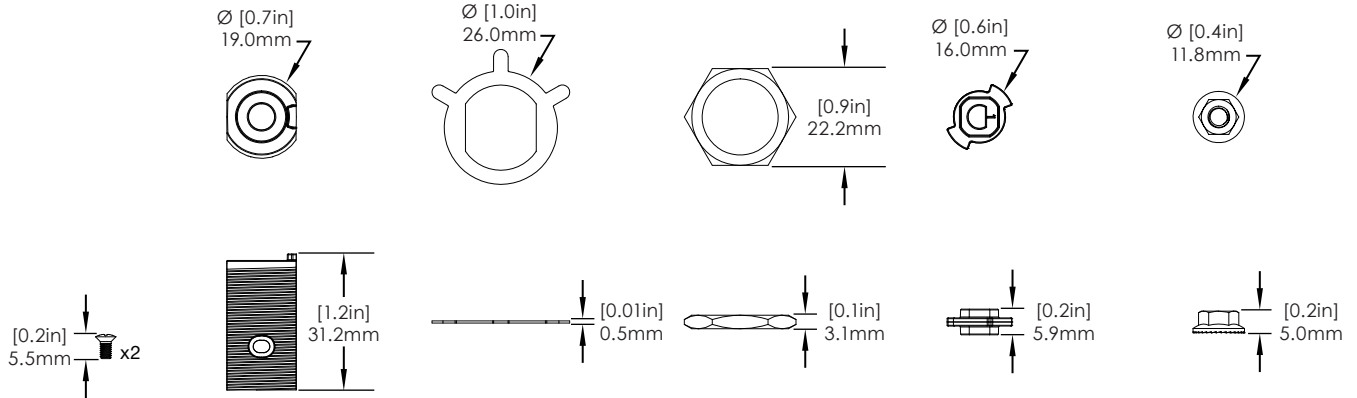

## SPECIFICATIONS

Cam Lock 22mm Diameter, 18.5mm Flat Width Kit (LL321):

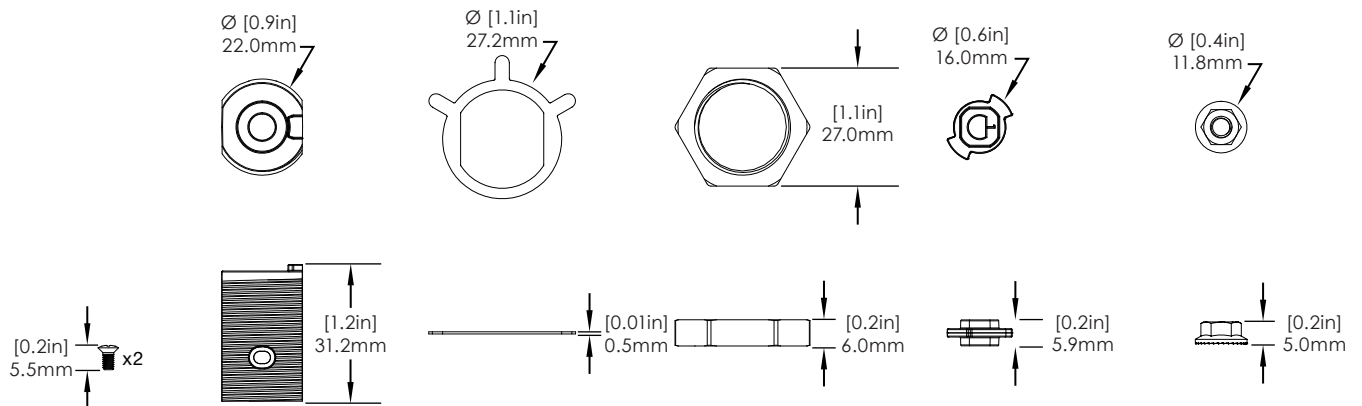

# LIVE Locks/ Technical Specifications

## SPECIFICATIONS

Cam Lock 22mm Diameter, 18.5mm Flat Width Kit (LL323):

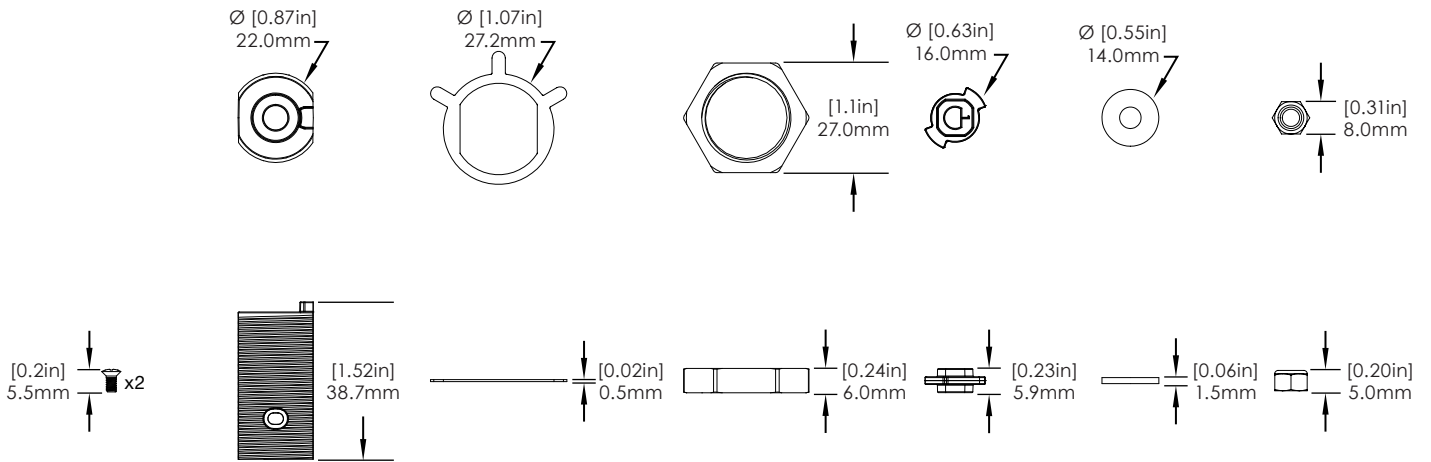

## SPECIFICATIONS

Cam Lock InVue Cam Arm Adapters - Pack of 10 (LL340):

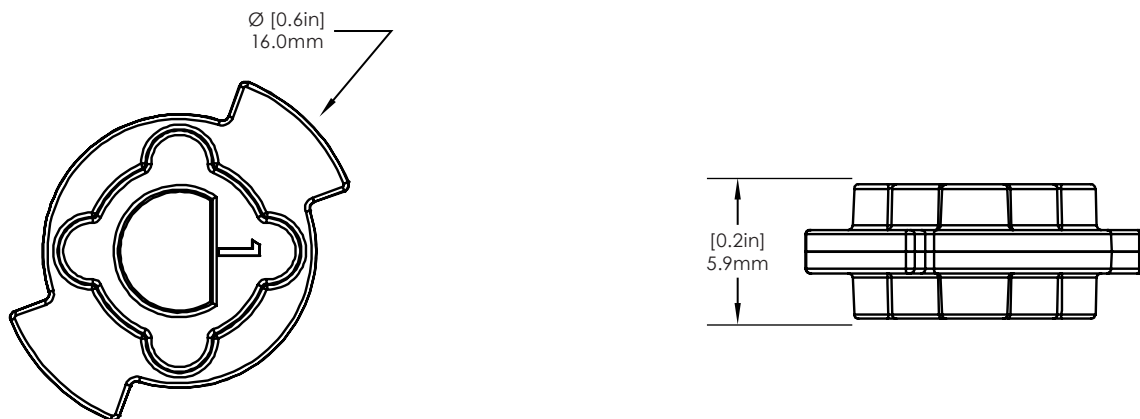



# LIVE Locks/ Technical Specifications

## SPECIFICATIONS

Cam Lock Door Adaptor Kit - Pack of 2 (LL341):

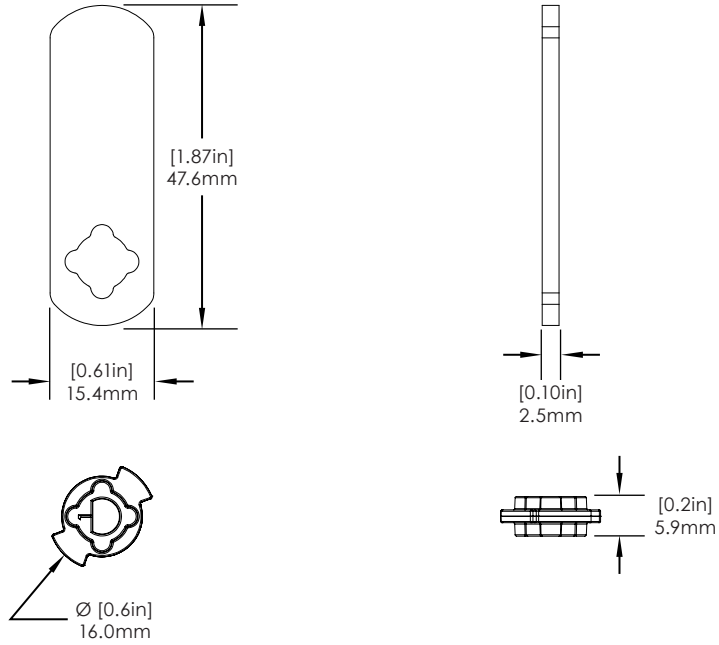

## SPECIFICATIONS

Slider Lock Replacement Adhesive - Pack of 10 (LL140):

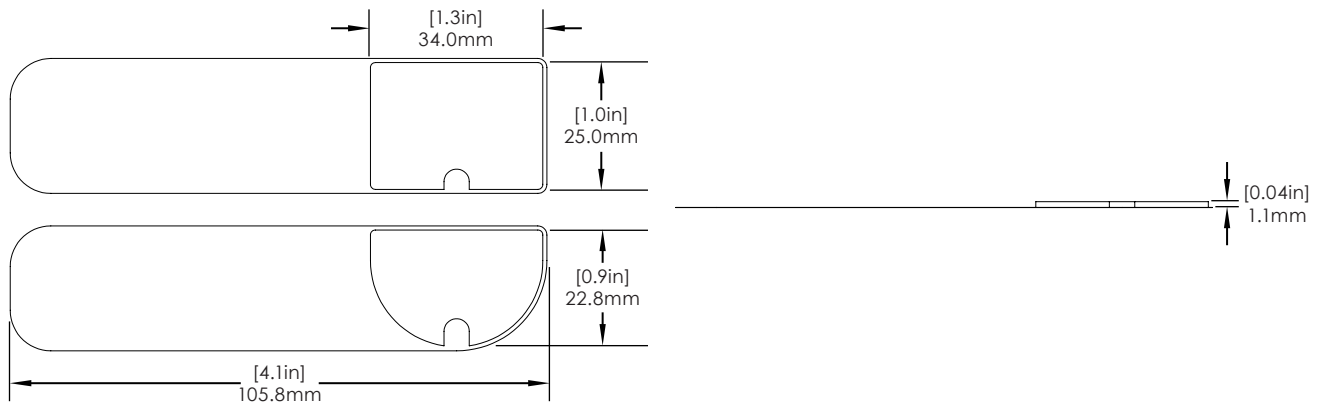

# LIVE Locks/ Technical Specifications

## SPECIFICATIONS

Slider Lock Strike Plate Replacement Adhesive - Pack of 10 (LL141):

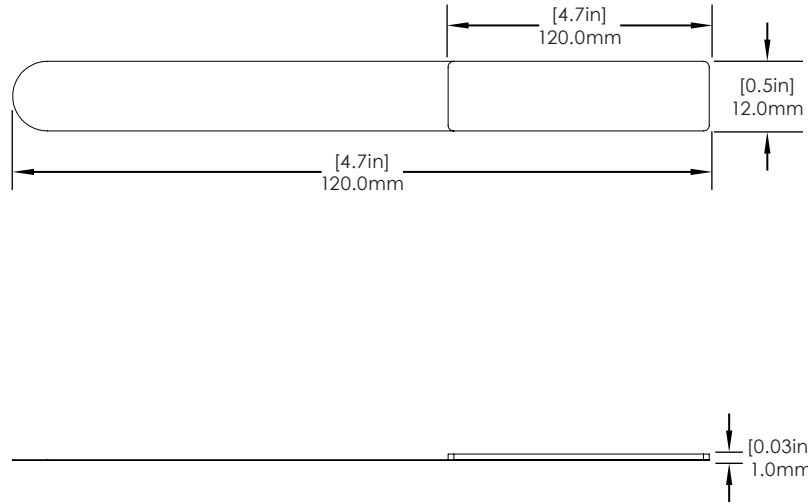

## SPECIFICATIONS

Plunger & Cam Lock Replacement Adhesive - Pack of 10 (LL901):

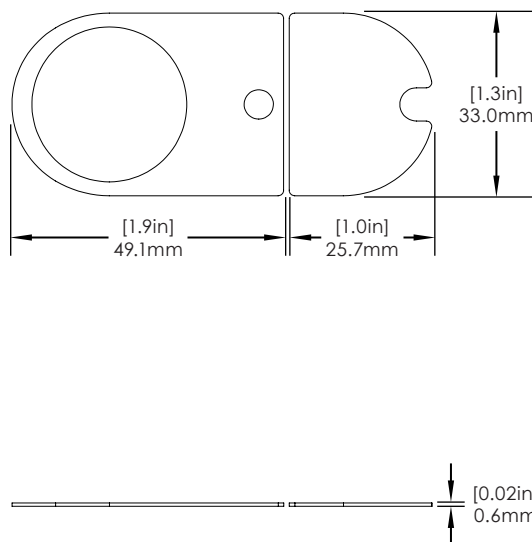

# LIVE Locks/ Technical Specifications

## SPECIFICATIONS

LIVE Locks 7mm Riser (LL902):

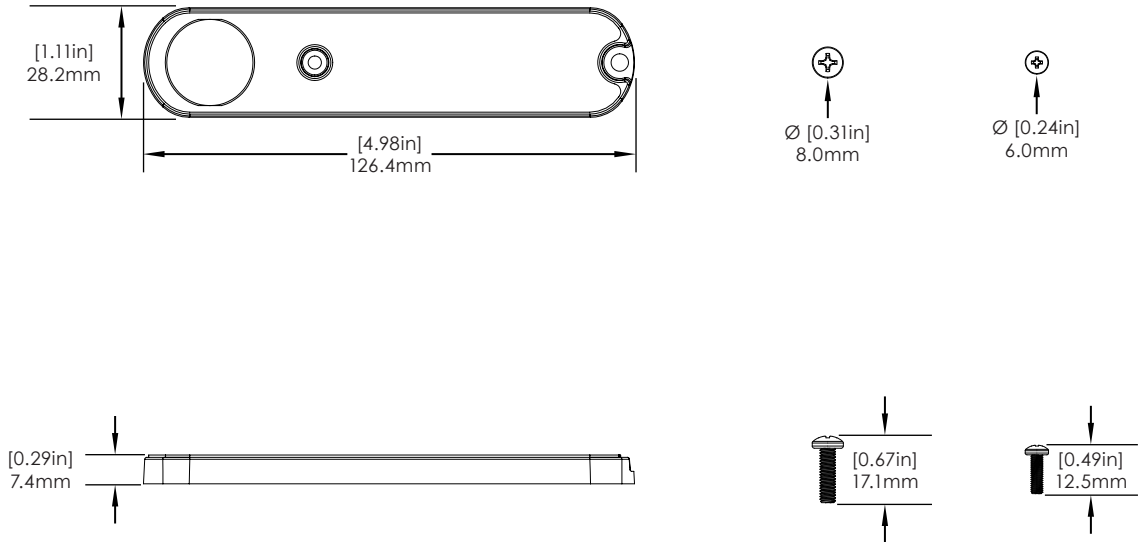

## SPECIFICATIONS

LIVE Locks 3mm Riser (LL903):

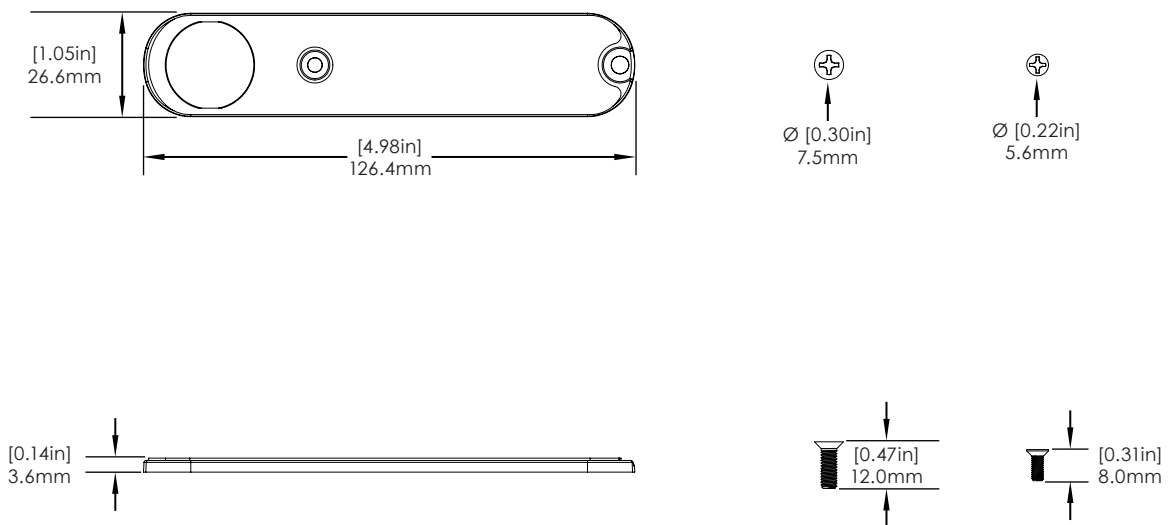

# LIVE Locks/ Technical Specifications

## SPECIFICATIONS

LIVE Lock Replacement Caps - Pack of 20 (LL904):

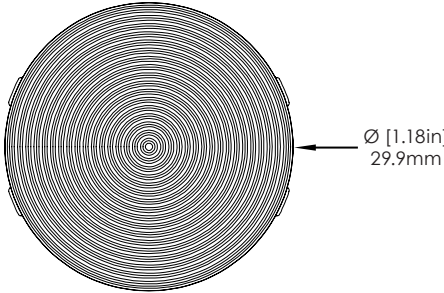

## SPECIFICATIONS

Magnet Key - Pack of 4 (DBG400):

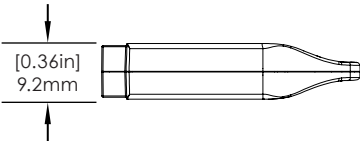
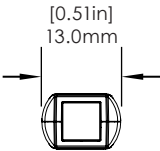
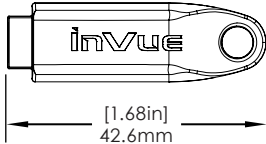

## LIVE Locks/ Technical Specifications

### LIVE LOCK BODIES

ORDER CODE	DESCRIPTION
LL101-B/W	LIVE Slider Lock Body
LL201-B/W	LIVE Plunger Lock Body
LL202-B/W	LIVE Plunger Lock Body - Long Pin
LL301-B/W	LIVE Cam Lock Body
LL302-B/W	LIVE Cam Lock Body - Long Pin
LL401-B/W	LIVE U-Lock Body

### LIVE LOCK ACCESSORIES

ORDER CODE	DESCRIPTION
LL110	LIVE Slider Lock - Short Strike Plate
LL111	LIVE Slider Lock - Long Strike Plate
LL220	LIVE Plunger Lock - 22-35mm Diameter Hole Kit
LL221	LIVE Plunger Lock - Oval Recess Kit
LL222	LIVE Plunger Lock 13-16mm Panel Adapter Kit
LL223	LIVE Plunger Lock 16-20mm Panel Adapter Kit
LL320	LIVE Cam Lock 19mm Diameter, 16mm Flat Width Kit
LL321	LIVE Cam Lock 22mm Diameter, 18.5mm Flat Width Kit
LL323	LIVE Cam Lock 22mm Diameter, 18.5mm Flat Width Kit
LL340	LIVE Cam Lock InVue Cam Arm Adapters - Pack of 10
LL341	LIVE Cam Lock Door Adapter Kit - Pack of 2
LL902	LIVE Lock 7mm Riser - For Use with Plunger & Cam Locks
LL903	LIVE Lock 3mm Riser - For Use with Plunger & Cam Locks
LL904	LIVE Lock Replacement Caps - Pack of 20
DBG400	Magnet Key - Pack of 4



# LIVE Locks/ Technical Specifications

## LIVE LOCK REPLACEMENT ADHESIVES

ORDER CODE	DESCRIPTION
LL140	LIVE Slider Lock Replacement Adhesive - Pack of 10
LL141	LIVE Slider Lock Strike Plate Replacement Adhesive - Pack of 10
LL901	LIVE Plunger & Cam Lock Replacement Adhesive - Pack of 10

©2024 InVue. No endorsement of InVue products has been made by any of the manufacturers of the products shown. Product is sold pursuant to InVue's warranty which can be found at [www.invue.com/warranty](http://www.invue.com/warranty).

**THE AMERICAS** 704.752.6513 • 888.55.INVUE  
**EUROPE, MIDDLE EAST & AFRICA** +31.23.7113377  
**ASIA PACIFIC** +852.3127.6811

