

# inVue

L440  
PL901

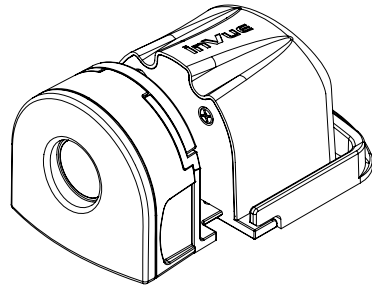

## Included Parts

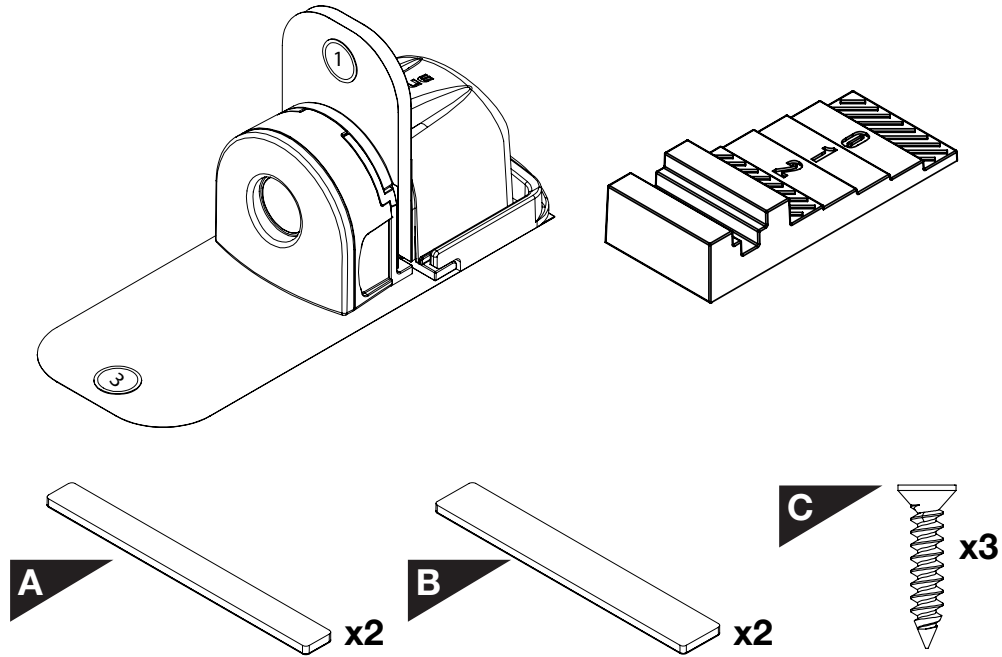

1

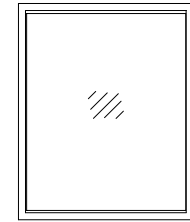

Or

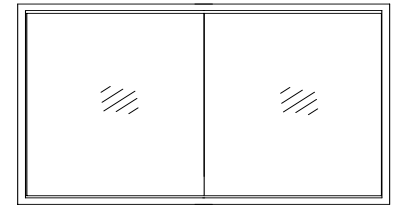

**!** CAUTION: If the L440 will be installed on a double door fixture please see the instruction sheet for the door brace (PL920-01).

2a

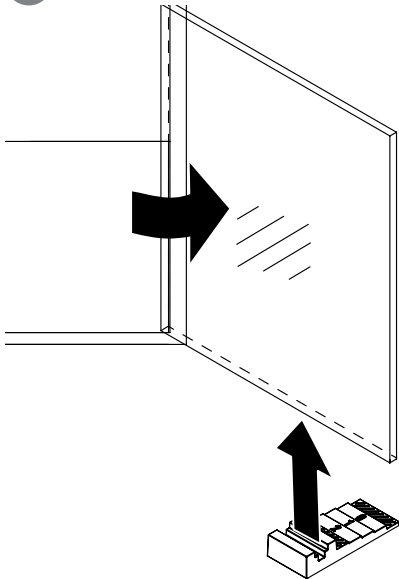

2b

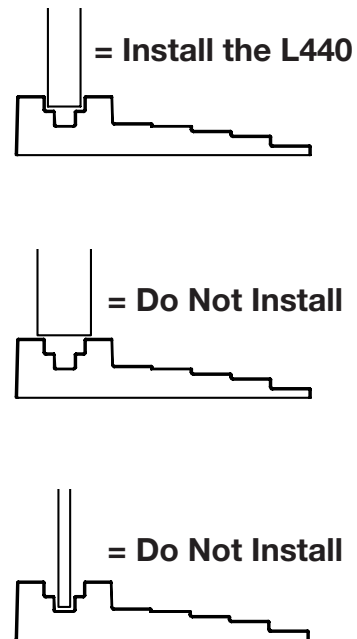

3

If mounting the L440 to a glass shelf, please see the instructions for the glass mount strike plate (PL920-2).

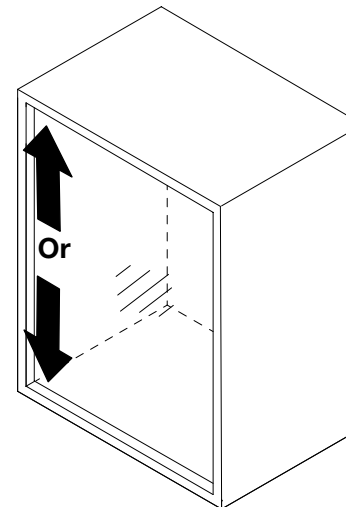

4

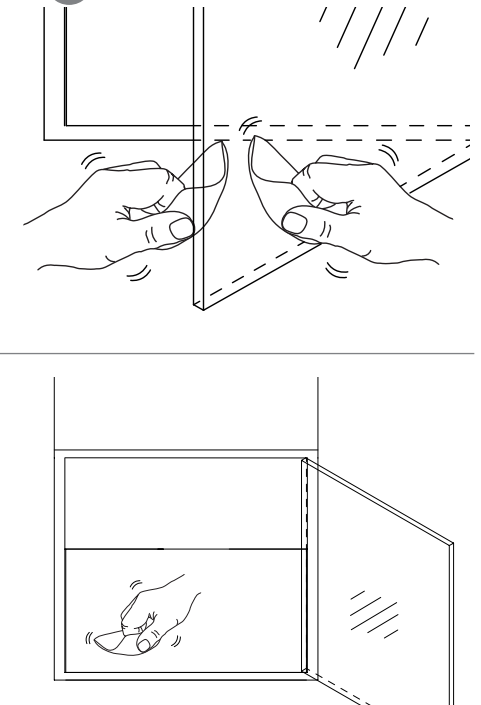

5

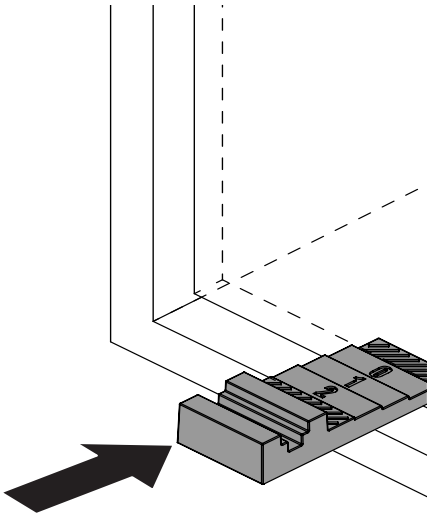

6

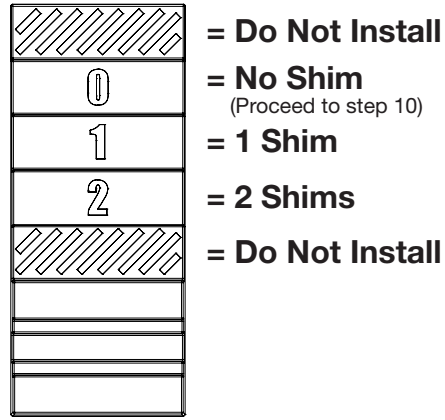

7

If needed from steps 5 & 6.

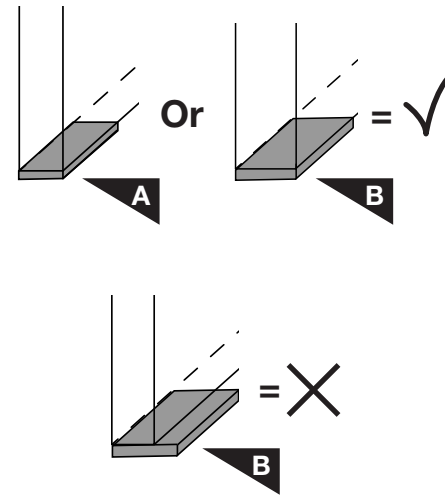

**CAUTION:** Be sure that the shim is not wider than the thickness of the glass door.

8

If needed from steps 5 & 6.

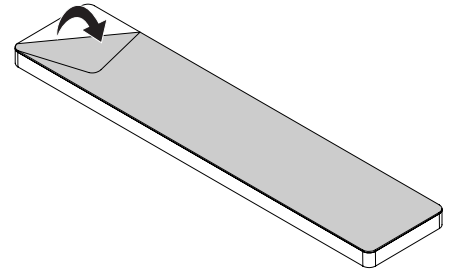

9

If needed from steps 5 & 6.

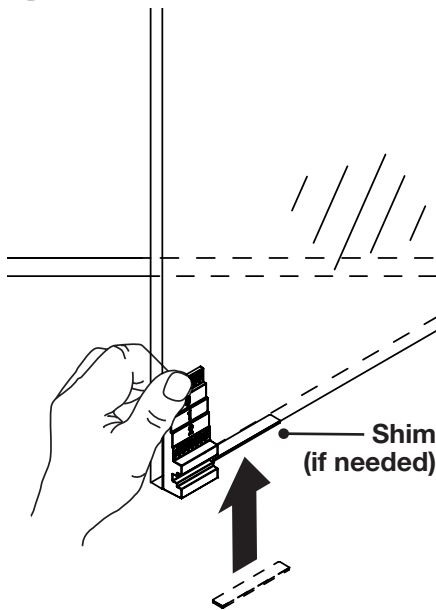

10a

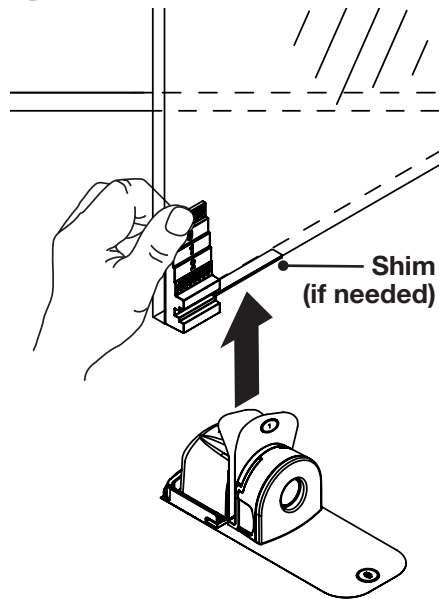

10b

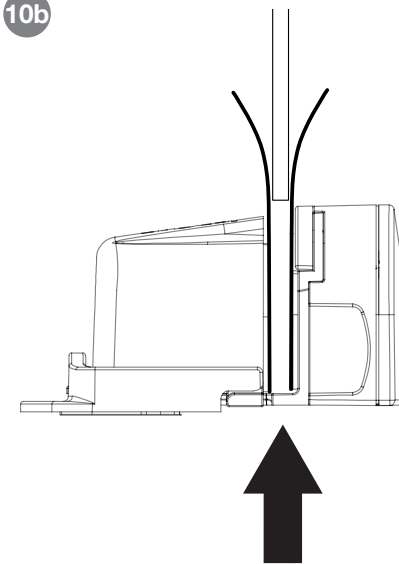

**CAUTION:** Be sure that the glass goes between the 2 adhesive liners on the lock housing and that the lock is pressed against the bottom edge of the glass or shim (if needed).

11

Remove release liner #1

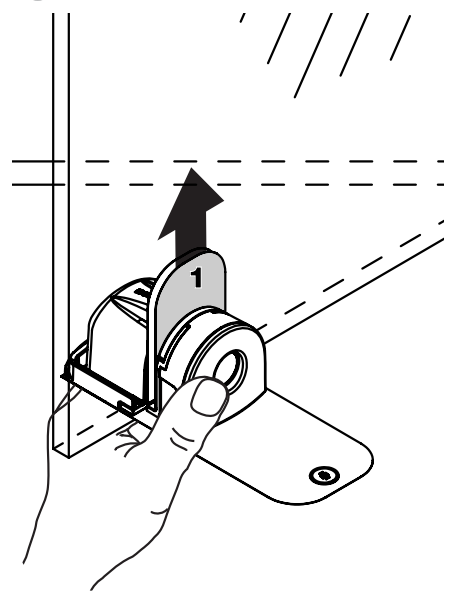

**Note:** Be sure that the lock housing is pressed firmly against the glass.

12 Remove release liner #2

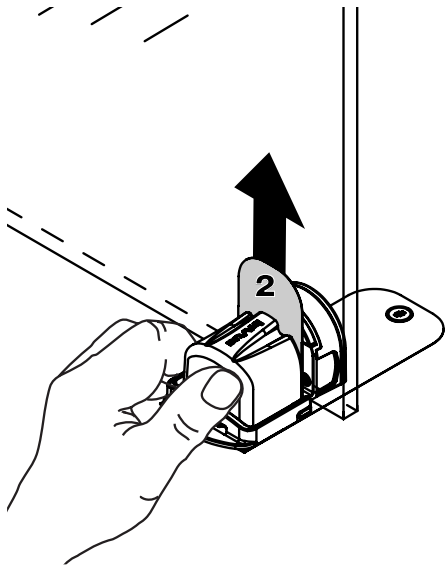

**Note:** Be sure that the lock housing is pressed firmly against the glass.

13

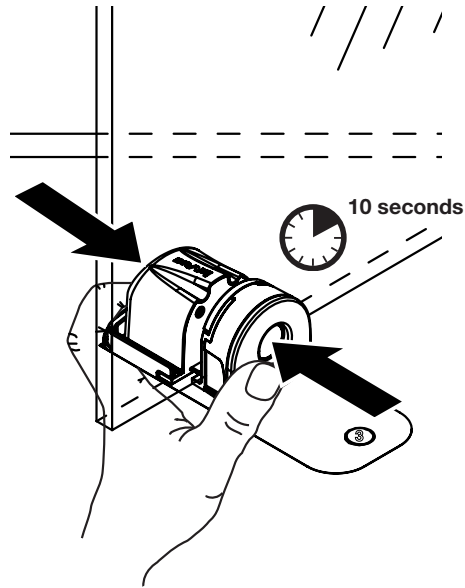

14a

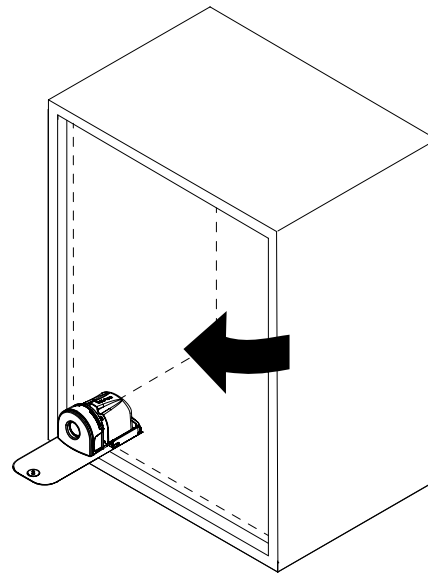

14b Remove release liner #3

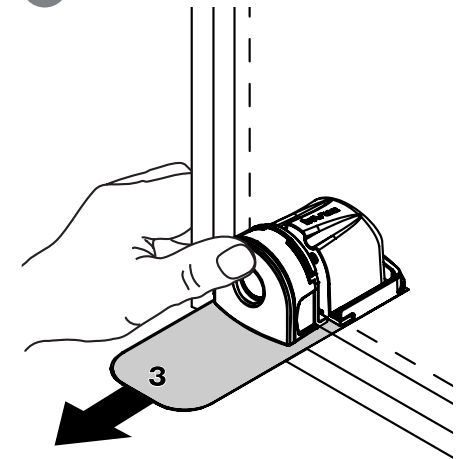

**CAUTION:** Hold the door in the closed position while pulling the #3 adhesive liner.

15

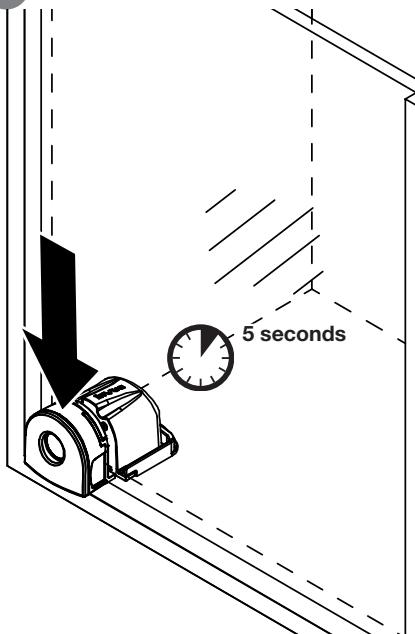

16

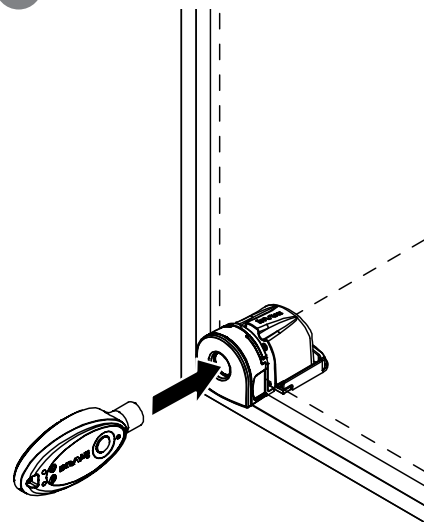

**Note:** If the key does not beep and makes a "knack-knack" sound it means the key was pulled away too soon. Try again and wait for the beep before pulling the key away.

17

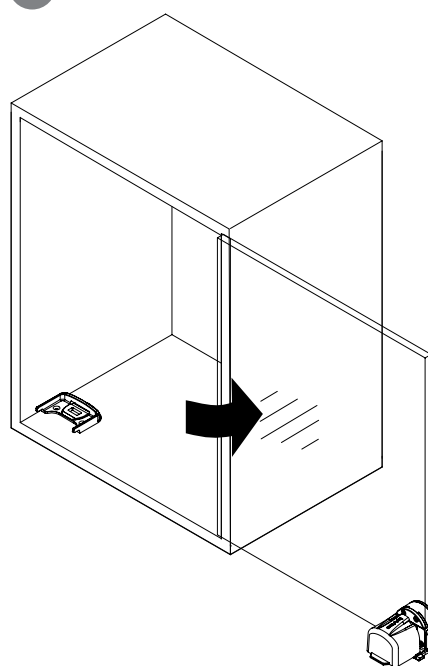

18

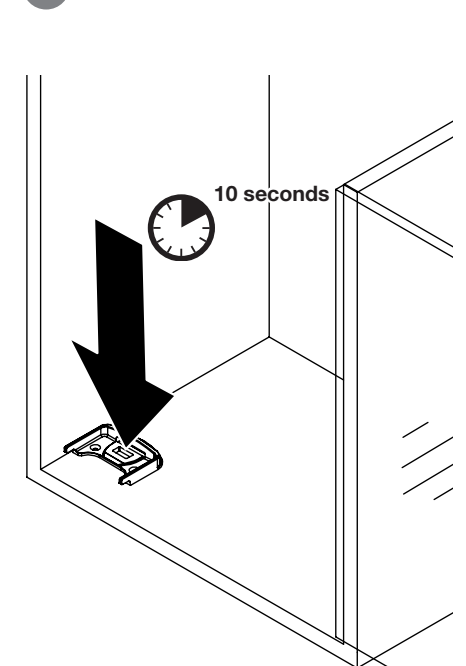

19

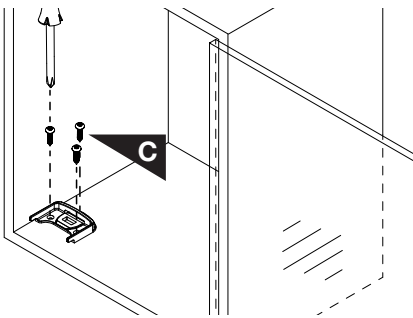
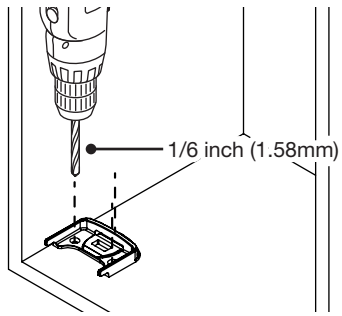

**Use Instructions:**

1

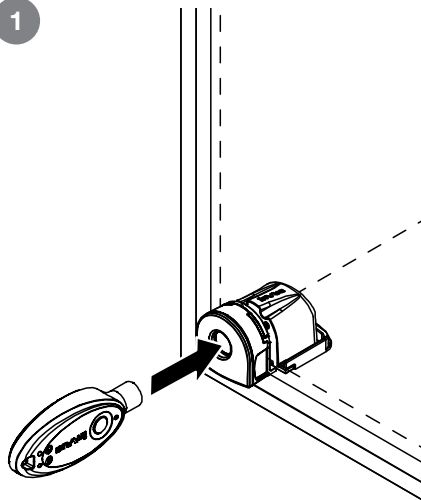

**Note:** If the key does not beep and makes a “knack-knack” sound it means the key was pulled away too soon. Try again and wait for the beep before pulling the key away.

2

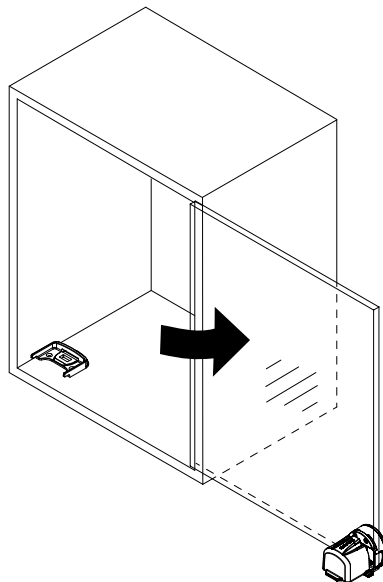

3

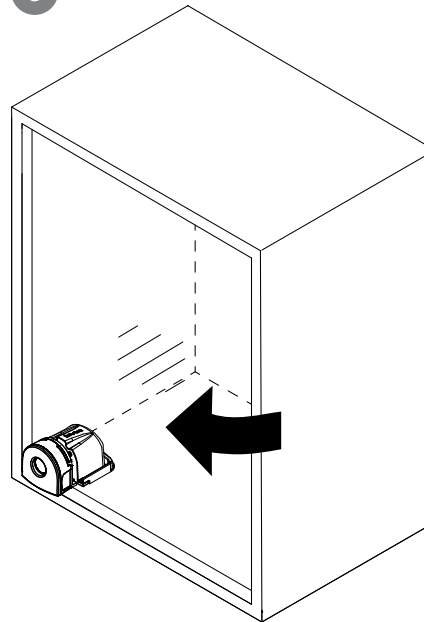

SD0449 Rev10 05/19/2017

**inVUE**

[www.invue.com](http://www.invue.com)

NA / LATAM // 704.752.6513 • 888.55.INVUE

EMEA // +31.23.8900150

APAC // +852.3127.6811

© 2016 InVue Security Products Inc. All rights reserved.  
InVue is a registered trademark of InVue Security Products.