

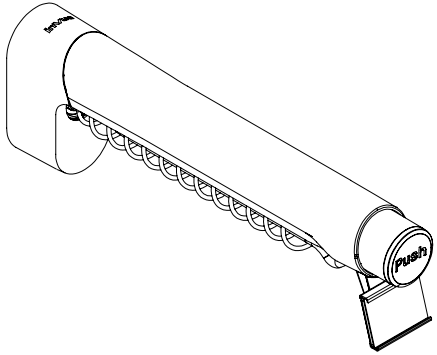

T1000

Anti-Sweep Dispenser, 12" Hang Bar
T1040, T1041, T1042, T1046-B1,
T1046-B2, T1046-B3



Part Identification

Button

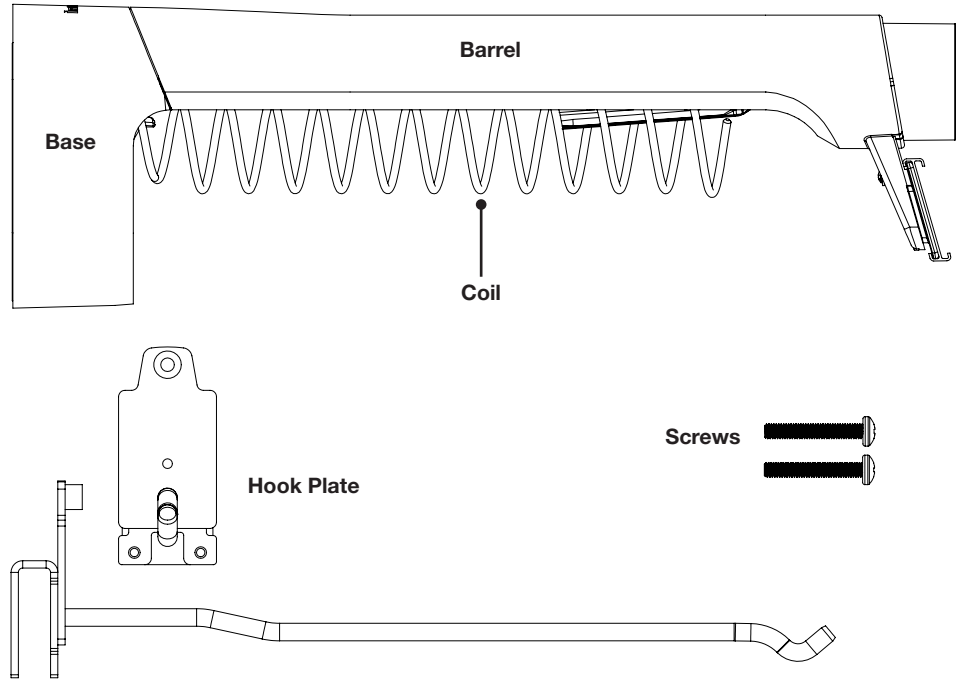

1a Place the hook bracket over the hang bar.

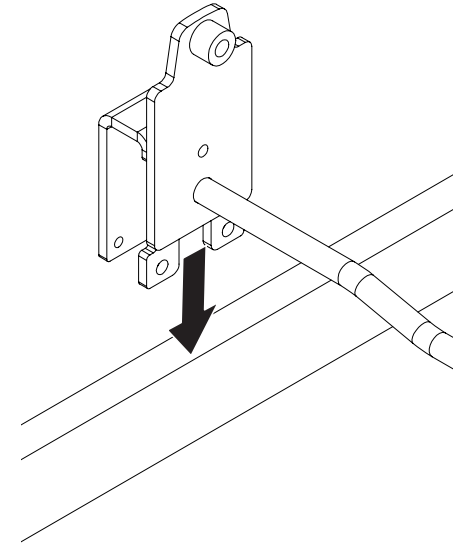

1b Install the the 2 screws to secure the hook bracket to the hang bar.

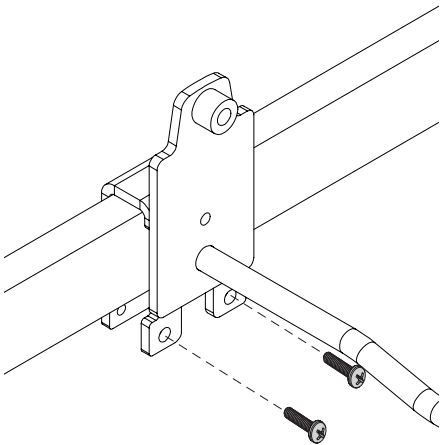

2 Hold the rear housing in one hand and slide the barrel several inches away from the rear housing.
Hold the barrel in place.
Note: Insert the sensor removal multitool attachment (AF6313) into the slot on the top of the T1000. If not available, hold it in place by hand.

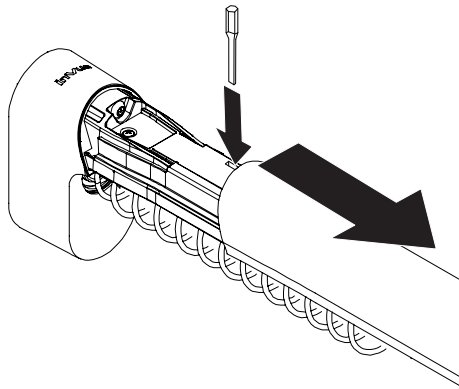

3 While holding the barrel open, feed the hook through the hole in the back of the rear housing. Ensure the hook feeds all the way through the coil.

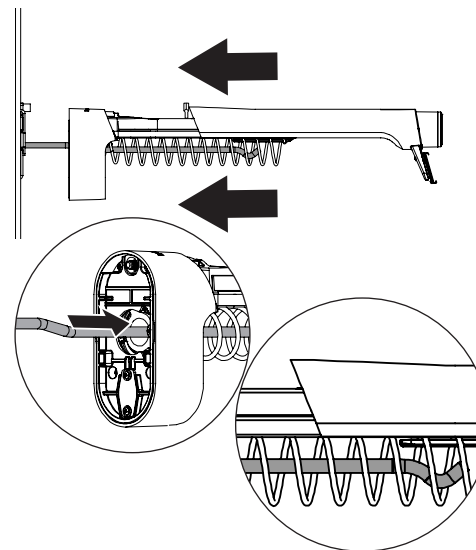

4 Push the T1000 against the wall while aligning the screw with the hole in the screw plate. **Continue to hold the barrel open.**

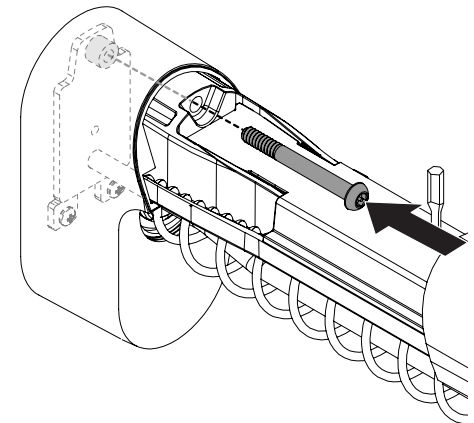

- 5** Tighten the screw using the T20 bit with the multitool (AF6313.) Remove bit and release the barrel so it returns to the closed position.
Note: Do not overtighten screw.

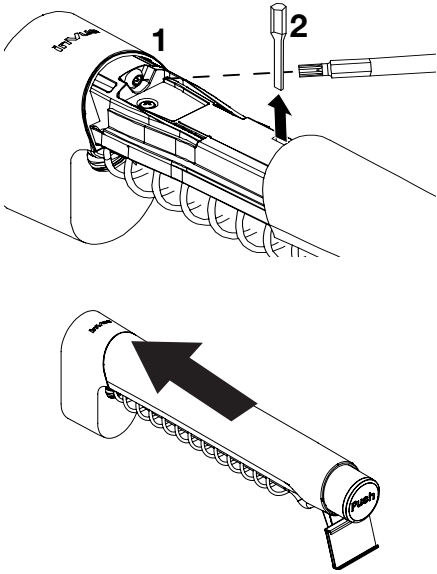

- 6** **Loading product:**
 Place merchandise packaging on hook and hold against coil.
Note: Before loading any products make sure all tension on the internal spring is released by depressing the button until the coil no longer moves.

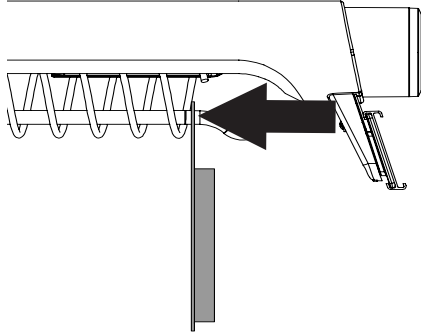

- 7** While holding the packaging against the coil, pull barrel to its **full extension** then return it to its closed position. Verify product is hanging on the rod and the coil is not threaded through the hangtab.

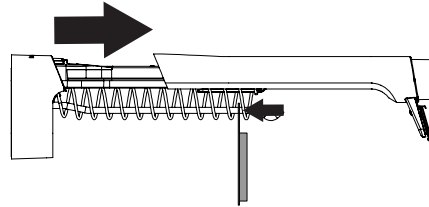

- 8** Repeat to load additional products, ensuring that one product is loaded in each coil space.
Note: Do not overload past the last coil space.

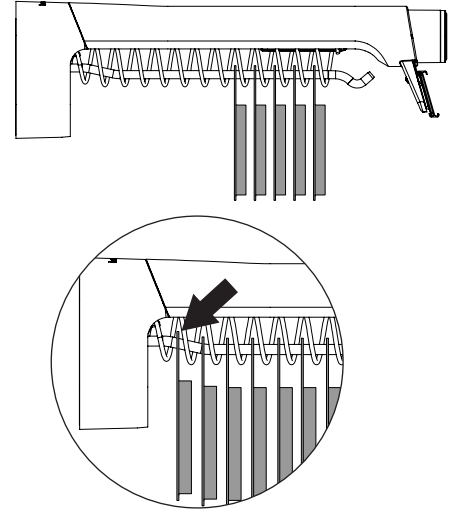

- 9** Push button to dispense merchandise.

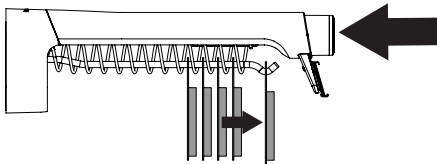

SD0474 Rev1 11/29/2017

invue

www.invue.com

NA / LATAM // 704.752.6513 • 888.55.INVUE

EMEA // +31.23.8900150

APAC // +852.3127.6811