

## CT80

### Ingenico Moby Series Bracket CTBA010-B

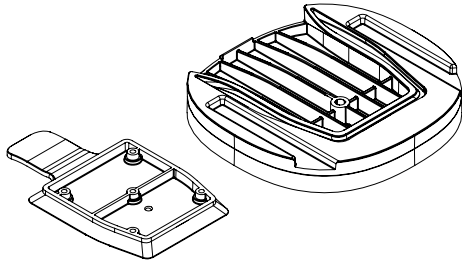

- 1** Place the dovetail plate onto the back of the device. make sure the release tab faces towards the top of the device.

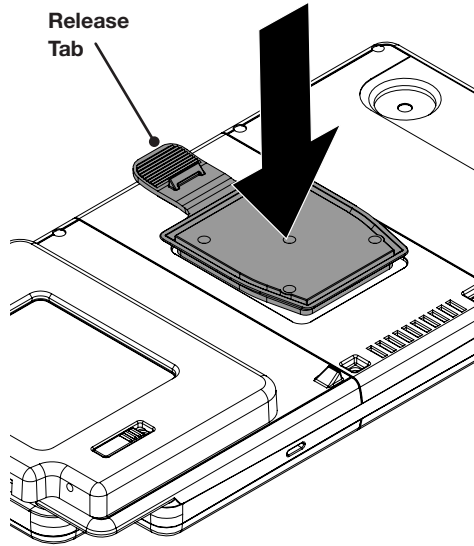

- 2** Secure the dovetail plate to the device with the 5 provided screws.

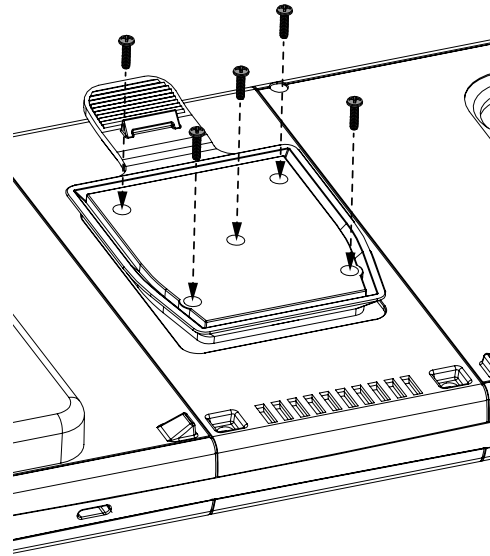

- 3** Slide the bracket over the dovetail plate. It will snap into place.

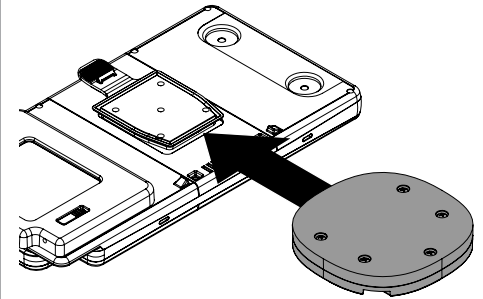

- 4** Clean the bracket with the provided alcohol wipe. Allow it to dry completely.

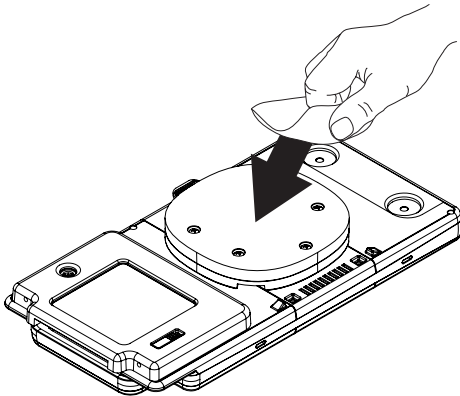

- 5a** If using the Moby M120 version, remove the small rubber pad from the handle and insert the taller rubber stopper.

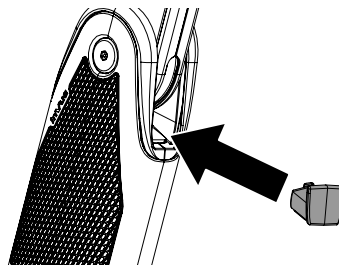
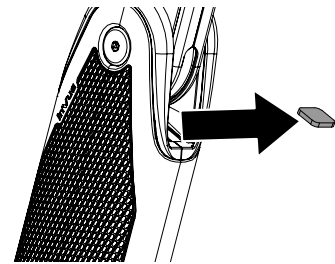

- 5b** Orient the handle so that the arrow on the top will face the top of the device.

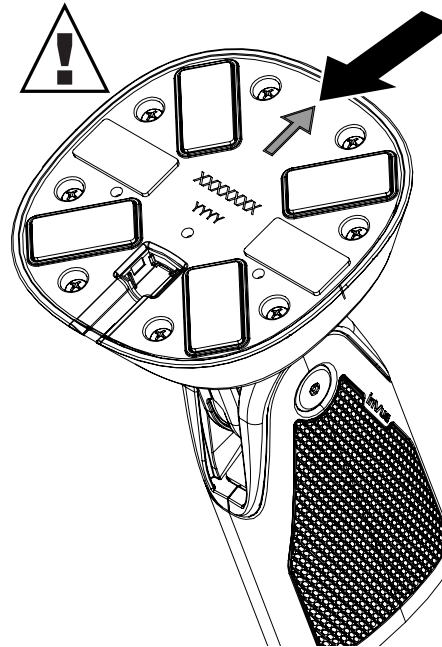

- 5c** Remove the clear film from the adhesives on the CT80 handle.

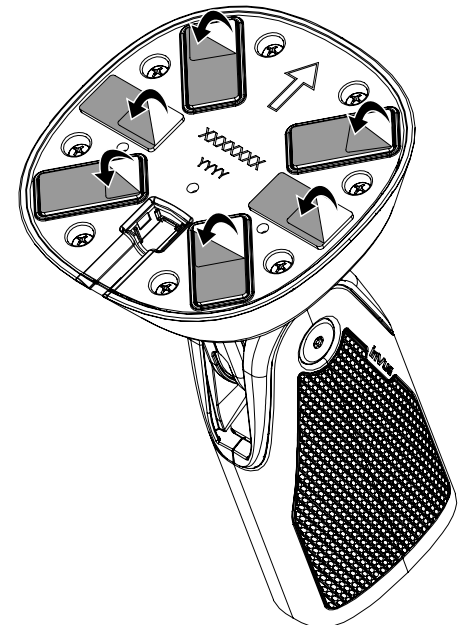

- 6 With the mousehole facing towards the bottom of the device, center the handle on the bracket and apply pressure for at least 10 seconds.

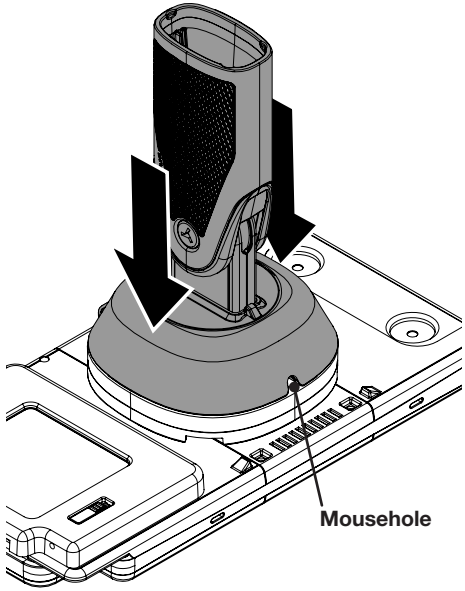

- 7 See the instruction for the CT80 stand for more information on setting up the stand and attaching the handle.

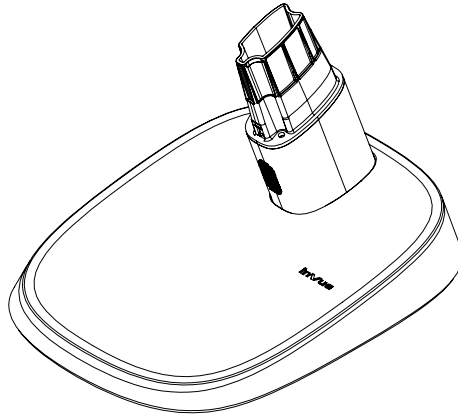

- 8 To release the device from the handle, press down on the release tab and slide the device free.

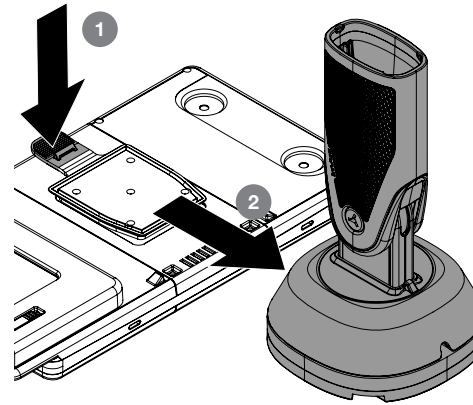

SD0645 Rev3 10/31/18

**INVUE**

[www.invue.com](http://www.invue.com)

NA / LATAM // 704.752.6513 • 888.55.INVUE

EMEA // +31.23.8900150

APAC // +852.3127.6811