

## S1060

Universal Slot Mount DRD400

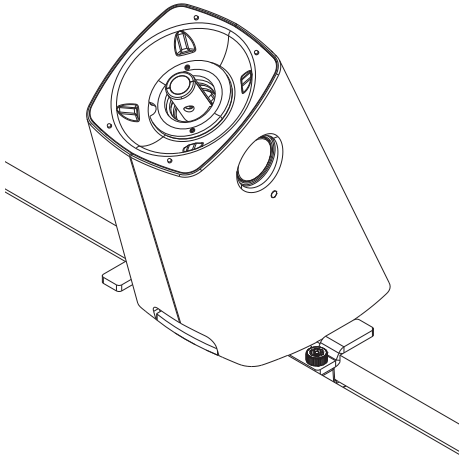

**1A** If routing power cable through fixture slot: Route power cable through the slot mount plate.

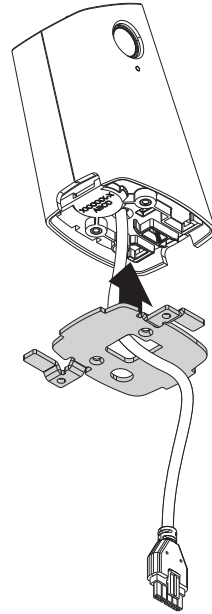

**2A** Secure slot mount plate with flat head phillips screws.

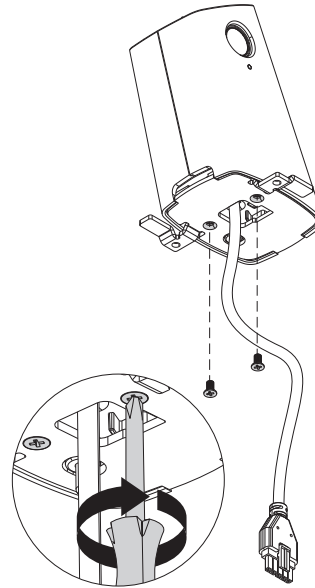

**1B** If routing power cable above fixture: Route power cable through channel next to plunger and out of the back slot in the stand.

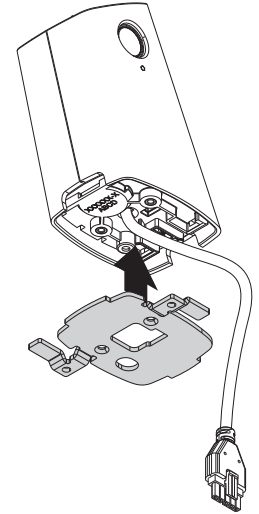

**2B** Secure slot mount plate with flat head phillips screws.

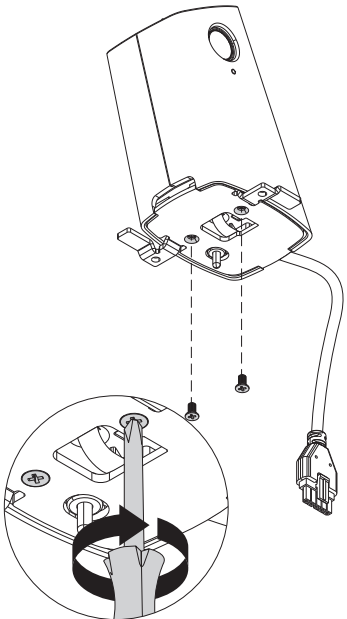

**3** Determine the appropriate screw length based upon the thickness of your fixture. Insert screws through slot mount plate holes and attach slot mount brackets. Do not tighten. Make sure slot mount brackets are oriented parallel to slot opening.

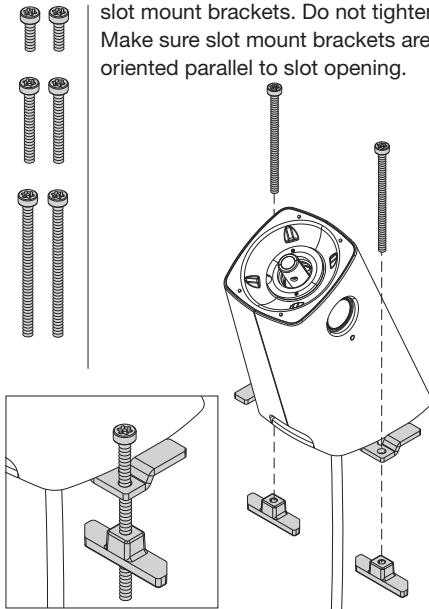

**4a** If routing power cable through fixture slot: Route cable through slot.

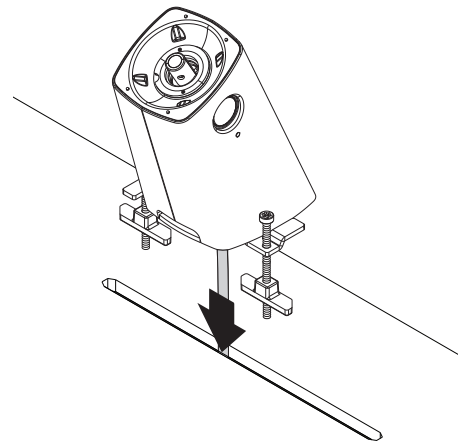

**4b** If routing power cable above fixture: Route cable to back of stand.

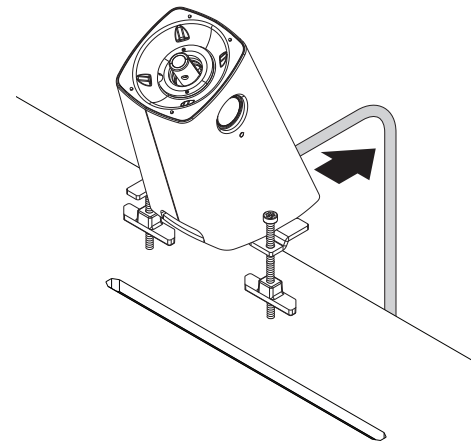

**5** Place slot mount plate, studs and mounting brackets into fixture slot.  
**Note:** slot width must be between 9mm-16mm.

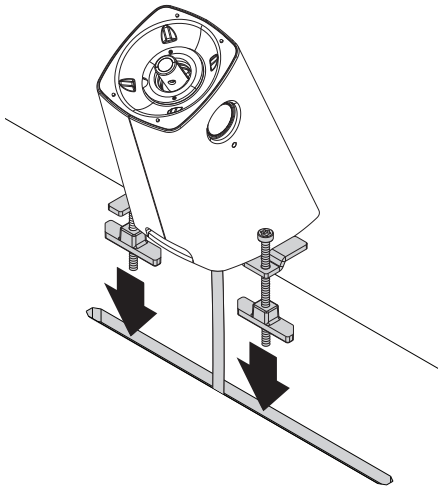

**6** From below, rotate the mounting brackets 90°.

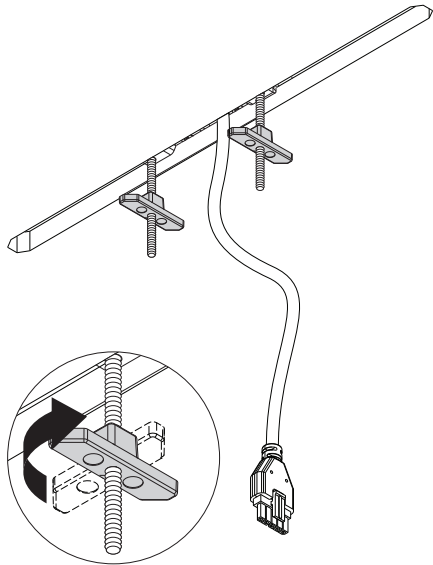

**7** From above, tighten both screws with a T-20 bit. Do Not overtighten.

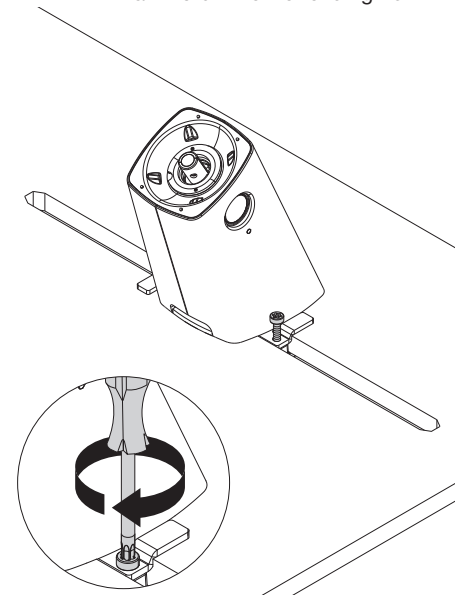

**8** Plug stand cable into power supply. Plug power supply into outlet.

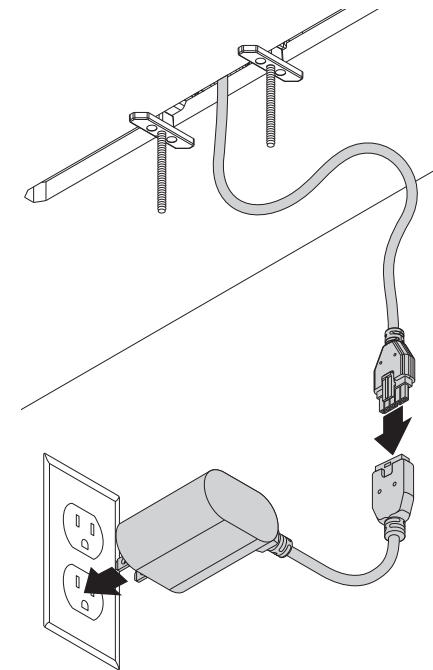

**9** **Optional auxiliary sensor:** Attach the sensor to the device to be protected. Plug the cable into the auxiliary port in the back of the stand.

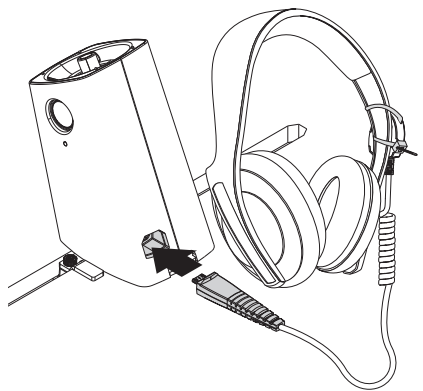

**10** **To lock down:** Confirm the sensor and device are on top of the stand. Use a T-20 bit to push in and then turn the screw clockwise a quarter turn.  
**To unlock:** Turn the screw counter clockwise a quarter turn and remove T-20 bit.

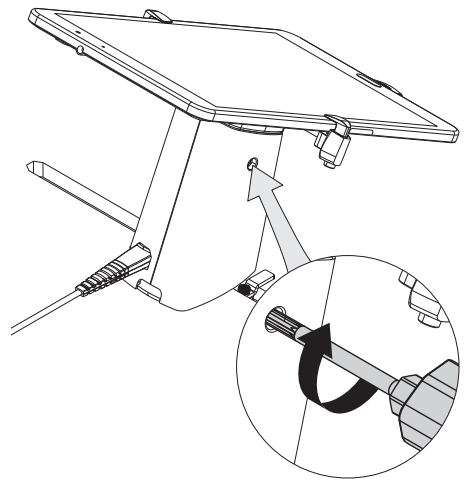

**Note:** Powered applications for auxiliary port are limited to a maximum 5V, 500mA.

SD0349 Rev0 05/6/16

**inVue**

[www.invue.com](http://www.invue.com)

NA / LATAM // 704.752.6513 • 888.55.INVUE  
EMEA // +31.23.8900150  
APAC // +852.3127.6811

© 2016 InVue Security Products Inc. All rights reserved.  
InVue is a registered trademark of InVue Security Products.