

# Kenmore®/MD



## Top Load Washer

4.7 cu. ft. (DOE) / 5.3 cu. Ft. (IEC)



Use & Care Guide

KKW4.7TLA-W  
KKW4.7TLA-G

# TABLE OF CONTENTS

SAFETY AND PRECAUTIONS .....	3
GROUNDING INSTRUCTIONS .....	4
IMPORTANT SAFEGUARDS .....	4
TECHNICAL SPECIFICATIONS.....	6
PARTS AND ACCESSORIES.....	7
DIMENSIONS.....	7
LOCATION REQUIREMENTS .....	8
INSTALLATION INSTRUCTIONS .....	9
UNPACKING YOUR WASHER.....	9
CONNECTING THE WATER SUPPLY .....	10
CONNECTING THE DRAIN HOSE.....	11
LEVELLING THE WASHER.....	12
PLUGGING IN AND TESTING.....	12
WASHER CYCLES AND OPTIONS .....	13
OPERATING YOUR WASHER.....	14
CONTROL PANEL .....	14
OPERATING YOUR WASHER.....	16
WASHING A LOAD OF LAUNDRY .....	16
STEP 1: PREPARE THE LOAD.....	16
STEP 2: ADD CLEANING PRODUCTS.....	17
STEP 3: SELECT WASH CYCLE AND START.....	18
ADDING AN ITEM MID-CYCLE.....	18
USER-MAINTENANCE INSTRUCTIONS .....	19
CLEANING THE EXTERIOR .....	19
CLEANING THE INTERIOR.....	19
CLEANING THE AUTOMATIC DISPENSERS.....	20
CLEANING THE INNER TUB FILTER .....	20
CLEANING THE WATER INLETS .....	20
TROUBLESHOOTING .....	21
ERROR CODES .....	23
WARRANTY .....	24

# SAFETY AND PRECAUTIONS

**Read all instructions before using this appliance.**

## IMPORTANT SAFETY SYMBOLS AND PRECAUTIONS



This is the safety alert symbol. This symbol alerts you to potential hazards that can kill or hurt you and others.



This icon indicates hazards or unsafe practices that may result in severe personal injury or death to you or others if you don't follow the instructions in this manual.



This icon indicates hazards or unsafe practices that may result in damage to property or mild to moderate personal injury to you or others if you don't follow the instructions in this manual.



To reduce the risk of fire, electric shock, or injury to persons when using your appliance, follow basic precautions, including the following:

1. Do not wash articles that have been previously cleaned in, washed in, soaked in, or spotted with gasoline, dry-cleaning solvents, or other flammable or explosive substances, as they give off vapours that could ignite or explode.
2. Do not add gasoline, dry-cleaning solvents, or other flammable or explosive substances to the wash water. These substances give off vapours that could ignite or explode.
3. Under certain conditions, hydrogen gas may be produced in a hot water system that has not been used for two weeks or more. **HYDROGEN GAS IS EXPLOSIVE.** If the hot water system has not been used for such a period, before using the washing machine, turn on all hot water faucets and let the water flow from each for several minutes. This will release any accumulated hydrogen gas. Do not smoke or use an open flame during this time as the hydrogen gas is flammable and could ignite and explode.
4. Risk of Suffocation and Injury from Entrapment: Do not allow children to play on or in the appliance. Close supervision of children is necessary when using the appliance near children.
5. Before the appliance is removed from service or discarded, remove the door.
6. Do not reach into the appliance if the tub or agitator is moving.
7. Do not tamper with controls.
8. Do not repair or replace any part of the appliance or attempt any servicing unless specifically recommended in the user-maintenance instructions or in published user-repair instructions that you understand and have the skills to carry out.
9. Do not use replacement parts that have not been recommended by the manufacturer (eg. parts made at home using a 3D printer).

# SAFETY AND PRECAUTIONS

## GROUNDING INSTRUCTIONS

This appliance must be grounded. In the event of a malfunction or breakdown, grounding will reduce the risk of electric shock by providing a path of least resistance for electric current. This appliance is equipped with a power cord with an equipment-grounding conductor and a grounding (3-prong) plug. The plug must be plugged into an appropriate outlet that is installed and grounded in accordance with all local codes and ordinances.

### **WARNING**

- Improper connection of the equipment-grounding conductor can result in a risk of electric shock. Check with a qualified electrician or service representative if you are in doubt as to whether the washer is properly grounded.
- Do not modify the plug provided with the appliance. If the plug will not fit into your outlet, have the proper outlet installed by a qualified electrician.
- Certain internal parts are intentionally not grounded and may present a risk of electric shock only during servicing. Service Personnel – Do not contact the following parts while the appliance is energized: Electrical Valve, Main Control Box and Capacitor.

## IMPORTANT SAFEGUARDS

### **CAUTION**

Observe the following precautions to prevent injury to yourself or others or damage to property:

- Please read this manual carefully before using the appliance. Follow all instructions and keep the manual for future reference.
- This appliance is not intended for use by persons (including children) with reduced physical, sensory or mental capabilities, or lack of experience and knowledge, unless they have been given supervision or instruction concerning use of the appliance by a person responsible for their safety and understand the hazards involved. Children should be supervised to ensure that they do not play with the appliance.
- This appliance is intended for indoor use only.
- This appliance is intended to be used in household and similar applications such as:
  - staff kitchen areas in shops, offices and other working environments
  - farmhouses and by clients in hotels, motels and other residential type environments
  - bed and breakfast type environments
  - catering and other similar non-retail applications.

# SAFETY AND PRECAUTIONS

## CAUTION

- If the power cord is damaged, it must be replaced by the manufacturer or a qualified Kenmore service technician.
- Do not attempt to disassemble, repair or replace any part of the appliance unless it is specifically recommended in this manual. All other servicing should be referred to a qualified Kenmore service technician.
- Do not insert your hand into or remove clothing from the tub before it has completely stopped spinning.
- Do not install the appliance in a damp, wet or humid environment. Doing so could result in electrical shock, short circuits, or fire.
- Do not clean the outside of the machine by rinsing it directly with water.
- To avoid accidents, never allow children to climb up or onto the machine and do not let children look into the tub while it is spinning.
- Never wash clothes or other items that have been contaminated with flammable materials such as kerosene, gasoline or alcohol.
- Do not damage the power cord or plug. Doing so could result in electrical shock, short circuits, or fire. If the power cord is damaged, discontinue use immediately and contact Kenmore Customer Care for repair or replacement.
- Unplug the appliance when it is not in use. To unplug, grasp the plug and pull it from the electrical outlet. Never unplug the appliance by pulling on the power cord.
- Regularly clean the power plug with a dry cloth to remove dust and dirt which could cause contact failure. Always unplug the appliance before cleaning the plug.
- To prevent electrical shock from water leaking, this appliance must be plugged into a properly grounded three-prong plug. Do not under any circumstances cut or remove the third ground prong from the supplied power cord. Always insert the power plug firmly into the outlet.
- Do not touch the power cord, plug or outlet with wet hands. Doing so could cause electrical shock. Always ensure that your hands are completely dry before plugging in or unplugging the appliance.
- Never place flammable items such as lit candles, incense, burning mosquito repellent, or cigarettes on top of the appliance. Never place heat sources such as electric heaters or toaster ovens on top of the appliance.
- Never use the appliance with an extension cord. Use of an extension cord can cause voltage drop, overheating, and increased risk of electrical shock or fire. Use only a grounded, dedicated outlet within reach of the factory-provided power cord.

# SAFETY AND PRECAUTIONS

## CAUTION

- Ensure that the water supply hoses are connected and the hot and cold water supplies are opened before using the washer.
- When washing with warm water, the temperature should not exceed 122°F (50°C).
- Never store or place heavy objects on top of the washer. Do not let children sit on top of the washer.
- Do not wash down jackets, raincoats, fishing coats, or similar waterproof items in the washer.
- The washer must be connected to the water main using the new hose sets supplied with the appliance. Failing to do so may result in a water leakage or overflow and may damage your property. Never reuse old hose sets.
- The vent openings must not be obstructed by a carpet or other objects.

## READ AND SAVE THESE INSTRUCTIONS

# TECHNICAL SPECIFICATIONS

Weight		123.5 lb (56 kg)
Dimensions (W x D x H)		27 x 29 x 43.5 in (686 x 736 x 1105 mm)
Application water pressure		0.03 MPa ~ 1.0 MPa
Rated power supply		115 V/60 Hz
Rated input power	Washing	650W
	Spinning	550W
	Pump	80W

# PARTS AND ACCESSORIES

1. Cabinet
2. Frame
3. Control Panel
4. Top Lid
5. Power Cord
6. Handle
7. Drain hose
8. User Manual
9. Drain hose guide
10. Water supply hoses (2)
11. Leveling feet

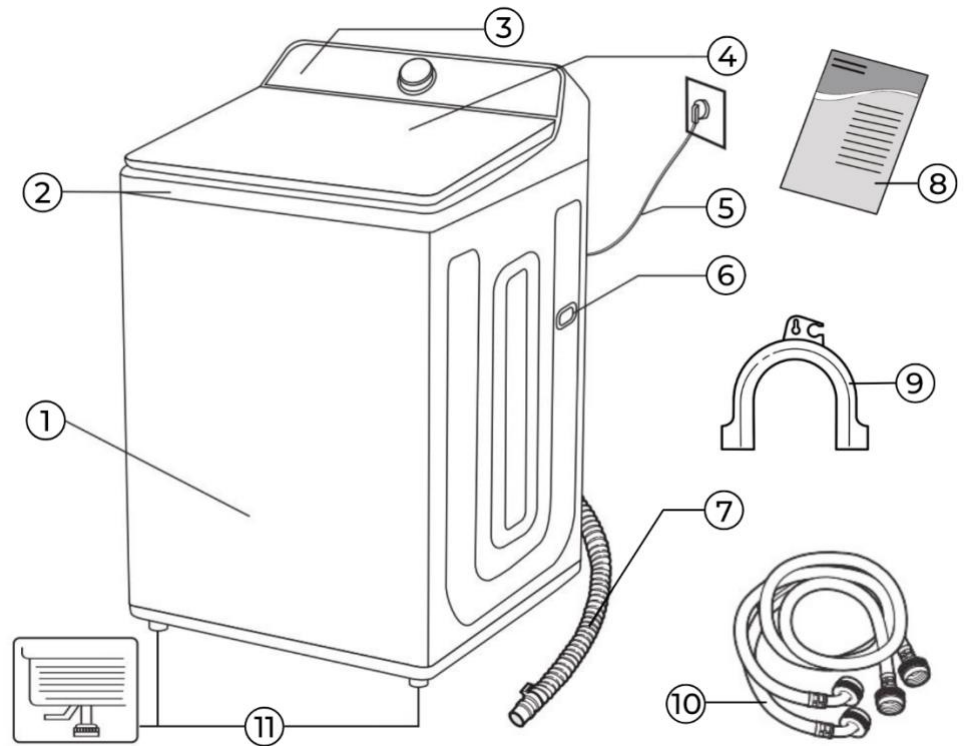

# DIMENSIONS

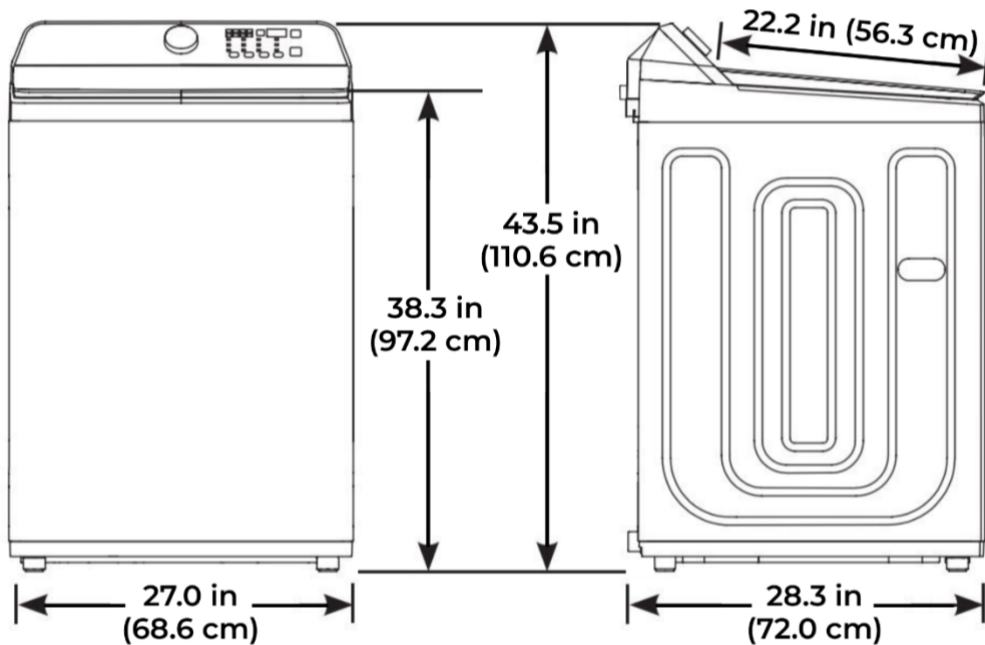

# LOCATION REQUIREMENTS

Before you install the washer, make sure the location:

- Has a hard, level surface without carpeting or flooring that may obstruct ventilation.
- Has adequate ventilation and enough space that the washer does not press against or rest on its power cord or water supply hoses.
- Is away from heat sources or flammable materials such as oil or gas.
- Is not exposed to direct sunlight or freezing temperatures (below 32°F or 0°C).

## ALCOVE OR CLOSET INSTALLATION

- If installing the washer in an alcove or closet, observe the following minimum clearances:

Sides: 1 in/2.5 cm

Rear: 6 in/15.2 cm

Front: 2 in/5.1 cm

Top: 22.6 in/57.5 cm

- The closet front must have two unobstructed air openings for a combined minimum total area of 72 in<sup>2</sup> with 3 in minimum clearance on the top and bottom. A louvered door with equivalent space clearance is acceptable.

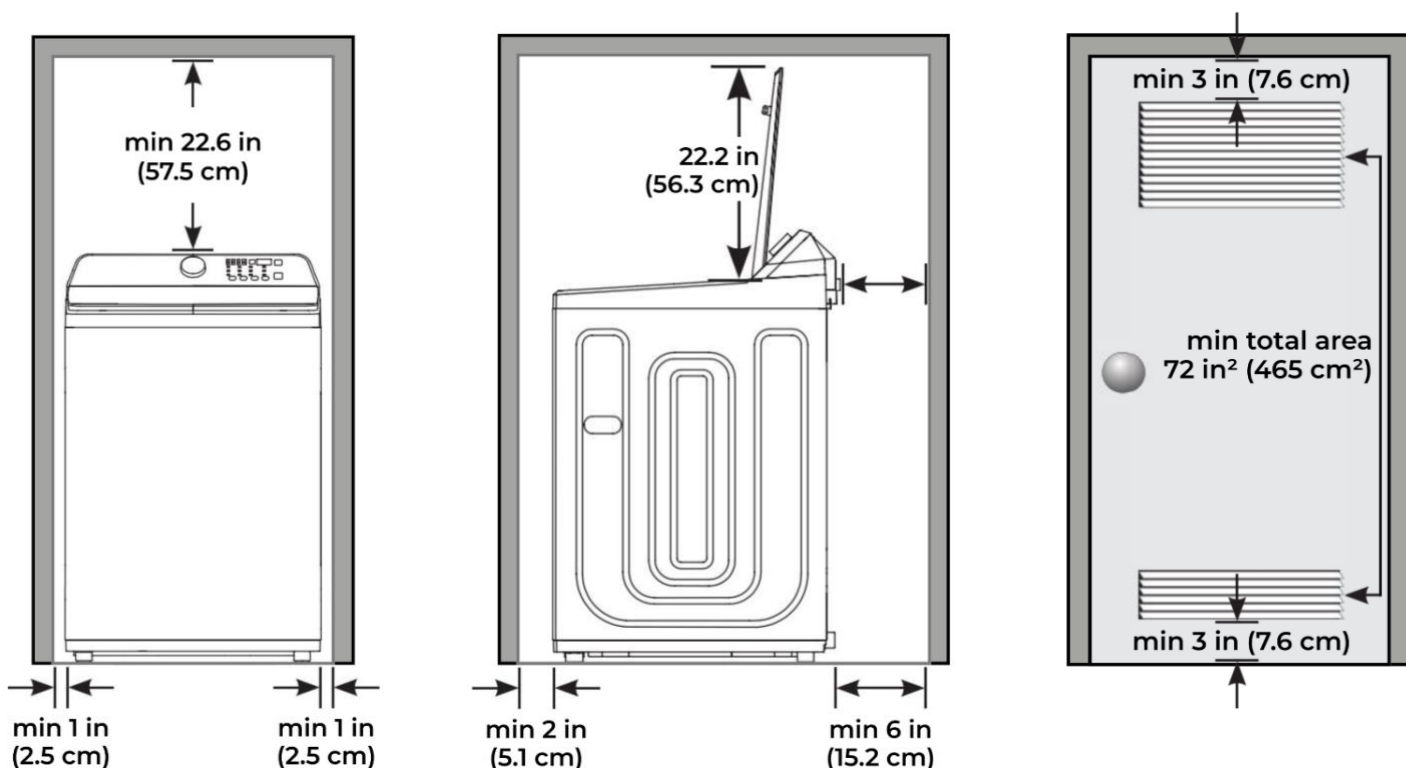

# INSTALLATION INSTRUCTIONS

## CAUTION

- Certain internal parts are intentionally not grounded and may present a risk of electric shock only during servicing. Service Personnel: Do not contact the following parts while the appliance is energized: Electrical Valve, Main Control Box and Capacitor.
- When you initially install the washer, be sure to use new hoses. Failing to do so may result in a water leakage which could cause electrical shock, short circuits, or fire.
- Before installing the water supply hoses, check for the rubber gaskets inside the fittings at each end of the hoses and reinstall them if they have shifted or fallen out during transport. Installing the water supply hoses without rubber gaskets may result in a water leakage which could cause electrical shock, short circuits, or fire.
- Do not attempt to stretch a water supply hose or connect multiple hoses together to increase the length. Doing so could result in a water leakage which could cause electrical shock, short circuits, or fire. If a water supply hose is too short, replace it with a longer high-pressure water hose.

## UNPACKING YOUR WASHER

1. Carefully remove all packaging materials, including the foam shipping base (A).
2. Open the washer lid and remove the rubber pad from the latch (B).
3. Remove the accessories from the tub, unpack, and check that all parts are present.
4. Safely dispose of/recycle all packaging materials.

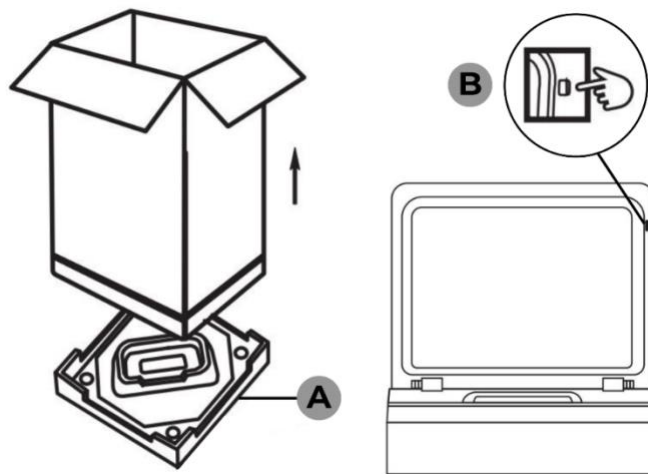

# INSTALLATION INSTRUCTIONS

## CONNECTING THE WATER SUPPLY

1. Ensure that the rubber gaskets are correctly placed inside the fittings at each end of the water supply hoses.
2. Locate the water supply and connect the hoses to the hot and cold water supply valves or faucets. Tighten the fittings by hand until they are snug, and then tighten them an additional two-thirds of a turn with pliers.

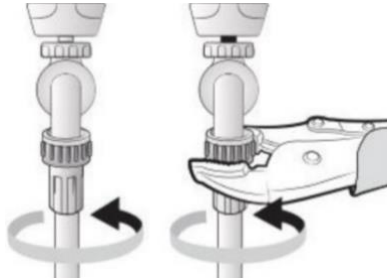

**IMPORTANT:** Do not overtighten the fittings or apply tape or sealant to the water supply valves or inlets. This can damage the fittings.

3. Place the unconnected ends of the hoses into a bucket or laundry tub and turn on the hot and cold water supplies for 10 or 15 seconds to flush the water lines and remove any particles that might clog the hoses.



4. Locate the water supply inlets on the back of the washer and connect the ends of the hoses to the corresponding inlets, making sure the hoses are not twisted or bent. The hose connected to the hot water supply must be attached to the inlet labeled “H” or “HOT” and the hose connected to the cold water supply must be attached to the inlet labeled “C” or “COLD.”

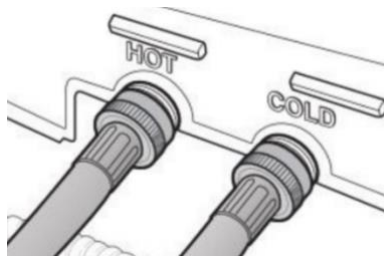

**IMPORTANT:** If the hoses are twisted or bent, the hoses can leak and cause electric shock due to the water leakage.

5. Tighten the fittings by hand until they are snug, and then tighten them an additional two-thirds of a turn with pliers.
6. Turn on the hot and cold water supplies and check all connections for leaks.

# INSTALLATION INSTRUCTIONS

## CONNECTING THE DRAIN HOSE

The end of the drain hose can be positioned in a wall standpipe, a floor standpipe, or a laundry tub. The height of the standpipe or laundry tub must be no lower than 39 in (99 cm) and no higher than 78 in (200 cm).

1. Attach the end of the drain hose to the supplied hose guide.
2. Place the end of the drain hose in the standpipe or laundry tub and position the hose guide over the side.
3. Use a cable tie to secure the drain hose in one of the following ways:
  - Wall standpipe: Fastened to the supply hoses (A)
  - Floor standpipe: Fastened to the standpipe (B)
  - Laundry tub: Fastened to the leg of the tub (C)

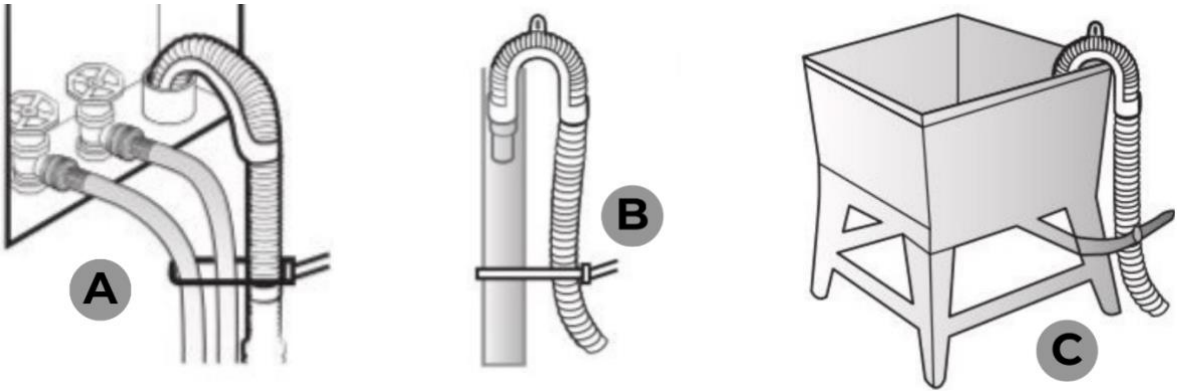

**NOTE:** While the drain hose can be installed to a maximum of 78 in (200 cm), draining performance may be reduced at this height, resulting in the washer having an odour due to retained water in the drain system.

# INSTALLATION INSTRUCTIONS

## LEVELLING THE WASHER

1. Slide the washer into position and pour water into the tub to just below the bottom of the agitator.
2. Check if the agitator is centered in the water.

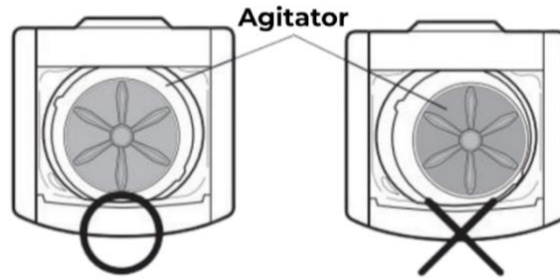

3. If the agitator is not centered, level the washer by turning the leveling feet clockwise to extend them or counterclockwise to retract.

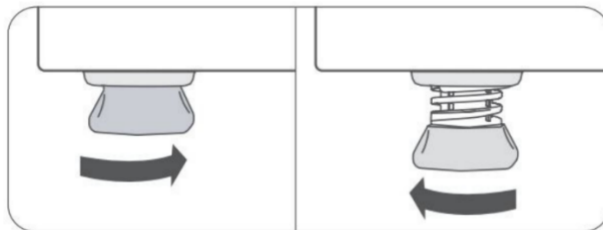

## PLUGGING IN AND TESTING

1. Plug the power cord into a 3-prong, well grounded, 120V/60Hz approved electrical outlet protected by a 15-amp fuse or comparable circuit breaker.

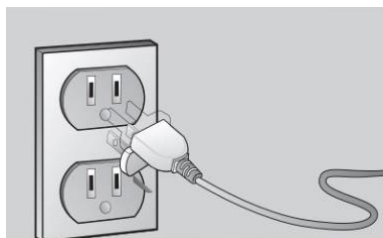

2. Run a **Rinse & Spin** cycle (without detergent) according to the Operating Instructions on the following pages to check if your washer is properly installed. The washer should not rock or vibrate excessively when water is supplied or when washing or spinning, and should drain well during the spin cycle.

# WASHER CYCLES AND OPTIONS

Cycle	Description	Default Settings					Additional Options	
		Fabric Softener	Soil Level	Water Temp	Water Level	Cycle Time (Approx.)	Extra Rinse	Delay Start
Normal/Casual	<ul style="list-style-type: none"> <li>Cleans normally soiled cottons, linens, and mixed loads.</li> </ul>	●	Medium	Cold	Med Low	1h45min		●
Bulky/Bedding	<ul style="list-style-type: none"> <li>Used to wash large items such as coats, sheets, blankets, sleeping bags, small washable rugs, and small comforters.</li> <li>Fills with enough water to wet down the load before starting the wash cycle.</li> </ul>	●	Medium	Cold	Med High	2h12min	●	●
Heavy Duty	<ul style="list-style-type: none"> <li>Cleans heavily-soiled items and durable fabrics such as towels and sports uniforms.</li> </ul>	●	Heavy	Warm	Medium	2h09min	●	●
Express	<ul style="list-style-type: none"> <li>Used to quickly clean a small load of lightly-soiled items.</li> </ul>	●	Light	Cold	Med Low	58min	●	●
Jeans	<ul style="list-style-type: none"> <li>Clean normally-soiled denims and sturdy khakis.</li> </ul>	●	Heavy	Cold	Medium	1h55min	●	●
Clean Washer	<ul style="list-style-type: none"> <li>Thoroughly cleans the empty washer tub. Never place garments or other items in the washer during the <b>Clean Washer</b> cycle.</li> <li>Use with a washing machine cleaning tablet or chlorine bleach. <b>Do not add detergent.</b></li> </ul>		n/a	Warm	High	1h46min		
Drain & Spin	<ul style="list-style-type: none"> <li>Removes excess water from the tub after a power interruption or cancelled cycle.</li> </ul>		n/a	n/a	n/a	1h04min		●
Rinse & Spin	<ul style="list-style-type: none"> <li>Used to rinse and then excess moisture from loads needing additional rinsing or items such as swimsuits that require rinsing only.</li> <li>Can be used to freshen a load after a power interruption or cancelled cycle.</li> </ul>		n/a	Cold	Medium	43min	●	●
Spin	<ul style="list-style-type: none"> <li>Removes excess moisture to shorten drying time for heavy fabrics or items that have been hand-washed.</li> <li>Can be used to correct unbalanced loads.</li> </ul>		n/a	n/a	n/a	15min		
Delicates	<ul style="list-style-type: none"> <li>Used to clean lightly soiled items that require gentle care such as hand-wash fabrics, lingerie, or machine-wash silks.</li> <li>Place small items in mesh garment bags before washing.</li> </ul>	●	Light	Cold	Medium	1h35min	●	●
Light Wash	<ul style="list-style-type: none"> <li>Used to clean lightly soiled mixed loads.</li> </ul>	●	Medium	Cold	Medium	2h19min	●	●
Soak	<ul style="list-style-type: none"> <li>Used to clean heavily soiled fabrics or items with set-in stains.</li> <li>Adds a pre-soak cycle with alternating soaking and agitation before washing.</li> </ul>	●	Heavy	Cold	High	2h14min	●	●

# OPERATING YOUR WASHER

## CONTROL PANEL

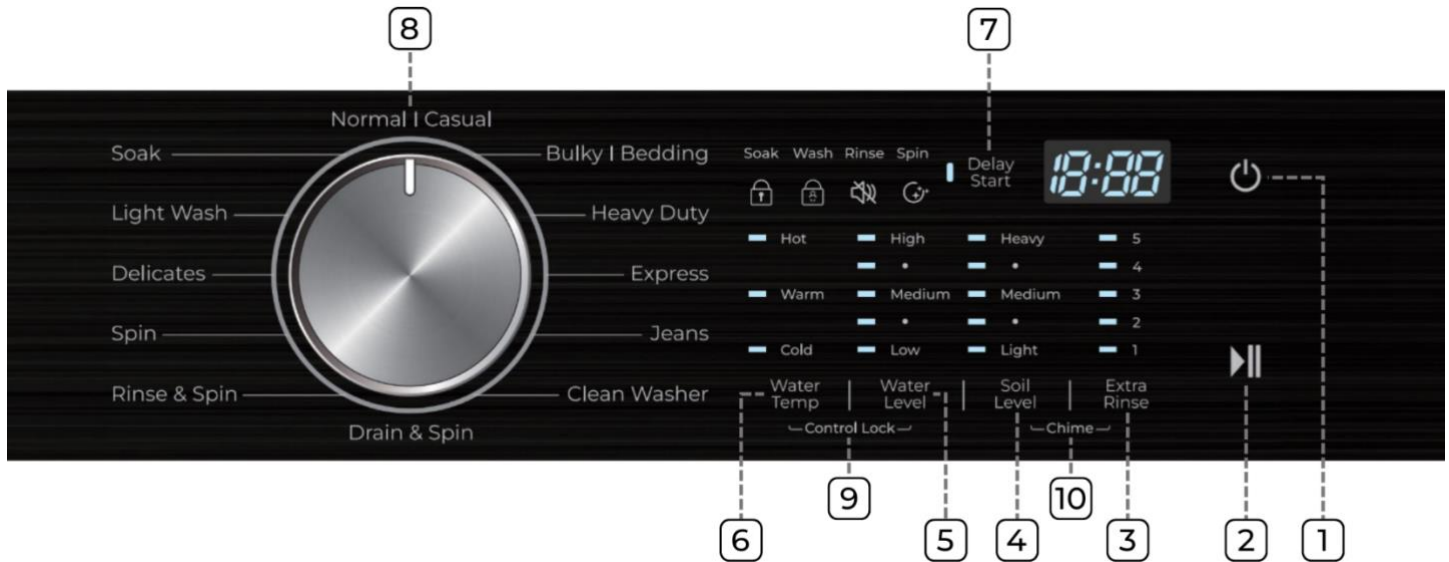

<p><b>1</b> Power</p>	<ul style="list-style-type: none"> <li>• Press <b>Power</b> once to turn the washer on or off.</li> <li>• The washer will automatically turn off after 10 minutes of inactivity.</li> </ul>
<p><b>2</b> Start/Pause</p>	<ul style="list-style-type: none"> <li>• After choosing your options, press <b>Start/Pause</b> to start the wash cycle.</li> <li>• Press <b>Start/Pause</b> at any time during the wash cycle to pause and press it again to resume.</li> <li>• While paused, you can open the lid to add or remove items, but you cannot change any settings.</li> </ul>
<p><b>3</b> Extra Rinse</p>	<ul style="list-style-type: none"> <li>• To add additional rinse cycles, press <b>Extra Rinse</b> repeatedly to cycle through the options 1-5, stopping when you reach your desired number.</li> <li>• The display will show the updated cycle time for your selection.</li> </ul>
<p><b>4</b> Soil Level</p>	<ul style="list-style-type: none"> <li>• Press <b>Soil Level</b> repeatedly to cycle through the options <i>Heavy – Med Heavy – Medium – Med Light – Light</i>, stopping when you reach your desired level.</li> <li>• The display will show the updated cycle time for your selection.</li> </ul>

# OPERATING YOUR WASHER

## CONTROL PANEL (cont.)

<b>5</b> Water Level	<ul style="list-style-type: none"><li>• Press <b>Water Level</b> repeatedly to cycle through the options <i>High – Med High – Medium – Med Low – Low</i>, stopping when you reach your desired fill level.</li><li>• The display will show the updated cycle time for your selection.</li></ul>
<b>6</b> Water Temp	<ul style="list-style-type: none"><li>• Press <b>Water Temp</b> repeatedly to cycle through the options <i>Hot – Warm – Cold</i>, stopping when you reach your desired temperature.</li><li>• The display will show the updated cycle time for your selection.</li></ul>
<b>7</b> Delay Start	<ul style="list-style-type: none"><li>• After selecting a cycle and options, press <b>Delay Start</b> repeatedly to cycle through the delay times, stopping when you reach your desired time. Press <b>Start/Pause</b> to confirm your selection and start the delay.</li><li>• During the delay period, the digital display will show the time remaining and only the <b>Delay Start</b> and <b>Power</b> controls will be operational. Press <b>Delay Start</b> during this time to display the selected wash cycle and options for 3 seconds.</li></ul>
<b>8</b> Cycle Selector	<ul style="list-style-type: none"><li>• Turn the <b>Cycle Selector</b> dial to choose your desired wash cycle.</li><li>• The approximate cycle time for each option will show on the display.</li></ul>
<b>9</b> Control Lock	<ul style="list-style-type: none"><li>• To turn the <b>Control Lock</b> on or off, hold <b>Water Temp</b> and <b>Water Level</b> together for 3 seconds.</li><li>• While the <b>Control Lock</b> is active, all controls other than <b>Power</b> will be unavailable and an alarm will sound if the lid is opened during the wash cycle. If the lid is not closed within 5 seconds, the washer will automatically drain.</li></ul>
<b>10</b> Chime	<ul style="list-style-type: none"><li>• To turn the cycle end chime on or off, hold <b>Soil Level</b> and <b>Extra Rinse</b> together for 3 seconds.</li><li>• Error and <b>Control Lock</b> alarms will still sound if triggered.</li></ul>

# OPERATING YOUR WASHER

## CAUTION

- To prevent damage to clothing or appliances, always inspect clothing, including pockets, and remove any loose or hard items and close zippers before washing.
- Do not wash items other than laundry, such as disposable diapers.
- Use only HE (High-Efficiency) detergent to prevent excessive suds, leaks, odours, or cycle interruptions. Using non-HE detergent will void any warranty coverage for suds-related failures or damage.
- Never attempt to open the lid while it is spinning, especially at high speeds. Serious injury or entrapment could result.
- Do not overload the tub. Ensure all laundry is completely inside the tub. Exposed items can cause damage, leaks, or abnormal vibration. For best results, wash large bedding items such as blankets and quilts one at a time.
- The maximum load for this washer is 23 lb (10.5 kg). When washing a load that is close to the maximum, select the **Heavy Duty** cycle and set the **Water Level** to High.
- Failure to closely follow these instructions may cause abnormal vibrations and unbalanced load that could result in physical injury and damage to your appliance and/or property.

## WASHING A LOAD OF LAUNDRY

### STEP 1: PREPARE THE LOAD

1. Inspect all items to be washed:
  - Check pockets and remove loose items (ie. coins, receipts, pins).
  - Fasten buttons and close zippers.
  - Reverse clothing with surfaces that could flake off.
  - Use a brush to remove pet fur, hair, sand, etc.
2. Sort laundry by fabric type, soil level, colour, and special washing instructions. For best results:
  - Wash delicate items such as brassieres, hosiery, and lingerie on the **Delicates** cycle with similar lightweight items.
  - Always use the **Bulky/Bedding** cycle for bedding items. Wash large bedding items such as blankets and quilts one at a time.
  - Add 2-3 towels to improve spin performance when washing large items such as rugs or pillows, or a few smaller items such as stuffed toys or sweaters.
  - When washing heavily soiled loads, fill the tub no more than half full.

# OPERATING YOUR WASHER

3. Fill the tub with dry, unfolded clothes, up to  $\frac{3}{4}$  full. Do not overload the washer as this may reduce washing efficiency and/or cause excess wear, creasing, or wrinkling of the load.

**IMPORTANT:** Ensure all laundry is completely inside the tub. When washing a load that is close to the maximum of 23 lb (10.5 kg), select the **Heavy Duty** cycle and set the **Water Level** to High. Failure to do so can cause abnormal vibration, unbalanced load, injury and/or damage.

## STEP 2: ADD CLEANING PRODUCTS

4. Open the detergent dispenser drawer and add the manufacturer's recommended amount of HE (High-Efficiency) liquid or powder detergent to the detergent compartment (A). Do not exceed the MAX fill line.

**IMPORTANT:** Use only HE (High-Efficiency) detergent to prevent excessive suds, leaks, odours, or cycle interruptions.

**NOTE:** It is normal for a small amount of water to remain in the dispenser compartments at the end of the cycle.

5. If using, add the manufacturer's recommended amount of color-safe, non-chlorine bleach to the same compartment.

**IMPORTANT:** Do not put chlorine bleach in the dispenser drawer.

6. If using, add the manufacturer's recommended amount of liquid fabric softener (if using) to the fabric softener compartment (B). Do not exceed the MAX fill line.
7. Close the dispenser drawer by pushing it slowly and smoothly back into place.

**IMPORTANT:** The detergent dispenser drawer must be in place before you start your washer. Never open the dispenser drawer while the washer is operating.

8. If using, add the manufacturer's recommended amount of liquid chlorine bleach to the bleach compartment (C). Do not exceed the MAX fill line.

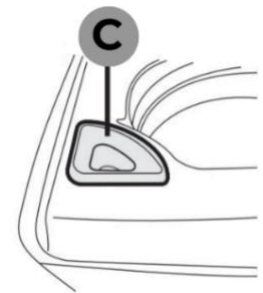
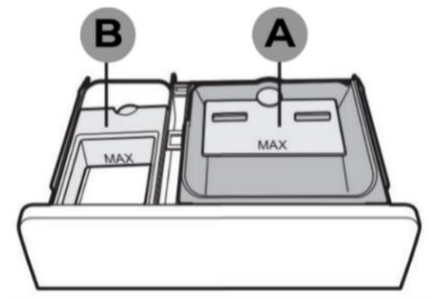

# OPERATING YOUR WASHER

## STEP 3: SELECT WASH CYCLE AND START

9. Close the lid and press **Power** to turn the washer on.
10. Choose the appropriate wash cycle and options for the load (see “Wash Cycles and Options” and “Using Your Control Panel,” above) and press **Start/Pause** to start.
11. When the cycle finishes, the cycle end signal will sound (if enabled) and the washer will turn off. Open the lid and remove your laundry.

**NOTE:** The actual cycle time will vary due to water pressure, temperature, load size, and detergent type as the washer automatically adjusts for optimal performance.

## ADDING AN ITEM MID-CYCLE

For your safety, the washer will lock automatically when the wash cycle begins and remain locked until it ends. To add additional items during the wash cycle, follow these steps:

1. Press **Start/Pause** to pause the cycle.
2. Wait for the tub to come to a complete stop and the lid to unlock automatically. Do not attempt to open the lid before it has unlocked on its own.

**IMPORTANT:** Never attempt to open the lid while it is spinning, especially at high speeds. Serious injury or entrapment could result.

3. Add the item and close the lid.
4. Press **Start/Pause** to resume the cycle.

# USER-MAINTENANCE INSTRUCTIONS

## CAUTION

- Unplug the washer and turn off the hot and cold water supplies when not in use to prevent the possibility of damage from escaping water.
- To avoid damage to internal or external components, do not use abrasive or harsh cleansers, solvent-based cleaning agents, flammable fluids, hard brushes, or scouring pads on any part of the washer.
- To prevent damage to the washer or control panel finishes, apply spray-on laundry pre-treatment and stain remover products away from the washer and wipe up any spills or overspray immediately.
- Leave the washer lid open between uses to let the inside dry completely.
- Never use the **Clean Washer** cycle with laundry in the tub. Doing so could result in damage to the laundry or the washer.
- Certain internal parts are intentionally not grounded and may present a risk of electric shock only during servicing. Service Personnel: Do not contact the following parts while the appliance is energized: Electrical Valve, Main Control Box and Capacitor.

## CLEANING THE EXTERIOR

1. Use a soft, damp cloth to wipe up detergent, bleach, or other spills on the top or sides of the washer as they occur.
2. Regularly wipe dust or hard water residue from the top and sides of the washer with a soft, damp cloth and dry thoroughly.
3. Clean the control panel regularly with a soft, damp cloth. Do not use abrasive powders or cleaning pads. Do not spray cleaners directly on the control panel.

## CLEANING THE INTERIOR

**NOTE:** Use the correct amount of detergent, fabric softener, and bleach and wipe out the drawer after every 2-3 washes to prevent excess product buildup.

1. Use a soft cloth to wipe any residue from the tub after each use.
2. Once a month, run a **Clean Washer** cycle with the tub empty to remove any causes of odors inside the washer. Do not add detergent.

# USER-MAINTENANCE INSTRUCTIONS

## CLEANING THE AUTOMATIC DISPENSERS

1. Use a soft, damp cloth to wipe any residue out of the bleach compartment.
2. Remove the detergent dispenser drawer: Pull the drawer out as far as it goes, then tilt it slightly upwards while pulling to release it.
3. Wash the dispenser drawer in warm, soapy water, using a soft-bristle brush or toothbrush if needed to remove stubborn buildup. Rinse under running water and dry completely.
4. Push the dispenser drawer straight back in to reinstall and run an empty rinse cycle to flush out any remaining debris.

## CLEANING THE INNER TUB FILTER

1. Rotate and lift off the agitator cap, then unscrew the inner tub filter by turning it clockwise and remove (A).
2. Remove lint and debris from the surface of the filter and discard (B).
3. Rinse the filter thoroughly in clean water (C).
4. Reinstall the filter and replace the agitator cap (D).

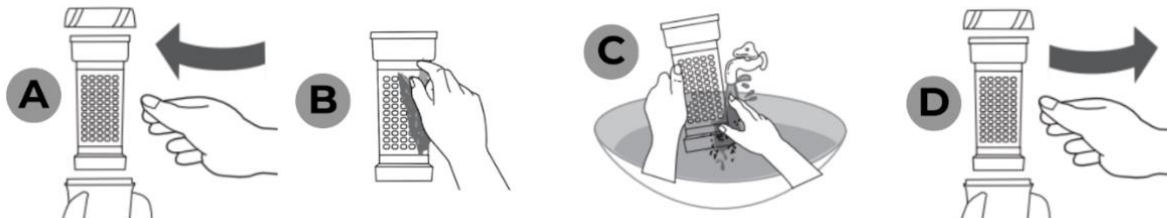

## CLEANING THE WATER INLETS

1. Unplug the washer and turn off the hot and cold water supplies.
2. Disconnect the hoses from the hot and cold water inlets on the back of the washer (A).
3. Use pliers to remove the filter screens from the inlets (B).
4. Submerge the filter screens (including the threaded connectors) deeply in water and swish around to remove any residue.
5. Reinsert the filter screens and reconnect the hoses to their corresponding inlets. Tighten the hose fittings by hand until snug and then tighten them an additional two-thirds of a turn with pliers.
6. Turn on the hot and cold water supplies and check all connections for leaks.

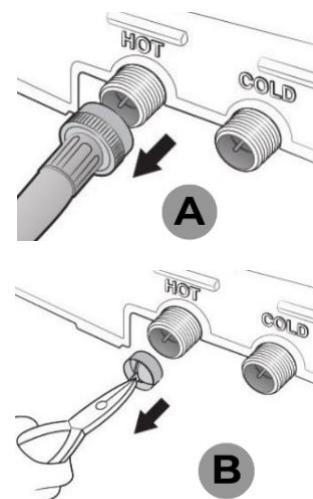

# TROUBLESHOOTING

If your appliance is not working normally, you may be able to avoid the cost of a service call by checking the following list of common problems:

Problem	Possible Causes and Solutions
Wash cycle does not start.	Check if the washer is plugged in and there is not a power failure.
	Make sure the outlet is not defective and the voltage is not too low. Defective outlets must be repaired by an electrician.
	Check the fuses and circuit breakers. Replace the fuse or reset the circuit breaker if needed. If the problem persists, contact an electrician.
	Make sure the hot and cold water supplies are turned on and the water supply hoses are properly connected.
	Make sure the washer lid is closed properly.
	Check if you have pressed the <b>Start/Pause</b> button after choosing the wash cycle.
	Check if the <b>Control Lock</b> is activated and deactivate it if needed.
	Before the washer starts to fill, you will hear a series of clicking noises as the washer makes sure the lid is locked and does a quick drain. This is part of normal operation.
	Make sure that the <b>Delay Start</b> option is not turned on and turn it off if needed.
No water or not enough water.	Check the plug, outlet, fuses, circuit breakers, and power supply as above to make sure there is power to the washer.
	Make sure the hot and cold water supplies are turned on and the water supply hoses are properly connected.
	Make sure the water supply to the residence is on and water pressure is adequate.
	Check if the water supply hoses are kinked and straighten if needed.
	Disconnect the hoses and check the water inlet filter screens and remove any debris that might be clogging them.
	Make sure you have deactivated the <b>Control Lock</b> and pressed <b>Start/Pause</b> as above.
Excessive vibration or noise during operation.	Check if the washer is level and adjust leveling feet if necessary.
	Check if the washer is touching other objects or appliances and correct if needed.
	Make sure the laundry load is evenly distributed in the tub. If the washer detects an imbalance during the spin process, it will automatically try to redistribute the load. If the imbalance is not corrected after three attempts, the washer will stop and you will need to manually redistribute the clothing.

# TROUBLESHOOTING

Problem	Possible Causes and Solutions
Washer stops during cycle.	Check the plug, outlet, fuses, circuit breakers, and power supply as above to make sure there is power to the washer.
	For your safety, the washer will not spin unless the lid is closed and locked. Make sure the washer lid is closed properly and press <b>Start/Pause</b> to resume operation.
	Before the washer starts to fill, you will hear a series of clicking noises as the washer makes sure the lid is locked and does a quick drain. This is part of normal operation.
	Sometimes your washer will pause between stages in the cycle. This is part of normal operation. Wait to see if it starts again.
	Disconnect the hoses and check the water inlet filter screens and remove any debris that might be clogging them.
Washer does not spin or spin cycle stops.	Check the plug, outlet, fuses, circuit breakers, and power supply as above to make sure there is power to the washer.
	For your safety, the washer will not spin unless the lid is closed and locked. Make sure the washer lid is closed properly and press <b>Start/Pause</b> resume operation.
	Check if the washer is level and adjust leveling feet if necessary.
	Make sure the laundry load is balanced (evenly distributed in the tub).
Washer does not start draining or does not drain completely.	Check the plug, outlet, fuses, circuit breakers, and power supply as above to make sure there is power to the washer.
	Check that the height of the drain hose is within specified limits and correct if necessary.
	Make sure the drain hose is not kinked and straighten if necessary.
	Disconnect the drain hose and ensure that it is not clogged by debris.
	Check your residence's drainpipes. If the sewer system servicing your residence is clogged, you will need to contact a qualified plumber or repair professional.

# ERROR CODES

If your appliance is not working normally and is displaying an error code, you may be able to avoid the cost of a service call by consulting the following table:

Code	Cause	Possible Solution
E0	The faucet is not turned on or the water pressure is abnormal.	Restore normal water pressure and restart.
	The water intake exceeds 30 minutes.	Restore normal water pressure and restart or replace the water inlet valve and restart.
	The water inlet valve is faulty.	Replace the water inlet valve and restart.
E1	Drainage time exceeds 20 minutes without reaching the reset water level.	Press <b>Start/Pause</b> to restart or power off.
E2	The cover is opened during operation.	Close the cover or turn off the power.
E3	Three attempts to correct an unbalanced load have failed.	Press <b>Start/Pause</b> , open the washer lid, redistribute the load evenly, and resume.
E4	Water level is above the high water alarm limit.	Normal operation will resume once the water has drained to below the alarm limit. If the problem persists, contact Kenmore Customer Assistance.
	Water level is below the low water limit.	Refer to the "No water or not enough water," section in Troubleshooting, above. If the problem persists, contact Kenmore Customer Assistance.
	Water level sensor is faulty.	Contact Kenmore Customer Assistance.
E5	Lid has been opened while the <b>Control Lock</b> is active.	Close the lid within 5 seconds. If more than 5 seconds has elapsed, press and hold the <b>Water Temp</b> and <b>Water Level</b> buttons together for 3 seconds to deactivate the <b>Control Lock</b> .
E7	Door lock does not latch properly and cycles repeatedly.	Press <b>Start/Pause</b> to restart or power off. If the problem persists, contact Kenmore Customer Assistance.
E8	Fuzzy logic value (load sensor) is not in the valid range.	Contact Kenmore Customer Assistance.
	Fuzzy logic circuit is faulty.	Contact Kenmore Customer Assistance.
	Belt tension is abnormal.	Contact Kenmore Customer Assistance.
E9	Water level sensor is faulty, allowing water to reach the overflow level.	Contact Kenmore Customer Assistance.
	Computer board is faulty.	Contact Kenmore Customer Assistance.
E10	Hall sensor anomaly.	Open the lid, redistribute the clothes, and restart. If draining is abnormal, refer to the "Washer does not start draining or does not drain completely," section in Troubleshooting, above. If the problem persists, contact Kenmore Customer Assistance.
E11	Communication failure.	Contact Kenmore Customer Assistance.
Ea	The computer board is damaged.	Contact Kenmore Customer Assistance.
Eb	Motor overheat protection or motor failure.	Contact Kenmore Customer Assistance.

# WARRANTY

**1** Year  
Limited Warranty

FOR ONE YEAR from the date of sale this product is warranted against defects in material or workmanship.

WITH PROOF OF SALE a defective product will be repaired or replaced free of charge.

Direct all claims for warranty service to Kenmore Customer Assistance, call 1-800-265-8456 or email [KenmoreCustomerCare@KC.com](mailto:KenmoreCustomerCare@KC.com)

This warranty covers manufacturer's defects including electrical and mechanical defects provided the appliance is correctly assembled, operated and maintained according to the supplied instructions. It does not cover damage caused by accident, misuse or abuse including overheating, unauthorized repairs or alterations, or use with a voltage converter or aftermarket accessories, and it does not apply to scratches, stains, discoloration or other surface damage that does not impair the product function. This warranty is void if the appliance is ever used for purposes other than private household use.

Koolatron Corporation  
4320 Federal Drive, Batavia, NY 14020 U.S.A.  
139 Copernicus Blvd., Brantford, ON N3P 1N4 Canada

Kenmore and the Kenmore logo are registered trademarks to Transform SR Brands LLC and are used under license by Koolatron Corporation