

WARRANTY

Koolatron Corporation warrants that this product will be free from defects in materials or workmanship under normal household use for a period of 1 year from the date of retail purchase. During this time, defective products will be repaired or replaced at the discretion of the retailer and/or Koolatron Corporation.

This warranty covers normal household usage and does not cover damage which occurs in shipment or results from accident, misuse or abuse, unauthorized repair or alteration, improper maintenance, commercial use, or use with a voltage converter or aftermarket accessories. A Koolatron Master Service Centre must perform all warranty work.

WARRANTY AND SERVICE PROCEDURE

Keep your original, dated, sales receipt with this manual. If this product proves to be defective within the warranty period, please contact Koolatron Corporation at 1-800-265-8456 (North America) or email service@koolatron.com for assistance.



www.koolatron.com

TOTAL Chef

0.9 cu.ft. / 23L Microwave Oven



TCMO-09-SS
User Manual

IMPORTANT SAFEGUARDS

TO AVOID POSSIBLE EXPOSURE TO EXCESSIVE MICROWAVE ENERGY

1. Do not attempt to operate this oven with the door open since open-door operation can result in harmful exposure to microwave energy. It is important not to defeat or tamper with the safety interlocks.
2. Do not place any object between the oven front face and the door or allow soil or cleaner residue to accumulate on sealing surfaces.
3. Do not operate the oven if it is damaged. It is very important that the oven door close properly and that there is no damage to the
 - a) Door (including any bents),
 - b) Hinges and latches (broken or loosened),
 - c) Door seals and sealing surfaces.
4. The oven should not be adjusted or repaired by anyone except qualified service personnel.

A SPECIAL NOTE ON ARCING

"Arcing" refers to the presence of sparks inside the microwave oven. It can be caused by:

- Metal or foil touching the inside walls of the oven.
- Foil not closely molded to food, where edges have been left sticking up.
- Small metal parts such as twist-ties, poultry pins, or gold-rimmed dishes.
- Recycled paper towels which may contain small amounts of metal.



CAUTION

If you see sparks in your Microwave Oven, immediately turn timer to OFF, cease cooking and correct the problem.

WARNING! When using electrical appliances, basic safety precautions should be followed, including the following. To reduce the risk of burns, electric shock, fire, injury to persons or exposure to excessive microwave energy:

1. Read all instructions before using the appliance.
2. Read and follow the specific "TO AVOID POSSIBLE EXPOSURE TO EXCESSIVE MICROWAVE ENERGY" above.
3. This appliance must be grounded. Connect only to properly grounded outlet. See "GROUNDING INSTRUCTIONS" on page 4.
4. Install or position this appliance only in accordance with the provided installation instructions.
5. Do not operate the oven when empty.
6. Some products such as whole eggs and sealed containers - for example, closed glass jars- are able to explode and should not be heated in this oven.

IMPORTANT SAFEGUARDS

7. Use this appliance only for its intended use as described in this manual. Do not use corrosive chemicals or vapors in this appliance. This type of oven is specifically designed to heat, cook, or dry food. It is not designed for industrial or laboratory use.
8. HOT CONTENTS CAN CAUSE SEVERE BURNS. DO NOT ALLOW CHILDREN TO USE THE MICROWAVE. Use caution when removing hot items.
9. To reduce the risk of fire in the oven cavity:
 - a) Do not overcook food. Carefully attend appliance when paper, plastic, or other combustible materials are placed inside the oven to facilitate cooking.
 - b) Remove wire twist-ties from paper or plastic bags before placing bag in oven.
 - c) If materials inside the oven should ignite, keep oven door closed, turn oven off, and disconnect the power cord or shut off power at the fuse or circuit breaker panel.
 - d) Do not use the cavity for storage purposes. Do not leave paper products, cooking utensils or food in the cavity when not in use.
10. Liquids, such as water, coffee, or tea are able to be overheated beyond the boiling point without appearing to be boiling due to surface tension of the liquid. Visible bubbling or boiling when the container is removed from the microwave oven is not always present. **THIS COULD RESULT IN VERY HOT LIQUIDS SUDDENLY BOILING OVER WHEN A SPOON OR OTHER UTENSIL IS INSERTED INTO THE LIQUID.** To reduce the risk of injury to person:
 - a) Do not overheat the liquid.
 - b) Stir the liquid both before and halfway through heating it.
 - c) Do not use straight-sided containers with narrow necks.
 - d) After heating, allow the container to stand in the microwave oven for a short time before removing the container.
 - e) Use extreme care when inserting a spoon or other utensil into the container.
11. Do not heat oil or fat for deep-frying. It is difficult to control the temperature of oil in microwave oven.
12. Foods with heavy skins such as potatoes, whole squash, apples and chestnuts should be pierced with a fork or the tip of a sharp knife before cooking.
13. Do not cover or block any openings on the appliance.
14. Do not store or use this appliance outdoors. Do not use this product near water, for example, near a kitchen sink, in a wet basement, near a swimming pool, or similar locations.
15. Do not operate this appliance if it has a damaged cord or a plug, if it is not working properly or if it has been damaged or dropped.
16. Do not immerse cord or plug in water. Keep cord away from heated surface. Do not let cord hang over edge of table or counter.
17. This appliance should be serviced only by qualified service personnel, contact nearest authorized service facility for examination, repair, or adjustment.

IMPORTANT SAFEGUARDS

18. When cleaning surfaces of door and oven that comes together on closing the door, use only mild, nonabrasive soaps, or detergents applied with a sponge or soft cloth.

19. This equipment has been tested and found to comply with Part 18 of the FCC Rules. Operation is subject to the following two conditions: (1) This device may not cause harmful interference, and (2) this device must accept any interference received, including interference that may cause undesired operation (only for USA).



CAUTION

Changes or modifications not expressly approved by the party responsible for compliance could void the user's authority to operate the product.

20. This equipment generates, uses and can radiate radio frequency energy and, if not installed and used in accordance with the instructions, may cause harmful interference to radio communications. However, there is no guarantee that interference will not occur in a particular installation. If this equipment does cause harmful interference to radio or television reception, which can be determined by turning the equipment off and on, the user is encouraged to try to correct the interference by one or more of the following measures:

- Reorient or relocate the receiving antenna.
- Increase the separation between the equipment and receiver.
- Connect the equipment into an outlet on a circuit different from that to which the receiver is connected.
- Consult the dealer or an experienced radio/TV technician for help.

If this product is not maintained in a good state of cleanliness, its surface could degrade.

This could affect the lifespan of the product and lead to a dangerous situation.

GROUNDING INSTRUCTIONS

This appliance must be grounded. In the event of an electrical short circuit, grounding reduces risk of electric shock by providing an escape wire for the electric current. This appliance is equipped with a cord having a grounding wire with a grounding plug. The plug must be plugged into an outlet that is properly installed and grounded.



WARNING!

Improper use of the grounding plug can result in a risk of electric shock.

IMPORTANT SAFEGUARDS

Consult a qualified electrician or serviceman if the grounding instructions are not completely understood, or if doubt exists as to whether the appliance is properly grounded, and if it is necessary to use an extension cord, use only a 3-wire extension cord that has a 3-blade grounding plug and a 3-slot receptacle that will accept the plug on the appliance. The marked rating of the extension cord shall be equal to or greater than the electrical rating of the appliance.

ELECTRICAL REQUIREMENTS

The electrical requirements are a 120VAC, 60 Hz, 20 amp. It is recommended that a separate circuit serving only the oven be provided. The oven is equipped with a 3-prong grounding plug. It must be plugged into a wall outlet properly installed and grounded.

POWER CORD

1. A short power supply cord is provided to reduce the risks resulting from becoming entangled in or tripping over a longer cord.
2. If the power supply cord is too short, do not use an extension cord. Have a qualified electrician or serviceman install an outlet near the appliance.
3. If it is absolutely necessary to use longer cord sets or an extension cord, extreme care must be exercised.
 - a) Use only a grounding type 3-wire extension cord that has a 3-blade grounding plug and a 3-slot receptacle that will accept the plug on the appliance.
 - b) The marked electrical rating of the cord set or extension cord must be equal to or greater than the electrical rating of the appliance. The longer cord should be arranged so that it will not drape over the counter top or table top where it can be pulled on by children or tripped over unintentionally.

SAVE THESE INSTRUCTIONS



WARNING! This product contains chemicals known to the State of California to cause cancer, and birth defects or other reproductive harm.
www.P65Warnings.ca.gov

INSTALLATION GUIDE

1. Make sure that all the packing materials are removed from the inside of the door.
2. **WARNING!** Check the oven for any damage, such as misaligned or bent door, damaged door seals and sealing surface, broken or loose door hinges and latches and dents inside the cavity or on the door. If there is any damage, do not operate the oven and contact qualified service personnel.
3. This microwave oven must be placed on a flat, stable surface to hold its weight and the heaviest food likely to be cooked in the oven.
4. DO NOT place the oven where heat, moisture, or high humidity are generated, or near combustible materials.
5. For correct operation, the oven must have sufficient airflow. Allow 20 cm of space above the oven, 10 cm at back and 5 cm at both sides. DO NOT cover or block any openings on the appliance. DO NOT remove feet.
6. DO NOT operate the oven without glass tray, roller support, and shaft in their proper positions.
7. Make sure that the power supply cord is undamaged and does not run under the oven or over any hot or sharp surface.
8. The socket must be readily accessible so that it can be easily unplugged in an emergency.
9. DO NOT use the oven outdoors.

BEFORE CALLING FOR SERVICE

Before asking for service, please check each item below:

- Check to ensure the oven is plugged in securely. If not, remove the plug from the outlet, wait 10 seconds, and plug it in again securely.
- Check for a blown circuit fuse or a tripped main circuit breaker. If these seem to be operating properly, test the outlet with another appliance.
- Check to ensure the control panel is programmed correctly and the timer is set.
- Check to ensure the door is securely closed, engaging the door lock system. If the door is not properly closed, the microwave energy will not flow inside.

IF NONE OF THE ABOVE RECTIFIES THE SITUATION, THEN CONTACT A QUALIFIED TECHNICIAN. DO NOT TRY TO ADJUST OR REPAIR THE OVEN YOURSELF.

COOKING TECHNIQUES

1. For even heating, arrange food with thickest areas towards the outside of the dish.
2. Cook for the shortest amount of time indicated by the recipe and add more time as needed. Food that is severely overcooked can smoke or ignite.
3. Cover foods while cooking to prevent spattering and help foods cook evenly.
4. Turn foods such as chicken and hamburgers once halfway through cooking to speed cooking. Turn larger foods such as roasts at least once.
5. Rearrange foods such as meatballs halfway through cooking both from top to bottom and from the center of the dish to the outside.
6. Use round or oval dishes, when possible, rather than square/rectangular dishes, as food in corners tends to overcook.

CHOOSING COOKWARE

The table below is a general guide to which types of cookware and utensils are suited to microwave cooking and which should not be used.

Cookware Type	Microwave Use	Notes
Microwave browning dishes	Yes	Follow the directions provided with the dish.
Glass and glass-ceramic dishes	Limited	Use only if labeled "heat-resistant" or "microwave-safe." Do not use dishes with metallic trim.
Ceramic, porcelain and stoneware	Limited	Use only if labeled "heat-resistant" or "microwave-safe." Do not use dishes with metallic trim.
Glass jars and bottles	No	Can shatter and cause damage and/or injury.
Microwaveable plastic wrap	Yes	Leave a small opening for some steam to escape and avoid placing directly on food.
Paper towels, napkins and wax paper	Limited	Do not use recycled paper, which may contain tiny metal fragments and could ignite.
Paper plates and cups	Limited	Use for short-term heating at low power. Do not use recycled paper, which may contain metal and could ignite.
Paper bags	No	These are a fire hazard, except for popcorn bags that are designed for microwave use.
Styrofoam plates, cups and containers	No	These can melt and leave an unhealthy residue on food.
Plastic dishes and containers	Limited	Use only if labeled "heat-resistant" or "microwave-safe." Re-used food containers such as margarine tubs can melt in the microwave.
Metal dishes, trays, racks and utensils	No	These do not microwave effectively and can spark and damage your oven.
Foil dishes and containers	No	These do not microwave effectively and can spark and damage your oven.
Aluminum foil	Limited	Flat, narrow strips of foil can be used to prevent overcooking of exposed areas. Leave at least 1 in (2.54 cm) between the foil and the oven wall. Do not use foil that is folded or crumpled as it can spark and cause damage.
Thermometers	Limited	Use only if labeled "microwave-safe" and follow the directions provided. Check the food in several spots.

PARTS & FEATURES

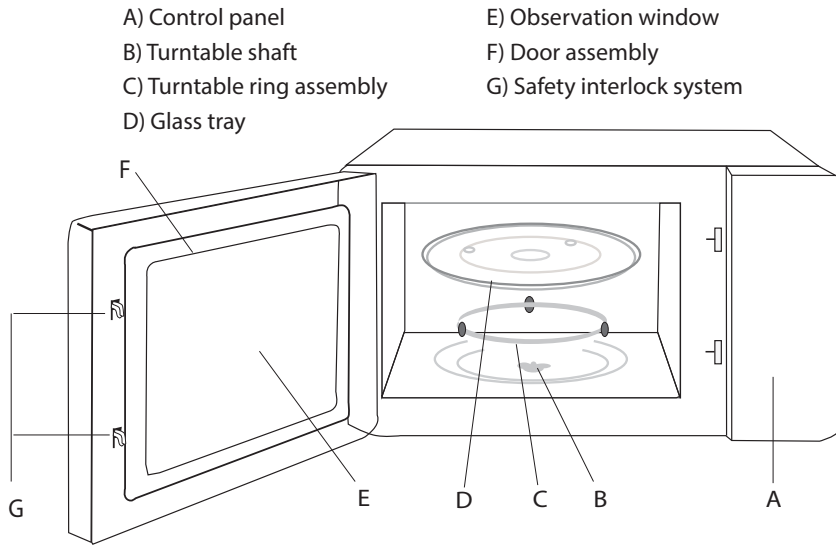

NOTE - Do not remove the mica plate covering the wave guide in the oven cavity.

- A. Never place the glass tray upside down. The glass tray should never be restricted.
- B. Both glass tray and turntable ring assembly must always be used during cooking.
- C. All food and containers of food are always placed on the glass tray for cooking.
- D. If glass tray or turntable ring assembly cracks or breaks, contact your nearest authorized service center.

TECHNICAL INFO

Power Consumption	120V ~ 60Hz, 1400W (microwave)
Output	900W
Operation Frequency	2450MHz
Outside Dimensions (H x W x D)	10.75" x 19" x 13.5"
Oven Capacity	0.9 cu.ft.
Net Weight	Approx. 25.1lbs

CONTROL PANEL

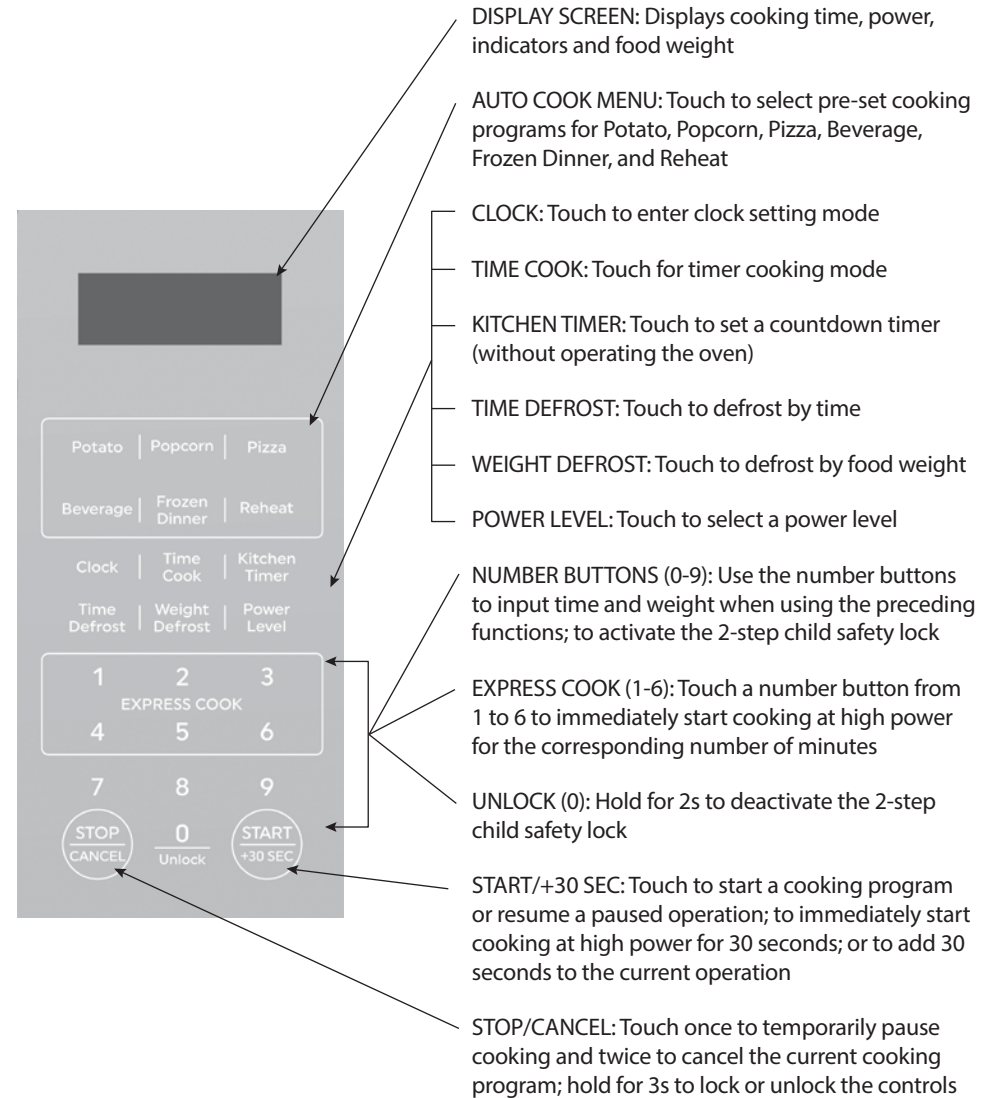

OPERATION INSTRUCTIONS

GENERAL INFORMATION

- When the oven is first plugged in, a beep will sound and the display screen will show "1:01".
- During setting, if there is no input or operation for 30 seconds, the system will return to standby mode.
- To pause cooking at any time, touch STOP/CANCEL once and touch START/+30 SEC to resume the operation. To cancel a cooking operation, touch STOP/CANCEL twice.
- After cooking ends, the display screen will show "End" and a beep will sound every two minutes until you touch STOP/CANCEL or open the door.
- In the process of operation, when touching a valid button, one beep will sound, but if an invalid button is touched, two beeps will sound.

2-STEP CHILD SAFETY LOCK

The Total Chef microwave is equipped with an electromagnetic safety lock that requires a 2-step process to open the oven door to protect children from being injured by hot food. The safety lock automatically engages during cooking and remains active for 30 minutes after cooking.

When the safety lock is engaged, you must press and hold the UNLOCK button for 2 seconds before you can open the door. If you do not open the door within 10 seconds of unlocking it, the safety lock will reactivate. After cooking ends, the display screen will show "Loc" every 5 seconds and the safety lock will remain engaged until the door is opened. If the door is not opened, the lock will automatically disengage after 30 minutes.

In standby mode, the oven door can be opened and closed normally. To manually engage the safety lock in standby mode, press the 7 and 9 buttons together. The display screen will show "Loc" and the safety lock will be activated. To deactivate it, press and hold the UNLOCK button for 2 seconds.

SETTING CLOCK TIME

This is a 12- or 24- hour clock. You can choose to set the clock time in 12- or 24- hour cycle by pressing CLOCK button in standby mode.

1. In standby mode, press CLOCK button repeatedly to select 12- or 24- hour clock.
2. Use number buttons to set the correct time.
3. Press CLOCK or START/+30 SEC. button once to confirm.

NOTE - During cooking, you can check the current clock time by pressing CLOCK button.

SETTING KITCHEN TIMER

1. In standby mode, touch KITCHEN TIMER once.
2. Use the number buttons to enter a time up to 99 minutes and 99 seconds.
3. Press START/+30 SEC. button to confirm.

NOTE - When the countdown ends, the buzzer will beep to remind you. You can check the countdown time by pressing KITCHEN TIMER button, if press STOP/CANCEL button when the display shows the time, the function can be cancelled.

OPERATION INSTRUCTIONS

TIMER COOKING

1. In standby mode, touch TIME COOK once.
2. Use the number buttons to enter a time up to 99 minutes and 99 seconds.
3. Touch POWER LEVEL to select your desired power level.
4. Touch START/+30 SEC to start.

NOTE - During cooking, you can check the power level by touching the POWER LEVEL button.

Touch POWER button	Cooking power (Display)	Touch POWER button	Cooking power (Display)
Once	100% (P100)	7 times	40% (P-40)
Twice	90% (P-90)	8 times	30% (P-30)
3 times	80% (P-80)	9 times	20% (P-20)
4 times	70% (P-70)	10 times	10% (P-10)
5 times	60% (P-60)	11 times	0% (P-00)
6 times	50% (P-50)		

DEFROST BY TIME

1. In standby mode, touch TIME DEFROST once.
2. Use the number buttons to enter a time up to 99 minutes and 99 seconds.
3. Touch START/+30 SEC to start.

NOTE - During defrosting, the system will pause and sound to remind user to turn food over, after that press START/+30 SEC. button to resume defrosting.

DEFROST BY WEIGHT

1. In standby mode, touch WEIGHT DEFROST once.
2. Use the number buttons to enter the weight of the frozen food from 4 to 64 oz.
3. Touch START/+30 SEC to start.

NOTE - During defrosting, the system will pause and sound to remind you to turn food over, after that press START/+30 SEC. button to resume defrosting.

EXPRESS COOK

In standby mode, touch a number button from 1 to 6 to immediately start cooking at 100% power for the corresponding number of minutes (1 for 1 minute, 2 for 2 minutes, etc).

ADD 30 SECONDS

1. In standby mode, touch START/+30 SEC to immediately start cooking at 100% power for 30 seconds. Touch the button again to increase the cooking time by another 30 seconds with each touch up to a maximum of 99 minutes and 99 seconds.
2. During Express Cooking and Timer Cooking operations, touch START/+30 SEC at any time to increase the remaining time by 30 seconds.

OPERATION INSTRUCTIONS

MULTI-STAGE COOKING

Your oven can be programmed to automatically carry out up to 3 microwave cooking sequences one after another without stopping. For example, you could program it to cook for several minutes at a high power and then reduce power to low for another set period of time. To program a multi-stage cooking sequence:

1. Follow steps 1-4 under TIMER COOKING to select the power level and time for the first stage, but do not press START/+30 SEC.
2. Repeat the same steps to select the power level and time for up to two more stages.
3. Touch START/+30 SEC to confirm and start the program.

NOTE - Multi-stage cooking can only be used with regular microwave cooking. It is not compatible with speed defrost, weight defrost or auto cook.

AUTO COOK

The auto cook menu is programmed with automatic cooking times and power levels for commonly microwaved foods. To run an auto cooking program:

1. In standby mode, touch the button for your desired food as many times as needed to select the appropriate weight or number of servings.
2. Touch START/+30 SEC to confirm and start the program.

Function	Options	Food	Weight/Amount Options
Potato	1 serving (8 oz), 2 servings (16 oz),	Beverage	1 cup (8 oz), 2 cups (16 oz), 3 cups (24 oz)
Popcorn	3.5 oz	Frozen Dinner	9 oz, 18 oz
Pizza	6 oz, 11 oz, 16 oz	Reheat	7 oz - 28 oz

NOTE - Auto cooking results will be affected by factors such as the size and shape of the food, how the food is arranged in the oven, and your personal preferences. If the results of any program are not satisfactory, please adjust the cooking time accordingly.

CONTROL LOCK

The control lock is used to prevent unsupervised operation of the microwave oven by children while the oven is in standby mode.

1. To activate the control lock, press and hold STOP/CANCEL for 3 seconds. The oven will beep and the display will show “- - -” for 5 seconds to indicate that the controls are now locked.
2. If a button is pressed while the controls are locked, the button will not work and the display will show “- - -” again.
3. Press and hold STOP/CANCEL for 3 seconds to unlock the controls.

NOTE - The control lock is different from the 2-step child safety lock, which prevents unauthorized opening of the oven door while it contains hot food.

OPERATION INSTRUCTIONS

BUTTON ADHESION PROTECTION

If at any time a button on the control panel is held or gets stuck for 1 minute, any program that is running will immediately stop, the microwave oven will beep and the display will show “FAIL.” If the button remains stuck, the oven will continue to beep once every minute and all controls will be inoperational. After troubleshooting to unstick the button, press STOP/CANCEL to return to standby mode.

