

# ARVI

## dresser/night stand

- steps -

### Anti tipping restraint instructions

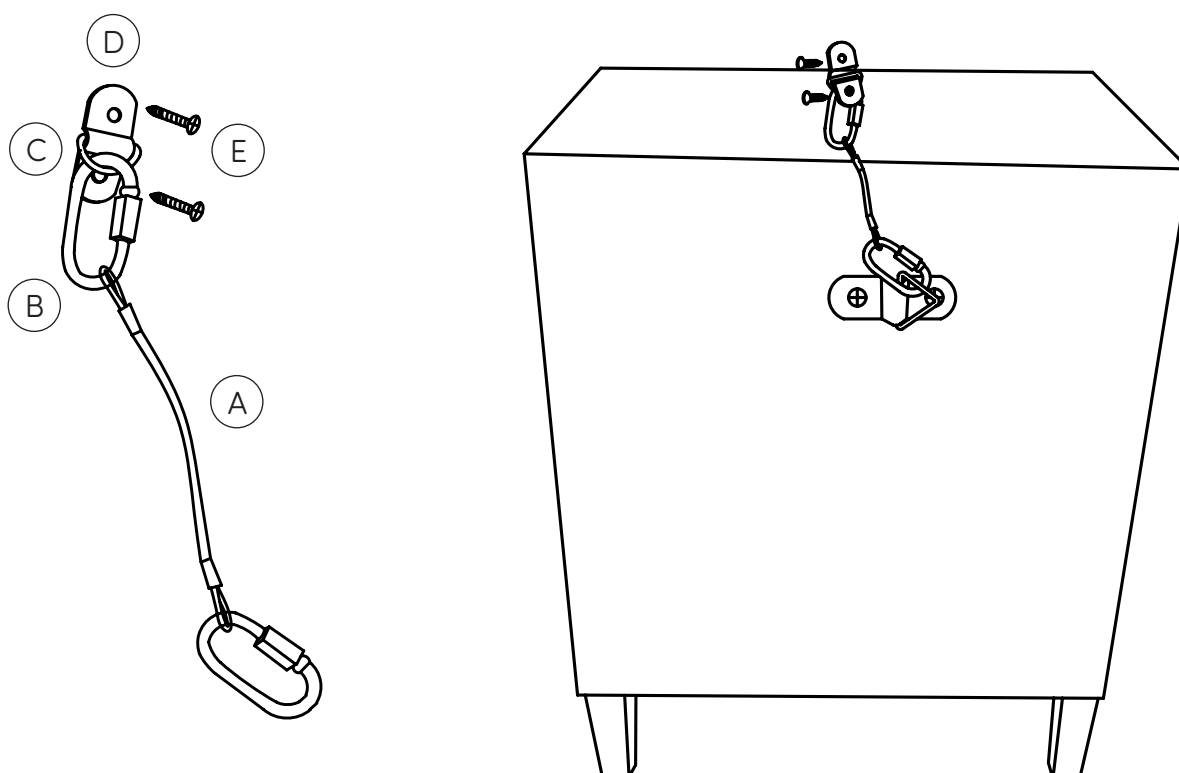

- Pre-fixed wall straps have been provided for your safety and we recommend that once position the unit is secured using these.
- When drilling into walls, always check there are no hidden wires or pipes etc. Put pull ring (C) into wall bracket (D)
- Position the bracket on your wall and mark the holes to be drilled. We recommend the bracket is fitted just below the top of your unit so that it is not visible when the unit is in place.
- Attach bracket (D) with pull ring (C) in place, using screws and wall plugs.
- Attach the strap (A) to the back of the unit using the hoop (B). Ensure the hoop (B) is locked.
- Carefully lift the unit into place and attach the free end of strap (A) to pull ring (C) on the wall, using the hoop (B) and lock it.
- Check to make sure all parts are secure and carefully move unit into position.