

Exploded Diagram for Series 724 (packed) and 4724 (mechanical seal), Sizes H, HL, K, KK, L, LQ & LL

NOTE: Kit may not apply to all models of these pumps. Contact your Viking Pump distributor with pump serial number for correct kit part numbers for that pump. Both a Seal Kit and a Rebuild Kit are needed to completely rebuild the pump. Additional non-kit parts, such as Rotor and Shaft Assembly, may also be required, depending on wear.

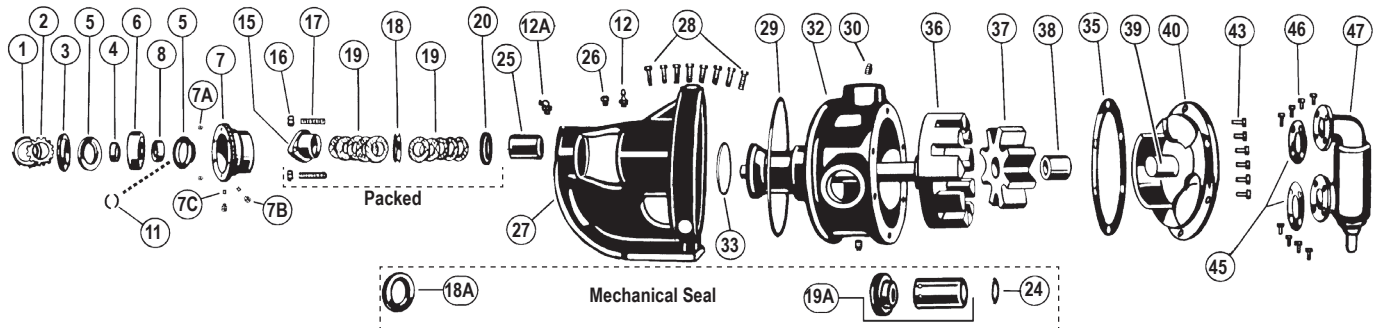

ITEM	PART (may not exactly match parts list descriptions)	PART INCLUDED IN:		
		724 SERIES (PACKED) SEAL KIT	4724 SERIES (SEALED) SEAL KIT	REBUILD KIT
1	Locknut	✓	✓	
2	Lockwasher	✓	✓	
3	End Cap for Bearing Housing			
5	Lip Seal for Bearing Housing (2 Req'd)	✓	✓	
4	Bearing Spacer Collar (Outer)	✓	✓	
6	Ball Bearing	✓	✓	
8	Bearing Spacer Collar (Inner)	✓	✓	
11	Ring, Half Round, 2-Req'd (Except H, HL)	✓	✓	
7	Bearing Housing			
7A	Setscrews for Bearing Housing (2-Req'd)	✓	✓	
7B	Setscrews for End Cap (2-Req'd)	✓	✓	
7C	Nylon Slug (2-Req'd)	✓	✓	
15	Packing Gland (724 only)			
16	Packing Gland Nut (2-Req'd) (724 only)	✓		
17	Packing Gland Stud (2-Req'd) (724 only)	✓		
19	Packing (724 only)	✓		
18	Lantern Ring (724 only)	✓		
20	Packing Retainer Washer (724 only)	✓		
19A	Mechanical Seal (4724 only) ②		✓	
18A	Lipseal for seal chamber (4724 only)		✓	
24	Seal Spacer (used on K size with PTFE seal only)		✓	

ITEM	PART (may not exactly match parts list descriptions)	PART INCLUDED IN:		
		724 SERIES (PACKED) SEAL KIT	4724 SERIES (SEALED) SEAL KIT	REBUILD KIT
25	Casing Bushing (part of 24)			✓
12A	Grease Fitting (Angle)			
26	Pressure Relief Plug			
12	Grease Fitting (Straight)			
27	Bracket			
28	Capscrews for Bracket ①			
33	O-Ring for Casing Stem	✓	✓	
29	O-Ring for Bracket	✓	✓	
32	Casing and Bushing Assembly (tapped or flanged)			
30	Pipe Plug (2-Req'd)			
36	Rotor and Shaft Assembly			
37	Idler and Bushing Assembly			✓
38	Idler Bushing (part of 27)			
35	Head Gasket	✓	✓	
39	Idler Pin (part of 40)			
40	Head and Idler Pin Assembly			✓
43	Capscrews for Head ①			✓
45	Gaskets for Relief Valve	✓	✓	
46	Capscrew for Relief Valve ①			✓
47	Relief Valve			

① Quantity of Capscrews depend on pump size.

② Mechanical seal elastomers in this kit are specified in seal kit description.

Kits include parts for Relief Valve head. Plain Head pumps will not need Relief Valve gaskets or capscrews. Discard extra parts.

Use Seal Lubricant in Seal Kit for installing mechanical seal and O-rings.

Important safety information and rebuild instructions are found in the Technical Service Manual.

Download current Technical Service Manuals from www.vikingpump.com:

TSM 000 - Installation, Startup, Troubleshooting,
Preventative Maintenance, Do's & Don'ts

TSM 212 - Heavy Duty Stainless Steel Pumps,
Series 724 and 4724, Sizes H-LL