

Exploded Diagram for Series 32 (packed) and 432 (mechanical seal), Size G
Includes 432-X Models (UL Listed for Fuel Oil)

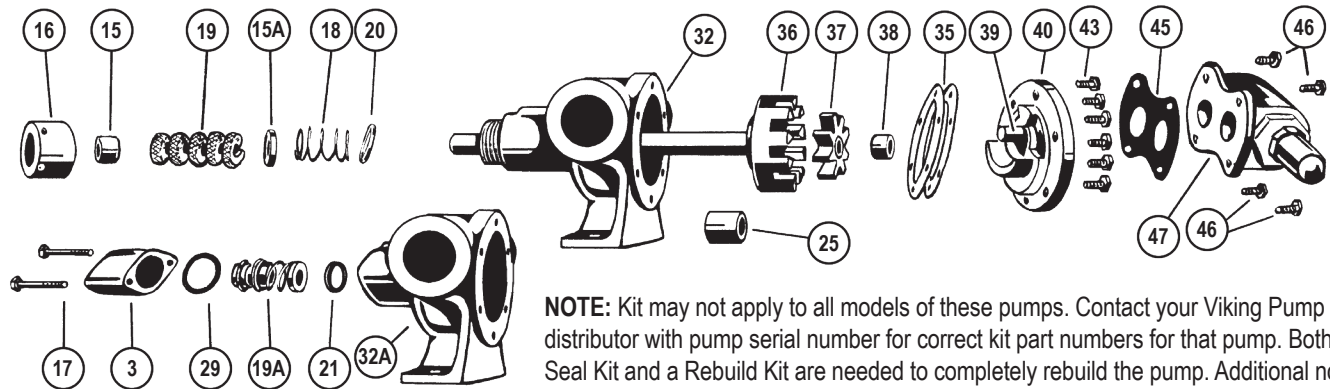

NOTE: Kit may not apply to all models of these pumps. Contact your Viking Pump distributor with pump serial number for correct kit part numbers for that pump. Both a Seal Kit and a Rebuild Kit are needed to completely rebuild the pump. Additional non-kit parts, such as Rotor and Shaft Assembly, may also be required, depending on wear.

ITEM	PART (may not exactly match parts list descriptions)	PART INCLUDED IN:		
		32 SERIES SEAL KIT	432 SERIES SEAL KIT	REBUILD KIT
16	Packing Nut (32 Series Only)	✓		
15	Outer Packing Gland (32 Series Only)	✓		
19	Packing (32 Series Only - 5 rings required)	✓		
15A	Inner Packing Gland (32 Series Only)	✓		
18	Packing Spring (32 Series Only)	✓		
20	Packing Spring Washer (32 Series Only)	✓		
32	Casing & Bushing Assembly (32 Series)			
25	Casing Bushing (included in 32/32A)			✓
36	Rotor and Shaft Assembly			
37	Idle & Bushing Assembly			✓
38	Idle Bushing (included in Idle & Bushing Assembly, 37)			
35	Head Gaskets	✓	✓	

ITEM	PART (may not exactly match parts list descriptions)	PART INCLUDED IN:		
		32 SERIES SEAL KIT	432 SERIES SEAL KIT	REBUILD KIT
39	Idle Pin (Included in Head & Idle Pin Assembly, 40)			
40	Head and Idle Pin Assembly			✓
43	Capscrews for Head			✓
45	Relief Valve Gasket ②	✓	✓	
47	Relief Valve (not included on non-RV pumps)			
46	Capscrews for Valve ②			✓
17	Capscrews for End Cap (432 Series Only)			✓
3	End Cap (432 Series Only)		✓	
29	Gasket for End Cap (432 Series Only)		✓	
19A	Mechanical Seal Complete (432 Series Only - Buna, Viton® or PTFE) ①		✓	
21	Set Collar with Setscrew		✓	
32A	Casing & Bushing Assembly (432 Series)			

① Mechanical seal elastomers in this kit are specified in seal kit description.

② Seal Kit include parts for Relief Valve models. Discard extra parts.

Use Seal Lubricant in 34 Series Seal Kits for installing mechanical seal.

Important safety information and rebuild instructions are found in the Technical Service Manual.

Download current Technical Service Manuals from www.vikingpump.com:

TSM 000 - Installation, Startup, Troubleshooting,
Preventative Maintenance, Do's & Don'ts

TSM 310.1 - General Purpose Pumps, Series 32 and 432, Sizes C-F-FH