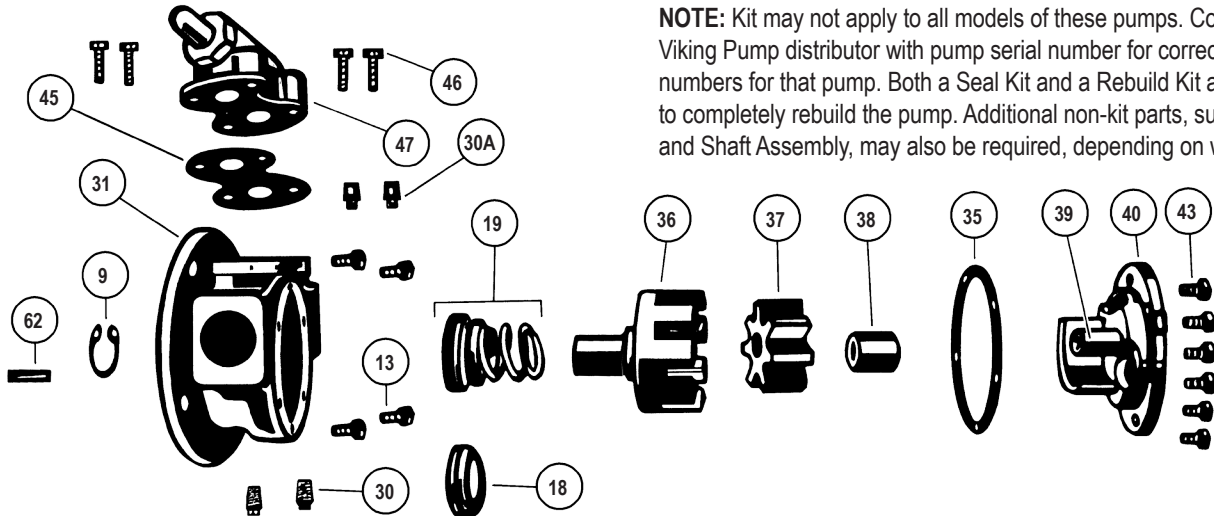

Exploded Diagram for Series 75 (lipseal) and 475 (mechanical seal), Sizes G, GG, H, HJ & HL

NOTE: Kit may not apply to all models of these pumps. Contact your Viking Pump distributor with pump serial number for correct kit part numbers for that pump. Both a Seal Kit and a Rebuild Kit are needed to completely rebuild the pump. Additional non-kit parts, such as Rotor and Shaft Assembly, may also be required, depending on wear.

ITEM	PART (may not exactly match parts list descriptions)	PART INCLUDED IN:		
		75 SERIES SEAL KIT	475 SERIES SEAL KIT	REBUILD KIT
9	Snap Ring ("G" and "GG" size 475 series only)		✓	
13	Capscrews for Pump to Motor			
18	Lip Seal (2-req'd - 75 Series only)	✓		
19	Mechanical Seal Complete (475 Series only) ②		✓	
30	Pipe Plug (2-req'd)			
30A	Machine Screw for Suckback (1 for 75 Series, 2 for 475 Series)			
31	Casing			
35	Head Gasket (set)	✓	✓	
36	Rotor and Shaft Assembly			
37	Idler & Bushing Assembly			✓
38	Idler Bushing (included in Idler & Bushing Assy, 37)			
39	Idler Pin (Included in Head & Idler Pin Assy, 40)			
40	Head and Idler Pin Assembly			✓
43	Capscrews for Head ①			✓
45	Relief Valve Gasket	✓	✓	
46	Capscrews for Relief Valve or Cover Plate ③			✓
47	Internal Relief Valve (complete)			
62	Key for Motor Shaft	✓	✓	

① Quantity of Capscrews depends on pump size.

② A tube of lubricant is included to aid in mechanical seal installation.

③ Capscrews to attach a relief valve are different than the capscrews to attach a cover plate. Kit includes capscrews for the relief valve and cover plate. Discard extra capscrews.

Important safety information and rebuild instructions are found in the Technical Service Manual.

Download current Technical Service Manuals from www.vikingpump.com:

TSM 000 - Installation, Startup, Troubleshooting,
Preventative Maintenance, Do's & Don'ts

TSM 320.2 - General Purpose Special Mounted Pumps,
Series 75 and 475, Sizes G-HL