

PN 2-EXP-006-000-00

**VIKING
PUMP**

A Unit of IDEX Corporation

VIKING PUMP, INC. • A Unit of IDEX Corporation

406 State Street • Cedar Falls, IA 50613

Phone: 319.266.1741 • Fax: 319.273.8157

**Exploded Diagram for Series 32 (packed),
Sizes J, K, KK, L and LQ**

**Plus (not pictured):
Series 34 Jacketed Pumps,
Sizes KK and LQ**

**Series 32E Electrically Heated Pumps,
Sizes LQ**

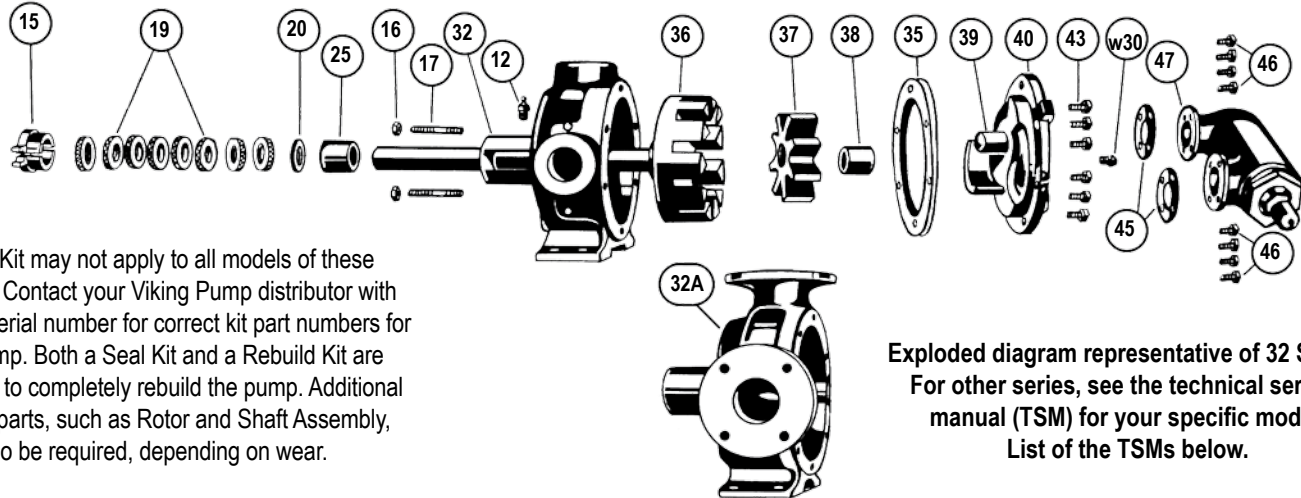

NOTE: Kit may not apply to all models of these pumps. Contact your Viking Pump distributor with pump serial number for correct kit part numbers for that pump. Both a Seal Kit and a Rebuild Kit are needed to completely rebuild the pump. Additional non-kit parts, such as Rotor and Shaft Assembly, may also be required, depending on wear.

Exploded diagram representative of 32 Series.
For other series, see the technical service
manual (TSM) for your specific model.
List of the TSMs below.

ITEM	PART (may not exactly match parts list descriptions)	PART INCLUDED IN:	
		32 SERIES SEAL KIT	REBUILD KIT
15	Two-Piece Packing Gland	✓	
19	Packing (4 rings in LQ)	✓	
20	Packing Retainer Washer	✓	
25	Casing Bushing		✓
16	Packing Gland Nuts		
17	Packing Gland Studs (Kit may include extras of different sizes)		
32	Casing and Bushing Assembly (J-L)		
32A	Casing and Bushing Assembly (LQ)		
12	Grease Fitting		
36	Rotor and Shaft Assembly		
37	Idle & Bushing Assembly		✓
38	Idle Bushing (included in Idle & Bushing Assembly, 37)		
35	Head Gasket Set	✓	
39	Idle Pin (Included in Head & Idle Pin Assembly, 40)		
40	Head and Idle Pin Assembly		✓
43	Capscrews for Head		✓
30	Pipe Plug		
45	Relief Valve Gasket (RV Pumps Only)	✓	
47	Relief Valve (RV Pumps Only)		
46	Capscrews for Valve (RV Pumps Only)		✓

Use Lubricant in Seal Kits for installing rotor/shaft.

Important safety information and rebuild instructions are found in the Technical Service Manual.

Download current Technical Service Manuals from www.vikingpump.com:

TSM 000 - Installation, Startup, Troubleshooting, Preventative Maintenance, Do's & Don'ts

TSM 312 - General Purpose Pumps, Series 32 and 432, Sizes G-N

TSM 430 - Jacketed Asphalt Pumps, Series 34 and 434, Sizes HL, KK, LQ, Q, M, N