

VIEW A-A

PORTS: 2X 3" FLANGES
 DRILLED AND TAPPED
 SUITABLE FOR USE WITH
 CLASS 250 ANSI FLANGES
 (224C, 1224C, 4224C)
 CLASS 300 ANSI FLANGES
 (223C, 4223C, 227C, 1227C, 4227C)

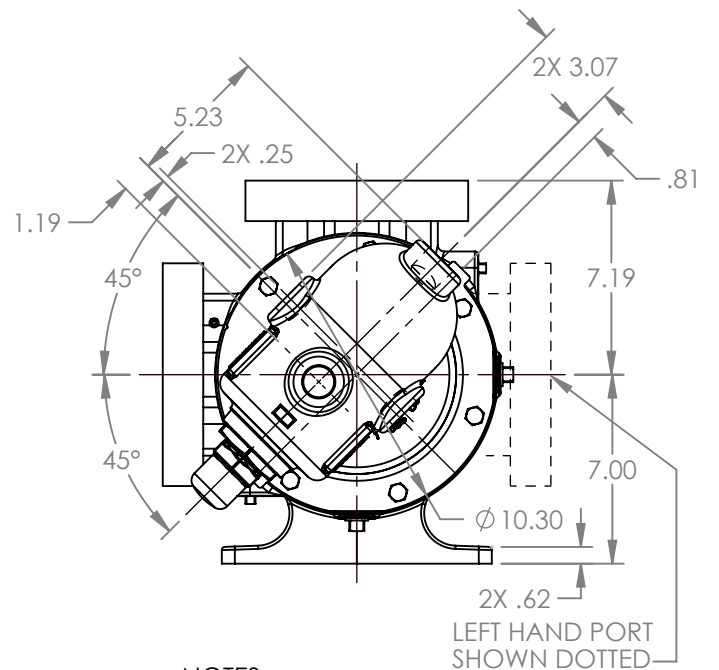
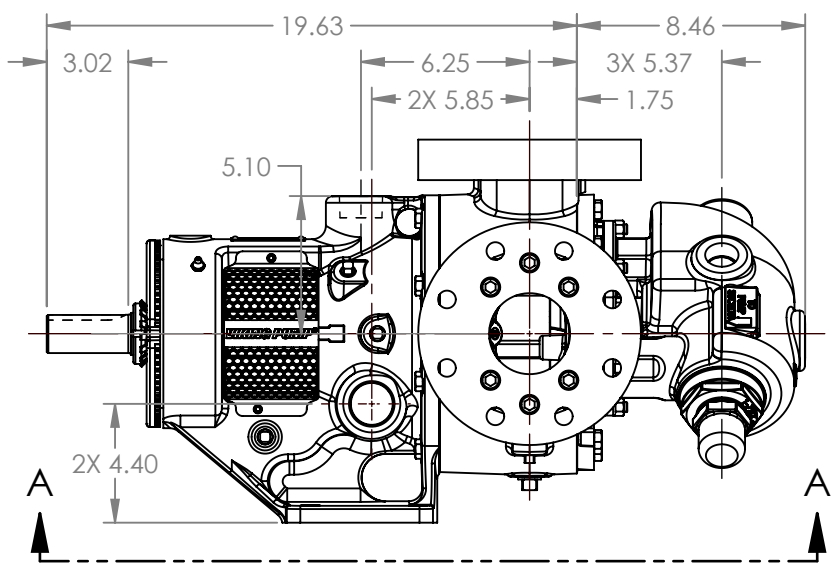

MODELS WITH OPTIONAL FLANGED PORTS:
 L223C, L4223C, L224C, L1224C, L4224C, L227C, L1227C, L4227C

NOTES:
 1. ALL DIMENSIONS ARE FOR REFERENCE ONLY.

STATE	Released	07/12/2023
DRAWN	dalcom	07/07/2023
CHECKED	DTL	07/11/2023

DIMENSIONS ARE IN INCHES

PROJECT: E330

WAS:



THIS DRAWING IS THE PROPERTY OF VIKING PUMP, INC. AND IS PROPRIETARY IN GENERAL AND DETAIL. IT SHALL NOT BE COPIED OR ITS CONTENTS REVEALED TO OUTSIDE PARTIES WITHOUT THE WRITTEN CONSENT OF VIKING PUMP, INC.

3D

DWG. NO.
 LV-4533

SHEET 1 OF 1

REV. A.0
 07/12/2023