

MOTOR FRAMES:  
364TC-365TC

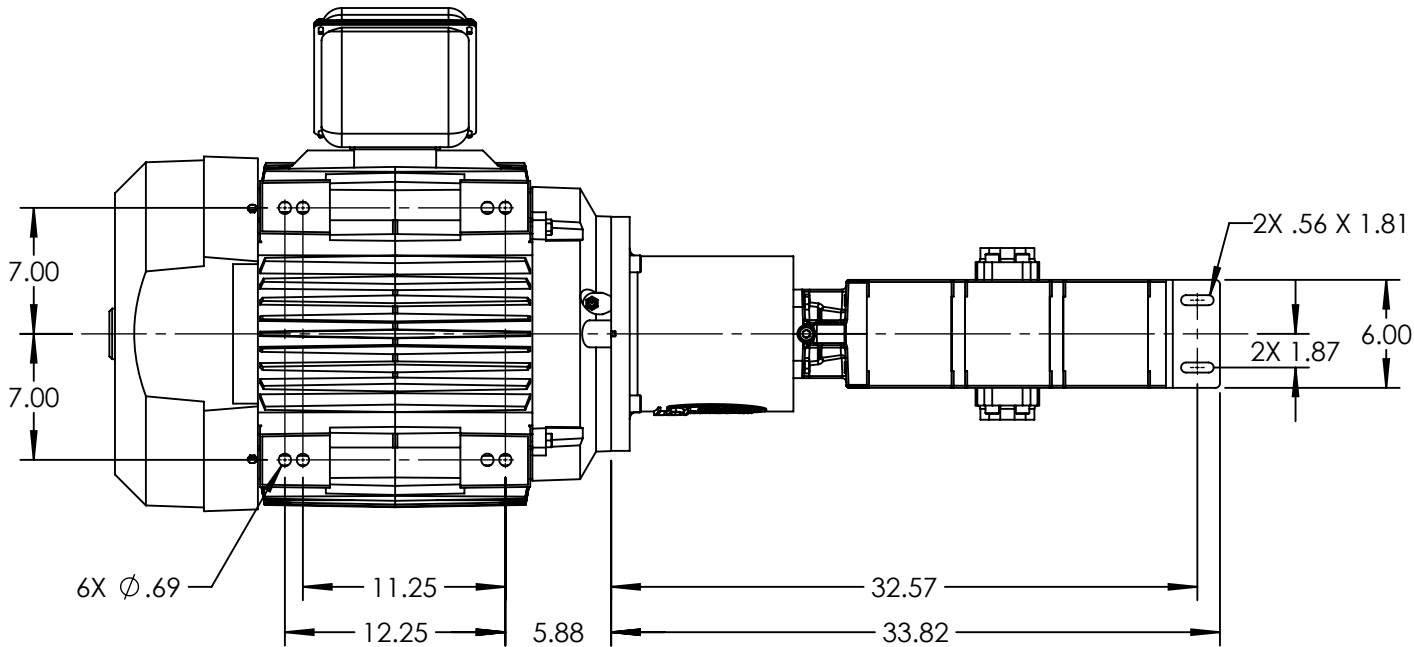
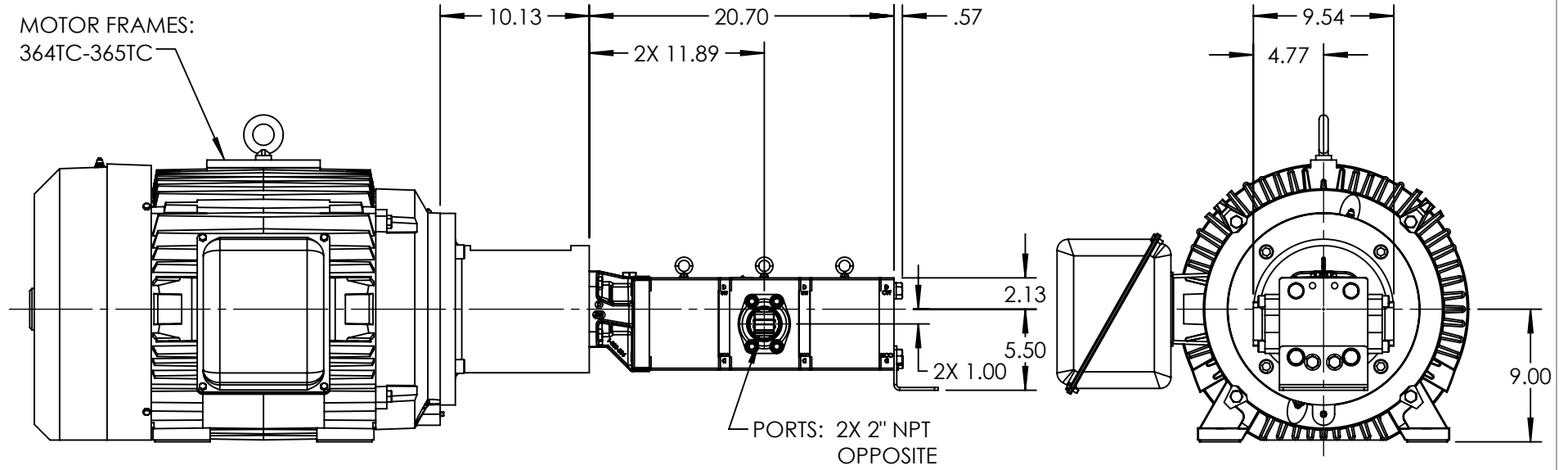

STANDARD MODELS: GB-41039-G00-M, GB-41039-G10-M

NOTES:

1. ALL DIMENSIONS ARE FOR REFERENCE ONLY.

STATE	Released	07/16/2021
DRAWN	bmanernach	7/8/2021
CHECKED	JAG	07/16/2021

DIMENSIONS ARE IN INCHES
PROJECT: E331
WAS:



VIKING PUMP, INC.  
A Unit of IDEX Corporation  
Cedar Falls, IA 50613  
U.S.A.

THIS DRAWING IS THE PROPERTY OF  
VIKING PUMP, INC. AND IS PROPRIETARY  
IN GENERAL AND DETAIL. IT SHALL NOT BE  
COPIED OR ITS CONTENTS REVEALED TO  
OUTSIDE PARTIES WITHOUT THE WRITTEN  
CONSENT OF VIKING PUMP, INC.

3D

DWG. NO. GPV-1039-011-U

SHEET 1 OF 1

REV. A.0

07/16/2021

# DATA SHEET



## Three Phase Induction Motor - Squirrel Cage

Customer :			
Product line	: W22 NEMA Premium Efficiency Three-Phase	Product code :	12205951
		Catalog # :	06018ET3E364TC-W22
Frame	: 364/5TC	Locked rotor time	: 27s (cold) 15s (hot)
Output	: 60 HP (45 kW)	Temperature rise	: 80 K
Poles	: 4	Duty cycle	: Cont.(S1)
Frequency	: 60 Hz	Ambient temperature	: -20°C to +40°C
Rated voltage	: 230/460 V	Altitude	: 1000 m.a.s.l.
Rated current	: 143/71.6 A	Protection degree	: IP55
L. R. Amperes	: 888/444 A	Cooling method	: IC411 - TEFC
LRC	: 6.2x(Code G)	Mounting	: F-1
No load current	: 52.0/26.0 A	Rotation <sup>1</sup>	: Both (CW and CCW)
Rated speed	: 1780 rpm	Noise level <sup>2</sup>	: 67.0 dB(A)
Slip	: 1.11 %	Starting method	: Direct On Line
Rated torque	: 177 ft.lb	Approx. weight <sup>3</sup>	: 908 lb
Locked rotor torque	: 220 %		
Breakdown torque	: 240 %		
Insulation class	: F		
Service factor	: 1.25		
Moment of inertia (J)	: 22.4 sq.ft.lb		
Design	: B		
Output	50%	75%	100%
Efficiency (%)	94.1	94.5	95.0
Power Factor	0.71	0.80	0.83
		Foundation loads	
		Max. traction	: 1222 lb
		Max. compression	: 2130 lb
		<u>Drive end</u>	<u>Non drive end</u>
Bearing type	:	6314 C3	6314 C3
Sealing	:	WSeal	WSeal
Lubrication interval	:	12000 h	12000 h
Lubricant amount	:	27 g	27 g
Lubricant type	:	Mobil Polyrex EM	
Notes			
USABLE @208V 151A SF 1.10 SFA 166A			
This revision replaces and cancel the previous one, which must be eliminated. (1) Looking the motor from the shaft end. (2) Measured at 1m and with tolerance of +3dB(A). (3) Approximate weight subject to changes after manufacturing process. (4) At 100% of full load.		These are average values based on tests with sinusoidal power supply, subject to the tolerances stipulated in NEMA MG-1.	
Rev.	Changes Summary	Performed	Checked
Performed by			
Checked by			
Date	07/07/2020		
		Page	Revision
		1 / 6	

# TORQUE AND CURRENT VS SPEED CURVE

Three Phase Induction Motor - Squirrel Cage



Customer :

Product line : W22 NEMA Premium Efficiency  
Three-Phase

Product code : 12205951

Catalog # : 06018ET3E364TC-W22

TORQUE AND CURRENT VS SPEED CURVE

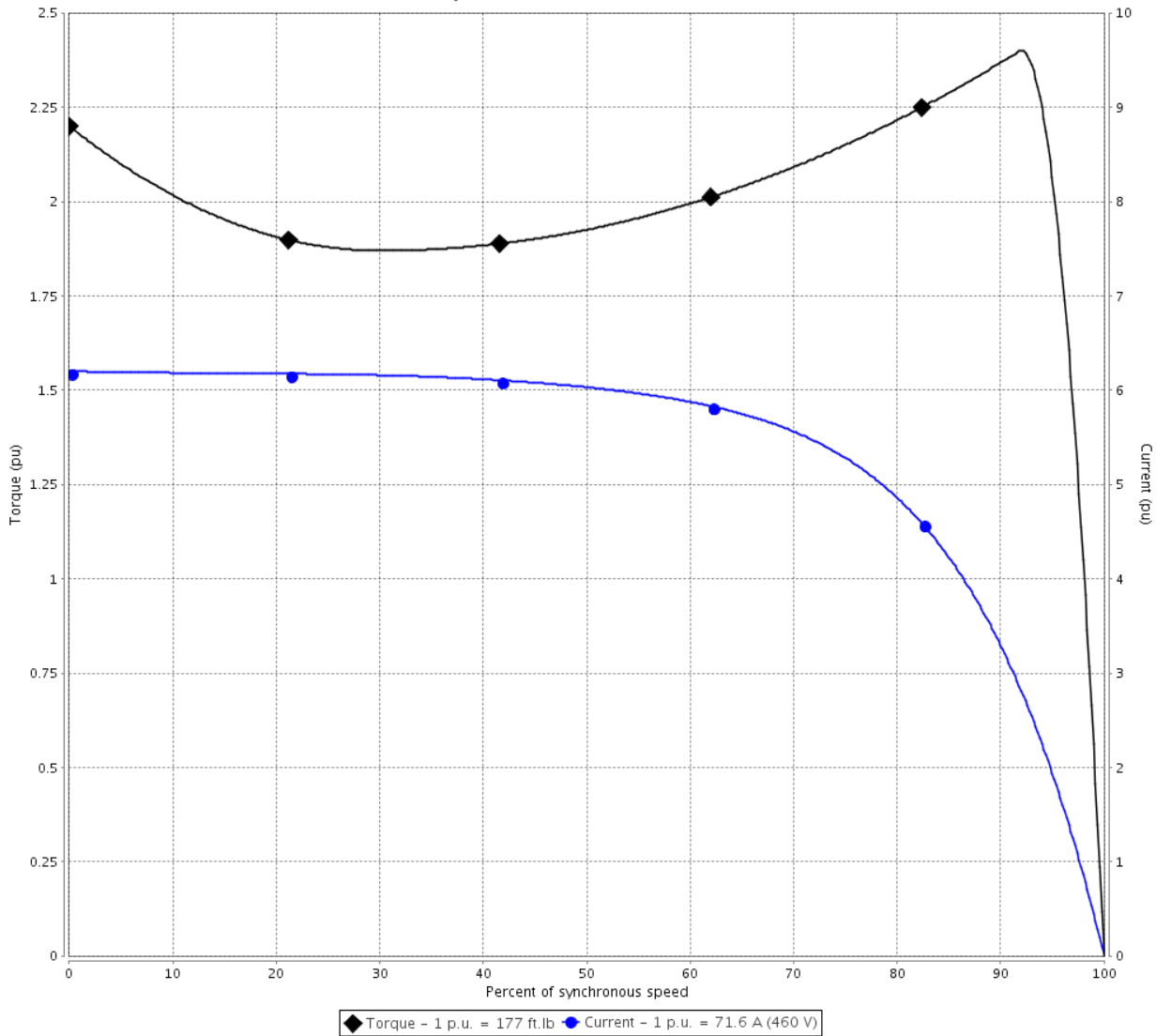

Performance : 230/460 V 60 Hz 4P

Rated current	: 143/71.6 A	Moment of inertia (J)	: 22.4 sq.ft.lb
LRC	: 6.2	Duty cycle	: Cont.(S1)
Rated torque	: 177 ft.lb	Insulation class	: F
Locked rotor torque	: 220 %	Service factor	: 1.25
Breakdown torque	: 240 %	Temperature rise	: 80 K
Rated speed	: 1780 rpm	Design	: B

Locked rotor time : 27s (cold) 15s (hot)

Rev.	Changes Summary	Performed	Checked	Date
Performed by			Page 2 / 6	Revision
Checked by				
Date	07/07/2020			

# LOAD PERFORMANCE CURVE

## Three Phase Induction Motor - Squirrel Cage



Customer :

Product line : W22 NEMA Premium Efficiency Three-Phase

Product code : 12205951

Catalog # : 06018ET3E364TC-W22

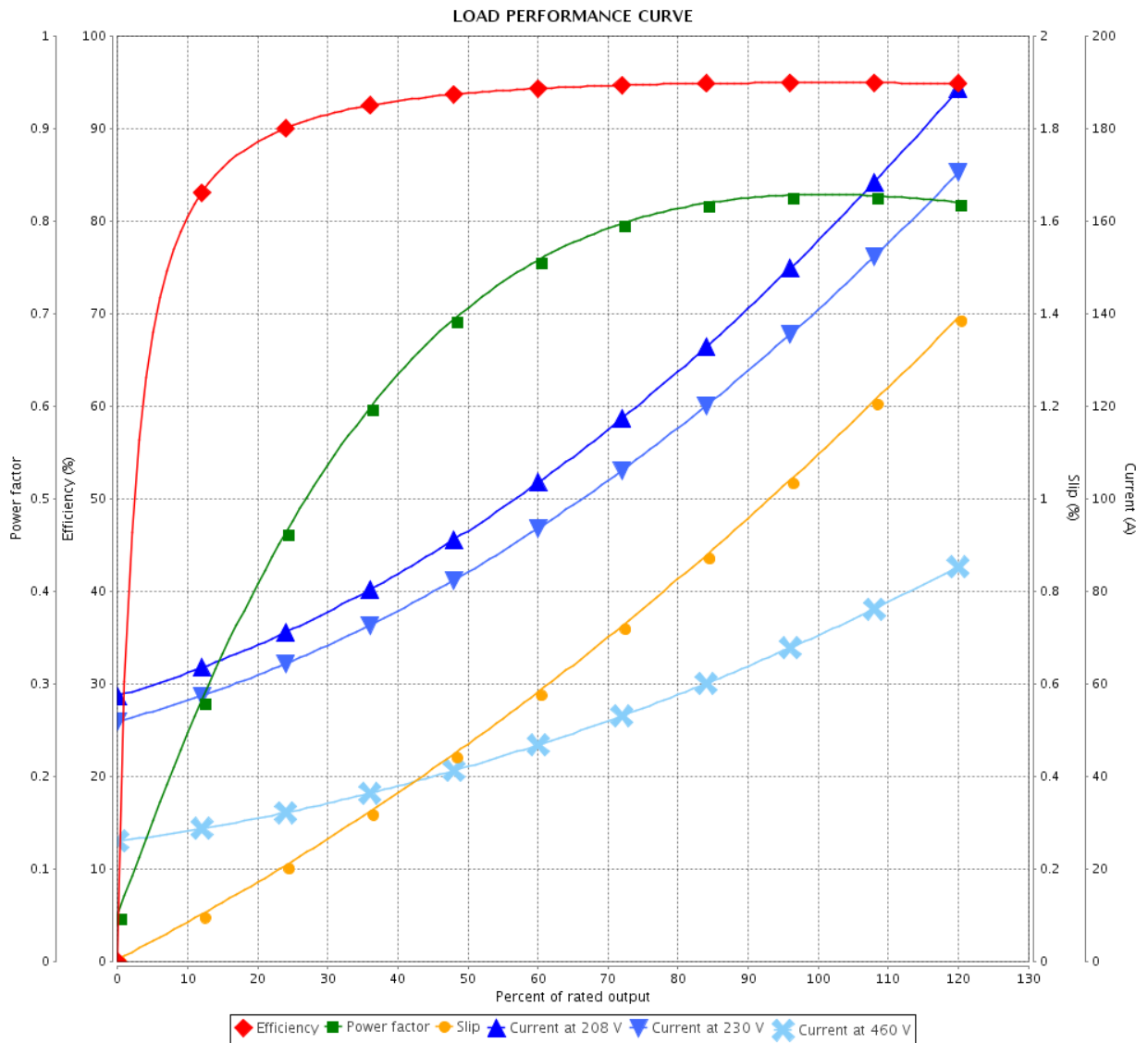

Performance : 230/460 V 60 Hz 4P

Rated current : 143/71.6 A  
 LRC : 6.2  
 Rated torque : 177 ft.lb  
 Locked rotor torque : 220 %  
 Breakdown torque : 240 %  
 Rated speed : 1780 rpm

Moment of inertia (J) : 22.4 sq.ft.lb  
 Duty cycle : Cont.(S1)  
 Insulation class : F  
 Service factor : 1.25  
 Temperature rise : 80 K  
 Design : B

Rev.	Changes Summary	Performed	Checked	Date
Performed by			Page	Revision
Checked by				
Date				

# THERMAL LIMIT CURVE

## Three Phase Induction Motor - Squirrel Cage



Customer :

Product line : W22 NEMA Premium Efficiency  
Three-Phase

Product code : 12205951

Catalog # : 06018ET3E364TC-W22

Performance : 230/460 V 60 Hz 4P

Rated current : 143/71.6 A  
LRC : 6.2  
Rated torque : 177 ft.lb  
Locked rotor torque : 220 %  
Breakdown torque : 240 %  
Rated speed : 1780 rpm

Moment of inertia (J) : 22.4 sq.ft.lb  
Duty cycle : Cont.(S1)  
Insulation class : F  
Service factor : 1.25  
Temperature rise : 80 K  
Design : B

Heating constant

Cooling constant

Rev.	Changes Summary	Performed	Checked	Date
Performed by				
Checked by			Page	Revision
Date	07/07/2020		4 / 6	

# THERMAL LIMIT CURVE

Three Phase Induction Motor - Squirrel Cage



Customer : \_\_\_\_\_

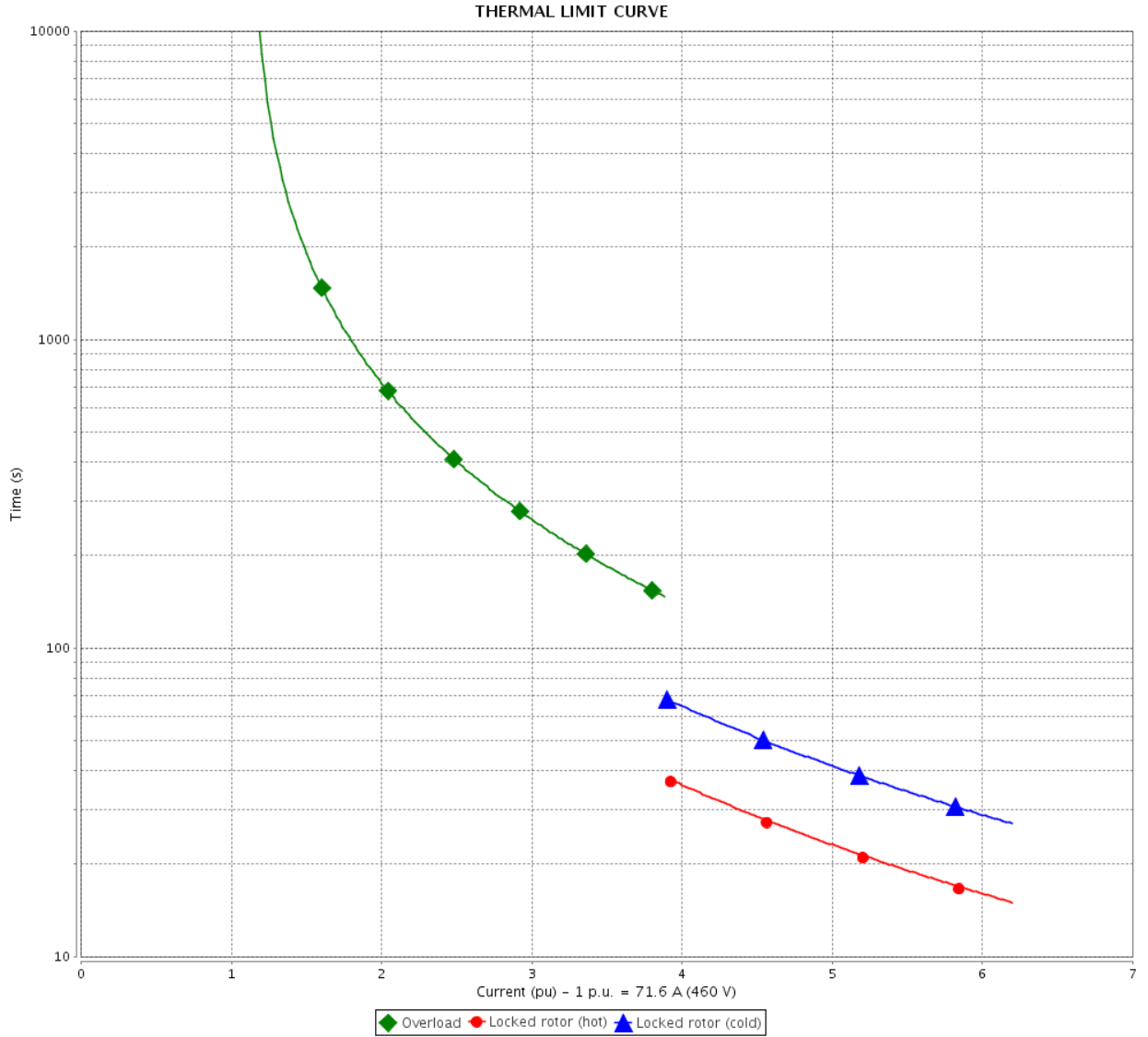

Rev.	Changes Summary	Performed	Checked	Date
Performed by				
Checked by				
Date				
			Page 5 / 6	Revision

# VFD OPERATION CURVE

Three Phase Induction Motor - Squirrel Cage



Customer :

Product line : W22 NEMA Premium Efficiency Three-Phase

Product code : 12205951

Catalog # : 06018ET3E364TC-W22

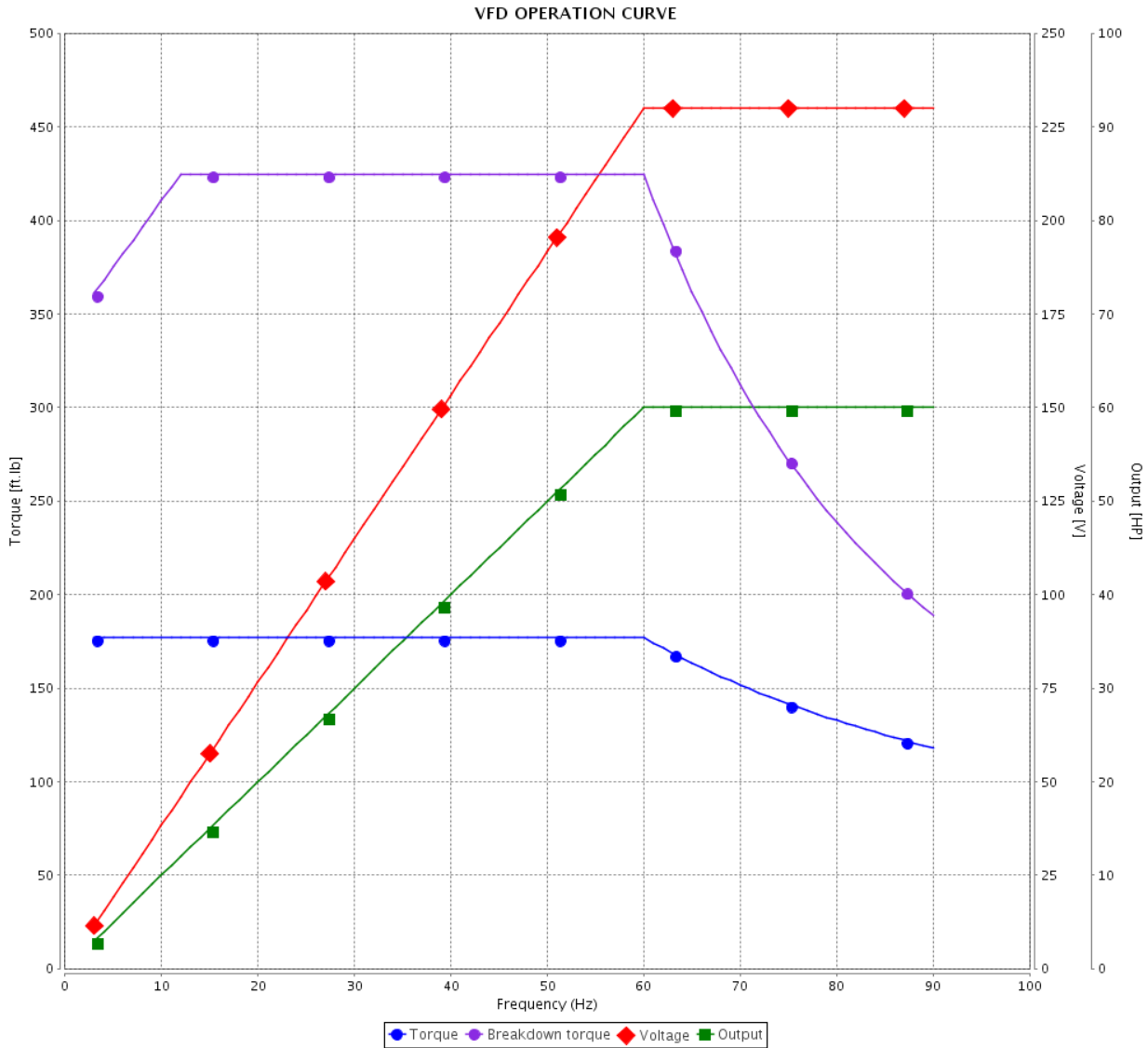

Performance : 230/460 V 60 Hz 4P

Rated current : 143/71.6 A  
 LRC : 6.2  
 Rated torque : 177 ft.lb  
 Locked rotor torque : 220 %  
 Breakdown torque : 240 %  
 Rated speed : 1780 rpm

Moment of inertia (J) : 22.4 sq.ft.lb  
 Duty cycle : Cont.(S1)  
 Insulation class : F  
 Service factor : 1.25  
 Temperature rise : 80 K  
 Design : B

Rev.	Changes Summary	Performed	Checked	Date
Performed by			Page 6 / 6	Revision
Checked by				
Date	07/07/2020			

1 2 3 4 5 6

A

B

C

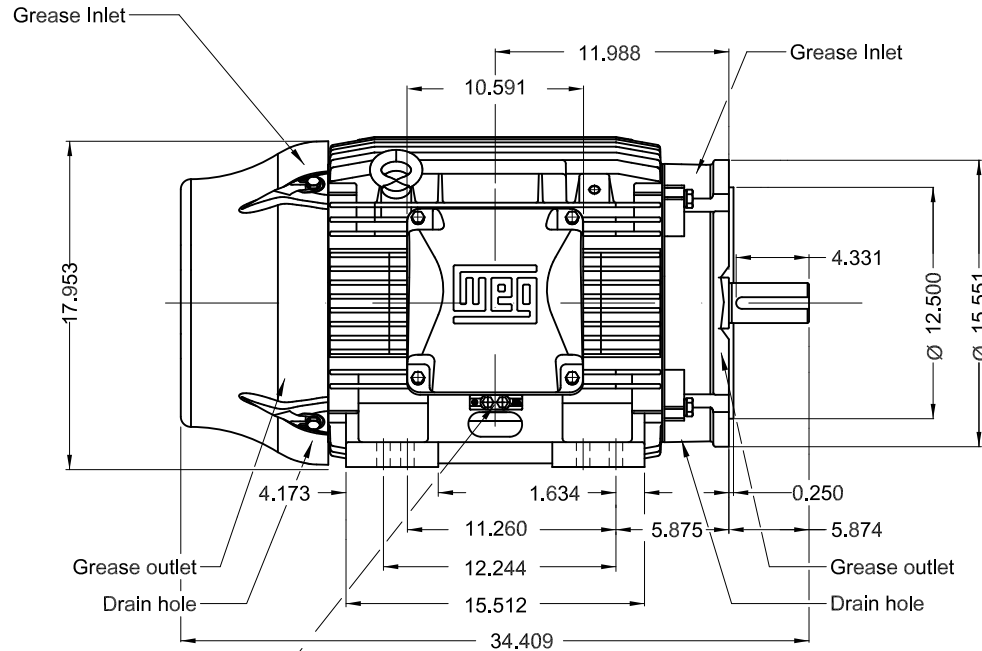
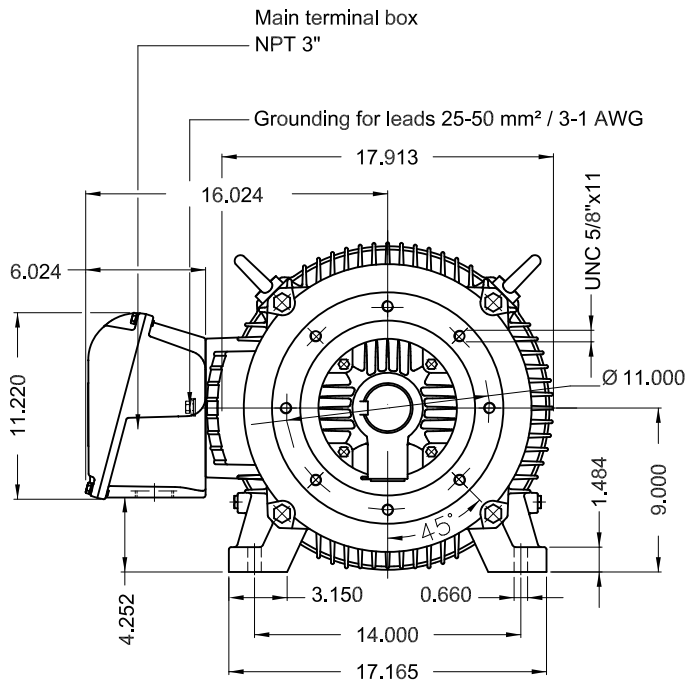

Grounding for leads 25-185 mm² / 3AWG-350MCM

D

E

Without vertical jackscrews  
 Color RAL 5009  
 Painting plan 203A  
 Mounting B34R(D)

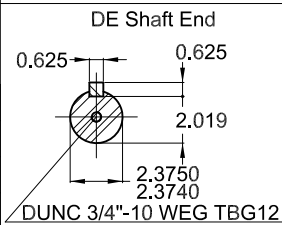

60 HP 04 Poles 60Hz A

ECM	LOC	SUMMARY OF MODIFICATIONS	EXECUTED	CHECKED	RELEASED	DATE	VER
EXECUTED	PIRWBUSER	THREE PHASE W22 MOTOR - NEMA PREMIUM EFF					
CHECKED		FRAME 364/5TC IP55 TEFC					
RELEASED							
REL DT.	WMO	Jaragua do Sul	Product Engineering	SHEET	1 / 1		

PREVIEW  
WDD





MODEL 06018ET3E364TC-W22  
MADE IN MEXICO  
12205951



Inverter Duty Motor  
Severe Duty



FOR SAFE AREA  
MOD.TE1BFOXON



For 60Hz: Class I, Div 2, Gr. A, B, C and D - T3  
Class I, Zone 2, IIC - T3

Class II, Div 2, Gr. F and G - T4

For 60Hz use on PWM, Gr. A, B, C, D and F,  
VT 1000:1, CT 20:1, 1.0SF, T3A

PH 3	FR 364/5TC	HP(kW) 60.0(45.0)	Hz 60
V 230/460	A 143/71.6	RPM 1780	DES B
NEMA NOM EFF 95.0 %	INS. CL. F ΔT 80 K	IP55	
ENCL TEFC	DUTY CONT.	AMB. 40°C	
CODE G	PF 0.83	SF 1.25	SFA 179/89.5
USABLE @208V 151 A	SF 1.10	SFA 166	
60HP 45kW 50Hz 380V 86.5A 1470RPM SF1.00 EFF 93.0% (IE1)	ALT 1000 m.a.s.l.	908 Lbs	

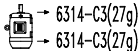
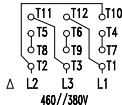
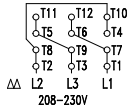

MOBIL POLYREX EM  
12000 h