

MOTOR FRAMES:
364TC-365TC

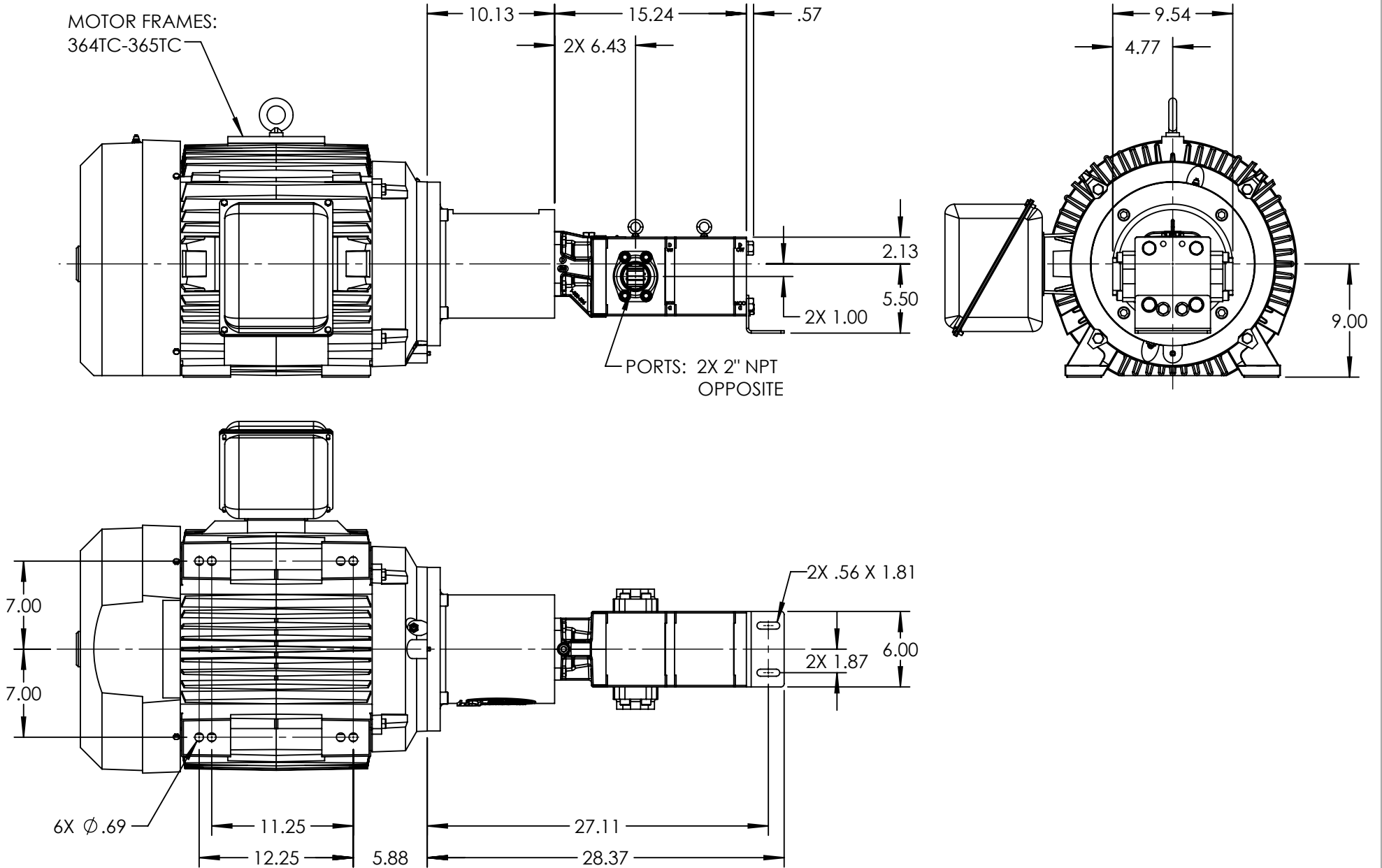

STANDARD MODELS: GB-41026-G00-M, GB-41026-G10-M

NOTES:

1. ALL DIMENSIONS ARE FOR REFERENCE ONLY.

| | | |
|---------|-------------|------------|
| STATE | Released | 07/16/2021 |
| DRAWN | bmanternach | 7/8/2021 |
| CHECKED | JAG | 07/16/2021 |

| |
|-----------------------------|
| DIMENSIONS ARE IN INCHES |
| PROJECT: E331 |
| WAS: |



VIKING PUMP, INC.
A Unit of IDEX Corporation
Cedar Falls, IA 50613
U.S.A.

THIS DRAWING IS THE PROPERTY OF
VIKING PUMP, INC. AND IS PROPRIETARY
IN GENERAL AND DETAIL. IT SHALL NOT BE
COPIED OR ITS CONTENTS REVEALED TO
OUTSIDE PARTIES WITHOUT THE WRITTEN
CONSENT OF VIKING PUMP, INC.

3D

DWG. NO. GPV-1026-076-U
SHEET 1 OF 1

REV. A.0
07/16/2021

TORQUE AND CURRENT VS SPEED CURVE

Three Phase Induction Motor - Squirrel Cage



Customer :

Product line : W22 NEMA Premium Efficiency
Three-Phase

Product code : 12076589

Catalog # : 07518ET3E365TC-W22

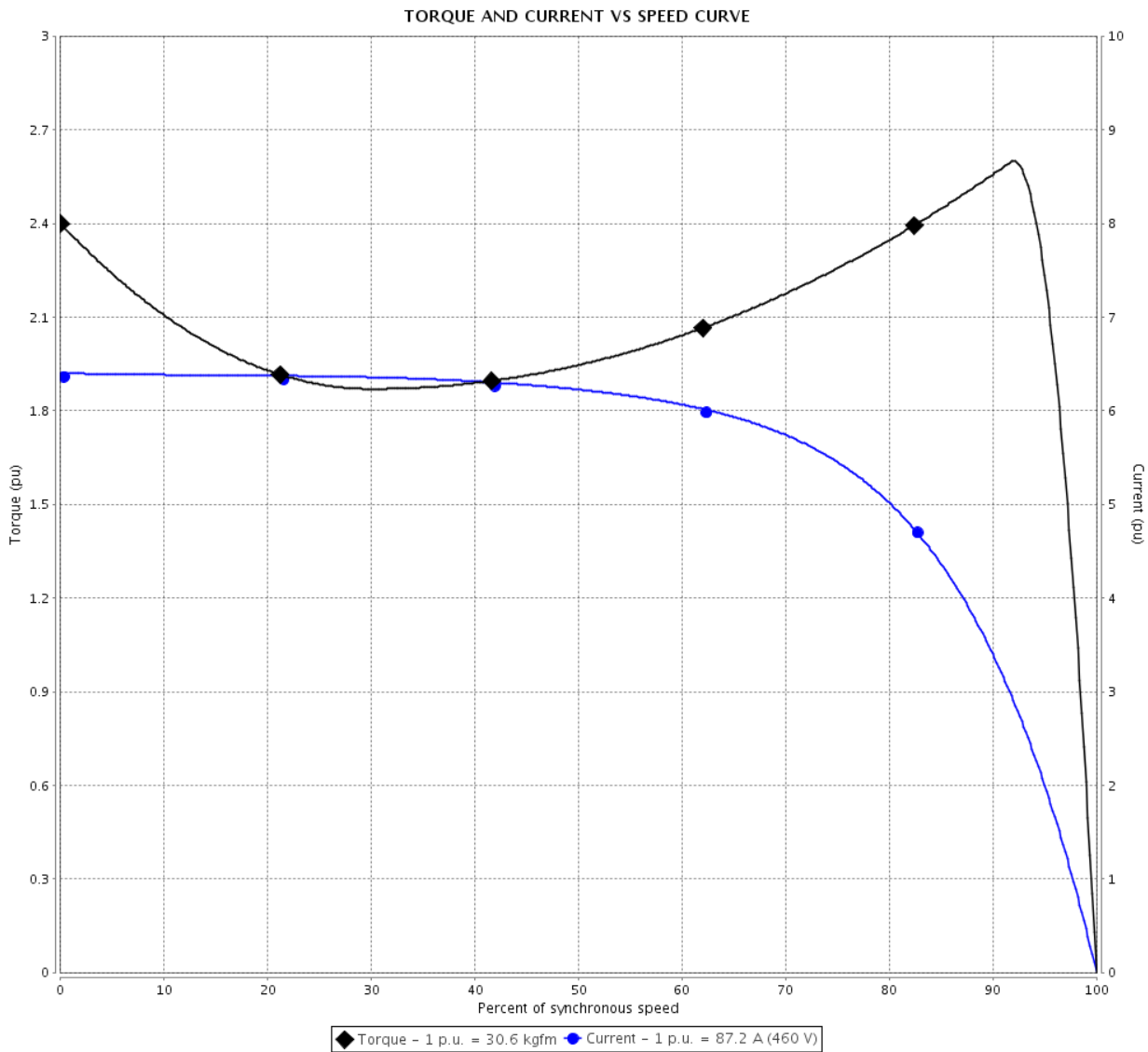

Performance : 230/460 V 60 Hz 4P

Rated current : 174/87.2 A
LRC : 6.4
Rated torque : 30.6 kgfm
Locked rotor torque : 240 %
Breakdown torque : 260 %
Rated speed : 1780 rpm

Moment of inertia (J) : 0.9798 kgm²
Duty cycle : Cont.(S1)
Insulation class : F
Service factor : 1.25
Temperature rise : 80 K
Design : B

Locked rotor time : 25s (cold) 14s (hot)

| Rev. | Changes Summary | Performed | Checked | Date |
|--------------|-----------------|-----------|---------------|----------|
| | | | | |
| Performed by | | | Page 2 / 6 | Revision |
| Checked by | | | | |
| Date | 06/08/2020 | | | |

LOAD PERFORMANCE CURVE

Three Phase Induction Motor - Squirrel Cage



Customer : _____

Product line : W22 NEMA Premium Efficiency
Three-Phase

Product code : 12076589

Catalog # : 07518ET3E365TC-W22

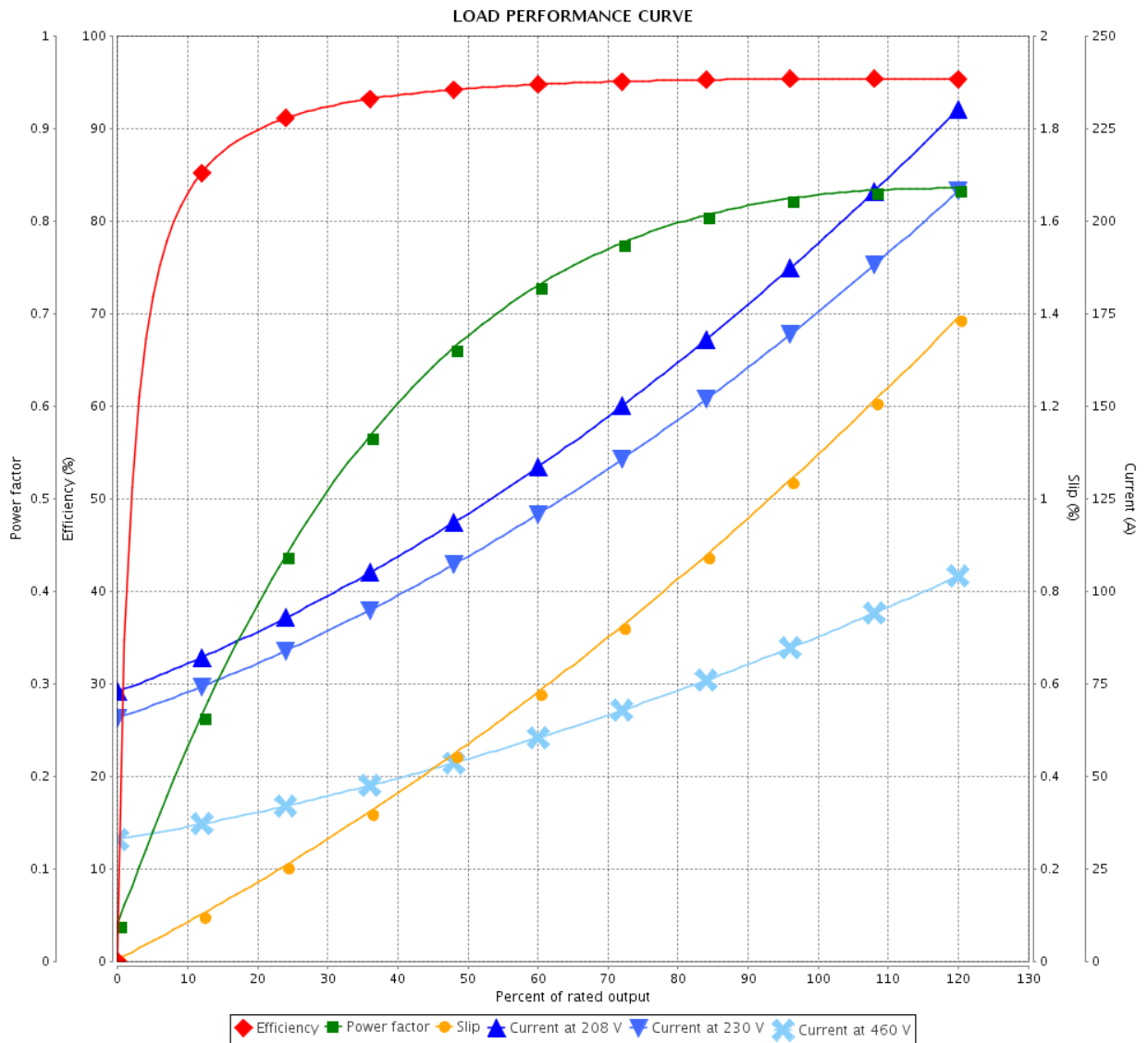

Performance : 230/460 V 60 Hz 4P

Rated current : 174/87.2 A
 LRC : 6.4
 Rated torque : 30.6 kgfm
 Locked rotor torque : 240 %
 Breakdown torque : 260 %
 Rated speed : 1780 rpm

Moment of inertia (J) : 0.9798 kgm²
 Duty cycle : Cont.(S1)
 Insulation class : F
 Service factor : 1.25
 Temperature rise : 80 K
 Design : B

| Rev. | Changes Summary | Performed | Checked | Date |
|--------------|-----------------|------------|---------|----------|
| | | | | |
| Performed by | | Page | | Revision |
| Checked by | | 3 / 6 | | |
| Date | | 06/08/2020 | | |

THERMAL LIMIT CURVE



Three Phase Induction Motor - Squirrel Cage

Customer :

Product line : W22 NEMA Premium Efficiency
Three-Phase

Product code : 12076589

Catalog # : 07518ET3E365TC-W22

Performance : 230/460 V 60 Hz 4P

Rated current : 174/87.2 A
LRC : 6.4
Rated torque : 30.6 kgfm
Locked rotor torque : 240 %
Breakdown torque : 260 %
Rated speed : 1780 rpm

Moment of inertia (J) : 0.9798 kgm²
Duty cycle : Cont.(S1)
Insulation class : F
Service factor : 1.25
Temperature rise : 80 K
Design : B

Heating constant

Cooling constant

| Rev. | Changes Summary | Performed | Checked | Date |
|--------------|-----------------|-----------|---------|----------|
| | | | | |
| Performed by | | | | |
| Checked by | | | Page | Revision |
| Date | 06/08/2020 | | 4 / 6 | |

THERMAL LIMIT CURVE

Three Phase Induction Motor - Squirrel Cage



Customer : _____

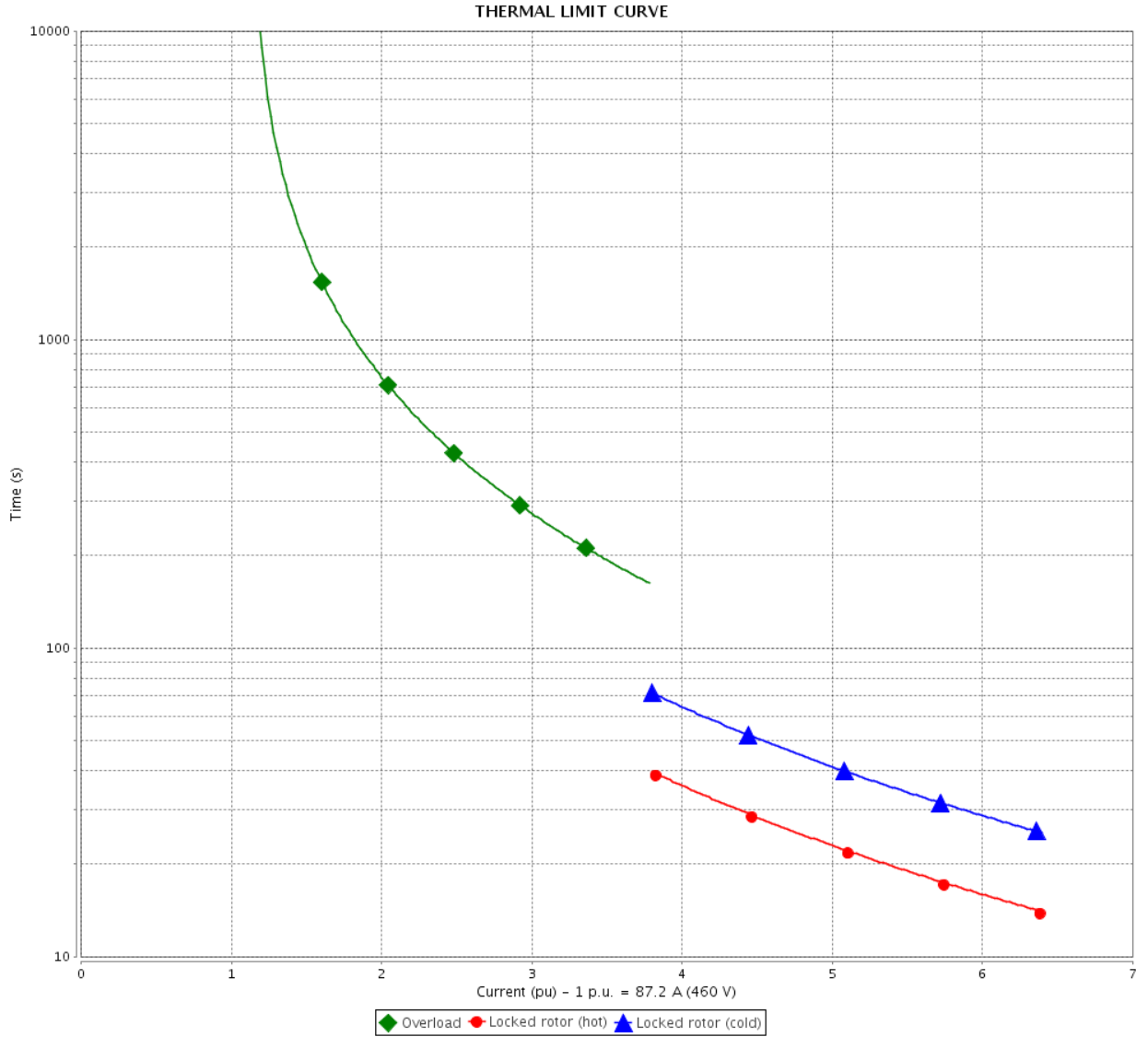

| Rev. | Changes Summary | Performed | Checked | Date |
|--------------|-----------------|-----------|---------|----------|
| | | | | |
| Performed by | | | | |
| Checked by | | | | |
| Date | | | | |
| | | | Page | Revision |
| | | | 5 / 6 | |

VFD OPERATION CURVE

Three Phase Induction Motor - Squirrel Cage



Customer :

Product line : W22 NEMA Premium Efficiency Three-Phase

Product code : 12076589

Catalog # : 07518ET3E365TC-W22

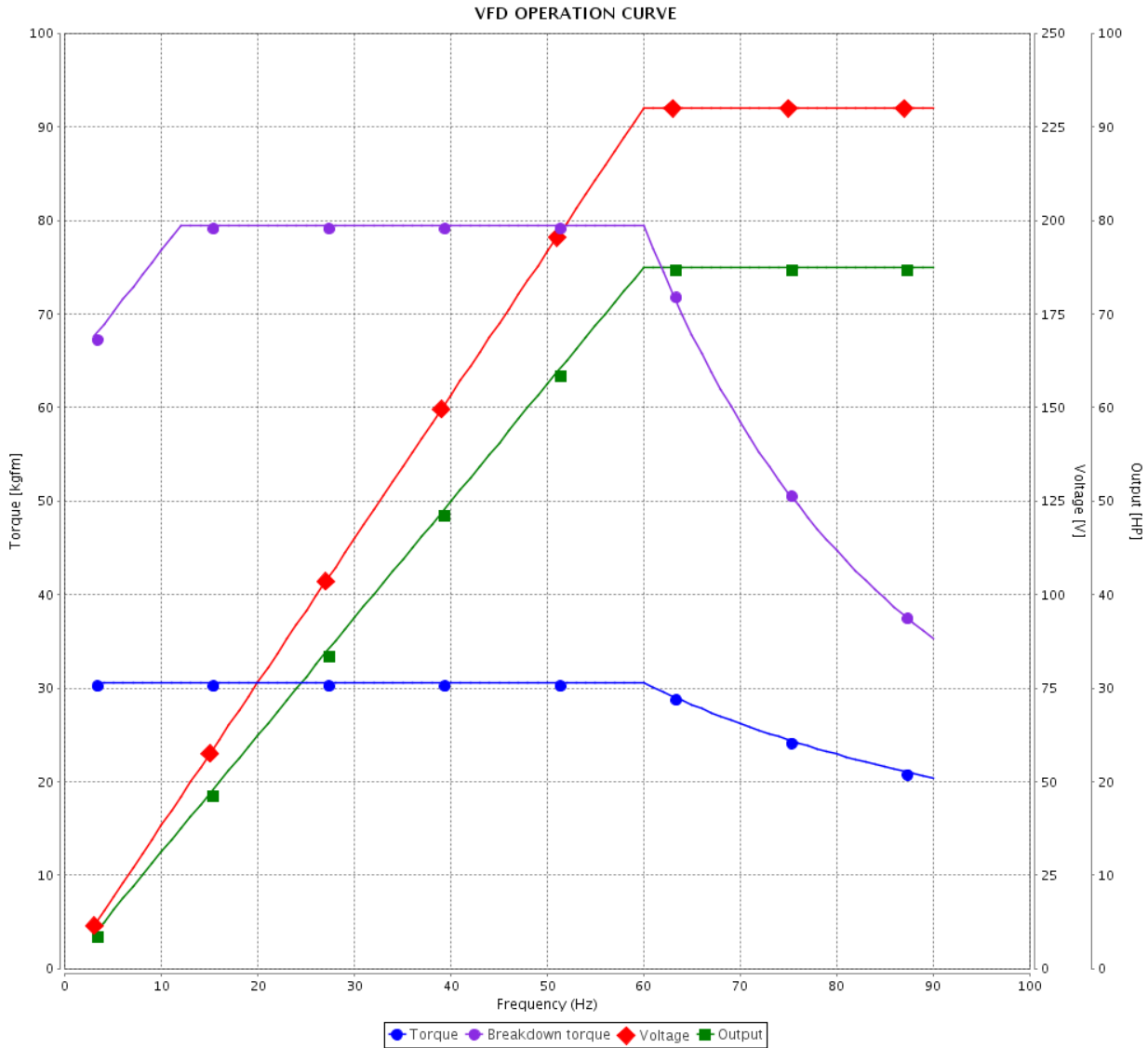

Performance : 230/460 V 60 Hz 4P

Rated current : 174/87.2 A
 LRC : 6.4
 Rated torque : 30.6 kgfm
 Locked rotor torque : 240 %
 Breakdown torque : 260 %
 Rated speed : 1780 rpm

Moment of inertia (J) : 0.9798 kgm²
 Duty cycle : Cont.(S1)
 Insulation class : F
 Service factor : 1.25
 Temperature rise : 80 K
 Design : B

| Rev. | Changes Summary | Performed | Checked | Date |
|--------------|-----------------|-----------|---------|----------|
| | | | | |
| Performed by | | | Page | Revision |
| Checked by | | | | |
| Date | | | | |

1 2 3 4 5 6

A

B

C

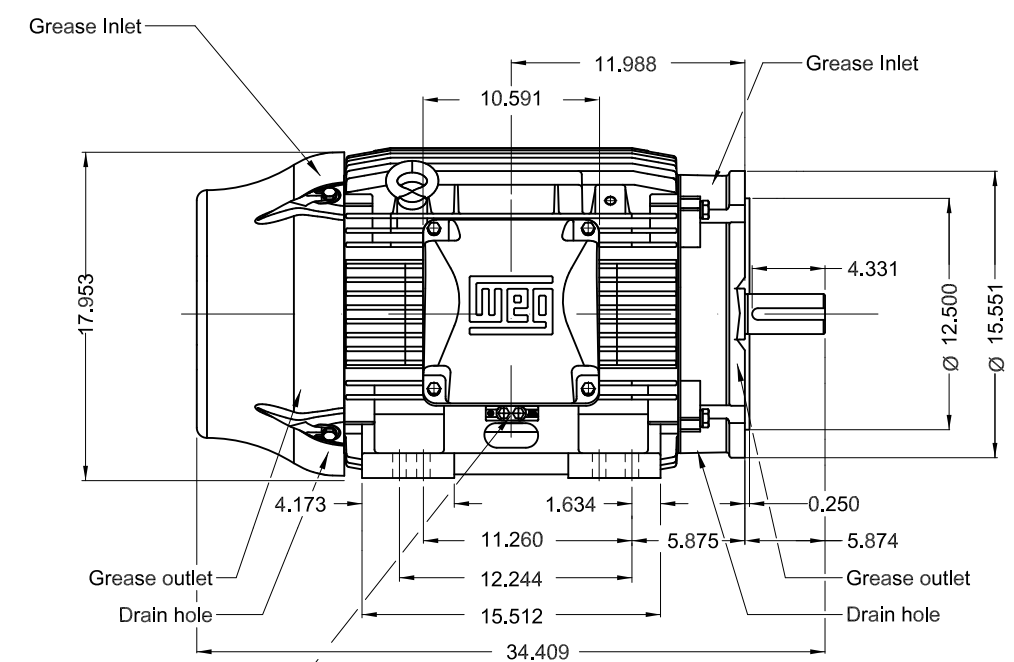
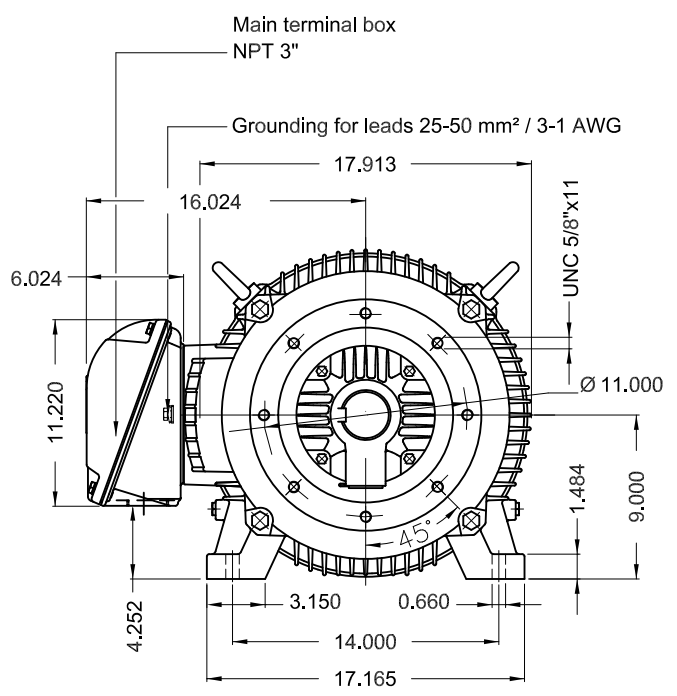

Grounding for leads 25-185 mm² / 3AWG-350MCM

D

E

Without vertical jackscrews
 Color RAL 5009
 Painting plan 203A
 Mounting B34R(D)

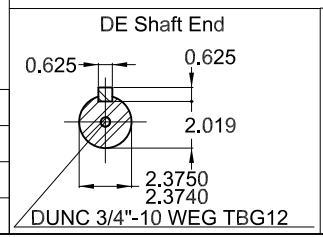

75 HP 04 Poles 60Hz A

| ECM | LOC | SUMMARY OF MODIFICATIONS | EXECUTED | CHECKED | RELEASED | DATE | VER |
|----------|-----------|--|---------------------|---------|----------|------|-----|
| EXECUTED | PIRWBUSER | THREE PHASE W22 MOTOR - NEMA PREMIUM EFF | | | | | |
| CHECKED | | FRAME 364/5TC IP55 TEFC | | | | | |
| RELEASED | | | | | | | |
| REL DT. | WMO | Jaragua do Sul | Product Engineering | SHEET | 1 / 1 | | |

PREVIEW
WDD





FOR SAFE AREA
MOD.TE1BFOXON



For 60Hz: Class I, Div 2, Gr. A, B, C and D - T3
Class I, Zone 2, IIC - T3
Class II, Div 2, Gr. F and G - T4
For 60Hz use on PWM, Gr. A, B, C, D and F,
VT 1000:1, CT 20:1, 1.0SF, T3A

MODEL 07518ET3E365TC-W22
MADE IN MEXICO
12076589

| | | | |
|---|----------------------------|-------------------|-------------|
| PH 3 | FR 364/5TC | HP(kW) 75.0(55.0) | Hz 60 |
| V 230/460 | A 174/87.2 | RPM 1780 | DES B |
| NEMA NOM EFF 95.4 % | INS. CL. F Δ T 80 K | IP55 | |
| ENCL TEFC | DUTY CONT. | AMB. 40°C | |
| CODE G | PF 0.83 | SF 1.25 | SFA 218/109 |
| USABLE @208V 186 A | SF 1.10 | SFA 205 | |
| 75HP 55kW 50Hz 380V 106A 1470RPM SF1.00 EFF 93.6% (IE2) | ALT 1000 m.a.s.l. | 952 Lbs | |

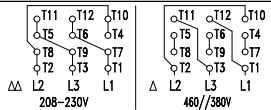

→ 6314-C3(27g) MOBIL POLYREX EM
→ 6314-C3(27g) 12000 h