

MOTOR FRAMES:
324TC-326TC

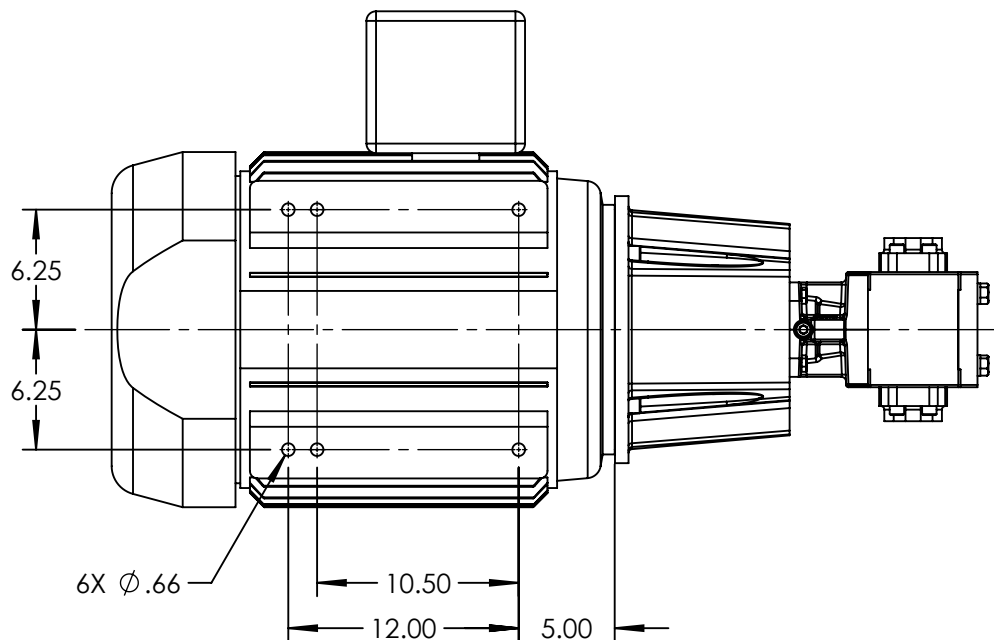
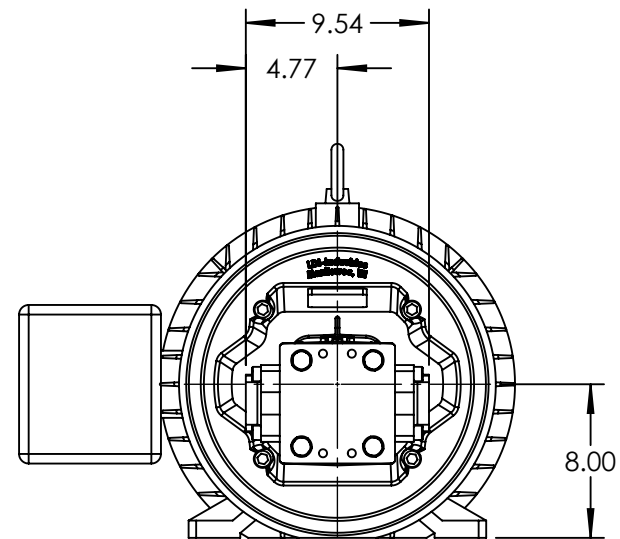
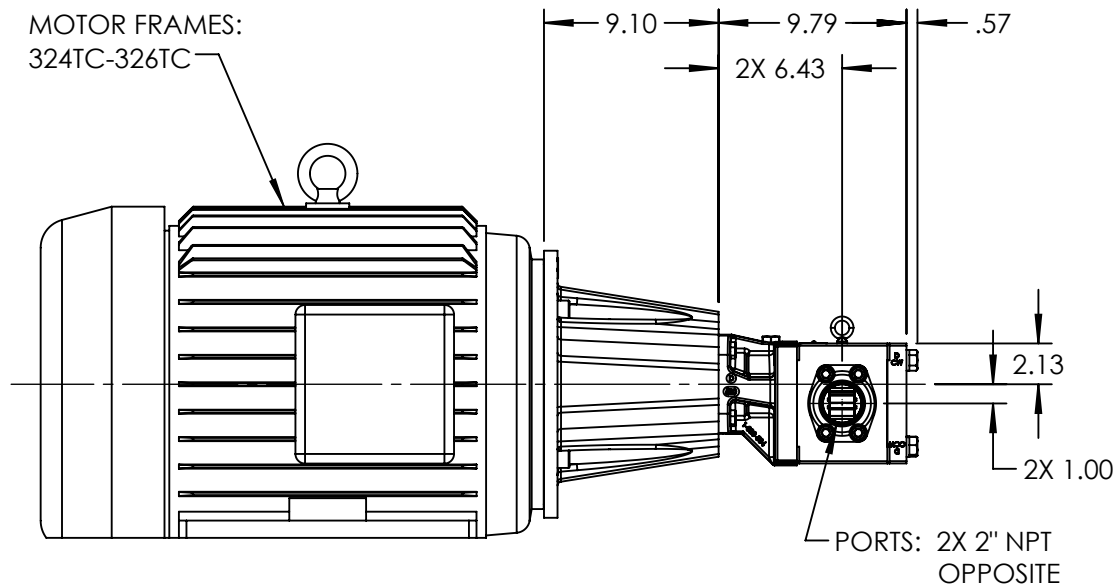

STANDARD MODELS: GB-41013-G00-M, GB-41013-G10-M

NOTES:

1. ALL DIMENSIONS ARE FOR REFERENCE ONLY.

STATE	Released	07/16/2021
DRAWN	bmanernach	7/1/2021
CHECKED	JAG	07/16/2021

DIMENSIONS ARE IN INCHES
PROJECT: E331
WAS:



VIKING PUMP, INC.
A Unit of IDEX Corporation
Cedar Falls, IA 50613
U.S.A.

THIS DRAWING IS THE PROPERTY OF
VIKING PUMP, INC. AND IS PROPRIETARY
IN GENERAL AND DETAIL. IT SHALL NOT BE
COPIED OR ITS CONTENTS REVEALED TO
OUTSIDE PARTIES WITHOUT THE WRITTEN
CONSENT OF VIKING PUMP, INC.

3D

DWG. NO. SHEET 1 OF 1
GPV-1013-042-U

REV. A.0
07/16/2021

DATA SHEET



Three Phase Induction Motor - Squirrel Cage

Customer :																			
Product line	: W22 NEMA Premium Efficiency Three-Phase																		
Product code :	12447129																		
Catalog # :	04018ET3E324TC-W22																		
Frame : 324/6TC Output : 40 HP (30 kW) Poles : 4 Frequency : 60 Hz Rated voltage : 208-230/460 V Rated current : 104-94.2/47.1 A L. R. Amperes : 635-575/287 A LRC : 6.1x(Code G) No load current : 29.3-34.0/17.0 A Rated speed : 1770 rpm Slip : 1.67 % Rated torque : 16.2 kgfm Locked rotor torque : 229 % Breakdown torque : 240 % Insulation class : F Service factor : 1.25 Moment of inertia (J) : 0.3861 kgm ² Design : B	Locked rotor time : 36s (cold) 20s (hot) Temperature rise : 80 K Duty cycle : Cont.(S1) Ambient temperature : -20°C to +40°C Altitude : 1000 m.a.s.l. Protection degree : IP55 Cooling method : IC411 - TEFC Mounting : F-1 Rotation ¹ : Both (CW and CCW) Noise level ² : 66.0 dB(A) Starting method : Direct On Line Approx. weight ³ : 267 kg																		
Output	25% 50% 75% 100%																		
Efficiency (%)	0.000 93.6 94.1 94.1																		
Power Factor	0.00 0.72 0.80 0.85																		
Foundation loads																			
Max. traction	: 438 kgf																		
Max. compression	: 705 kgf																		
	<table border="0"> <tr> <td></td> <td style="text-align: center;"><u>Drive end</u></td> <td style="text-align: center;"><u>Non drive end</u></td> </tr> <tr> <td>Bearing type</td> <td>: 6312 C3</td> <td>6212 C3</td> </tr> <tr> <td>Sealing</td> <td>: V'Ring</td> <td>V'Ring</td> </tr> <tr> <td>Lubrication interval</td> <td>: 20000 h</td> <td>20000 h</td> </tr> <tr> <td>Lubricant amount</td> <td>: 21 g</td> <td>13 g</td> </tr> <tr> <td>Lubricant type</td> <td colspan="2" style="text-align: center;">Mobil Polyrex EM</td> </tr> </table>		<u>Drive end</u>	<u>Non drive end</u>	Bearing type	: 6312 C3	6212 C3	Sealing	: V'Ring	V'Ring	Lubrication interval	: 20000 h	20000 h	Lubricant amount	: 21 g	13 g	Lubricant type	Mobil Polyrex EM	
	<u>Drive end</u>	<u>Non drive end</u>																	
Bearing type	: 6312 C3	6212 C3																	
Sealing	: V'Ring	V'Ring																	
Lubrication interval	: 20000 h	20000 h																	
Lubricant amount	: 21 g	13 g																	
Lubricant type	Mobil Polyrex EM																		
Notes																			
This revision replaces and cancel the previous one, which must be eliminated. (1) Looking the motor from the shaft end. (2) Measured at 1m and with tolerance of +3dB(A). (3) Approximate weight subject to changes after manufacturing process. (4) At 100% of full load.																			
These are average values based on tests with sinusoidal power supply, subject to the tolerances stipulated in NEMA MG-1.																			
Rev.	Changes Summary	Performed	Checked	Date															
Performed by																			
Checked by			Page	Revision															
Date	14/02/2020		1 / 6																

TORQUE AND CURRENT VS SPEED CURVE

Three Phase Induction Motor - Squirrel Cage



Customer :

Product line : W22 NEMA Premium Efficiency
Three-Phase

Product code : 12447129

Catalog # : 04018ET3E324TC-W22

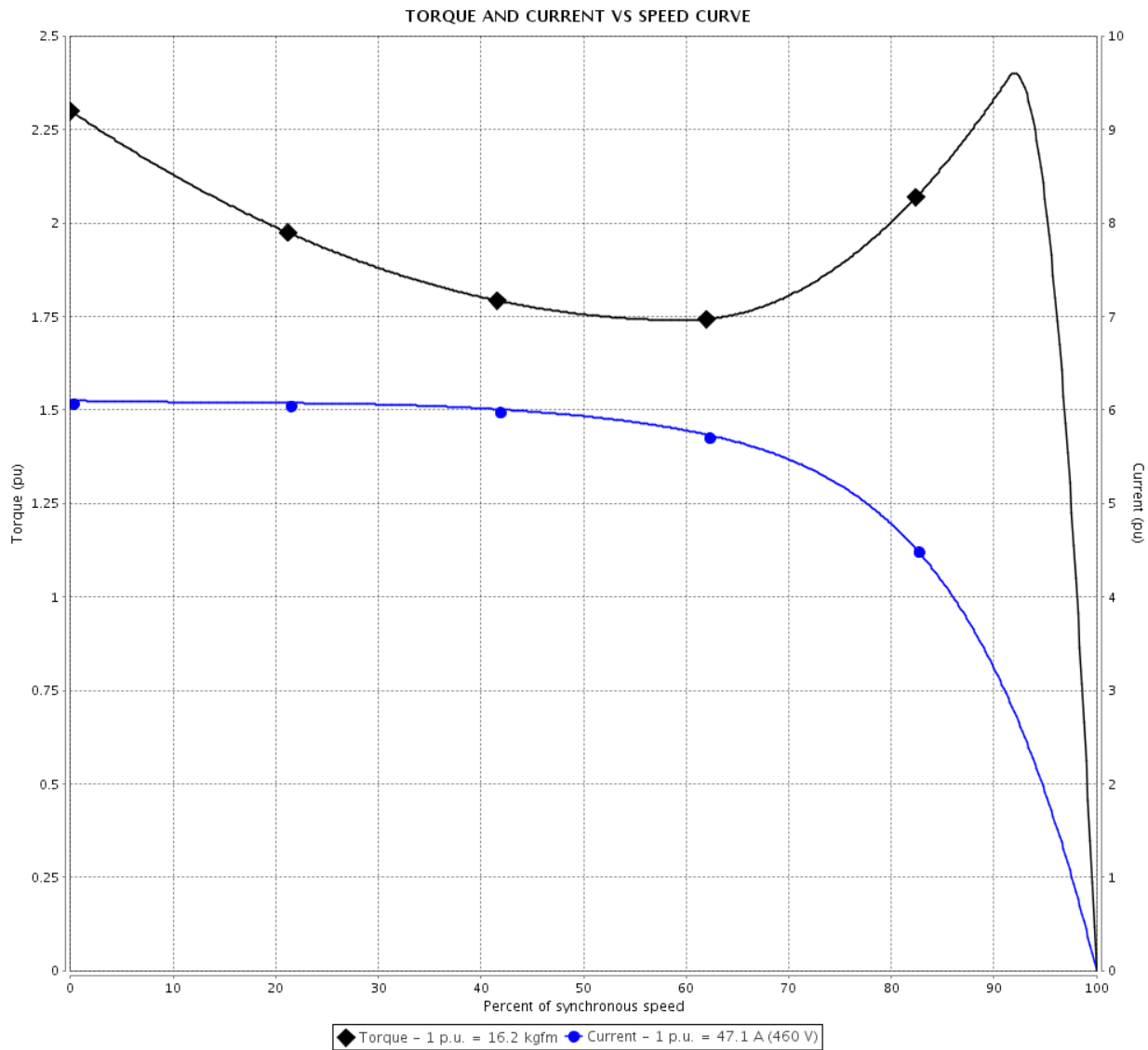

Performance : 208-230/460 V 60 Hz 4P

Rated current	: 104-94.2/47.1 A	Moment of inertia (J)	: 0.3861 kgm ²
LRC	: 6.1	Duty cycle	: Cont.(S1)
Rated torque	: 16.2 kgfm	Insulation class	: F
Locked rotor torque	: 229 %	Service factor	: 1.25
Breakdown torque	: 240 %	Temperature rise	: 80 K
Rated speed	: 1770 rpm	Design	: B

Locked rotor time : 36s (cold) 20s (hot)

Rev.	Changes Summary	Performed	Checked	Date
Performed by			Page 2 / 6	Revision
Checked by				
Date	14/02/2020			

LOAD PERFORMANCE CURVE

Three Phase Induction Motor - Squirrel Cage



Customer :

Product line : W22 NEMA Premium Efficiency Three-Phase

Product code : 12447129

Catalog # : 04018ET3E324TC-W22

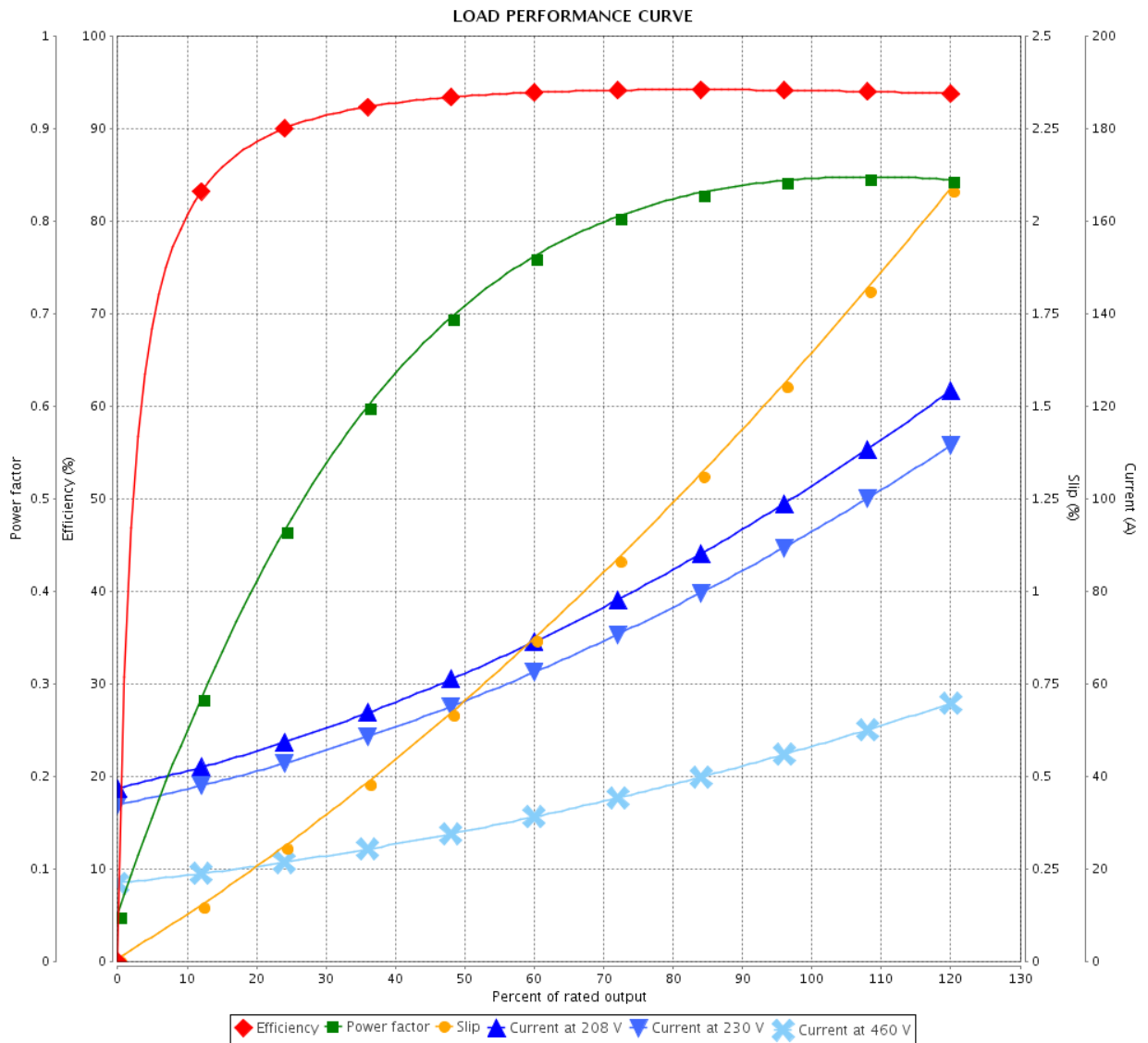

Performance : 208-230/460 V 60 Hz 4P

Rated current : 104-94.2/47.1 A
 LRC : 6.1
 Rated torque : 16.2 kgfm
 Locked rotor torque : 229 %
 Breakdown torque : 240 %
 Rated speed : 1770 rpm

Moment of inertia (J) : 0.3861 kgm²
 Duty cycle : Cont.(S1)
 Insulation class : F
 Service factor : 1.25
 Temperature rise : 80 K
 Design : B

Rev.	Changes Summary	Performed	Checked	Date
Performed by		Page		Revision
Checked by		3 / 6		
Date		14/02/2020		

THERMAL LIMIT CURVE



Three Phase Induction Motor - Squirrel Cage

Customer :

Product line : W22 NEMA Premium Efficiency
Three-Phase

Product code : 12447129

Catalog # : 04018ET3E324TC-W22

Performance : 208-230/460 V 60 Hz 4P

Rated current : 104-94.2/47.1 A
LRC : 6.1
Rated torque : 16.2 kgfm
Locked rotor torque : 229 %
Breakdown torque : 240 %
Rated speed : 1770 rpm

Moment of inertia (J) : 0.3861 kgm²
Duty cycle : Cont.(S1)
Insulation class : F
Service factor : 1.25
Temperature rise : 80 K
Design : B

Heating constant

Cooling constant

Rev.	Changes Summary	Performed	Checked	Date
Performed by				
Checked by			Page	Revision
Date	14/02/2020		4 / 6	

THERMAL LIMIT CURVE

Three Phase Induction Motor - Squirrel Cage



Customer : _____

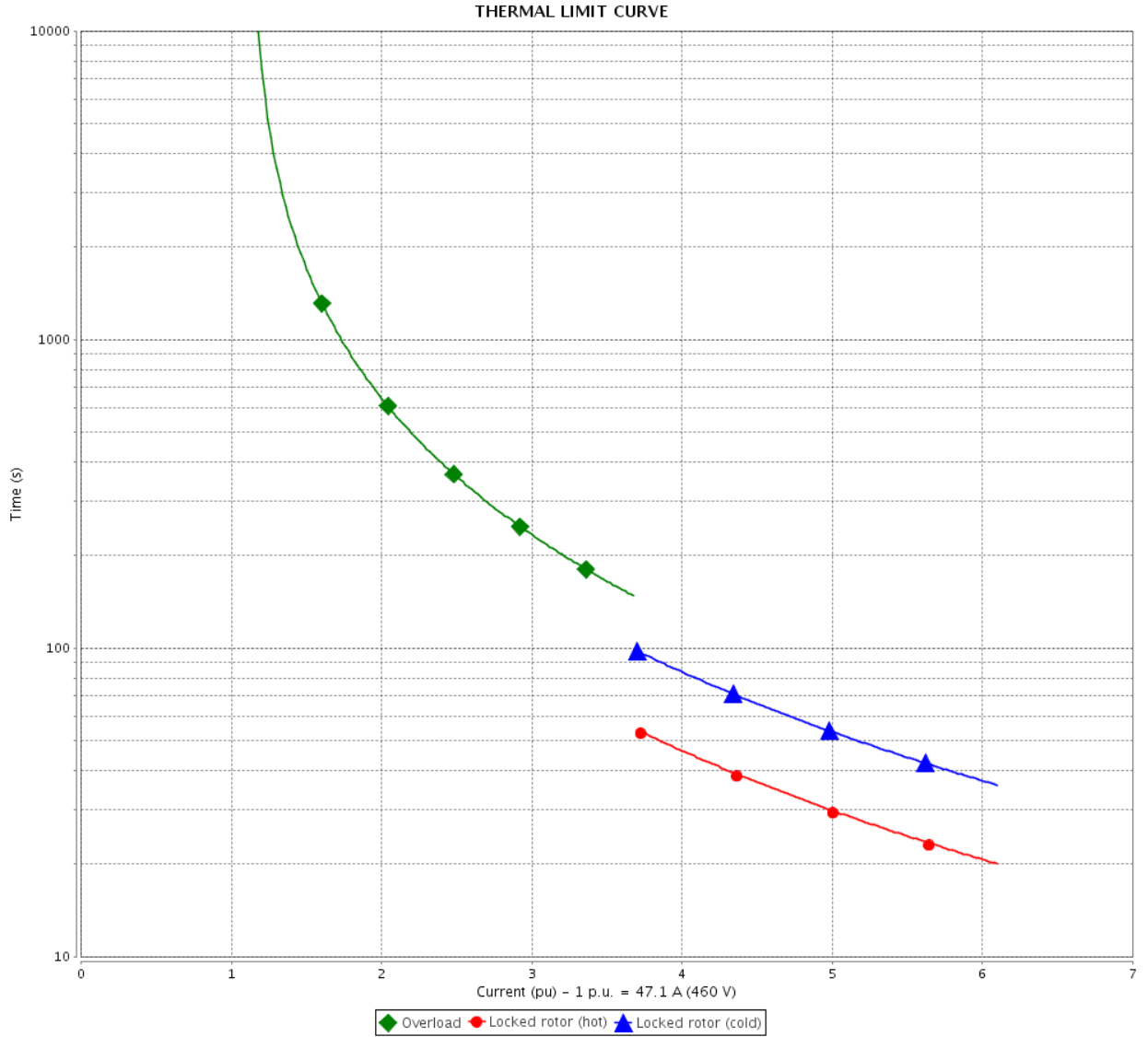

Rev.	Changes Summary	Performed	Checked	Date
Performed by		Page 5 / 6		Revision
Checked by				
Date				

VFD OPERATION CURVE

Three Phase Induction Motor - Squirrel Cage



Customer :

Product line : W22 NEMA Premium Efficiency
Three-Phase

Product code : 12447129

Catalog # : 04018ET3E324TC-W22

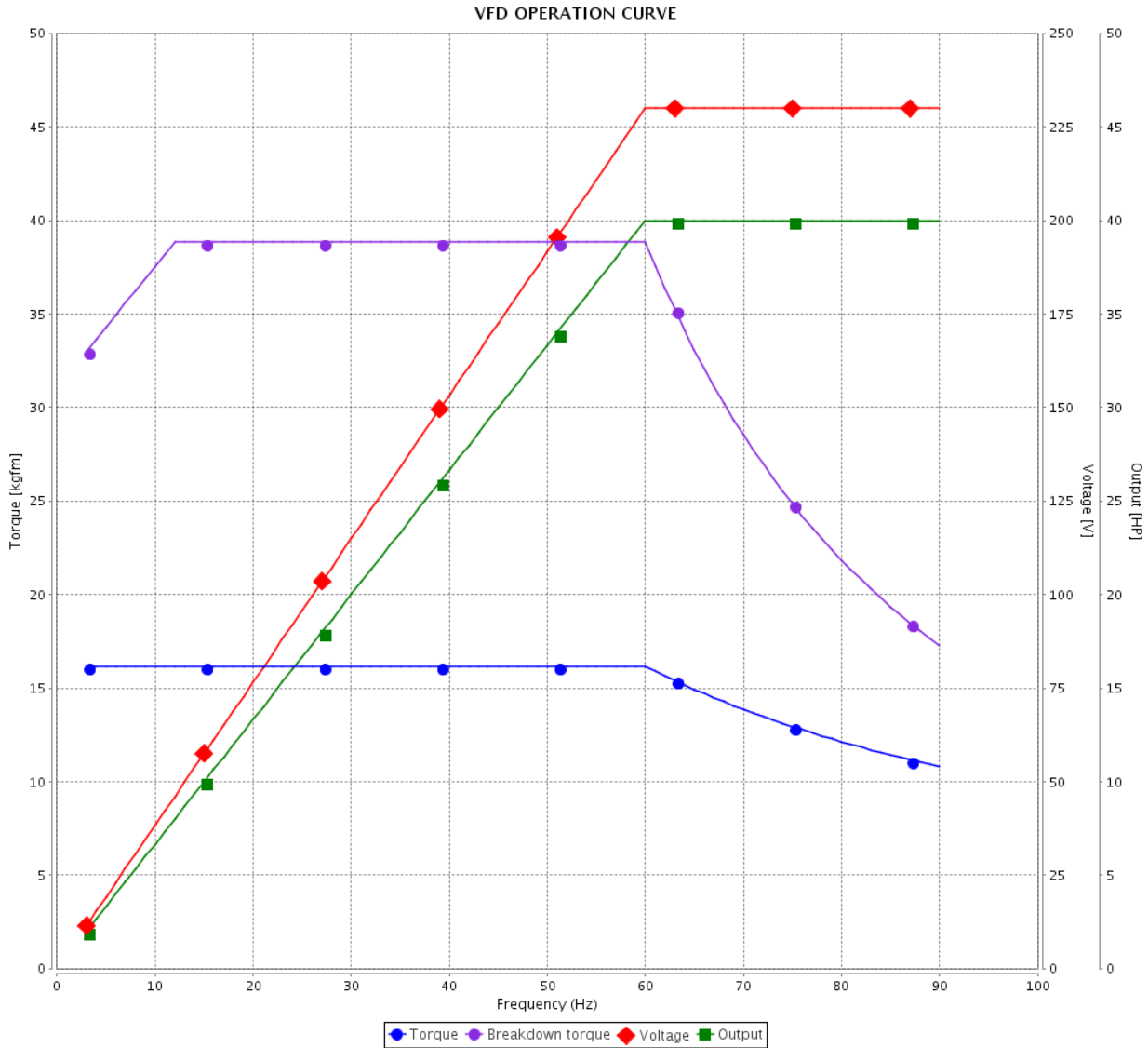

Performance : 208-230/460 V 60 Hz 4P

Rated current : 104-94.2/47.1 A
 LRC : 6.1
 Rated torque : 16.2 kgfm
 Locked rotor torque : 229 %
 Breakdown torque : 240 %
 Rated speed : 1770 rpm

Moment of inertia (J) : 0.3861 kgm²
 Duty cycle : Cont.(S1)
 Insulation class : F
 Service factor : 1.25
 Temperature rise : 80 K
 Design : B

Rev.	Changes Summary	Performed	Checked	Date
Performed by			Page 6 / 6	Revision
Checked by				
Date	14/02/2020			

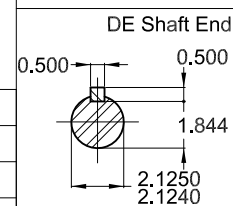
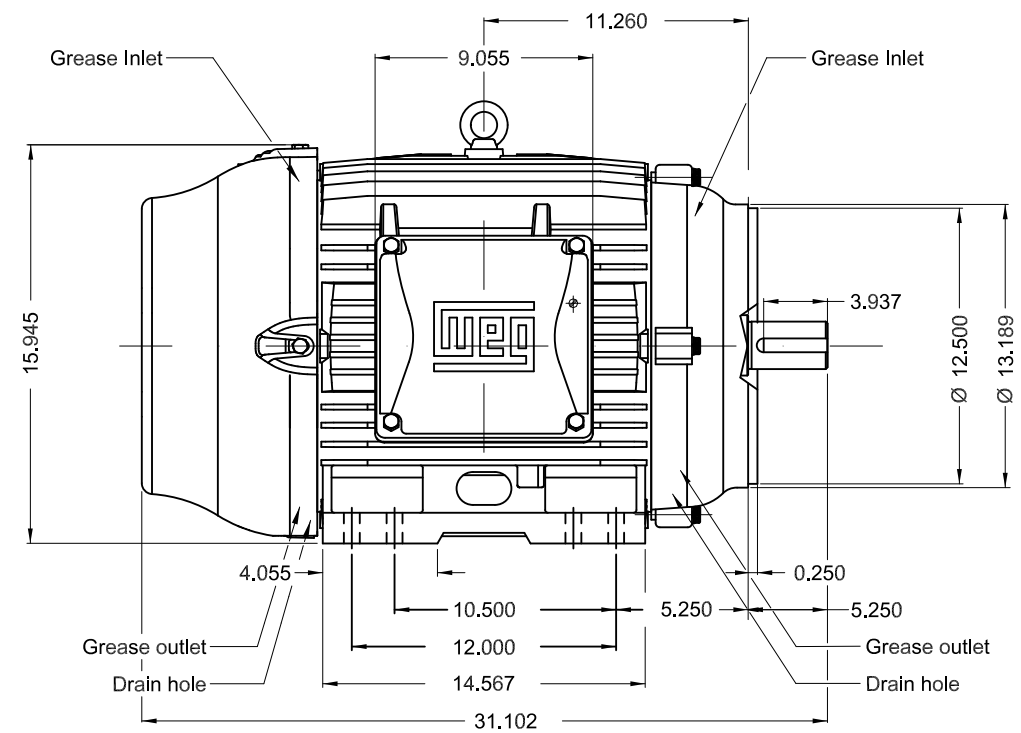
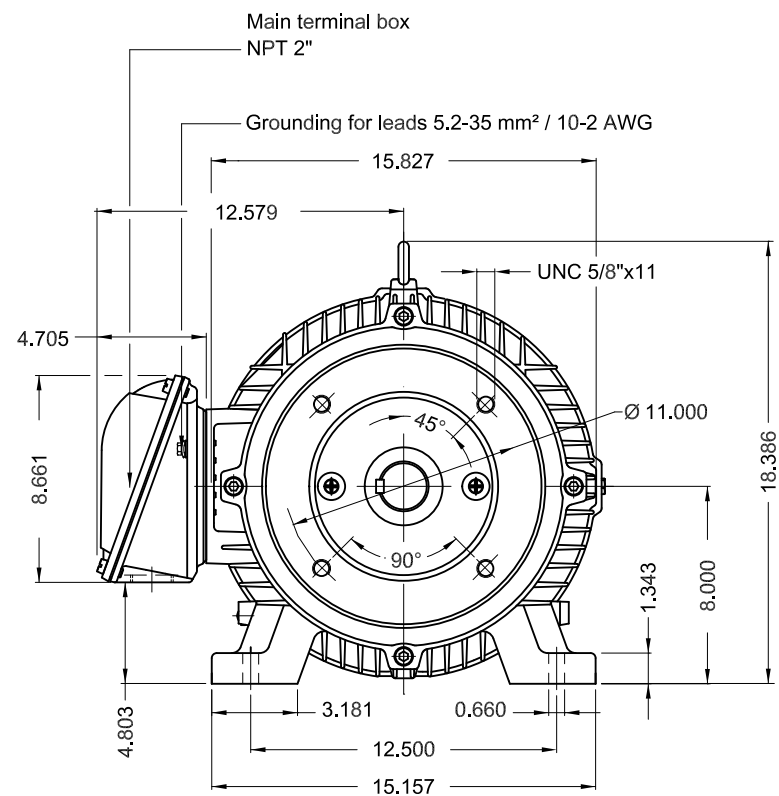

Without vertical jackscrews
 Color RAL 5009
 Painting plan 203A
 Mounting B34R(D)

40 HP 04 Poles 60Hz

A

ECM	LOC	SUMMARY OF MODIFICATIONS	EXECUTED	CHECKED	RELEASED	DATE	VER
EXECUTED	PIRWBUSER	THREE PHASE W22 MOTOR - NEMA PREMIUM EFF					
CHECKED		FRAME 324/6TC IP55 TEFC					
RELEASED							
REL DT.	WMO	Jaragua do Sul	Product Engineering				

PREVIEW
 WDD



SHEET 1 / 1

Dimensions in inches

XME A3

MODEL 04018ET3E324TC-W22
MADE IN MEXICO
12447129



Inverter Duty Motor
Severe Duty



FOR SAFE AREA
MOD.TE1BFOXON



For 60Hz: Class I, Div 2, Gr. A, B, C and D - T3
Class I, Zone 2, IIC - T3

Class II, Div 2, Gr. F and G - T4

For 60Hz use on PWM, Gr. A, B, C, D and F,
VT 1000:1, CT 20:1, 1.0SF, T3A

PH 3	FR 324/6TC	HP(kW) 40.0(30.0)	Hz 60
V 230/460	A 94.2/47.1	RPM 1770	DES B
NEMA NOM EFF 94.1 %	INS. CL. F Δ T 80 K	IP55	
ENCL TEFC	DUTY CONT.	AMB. 40°C	
CODE G	PF 0.85	SF 1.25	SFA 118/58.9
USABLE @208V 104 A	SF 1.15	SFA 120	
40HP 30kW 50Hz 380V 57.4A 1460RPM SF1.00 EFF 92.4% (IE2)	ALT 1000 m.a.s.l.	591 Lbs	

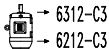
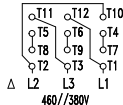
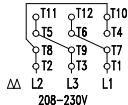

MOBIL POLYREX EM
21 g 20000 h