

GENERAL ARRANGEMENT DETAILS

PUMP INFORMATION

PUMP MODEL	STERILOBE SLAS/0039/15
LEFT/TOP CONNECTION	0.75" TRI-CLAMP
RIGHT/BOTTOM CONNECTION	0.75" TRI-CLAMP
DRIVE SHAFT POSITION	LEFT HAND DRIVE
FRONT COVER ADDITIONS	STANDARD
ROTORCASE ADDITIONS	STANDARD
GEARBOX ADDITIONS	STANDARD
PUMP ADDITIONS	STANDARD

THIS IS NOT A CERTIFIED DRAWING, USE FOR GENERAL INSTALLATION ONLY

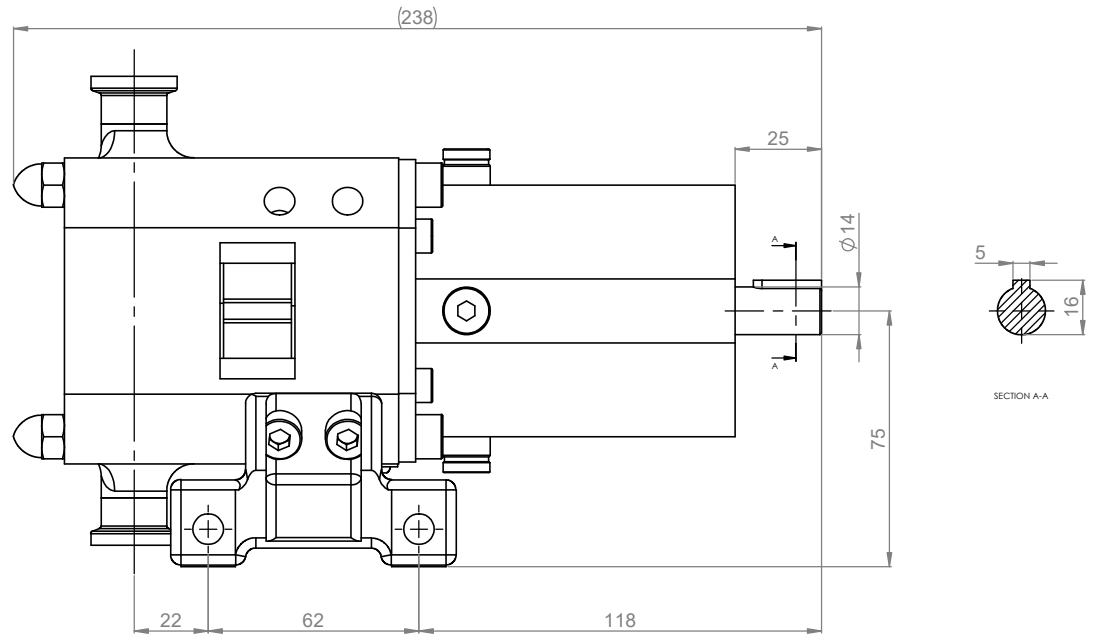
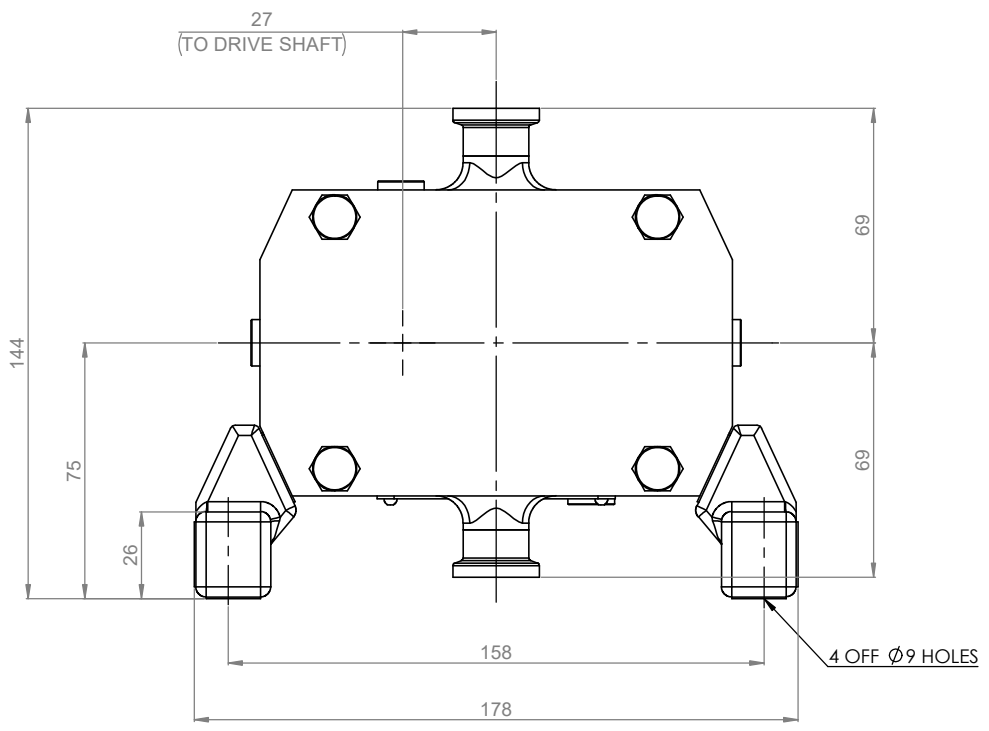
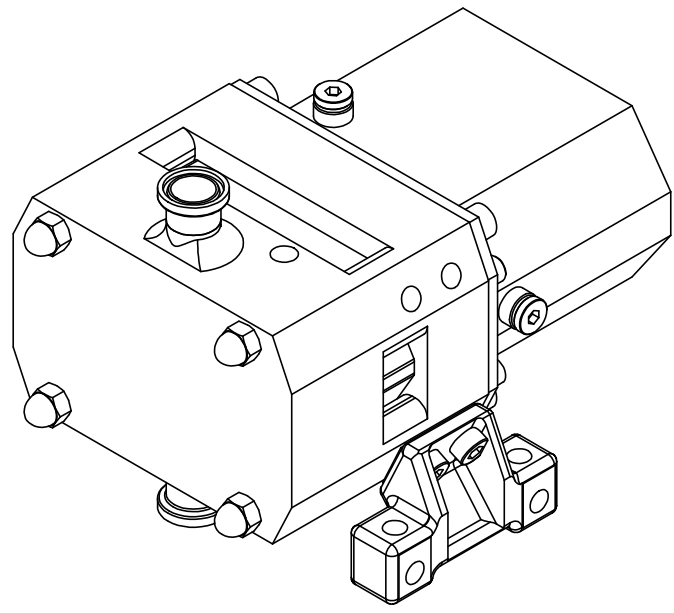

UPDATED TO CURRENT STANDARD		B	21/04/2022
AMENDMENT		ISSUE	DATE

VIKING PUMP
 HYGIENIC
 HIGHFIELD INDUSTRIAL ESTATE,
 EAST SUSSEX, BN23 6PT
 TEL: (+44) 1323 508211

COPYRIGHT:
 THIS DRAWING IS THE SOLE
 PROPERTY OF
VIKING PUMP HYGIENIC LTD.
 IT MUST NOT BE COPIED OR USED
 IN PART OR FULL, WITHOUT PRIOR
 WRITTEN CONSENT.

UNLESS OTHERWISE STATED:
 ALL DIMENSIONS ± 2.50
 ANGLES ±2.0°
 DO NOT SCALE THIS DRAWING
 REMOVE BURRS AND SHARP EDGES
 DIMENSIONS IN MILLIMETRES
IF IN DOUBT ASK

PROJECTION	DRAWN	CHECKED
	MEW	KCB

TITLE:	GENERAL ARRANGEMENT
DWG NO:	SLAS-TC-LEFT