

MOTOR FRAMES:  
284TC-286TC

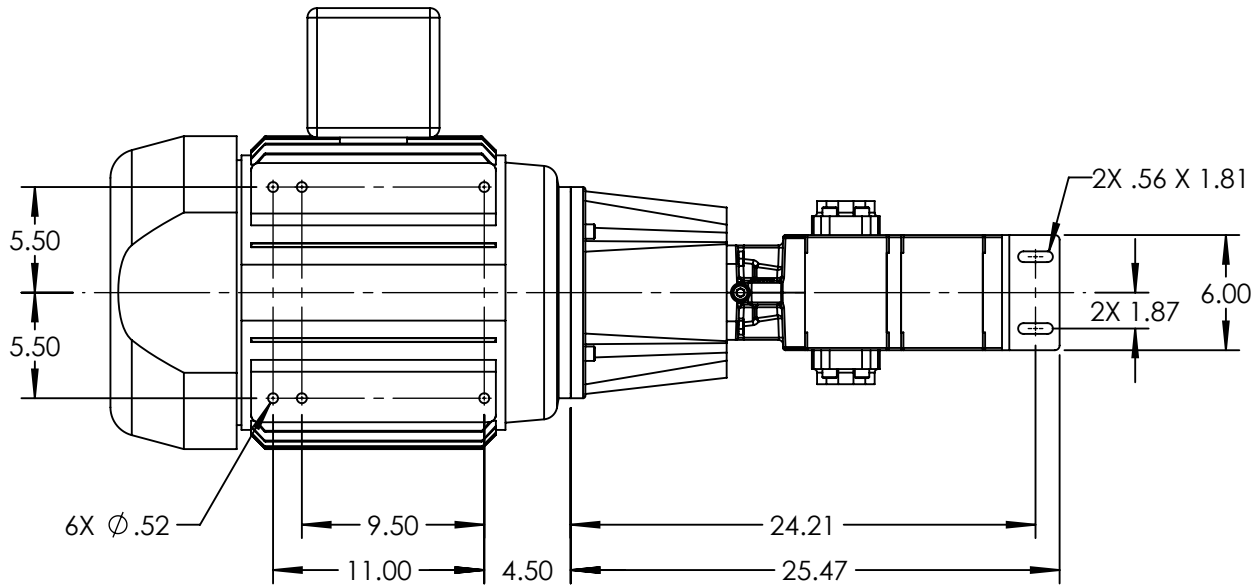
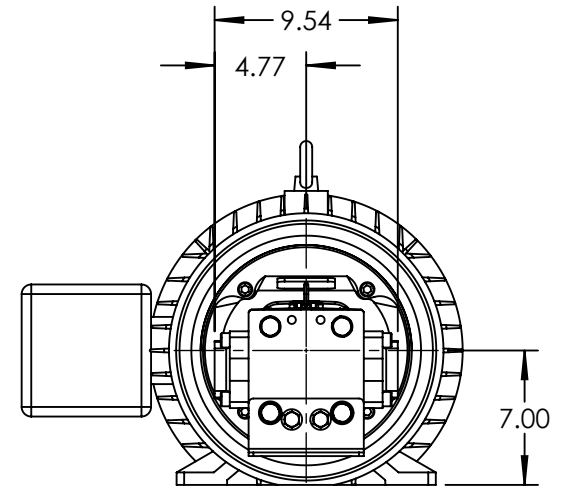
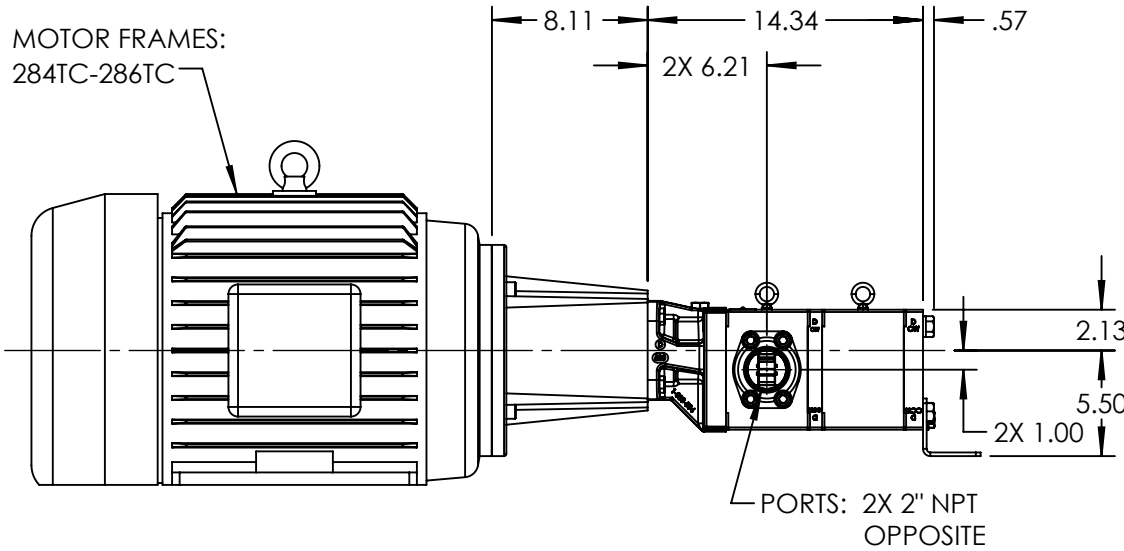

STANDARD MODELS: GB-41018-G00-M, GB-41018-G10-M

NOTES:

1. ALL DIMENSIONS ARE FOR REFERENCE ONLY.

STATE	Released	07/15/2021
DRAWN	bmanternach	6/23/2021
CHECKED	JAG	07/15/2021

DIMENSIONS ARE IN INCHES
PROJECT: E331
WAS:



VIKING PUMP, INC.  
A Unit of IDEX Corporation  
Cedar Falls, IA 50613  
U.S.A.

THIS DRAWING IS THE PROPERTY OF  
VIKING PUMP, INC. AND IS PROPRIETARY  
IN GENERAL AND DETAIL. IT SHALL NOT BE  
COPIED OR ITS CONTENTS REVEALED TO  
OUTSIDE PARTIES WITHOUT THE WRITTEN  
CONSENT OF VIKING PUMP, INC.

3D

DWG. NO. GPV-1018-031-U  
SHEET 1 OF 1

REV. A.0  
07/15/2021



# TORQUE AND CURRENT VS SPEED CURVE

Three Phase Induction Motor - Squirrel Cage



Customer :

Product line : W22 NEMA Premium Efficiency  
Three-Phase

Product code : 11457085

Catalog # : 03018ET3E286TC-W22

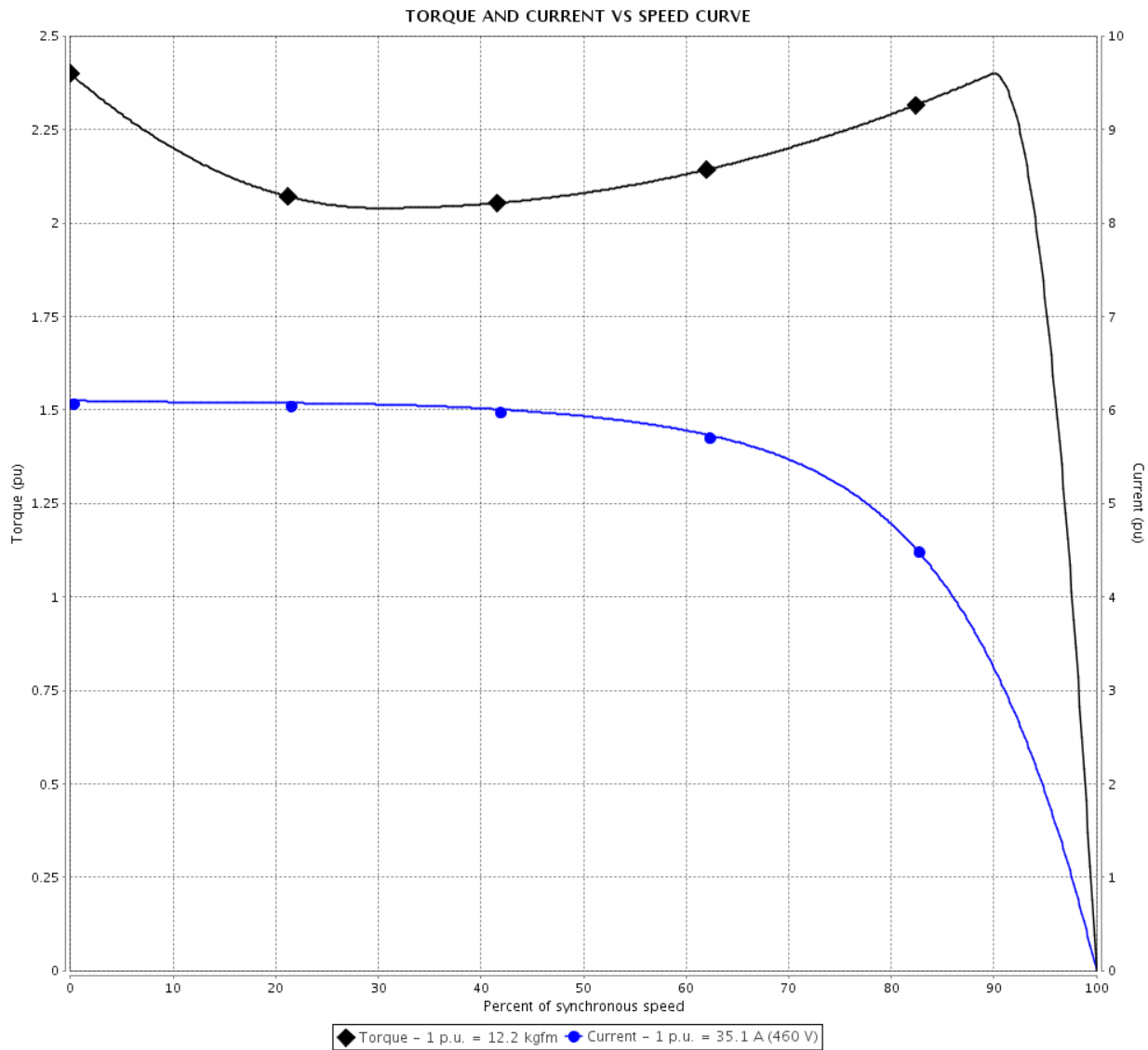

Performance : 208-230/460 V 60 Hz 4P

Rated current	: 77.6-70.2/35.1 A	Moment of inertia (J)	: 0.2467 kgm <sup>2</sup>
LRC	: 6.1	Duty cycle	: Cont.(S1)
Rated torque	: 12.2 kgfm	Insulation class	: F
Locked rotor torque	: 240 %	Service factor	: 1.25
Breakdown torque	: 240 %	Temperature rise	: 80 K
Rated speed	: 1765 rpm	Design	: B

Locked rotor time : 36s (cold) 20s (hot)

Rev.	Changes Summary	Performed	Checked	Date
Performed by			Page 2 / 6	Revision
Checked by				
Date	14/02/2020			

# LOAD PERFORMANCE CURVE

## Three Phase Induction Motor - Squirrel Cage



Customer :

Product line : W22 NEMA Premium Efficiency Three-Phase

Product code : 11457085

Catalog # : 03018ET3E286TC-W22

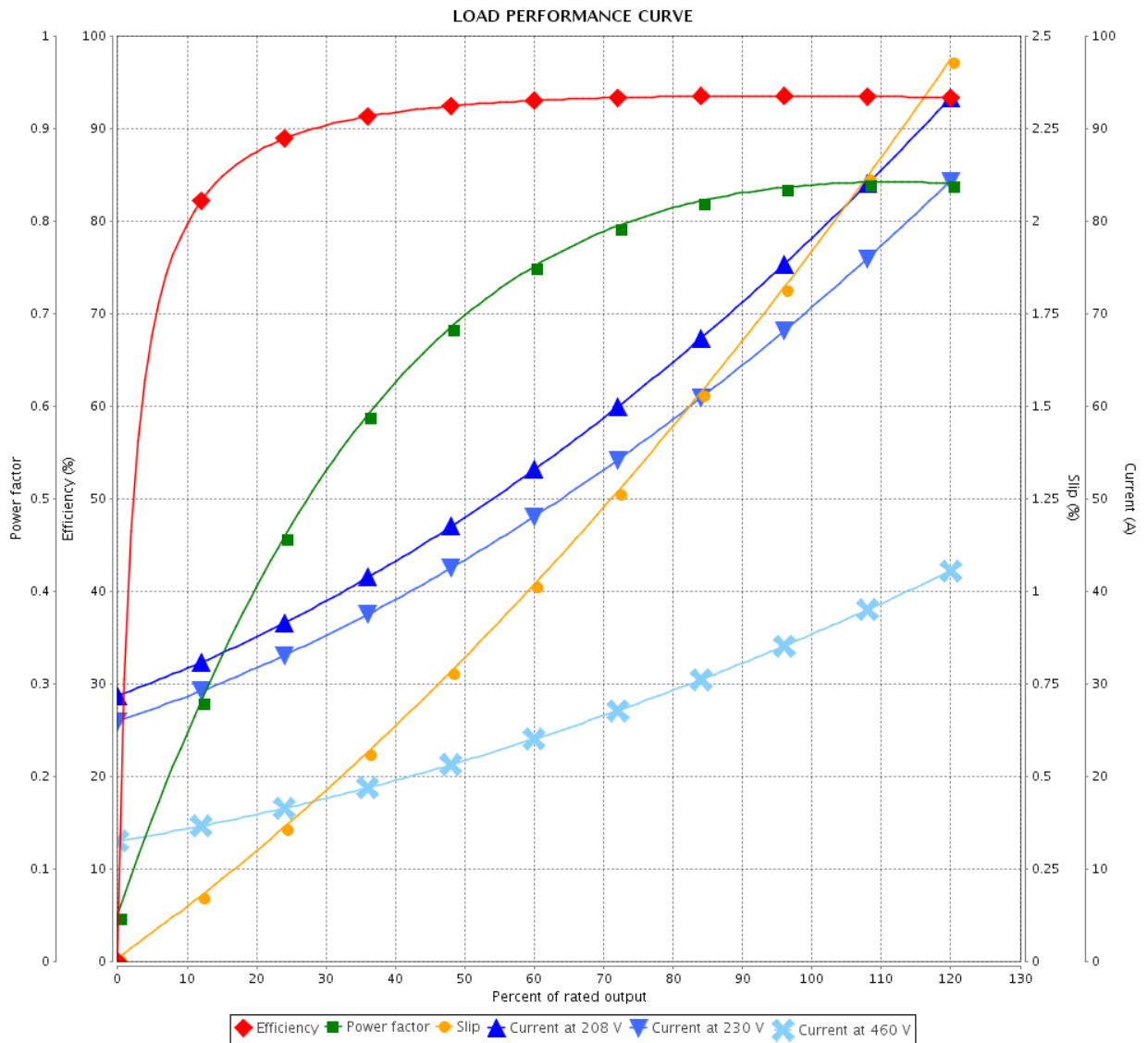

Performance : 208-230/460 V 60 Hz 4P

Rated current : 77.6-70.2/35.1 A  
 LRC : 6.1  
 Rated torque : 12.2 kgfm  
 Locked rotor torque : 240 %  
 Breakdown torque : 240 %  
 Rated speed : 1765 rpm

Moment of inertia (J) : 0.2467 kgm<sup>2</sup>  
 Duty cycle : Cont.(S1)  
 Insulation class : F  
 Service factor : 1.25  
 Temperature rise : 80 K  
 Design : B

Rev.	Changes Summary	Performed	Checked	Date
Performed by		Page		Revision
Checked by		3 / 6		
Date		14/02/2020		

# THERMAL LIMIT CURVE

## Three Phase Induction Motor - Squirrel Cage



Customer :

Product line : W22 NEMA Premium Efficiency  
Three-Phase

Product code : 11457085

Catalog # : 03018ET3E286TC-W22

Performance : 208-230/460 V 60 Hz 4P

Rated current : 77.6-70.2/35.1 A  
LRC : 6.1  
Rated torque : 12.2 kgfm  
Locked rotor torque : 240 %  
Breakdown torque : 240 %  
Rated speed : 1765 rpm

Moment of inertia (J) : 0.2467 kgm<sup>2</sup>  
Duty cycle : Cont.(S1)  
Insulation class : F  
Service factor : 1.25  
Temperature rise : 80 K  
Design : B

Heating constant

Cooling constant

Rev.	Changes Summary	Performed	Checked	Date
Performed by				
Checked by			Page	Revision
Date	14/02/2020		4 / 6	

# THERMAL LIMIT CURVE

Three Phase Induction Motor - Squirrel Cage



Customer : \_\_\_\_\_

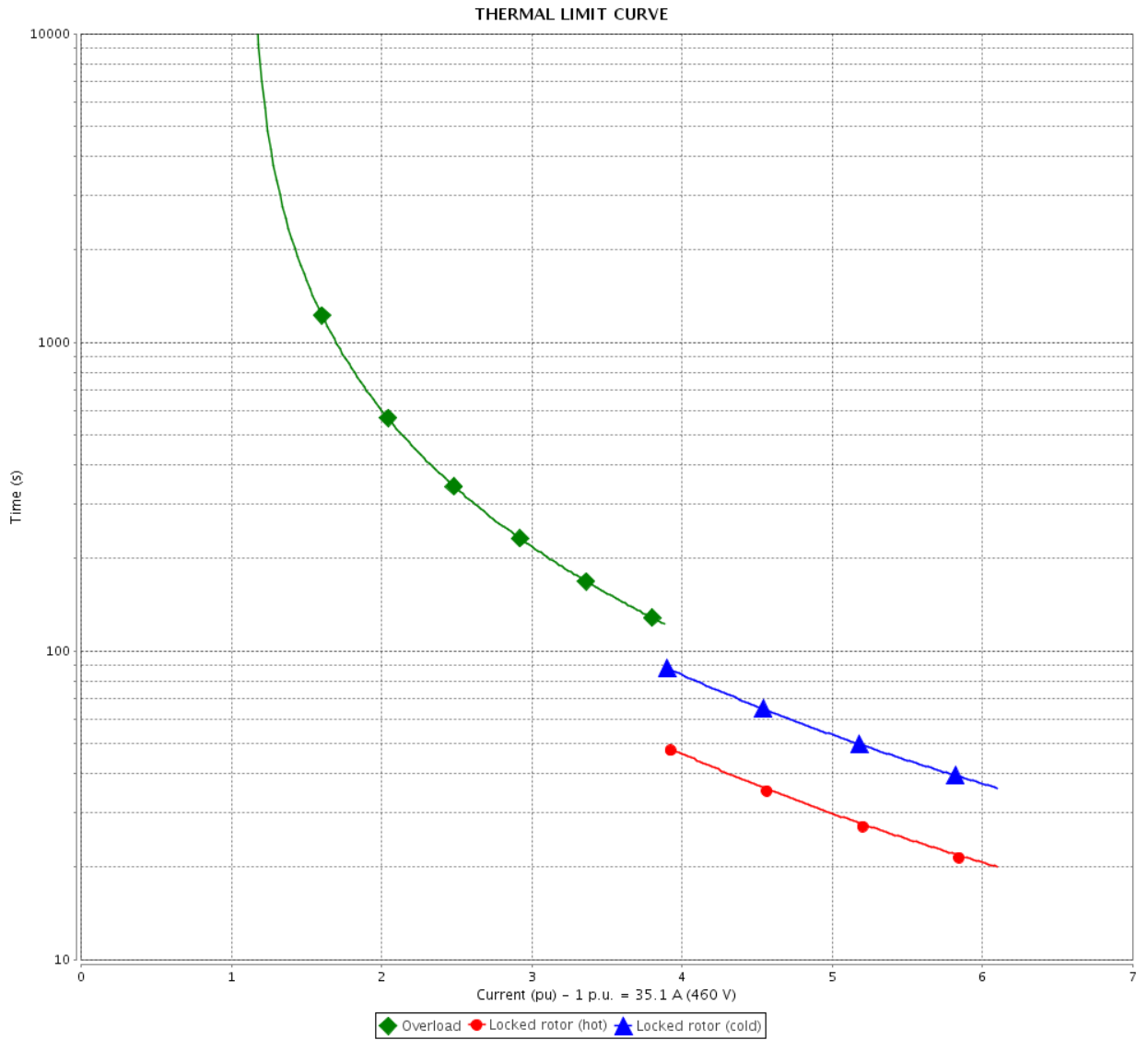

Rev.	Changes Summary	Performed	Checked	Date
Performed by		Page 5 / 6		Revision
Checked by				
Date				

# VFD OPERATION CURVE

Three Phase Induction Motor - Squirrel Cage

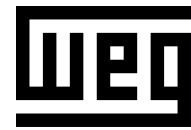

Customer :

Product line : W22 NEMA Premium Efficiency Three-Phase

Product code : 11457085

Catalog # : 03018ET3E286TC-W22

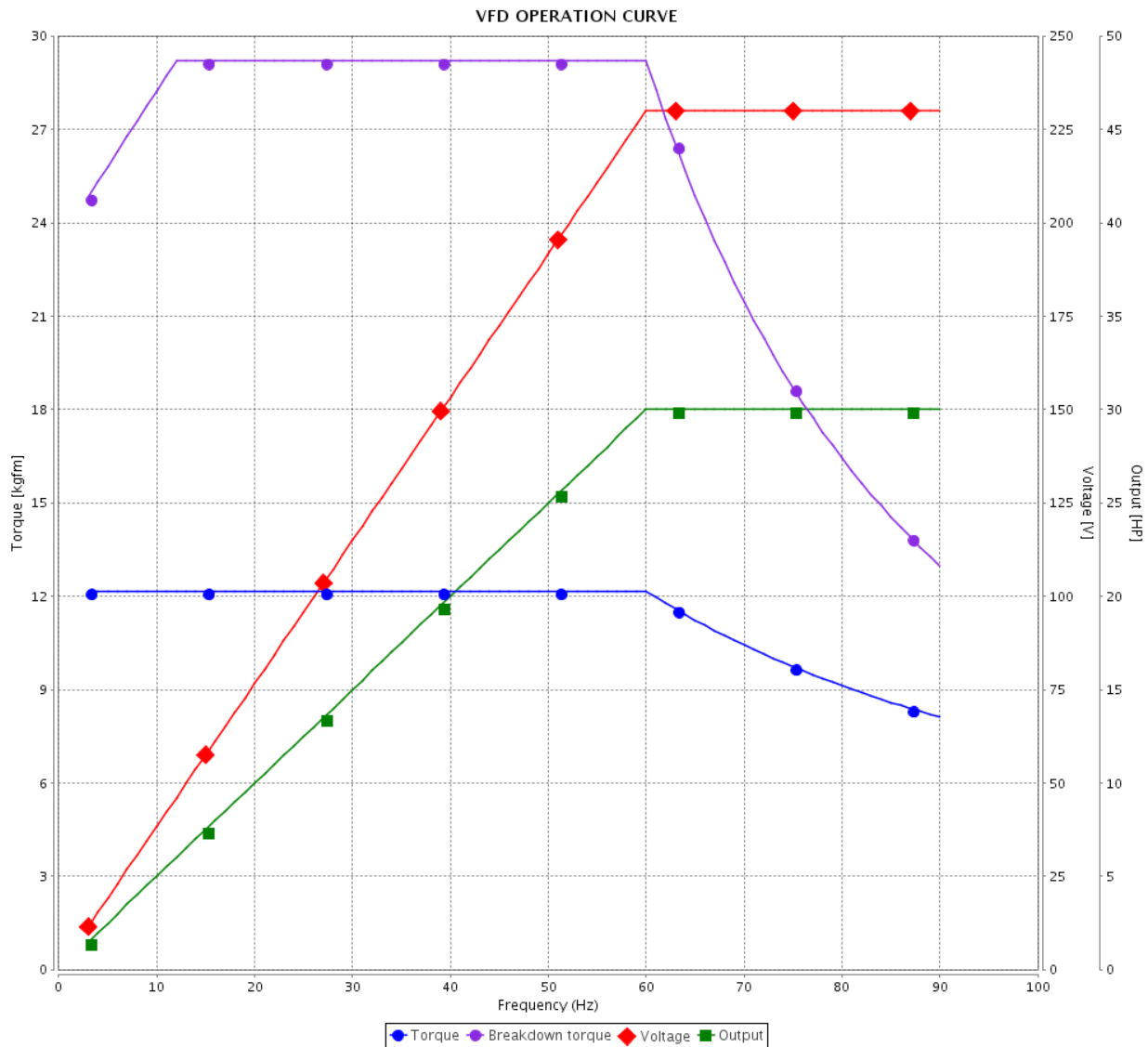

Performance : 208-230/460 V 60 Hz 4P

Rated current : 77.6-70.2/35.1 A  
 LRC : 6.1  
 Rated torque : 12.2 kgfm  
 Locked rotor torque : 240 %  
 Breakdown torque : 240 %  
 Rated speed : 1765 rpm

Moment of inertia (J) : 0.2467 kgm<sup>2</sup>  
 Duty cycle : Cont.(S1)  
 Insulation class : F  
 Service factor : 1.25  
 Temperature rise : 80 K  
 Design : B

Rev.	Changes Summary	Performed	Checked	Date
Performed by			Page 6 / 6	Revision
Checked by				
Date	14/02/2020			

1 2 3 4 5 6

A

B

C

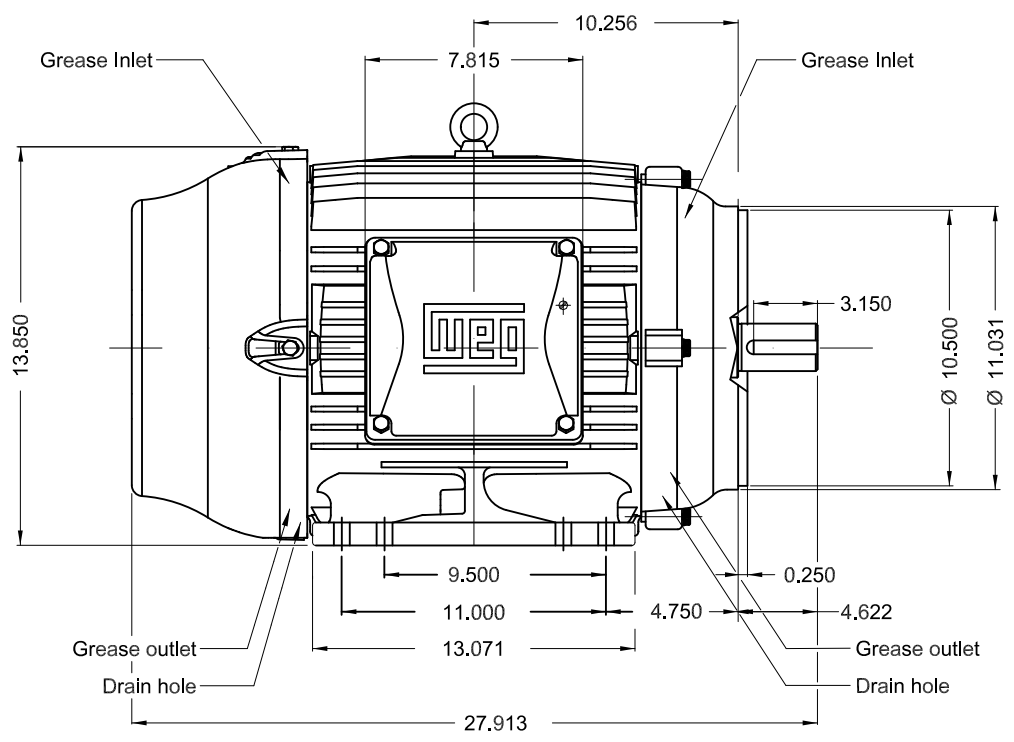
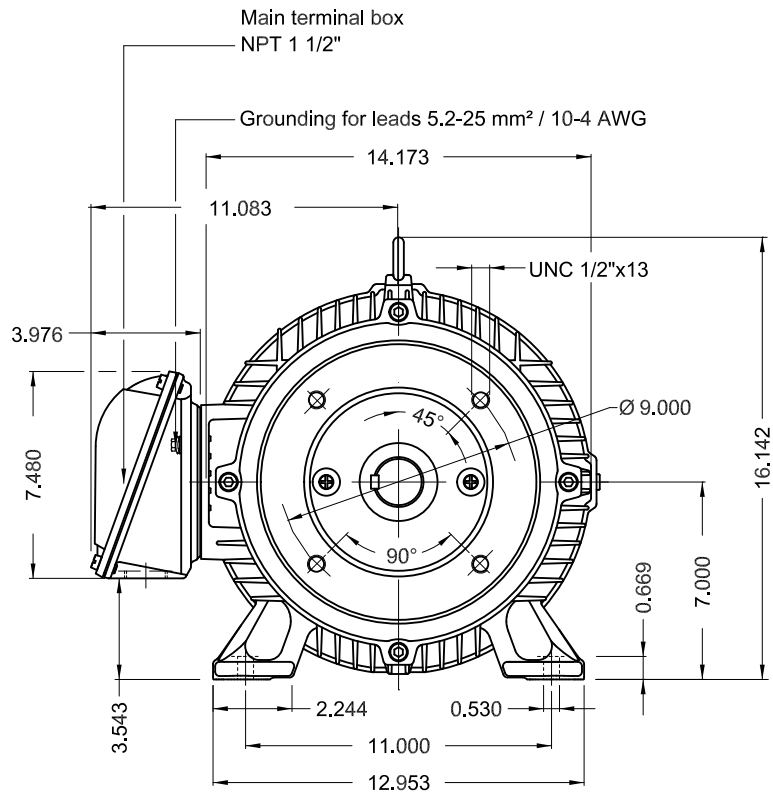

D

E

Color RAL 5009  
 Painting plan 203A  
 Mounting B34R(D)

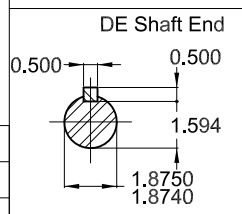

30 HP 04 Poles 60Hz A

ECM	LOC	SUMMARY OF MODIFICATIONS	EXECUTED	CHECKED	RELEASED	DATE	VER
EXECUTED	PIRWBUSER	THREE PHASE W22 MOTOR - NEMA PREMIUM EFF FRAME 284/6TC IP55 TEFC					
CHECKED							
RELEASED							
REL DT.	WMO		Jaragua do Sul	Product Engineering	SHEET	1 / 1	

PREVIEW  
 WDD





MODEL 03018ET3E286TC-W22  
MADE IN BRAZIL  
11457085



FOR SAFE AREA  
MOD.TE1BFOXON



For 60Hz: Class I, Div 2, Gr. A, B, C and D - T3  
Class I, Zone 2, IIC - T3  
Class II, Div 2, Gr. F and G - T4  
For 60Hz use on PWM, Gr. A, B, C, D and F,  
VT 1000:1, CT 20:1, 1.0SF, T3A

PH 3	FR 284/6TC	HP(kW) 30.0(22.0)	Hz 60
V 230/460	A 70.2/35.1	RPM 1765	DES B
NEMA NOM EFF 93.6 %	INS. CL. F $\Delta$ T 80 K	IP55	
ENCL TEFC	DUTY CONT.	AMB. 40°C	
CODE G	PF 0.84	SF 1.25	SFA 87.8/43.9
USABLE @208V 77.6 A	SF 1.15	SFA 89.2	
30HP 22kW 50Hz 380V 43.1A 1445RPM SF1.00 EFF 90.2% (IE1)	ALT 1000 m.a.s.l.	459 Lbs	

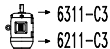
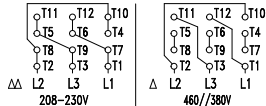

MOBIL POLYREX EM  
18 g 20000 h