

MOTOR FRAMES:
284TC-286TC

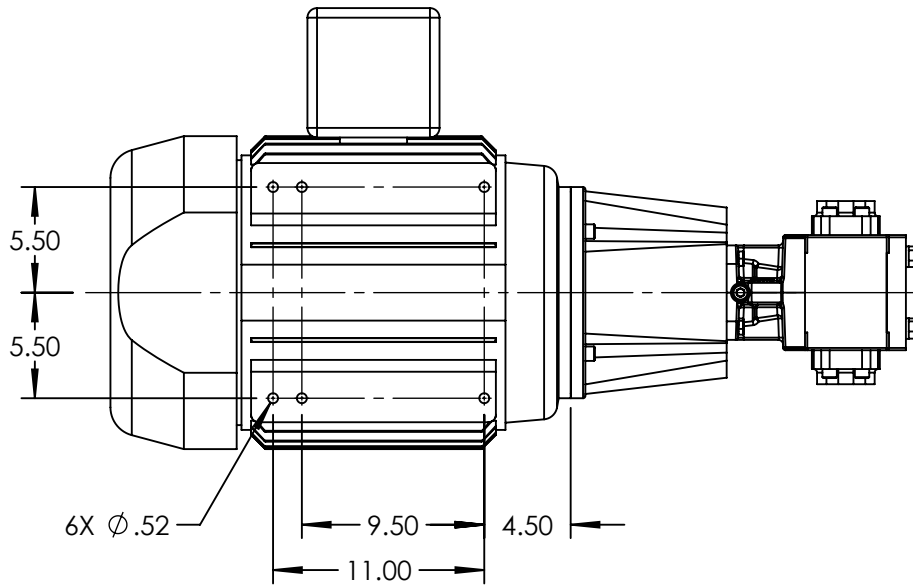
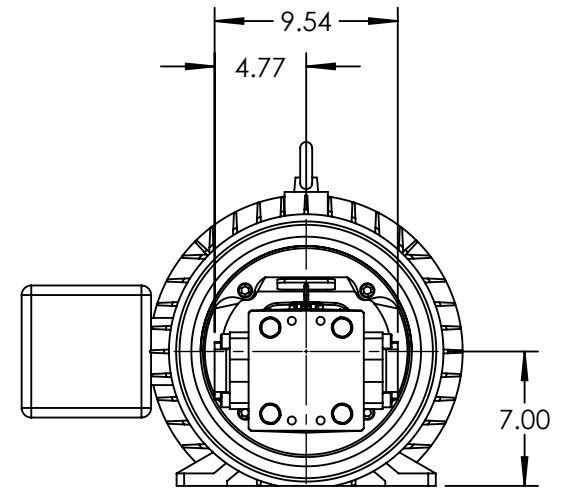
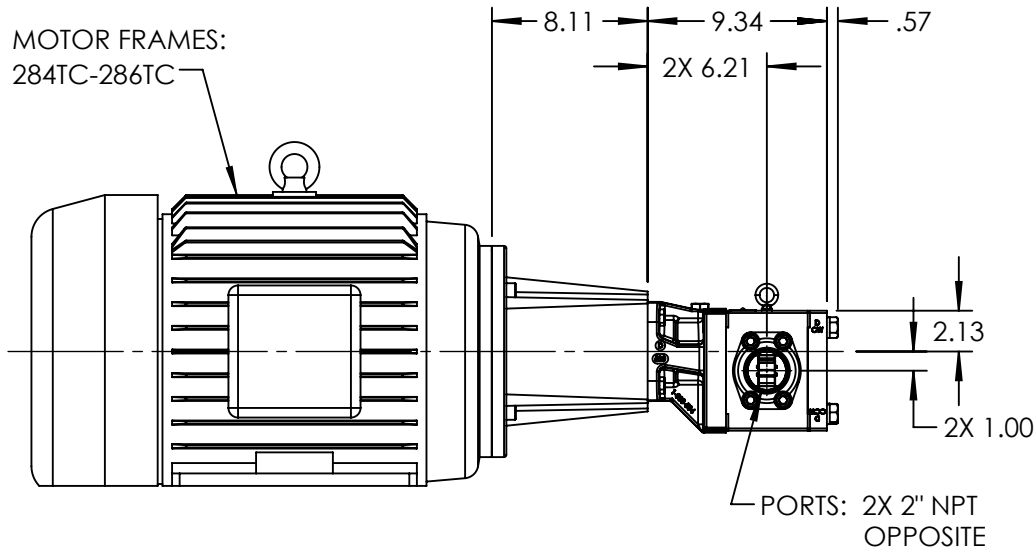

STANDARD MODELS: GB-41009-G00-M, GB-41009-G10-M

NOTES:

1. ALL DIMENSIONS ARE FOR REFERENCE ONLY.

STATE	Released	07/16/2021
DRAWN	bmanernach	6/23/2021
CHECKED	JAG	07/16/2021

DIMENSIONS ARE IN INCHES
PROJECT: E331
WAS:



VIKING PUMP, INC.
A Unit of IDEX Corporation
Cedar Falls, IA 50613
U.S.A.

THIS DRAWING IS THE PROPERTY OF
VIKING PUMP, INC. AND IS PROPRIETARY
IN GENERAL AND DETAIL. IT SHALL NOT BE
COPIED OR ITS CONTENTS REVEALED TO
OUTSIDE PARTIES WITHOUT THE WRITTEN
CONSENT OF VIKING PUMP, INC.

3D

DWG. NO. SHEET 1 OF 1
GPV-1009-032-U

REV. A.0
07/16/2021

DATA SHEET



Three Phase Induction Motor - Squirrel Cage

Customer :																																		
Product line		: W22 NEMA Premium Efficiency Three-Phase		Product code : 12447067 Catalog # : 02518ET3E284TC-W22																														
Frame	:	284/6TC		Locked rotor time																														
Output	:	25 HP (18.5 kW)		: 43s (cold) 24s (hot)																														
Poles	:	4		Temperature rise																														
Frequency	:	60 Hz		: 80 K																														
Rated voltage	:	230/460 V		Duty cycle																														
Rated current	:	59.0/29.5 A		: Cont.(S1)																														
L. R. Amperes	:	366/183 A		Ambient temperature																														
LRC	:	6.2x(Code G)		: -20°C to +40°C																														
No load current	:	21.0/10.5 A		Altitude																														
Rated speed	:	1765 rpm		: 1000 m.a.s.l.																														
Slip	:	1.94 %		Protection degree																														
Rated torque	:	74.4 ft.lb		: IP55																														
Locked rotor torque	:	240 %		Cooling method																														
Breakdown torque	:	270 %		: IC411 - TEFC																														
Insulation class	:	F		Mounting																														
Service factor	:	1.25		: F-1																														
Moment of inertia (J)	:	5.11 sq.ft.lb		Rotation ¹																														
Design	:	B		: Both (CW and CCW)																														
Output	50%	75%	100%	Noise level ²																														
Efficiency (%)	92.4	93.0	93.6	: 63.0 dB(A)																														
Power Factor	0.70	0.80	0.84	Starting method																														
				: Direct On Line																														
				Approx. weight ³																														
				: 422 lb																														
Foundation loads																																		
Max. traction : 809 lb																																		
Max. compression : 1230 lb																																		
<table border="0"> <tr> <td></td> <td></td> <td style="text-align: center;"><u>Drive end</u></td> <td></td> <td style="text-align: center;"><u>Non drive end</u></td> </tr> <tr> <td>Bearing type</td> <td>:</td> <td>6311 C3</td> <td></td> <td>6211 C3</td> </tr> <tr> <td>Sealing</td> <td>:</td> <td>V'Ring</td> <td></td> <td>V'Ring</td> </tr> <tr> <td>Lubrication interval</td> <td>:</td> <td>20000 h</td> <td></td> <td>20000 h</td> </tr> <tr> <td>Lubricant amount</td> <td>:</td> <td>18 g</td> <td></td> <td>11 g</td> </tr> <tr> <td>Lubricant type</td> <td>:</td> <td colspan="3" style="text-align: center;">Mobil Polyrex EM</td> </tr> </table>							<u>Drive end</u>		<u>Non drive end</u>	Bearing type	:	6311 C3		6211 C3	Sealing	:	V'Ring		V'Ring	Lubrication interval	:	20000 h		20000 h	Lubricant amount	:	18 g		11 g	Lubricant type	:	Mobil Polyrex EM		
		<u>Drive end</u>		<u>Non drive end</u>																														
Bearing type	:	6311 C3		6211 C3																														
Sealing	:	V'Ring		V'Ring																														
Lubrication interval	:	20000 h		20000 h																														
Lubricant amount	:	18 g		11 g																														
Lubricant type	:	Mobil Polyrex EM																																
Notes																																		
USABLE @208V 65.2A SF 1.15 SFA 75.0A																																		
<p>This revision replaces and cancel the previous one, which must be eliminated.</p> <p>(1) Looking the motor from the shaft end.</p> <p>(2) Measured at 1m and with tolerance of +3dB(A).</p> <p>(3) Approximate weight subject to changes after manufacturing process.</p> <p>(4) At 100% of full load.</p>			<p>These are average values based on tests with sinusoidal power supply, subject to the tolerances stipulated in NEMA MG-1.</p>																															
Rev.	Changes Summary			Performed	Checked	Date																												
Performed by																																		
Checked by					Page	Revision																												
Date	17/03/2020				1 / 6																													

TORQUE AND CURRENT VS SPEED CURVE

Three Phase Induction Motor - Squirrel Cage



Customer :

Product line : W22 NEMA Premium Efficiency
Three-Phase

Product code : 12447067

Catalog # : 02518ET3E284TC-W22

TORQUE AND CURRENT VS SPEED CURVE

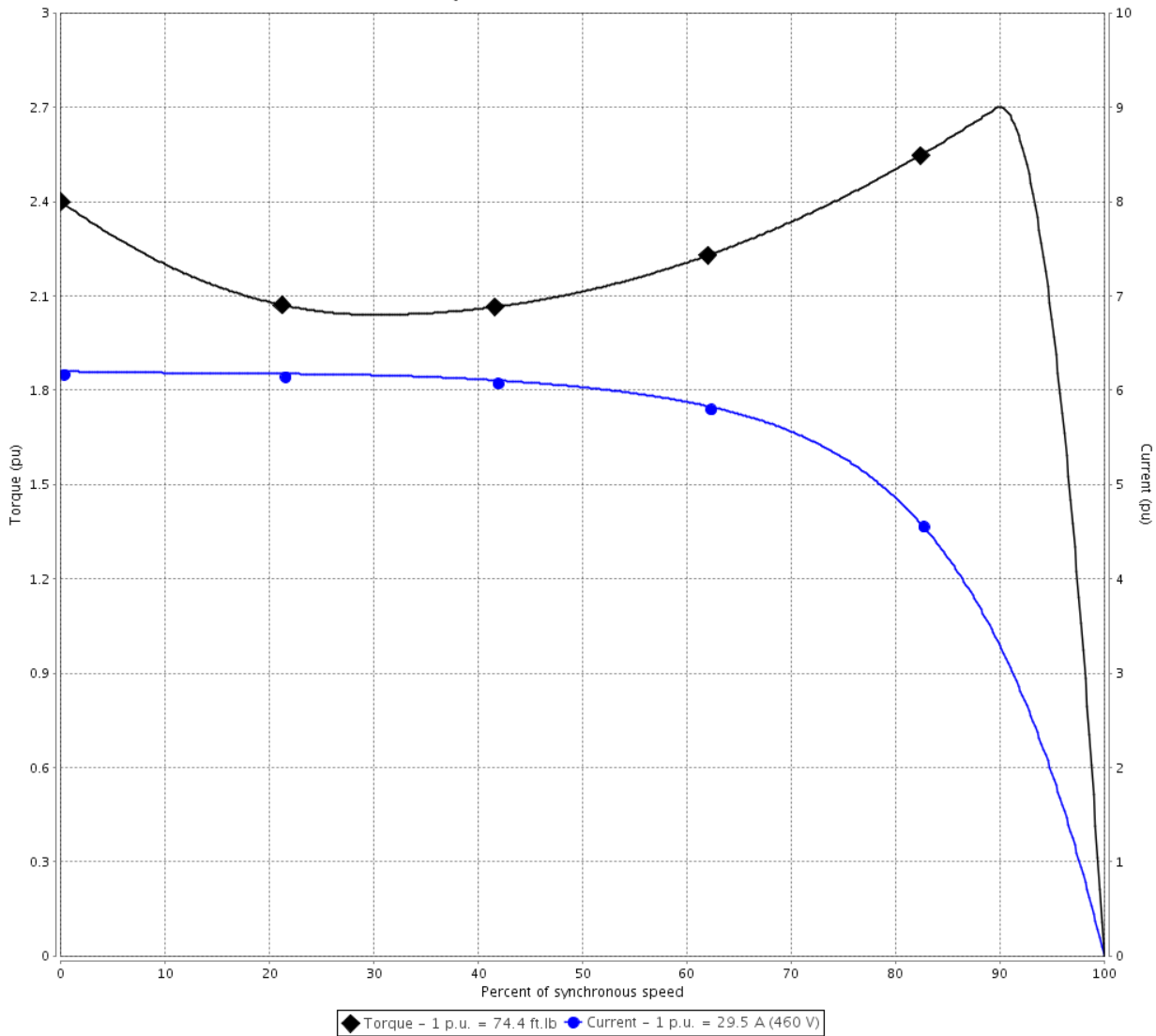

Performance : 230/460 V 60 Hz 4P

Rated current : 59.0/29.5 A
LRC : 6.2
Rated torque : 74.4 ft.lb
Locked rotor torque : 240 %
Breakdown torque : 270 %
Rated speed : 1765 rpm

Moment of inertia (J) : 5.11 sq.ft.lb
Duty cycle : Cont.(S1)
Insulation class : F
Service factor : 1.25
Temperature rise : 80 K
Design : B

Locked rotor time : 43s (cold) 24s (hot)

Rev.	Changes Summary	Performed	Checked	Date
Performed by			Page 2 / 6	Revision
Checked by				
Date	17/03/2020			

LOAD PERFORMANCE CURVE

Three Phase Induction Motor - Squirrel Cage



Customer :

Product line : W22 NEMA Premium Efficiency Three-Phase

Product code : 12447067

Catalog # : 02518ET3E284TC-W22

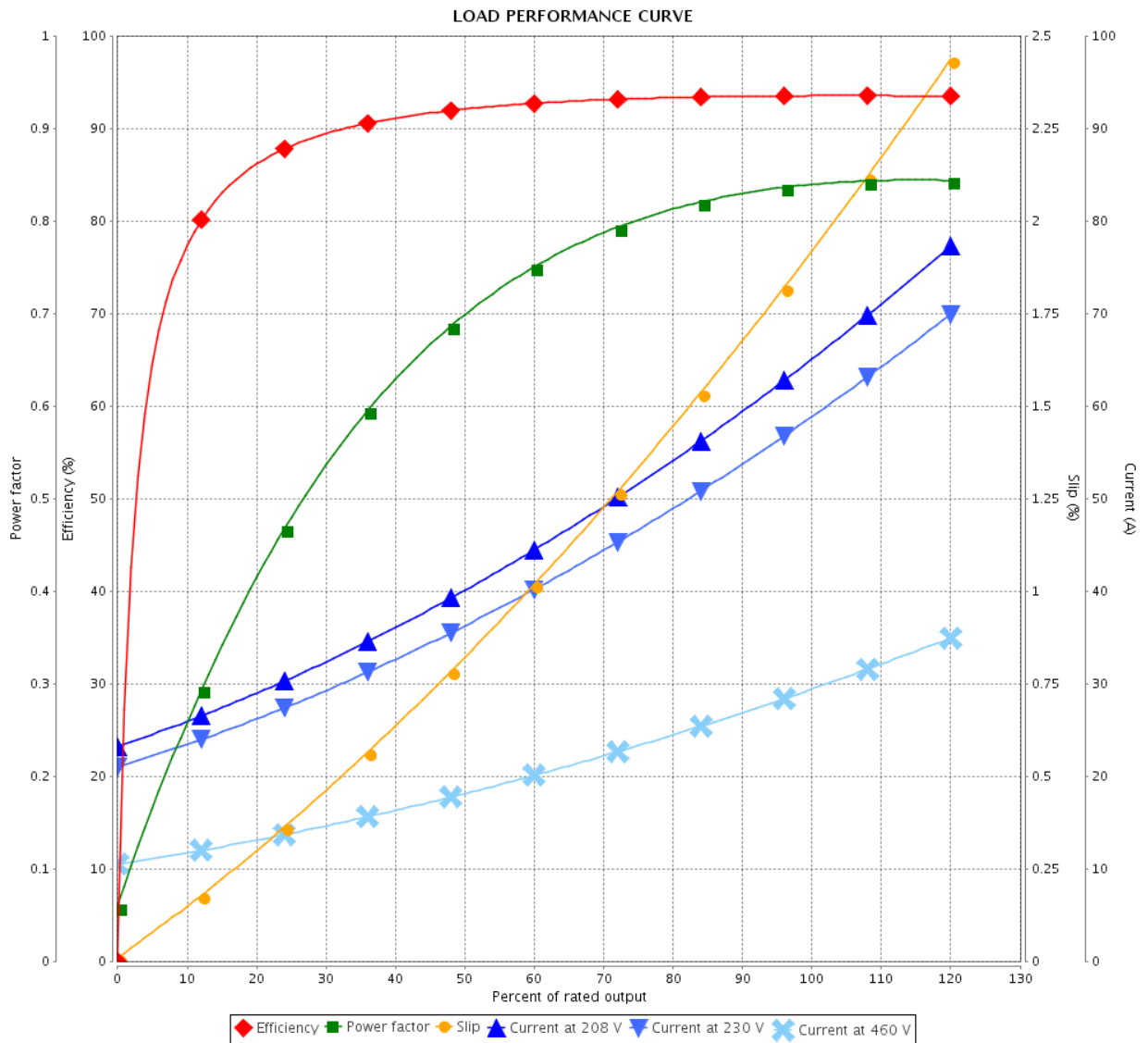

Performance : 230/460 V 60 Hz 4P

Rated current : 59.0/29.5 A
 LRC : 6.2
 Rated torque : 74.4 ft.lb
 Locked rotor torque : 240 %
 Breakdown torque : 270 %
 Rated speed : 1765 rpm

Moment of inertia (J) : 5.11 sq.ft.lb
 Duty cycle : Cont.(S1)
 Insulation class : F
 Service factor : 1.25
 Temperature rise : 80 K
 Design : B

Rev.	Changes Summary	Performed	Checked	Date
Performed by			Page	Revision
Checked by				
Date				

THERMAL LIMIT CURVE



Three Phase Induction Motor - Squirrel Cage

Customer :

Product line : W22 NEMA Premium Efficiency
Three-Phase

Product code : 12447067

Catalog # : 02518ET3E284TC-W22

Performance : 230/460 V 60 Hz 4P

Rated current : 59.0/29.5 A
LRC : 6.2
Rated torque : 74.4 ft.lb
Locked rotor torque : 240 %
Breakdown torque : 270 %
Rated speed : 1765 rpm

Moment of inertia (J) : 5.11 sq.ft.lb
Duty cycle : Cont.(S1)
Insulation class : F
Service factor : 1.25
Temperature rise : 80 K
Design : B

Heating constant

Cooling constant

Rev.	Changes Summary	Performed	Checked	Date
Performed by				
Checked by			Page	Revision
Date	17/03/2020		4 / 6	

THERMAL LIMIT CURVE

Three Phase Induction Motor - Squirrel Cage



Customer : _____

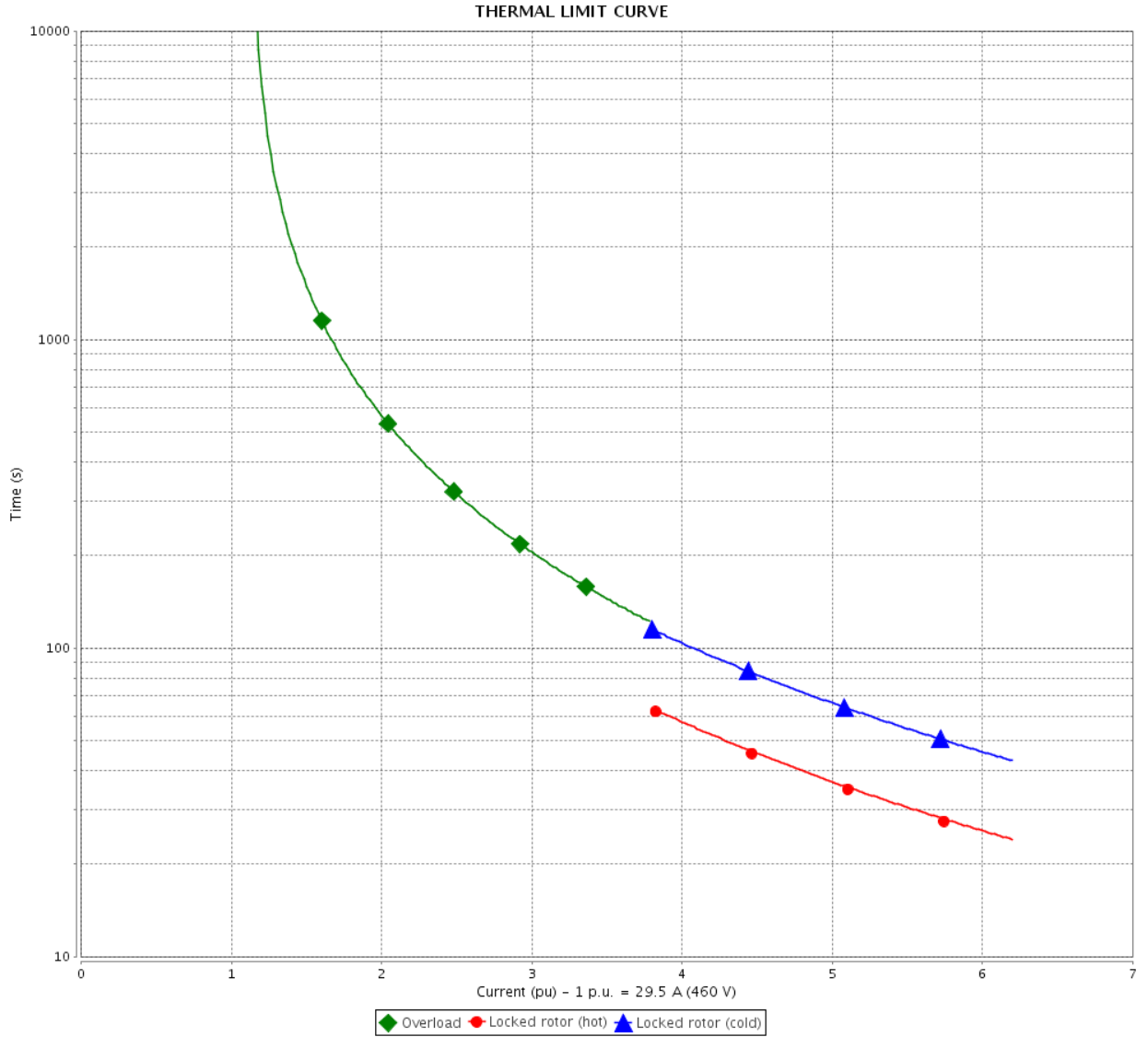

Rev.	Changes Summary	Performed	Checked	Date
Performed by				
Checked by				
Date				
			Page 5 / 6	Revision

VFD OPERATION CURVE

Three Phase Induction Motor - Squirrel Cage



Customer :

Product line : W22 NEMA Premium Efficiency Three-Phase

Product code : 12447067

Catalog # : 02518ET3E284TC-W22

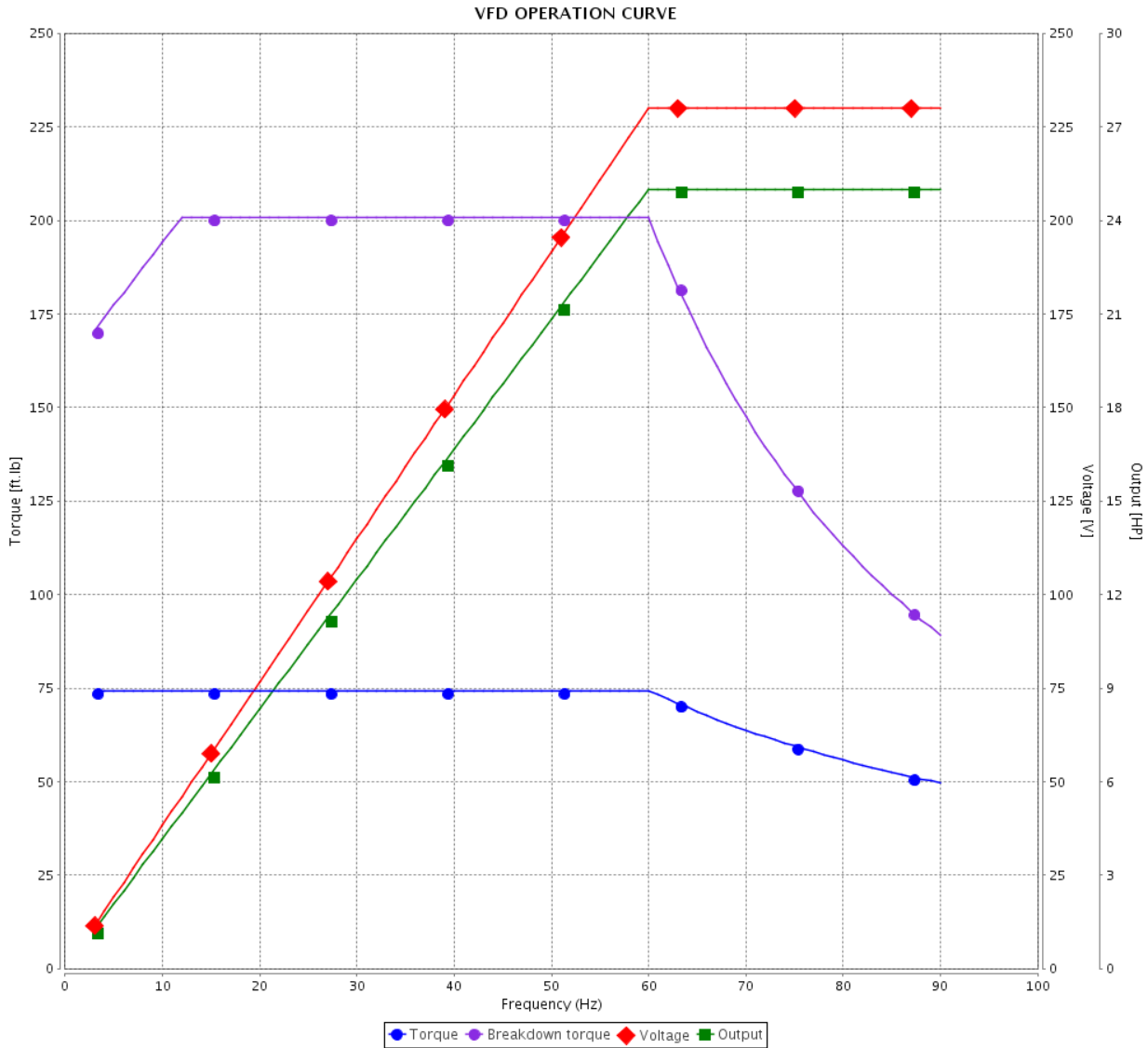

Performance : 230/460 V 60 Hz 4P

Rated current : 59.0/29.5 A
 LRC : 6.2
 Rated torque : 74.4 ft.lb
 Locked rotor torque : 240 %
 Breakdown torque : 270 %
 Rated speed : 1765 rpm

Moment of inertia (J) : 5.11 sq.ft.lb
 Duty cycle : Cont.(S1)
 Insulation class : F
 Service factor : 1.25
 Temperature rise : 80 K
 Design : B

Rev.	Changes Summary	Performed	Checked	Date
Performed by			Page	Revision
Checked by				
Date				

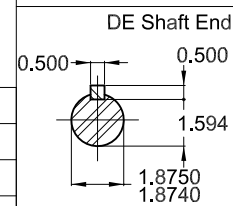
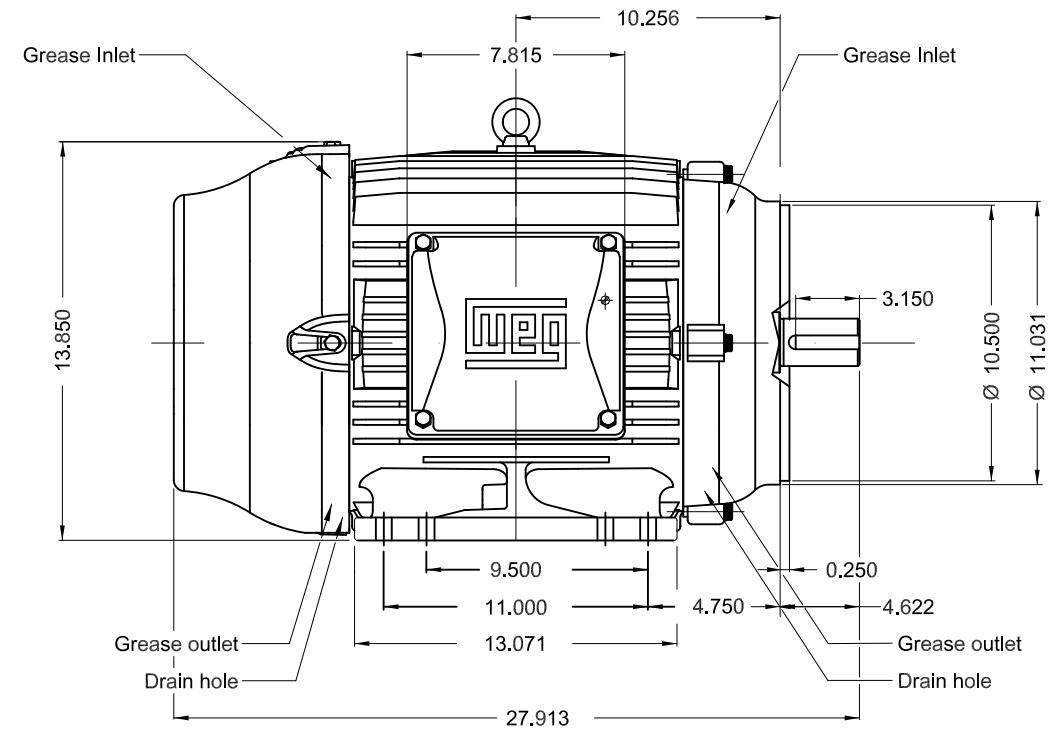
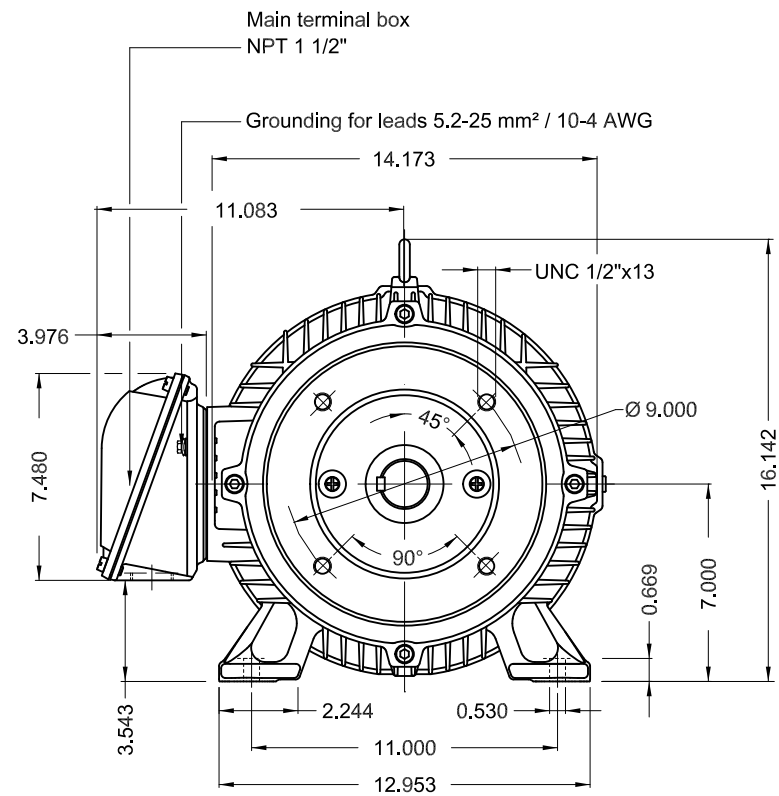

Without vertical jackscrews
 Color RAL 5009
 Painting plan 203A
 Mounting B34R(D)

25 HP 04 Poles 60Hz

Dimensions in inches

ECM	LOC	SUMMARY OF MODIFICATIONS	EXECUTED	CHECKED	RELEASED	DATE	VER
EXECUTED	PIRWBUSER	THREE PHASE W22 MOTOR - NEMA PREMIUM EFF					
CHECKED		FRAME 284/6TC IP55 TEFC					
RELEASED							
REL DT.	WMO	Jaragua do Sul	Product Engineering				

PREVIEW
 WDD



SHEET 1 / 1

MODEL 02518ET3E284TC-W22
MADE IN MEXICO
12447067



Inverter Duty Motor
Severe Duty



FOR SAFE AREA
MOD.TE1BFOXON



For 60Hz: Class I, Div 2, Gr. A, B, C and D - T3
Class I, Zone 2, IIC - T3

Class II, Div 2, Gr. F and G - T4

For 60Hz use on PWM, Gr. A, B, C, D and F,
VT 1000:1, CT 20:1, 1.0SF, T3A

PH 3	FR 284/6TC	HP(kW) 25.0(18.5)	Hz 60
V 230/460	A 59.0/29.5	RPM 1765	DES B
NEMA NOM EFF 93.6 %	INS. CL. F Δ T 80 K	IP55	
ENCL TEFC	DUTY CONT.	AMB. 40°C	
CODE G	PF 0.84	SF 1.25	SFA 73.8/36.9
USABLE @208V	65.2 A	SF 1.15	SFA 75.0
25HP 18.5kW 50Hz 380V 35.6A 1445RPM SF1.00 EFF 91.7% (IE2)	ALT 1000 m.a.s.l.		

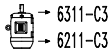
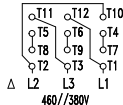
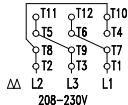

MOBIL POLYREX EM
18 g 20000 h

ALT 1000 m.a.s.l. 421 Lbs