

MOTOR: FRAMES  
182TC-184TC

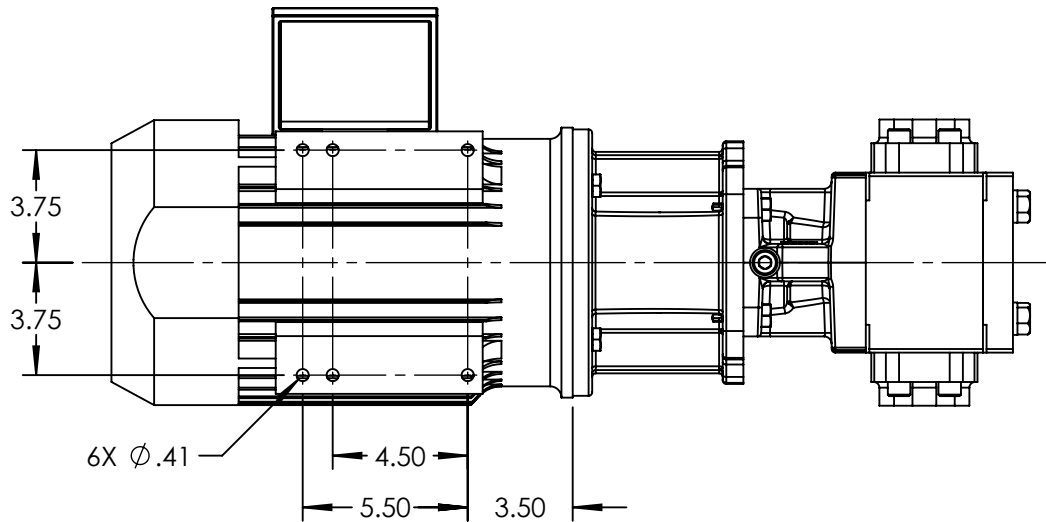
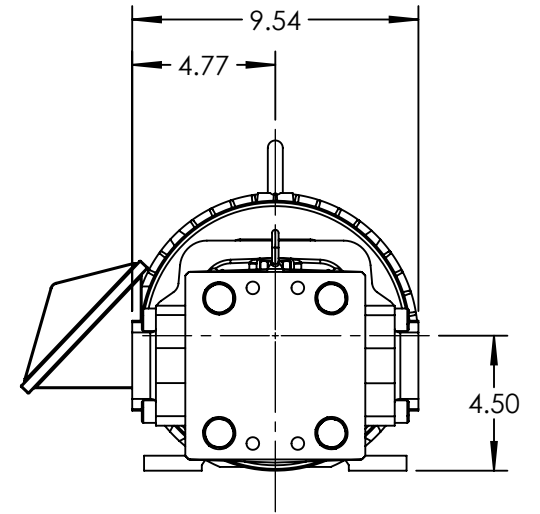
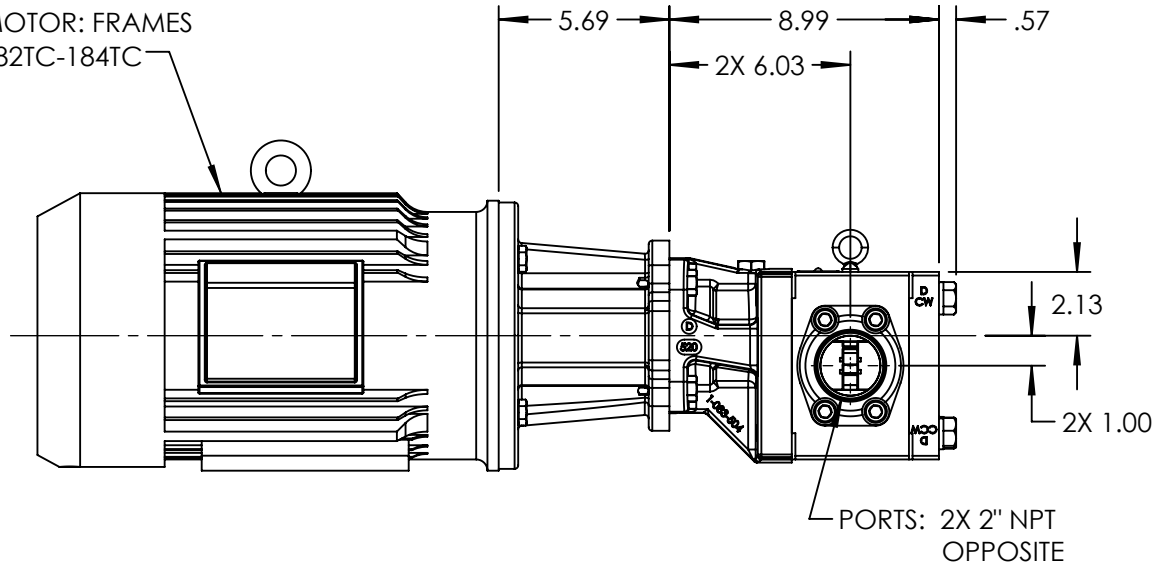

STANDARD MODELS: GB-41005-G00-M, GB-41005-G10-M

NOTES:

1. ALL DIMENSIONS ARE FOR REFERENCE ONLY.

STATE	Released	07/16/2021
DRAWN	bmanernach	6/21/2021
CHECKED	JAG	07/16/2021

DIMENSIONS ARE IN INCHES
PROJECT: E331
WAS:



VIKING PUMP, INC.  
A Unit of IDEX Corporation  
Cedar Falls, IA 50613  
U.S.A.

THIS DRAWING IS THE PROPERTY OF  
VIKING PUMP, INC. AND IS PROPRIETARY  
IN GENERAL AND DETAIL. IT SHALL NOT BE  
COPIED OR ITS CONTENTS REVEALED TO  
OUTSIDE PARTIES WITHOUT THE WRITTEN  
CONSENT OF VIKING PUMP, INC.

3D

DWG. NO.	SHEET 1 OF 1
GPV-1005-002-U	

REV. A.0
07/16/2021



# TORQUE AND CURRENT VS SPEED CURVE

## Three Phase Induction Motor - Squirrel Cage



Customer :

Product line : W22 NEMA Premium Efficiency  
Three-Phase

Product code : 12445724

Catalog # : 00318ET3E182TC-W22

TORQUE AND CURRENT VS SPEED CURVE

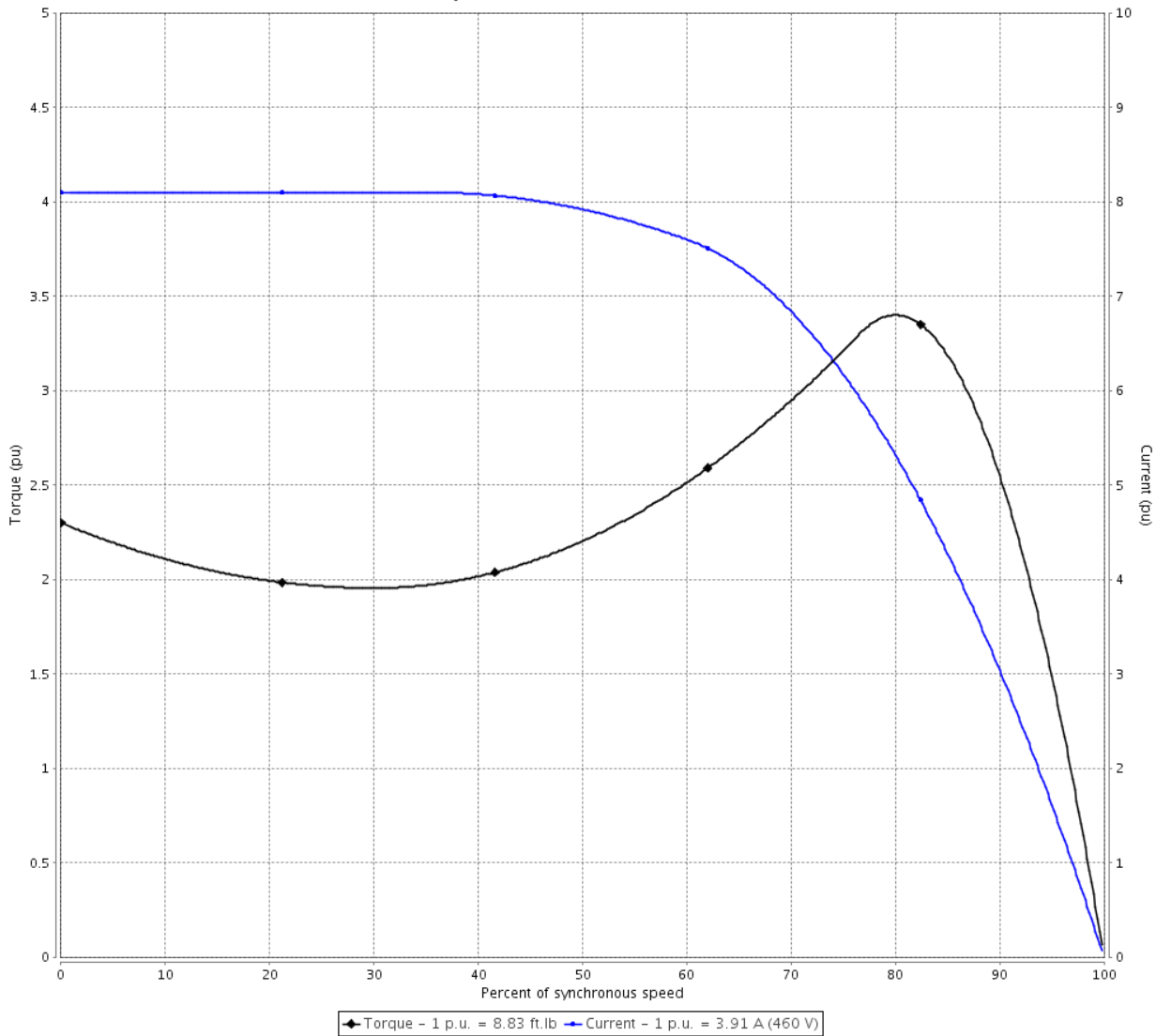

Performance : 208-230/460 V 60 Hz 4P

Rated current	: 8.65-7.82/3.91 A	Moment of inertia (J)	: 0.3401 sq.ft.lb
LRC	: 8.1	Duty cycle	: Cont.(S1)
Rated torque	: 8.83 ft.lb	Insulation class	: F
Locked rotor torque	: 229 %	Service factor	: 1.25
Breakdown torque	: 340 %	Temperature rise	: 80 K
Rated speed	: 1760 rpm	Design	: B

Locked rotor time : 41s (cold) 23s (hot)

Rev.	Changes Summary	Performed	Checked	Date
Performed by			Page 2 / 6	Revision
Checked by				
Date	15/01/2019			

# LOAD PERFORMANCE CURVE

## Three Phase Induction Motor - Squirrel Cage



Customer : \_\_\_\_\_

Product line : W22 NEMA Premium Efficiency  
Three-Phase

Product code : 12445724

Catalog # : 00318ET3E182TC-W22

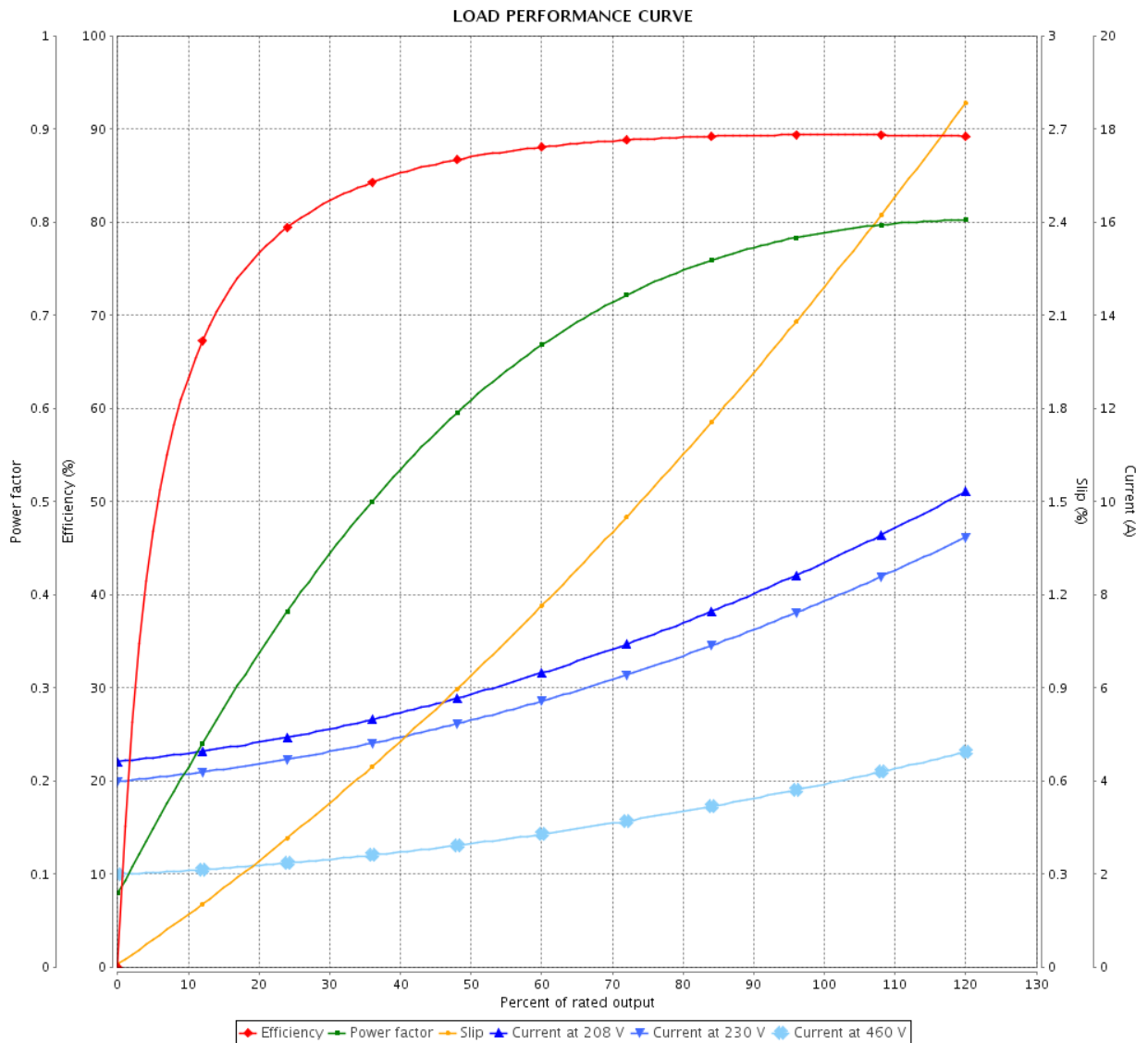

Performance : 208-230/460 V 60 Hz 4P

Rated current : 8.65-7.82/3.91 A  
 LRC : 8.1  
 Rated torque : 8.83 ft.lb  
 Locked rotor torque : 229 %  
 Breakdown torque : 340 %  
 Rated speed : 1760 rpm

Moment of inertia (J) : 0.3401 sq.ft.lb  
 Duty cycle : Cont.(S1)  
 Insulation class : F  
 Service factor : 1.25  
 Temperature rise : 80 K  
 Design : B

Rev.	Changes Summary	Performed	Checked	Date
Performed by		Page		Revision
Checked by		3 / 6		
Date		15/01/2019		

# THERMAL LIMIT CURVE



## Three Phase Induction Motor - Squirrel Cage

Customer :

Product line : W22 NEMA Premium Efficiency  
Three-Phase

Product code : 12445724

Catalog # : 00318ET3E182TC-W22

Performance : 208-230/460 V 60 Hz 4P

Rated current : 8.65-7.82/3.91 A  
LRC : 8.1  
Rated torque : 8.83 ft.lb  
Locked rotor torque : 229 %  
Breakdown torque : 340 %  
Rated speed : 1760 rpm

Moment of inertia (J) : 0.3401 sq.ft.lb  
Duty cycle : Cont.(S1)  
Insulation class : F  
Service factor : 1.25  
Temperature rise : 80 K  
Design : B

Heating constant

Cooling constant

Rev.	Changes Summary	Performed	Checked	Date
Performed by			Page 4 / 6	Revision
Checked by				
Date	15/01/2019			

# THERMAL LIMIT CURVE

Three Phase Induction Motor - Squirrel Cage



Customer : \_\_\_\_\_

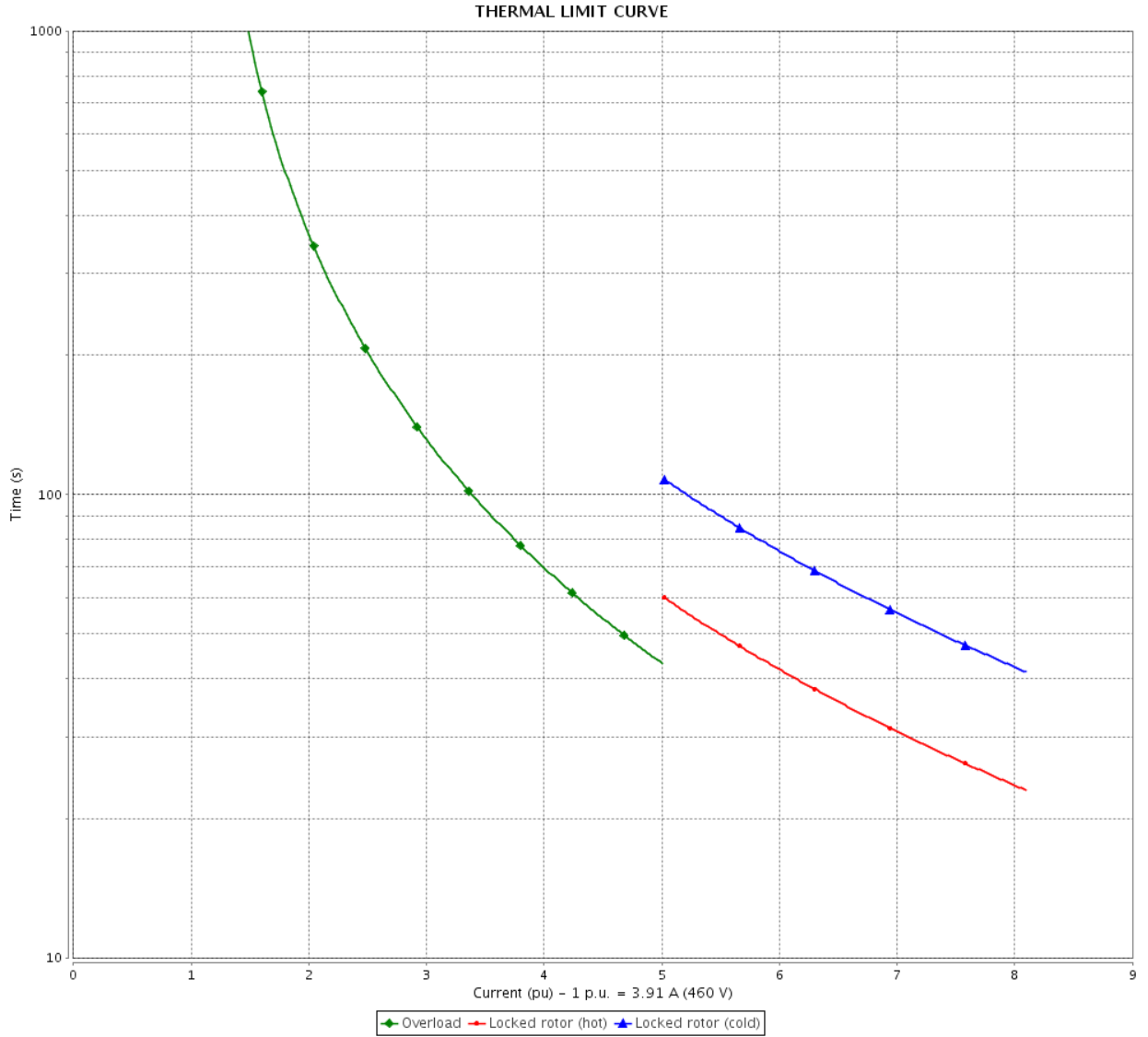

Rev.	Changes Summary	Performed	Checked	Date
Performed by				
Checked by				
Date				
			Page	Revision
			5 / 6	

# VFD OPERATION CURVE

Three Phase Induction Motor - Squirrel Cage



Customer : \_\_\_\_\_

Product line : W22 NEMA Premium Efficiency  
Three-Phase

Product code : 12445724

Catalog # : 00318ET3E182TC-W22

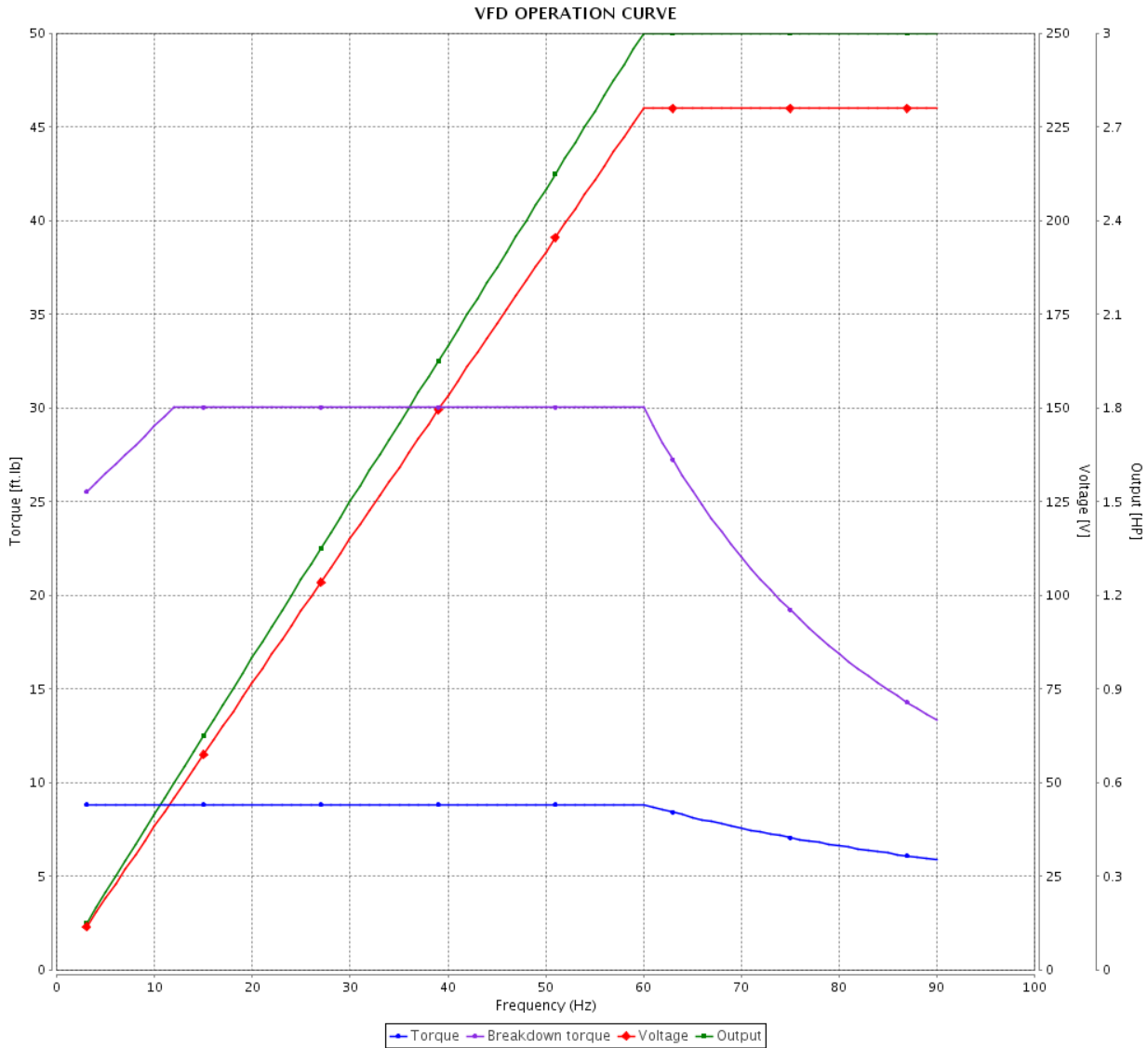

Performance : 208-230/460 V 60 Hz 4P

Rated current : 8.65-7.82/3.91 A  
 LRC : 8.1  
 Rated torque : 8.83 ft.lb  
 Locked rotor torque : 229 %  
 Breakdown torque : 340 %  
 Rated speed : 1760 rpm

Moment of inertia (J) : 0.3401 sq.ft.lb  
 Duty cycle : Cont.(S1)  
 Insulation class : F  
 Service factor : 1.25  
 Temperature rise : 80 K  
 Design : B

Rev.	Changes Summary	Performed	Checked	Date
Performed by			Page	Revision
Checked by			6 / 6	
Date	15/01/2019			

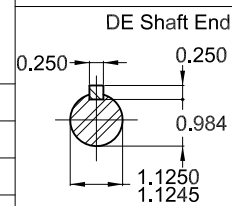
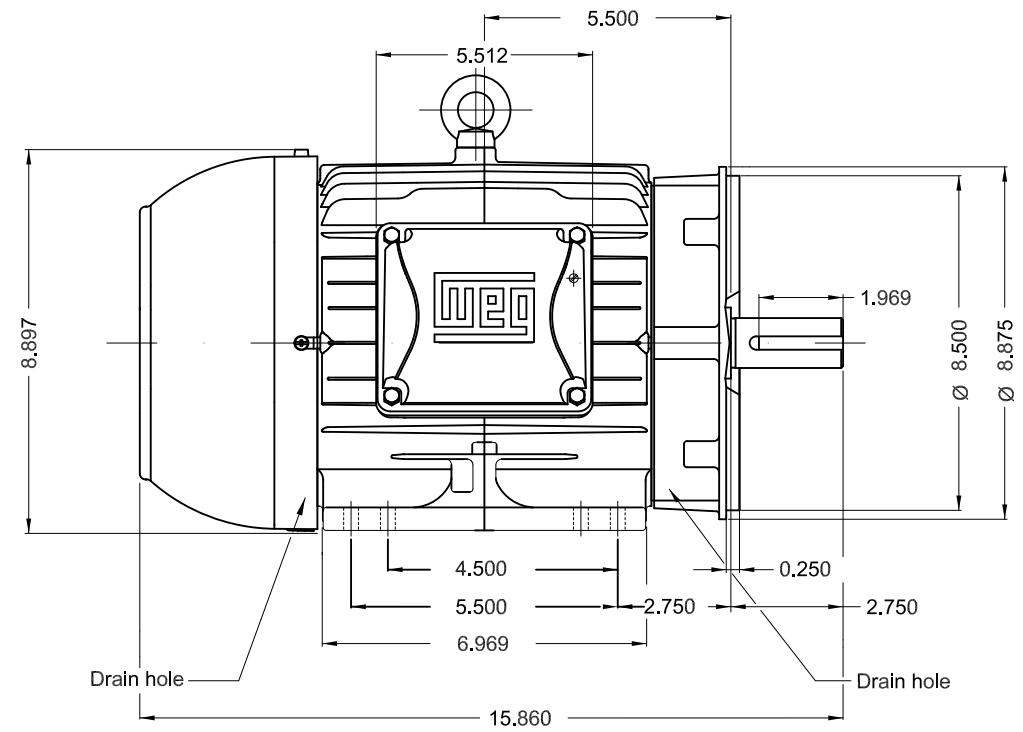
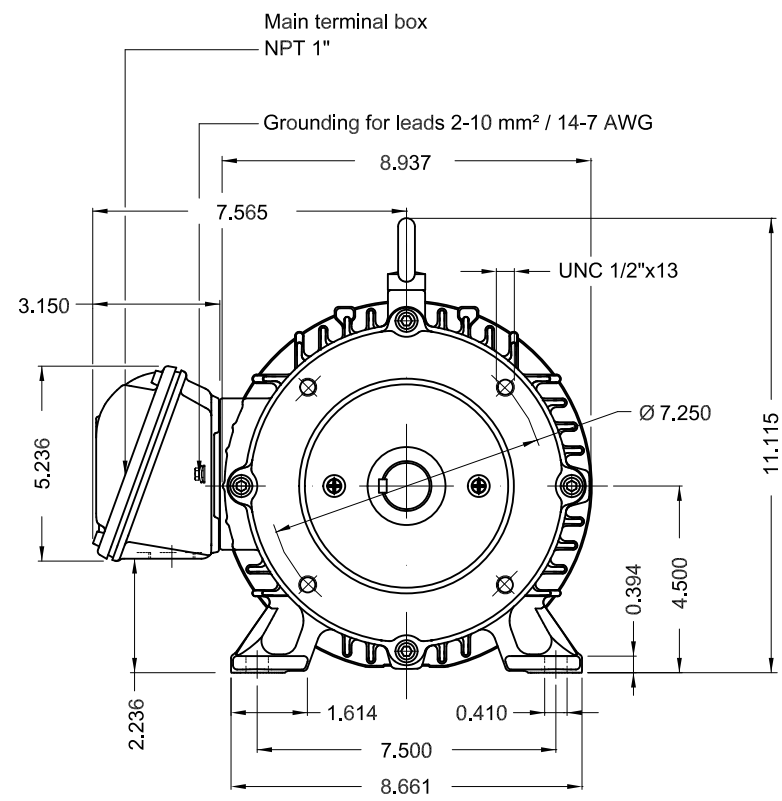

Bearing cap  
 Color RAL 5009  
 Painting plan 207A  
 Mounting B34R(D)

3 HP 04 Poles 60Hz

Dimensions in inches

ECM	LOC	SUMMARY OF MODIFICATIONS	EXECUTED	CHECKED	RELEASED	DATE	VER
EXECUTED	USERADMIN	THREE PHASE W22 MOTOR - NEMA PREMIUM EFF FRAME 182/4TC IP55 TEFC					
CHECKED							
RELEASED							
REL DT	WMO		Jaragua do Sul	Product Engineering			

**PREVIEW**  
 WDD



SHEET 1 / 1



**W22**

CC029A

® Inverter Duty Motor  
Severe Duty

12445724

MADE IN MEXICO MODEL 00318ET3E182TC-W22

PH 3 | FR 182/4TC | HP(kw) 3.0(2.2) | Hz 60 | SF 1.25 | PF 0.79

V 230/460 | A 7.82/3.91 | RPM 1760 | INS. CL. F ΔT 80 K | IP55

NEMA NOM EFF 89.5 % | DES B | DUTY CONT. | AMB 40°C

ENCL TEFC | SFA 9.78/4.89 | USABLE @208V 8.65 A | SF 1.15 SFA 9.95

2.2kW 50Hz 380V 4.60A 1445RPM SF1.25 EFF 87.5% (IE3) | CODE K

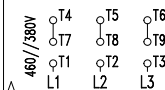
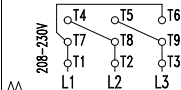

→6207-ZZ

→6206-ZZ

MOBIL POLYREX EM

ALT 1000 m.a.s.l. | 93 Lbs

For 60Hz: Class I, Div 2, Gr. A, B, C and D - T3

Class I, Zone 2, IIC - T3

Class II, Div 2, Gr. F and G - T5

For use on PWM, Gr. A, B, C, D, F and G

VT1000:1, CT20:1, 1.0SF, T4A

C US  
Energy Verified3PT9  
US LISTEDFOR SAFE AREA  
MOD.TE1BFOXON