

MOTOR FRAMES:
324TC-326TC

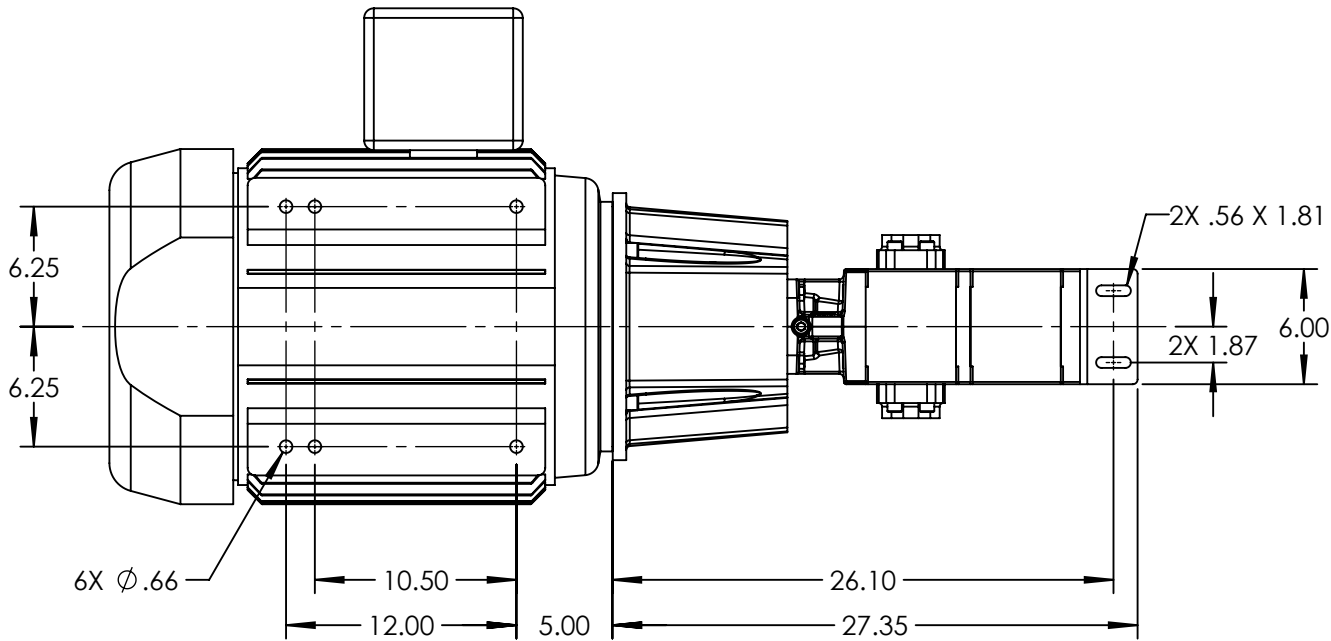
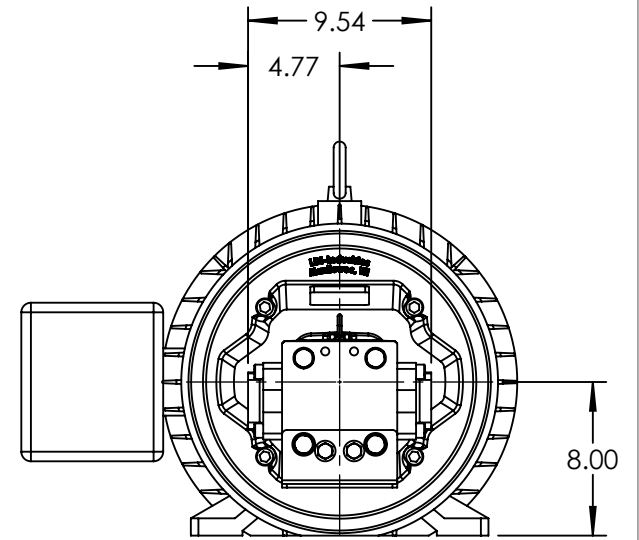
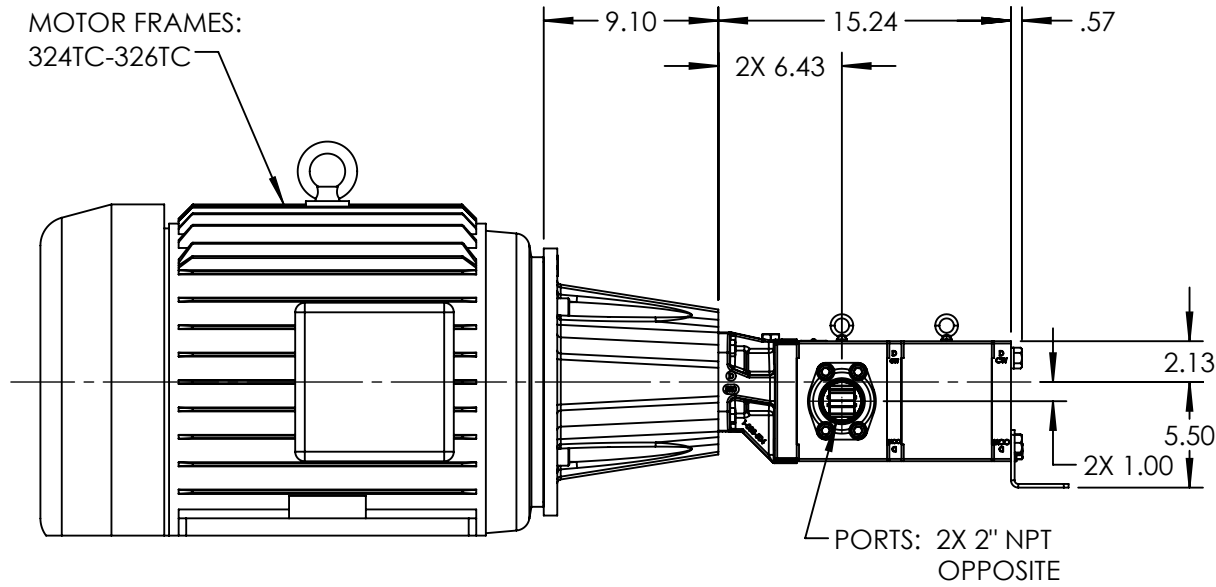

STANDARD MODELS: GB-41026-G00-M, GB-41026-G10-M

NOTES:

1. ALL DIMENSIONS ARE FOR REFERENCE ONLY.

STATE	Released	07/16/2021
DRAWN	bmanernach	7/1/2021
CHECKED	JAG	07/16/2021

DIMENSIONS ARE IN INCHES
PROJECT: E331
WAS:



VIKING PUMP, INC.
A Unit of IDEX Corporation
Cedar Falls, IA 50613
U.S.A.

THIS DRAWING IS THE PROPERTY OF
VIKING PUMP, INC. AND IS PROPRIETARY
IN GENERAL AND DETAIL. IT SHALL NOT BE
COPIED OR ITS CONTENTS REVEALED TO
OUTSIDE PARTIES WITHOUT THE WRITTEN
CONSENT OF VIKING PUMP, INC.

3D

DWG. NO. GPV-1026-075-U
SHEET 1 OF 1

REV. A.0
07/16/2021

TORQUE AND CURRENT VS SPEED CURVE

Three Phase Induction Motor - Squirrel Cage



Customer :

Product line : W22 NEMA Premium Efficiency
Three-Phase

Product code : 12447129

Catalog # : 04018ET3E324TC-W22

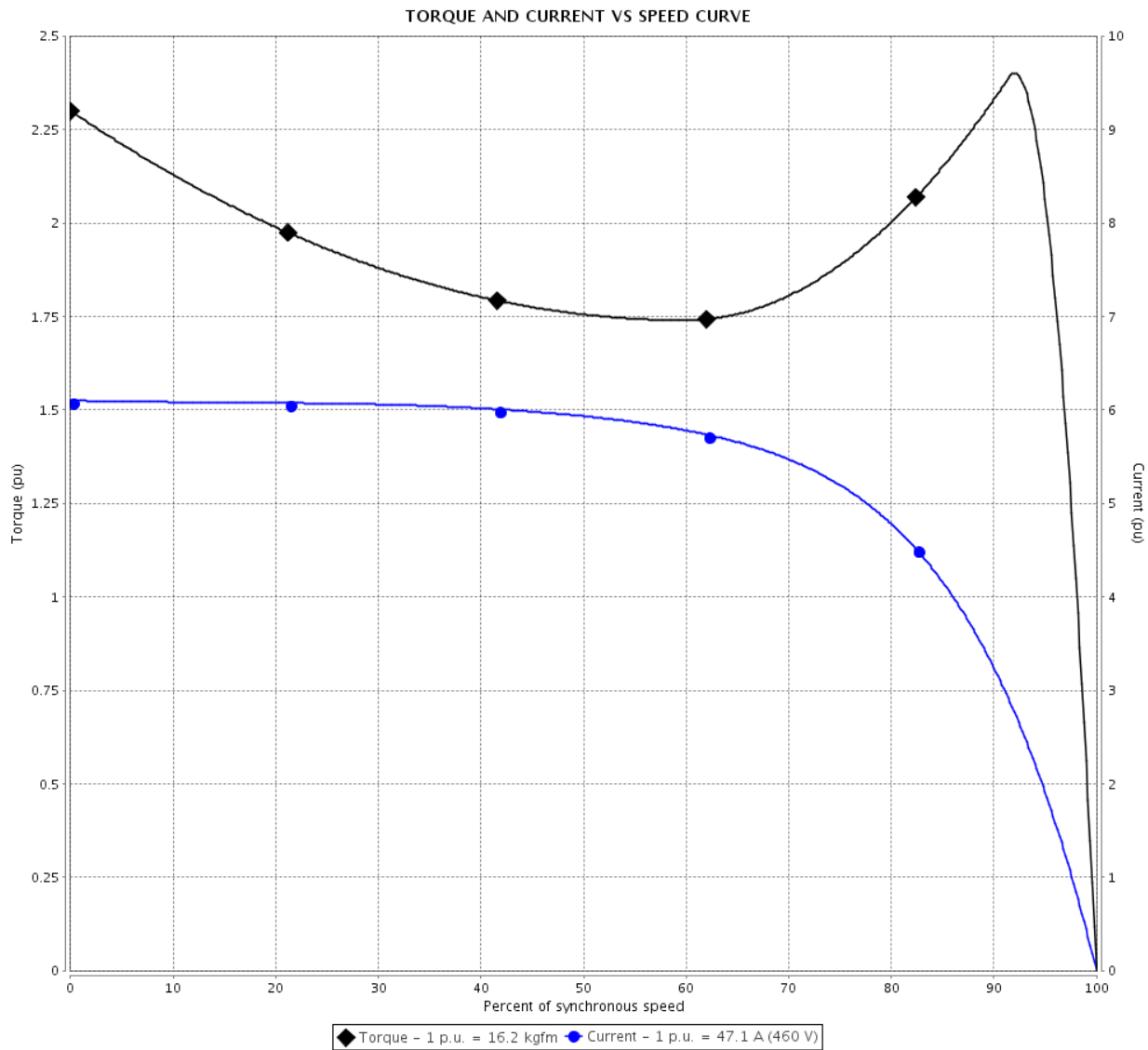

Performance : 208-230/460 V 60 Hz 4P

Rated current	: 104-94.2/47.1 A	Moment of inertia (J)	: 0.3861 kgm ²
LRC	: 6.1	Duty cycle	: Cont.(S1)
Rated torque	: 16.2 kgfm	Insulation class	: F
Locked rotor torque	: 229 %	Service factor	: 1.25
Breakdown torque	: 240 %	Temperature rise	: 80 K
Rated speed	: 1770 rpm	Design	: B

Locked rotor time : 36s (cold) 20s (hot)

Rev.	Changes Summary	Performed	Checked	Date
Performed by			Page 2 / 6	Revision
Checked by				
Date	14/02/2020			

LOAD PERFORMANCE CURVE

Three Phase Induction Motor - Squirrel Cage



Customer :

Product line : W22 NEMA Premium Efficiency
Three-Phase

Product code : 12447129

Catalog # : 04018ET3E324TC-W22

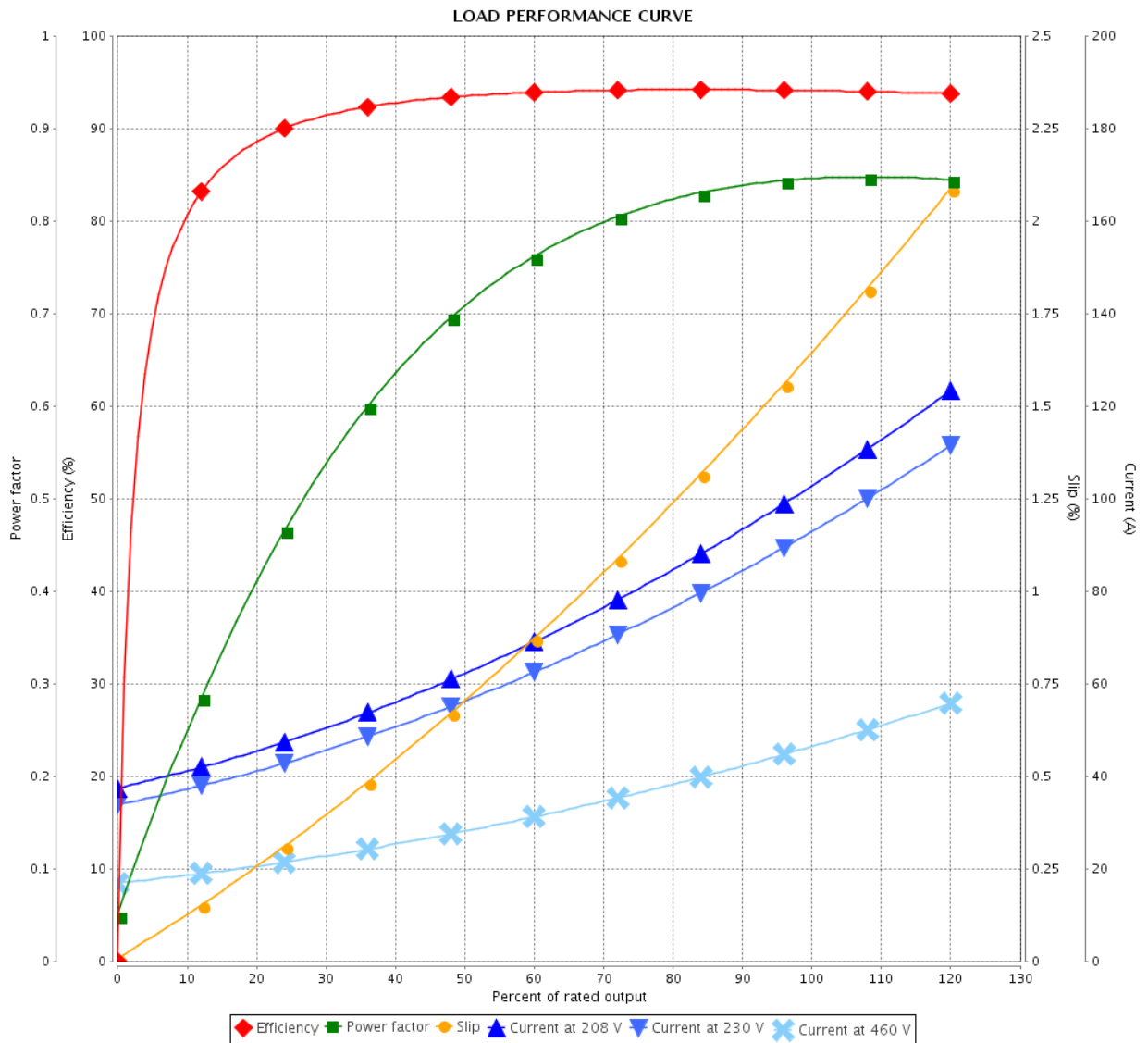

Performance : 208-230/460 V 60 Hz 4P

Rated current : 104-94.2/47.1 A
 LRC : 6.1
 Rated torque : 16.2 kgfm
 Locked rotor torque : 229 %
 Breakdown torque : 240 %
 Rated speed : 1770 rpm

Moment of inertia (J) : 0.3861 kgm²
 Duty cycle : Cont.(S1)
 Insulation class : F
 Service factor : 1.25
 Temperature rise : 80 K
 Design : B

Rev.	Changes Summary	Performed	Checked	Date
Performed by			Page	Revision
Checked by				
Date				

THERMAL LIMIT CURVE



Three Phase Induction Motor - Squirrel Cage

Customer :

Product line : W22 NEMA Premium Efficiency
Three-Phase

Product code : 12447129

Catalog # : 04018ET3E324TC-W22

Performance : 208-230/460 V 60 Hz 4P

Rated current : 104-94.2/47.1 A
LRC : 6.1
Rated torque : 16.2 kgfm
Locked rotor torque : 229 %
Breakdown torque : 240 %
Rated speed : 1770 rpm

Moment of inertia (J) : 0.3861 kgm²
Duty cycle : Cont.(S1)
Insulation class : F
Service factor : 1.25
Temperature rise : 80 K
Design : B

Heating constant

Cooling constant

Rev.	Changes Summary	Performed	Checked	Date
Performed by				
Checked by			Page	Revision
Date	14/02/2020		4 / 6	

THERMAL LIMIT CURVE

Three Phase Induction Motor - Squirrel Cage



Customer : _____

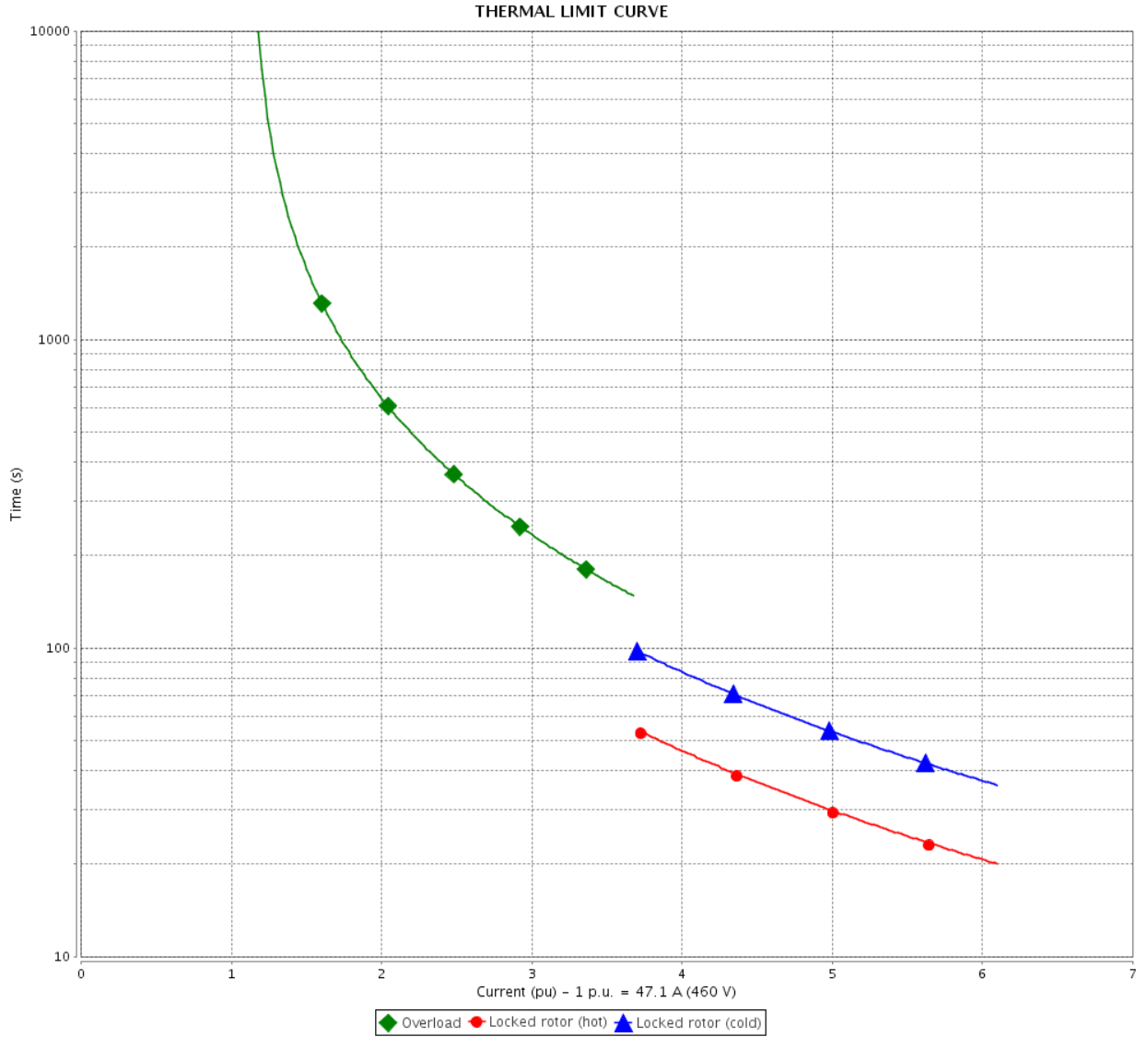

Rev.	Changes Summary	Performed	Checked	Date
Performed by				
Checked by				
Date				
			Page	Revision
			5 / 6	

VFD OPERATION CURVE

Three Phase Induction Motor - Squirrel Cage



Customer :

Product line : W22 NEMA Premium Efficiency Three-Phase

Product code : 12447129

Catalog # : 04018ET3E324TC-W22

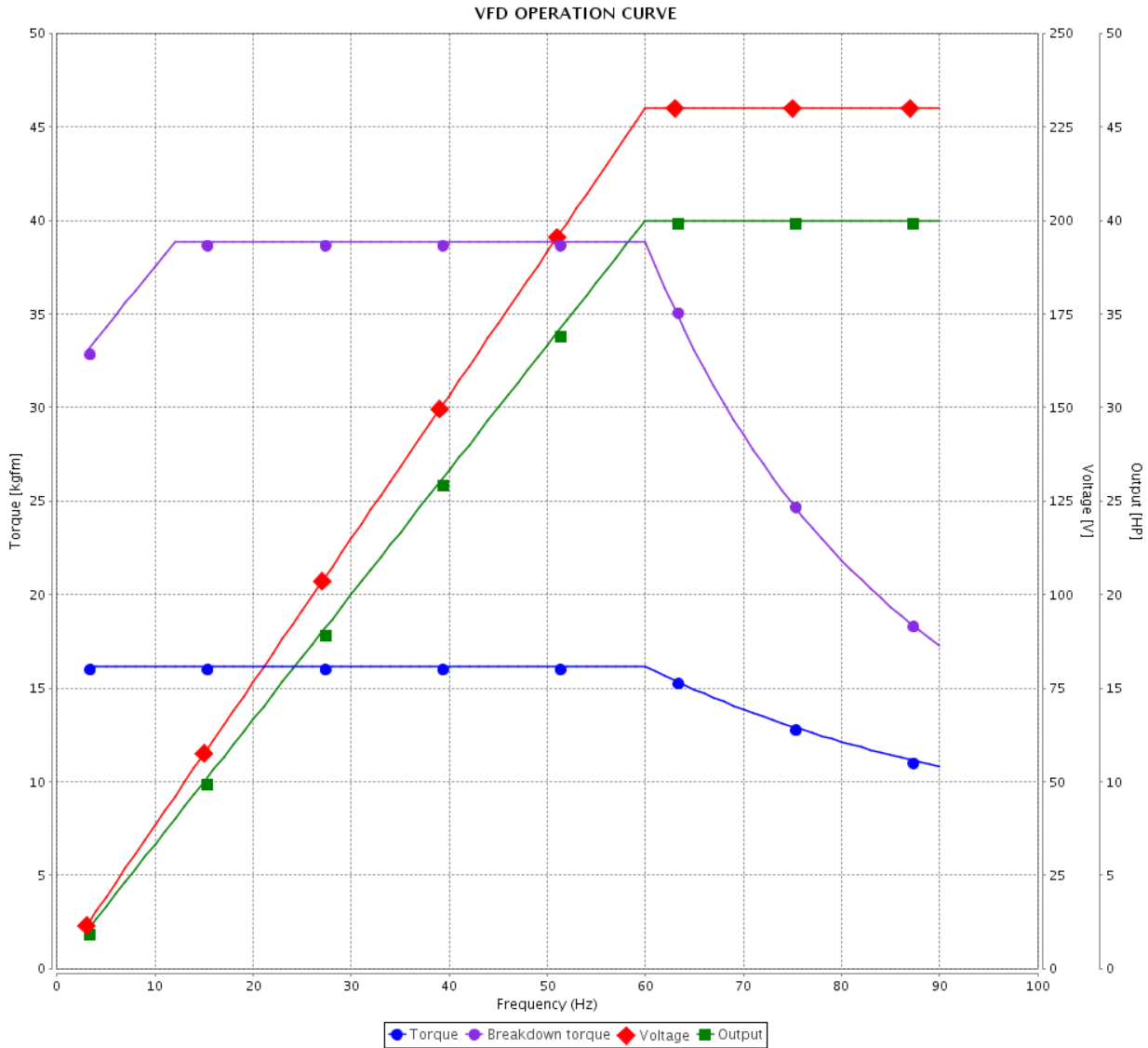

Performance : 208-230/460 V 60 Hz 4P

Rated current : 104-94.2/47.1 A
 LRC : 6.1
 Rated torque : 16.2 kgfm
 Locked rotor torque : 229 %
 Breakdown torque : 240 %
 Rated speed : 1770 rpm

Moment of inertia (J) : 0.3861 kgm²
 Duty cycle : Cont.(S1)
 Insulation class : F
 Service factor : 1.25
 Temperature rise : 80 K
 Design : B

Rev.	Changes Summary	Performed	Checked	Date
Performed by			Page 6 / 6	Revision
Checked by				
Date	14/02/2020			

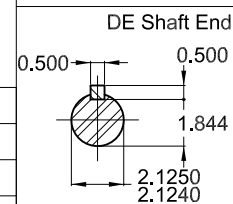
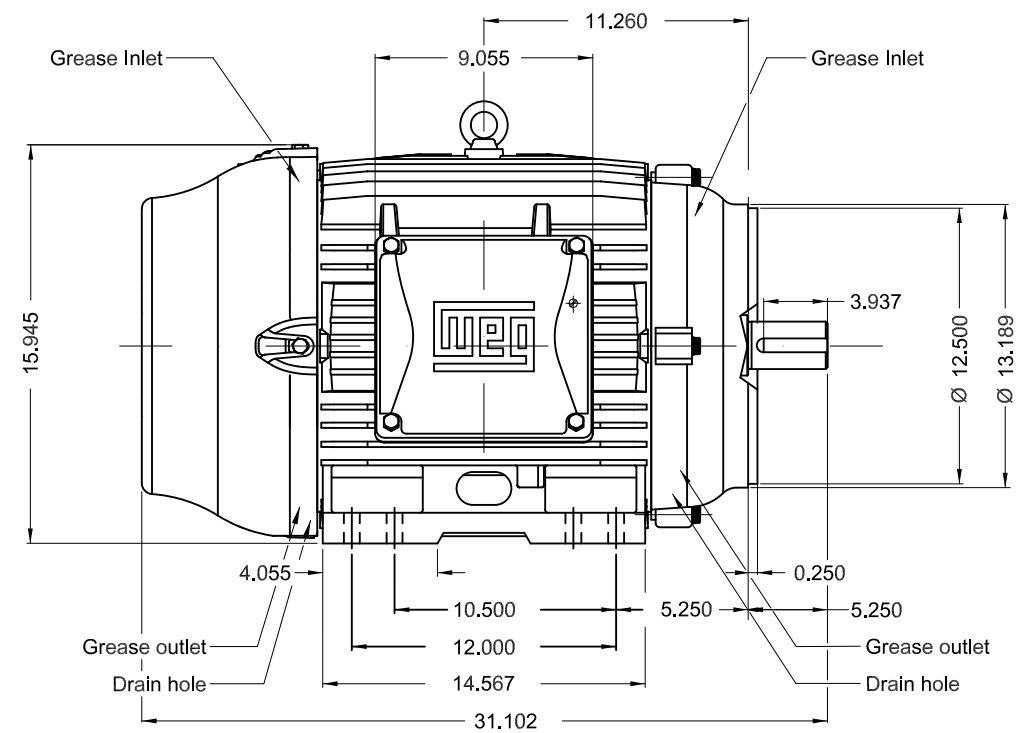
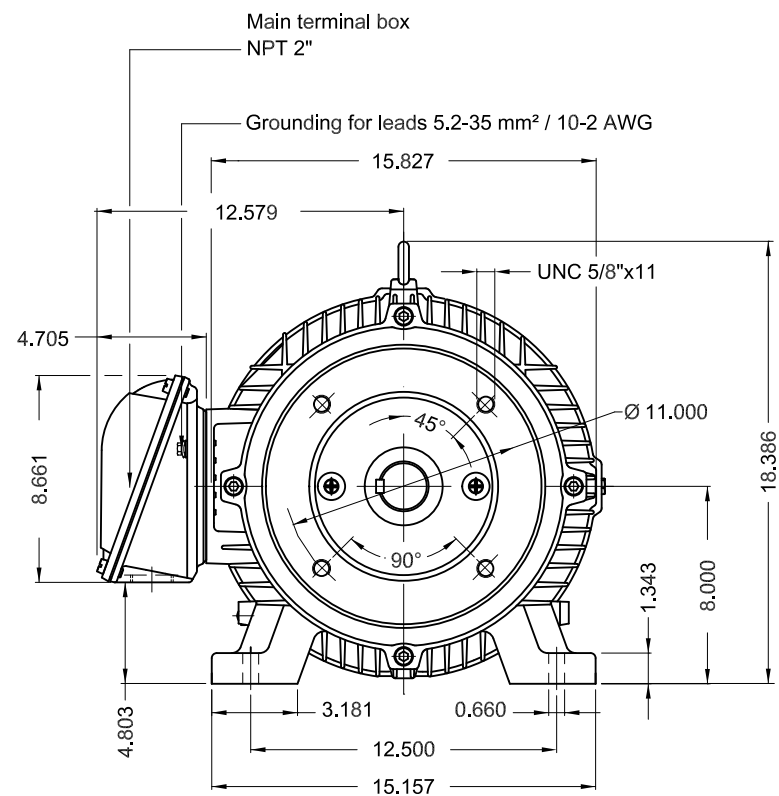

Without vertical jackscrews
 Color RAL 5009
 Painting plan 203A
 Mounting B34R(D)

40 HP 04 Poles 60Hz

Dimensions in inches

ECM	LOC	SUMMARY OF MODIFICATIONS	EXECUTED	CHECKED	RELEASED	DATE	VER
EXECUTED	PIRWBUSER	THREE PHASE W22 MOTOR - NEMA PREMIUM EFF FRAME 324/6TC IP55 TEFC					
CHECKED							
RELEASED							
REL DT.							
		WMO Jaragua do Sul	Product Engineering	SHEET 1 / 1			

PREVIEW
 WDD



MODEL 04018ET3E324TC-W22
MADE IN MEXICO
12447129



Inverter Duty Motor
Severe Duty



FOR SAFE AREA
MOD.TE1BFOXON



For 60Hz: Class I, Div 2, Gr. A, B, C and D - T3
Class I, Zone 2, IIC - T3

Class II, Div 2, Gr. F and G - T4

For 60Hz use on PWM, Gr. A, B, C, D and F,
VT 1000:1, CT 20:1, 1.0SF, T3A

PH 3	FR 324/6TC	HP(kW) 40.0(30.0)	Hz 60
V 230/460	A 94.2/47.1	RPM 1770	DES B
NEMA NOM EFF 94.1 %	INS. CL. F Δ T 80 K	IP55	
ENCL TEFC	DUTY CONT.	AMB. 40°C	
CODE G	PF 0.85	SF 1.25	SFA 118/58.9
USABLE @208V 104 A	SF 1.15	SFA 120	
40HP 30kW 50Hz 380V 57.4A 1460RPM SF1.00 EFF 92.4% (IE2)	ALT 1000 m.a.s.l.	591 Lbs	

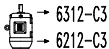
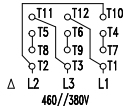
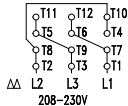

→ 6312-C3

→ 6212-C3

MOBIL POLYREX EM
21 g 20000 h