

MOTOR: FRAMES
182TC-184TC

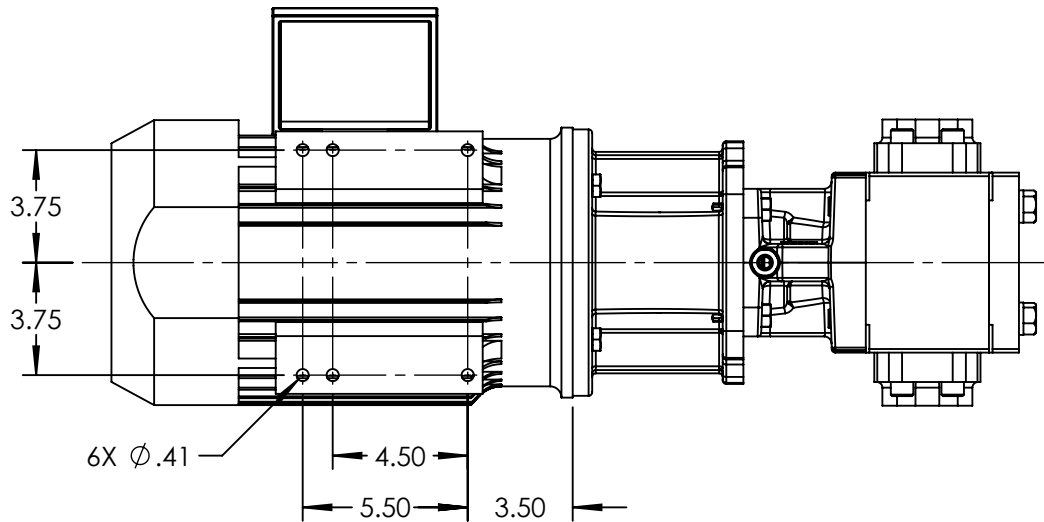
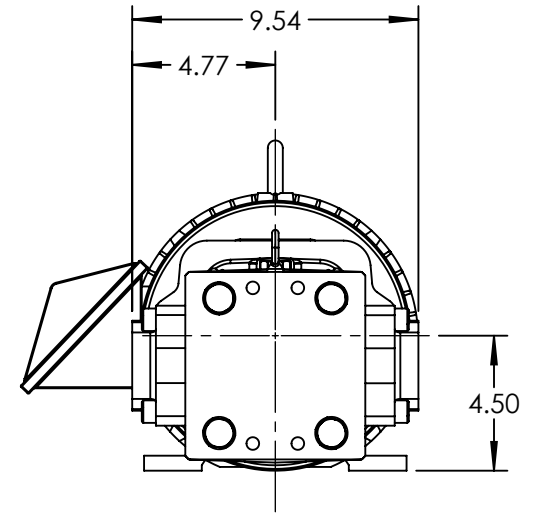
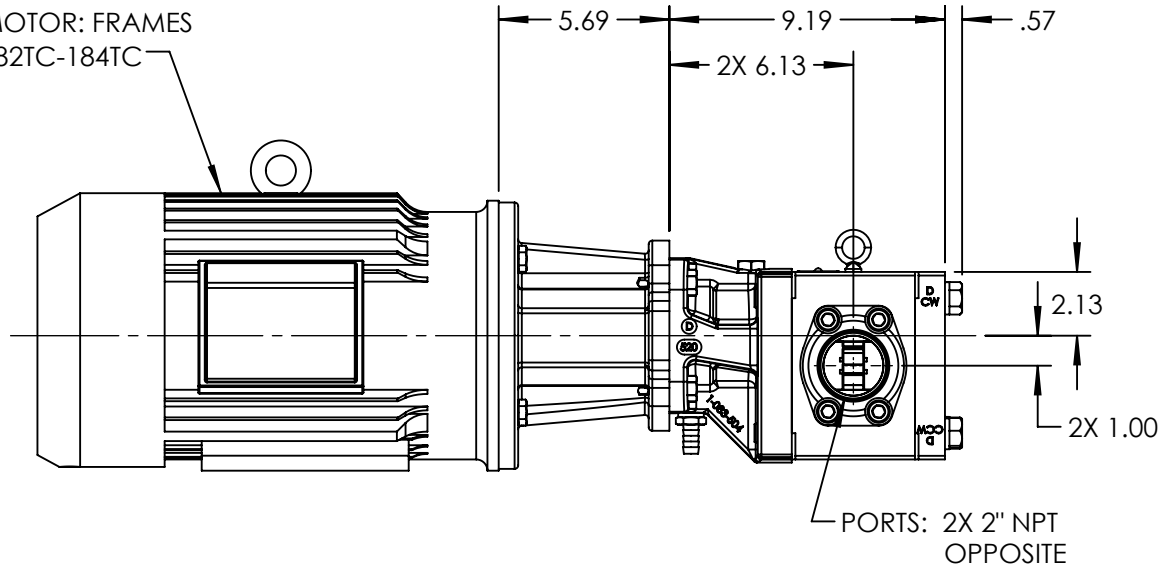

STANDARD MODELS: GB-41007-G00-M, GB-41007-G10-M

NOTES:

1. ALL DIMENSIONS ARE FOR REFERENCE ONLY.

STATE	Released	05/19/2022
DRAWN	bmanternach	5/19/2022
CHECKED	BAM	05/19/2022

DIMENSIONS ARE IN INCHES	
PROJECT:	
WAS:	



VIKING PUMP, INC.
A Unit of IDEX Corporation
Cedar Falls, IA 50613
U.S.A.

THIS DRAWING IS THE PROPERTY OF
VIKING PUMP, INC. AND IS PROPRIETARY
IN GENERAL AND DETAIL. IT SHALL NOT BE
COPIED OR ITS CONTENTS REVEALED TO
OUTSIDE PARTIES WITHOUT THE WRITTEN
CONSENT OF VIKING PUMP, INC.

3D

DWG. NO. SHEET 1 OF 1
GPV-1007-005-U

REV. A.0
05/19/2022

TORQUE AND CURRENT VS SPEED CURVE

Three Phase Induction Motor - Squirrel Cage



Customer :

Product line : W22 NEMA Premium Efficiency
Three-Phase

Product code : 12445724

Catalog # : 00318ET3E182TC-W22

TORQUE AND CURRENT VS SPEED CURVE

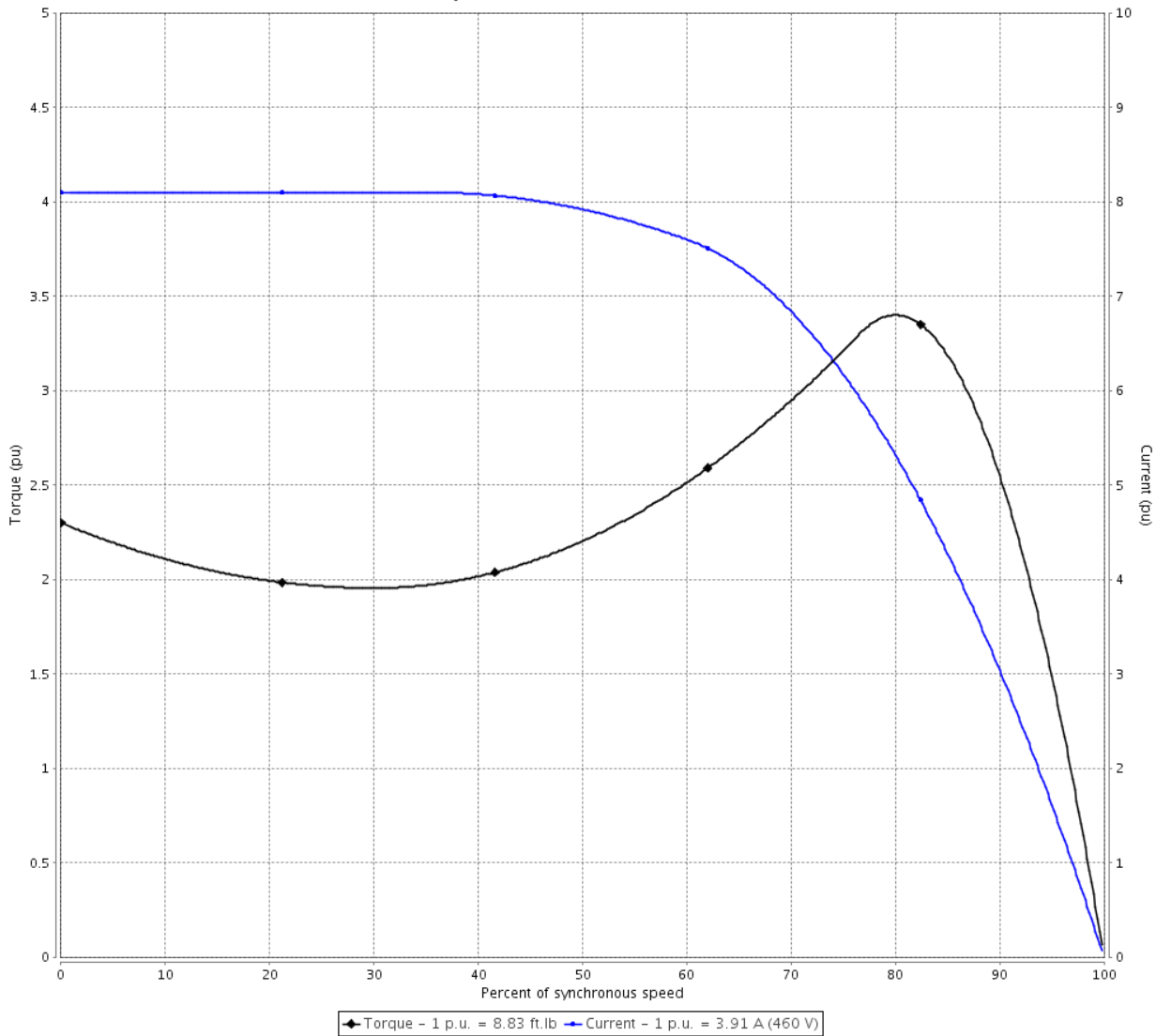

Performance : 208-230/460 V 60 Hz 4P

Rated current	: 8.65-7.82/3.91 A	Moment of inertia (J)	: 0.3401 sq.ft.lb
LRC	: 8.1	Duty cycle	: Cont.(S1)
Rated torque	: 8.83 ft.lb	Insulation class	: F
Locked rotor torque	: 229 %	Service factor	: 1.25
Breakdown torque	: 340 %	Temperature rise	: 80 K
Rated speed	: 1760 rpm	Design	: B

Locked rotor time : 41s (cold) 23s (hot)

Rev.	Changes Summary	Performed	Checked	Date
Performed by			Page 2 / 6	Revision
Checked by				
Date	15/01/2019			

LOAD PERFORMANCE CURVE

Three Phase Induction Motor - Squirrel Cage



Customer : _____

Product line : W22 NEMA Premium Efficiency
Three-Phase

Product code : 12445724

Catalog # : 00318ET3E182TC-W22

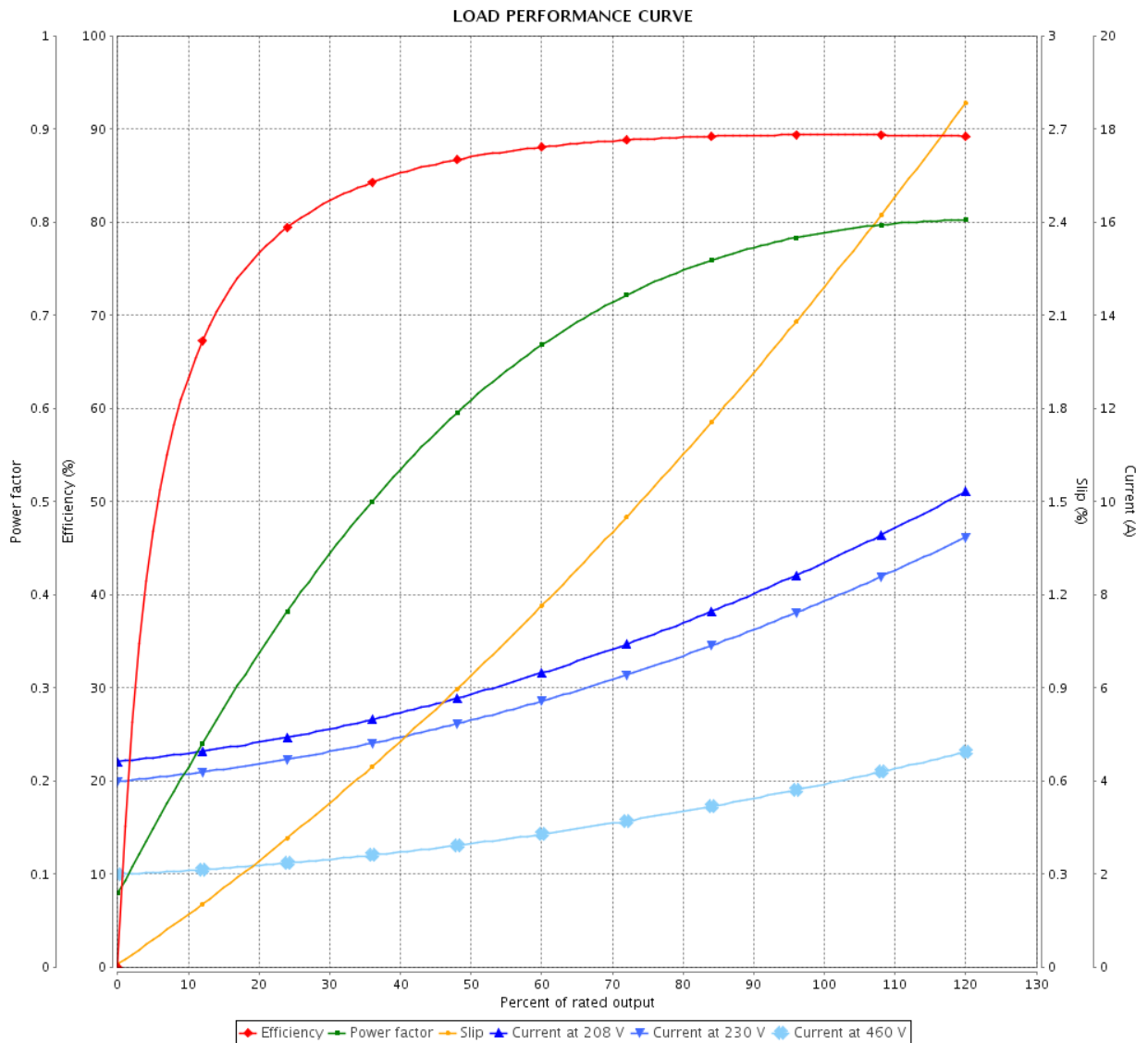

Performance : 208-230/460 V 60 Hz 4P

Rated current : 8.65-7.82/3.91 A
 LRC : 8.1
 Rated torque : 8.83 ft.lb
 Locked rotor torque : 229 %
 Breakdown torque : 340 %
 Rated speed : 1760 rpm

Moment of inertia (J) : 0.3401 sq.ft.lb
 Duty cycle : Cont.(S1)
 Insulation class : F
 Service factor : 1.25
 Temperature rise : 80 K
 Design : B

Rev.	Changes Summary	Performed	Checked	Date
Performed by		Page		Revision
Checked by		3 / 6		
Date		15/01/2019		

THERMAL LIMIT CURVE



Three Phase Induction Motor - Squirrel Cage

Customer :

Product line : W22 NEMA Premium Efficiency
Three-Phase

Product code : 12445724

Catalog # : 00318ET3E182TC-W22

Performance : 208-230/460 V 60 Hz 4P

Rated current : 8.65-7.82/3.91 A
LRC : 8.1
Rated torque : 8.83 ft.lb
Locked rotor torque : 229 %
Breakdown torque : 340 %
Rated speed : 1760 rpm

Moment of inertia (J) : 0.3401 sq.ft.lb
Duty cycle : Cont.(S1)
Insulation class : F
Service factor : 1.25
Temperature rise : 80 K
Design : B

Heating constant

Cooling constant

Rev.	Changes Summary	Performed	Checked	Date
Performed by			Page 4 / 6	Revision
Checked by				
Date	15/01/2019			

THERMAL LIMIT CURVE

Three Phase Induction Motor - Squirrel Cage



Customer : _____

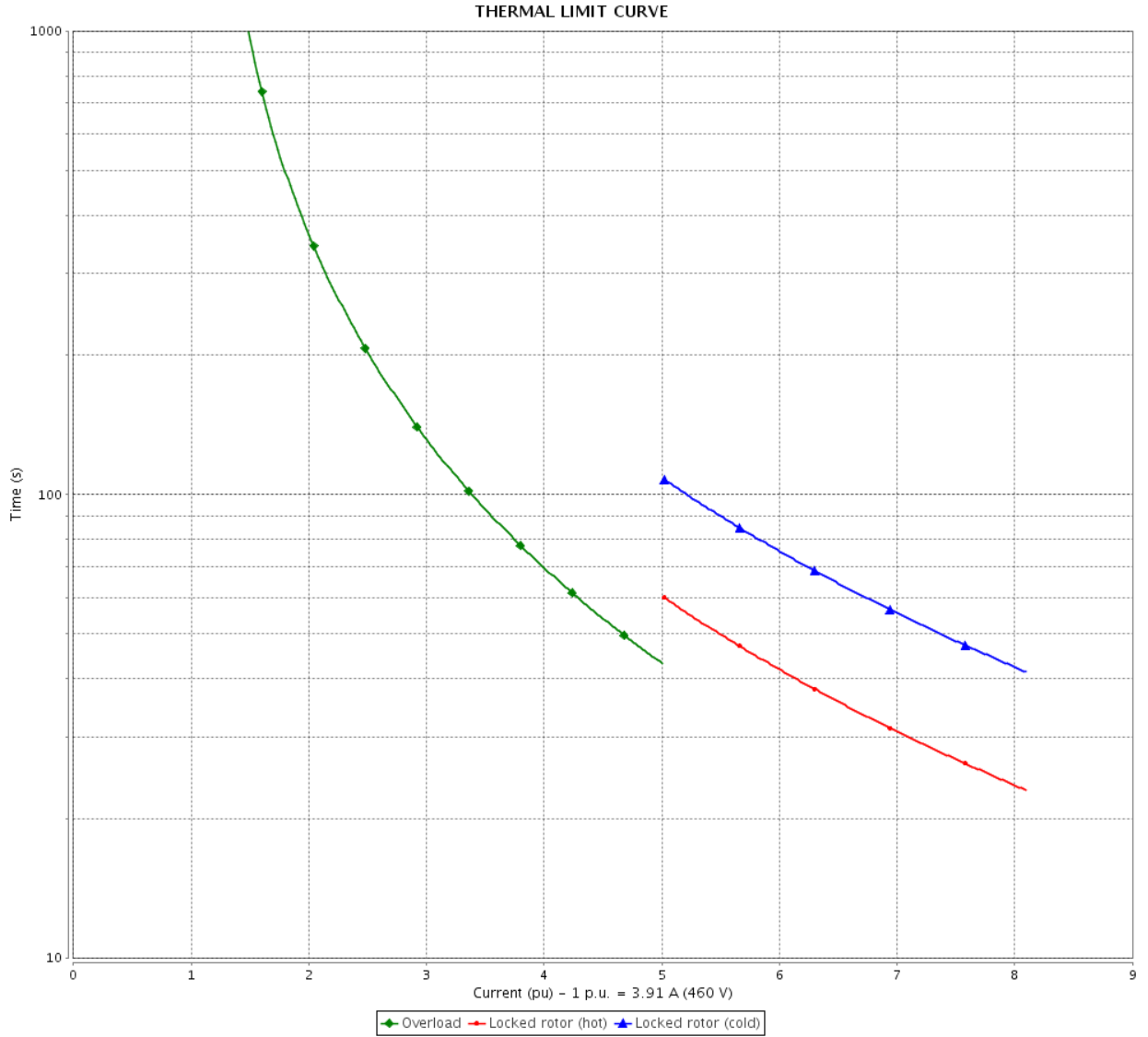

Rev.	Changes Summary	Performed	Checked	Date
Performed by				
Checked by				
Date				
			Page	Revision
			5 / 6	

VFD OPERATION CURVE

Three Phase Induction Motor - Squirrel Cage



Customer : _____

Product line : W22 NEMA Premium Efficiency
Three-Phase

Product code : 12445724

Catalog # : 00318ET3E182TC-W22

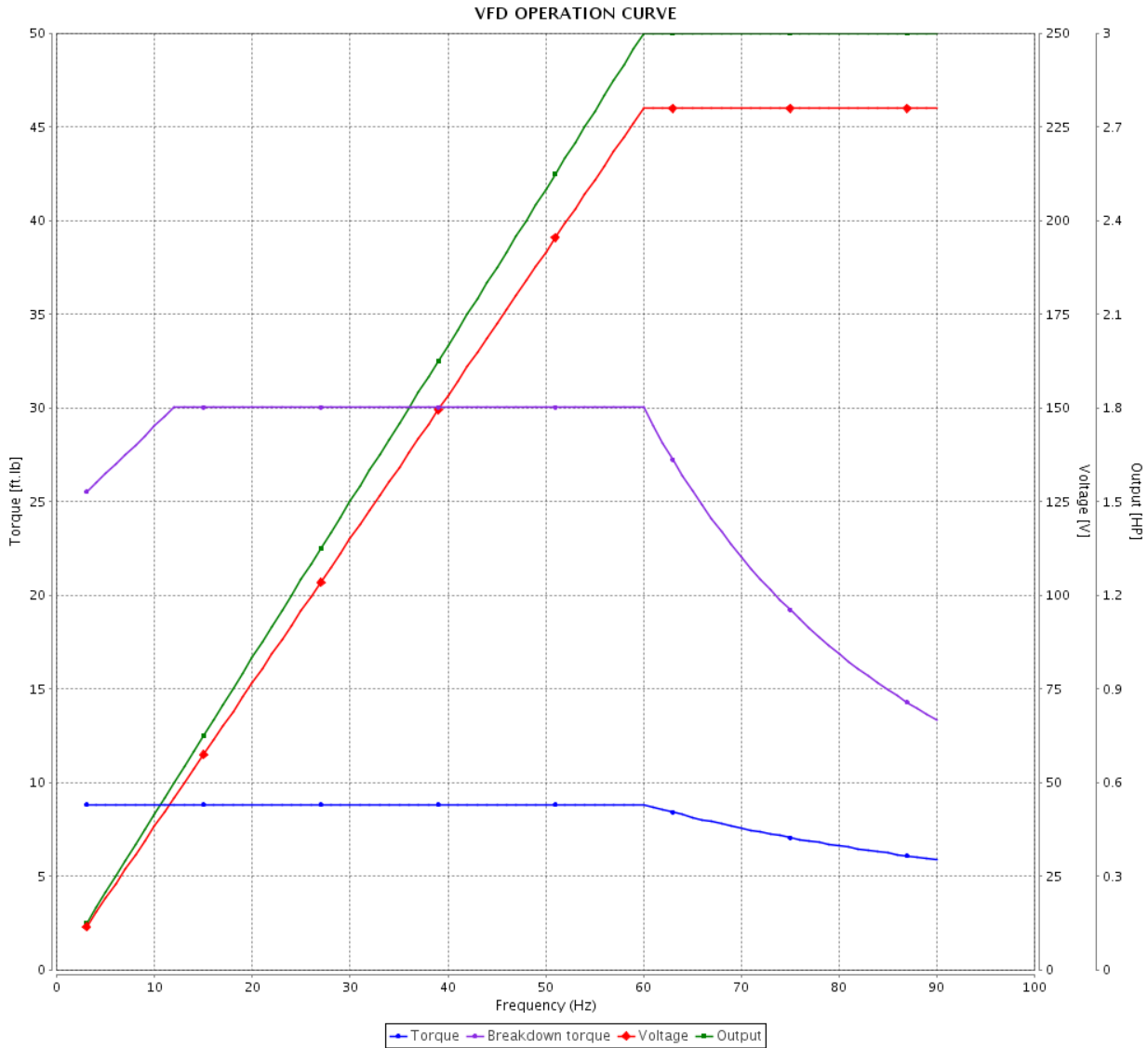

Performance : 208-230/460 V 60 Hz 4P

Rated current : 8.65-7.82/3.91 A
 LRC : 8.1
 Rated torque : 8.83 ft.lb
 Locked rotor torque : 229 %
 Breakdown torque : 340 %
 Rated speed : 1760 rpm

Moment of inertia (J) : 0.3401 sq.ft.lb
 Duty cycle : Cont.(S1)
 Insulation class : F
 Service factor : 1.25
 Temperature rise : 80 K
 Design : B

Rev.	Changes Summary	Performed	Checked	Date
Performed by			Page	Revision
Checked by				
Date				

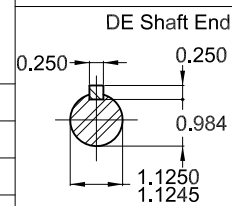
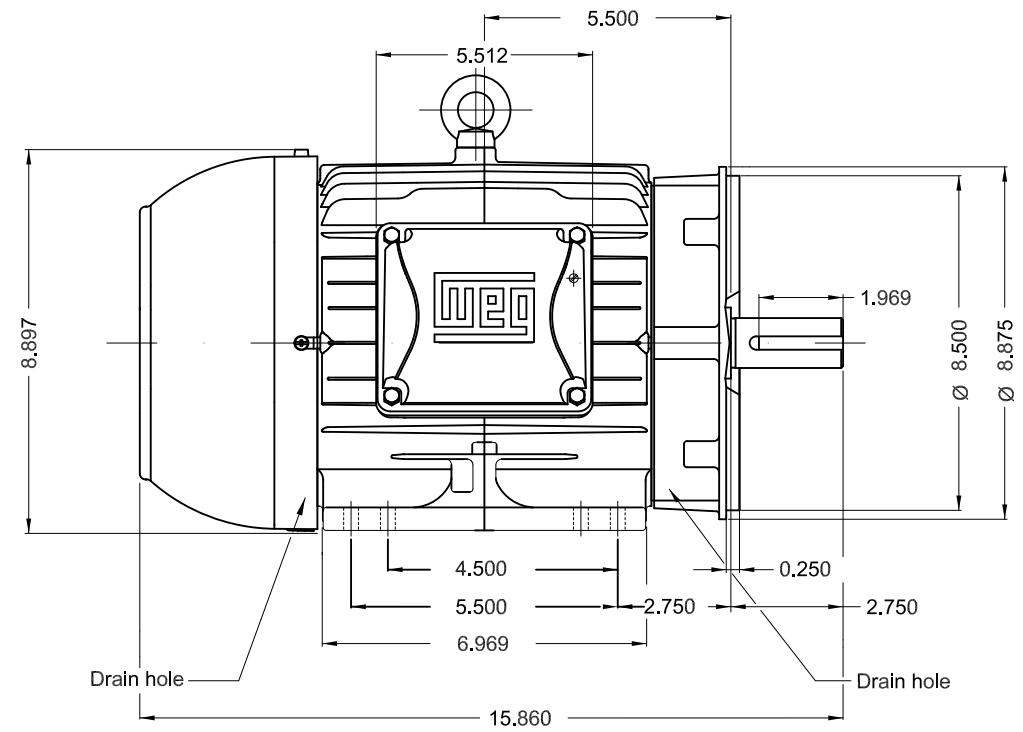
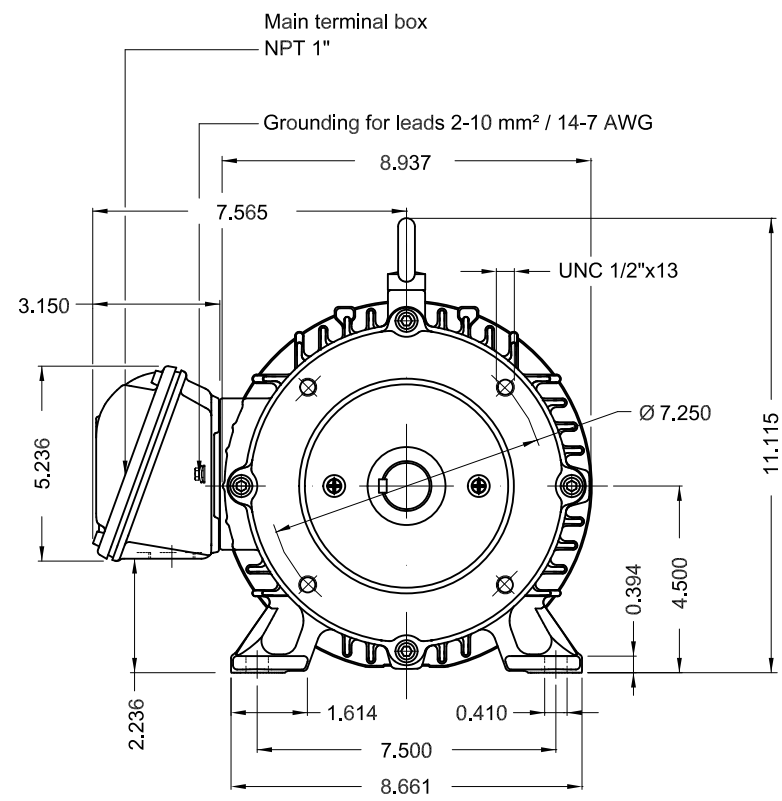

Bearing cap
 Color RAL 5009
 Painting plan 207A
 Mounting B34R(D)

3 HP 04 Poles 60Hz

A

ECM	LOC	SUMMARY OF MODIFICATIONS	EXECUTED	CHECKED	RELEASED	DATE	VER
EXECUTED	USERADMIN	THREE PHASE W22 MOTOR - NEMA PREMIUM EFF					
CHECKED		FRAME 182/4TC IP55 TEFC					
RELEASED							
REL DT	WMO	Jaragua do Sul	Product Engineering				

PREVIEW
 WDD



SHEET 1 / 1

**W22**

CC029A

® Inverter Duty Motor
Severe Duty

12445724

MADE IN MEXICO MODEL 00318ET3E182TC-W22

PH 3 | FR 182/4TC | HP(kw) 3.0(2.2) | Hz 60 | SF 1.25 | PF 0.79

V 230/460 | A 7.82/3.91 | RPM 1760 | INS. CL. F Δ T 80 K | IP55

NEMA NOM EFF 89.5 % | DES B | DUTY CONT. | AMB 40°C

ENCL TEFC | SFA 9.78/4.89 | USABLE @208V 8.65 A | SF 1.15 | SFA 9.95

2.2kW 50Hz 380V 4.60A 1445RPM SF1.25 EFF 87.5% (IE3) | CODE K

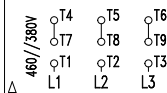
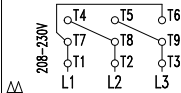

→6207-ZZ

→6206-ZZ

MOBIL POLYREX EM

ALT 1000 m.a.s.l. | 93 Lbs

For 60Hz: Class I, Div 2, Gr. A, B, C and D - T3

Class I, Zone 2, IIC - T3

Class II, Div 2, Gr. F and G - T5

For use on PWM, Gr. A, B, C, D, F and G

VT1000:1, CT20:1, 1.0SF, T4A

3PT9
US LISTEDFOR SAFE AREA
MOD.TE1BFOXON