

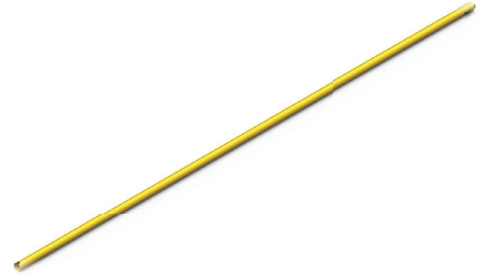

## GUY MARKER

### INSTALLATION INSTRUCTIONS



#### IMPORTANT SAFETY INFORMATION

**READ AND COMPLETELY UNDERSTAND ALL INSTRUCTIONS BEFORE INSTALLING PRODUCT. FAILURE TO FOLLOW THESE INSTRUCTIONS MAY RESULT IN PERSONAL INJURY OR DEATH.**

This product is intended for use by trained technicians only. This product should not be used by anyone who is not familiar with and not trained to use it. When working in the area of energized lines, extra care should be taken to prevent accidental electrical contact. Be sure to wear proper safety equipment per your company protocol. These instructions are not intended to supersede any company construction or safety standards. These instructions are offered only to illustrate safe installation for the individual. PLP products are intended for the specified application only. Do not modify this product under any circumstances. Do not reuse or reinstall any PLP product unless that capability is expressly indicated in the product's Installation Instructions. For proper performance and personal safety, be sure to select the proper PLP product before installation. PLP products are precision devices. To ensure proper performance, they should be stored in cartons under cover and handled carefully.

#### TUBE PROFILES

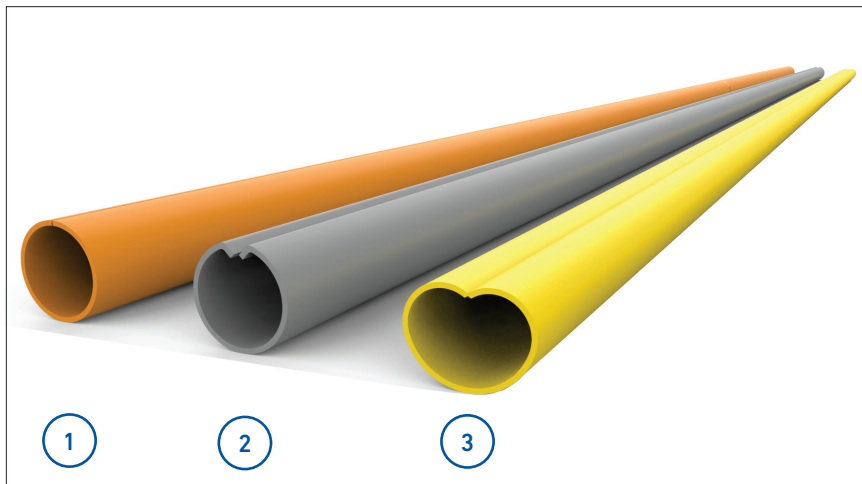

1. Round
2. Heart-Shaped (B-Profile)
3. Round Overlapping

#### ATTACHMENT OPTIONS

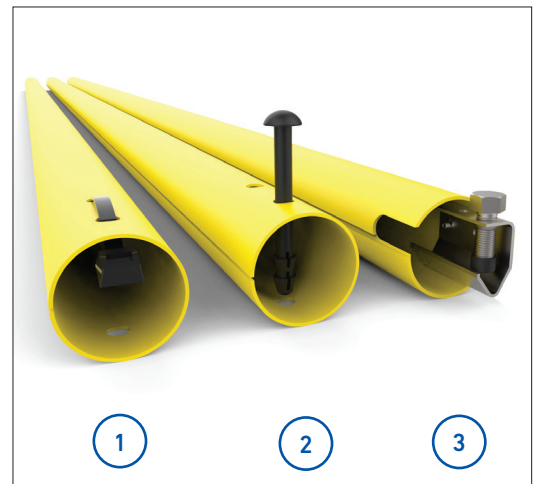

1. Universal Cable Tie
2. LOOP LOCK® Pin
3. Stainless Steel Clamp

#### Tools (Optional):

- Pliers
- Ratchet/socket or nut driver

## GUY MARKER TUBE INSTALLATION

- 1 Begin the application by placing the V-notch end of the Guy Marker (Image 1) onto the strand and apply pressure, forcing the tube completely over the strand. Bending the tube can help with this process (Image 2).

Continue pushing the Guy Marker up the strand until it is fully applied over the strand.

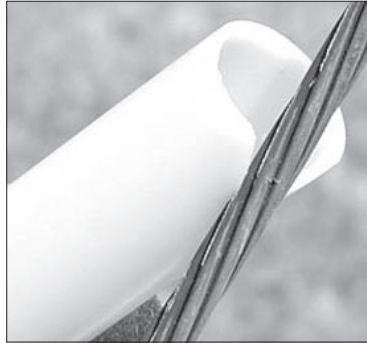

Image 1



Image 2

## ATTACHMENT OPTIONS INSTALLATION

### 2A Universal Cable Tie

Remove the Universal Cable Tie from the tube (Image 3). Once the tube is completely on the strand, thread the cable tie through the bottom holes of the Guy Marker and the dead-end loop (Image 4).

Secure the cable tie.



Image 3

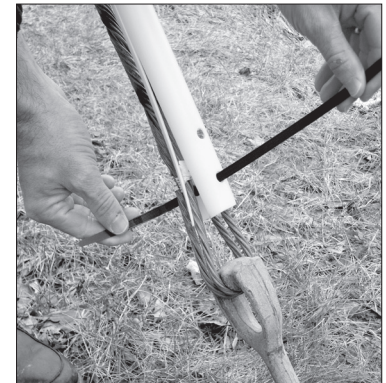

Image 4



Feed Tie Through the Tab



Pull to Tighten

### 2B LOOP LOCK® Pin

The LOOP LOCK Pin comes pre-installed in one of the two holes in the Guy Marker.

Once the tube is completely on the strand, push the pin through the dead-end loop and align it with the opposite hole. Using sufficient pressure, snap the pin through the opposite hole in the Guy Marker.

**NOTE:** Pliers may be used to snap the LOOP LOCK Pin into place.



## 2C

## Stainless Steel Clamp

**NOTE:** The clamp end of the Guy Marker can be installed at the top or bottom of the strand.

Begin by unscrewing the bolt as far as possible. Ensure the Guy Marker is in the desired location, and then secure the clamp by tightening the 9/16" bolt. A ratchet/socket or nut driver may be used.

### CAUTION

Do not overtighten the bolt. If the strand is larger than 1/2", remove the protective cap from the bolt before inserting the strand into the clamp.

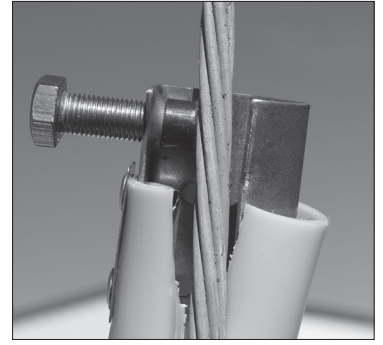

Top of Strand Installation



Bottom of Strand Installation



**GLOBAL HEADQUARTERS**  
660 BETA DRIVE  
CLEVELAND, OH 44143

+1 440 461 5200  
INFO@PLP.COM  
PLP.COM