

COYOTE® DEN

COYOTE DEN Wall Boxes are designed for indoor or outdoor fiber splice points commonly found at multi-dwelling units or utility poles that require the distribution of multiple drop cables or patch cords. The COYOTE DEN units are configured with fiber organizers for either direct splice or cross-connect applications and incorporate a flip tray management system to help organize customer connections. These durable wall boxes utilize a cable grommet system and an integrated cover gasket to prevent water and dust ingress into the closure, to ensure the protection of the critical network connections located inside them.

FEATURES AND BENEFITS

- Available in three different sizes (DEN2, DEN3, and DEN5) for either direct splice or cross-connect applications
- Can be directly mounted to an interior or exterior wall or banded to a pole
- Hinged cover that secures to the base with either locking tabs or hinging latches
- Optional lock for added security of the cover to the base
- Flexible grommet sealing system supports round and flat cable profiles
- Organizers are designed to accept flip trays which allow easy access to fibers and slack buffer tubes
- Flip trays store single fusion splices or PLC splitters
- Cross-connect organizer in the largest wall box size (DEN5) utilizes a flip cassette system for better management of patch cord routing and fiber connections
- Cross-connect organizers are compatible with SC or LC adapters (APC or UPC)
- Grommets, splice trays/cassettes, and organizer are supplied with each wall box
- Designed and tested in accordance with IEC 61753-1 Category A and rated to IP-65 requirements

CROSS-CONNECT ORGANIZER SYSTEMS FOR COYOTE® DEN2 & DEN3

- Removable organizers that protect the splice tray and buffer tubes from being tampered with once installed into the wall box
- Allows for incoming cables to be installed and spliced outside of the wall box
- Utilizes a 24 CT. low-profile flip splice tray to allow access to slack buffer tube storage
- Adapter cover protects incoming connections from being tampered with
- COYOTE DEN2 organizer accepts up to 8 duplex SC or quad LC connectors (16 SC or 32 LC connections). The DEN3 organizer accepts up to 12 duplex SC or quad LC connectors (24 SC or 48 LC connections)

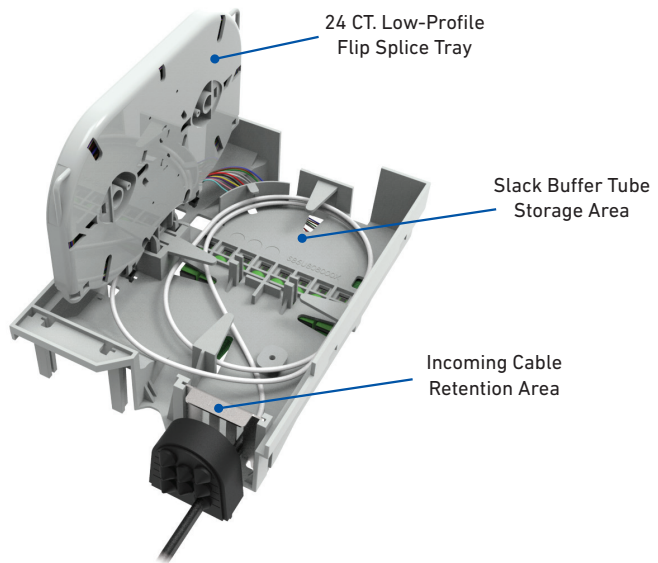

Bottom of COYOTE DEN2 Cross-Connect Organizer

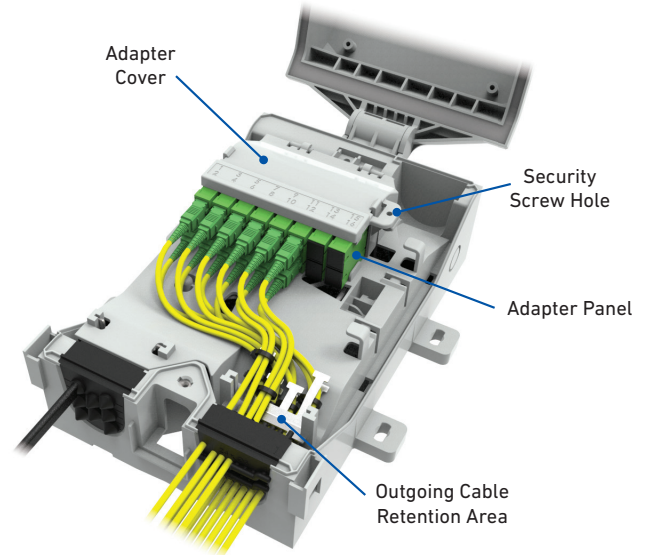

Top of COYOTE DEN2 Cross-Connect Organizer

FOR COYOTE® DEN5

- Organizer can be removed from the wall box to enable better access to routing features
- Utilizes a cassette tray system that allows splicing and fiber connections to be made on the same tray
- Modular design allows the cassette trays to rotate to gain access to fiber connections or slack buffer tubes
- Routing channels on the sides of each cassette tray allow incoming jumper cables or connectorized drop cables to route from the back of the wall box

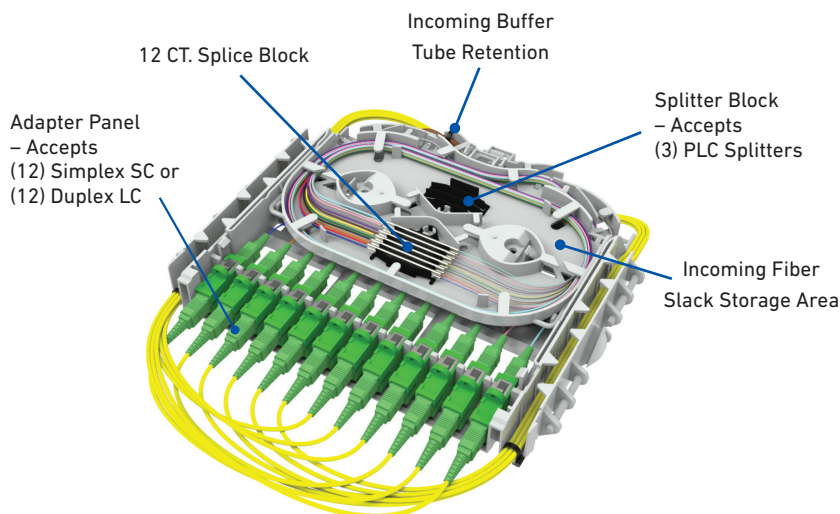

Cassette Tray with Cover Removed

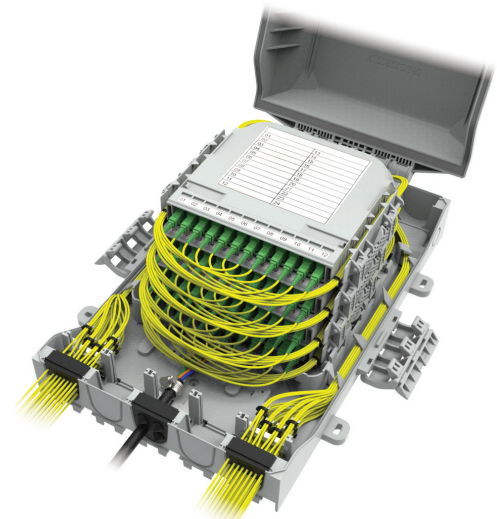
COYOTE DEN5 Cross-Connect Organizer
with 4 Cassette Trays



COYOTE® DEN2

Specifications

Catalog Number	COYDEN2-SPL	COYDEN2-XC
Application	Direct Splice	Cross-Connect
Splice Capacity (Maximum)	48 CT. Single Fusion	24 CT. Single Fusion
Number of Splice Trays (Maximum)	2 Low Profile	1 Low Profile
Adapter Port Quantity (Maximum)	Not Available	16 SC (Duplex) or 32 LC (Quad)
Indoor Cable Ports ^{1,3}	5	
Outdoor Cable Ports ^{2,3}	2	
Cable Diameters	0.07" – 0.12" (1.8 mm – 3.0 mm) & 0.14" – 0.51" (3.6 mm – 13.0 mm)	
Configuration	In-Line or Butt	
Application	Wall or Pole Mount	
Ingress Protection	IP-65	
Flame Protection	V0	
Size	9.9" L x 5.9" W x 3.3" H (252 x 150 x 85 mm)	

¹ Cable ports located on all sides of the wall box can be used for indoor applications.

² Cable ports located at bottom of the wall box can only be used for outdoor applications.

³ Multi-hole grommets allow for more than one cable to enter each cable port.

Components

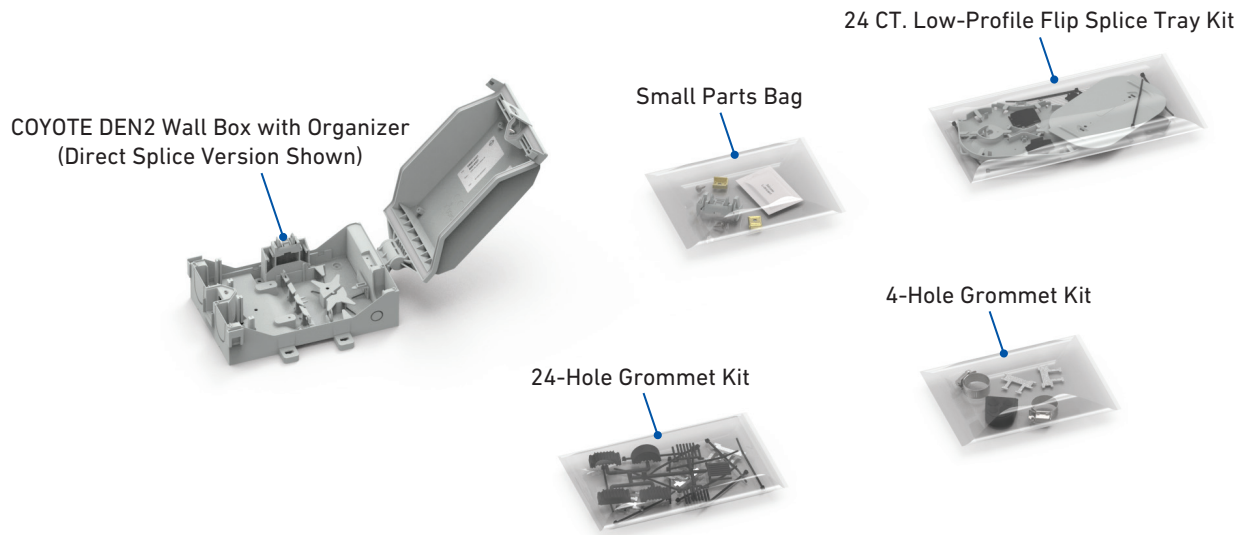

COYOTE DEN2 Wall Box Kits

Catalog Number	Description
COYDEN2-SPL	COYOTE DEN2 Wall Box with Direct Splice Organizer – Includes (2) COYOTE DEN 24 CT. Low-Profile Flip Splice Tray Kits, (1) 4-Hole Grommet Kit: (2 Holes) 0.38" – 0.46" (9.7 – 11.7 mm) & (2 Holes) 0.46" – 0.51" (11.7 – 13.0 mm), (1) 24-Hole Grommet Kit: (24 Holes) 0.07" – 0.12" (1.8 – 3.0 mm), & (1) Small Parts Bag
COYDEN2-XC	COYOTE DEN2 Wall Box with Cross-Connect Organizer – Includes (1) COYOTE DEN 24 CT. Low-Profile Flip Splice Tray Kits, (1) 4-Hole Grommet Kit: (2 Holes) 0.38" – 0.46" (9.7 – 11.7 mm) & (2 Holes) 0.46" – 0.51" (11.7 – 13.0 mm), (1) 24-Hole Grommet Kit: (24 Holes) 0.07" – 0.12" (1.8 – 3.0 mm), & (1) Small Parts Bag

COYOTE® DEN3

Specifications

Catalog Number	COYDEN3-SPL	COYDEN3-XC
Application	Direct Splice	Cross-Connect
Splice Capacity (Maximum)	96 CT. Single Fusion	48 CT. Single Fusion
Number of Splice Trays (Maximum)	4 Low Profile	2 Low Profile
Adapter Port Quantity (Maximum)	Not Available	24 SC (Duplex) or 48 LC (Quad)
Indoor Cable Ports ^{1, 3}	7	
Outdoor Cable Ports ^{2, 3}	3	
Cable Diameters	0.07" – 0.12" (1.8 mm – 3.0 mm) & 0.14" – 0.51" (3.6 mm – 13.0 mm)	
Configuration	In-Line or Butt	
Application	Wall or Pole Mount	
Ingress Protection	IP-65	
Flame Protection	V0	
Size	11.6" L x 7.4" W x 4.2" H (295 x 187 x 106 mm)	

¹ Cable ports located on all sides of the wall box can be used for indoor applications.

² Cable ports located at bottom of the wall box can only be used for outdoor applications.

³ Multi-hole grommets allow for more than one cable to enter each cable port.

Components

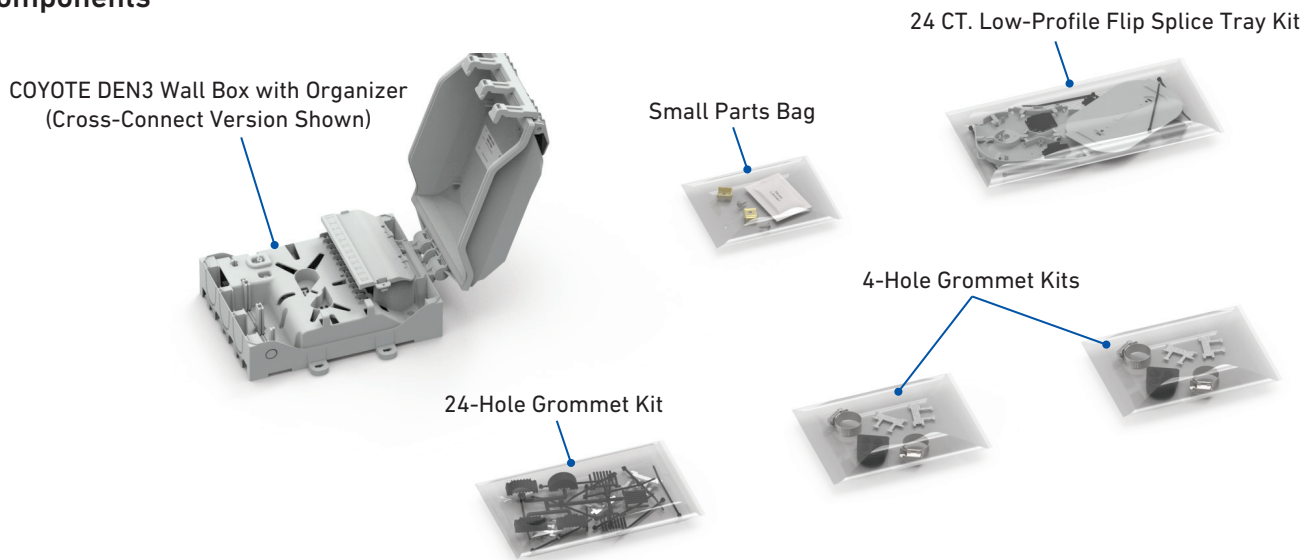

COYOTE DEN3 Wall Box Kits

Catalog Number	Description
COYDEN3-SPL	COYOTE DEN3 Wall Box with Direct Splice Organizer – Includes (4) COYOTE DEN 24 CT. Low-Profile Flip Splice Tray Kits, (1) 4-Hole Grommet Kit: (4 Holes) 0.30" – 0.38" (7.6 – 9.7 mm), (1) 4-Hole Grommet Kit: (2 Holes) 0.38" – 0.46" (9.7 – 11.7 mm) & (2 Holes) 0.46" – 0.51" (11.7 – 13.0 mm), (1) 24-Hole Grommet Kit: (24 Holes) 0.07" – 0.12" (1.8 – 3.0 mm), & (1) Small Parts Bag
COYDEN3-XC	COYOTE DEN3 Wall Box with Cross-Connect Organizer – Includes (2) COYOTE DEN 24 CT. Low-Profile Flip Splice Tray Kits, (1) 4-Hole Grommet Kit: (4 Holes) 0.30" – 0.38" (7.6 – 9.7 mm), (1) 4-Hole Grommet Kit: (2 Holes) 0.38" – 0.46" (9.7 – 11.7 mm) & (2 Holes) 0.46" – 0.51" (11.7 – 13.0 mm), (1) 24-Hole Grommet Kit: (24 Holes) 0.07" – 0.12" (1.8 – 3.0 mm), & (1) Small Parts Bag



COYOTE® DEN5 FOR DIRECT SPLICE APPLICATIONS

Specifications

Catalog Number	COYDEN5-SPL
Application	Direct Splice
Splice Capacity (Maximum)	96 CT. Single Fusion
Number of Splice Trays (Maximum)	4 Deep Profile
Indoor Cable Ports ^{1,3}	9
Outdoor Cable Ports ^{2,3}	5
Cable Diameters	0.07" – 0.12" (1.8 mm – 3.0 mm) & 0.14" – 0.51" (3.6 mm – 13.0 mm)
Configuration	In-Line or Butt
Application	Wall or Pole Mount
Ingress Protection	IP-65
Flame Protection	V0
Size	16.8" L x 11.4" W x 5.2" H (427 x 290 x 132 mm)

¹ Cable ports located on all sides of the wall box can be used for indoor applications.

² Cable ports located at bottom of the wall box can only be used for outdoor applications.

³ Multi-hole grommets allow for more than one cable to enter each cable port.

Components

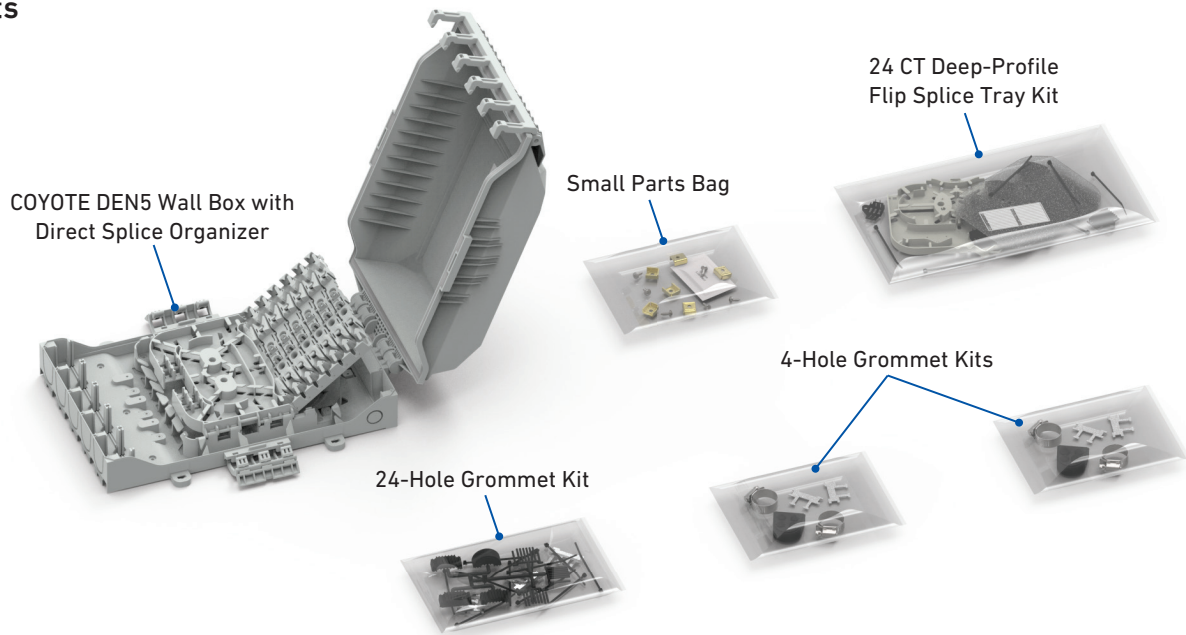

COYOTE DEN5 Wall Box Kit for Direct Splice Applications

Catalog Number	Description
COYDEN5-SPL	COYOTE DEN5 Wall Box with Direct Splice Organizer – Includes (4) COYOTE DEN 24 CT. Deep Profile Flip Splice Tray Kits, (1) 4-Hole Grommet Kit: (2 Holes) 0.38" – 0.46" (9.7 – 11.7 mm) & (2 Holes) 0.46" – 0.51" (11.7 – 13.0 mm), (1) 24-Hole Grommet Kit: (24 Holes) 0.07" – 0.12" (1.8 – 3.0 mm), & (1) Small Parts Bag

COYOTE® DEN5 FOR CROSS-CONNECT APPLICATIONS

Specifications

Catalog Number	COYDEN5-CSTE2	COYDEN5-CSTE4
Application	Cross-Connect	
Splice Capacity (Maximum)	48 CT. Single Fusion	96 CT. Single Fusion
Number of Cassettes (Maximum)	2	4
Adapter Port Quantity (Maximum)	24 SC (Simplex) or 48 LC (Duplex)	48 SC (Simplex) or 96 LC (Duplex)
Indoor Cable Ports ^{1,3}	9	
Outdoor Cable Ports ^{2,3}	5	
Cable Diameters	0.07" – 0.12" (1.8 mm – 3.0 mm) & 0.14" – 0.51" (3.6 mm – 13.0 mm)	
Configuration	In-Line or Butt	
Application	Wall or Pole Mount	
Ingress Protection	IP-65	
Flame Protection	V0	
Size	16.8" L x 11.4" W x 5.2" H (427 x 290 x 132 mm)	

¹ Cable ports located on all sides of the wall box can be used for indoor applications.

² Cable ports located at bottom of the wall box can only be used for outdoor applications.

³ Multi-hole grommets allow for more than one cable to enter each cable port.

Components

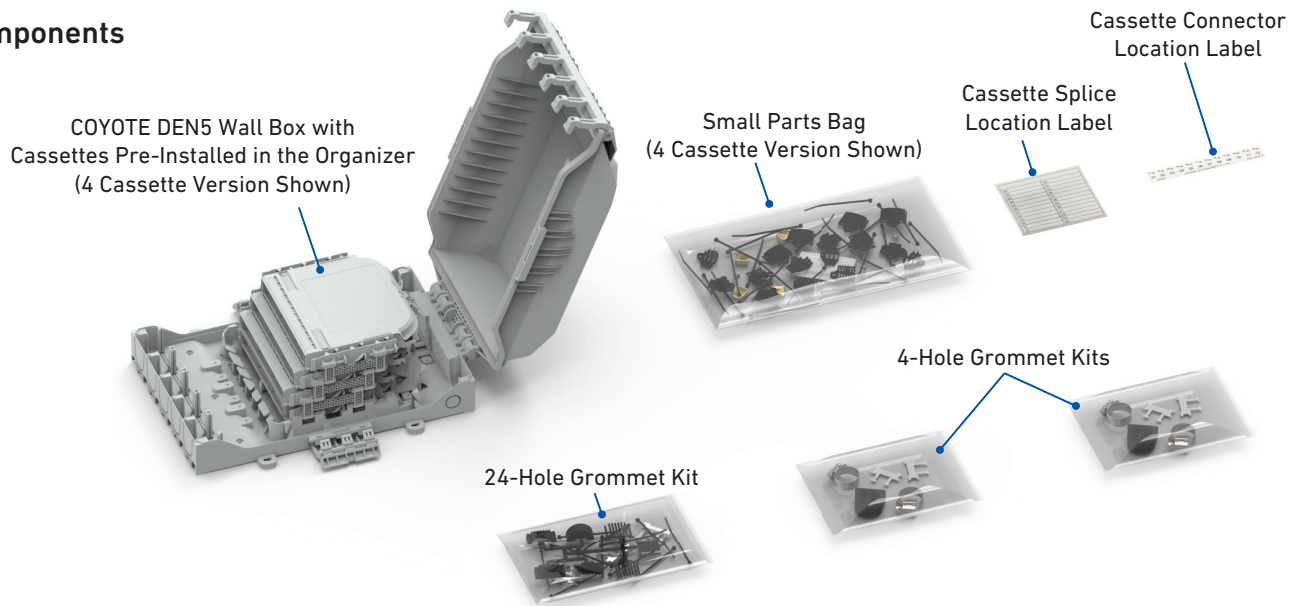

COYOTE DEN5 Wall Box Kits for Cross-Connect Applications

Catalog Number	Description
COYDEN5-CSTE2	COYOTE DEN5 Wall Box with 2 Cassette Trays – Includes (2) Cassette Splice Location Labels, (2) Cassette Connector Location Labels, (1) 4-Hole Grommet Kit: (2 Holes) 0.38" – 0.46" (9.7 – 11.7 mm) & (2 Holes) 0.46" – 0.51" (11.7 – 13.0 mm), (2) 24-Hole Grommet Kit: (24 Holes) 0.07" – 0.12" (1.8 – 3.0 mm), & (1) Small Parts Bag
COYDEN5-CSTE4	COYOTE DEN5 Wall Box with 4 Cassette Trays – Includes (4) Cassette Splice Location Labels, (4) Cassette Connector Location Labels, (1) 4-Hole Grommet Kit: (2 Holes) 0.38" – 0.46" (9.7 – 11.7 mm) & (2 Holes) 0.46" – 0.51" (11.7 – 13.0 mm), (2) 24-Hole Grommet Kit: (24 Holes) 0.07" – 0.12" (1.8 – 3.0 mm), & (1) Small Parts Bag