



# SERVI-BOND™ SHIELD CONNECTOR

## INSTALLATION INSTRUCTIONS



### IMPORTANT SAFETY INFORMATION

**READ AND COMPLETELY UNDERSTAND ALL INSTRUCTIONS BEFORE INSTALLING PRODUCT. FAILURE TO FOLLOW THESE INSTRUCTIONS MAY RESULT IN PERSONAL INJURY OR DEATH.**

This product is intended for use by trained technicians only. This product should not be used by anyone who is not familiar with and not trained to use it. When working in the area of energized lines, extra care should be taken to prevent accidental electrical contact. Be sure to wear proper safety equipment per your company protocol. These instructions are not intended to supersede any company construction or safety standards. These instructions are offered only to illustrate safe installation for the individual. PLP products are intended for the specified application only. Do not modify this product under any circumstances. Do not reuse or reinstall any PLP product unless that capability is expressly indicated in the product's Installation Instructions. For proper performance and personal safety, be sure to select the proper PLP product before installation. PLP products are precision devices. To ensure proper performance, they should be stored in cartons under cover and handled carefully.

### SERVI-BOND SHIELD CONNECTOR TYPES

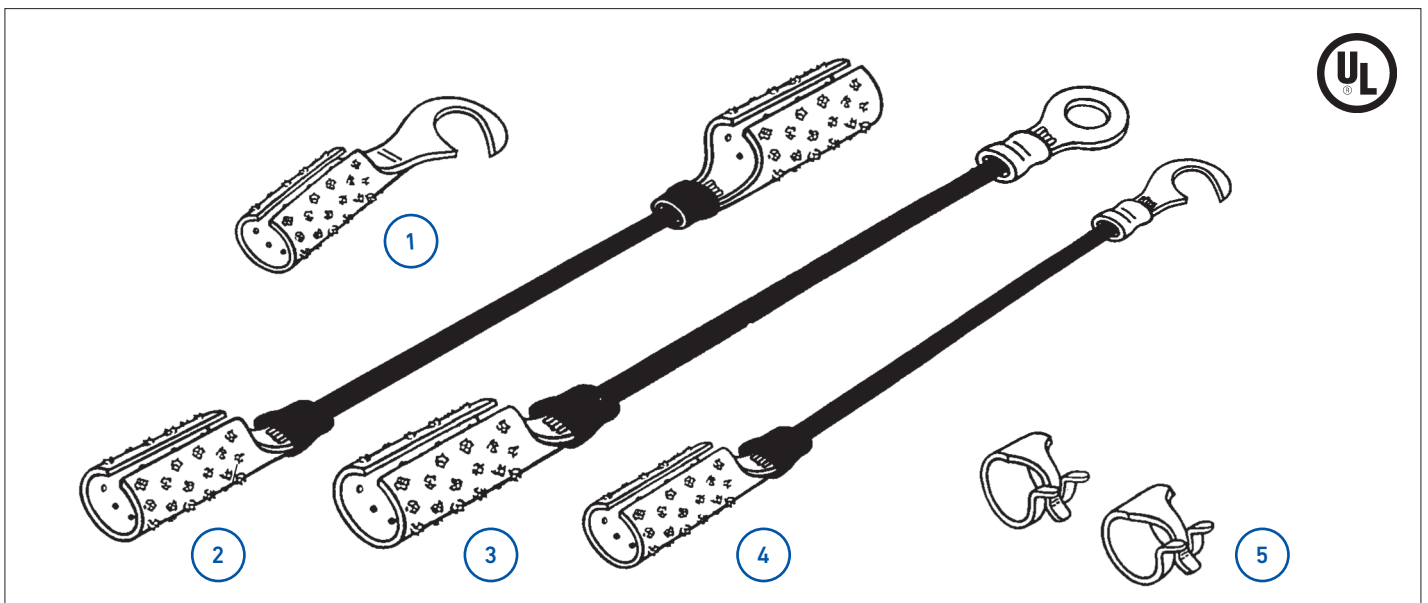

1. Short Neck
2. Floating Special
3. Floating Ring Terminal
4. Floating Hook Terminal
5. Spring Clamps

## CABLE PREPARATION AND INSTALLATION

- 1 The SERVI-BOND Shield Connector is designed to provide or extend shield continuity between various sizes and types of twisted-pair service wires and a point of ground.

Pull service wire through grommet entry on terminal block or Network Interface Device leaving 10" of cable extending above the grommet. Remove outer jacket and shield of service wire approximately 1-1/2" above the grommet.

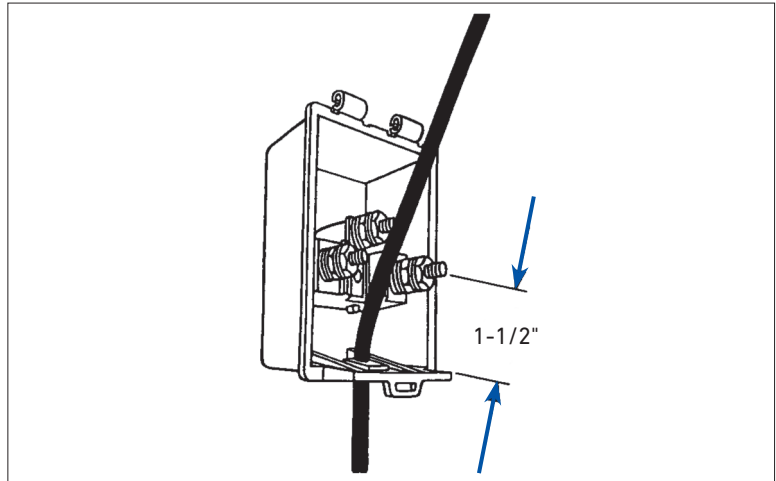

- 2 Remove inner core or core wrapper to expose primary conductors, leaving approximately 1/8" of core sheath or core wrapper extending beyond the end of the outer jacket.

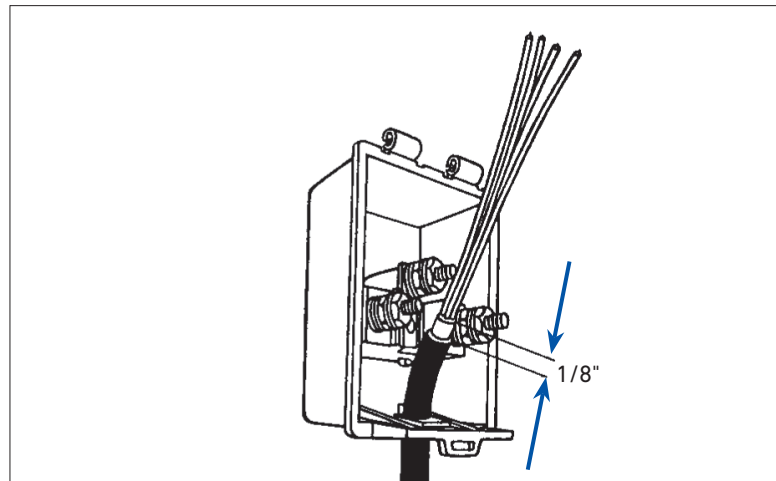

## CONNECTOR ASSEMBLY

- 3 Position the spring clamps over the service wire. Cut open the outer jacket and shield of the service wire with a single slit approximately 1-1/4" long.

**NOTE:** The inner core sheath or core wrapper must not be slit in order to protect the primary conductors from damage. It may be necessary to displace the grommet during the SERVI-BOND Shield Connector installation.

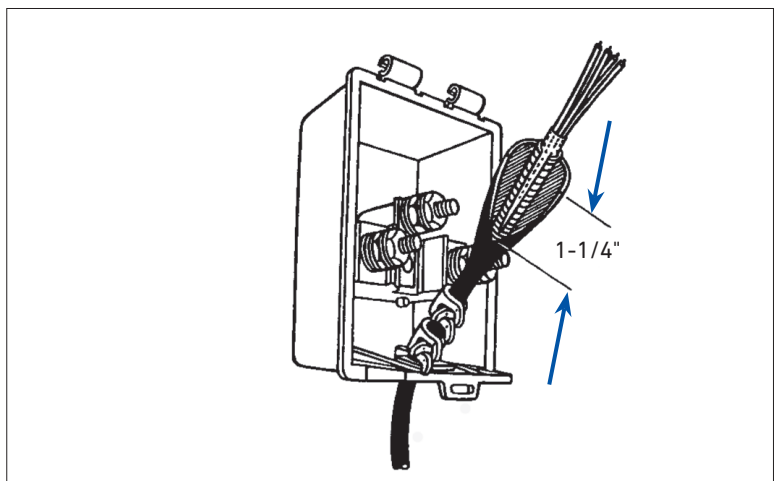

4

Slip the serrated portion of the SERVI-BOND Shield Connector over the inner core sheath or core wrapper. Wrap the open outer jacket and shield of the service wire around the serrated portion of the SERVI-BOND Shield Connector and apply gentle pressure with pliers or channel locks to force SERVI-BOND Shield Connector serrations into shield.

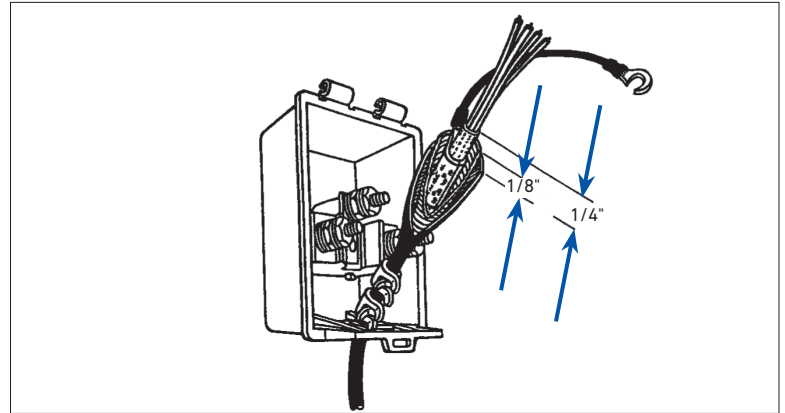

## FINAL APPLICATION

5

Use pliers to slip spring clamps (refer to chart) around the service wire and serrated portion of the SERVI-BOND Shield Connector.

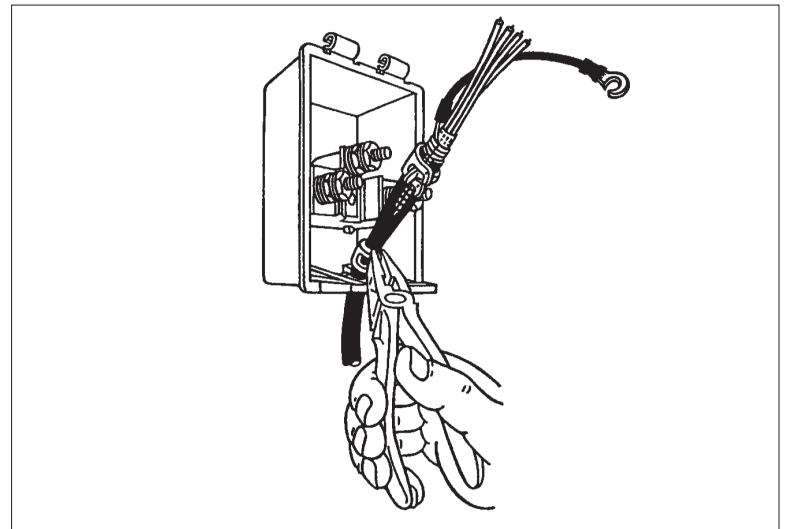

6

Position SERVI-BOND Shield Connector hook (or ring terminal) over ground post and secure. Hook (or ring) must be installed left to right.

Terminate primary conductors to protector posts in accordance with system standard practice.

Reposition the grommet if necessary.

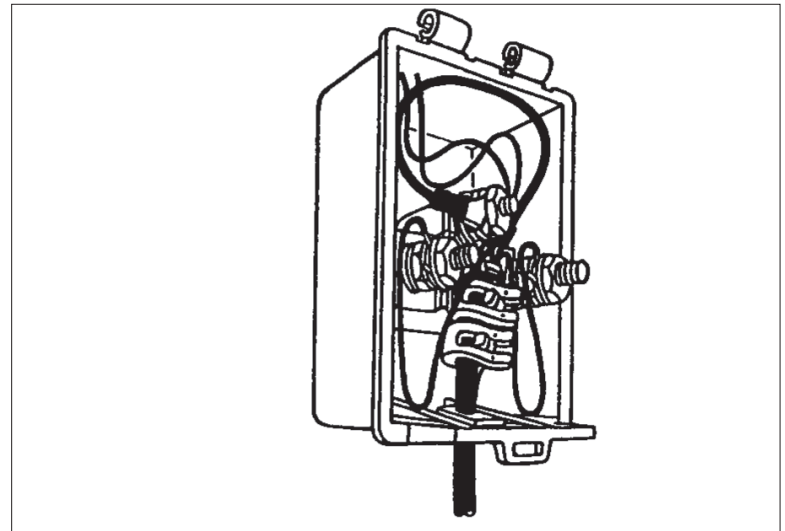

Catalog Number	Spring Clamp Color Code	Maximum Service Wire Diameter in	Service Cable Range
8000735 (Short Neck)	Silver	0.30	2-Pair or 3-Pair (Armored and Non-Armored)
8000736 (Short Neck)	Yellow	0.36	5-Pair or 6-Pair (Non-Armored)
	Black	0.41	5-Pair or 6-Pair Armored
8000737 4.5" Harness (Floating Neck Terminal)	Silver	0.30	2-Pair or 3-Pair (Armored and Non-Armored)
8000738 4.5" Harness (Floating Hook Terminal)	Yellow	0.36	5-Pair or 6-Pair (Non-Armored)
	Black	0.41	5-Pair or 6-Pair Armored
8000739* 7" Harness (Floating Hook Terminal)	Silver	0.30	2-Pair or 3-Pair (Armored and Non-Armored)
8000744* 7" Harness (Floating Hook Terminal)	Silver	0.36	5-Pair or 6-Pair (Armored and Non-Armored)
	Black	0.41	5-Pair or 6-Pair (Armored and Non-Armored)
8000746 14" harness (Floating Hook Terminal)	Silver	0.36	5-Pair or 6-Pair (Armored and Non-Armored)
	Black	0.41	5-Pair or 6-Pair (Armored and Non-Armored)
8000748 2.75" harness (Floating Special)	Black	0.41	5-Pair or 6-Pair (Armored and Non-Armored)
8000750 4.5" harness (Floating Ring Terminal)	Yellow	0.36	5-Pair or 6-Pair
	Black	0.41	5-Pair or 6-Pair (Armored and Non-Armored)
8000752 4.5" harness (Floating Hook Terminal)	Aluminum	0.56	12-Pair (Armored and Non-Armored)

\* REA Accepted