

COYOTE[®] ACE

The **COYOTE ACE (Adaptable Connection Enclosure)** offers the greatest flexibility to address the multitude of connection options required to support home and office networks. Interchangeable inserts allow the enclosure to be configured to support fiber/coax applications, fiber/CAT6 applications, Coax/CAT6 application, coax only applications and fiber only applications. The enclosure can be used in conjunction with the COYOTE Fiber Wall Plates to support additional fiber slack storage or applications requiring 1x4 coax splitters. Each COYOTE ACE is produced from flame retardant compounds.

FEATURES AND BENEFITS

- Supports splice/patch applications and multiple connection types
- Accepts industry standard adapters and coax splitters
- Fiber entrance slots on side and top of base for surface mount applications using raceway
- Large opening in back wall of base to support transition of fiber or coax when mounted to an electrical outlet box
- Can be combined with the COYOTE Access Solutions™ Fiber Wall Plate to provide additional slack storage or address fiber with coax splitter applications
- Flame retardant

COYOTE® ACE

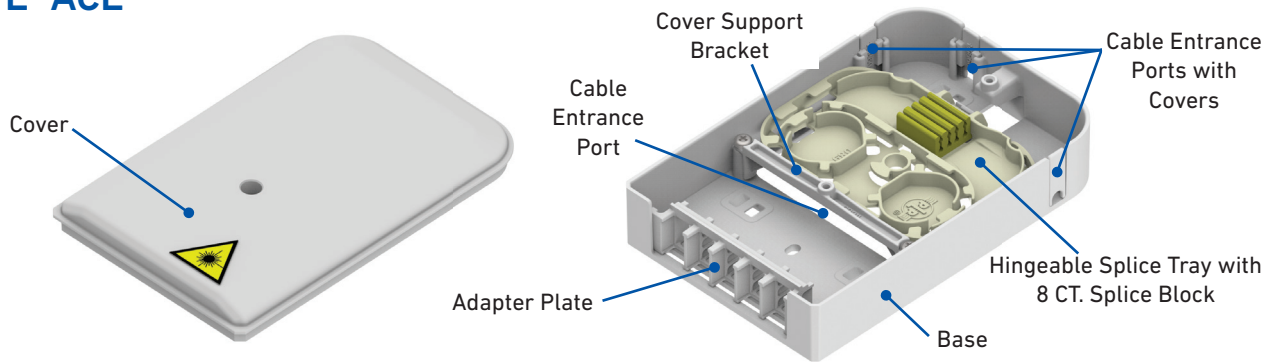

Specifications

Catalog Numbers	COYACE-001 through COYACE-008
Splice Capacity (Maximum) – Single Fusion	8
Adapter Port Quantity (Maximum)	(5) SC, (10) LC, (1) 1x2, 1x3, or 1x4 Coax Splitter, (2) CAT5, CAT6, RJ11, RJ45, or Coax Adapters
Adapter Plate Configurations	(5) Fiber Adapters, (3) Fiber Adapters and (1) Ethernet or Coax Adapter, (1) Fiber Adapter and (2) Ethernet or Coax Adapter, (1) Fiber Adapter and (1) 1x2 Coax Splitter, (1) Ethernet or Coax Adapter and (1) 1x2 Coax Splitter, or (1) 1x3 or 1x4 Coax Splitter
Colors	White
Cable Entrance Ports	(1) Top Edge, (1) Left Edge, (1) Right Edge, and (1) Back of Base
Size	4" W x 6" L x 1" D (102 x 152 x 25 mm)

COYOTE ACE Kit Contents

Catalog Numbers	Description
COYACE-000	COYOTE ACE – Includes (1) Base, (1) Cover, (5) Empty Adapter Plates, (3) Port Covers, and Mounting Hardware
COYACE-001	COYOTE ACE – Includes (1) Splice Tray Kit and (2) SC/APC Shuttered Adapters and Pigtailed
COYACE-002	COYOTE ACE – Includes (1) Splice Tray Kit and (5) SC/APC Shuttered Adapters and Pigtailed
COYACE-003	COYOTE ACE – Includes (1) Splice Tray Kit and (2) SC/UPC Shuttered Adapters and Pigtailed
COYACE-004	COYOTE ACE – Includes (1) Splice Tray Kit and (5) SC/UPC Shuttered Adapters and Pigtailed
COYACE-005	COYOTE ACE – Includes (1) CAT6 Adapter, (1) Coax Adapter, and (1) SC/APC Shuttered Adapter
COYACE-006	COYOTE ACE – Includes (1) Coax Adapter and (1) SC/APC Shuttered Adapter
COYACE-007	COYOTE ACE – Includes (1) SC/APC Shuttered Adapter
COYACE-008	COYOTE ACE – Includes (1) Splice Tray Kit and (1) SC/APC Shuttered Adapters and Pigtailed

All kits include (1) Base, (1) Cover, (5) Empty Adapter Plates, (3) Port Covers and Mounting Hardware

COYOTE ACE Accessories

Catalog Numbers	Description
8004034	Splice Tray Kit – Includes (1) Splice Tray and (1) Splice Block
80811215	Adapter Kit – Includes (2) SC/APC Shuttered Adapters
80811216	Adapter Kit – Includes (3) SC/APC Shuttered Adapters
80813611	Adapter Kit – Includes (2) LC/APC Shuttered Adapters
80813612	Adapter Kit – Includes (3) LC/APC Shuttered Adapters
800014114	Adapter Kit – Includes (2) SC/UPC Shuttered Adapters
800014115	Adapter Kit – Includes (3) SC/UPC Shuttered Adapters
80813613	Adapter Kit – Includes (2) LC/UPC Shuttered Adapters
80813614	Adapter Kit – Includes (3) LC/UPC Shuttered Adapters
800013979	Pigtail Kit – Includes (2) SC/APC 900 µm Pigtailed
800013980	Pigtail Kit – Includes (3) SC/APC 900 µm Pigtailed
800014109	Pigtail Kit – Includes (2) SC/UPC 900 µm Pigtailed
800014110	Pigtail Kit – Includes (3) SC/UPC 900 µm Pigtailed
80811135	CAT6 Jack
80812152	Coax Jack

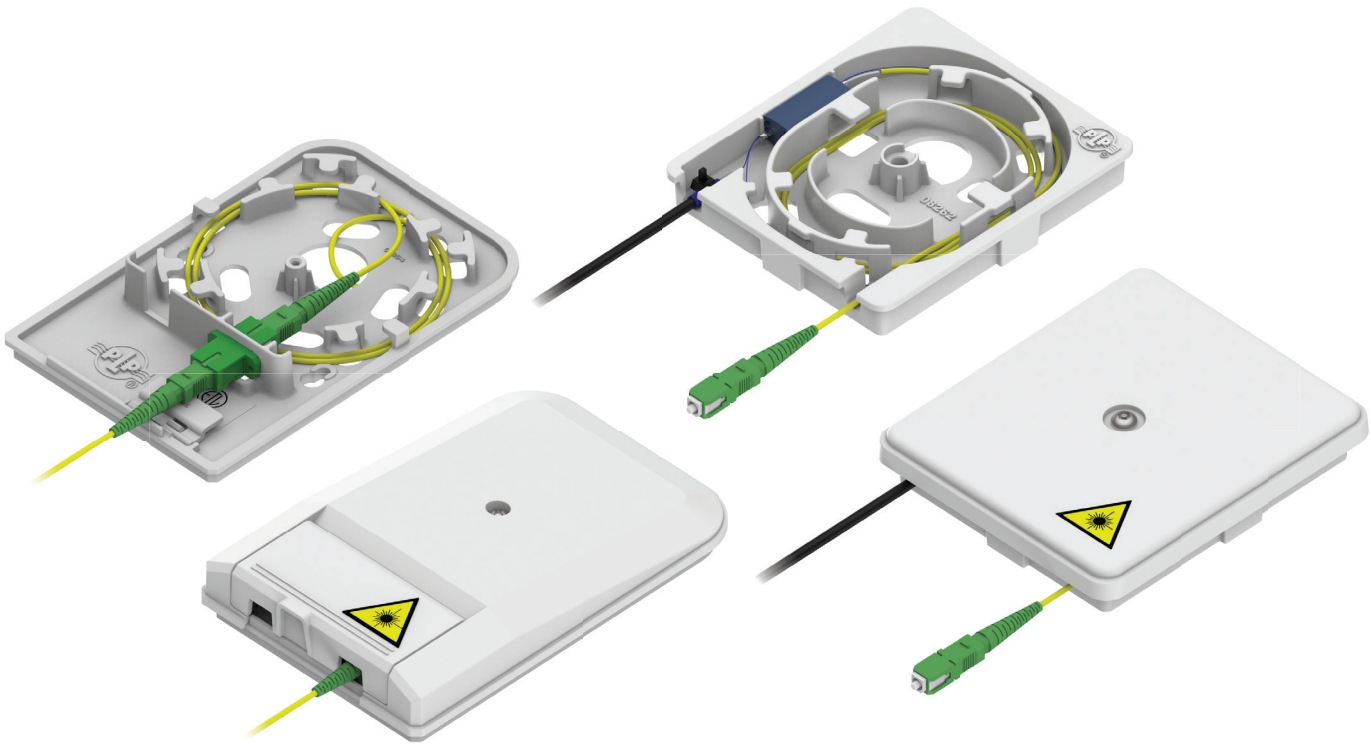

COYOTE® ACCESS SOLUTIONS™ FIBER WALL PLATES

The **COYOTE Access Solutions Fiber Wall Plates** are compact fiber organizers used to create a fiber demarcation point inside the home, office, or apartment. Internal fiber routing features control bend radius and allows for slack storage outside of the wall cavity. Specific designs also provide for splicing inside the wall plate. Each wall plate is produced from flame retardant compounds, is easy to install and is capable of being mounted directly to a standard electrical junction box or a wall.

FEATURES AND BENEFITS

Fiber Wall Plate

- Designed to store a pre-connectorized pigtail for connection to a mating adapter
- Mounts to standard electrical junction boxes or wall
- Internal fiber routing provides bend radius control
- Hinged door provides open access for easy fiber connection or removal
- Internal adapter with automatic shutter provides protection from laser light output
- Flame retardant

Splice & Store Fiber Wall Plate

- Designed for splicing and storing a pre-connectorized fiber pigtail
- Provides up to 8 ft (2430 mm) of 2 mm or 4 ft (1220 mm) of 3 mm jacketed fiber
- Fiber entrance ports through the back and bottom edge of the wall plate
- Flame retardant

FIBER WALL PLATE

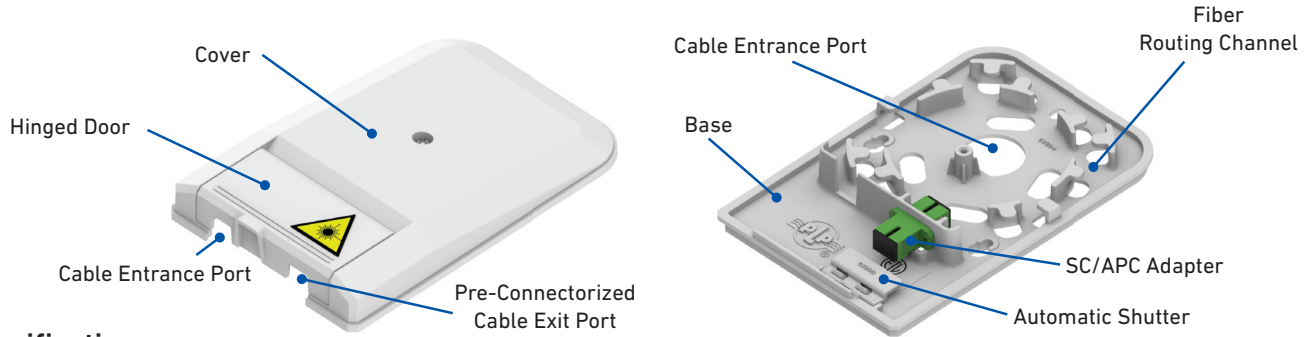

Specifications

Catalog Numbers	8006992W, 8006992IV
Splice Capacity	0
Adapter Port Quantity (Maximum)	1 SC/APC (provided)
Colors	White and Almond
Cable Entrance Ports	(1) Bottom Edge and (1) Back of Base
Size	4" W x 6" L x 1" D (102 x 152 x 25 mm)

COYOTE Fiber Wall Plate Kit Contents

Catalog Numbers	Description
8006992W	COYOTE Fiber Wall Plate in White – Includes (1) Base, (1) Cover, (1) SC/APC Factory Installed Adapter and (1) Mounting Hardware Kit
8006992IV	COYOTE Fiber Wall Plate in Almond – Includes (1) Base, (1) Cover, (1) SC/APC Factory Installed Adapter and (1) Mounting Hardware Kit

SPLICE & STORE FIBER WALL PLATE

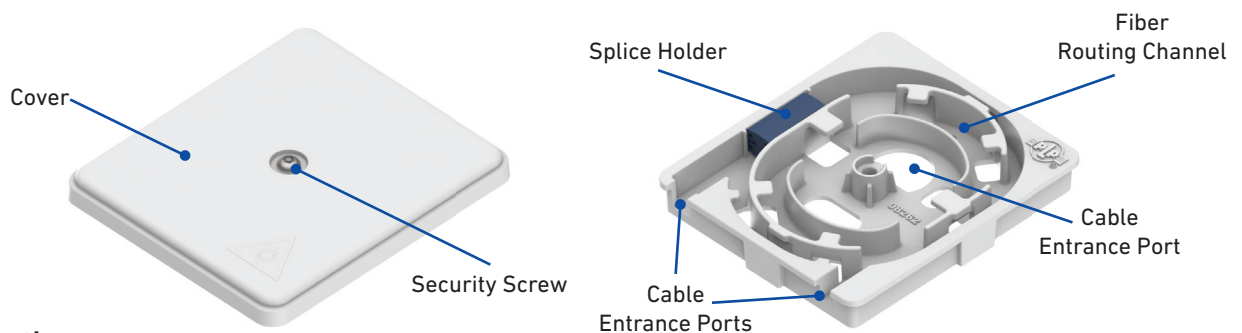

Specifications

Catalog Numbers	80061045
Splice Capacity	1
Adapter Port Quantity (Maximum)	0
Colors	White
Cable Entrance Ports	(2) Bottom Edge and (1) Back of Base
Size	4.5" W x 5.0" L x 0.87" D (114 x 127 x 22 mm)

COYOTE Fiber Wall Plate Kit Contents

Catalog Number	Description
80061045	COYOTE Splice & Store Fiber Wall Plate in White – Includes (1) Base, (1) Cover, (1) Blue LITE-GRIP® Retention Block, (1) Felt Strip, (2) Tie Wraps and (1) Security Screw