

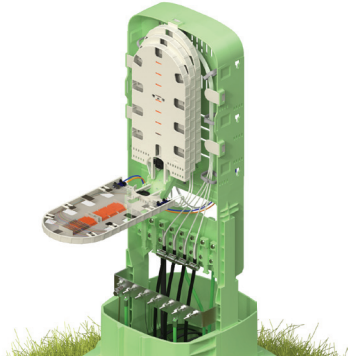

# COYOTE® 10" PEDESTAL FLIP TRAY KIT

## INSTALLATION INSTRUCTIONS



### IMPORTANT SAFETY INFORMATION

**READ AND COMPLETELY UNDERSTAND ALL INSTRUCTIONS BEFORE INSTALLING PRODUCT. FAILURE TO FOLLOW THESE INSTRUCTIONS MAY RESULT IN PERSONAL INJURY OR DEATH.**

This product is intended for use by trained technicians only. This product should not be used by anyone who is not familiar with and not trained to use it. When working in the area of energized lines, extra care should be taken to prevent accidental electrical contact. Be sure to wear proper safety equipment per your company protocol. These instructions are not intended to supersede any company construction or safety standards. These instructions are offered only to illustrate safe installation for the individual. PLP products are intended for the specified application only. Do not modify this product under any circumstances. Do not reuse or reinstall any PLP product unless that capability is expressly indicated in the product's Installation Instructions. For proper performance and personal safety, be sure to select the proper PLP product before installation. PLP products are precision devices. To ensure proper performance, they should be stored in cartons under cover and handled carefully.

### PACKAGE COMPONENTS

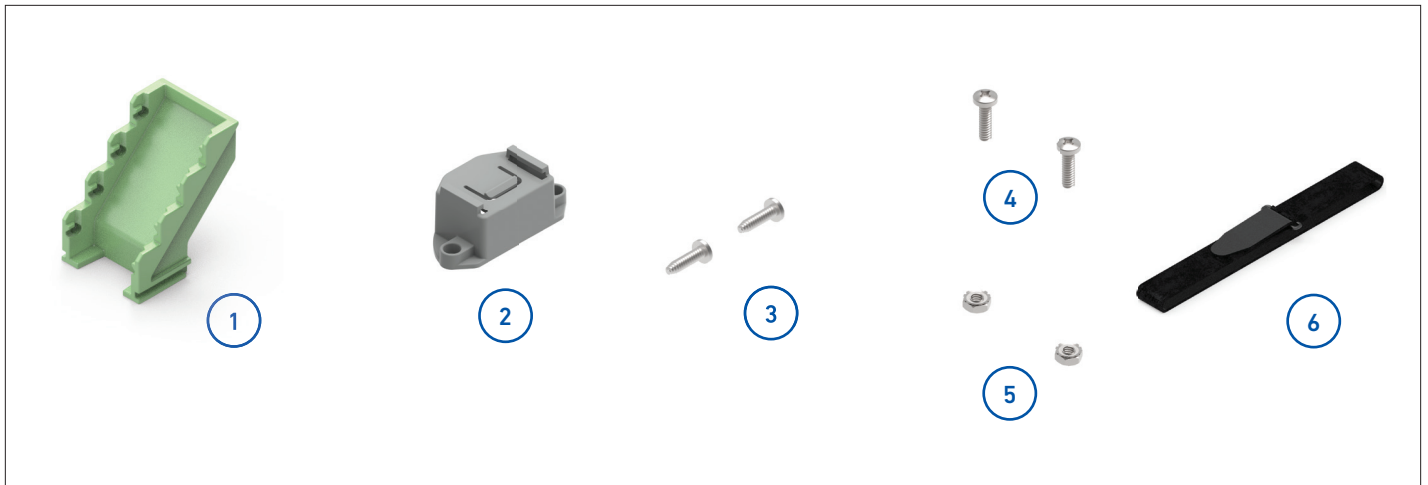

1. Flip Tray Tower (1)
2. Flip Tray Spacer (1)
3. Screw, #6 x 1/2" (2)
4. Bolt, #6 x 1/2" (2)
5. Keps Nut, #6 (2)
6. Hold Down Strap (1)

#### Tools Required:

- Fiber Optic Cable Opening Tools
- Phillips Head Screwdriver

- 1 Install the flip tray spacer to the organizer by aligning the brackets with the features in the organizer as shown.

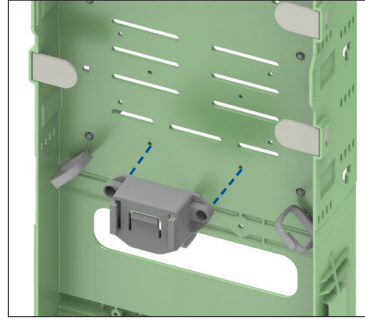

For Medium Flip Trays

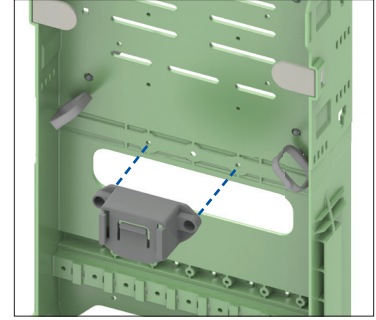

For Long HD Flip Trays

- 2 Secure the flip tray spacer to the organizer using the screws provided.

**NOTE:** For long HD flip trays, the spacer will be secured with the nuts and bolts provided.

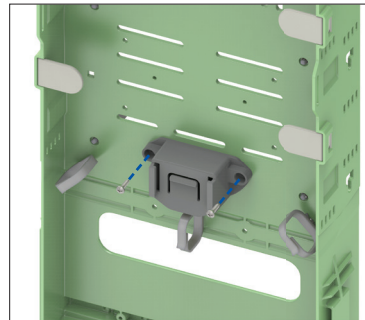

For Medium Flip Trays

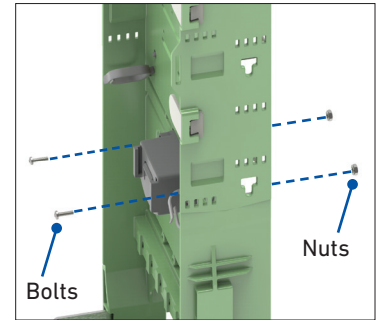

For Long HD Flip Trays

- 3 Install the flip tray tower onto the spacer by sliding it into the slots of the spacer. The tower is fully engaged into the spacer when the top of the tower is flush with the top of the spacer.

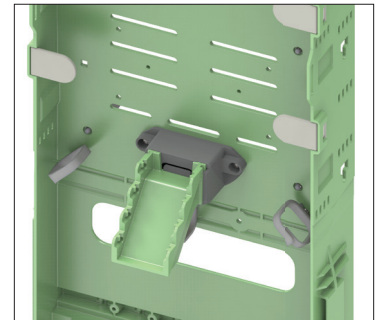
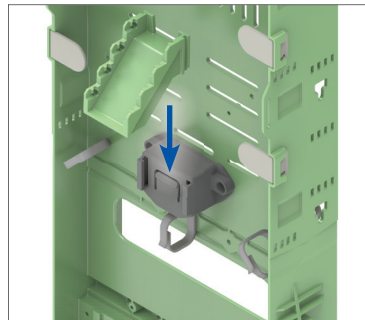

- 4 Install a flip tray into the tower by pushing the slide lock towards the tray and squeezing the tray legs together.

The flip trays can be locked in position by pushing the slide lock towards the flip tray spacer.

**NOTE:** The first thin profile tray should be installed at the position closest to the organizer as shown in the image. For deep profile trays, skip a position in the tower.

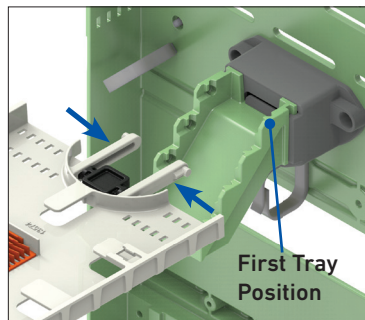

First Tray Position

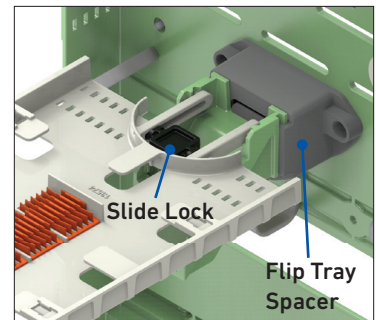

Slide Lock

Flip Tray Spacer

5

When trays are stored in the upright position, the slide lock will fall down and secure them in their position. To flip them down to access fibers, push the slide lock towards the trays and rotate the trays down.

**NOTE:** The slide lock must be in the locked position for each tray that is being accessed. Lock ALL the flip trays in the stack, **NOT** just the bottom tray.

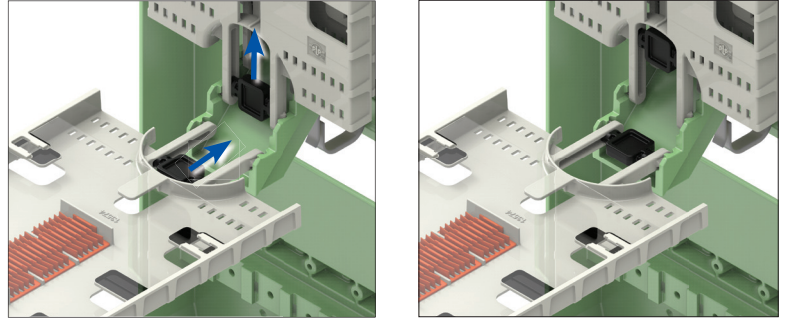

6

Route the buffer tube(s) to the tray(s) and secure them to the flip tray(s) according to the installation instructions provided with each tray.

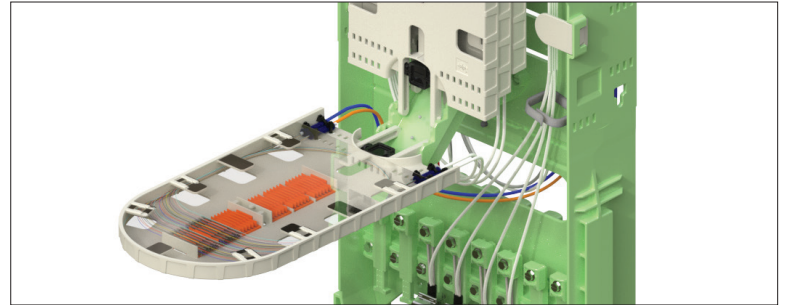

7

Route the fibers on the flip tray according to the installation instructions included with the tray kit. Splice the fibers according to your standard company practices.

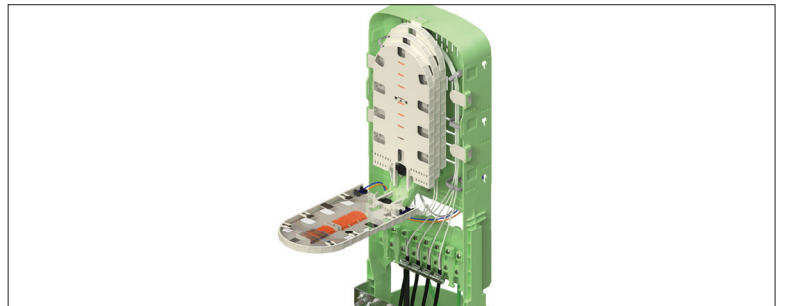

8

Secure the flip tray(s) to the organizer with the hold down strap.

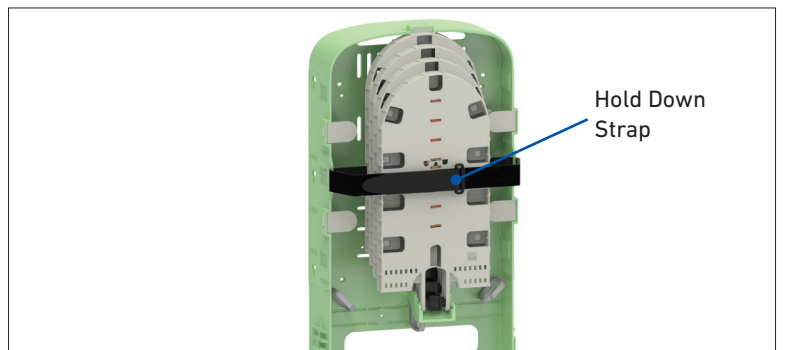

## APPENDIX

### COYOTE® Splice Tray Capacity Chart for COYOTE 10" Pedestal

PLP Catalog Number	Description	Image	Splice Type	Max Trays per Closure	Closure Max Splice Capacity
80814405	Flip Medium Thin Profile (72 CT SF / 144 CT MF)		Single Fusion (Double Stack) OR Mass Fusion/ Ribbon	4	288 SF 288 MF
80814406	Flip Medium Deep Profile (72 CT SF / 288 CT MF)		Single Fusion (Double Stack) OR Mass Fusion/ Ribbon	2	144 SF 576 MF
80813238	HD Flip Long Thin Profile (72 CT SF/288 CT MF)		Single Fusion (Double Stack) OR Mass Fusion/ Ribbon	4	288 SF 1,152 MF
80813301	HD Flip Long Thin Profile (108 CT)		Single Fusion (Double Stack)	4	432
80813121	HD Flip Long Deep Profile (288 CT)		Mass Fusion/ Ribbon	2	576 MF